

WIND/SOLAR ENERGY GENERATION OVERLAY (WSE-O) PLAN (WSEO-17-001)

FOR THE FRONT RANGE-MIDWAY SOLAR PROJECT

EL PASO COUNTY, COLORADO

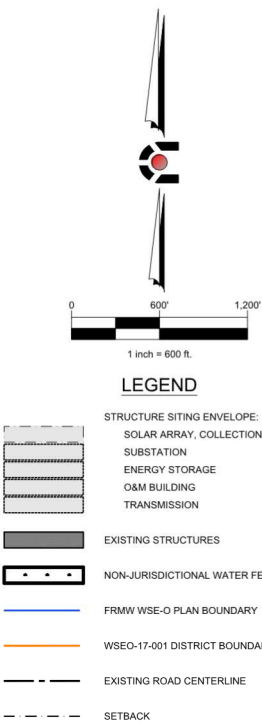
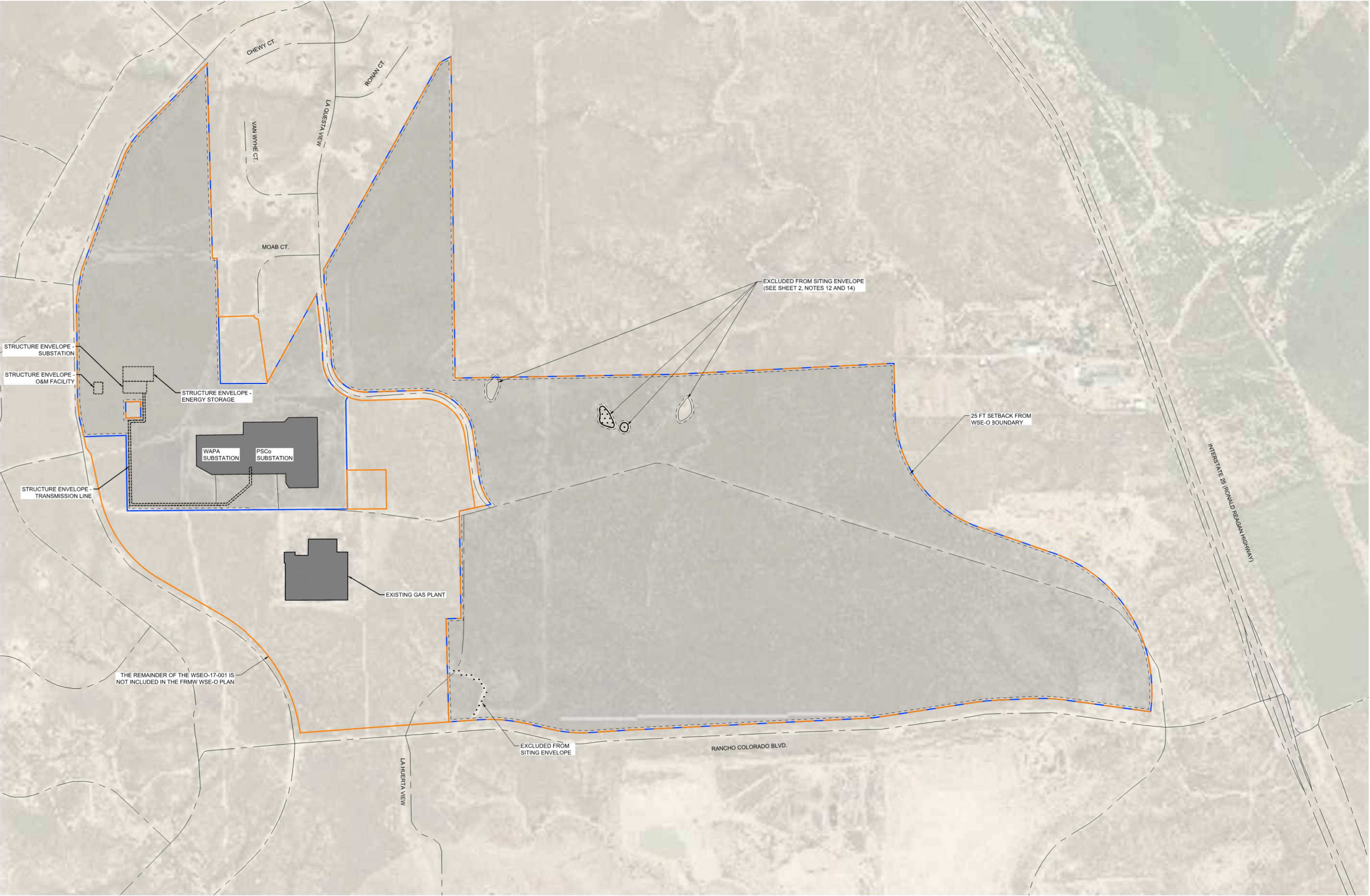

6/16/2020 8:08 AM : X:\15-177 FRMW SOLAR - EARLY ASSISTANCE\CIVIL\CAD\PLANS\DWG\PROPOSED MAP.DWG

PRELIMINARY - NOT FOR CONSTRUCTION

CIVIL ENGINEERING
DEVELOPMENT CONSULTING
NATURAL RESOURCES CONSULTING
LAND SURVEYING
303.705.4444
1950 W. Littleton Blvd., Ste. 109
Littleton, CO 80120

CALL US BEFORE YOU CONSIDER BREAKING
THE GRADE OR LOCATING FOR THE MARKING OF
UNDERGROUND UTILITY.

CORE ASSUMES NO RESPONSIBILITY FOR EXISTING UTILITY
LOCATIONS HORIZONTAL AND VERTICAL. THE EXISTING
LOCATIONS HORIZONTAL AND VERTICAL INFORMATION, IT IS HOWEVER,
FROM THE BEST AVAILABLE INFORMATION. IT IS HOWEVER,
THE LOCATION OF ALL UTILITIES PRIOR TO THE
COMPLETION OF ANY CONSTRUCTION ACTIVITIES.

#	REVISION DESCRIPTION	DATE	BY
1	FIRST SUBMITTAL	06/17/20	TP

WSE-O PLAN (WSEO-17-001)
EL PASO COUNTY, COLORADO

FRONT RANGE-MIDWAY SOLAR PROJECT
PROPOSED SOLAR GENERATION MAP

DESIGNED BY:	TP
DRAWN BY:	TP
CHECKED BY:	DB
JOB NO.	19-177
SHEET	5 OF 13