

SITE PLAN

12427 Ellingwood Peak Pl ✓

Peyton, CO 80831 ✓

Parcel ID: 4230106027 ✓

Lot area: 0.23 Acres ✓

Paper Size: 11"x17" ✓

ADD26299

PLAT-12169

PUD

APPROVED 250 SQ FT

DECK - NEW

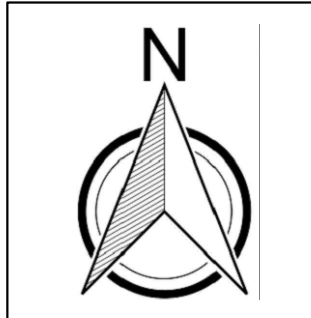

scale 1"=20'

Ellingwood Peak Pl

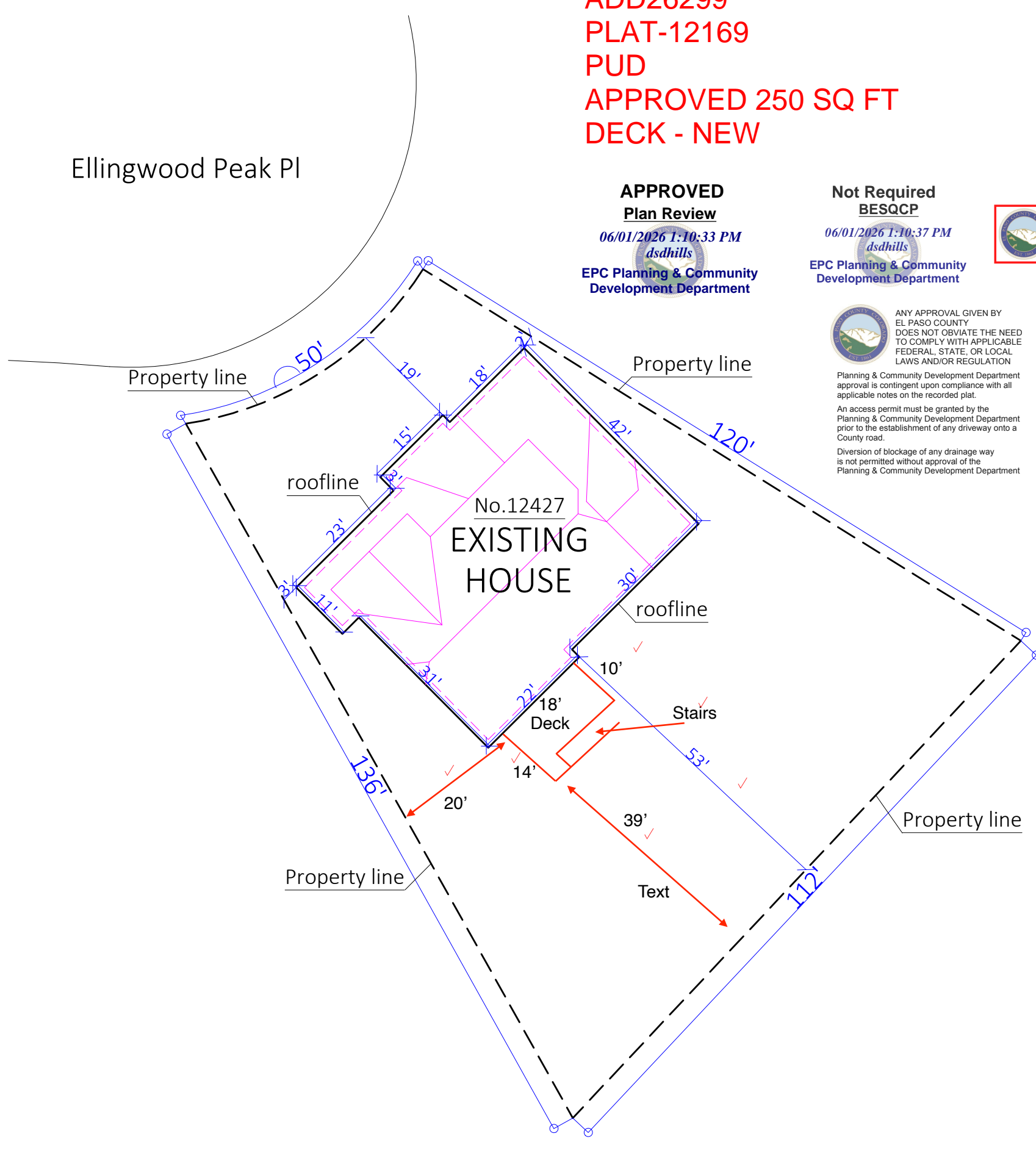

APPROVED
Plan Review

06/01/2026 1:10:33 PM

dsdhills

EPC Planning & Community
Development Department

Not Required
BESQCP

06/01/2026 1:10:37 PM

dsdhills

EPC Planning & Community
Development Department



It is the owner's responsibility to coordinate with easement holders to avoid impact to utilities that may be located in the easements.



ANY APPROVAL GIVEN BY EL PASO COUNTY DOES NOT OBLIATE THE NEED TO COMPLY WITH APPLICABLE FEDERAL, STATE, OR LOCAL LAWS AND/OR REGULATION

Planning & Community Development Department approval is contingent upon compliance with all applicable notes on the recorded plat.

An access permit must be granted by the Planning & Community Development Department prior to the establishment of any driveway onto a County road.

Diversion of blockage of any drainage way is not permitted without approval of the Planning & Community Development Department

Project:
Remove and replace deck
Uncovered
Approx. 250 SqFt ✓
Approx. 8'-6" high ✓

Parcel No: 4230106027

Lot Description: LOT 43 MERIDIAN ✓
RANCH FIL NO 2 ✓

Lot Size: 10,036
House: 1,311
Garage: 640
Deck: 250 ✓
Lot COverage: ~22% ✓

Zoning: PUD ✓

Plat No: R12169 ✓

Disclaimer

This is not a Legal Survey, nor is it intended to be or replace one.

These measurements are approximate and are for illustrative purposes only.

This work product represents only generalized location of features, objects or boundaries and should not be relied upon as being legally authoritative for the precise location of any feature, objects or boundary.

RESIDENTIAL



2023 PPRBC
IECC: N/A

Address: 12427 ELLINGWOOD PEAK PL, PEYTON

Parcel: 4230106027

Plan Track #: 213471 

Received: 22-May-2026 (NICOLASV)

Description:

DECK - NEW

Contractor: WE BUILD DECKS LLC

Type of Unit:

Required PPRBD Departments (2)

Floodplain

(N/A) RBD GIS

Construction

Required Outside Departments (1)

County Zoning

APPROVED
Plan Review
06/01/2026 1:11:22 PM

EPC Planning & Community
Development Department

Release of this plan does not preclude compliance with all applicable codes, ordinances and other pertinent regulations. This plan set must be present on the job site for every inspection.