

VICINITY MAP

FLYING HORSE NORTH FILING NO. 3

A PORTION OF SECTION 36, TOWNSHIP 11 SOUTH, RANGE 66 WEST OF THE SIXTH PRINCIPAL MERIDIAN,
COUNTY OF EL PASO, STATE OF COLORADO

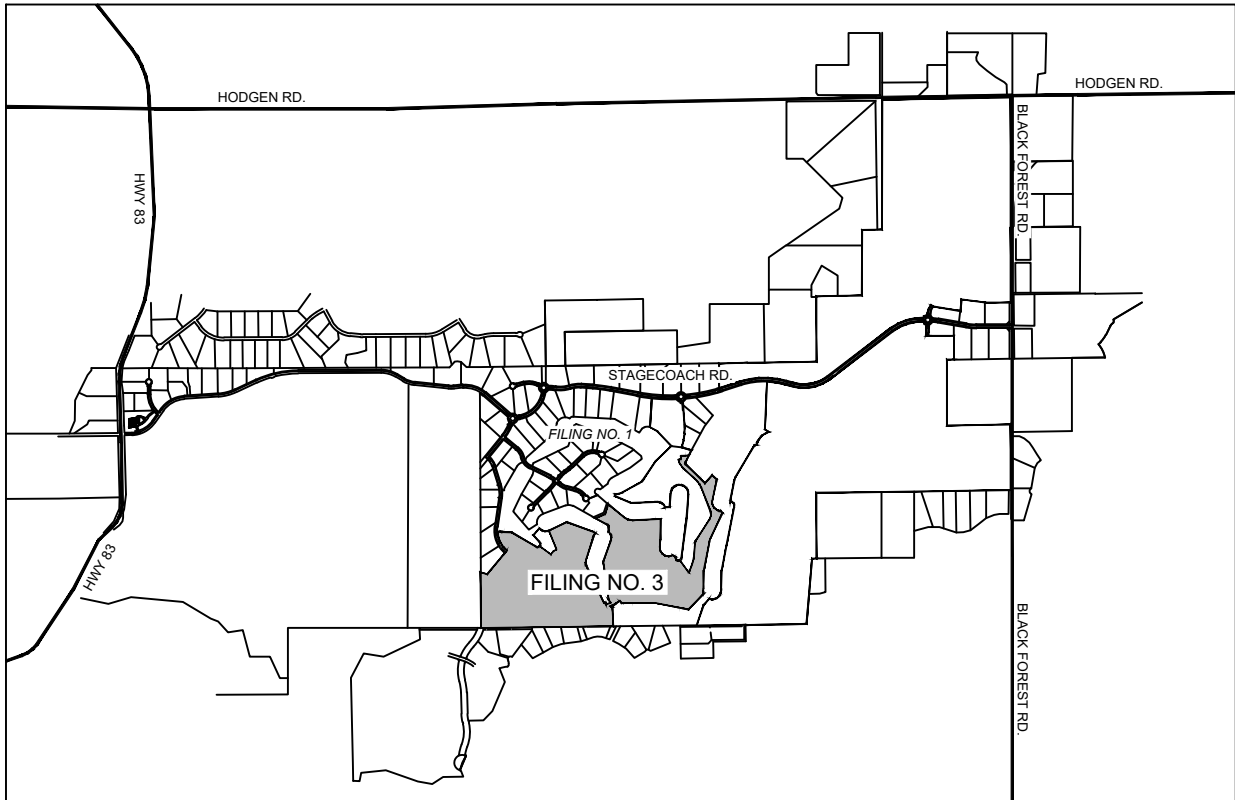

NOT TO SCALE