



MARK	DATE	REVISIONS

NO. OF SHEETS: 01/15/2020
 DATE: 01/15/2020
 DRAWN: JBC
 CHECKED: JBC
 PROJECT: E100

GENERAL PHOTOMETRY NOTES

- A. THESE PHOTOMETRIC CALCULATIONS ARE BASED ON THE FOLLOWING ASSUMPTIONS AND CORRECTION FACTOR:
- B. ALL LIGHT FIXTURES SHALL BE OF THE SAME COGNOMINE LEVELS SHOWING TO VARIABLE FIELD CONDITIONS, SUCH AS LAWN, PARK, AND DRIVE RECREATION.
- C. THE PLAN IS BASED ON THE INFORMATION AVAILABLE. THE LUMINAIRE LOCATIONS SHOWN MUST BE COORDINATED WITH EXISTING OR FUTURE FIELD CONDITIONS.
- D. ALL DIMENSIONS SHALL BE FROM DUK TO DOWN FOR SECURITY REASON.

Measurement at Property Boundaries
 Light levels measured at the property line of the development site adjacent to residential property shall be not less than 0.1 foot candles as a direct result of the on-site lighting. All light fixtures mounted within 15' of the property line shall be classified as IES Type I or Type III, or shall be demonstrated to provide similar distribution patterns. All light fixtures shall be fitted with "shielding" reflectors on the sides facing the residential property line.

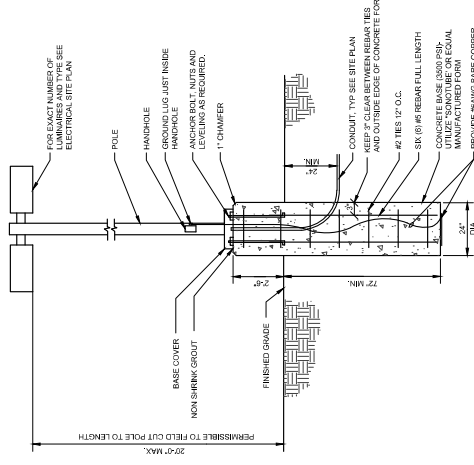
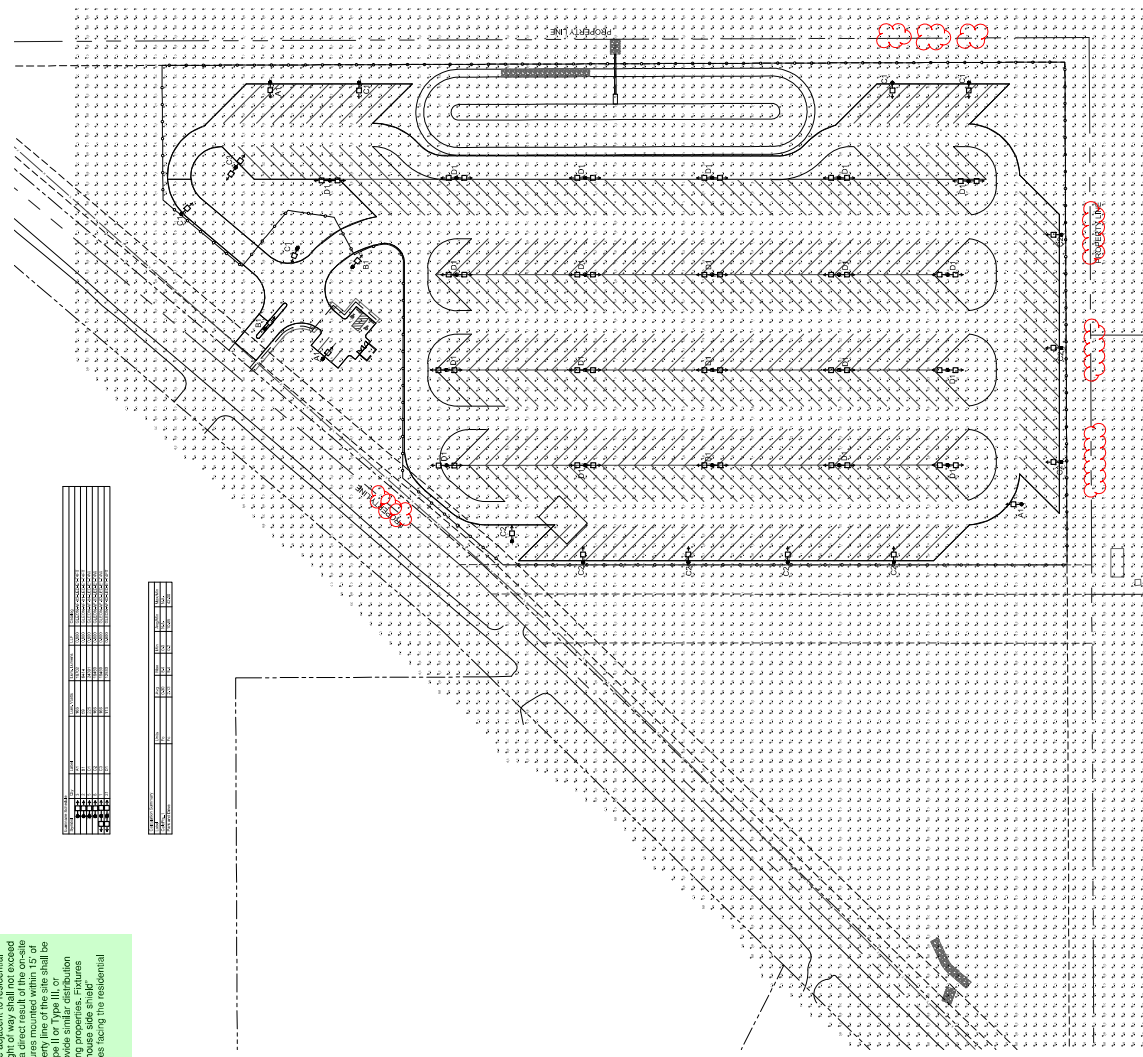

1 TYPICAL POLE BASE DETAIL
 NOT TO SCALE





REVISION	DATE	COMMENT

FIG. 1
GENERAL INFORMATION

GENERAL CONDITIONS:
1. All work shall be in accordance with the Division of Work included in the Schematic Schedule of Values and the Division of Work included in the Construction Documents.
2. The Contractor shall be responsible for obtaining all permits, licenses, and approvals required for the performance of the work.
3. The Contractor shall be responsible for coordinating with all other trades and utility companies to ensure that the work is completed in a timely and efficient manner.
4. The Contractor shall be responsible for maintaining safe access to all existing and adjacent structures and utilities.
5. The Contractor shall be responsible for protecting all existing structures and utilities from damage during the performance of the work.
6. The Contractor shall be responsible for cleaning up all work areas and removing all debris and materials from the site upon completion of the work.
7. The Contractor shall be responsible for maintaining accurate records of all materials used and labor hours expended during the performance of the work.

ITEMS TO BE SUPPLIED BY OTHERS:
1. Electrical power to the site.
2. Water supply to the site.
3. Gas supply to the site.
4. Sewer service to the site.

DATE: 04/15/2020

FIG. 2
LUMINAIRES

GENERAL CONDITIONS:
1. All work shall be in accordance with the Division of Work included in the Schematic Schedule of Values and the Division of Work included in the Construction Documents.
2. The Contractor shall be responsible for obtaining all permits, licenses, and approvals required for the performance of the work.
3. The Contractor shall be responsible for coordinating with all other trades and utility companies to ensure that the work is completed in a timely and efficient manner.
4. The Contractor shall be responsible for maintaining safe access to all existing and adjacent structures and utilities.
5. The Contractor shall be responsible for protecting all existing structures and utilities from damage during the performance of the work.
6. The Contractor shall be responsible for cleaning up all work areas and removing all debris and materials from the site upon completion of the work.
7. The Contractor shall be responsible for maintaining accurate records of all materials used and labor hours expended during the performance of the work.

ITEMS TO BE SUPPLIED BY OTHERS:
1. Electrical power to the site.
2. Water supply to the site.
3. Gas supply to the site.
4. Sewer service to the site.

DATE: 04/15/2020

FIG. 3
LUMINAIRES

GENERAL CONDITIONS:
1. All work shall be in accordance with the Division of Work included in the Schematic Schedule of Values and the Division of Work included in the Construction Documents.
2. The Contractor shall be responsible for obtaining all permits, licenses, and approvals required for the performance of the work.
3. The Contractor shall be responsible for coordinating with all other trades and utility companies to ensure that the work is completed in a timely and efficient manner.
4. The Contractor shall be responsible for maintaining safe access to all existing and adjacent structures and utilities.
5. The Contractor shall be responsible for protecting all existing structures and utilities from damage during the performance of the work.
6. The Contractor shall be responsible for cleaning up all work areas and removing all debris and materials from the site upon completion of the work.
7. The Contractor shall be responsible for maintaining accurate records of all materials used and labor hours expended during the performance of the work.

ITEMS TO BE SUPPLIED BY OTHERS:
1. Electrical power to the site.
2. Water supply to the site.
3. Gas supply to the site.
4. Sewer service to the site.

DATE: 04/15/2020

FIG. 4
LUMINAIRES

GENERAL CONDITIONS:
1. All work shall be in accordance with the Division of Work included in the Schematic Schedule of Values and the Division of Work included in the Construction Documents.
2. The Contractor shall be responsible for obtaining all permits, licenses, and approvals required for the performance of the work.
3. The Contractor shall be responsible for coordinating with all other trades and utility companies to ensure that the work is completed in a timely and efficient manner.
4. The Contractor shall be responsible for maintaining safe access to all existing and adjacent structures and utilities.
5. The Contractor shall be responsible for protecting all existing structures and utilities from damage during the performance of the work.
6. The Contractor shall be responsible for cleaning up all work areas and removing all debris and materials from the site upon completion of the work.
7. The Contractor shall be responsible for maintaining accurate records of all materials used and labor hours expended during the performance of the work.

ITEMS TO BE SUPPLIED BY OTHERS:
1. Electrical power to the site.
2. Water supply to the site.
3. Gas supply to the site.
4. Sewer service to the site.

DATE: 04/15/2020

FIG. 5
LUMINAIRES

GENERAL CONDITIONS:
1. All work shall be in accordance with the Division of Work included in the Schematic Schedule of Values and the Division of Work included in the Construction Documents.
2. The Contractor shall be responsible for obtaining all permits, licenses, and approvals required for the performance of the work.
3. The Contractor shall be responsible for coordinating with all other trades and utility companies to ensure that the work is completed in a timely and efficient manner.
4. The Contractor shall be responsible for maintaining safe access to all existing and adjacent structures and utilities.
5. The Contractor shall be responsible for protecting all existing structures and utilities from damage during the performance of the work.
6. The Contractor shall be responsible for cleaning up all work areas and removing all debris and materials from the site upon completion of the work.
7. The Contractor shall be responsible for maintaining accurate records of all materials used and labor hours expended during the performance of the work.

ITEMS TO BE SUPPLIED BY OTHERS:
1. Electrical power to the site.
2. Water supply to the site.
3. Gas supply to the site.
4. Sewer service to the site.

DATE: 04/15/2020

FIG. 6
LUMINAIRES

GENERAL CONDITIONS:
1. All work shall be in accordance with the Division of Work included in the Schematic Schedule of Values and the Division of Work included in the Construction Documents.
2. The Contractor shall be responsible for obtaining all permits, licenses, and approvals required for the performance of the work.
3. The Contractor shall be responsible for coordinating with all other trades and utility companies to ensure that the work is completed in a timely and efficient manner.
4. The Contractor shall be responsible for maintaining safe access to all existing and adjacent structures and utilities.
5. The Contractor shall be responsible for protecting all existing structures and utilities from damage during the performance of the work.
6. The Contractor shall be responsible for cleaning up all work areas and removing all debris and materials from the site upon completion of the work.
7. The Contractor shall be responsible for maintaining accurate records of all materials used and labor hours expended during the performance of the work.

ITEMS TO BE SUPPLIED BY OTHERS:
1. Electrical power to the site.
2. Water supply to the site.
3. Gas supply to the site.
4. Sewer service to the site.

DATE: 04/15/2020