

File Location: Q:\IDEN\Projects\0399-00 Mountain View Academy\Design\CDs\Civil\Phase II\GEC\GEC.dwg Plot Date: 2/6/2020 4:19 PM Last Saved By: SZIMMERMANN

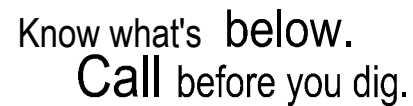

-

1. EXISTING VEGETATION CONSISTS ENTIRELY OF NATIVE GRASSES AND WEED SPECIES.
2. SURFACE ROUGHENING WILL BE PERFORMED IN ALL TEMPORARILY INACTIVE AREAS WITH DISTURBED SOILS.
3. EROSION CONTROL BLANKETS TO BE INSTALLED AT CONTRACTOR'S DISCRETION ON ALL DISTURBED SLOPES STEEPER THAN 4:1.
4. ALL DISTURBED AREAS TO BE SEEDED AND MULCHED UPON PROJECT COMPLETION OR WITHIN 14 DAYS OF INACTIVITY.
5. ALL BMP'S TO REMAIN IN PLACE UPON PROJECT COMPLETION.

[illegible]

MOUNTAIN VIEW ACADEMY
GRADING AND EROSION CONTROL PLAN
INITIAL GEC

TITLE:

PE STAMP

65120399

02/07/2020
DATE

GEC-1

2 of 4

FOR AND ON BEHALF OF MERRICK & COMPANY

File Location: Q:\DENI\Projects\0399-00 Mountain View Academy\Design\CDs\Civil\Phase II\GEC\GEC.dwg Plot Date: 2/6/2020 4:30 PM Last Saved By: SZIMMERMANIN

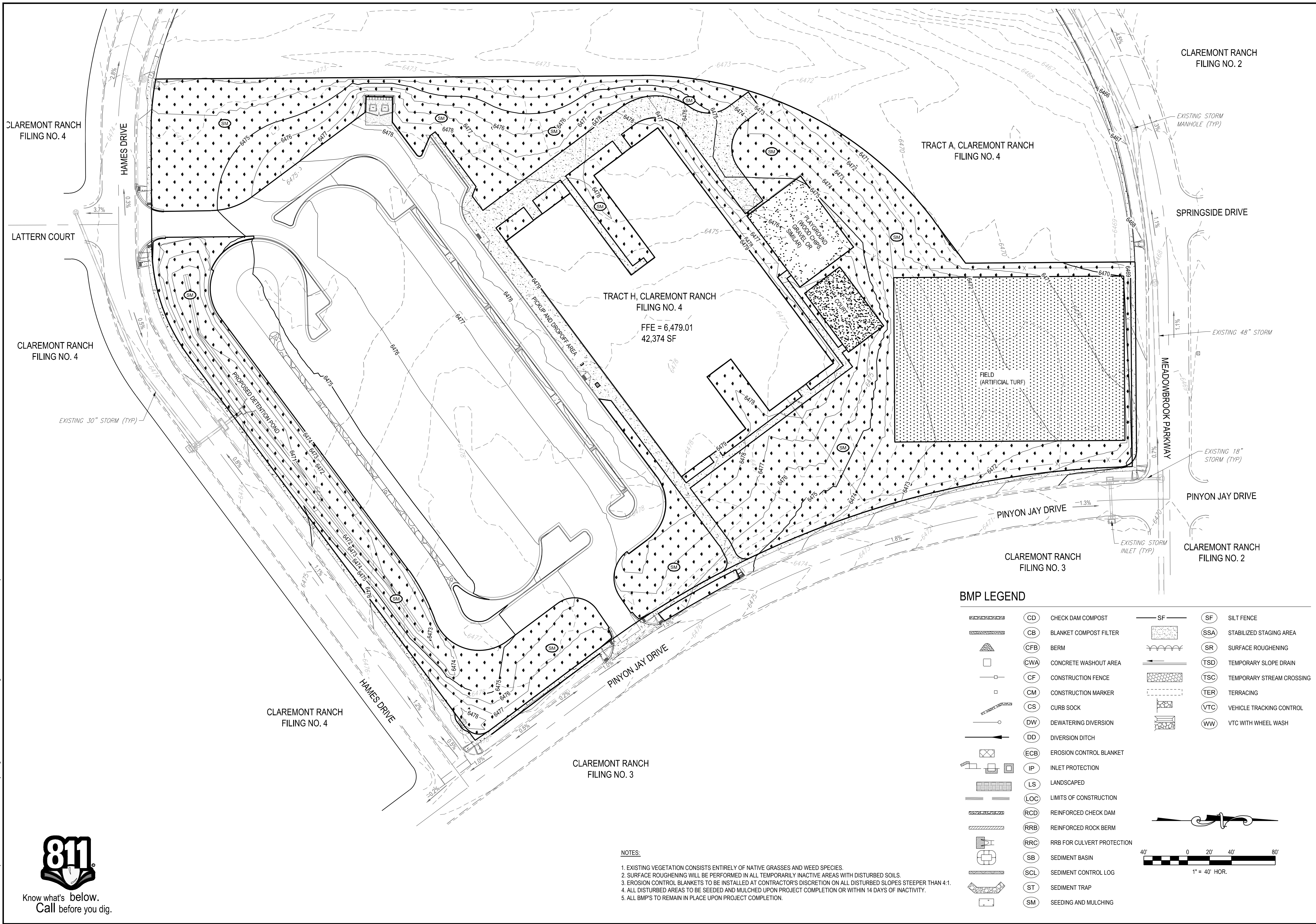
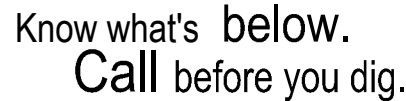
[illegible]