

RICHMOND AMERICAN HOMES

JOB#28380039

PLOT PLAN

LOT 39

SFD24521

LOT 39 SCHEDULE NUMBER 5405101069
 LOT 40 SCHEDULE NUMBER 5405101070

APPROVED
BESQCP
 05/22/2024 8:58:36 AM
 dsdyounger
 EPC Planning & Community
 Development Department

APPROVED
Plan Review
 05/22/2024 8:58:41 AM
 dsdyounger
 EPC Planning & Community
 Development Department

It is the owner's responsibility to coordinate with easement holders to avoid impact to utilities that may be located in the easements.

ANY APPROVAL GIVEN BY B&J SURVEYING, INC. DOES NOT CONSTITUTE THE NEED TO COMPLY WITH APPLICABLE FEDERAL, STATE OR LOCAL LAWS AND/OR REGULATIONS.
 Planning & Community Development Department approval is required prior to construction with all applicable rules on the record plat.
 An access permit must be obtained by the Planning & Community Development Department prior to the establishment of any driveway onto a County road.
 Division of drainage of any drainage may be not permitted without approval of the Planning & Community Development Department.

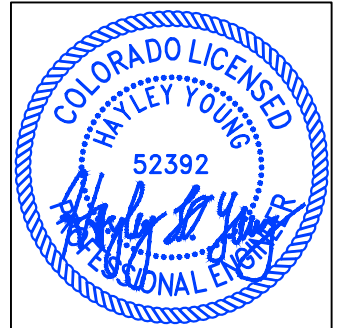
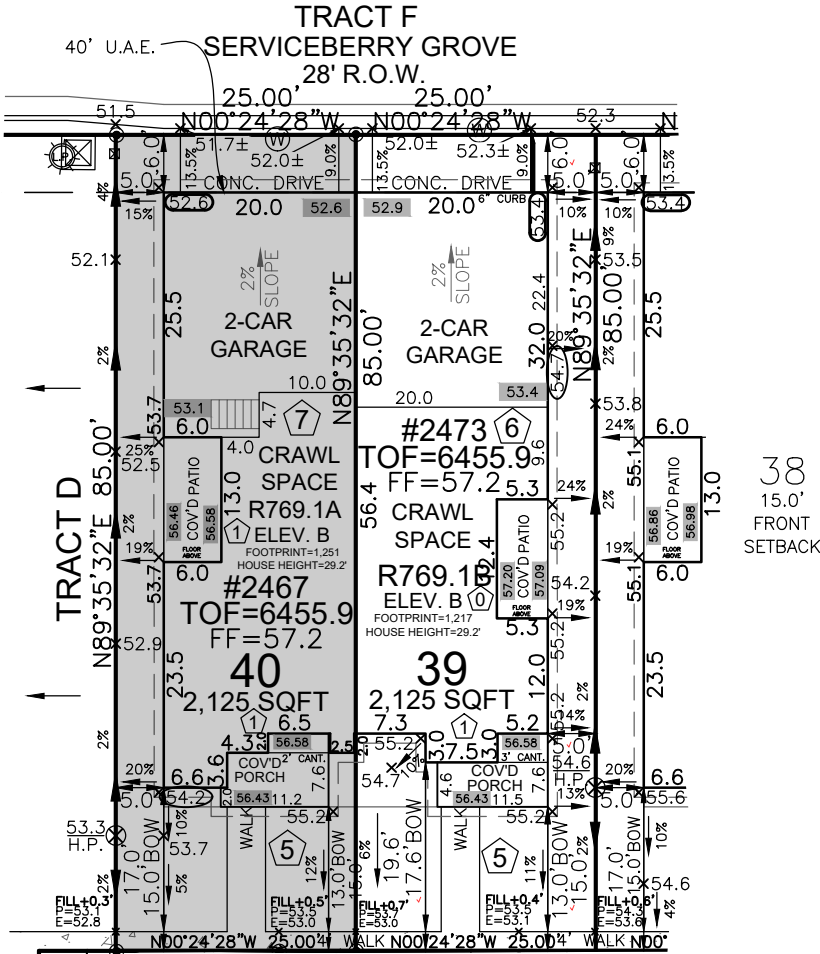

HAYLEY YOUNG, P.E.
 DATE: 04.20.24
 I HEREBY CERTIFY ONLY THE ELEMENTS OF THIS DOCUMENT THAT FALL WITHIN THE SCOPE OF MY DUTIES AS A P.E.

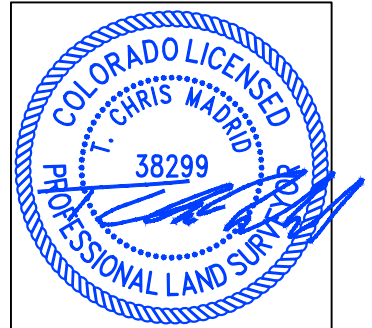

T. CHRIS MADRID, P.L.S.
 DATE: 04.20.24
 I HEREBY CERTIFY ONLY THE ELEMENTS OF THIS DOCUMENT THAT FALL WITHIN THE SCOPE OF MY DUTIES AS A P.L.S.

AVG F.G CALC.

| |
|---------------|
| 55.2 |
| 55.2 |
| 53.4 |
| +52.9 |
| 216.7/4= 54.2 |

ALLEY SETBACK DRIVE COVERAGE
 ALLEY SETBACK=150 SF
 DRIVE COVERAGE IN
 ALLEY SETBACK=109 SF
 COVERAGE=72.6%

NOTE:
 LOTS 1-24 ADDRESSED FROM VANHOUTTE VIEW,
 25-40 ADDRESSED FROM SERVICEBERRY GROVE,
 41-44 ADDRESSED FROM FOUNTAIN GRASS GROVE,
 65-74 ADDRESSED FROM FOUNTAIN GRASS GROVE,
 75-88 ADDRESSED FROM PURPLE FOUNTAIN POINT,
 95-100 ADDRESSED FROM FOERSTER GRASS VIEW - WITH ADDRESSES PLACED AT FRONT & REAR OF THE HOME .

LOT = 40
TOF = 55.9
GARAGE SLAB = 52.6
GRADE BEAM = 44"
 (55.9 - 52.6 = 03.3 * 12 = 40" + 4" = 44")
 *FROST DEPTH MUST BE MAINTAINED
LOWERED FINISH GRADE ALONG HOUSE
 POUR TALLER WALL IN GARAGE TO MAINTAIN FROST PROTECTION
LOWERED FINISH GRADE AT PATIO
 CUT/FILL AT LOCATIONS SHOWN FOR ADEQUATE DRAINAGE

LOT = 39
TOF = 55.9
GARAGE SLAB = 52.9
GRADE BEAM = 40"
 (55.9 - 52.9 = 03.0 * 12 = 36" + 4" = 40")
 *FROST DEPTH MUST BE MAINTAINED
LOWERED FINISH GRADE ALONG HOUSE
 POUR TALLER WALL IN GARAGE TO MAINTAIN FROST PROTECTION
CUT/FILL AT LOCATIONS SHOWN FOR ADEQUATE DRAINAGE
 POUR 6" CURB ALONG SIDE OF DRIVE TO PROVIDE POSITIVE DRAINAGE

LEGEND

LOWERED FINISH GRADE:

- (XX.X) HOUSE
- (XX.X) PORCH
- (XX.X) GARAGE/CRAWL SPACE
- (XX.X) FOUNDATION STEP
- (XX) CONCRETE
- (X) RISER COUNT
- (XX.XX) CONCRETE ELEVATION
- ([XX.X]) GRADING PLAN ELEVATION
- OVEREX LIMITS

Released for Permit
 04/30/2024 10:29:37 AM
 BECKY A
 ENUMERATION

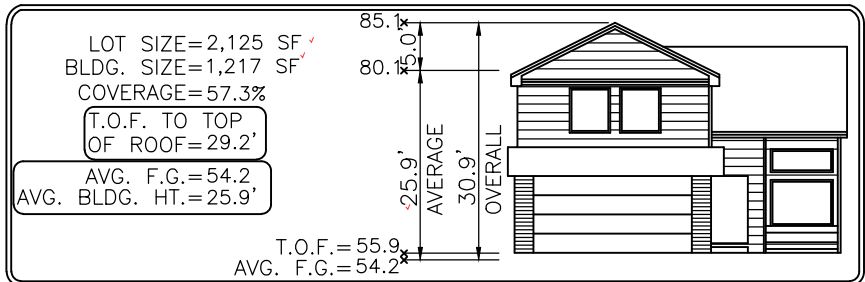
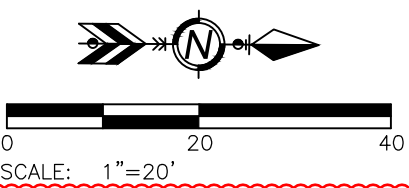

Elevation view of building is an illustrative tool only to indicate the calculation for the average building height.

LOT 39 MODEL OPTIONS: R769.1-B/2-CAR/CRAWL SPACE
 LOT 40 MODEL OPTIONS: R769.1-B/2-CAR/CRAWL SPACE

| | | | |
|---|---|---|--|
| SUBDIVISION: URBAN COLLECTION AT PALMER VILLAGE | | GENERAL NOTES: | |
| COUNTY: EL PASO | | <ul style="list-style-type: none"> PLOT PLAN NOT TO BE USED FOR EXCAVATION PLAN OR FOUNDATION PLAN LAYOUT. PLOT PLAN SUBJECT TO APPROVAL BY ZONING/BUILDING AUTHORITY PRIOR TO STAKEOUT. EASEMENTS DISPLAYED ON THIS PLOT ARE FROM THE RECORDED PLAT AND MAY NOT INCLUDE ALL EASEMENTS OF RECORD. PLOT PLAN MUST BE APPROVED BY BUILDER PRIOR TO ORDERING STAKEOUT. LOT CORNER ELEVATION CHECK: 05.30.23 | |
| ADDRESS: 2473 SERVICEBERRY GROVE | | | |
| MINIMUM SETBACKS: | DRAWN BY: DV | DATE: 04.19.24 | |
| FRONT: 15' | 6841 South Yosemite Street #100 Centennial, CO 80112 USA Phone: (303) 850-0559 Fax: (303) 850-0711 E-mail: info@bjsurveying.net | | |
| REAR: 6' | | | |
| SIDE: 5' | | | |



May 16, 2024

Marea Newmark
SCO Construction Admin Manager
Richmond American Homes
4350 S. Monaco St.
Denver, CO 80237

RE: Comcast consent; Eaves Encroachment
Feathergrass / Urban Collection at Palmer Lake.
Lots 13-24; 2429 Vanhoutte View thru 2495 Vanhoutte View
Lots 25-40 ; 2426 Serviceberry Grove thru 2467 Serviceberry Grove
Lots 41-44; 7371 Fountain Grass Grove thru 7383 Fountain Grass Grove
Lots 47-54; 2454 Hannah Ridge Drive thru 2482 Hannah Ridge Drive

You contacted us requesting a letter of consent to encroach on the side lot easement for the above listed address.

Comcast has no issue and will grant consent.

This consent does not release any easement rights that Comcast has for this property.

Don't hesitate to contact me if there are any further questions.

Best Regards,

A handwritten signature in cursive script that reads "Jason Jacobsen".

Jason Jacobsen
Construction Supervisor
Jason_Jacobsen@cable.comcast.com



Memorandum

To: Marea Newmark, Richmond American Homes Date: May 08, 2024

From: Drew Makings Dept: Development Services

Re: Easement Encroachment Request for certain lots in Feathergrass.

This memo is in response to your May 1st, 2024 request for overhead roof eaves, soffit (aerial) and window well(s) (surficial) to encroach into the respective side lot easements for the following properties:

| | |
|---|---|
| <ul style="list-style-type: none">• 2495 Vanhoutte View• 2489 Vanhoutte View• 2483 Vanhoutte View• 2477 Vanhoutte View• 2471 Vanhoutte View• 2465 Vanhoutte View• 2459 Vanhoutte View• 2453 Vanhoutte View• 2447 Vanhoutte View• 2441 Vanhoutte View• 2435 Vanhoutte View• 2429 Vanhoutte View• 2426 Serviceberry Grove• 2432 Serviceberry Grove• 2438 Serviceberry Grove• 2444 Serviceberry Grove• 2450 Serviceberry Grove• 2456 Serviceberry Grove• 2462 Serviceberry Grove• 2468 Serviceberry Grove | <ul style="list-style-type: none">• 2474 Serviceberry Grove• 2480 Serviceberry Grove• 2486 Serviceberry Grove• 2492 Serviceberry Grove• 2485 Serviceberry Grove• 2479 Serviceberry Grove• 2473 Serviceberry Grove• 2467 Serviceberry Grove• 7389 Fountain Grass Grove• 7383 Fountain Grass Grove• 7377 Fountain Grass Grove• 7371 Fountain Grass Grove• 2482 Hannah Ridge Drive• 2478 Hannah Ridge Drive• 2474 Hannah Ridge Drive• 2470 Hannah Ridge Drive• 2466 Hannah Ridge Drive• 2462 Hannah Ridge Drive• 2458 Hannah Ridge Drive• 2454 Hannah Ridge Drive |
|---|---|

Colorado Springs Utilities does not object to the request to allow the subject easement encroachment provided that the following acknowledgements are made:

1. The projection does not deviate from the permitted plans with respect to location and dimension.
2. The location of any Utilities owned Natural Gas service is per Colorado Springs Utilities Gas Line Extension & Service Standards (2022)
3. The projection does not extend into the Side Lot Easement more than a maximum of Eighteen (18) inches.
4. If it is necessary to relocate any existing utility facilities, then such relocation shall be at the Applicant's expense, and if required, Applicant shall grant new easements for the relocated facilities.
5. This Response is only pertinent to Colorado Springs Utilities as ONE of MANY entities that has rights to this easement. Approval by CSU does NOT represent a WHOLESAL APPROVAL for this activity as there are other public entities that retain right under the Public Utility Easement.

Please contact me if you need additional information. Thank you,

Drew Makings, Engineer V
Utilities Development Services 668-8127

SITE



2023 PPRBC
2021 IECC

Address: 2473 SERVICEBERRY GRV, COLORADO SPRINGS

Parcel: 5405101069

Plan Track #: 189160 

Received: 30-Apr-2024 (BECKYA)

Description:

RESIDENCE

Type of Unit:

| | | |
|---------------|------|-------------------|
| Garage | 443 | |
| Main Level | 629 | |
| Upper Level 1 | 846 | |
| | 1918 | Total Square Feet |

Required PPRBD Departments (2)

| | |
|--|---|
| Enumeration APPROVED BECKYA 4/30/2024 11:30:00 AM | Floodplain (N/A) RBD GIS |
|--|---|

Required Outside Departments (1)

| |
|--|
| County Zoning APPROVED <u>Plan Review</u> <i>05/22/2024 8:56:32 AM</i> <i>dsdyounger</i> EPC Planning & Community Development Department |
|--|

Release of this plan does not preclude compliance with all applicable codes, ordinances and other pertinent regulations. This plan set must be present on the job site for every inspection.