



North is this direction. Please fix.

Lot north of property is the East fork of sand creek. No apparent business or lot.

Lot owned by: Bear Claw Landscaping 7301 Cole View Colorado Springs, CO. 80915

The property is shaped differently than depicted.

Lot owned by: Golden Age Preservation 7330 Cole View Colorado Springs, CO. 80915

Lot owned by: Brightview Landscaping Services 7343 Cole View Colorado Springs, CO. 80915







Identify all surface types on site as well as all anticipated parking and storage areas.

Equipment yard storage -Area by North, West & South fence walls are for equipment storage

Please identify lot ownership based on what is shown in the County Assessor's information.

Show where the storage areas will be depicted on this plan.

There is a 25' setback on this property line, show that there are no structures or equipment storage in that 25 feet setback.

- Mobile Work trailer: 30' x 8'2"-8' tall 
- Mobile Job site trailer: 50'long x14'wide & 10'6"-8'6" tall. 
- Mobile Job site trailer: 45'long x8 wide & 8' tall 
- 6ft security fence w/ green slats and 1ft of barbed wire on top surrounding lot. 
- Temporary structure: 65' Long x 30' wide & 17' tall. 
- Dumpster: 20'x8' Dumpster 
- Property Line/Easment 

Lot's/ housing comm. owned by: Meadow Brook Crossing, LLC 90 S. Cascade Ave, Suite 1500 Colorado Springs, CO. 80903

It does not appear that the property line and easements shown on this site plan accurately reflect what is shown in the Plat #12506. Please adjust the property line and easements to reflect what is shown within the Plat #12506. Additionally, as shown in the plat identify Tract B on the site plan.

Add PCD File No. AL1817

123'



North is this direction. Please fix.

37' from fence to Mobile Work trailer

9' from fence to Mobile Work trailer

35' from fence to Temporary structure

4' from fence to Mobile job site trailer

27' from fence to Temporary structure

3' from fence to mobile job site trailer

33' from fence to Mobile job site trailer

84' from north fence to dumpster

69' from south fence to Dumpster

43'

22'

Cole View

7315 Cole View

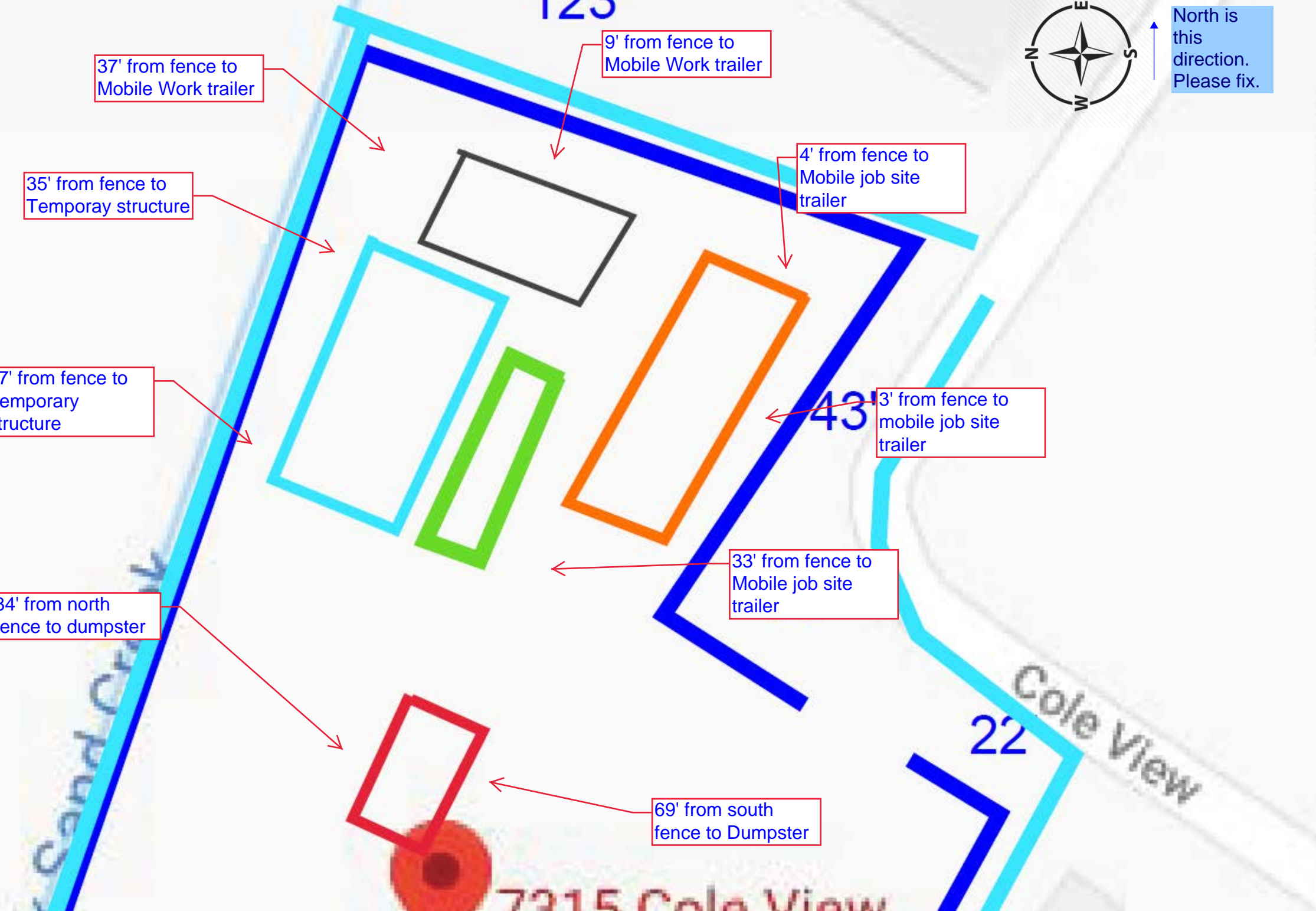

Markup Summary

dsdgrimm (8)

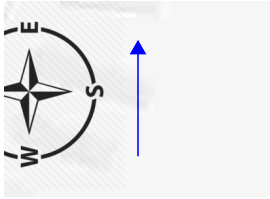

Subject: Arrow
Page Label: 1
Lock: Unlocked
Author: dsdgrimm
Date: 11/20/2018 1:01:16 PM
Color: ■

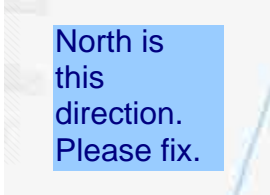

Subject: Engineer
Page Label: 1
Lock: Unlocked
Author: dsdgrimm
Date: 11/20/2018 1:02:16 PM
Color: ■

North is this direction. Please fix.

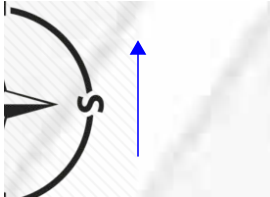

Subject: Arrow
Page Label: 2
Lock: Unlocked
Author: dsdgrimm
Date: 11/20/2018 1:02:48 PM
Color: ■

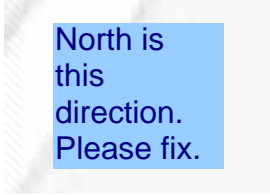

Subject: Engineer
Page Label: 2
Lock: Unlocked
Author: dsdgrimm
Date: 11/20/2018 1:02:57 PM
Color: ■

North is this direction. Please fix.

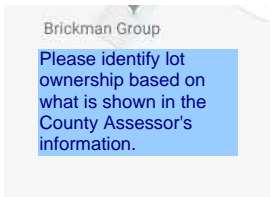

Subject: Engineer
Page Label: 1
Lock: Unlocked
Author: dsdgrimm
Date: 11/20/2018 1:08:14 PM
Color: ■

Please identify lot ownership based on what is shown in the County Assessor's information.

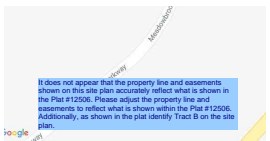

Subject: Engineer
Page Label: 1
Lock: Unlocked
Author: dsdgrimm
Date: 11/20/2018 1:19:19 PM
Color: ■

It does not appear that the property line and easements shown on this site plan accurately reflect what is shown in the Plat #12506. Please adjust the property line and easements to reflect what is shown within the Plat #12506. Additionally, as shown in the plat identify Tract B on the site plan.

Add PCD File
No. AL1817

Subject: Engineer
Page Label: 1
Lock: Unlocked
Author: dsdgrimm
Date: 11/20/2018 1:25:28 PM
Color: ■

Add PCD File No. AL1817

Identify all
surface types on
site as well as all
anticipated
parking and
storage areas.

Subject: Engineer
Page Label: 1
Lock: Unlocked
Author: dsdgrimm
Date: 11/20/2018 1:50:30 PM
Color: ■

Identify all surface types on site as well as all anticipated parking and storage areas.

dsdkendall (5)



Subject: Arrow
Page Label: 1
Lock: Unlocked
Author: dsdkendall
Date: 11/20/2018 1:51:06 PM
Color: ■

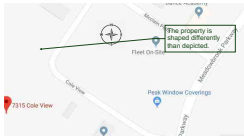

Subject: Callout
Page Label: 1
Lock: Unlocked
Author: dsdkendall
Date: 11/20/2018 1:51:32 PM
Color: ■

The property is shaped differently than depicted.

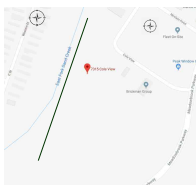

Subject: Arrow
Page Label: 1
Lock: Unlocked
Author: dsdkendall
Date: 11/20/2018 1:52:14 PM
Color: ■

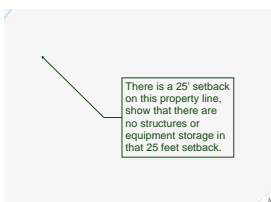

Subject: Callout
Page Label: 1
Lock: Unlocked
Author: dsdkendall
Date: 11/20/2018 1:52:59 PM
Color: ■

There is a 25' setback on this property line, show that there are no structures or equipment storage in that 25 feet setback.

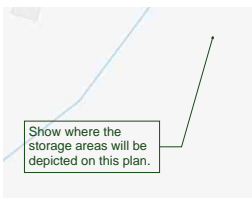

Subject: Callout
Page Label: 1
Lock: Unlocked
Author: dsdkendall
Date: 11/20/2018 2:00:12 PM
Color: ■

Show where the storage areas will be depicted on this plan.