



Show the structure that is in this area.

Show if there are any dumpsters on the premise.

Mobile Work trailer(storage):30' x 8'2"-8' tall 

Mobile Job site trailer 50'long x14'wide & 10'6"-8'6" tall. 

6ft security fence w/ green slats and 1ft of barbed wire on top surrounding lot. 

Storage areas cannot be taller than 6 feet. IF they are they must be placed in the rear third of the property.

Cab Storage Area

When I walked the property There were a couple spots of storage, please include more detail on where the storage areas are.

Site development plan application must meet all requirements of the Land Development Code, if you cannot meet areas of Ch. 6 you must formally request it as part of the special use application.

Show the following information:

- North arrow and scale
- All surface types on site
- All adjacent properties (owner and address)
- All anticipated parking areas
- Distances from property line to all existing and proposed structures
- Property line, all easements, and Tract B from the approved Plat #12506
- Based on a site visit, it appears that there is large temporary structure on site which must be shown on the site plan.

Markup Summary

dsdgrimm (1)

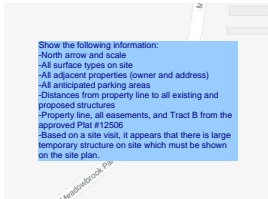

Subject: Engineer
Page Label: 1
Author: dsdgrimm
Date: 9/20/2018 4:49:42 PM
Color: ■

Show the following information:
-North arrow and scale
-All surface types on site
-All adjacent properties (owner and address)
-All anticipated parking areas
-Distances from property line to all existing and proposed structures
-Property line, all easements, and Tract B from the approved Plat #12506
-Based on a site visit, it appears that there is large temporary structure on site which must be shown on the site plan.

dsdkendall (5)

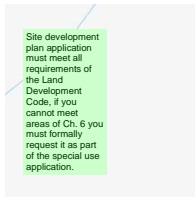

Subject: Text Box
Page Label: 1
Author: dsdkendall
Date: 9/24/2018 10:10:25 AM
Color: ■

Site development plan application must meet all requirements of the Land Development Code, if you cannot meet areas of Ch. 6 you must formally request it as part of the special use application.

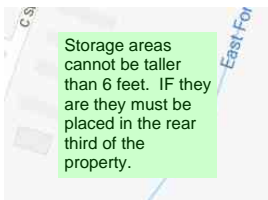

Subject: Text Box
Page Label: 1
Author: dsdkendall
Date: 9/24/2018 10:10:28 AM
Color: ■

Storage areas cannot be taller than 6 feet. IF they are they must be placed in the rear third of the property.

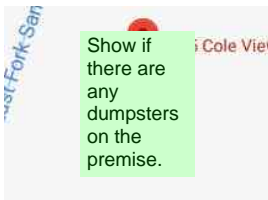

Subject: Text Box
Page Label: 1
Author: dsdkendall
Date: 9/24/2018 10:10:30 AM
Color: ■

Show if there are any dumpsters on the premise.

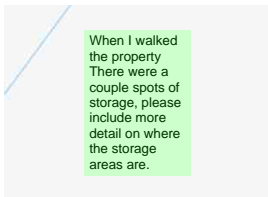

Subject: Text Box
Page Label: 1
Author: dsdkendall
Date: 9/24/2018 10:10:31 AM
Color: ■

When I walked the property There were a couple spots of storage, please include more detail on where the storage areas are.

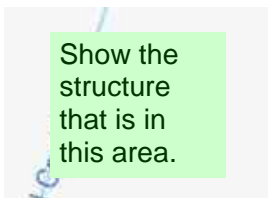

Subject: Text Box
Page Label: 1
Author: dsdkendall
Date: 9/24/2018 10:10:33 AM
Color: ■

Show the structure that is in this area.