

SFD23352

ANY APPROVAL GIVEN BY EL PASO COUNTY DOES NOT OBVIATE THE NEED TO COMPLY WITH APPLICABLE FEDERAL, STATE, OR LOCAL LAWS AND/OR REGULATION

Planning & Community Development Department approval is contingent upon compliance with all applicable notes on the recorded plat.

An access permit must be granted by the Planning & Community Development Department prior to the establishment of any driveway onto a County road.

Diversion or blockage of any drainage way is not permitted without approval of the Planning & Community Development Department

It is the owner's responsibility to coordinate with easement holders to avoid impact to utilities that may be located in the easements.

APPROVED
Plan Review
05/16/2023 8:12:09 AM
dsdyounger
EPC Planning & Community
Development Department

Not Required
BESQCP
05/16/2023 8:12:04 AM
dsdyounger
EPC Planning & Community
Development Department

MOBILE HOME SITE PLAN

Mobile Home Park: Circle Drive

Space Number: 902 Size of Mobile Home: 14 x 40

Released for Permit
05/01/2023 11:38:39 AM
REGIONAL
BUILDING DEPARTMENT
brent
ENUMERATION

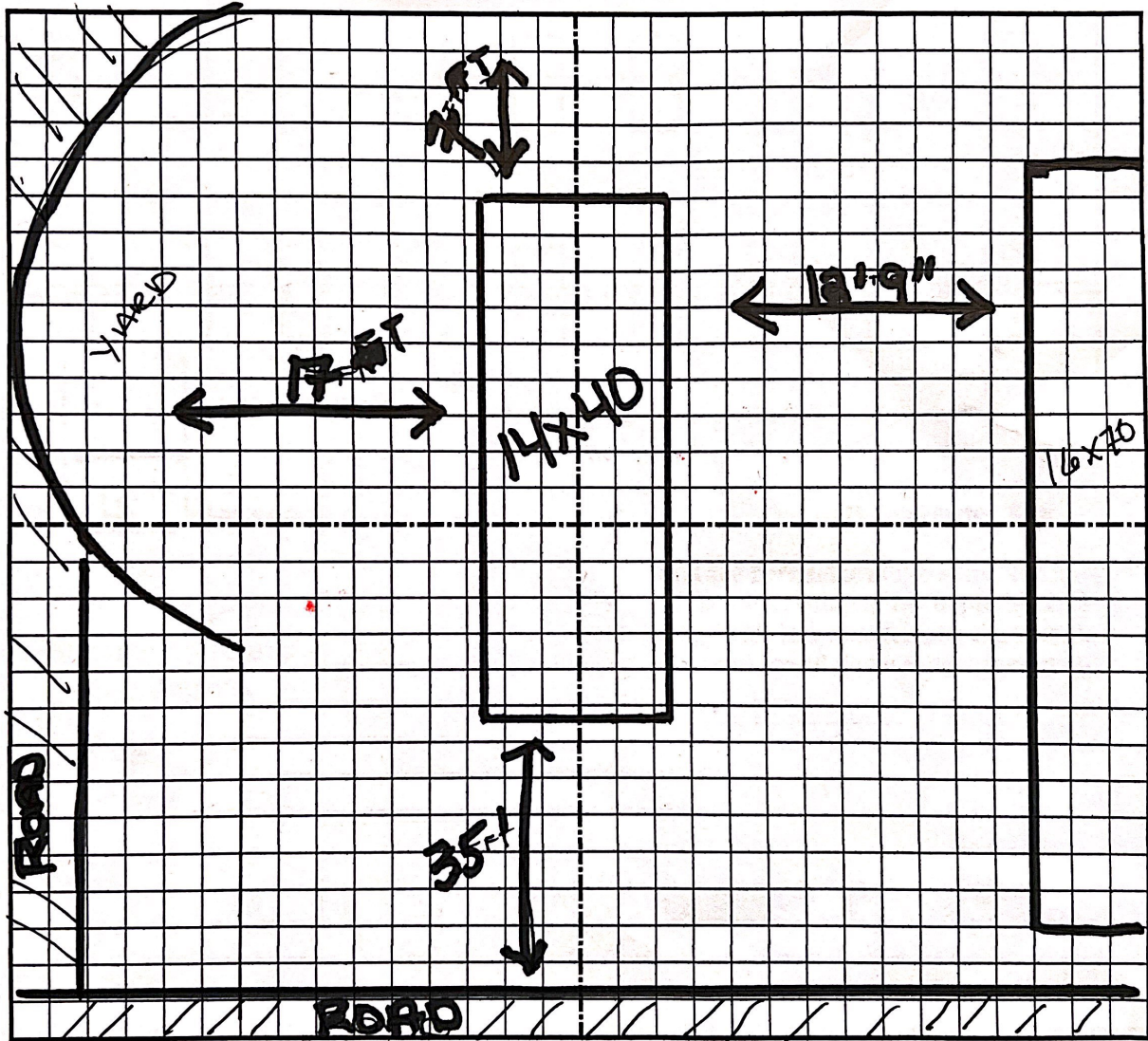

Each Square equals 5' x 5'

RESIDENTIAL



2017 PPRBC

Address: 2840 S CIRCLE DR 902, COLORADO SPRINGS

Parcel: 6428300055

Plan Track #: 175561  Received: 28-Apr-2023 (SIERRAC)

Description:

MANUFACTURED HOME - TEMPORARY SET

Contractor: PRINDLE MOBILE HOME SERVICES, LLC

Type of Unit:

Plan-check Fee: \$26.88 (1950048)

Required PPRBD Departments (4)

Enumeration

Released for Permit
05/01/2023 11:38:55 AM
brent
ENUMERATION

Floodplain
Released for Permit
04/28/2023 2:03:57 PM
Pikes Peak
REGIONAL
Building Department
keith
FLOODPLAIN

Construction

Mechanical
Released for Permit
05/09/2023 1:12 AM
Pikes Peak
REGIONAL
Building Department
Justin C
MECHANICAL

Required Outside Departments (1)

County Zoning
APPROVED
Plan Review
05/16/2023 8:19:49 AM
dsdyounger
EPC Planning & Community
Development Department

Release of this plan does not preclude compliance with all applicable codes, ordinances and other pertinent regulations. This plan set must be present on the job site for every inspection.