

EL PASO

COMMISSIONERS
DARRYL GLENN (PRESIDENT)
MARK WALLER (PRESIDENT PRO TEMPORE)



COUNTY

STAN VANDERWERF
LONGINOS GONZALEZ
PEGGY LITTLETON

PLANNING AND COMMUNITY DEVELOPMENT DEPARTMENT
CRAIG DOSSEY, EXECUTIVE DIRECTOR

September 21, 2017

This letter is to inform you of the following petition which has been submitted to El Paso County:

U-17-002

RUIZ

**APPROVAL OF LOCATION
WINDMILL MESA PARK**

A request by Widefield School District No. 3 for an approval of location to allow for the expansion of an existing public park. The site is located on the east side of Bradley Road, south of Marabou Way. (Parcel No. 65121-00-012) (Commissioner District No. 4) (Nina Ruiz)

Type of Hearing: Quasi-Judicial

For

Against

No Opinion

Comments: _____

(FOR ADDITIONAL COMMENTS, PLEASE ATTACH ANOTHER SHEET.)

- **This item is scheduled to be heard by the El Paso County Planning Commission on October 17, 2017.** The meeting begins at 9:00 a.m. and will be conducted in the Second Floor Hearing Room of the Pikes Peak Regional Development Center, 2880 International Circle, Colorado Springs.
- The date and order when this item will be considered can be obtained by calling the Planning and Community Development Department or through El Paso County's Web site (www.elpasoco.com). Actions taken by the El Paso County Board of County Commissioners are posted on the internet following the meeting.
- The Staff Report for this Agenda item can be found at:
<http://adm.elpasoco.com/Development%20Services/Pages/PlanningCommission2017.aspx>

Your response will be a matter of public record and available to the applicant prior to the hearing. You are welcome to appear in person at the hearing to further express your opinion on this petition. If we can be of any assistance, please call 719-520-6300.

Sincerely,

Nina Ruiz, Project Manager/Planner II

Your Name: _____
(printed) (signature)

Address: _____

Property Location: _____ Phone: _____

2880 INTERNATIONAL CIRCLE, SUITE 110
PHONE: (719) 520-6300



COLORADO SPRINGS, CO 80910-3127
FAX: (719) 520-6695

www.ELPASOCO.com

COPY
9/21/17

El Paso County Parcel Information

File Name: U-17-002

PARCEL	NAME
6512100012	WIDEFIELD SCHOOL DISTRICT NO 3

Zone Map No.: --

ADDRESS	CITY	STATE
1820 MAIN ST	COLORADO SPRINGS	CO

ZIP	ZIPPLUS
80911	1152

Date: September 21, 2017

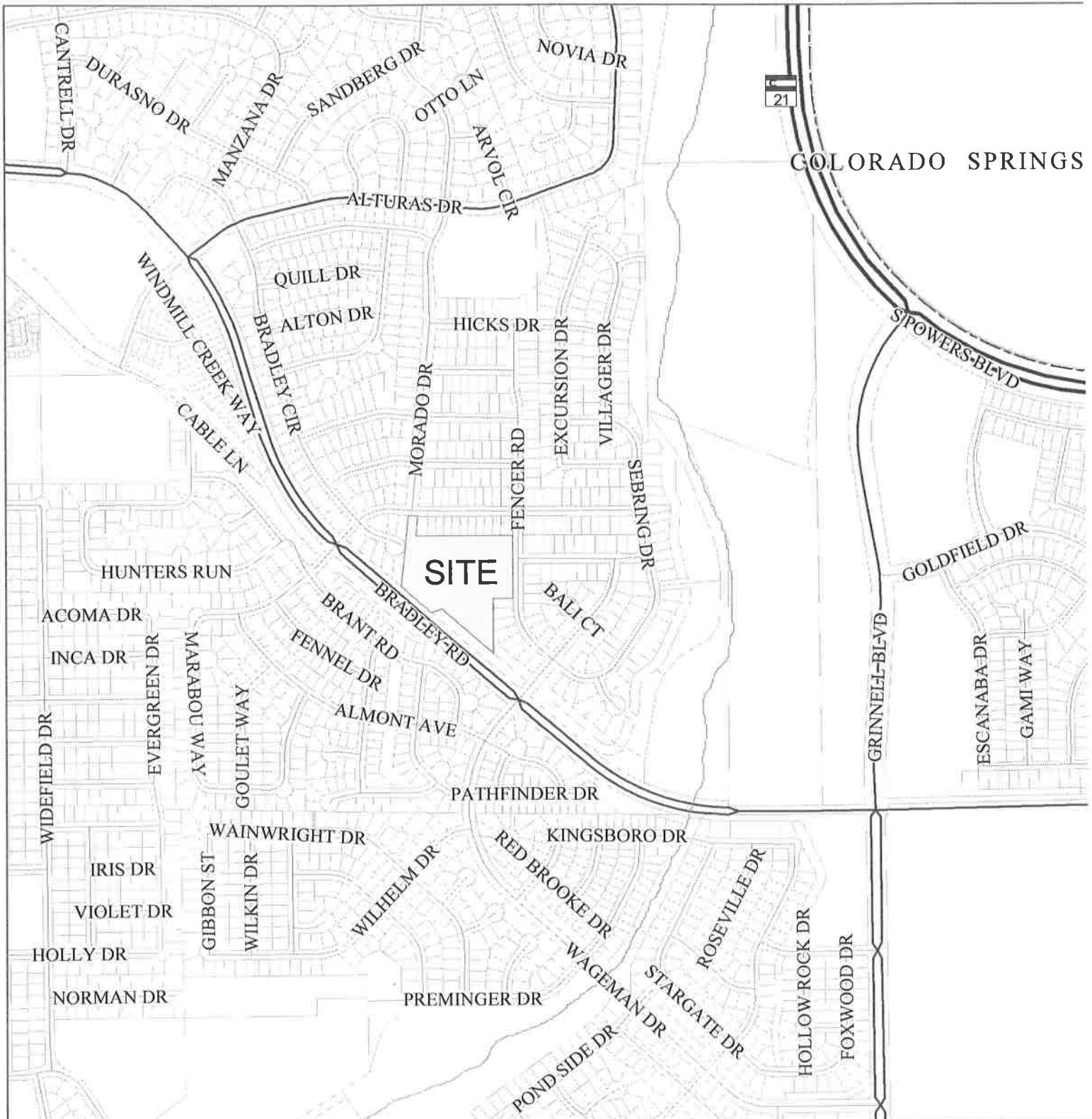

Please report any parcel discrepancies to:
El Paso County Assessor
1675 W. Garden of the Gods Rd.
Colorado Springs, CO 80907
(719) 520-6600



COPYRIGHT 2017 by the Board of County Commissioners, El Paso County, Colorado. All rights reserved. No part of this document or data contained herein may be reproduced, used to prepare derivative products, or distributed without the specific written approval of the Board of County Commissioners, El Paso County, Colorado. This document was prepared from the best data available at the time of printing. El Paso County, Colorado, makes no claim as to the completeness or accuracy of the data contained herein.

U-17-002

6512221009
ANGELINE ALEXANDER
4771 BRANT RD
COLORADO SPRINGS, CO 80911

6512109017
BERRY JONATHAN J
5442 MARABOU WAY
COLORADO SPRINGS, CO 80911

6512110011
BOAHEN ISAAC
5413 MARABOU WAY
COLORADO SPRINGS, CO 80911

6512124008
BROWN ADAM VINCENT
4696 FENCER RD
COLORADO SPRINGS, CO 80911

6512219001
CAMPOS MONICA K
5405 BRADLEY CIR
COLORADO SPRINGS, CO 80911

6512110005
CANALES ALEX CRUZ
5497 MARABOU WAY
COLORADO SPRINGS, CO 80911

6512124003
CARROLL ERIN K
4656 FENCER RD
COLORADO SPRINGS, CO 80911

6512124006
CIMINO SAMMY L
4680 FENDER RD
COLORADO SPRINGS, CO 80911

6512111007
CLARK DAVID J II
4923 BRANT RD
COLORADO SPRINGS, CO 80911

6512125001
CLARK KURTISS C
4623 FENCER RD
COLORADO SPRINGS, CO 80911

6512220002
COLE JUSTIN D
5412 BRADLEY CIR
COLORADO SPRINGS, CO 80911

6512111009
CONLEY DAVID L
4939 BRANT RD
COLORADO SPRINGS, CO 80911

6512110007
CSH 2016-1 BORROWER LLC
8665 E HARTFORD DR STE 200
SCOTTSDALE, AZ 85255

6512104001
DALBEC MIKKI I
3730 E BLANEY RD
PEYTON, CO 80831

6512110001
DAVIS MARK A &
5553 MARABOU WAY
COLORADO SPRINGS, CO 80911

6512109011
DELP LIVING TRUST
5526 MARABOU WAY
COLORADO SPRINGS, CO 80911

6512104002
DUNCAN MARK C
5417 BRADLEY CIR
COLORADO SPRINGS, CO 80911

6512110004
FOSTER JUSTIN SCOTT
5511 MARABOU WAY
COLORADO SPRINGS, CO 80911

6512100009
FOUNTAIN MUTUAL IRRIGATION CO
PO BOX 75292
COLORADO SPRINGS, CO 80970

6512200010
FOUNTAIN MUTUAL METROPOLITAN
DIST
PO BOX 1976
COLORADO SPRINGS, CO 80901

6512111001
FOUNTAIN VALLEY RANCH FILING NO 9
PO BOX 5386
COLORADO SPRINGS, CO 80931

6512124002
GOODELL VICTORIA A
4648 FENCER RD
COLORADO SPRINGS, CO 80911

6512109015
GOROZTIETA KEVIN
5470 MARABOU WAY
COLORADO SPRINGS, CO 80911

6512123002
GUILBAULT LISA M
5615 MARABOU WAY
COLORADO SPRINGS, CO 80911

6512111006
HAMLETT JAMES
4915 BRANT RD
COLORADO SPRINGS, CO 80911

6512221010
HAZEN SHAWN P
4779 BRANT RD
COLORADO SPRINGS, CO 80911

6512109010
HERNANDO ARTURO P JR &
5540 MARABOU WAY
COLORADO SPRINGS, CO 80911

6512111008
HONSVICK GILBERT C
4931 BRANT RD
COLORADO SPRINGS, CO 80911

6512110006
IVERSON GREGORY L
5483 MARABOU WAY
COLORADO SPRINGS, CO 80911

6512111003
JENKINS JASON H
4827 BRANT RD
COLORADO SPRINGS, CO 80911

6512111005
JONES KELLI
CMR 445 BOX 151
APO, AE 09046

6512123001
KNOEFLER JACOB N
8089 HOLLYGRAPE LN
COLORADO SPRINGS, CO 80927

6512125024
KURTH CANDACE A
4639 FENCER RD
COLORADO SPRINGS, CO 80911

6512125025
LOVE JANATHA Y
3578-E HARTSEL DR #238
COLORADO SPRINGS, CO 80920

6512110003
MACRI CHANDRA AKILAH
5525 MARABOU WAY
COLORADO SPRINGS, CO 80911

6512124007
MATHEWS CYNTHIA S
4688 FENCER RD
COLORADO SPRINGS, CO 80911

6512123021
MCCRAY TERRENCE M
5618 FANTASIA DR
COLORADO SPRINGS, CO 80911

6512109014
MCCULLOUGH SHAYNE
5484 MARABOU WAY
COLORADO SPRINGS, CO 80911

6512123022
MCKILLIPS KOLETTE R
5610 FANTASIA DR
COLORADO SPRINGS, CO 80911

6512109012
MEAD MEREDITH
5512 MARABOU WAY
COLORADO SPRINGS, CO 80911

6512109013
MORRISON EARLIE III
5498 MARABOU WAY
COLORADO SPRINGS, CO 80911

6512125022
NARDO FAY RACHELLE
PO BOX 31395
COLORADO SPRINGS, CO 80931

6512221012
ONEILL GEORGE F
265 ALL SKY DR
COLORADO SPRINGS, CO 80921

6512111011
OPIE GREGORY R
24059 HIGH MEADOW DR
GOLDEN, CO 80401

6512104004
OTT KENNETH E &
187 PARKER RD
BOYCE, LA 71409

6512109018
PARDALIS JAN M
5428 MARABOU WAY
COLORADO SPRINGS, CO 80911

6512110010
PAUL CYNTHIA G &
5427 MARABOU WAY
COLORADO SPRINGS, CO 80911

6512220001
RAY WILLIAM B &
5406 BRADLEY CIR
COLORADO SPRINGS, CO 80911

6512124004
SECURITY WATER DISTRICT
231 SECURITY BLVD
COLORADO SPRINGS, CO 80911

6512221011
SEGARRA EDUARDO F
4787 BRANT RD
COLORADO SPRINGS, CO 80911

6512110002
SONNENBERG KEITH D
5539 MARABOU WAY
COLORADO SPRINGS, CO 80911

6512104003
SPRINGER CLAUDE LEROY
5424 BRADLEY CIR
COLORADO SPRINGS, CO 80911

6512110009
STARKE AMANDA
5441 MARABOU WAY
COLORADO SPRINGS, CO 80911

6512110008
SUNIGA ALFRED IV
5455 MARABOU WAY
COLORADO SPRINGS, CO 80911

6512125023
TANNER CHRISTOPHER A
4647 FENCER RD
COLORADO SPRINGS, CO 80911

6512109016
TAYLOR HENRY B
5456 MARABOU WAY
COLORADO SPRINGS, CO 80911

6512124001
TAYLOR JOEL D
4640 FENCER RD
COLORADO SPRINGS, CO 80911

6512109019
VAN HOUSE PAUL R
5414 MARABOU WAY
COLORADO SPRINGS, CO 80911

6512103004
WARD BRYAN
5396 MARABOU WAY
COLORADO SPRINGS, CO 80911

6512111012
WASIK GLENN E
4963 BRANT RD
COLORADO SPRINGS, CO 80911

6512124005
WATTS CHERYL L
4672 FENCER RD
COLORADO SPRINGS, CO 80911

6512111002
WELCH DANIEL P
4819 BRANT RD
COLORADO SPRINGS, CO 80911

6512100012
WIDEFIELD SCHOOL DISTRICT NO 3
1820 MAIN ST
COLORADO SPRINGS, CO 80911

6512111004
WUNDER LISENKA
4835 BRANT RD
COLORADO SPRINGS, CO 80911

6512111010
WYNNE BRIAN K
4947 BRANT RD
COLORADO SPRINGS, CO 80911