

# APPROVED

Plan Review

07/31/2020 11:46:52 AM

dsdespinoza

EPC Planning & Community  
Development Department

Not Required  
BESQCP

07/31/2020 11:47:32 AM

dsdespinoza

EPC Planning & Community  
Development Department

R130275  
ADD20435  
PLAT 13698  
ZONE PUD  
DIST 4



ANY APPROVAL GIVEN BY  
EL PASO COUNTY  
DOES NOT OVIATE THE NEED  
TO COMPLY WITH APPLICABLE  
FEDERAL, STATE, OR LOCAL  
LAWS AND/OR REGULATION

Planning & Community Development Department  
approval is contingent upon compliance with all  
applicable notes on the recorded plat.  
An access permit must be granted by the  
Planning & Community Development Department  
prior to the establishment of any driveway onto a  
County road.  
Division of blockage of any drainage way  
is not permitted without approval of the  
Planning & Community Development Department



It is the owner's responsibility to  
coordinate with easement holders  
to avoid impact to utilities that  
may be located in the easements.

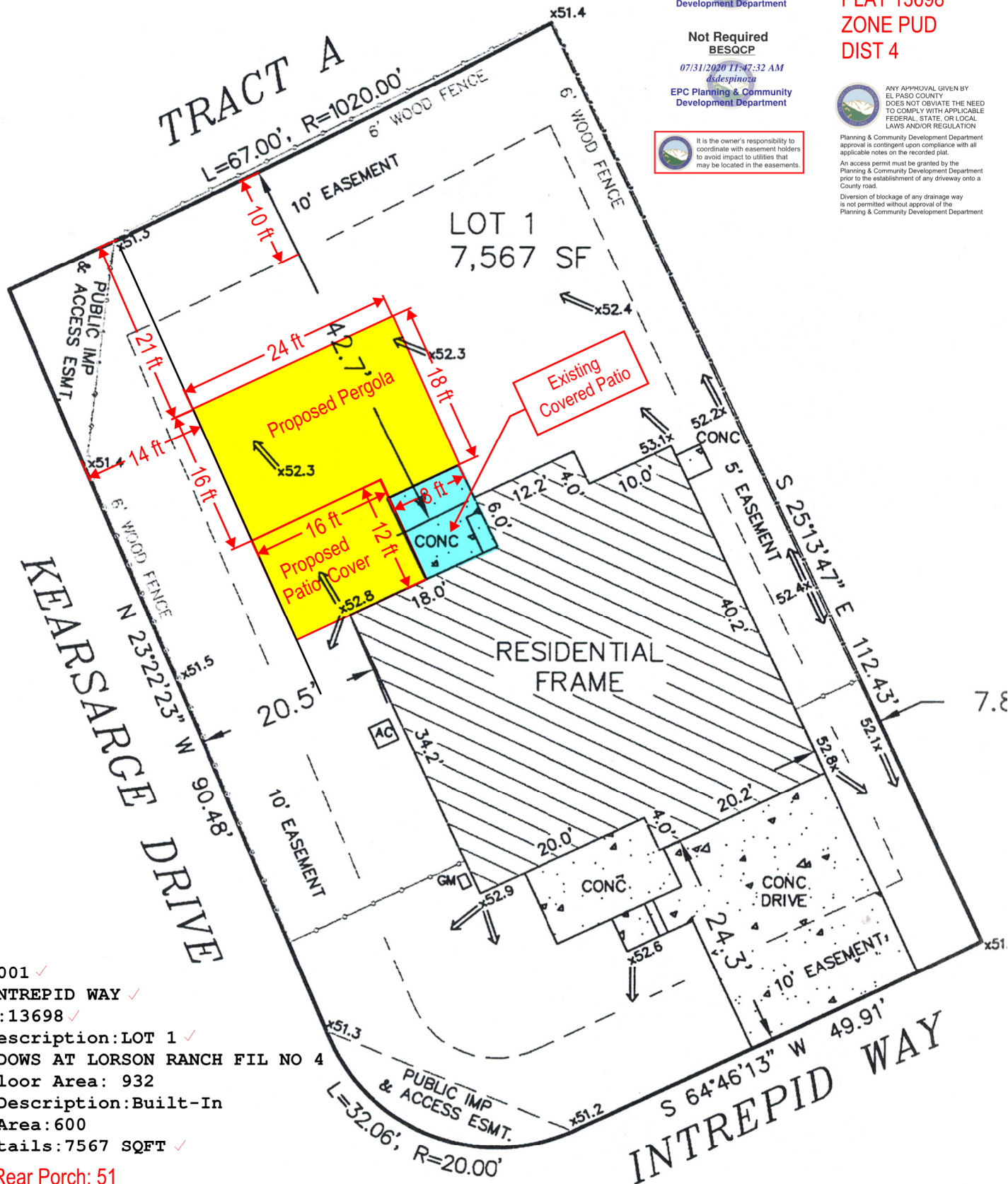

5523202001 ✓  
10002 INTREPID WAY ✓  
Plat No:13698 ✓  
Legal Description: LOT 1 ✓  
THE MEADOWS AT LORSON RANCH FIL NO 4  
First Floor Area: 932  
Garage Description: Built-In  
Garage Area: 600  
Land Details: 7567 SQFT ✓

Covered Rear Porch: 51  
Covered Front Porch: 123.3  
Proposed Patio Cover: 192  
Proposed Pergola: 400  
Total Footprint: 2,298.3  
Structural Lot Coverage: 30.37%

DATE: 5/16/17

House

10. Examen

41



# RESIDENTIAL



2017 PPRBC

**Address: 10002 INTREPID WAY, COLORADO SPRINGS**

**Plan Track #: 130275**

**Received: 24-Jun-2020 (NICKH)**

**Parcel: 5523202001**

**Map #: 957G**

## Description:

### PATIO COVER

Contractor: HOMEOWNER

Type of Unit:

## Required PPRBD Departments (2)

### Floodplain

(N/A) RBD GIS

### Construction Released for Permit

**07/01/2020 7:05:56 AM**



## Required Outside Departments (1)

### County Zoning

### APPROVED Plan Review

*07/31/2020 11:51:43 AM  
dsdespinoza*

EPC Planning & Community  
Development Department

Release of this plan does not preclude compliance with all applicable codes, ordinances and other pertinent regulations. This plan set must be present on the job site for every inspection.