

CLAREMONT RANCH FILING NO. 9C  
LOT 2B, BLOCK 1  
A PORTION OF SECTION 4, TOWNSHIP 14 SOUTH, RANGE 65 WEST  
OF THE 6TH P.M., EL PASO COUNTY, COLORADO  
SITE DEVELOPMENT PLAN

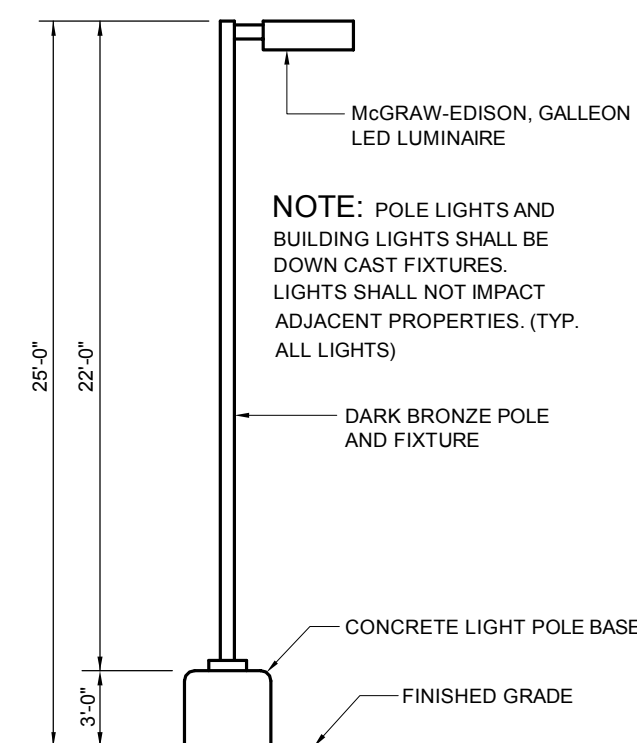
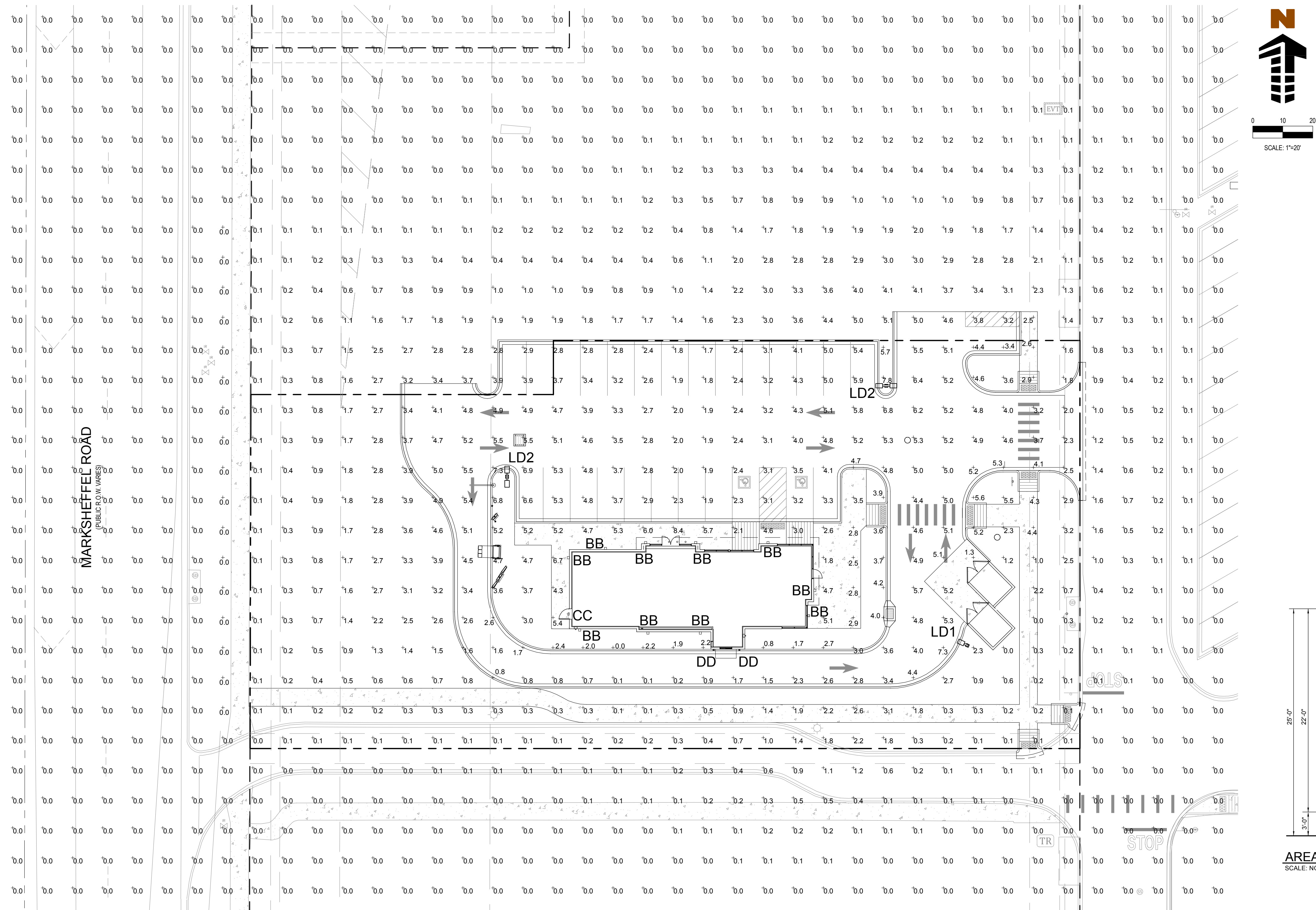

AREA LIGHT DETAIL  
SCALE: NOT TO SCALE

NOTES:

THE STUDY IS BASED ON REQUESTED ILLUMINATION LEVELS, LUMINAIRE LOCATIONS, OR ADDITIONAL CRITERIA BY THE AUTHORITIES HAVING JURISDICTION.

THE CALCULATED PHOTOMETRIC LEVELS MAY OR MAY NOT MEET CERTAIN STANDARDS OR RECOMMENDED PRACTICES OF IESNA.

THE PHOTOMETRIC PLAN REPRESENTS ILLUMINATION LEVELS CALCULATED FROM LABORATORY DATA TAKEN UNDER CONTROLLED CONDITIONS UTILIZING CURRENT INDUSTRY STANDARD LAMP RATINGS IN ACCORDANCE WITH ILLUMINATING ENGINEERING SOCIETY (IES) APPROVED METHODS. LABORATORY TESTS ARE MADE UNDER OPTIMUM CONDITION, WITH LAMP OUTPUT AT RATED VALUE, AND IN ACCORDANCE WITH ILLUMINATING ENGINEERING SOCIETY APPROVED METHODS.

ACTUAL ILLUMINANCE LEVELS MAY DIFFER DUE TO VARIABLE FIELD CONDITIONS SUCH AS (BUT NOT LIMITED TO): VARIANCE IN LAMP LUMEN OUTPUT; LAMP TILT FACTOR; BALLAST WATTAGE OUTPUT; LINE VOLTAGE AT BALLAST; REFLECTOR SPECULARITY; LAMP LUMEN DEPRECIATION; AND LUMINAIRE DIRT DEPRECIATION.

THE 27'-6" MOUNTING HEIGHT IS THE ACTUAL ASSEMBLY (POLE, BASE, AND FIXTURE) AND MAY DIFFER FROM THE FROM THE LUMINAIRE'S LUMINOUS APERTURE.

COPYRIGHT

THESE PLANS ARE AN INSTRUMENT OF SERVICE AND ARE THE PROPERTY OF GALLOWAY, AND MAY NOT BE DUPLICATED, DISCLOSED, OR REPRODUCED WITHOUT THE WRITTEN CONSENT OF GALLOWAY. COPYRIGHTS AND INFRINGEMENTS WILL BE ENFORCED AND PROSECUTED.

CLAREMONT RANCH  
FILING NO. 9C  
LOT 2B, BLOCK 1

CONSTITUTION AND MARKSHEFFEL  
EL PASO COUNTY, COLORADO

#	Date	Issue / Description	Int.
—	—	—	—
—	—	—	—
—	—	—	—
—	—	—	—
—	—	—	—
—	—	—	—
—	—	—	—
—	—	—	—
—	—	—	—
—	—	—	—
—	—	—	—

Project No:	EDI000040
Drawn By:	JMG
Checked By:	BR
Date:	11/17/17

PHOTOMETRIC DETAILS

C3.0



