



September 15, 2021

EPC - Planning
2880 International Circle
Colorado Springs, CO 80910

SUBJECT: Administrative Determination Request Letter
Mountain View Electric Association, Inc. (MVEA)
EPC County File No. TBD

Dear EPC Planning:

Mountain View Electric Association, Inc (MVEA) will be constructing a 12.5 kV underground electrical distribution feeder line running along the east side of Vollmer Road. The underground installation will be approximately 2 miles in length and will begin at the Meridian Electric Substation near the intersection of Eastonville Road and Latigo Boulevard. The installation will run south parallel to Eastonville Road offset a distance of approximately 55' from the road. The line terminates south of the proposed Rex Road extension in the undeveloped land north of Falcon High School.

The utility line is located in sections 16, 21, 28, and 29, 12S, 64W of the 6th P.M., El Paso County, Colorado. Site maps are attached.

MVEA is requesting an exemption for these projects per section 5.104 (4) of the EPC Land Development Code. 1041 Regulations are not applicable to this project due to the utility installation being a 12.5kv lower-voltage distribution line, not 115 kV or more. This is not construction of a transmission line, nor construction of a major facility of a public utility.

Sincerely,

Amy Carlsen
Right of Way Specialist

This Association is an equal opportunity provider and employer.

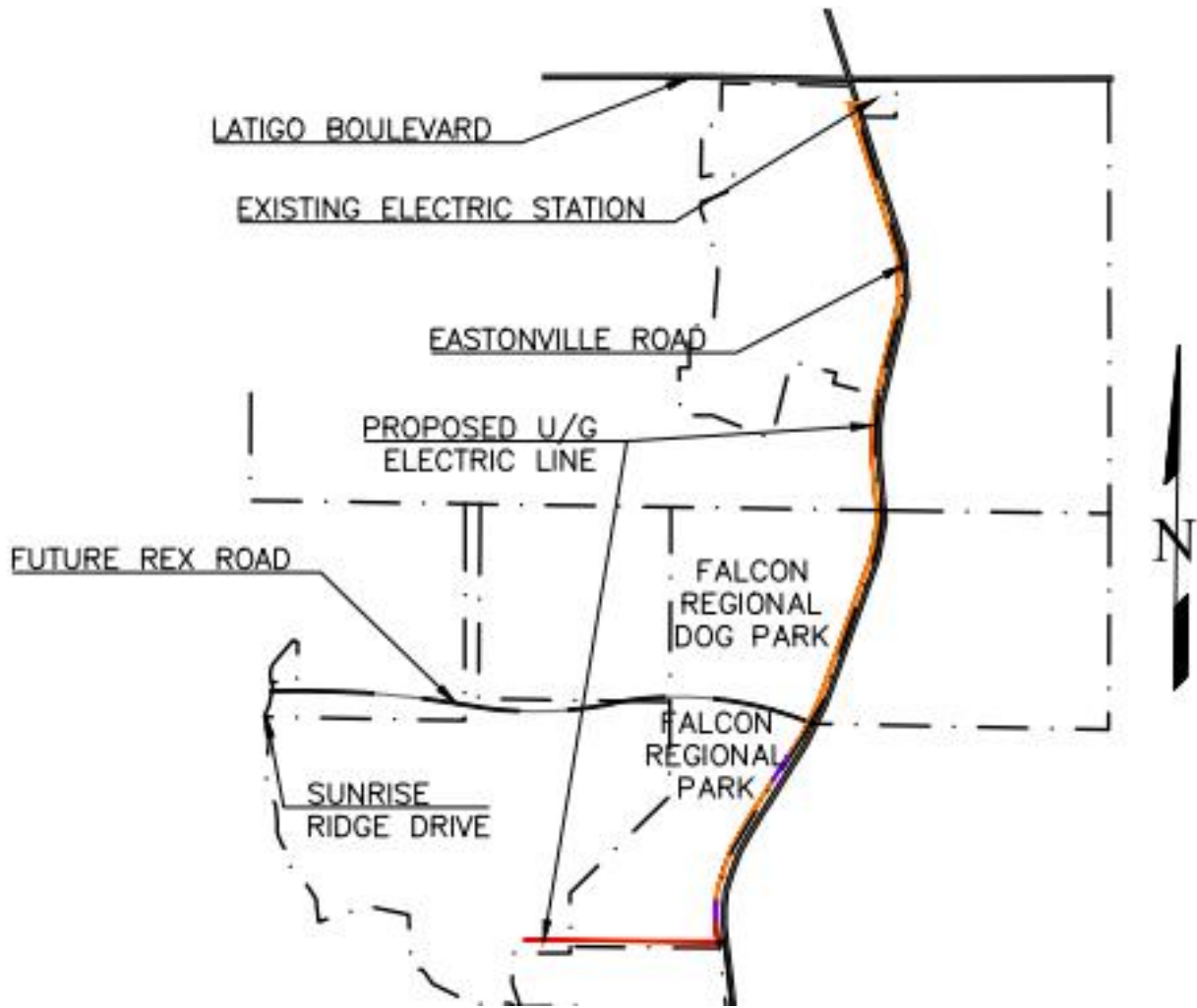

MVEA Eastonville II - Vicinity Map

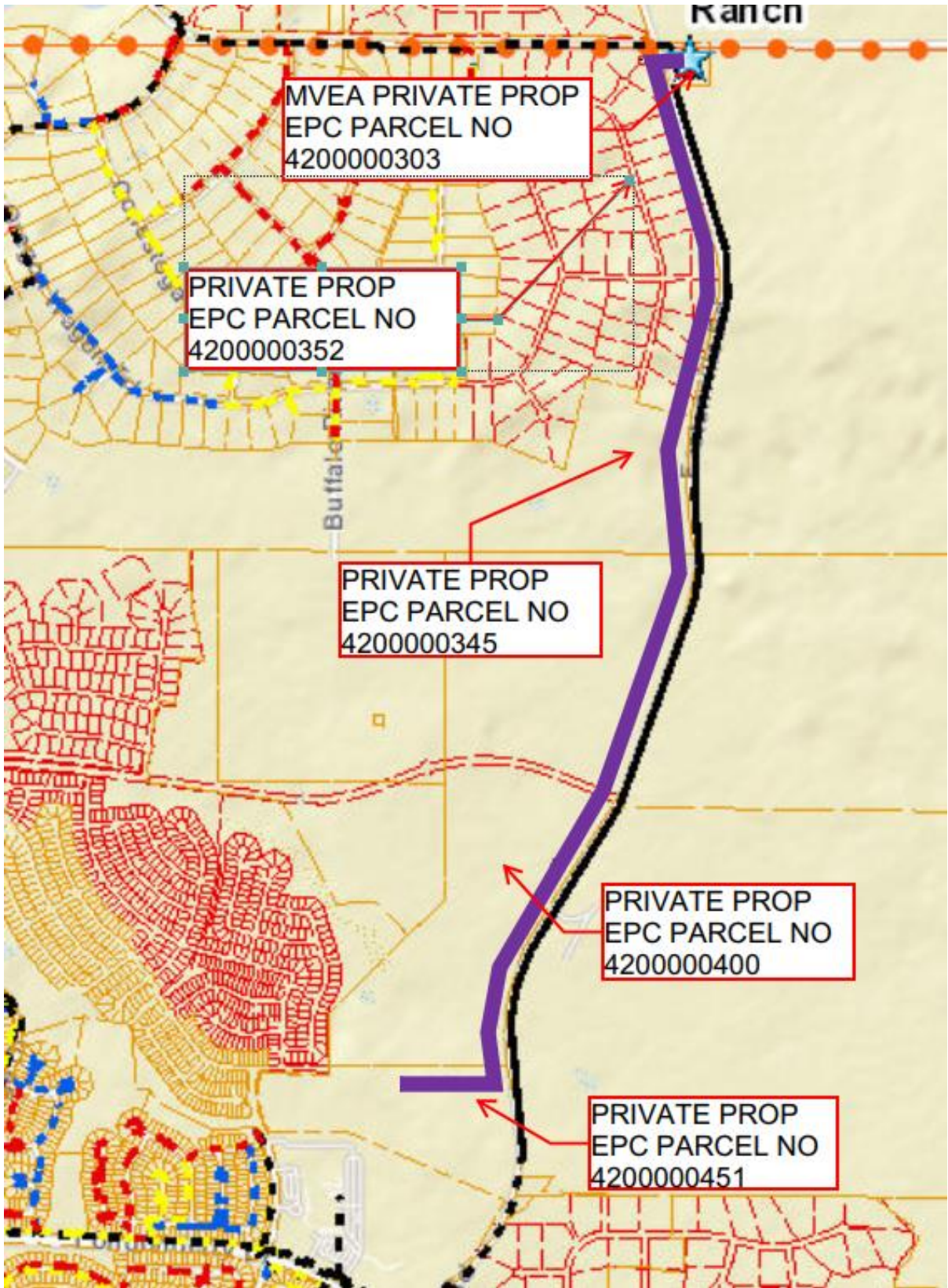

MVEA Eastonville II - MVEA System Map New (12.5 kv) Distribution Line (shown in purple)