

CONSTRUCTION PLANS  
FOR  
**THE HILLS AT LORSON RANCH FILING NO. 1**  
STORM SEWER CONSTRUCTION PLANS



Know what's below.  
Call before you dig.

CALL 2-BUSINESS DAYS IN ADVANCE  
BEFORE YOU DIG, GRADE OR  
EXCAVATE FOR THE MARKING OF  
UNDERGROUND MEMBER UTILITIES

**STREET CONSTRUCTION FOR INFORMATION ONLY!!!!**

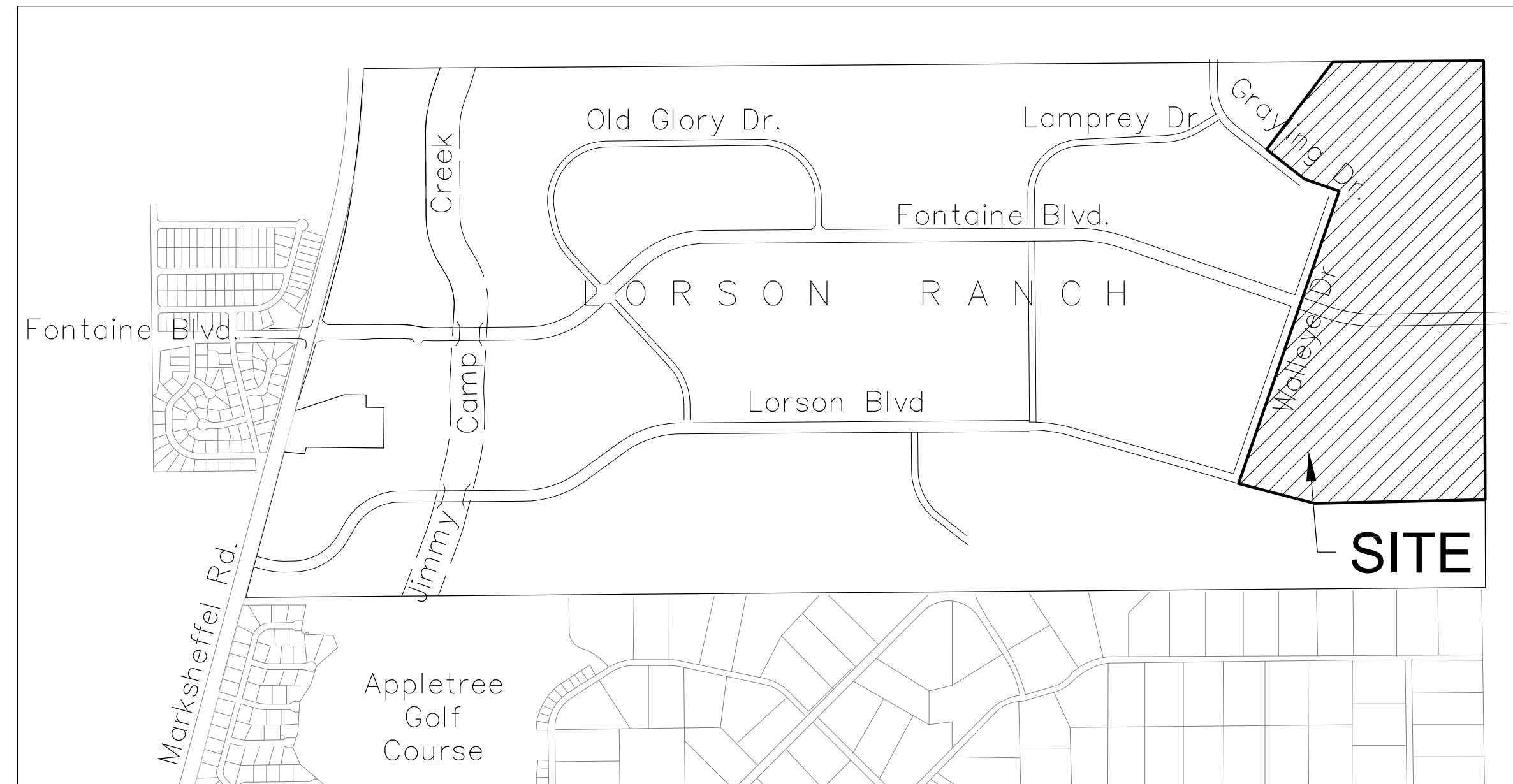

VICINITY MAP  
NO SCALE

PREPARED FOR:  
**LORSON, LLC**  
N. WAHSATCH AVE., SUITE 301  
COLORADO SPRINGS, CO 80903  
719-635-3200  
CONTACT: JEFF MARK

PREPARED BY:  
**CORE ENGINEERING GROUP**  
15004 1ST AVENUE S.  
BURNSVILLE, MN 55306  
719-570-1100  
CONTACT: RICHARD L. SCHINDLER P.E.

SHEET INDEX	
SHEET NO.	SHEET DESCRIPTION
C1.1	COVER SHEET
C1.2	NOTES
C1.3	TYPICAL SECTIONS
C2.1-C2.4	STREET HORIZONTAL CONTROL
C6.1-C6.30	STREET - STORM PLAN AND PROFILES - SOUTH HALF
C6.31-C6.55	STREET - STORM PLAN AND PROFILES - NORTH HALF
C6.56-C6.58	STREET - STORM PLAN AND PROFILES - FONTAINE BLVD.
C7.1-C7.2	PLAN AND PROFILE - STORM LATERALS
C10.1-C10.3	DETAILS

**DEVELOPER'S STATEMENT**

THE UNDERSIGNED OWNER/DEVELOPER HAS READ AND WILL COMPLY WITH ALL THE REQUIREMENTS SPECIFIED IN THESE CONSTRUCTION PLANS AND THE ACCOMPANYING DRAINAGE REPORT.

**BUSINESS NAME**

BY JEFF MARK DATE JAN 18, 2021

**TITLE**

MANAGER

ADDRESS 212 N. WAHSATCH AVE. SUITE 301  
COLORADO SPRINGS, CO 80903

Label the sheets not containing storm drains as "for information only"

**LEGEND**

- SUBDIVISION BOUNDARY
- EXISTING AND PROPOSED RIGHT OF WAY
- EXISTING AND PROPOSED LOT LINES
- EXISTING AND PROPOSED EASEMENTS
- STREET CENTERLINE
- PROPOSED CURB AND GUTTER
- EX-W --- EXISTING WATERMAIN
- W-O --- PROPOSED WATERMAIN
- SS-8 --- EXISTING SANITARY SEWER
- SS-8 --- PROPOSED SANITARY SEWER
- SS-24 --- EXISTING 24" SANITARY SEWER
- G --- EXISTING GASMAIN
- E --- EXISTING UNDERGROUND ELECTRIC
- OHE --- EXISTING OVERHEAD ELECTRIC
- TV --- EXISTING CABLE TV
- T --- EXISTING PHONE OR FIBER OPTIC
- EXISTING STORM DRAIN
- PROPOSED STORM SEWER
- --- EXISTING MANHOLES
- --- PROPOSED SANITARY AND STORM MANHOLES
- ⊗ --- EXISTING AND PROPOSED WATERMAIN VALVES
- ⊗ --- EXISTING AND PROPOSED FIRE HYDRANT
- EXISTING UTILITY POLE
- PROPOSED STORM SEWER INLET

**CONSTRUCTION APPROVAL**

COUNTY PLAN REVIEW IS PROVIDED ONLY FOR GENERAL CONFORMANCE WITH COUNTY DESIGN CRITERIA. THE COUNTY IS NOT RESPONSIBLE FOR THE ACCURACY AND ADEQUACY OF THE DESIGN, DIMENSIONS, AND/OR ELEVATIONS WHICH SHALL BE CONFIRMED AT THE JOB SITE. THE COUNTY THROUGH THE APPROVAL OF THIS DOCUMENT ASSUMES NO RESPONSIBILITY FOR COMPLETENESS AND/OR ACCURACY OF THIS DOCUMENT.

FILED IN ACCORDANCE WITH THE REQUIREMENTS OF THE EL PASO COUNTY LAND DEVELOPMENT CODE, DRAINAGE CRITERIA MANUALS VOLUME 1 AND 2, AND ENGINEERING CRITERIA MANUAL AS AMENDED. IN ACCORDANCE WITH ECM SECTION 1.12, THESE CONSTRUCTION DOCUMENTS WILL BE VALID FOR CONSTRUCTION FOR A PERIOD OF 2 YEARS FROM THE DATE SIGNED BY THE EL PASO COUNTY ENGINEER. IF CONSTRUCTION HAS NOT STARTED WITHIN THOSE TWO YEARS THE PLANS WILL NEED TO BE RESUBMITTED FOR APPROVAL, INCLUDING PAYMENT OF REVIEW FEES AT THE PLANNING AND COMMUNITY DEVELOPMENT DIRECTOR'S DISCRETION.

JENNIFER IRVINE, COUNTY ENGINEER/ECM ADMINISTRATOR DATE  
CONDITIONS: FOR STORM SEWER CONSTRUCTION ONLY

**ENGINEER'S APPROVAL**

THESE DETAILED PLANS AND SPECIFICATIONS WERE PREPARED UNDER MY DIRECTION AND SUPERVISION. SAID PLANS AND SPECIFICATIONS HAVE BEEN PREPARED ACCORDING TO THE CRITERIA ESTABLISHED BY THE COUNTY FOR DETAILED ROADWAY, DRAINAGE, GRADING AND EROSION CONTROL PLANS AND SPECIFICATIONS, AND SAID PLANS AND SPECIFICATIONS ARE IN CONFORMITY WITH APPLICABLE MASTER DRAINAGE PLANS AND MASTER TRANSPORTATION PLANS. SAID PLANS AND SPECIFICATIONS MEET THE PURPOSES FOR WHICH THE PARTICULAR ROADWAY AND DRAINAGE FACILITIES ARE DESIGNED AND ARE CORRECT TO THE BEST OF MY KNOWLEDGE AND BELIEF. I ACCEPT RESPONSIBILITY FOR ANY LIABILITY CAUSED BY ANY NEGLIGENT ACTS, ERRORS OR OMISSIONS ON MY PART IN PREPARATION OF THESE DETAILED PLANS AND SPECIFICATIONS.

RICHARD L. SCHINDLER, P.E. # 33997  
FOR AND ON BEHALF OF CORE ENGINEERING GROUP

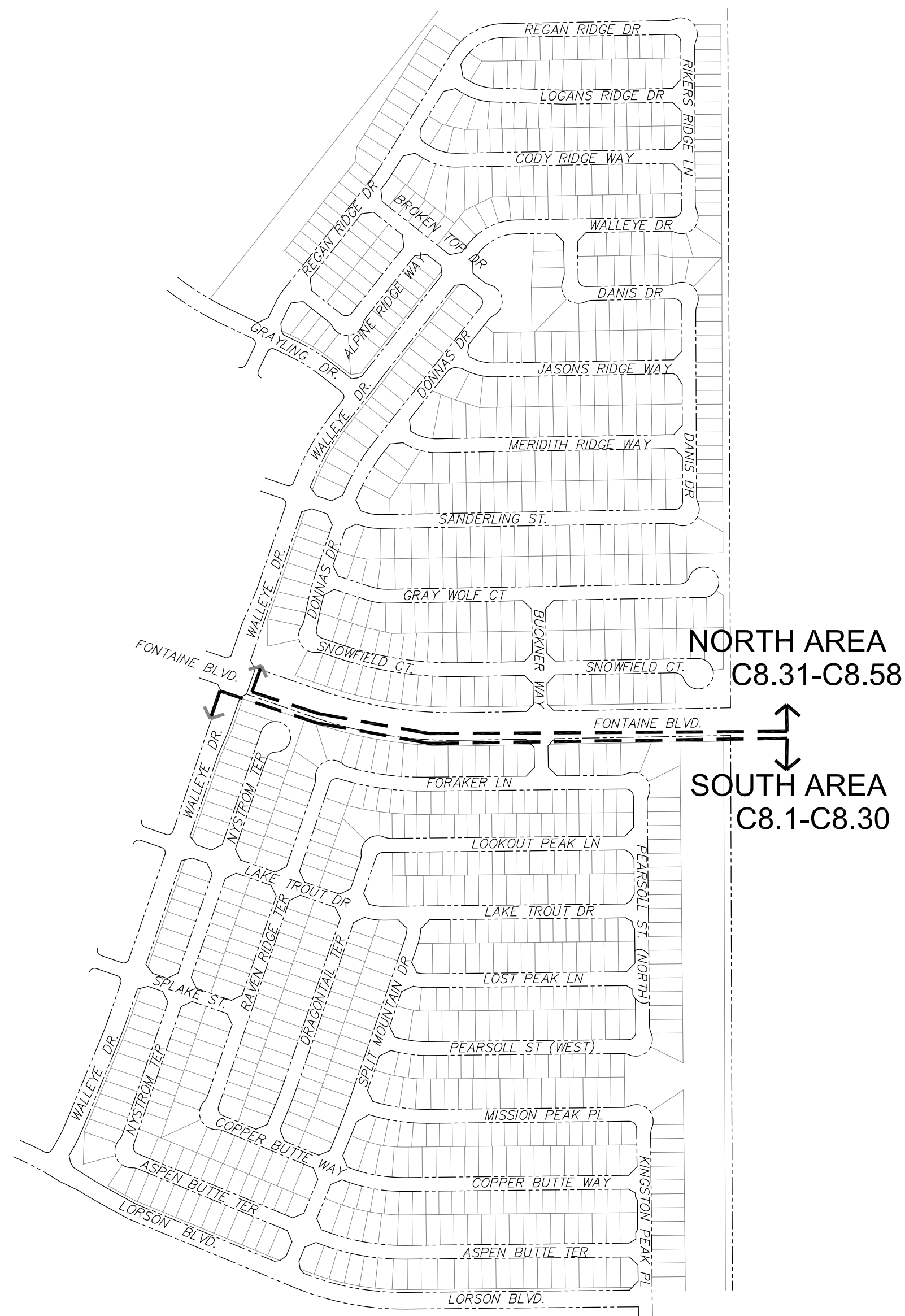

KEY MAP  
NO SCALE

**WATER / SANITARY**  
WIDEFIELD WATER AND SANITATION DISTRICT  
8495 FONTAINE BLVD.  
COLORADO SPRINGS, CO 80925  
719-390-7111

**CABLE**  
COMCAST  
P.O. BOX 173838  
DENVER, CO 80217  
970-641-4774

**ELECTRIC**  
MOUNTAIN VIEW ELECTRIC  
11140 E. WOODMEN RD.  
COLORADO SPRINGS, CO 80831  
719-495-2283

**SECURITY FIRE PROTECTION DISTRICT**  
400 SECURITY BOULEVARD  
SECURITY, CO 80911  
719-392-7121

**TELEPHONE**  
CENTURYLINK  
7925 INDUSTRY ROAD  
COLORADO SPRINGS, CO 80939  
719-278-4651

**GAS**  
BLACK HILLS ENERGY  
7060 ALLEGRE ST.  
FOUNTAIN, CO 80817  
719-393-6639

**EL PASO COUNTY PLANNING AND COMMUNITY DEVELOPMENT**  
2880 INTERNATIONAL CIRCLE  
COLORADO SPRINGS, CO 80910  
719-520-6300

**BASIS OF BEARING**

BEARINGS ARE BASED ON THE SOUTH LINE OF THE NORTH HALF OF SECTION 23, TOWNSHIP 15 SOUTH, RANGE 65 WEST OF THE 6TH PRINCIPAL MERIDIAN AS BEING SOUTH 89°41'52" WEST. THE EAST QUARTER CORNER OF SAID SECTION 23 IS A FOUND 3-1/2" ALUMINUM CAP MONUMENT AND THE WEST QUARTER CORNER OF SAID SECTION 23 IS A FOUND 2-1/2" ALUMINUM CAP MONUMENT

**BENCHMARK**

FIMS MONUMENT F204 LOCATED AT THE NORTHWEST CORNER OF FONTAINE BLVD AND COTTONWOOD GROVE DR. ELEVATION 5724.072 (N.G.V.D. 29)

**TRAFFIC CONTROL NOTE**

THE CONTRACTOR SHALL PROVIDE ALL TRAFFIC CONTROL DEVICES AND MONITORING NECESSARY TO SAFELY COMPLETE THE WORK SHOWN IN THESE CONSTRUCTION DOCUMENTS IN CONFORMANCE WITH M.U.T.C.D. GUIDELINES. THE CONTRACTOR SHALL COMPLETE ALL NECESSARY WORK FOR PLAN REVIEW, PERMITS AND PROCESSING. TRAFFIC CONTROL WILL NOT BE PAID SEPARATELY BUT IS INCLUDED IN THE COST OF THE PROJECT.

PUD/SP 21-006

**CORE ENGINEERING GROUP**  
15004 1ST AVENUE S.  
BURNSVILLE, MN 55306  
PH: 719-570-1100  
CONTACT: RICHARD L. SCHINDLER, P.E.  
EMAIL: Rich@ceng1.com

DATE: \_\_\_\_\_  
DESCRIPTION: \_\_\_\_\_  
NO: \_\_\_\_\_  
PREPARED FOR: **LORSON, LLC**  
212 N. WAHSATCH AVE. SUITE 301  
COLORADO SPRINGS, COLORADO 80903  
CONTACT: JEFF MARK

DRAWN: RLS  
DESIGNED: RLS  
CHECKED: RLS

**THE RIDGE AT LORSON RANCH FIL NO. 1**  
**STORM SEWER CONSTRUCTION PLANS**

DATE: JULY, 2021  
PROJECT NO. 100.064  
SHEET NUMBER C0.1  
TOTAL SHEETS: 70



- NOTES
1. ALL SPOT ELEVATIONS ARE FLOW LINE UNLESS OTHERWISE NOTED.
  2. SEE GRADING PLAN FOR GRADING INFORMATION.
  3. ALL STORM SEWER SHALL BE CLASS III RCP.
  4. ALL MHS SHALL BE TYPE 1 UNLESS OTHERWISE NOTED.

- ① CURVE DATA ID
- ② CURB TRANSITIONS
- ③ PEDESTRIAN RAMP, SEE SHEET C10.1

CURVE TABLE			
CURVE	LENGTH	RADIUS	DELTA
C7	22.02'	48.83	25°50'31"
C8	22.02'	48.83	25°50'31"
C9	123.42'	51.17	138°11'51"
C111	54.10'	35.83	86°30'50"

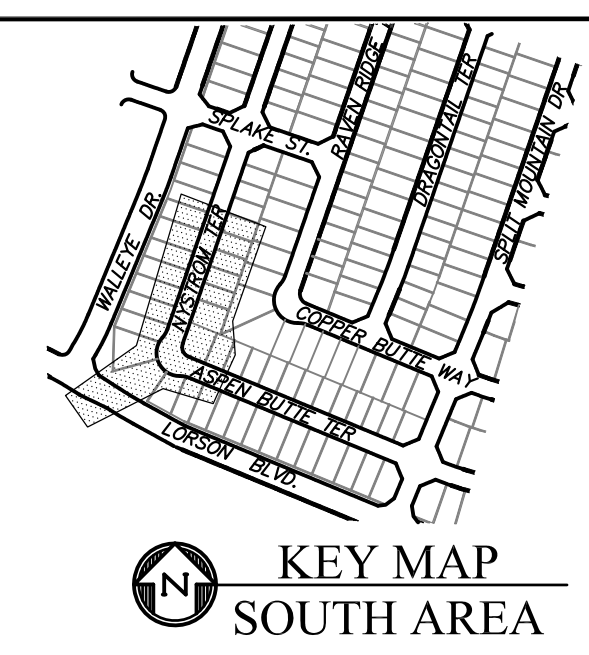
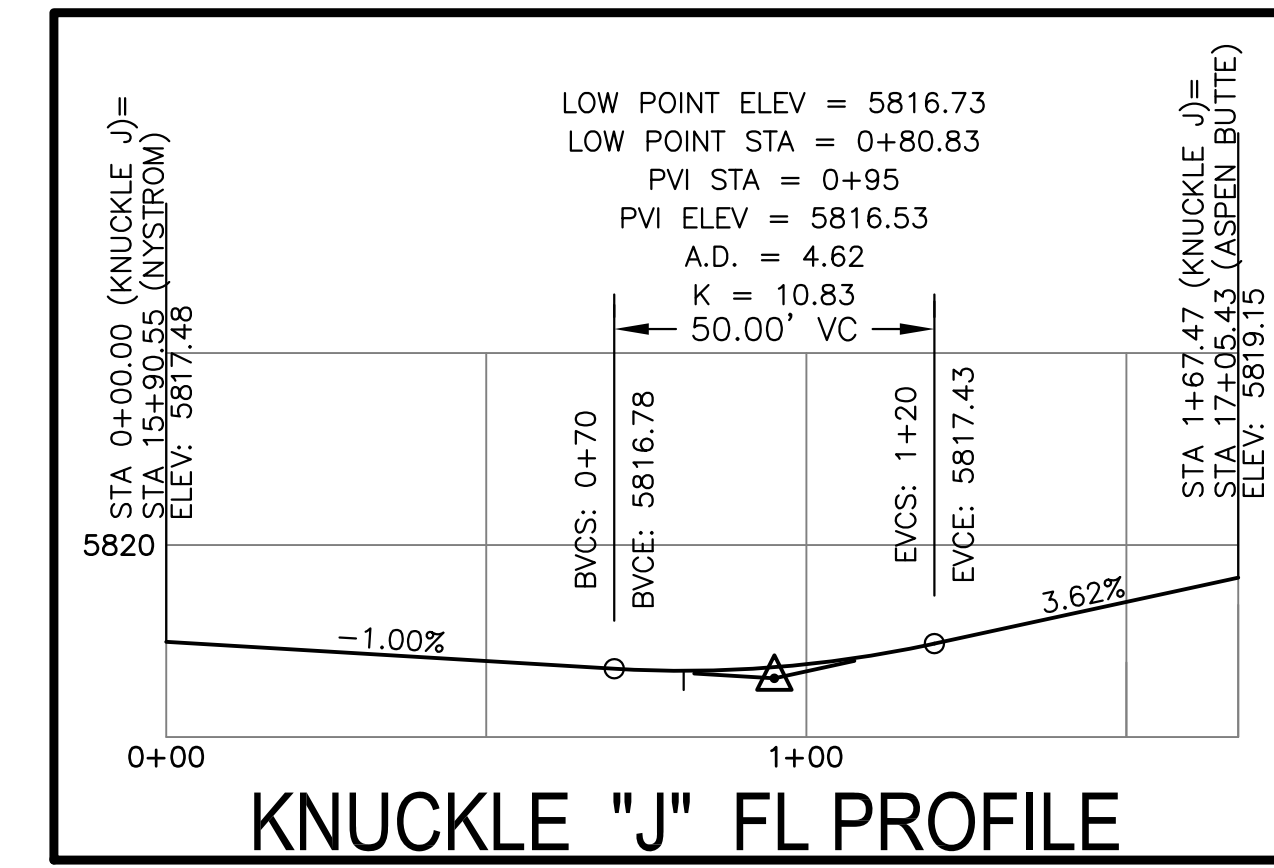
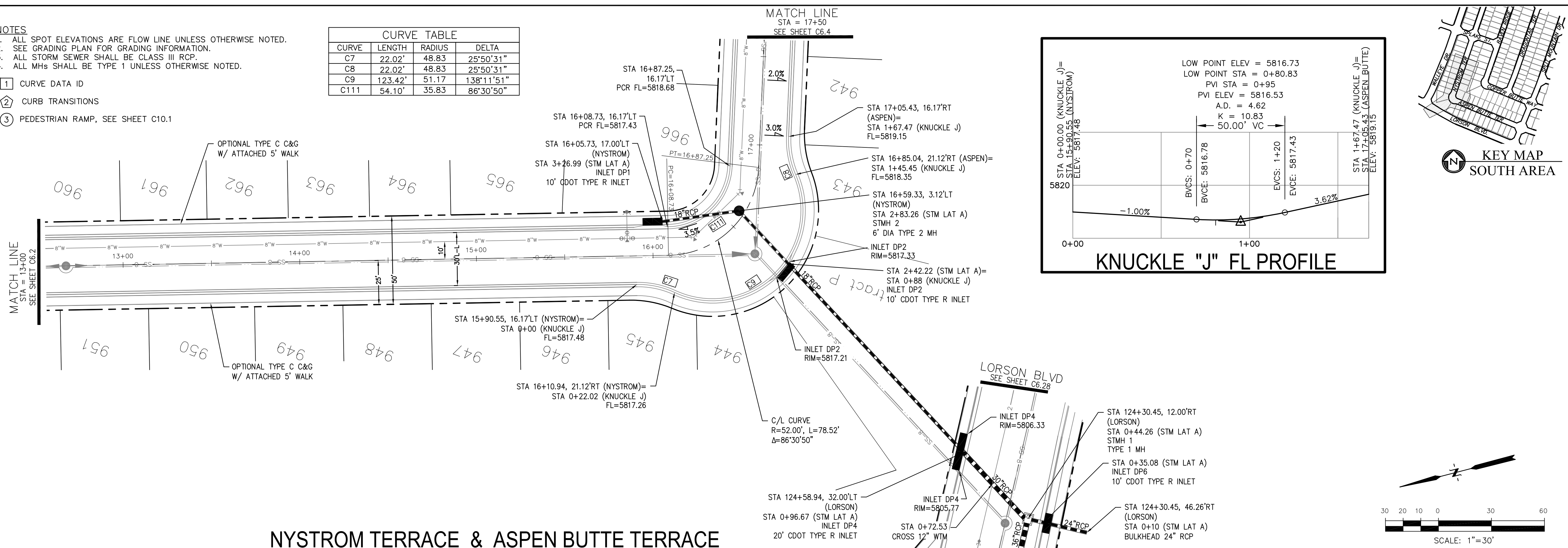

NYSTROM TERRACE & ASPEN BUTTE TERRACE

LOW POINT ELEV = 5817.83  
 LOW POINT STA = 16+06.14  
 PVI STA = 16+60  
 PVI ELEV = 5817.24  
 A.D. = 5.90  
 K = 26.27

STORM LATERAL 'A' PROFILE

SCALES: HORIZ. 1"=30'  
 VERT. 1"=5'

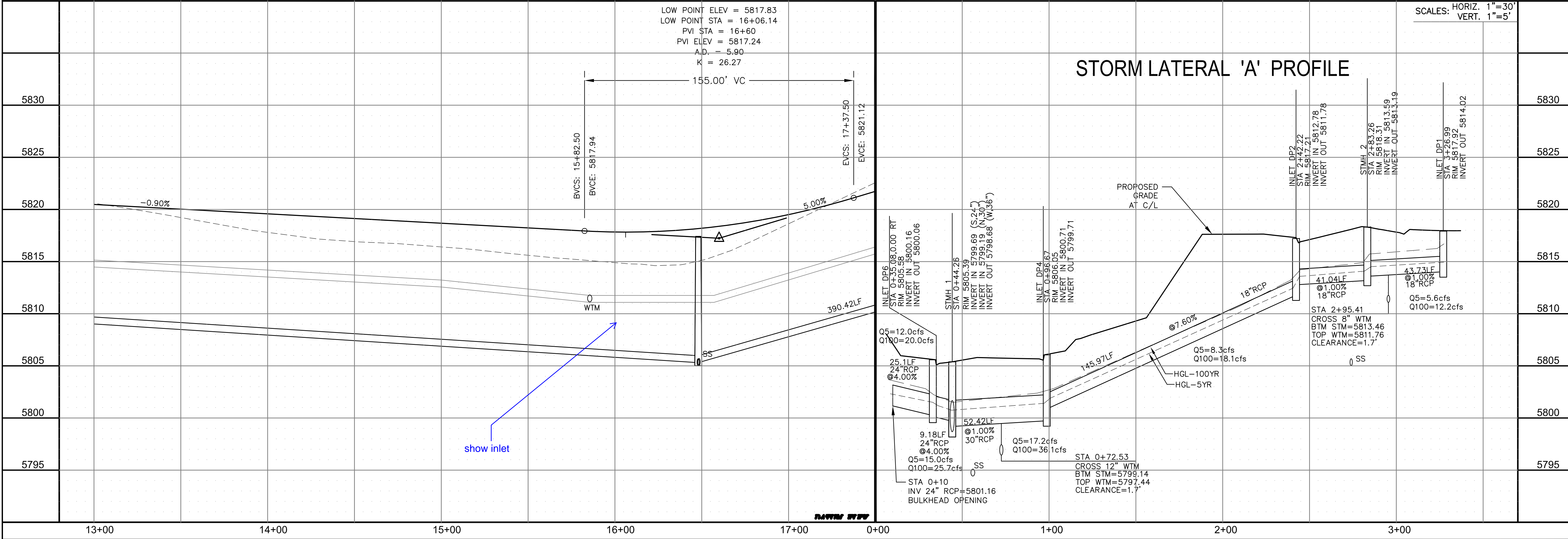

**CORE ENGINEERING GROUP**  
 15004 1ST AVENUE S.  
 BIRMGHAM, AL 35206  
 CONTACT: RICHARD L. SCHINDLER, P.E.  
 EMAIL: Rich@cegi.com

DATE: \_\_\_\_\_  
 NO. \_\_\_\_\_  
 DESCRIPTION: \_\_\_\_\_  
 PREPARED FOR: **LORSON, LLC**  
 212 N. WAHSATCH AVE., SUITE 301  
 COLORADO SPRINGS, COLORADO 80903  
 CONTACT: JEFF MARK

PROJECT: **THE RIDGE AT LORSON RANCH**  
 FONTAINE BLVD - WALLEYE DR  
 COLORADO SPRINGS, COLORADO

DRAWN: RLS  
 DESIGNED: RLS  
 CHECKED: RLS

STREET / STORM - SOUTH AREA  
 NYSTROM TERRACE  
 STA 13+00 TO 17+50

DATE: JULY, 2021  
 PROJECT NO. 100.064  
 SHEET NUMBER C6.3  
 TOTAL SHEETS: 70



- NOTES
1. ALL SPOT ELEVATIONS ARE FLOW LINE UNLESS OTHERWISE NOTED.
  2. SEE GRADING PLAN FOR GRADING INFORMATION.
  3. ALL STORM SEWER SHALL BE CLASS III RCP.
  4. ALL MHS SHALL BE TYPE 1 UNLESS OTHERWISE NOTED.

- ① CURVE DATA ID
- ② CURB TRANSITIONS
- ③ PEDESTRIAN RAMP, SEE SHEET C10.1

Please move manhole west as far as possible to move storm drain out from under curb and gutter

CURVE	LENGTH	RADIUS	DELTA
C40	22.02'	48.83	25°50'31"
C41	22.02'	48.83	25°50'31"
C42	126.54'	51.17	141°41'02"
C56	31.42'	20.00	90°00'00"
C60	31.42'	20.00	90°00'00"
C85	56.28'	35.83	90°00'00"

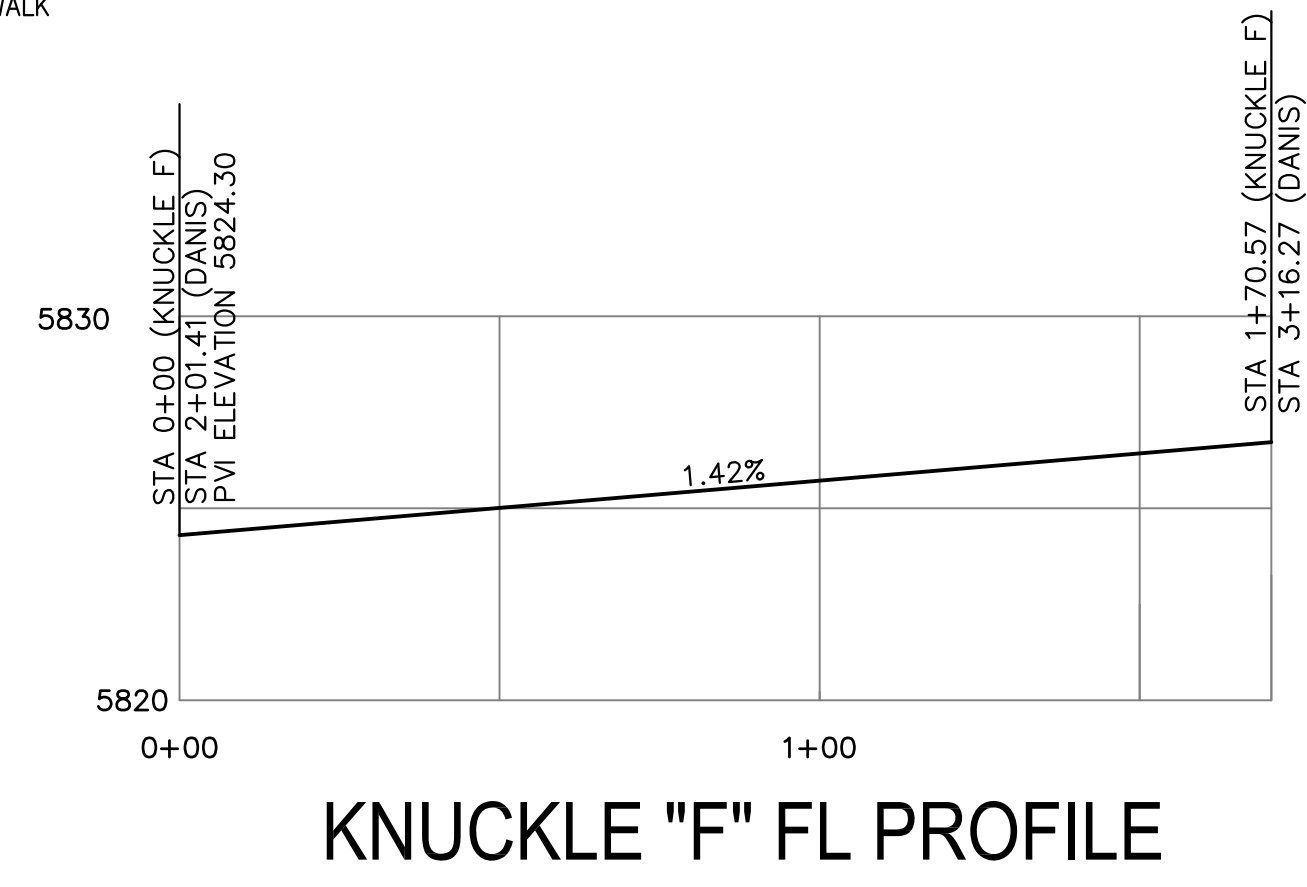
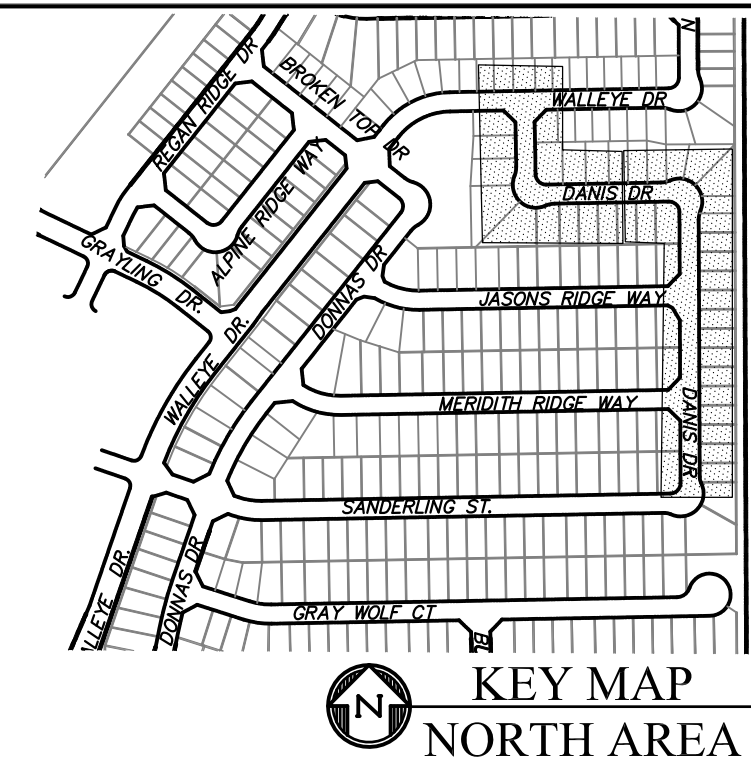
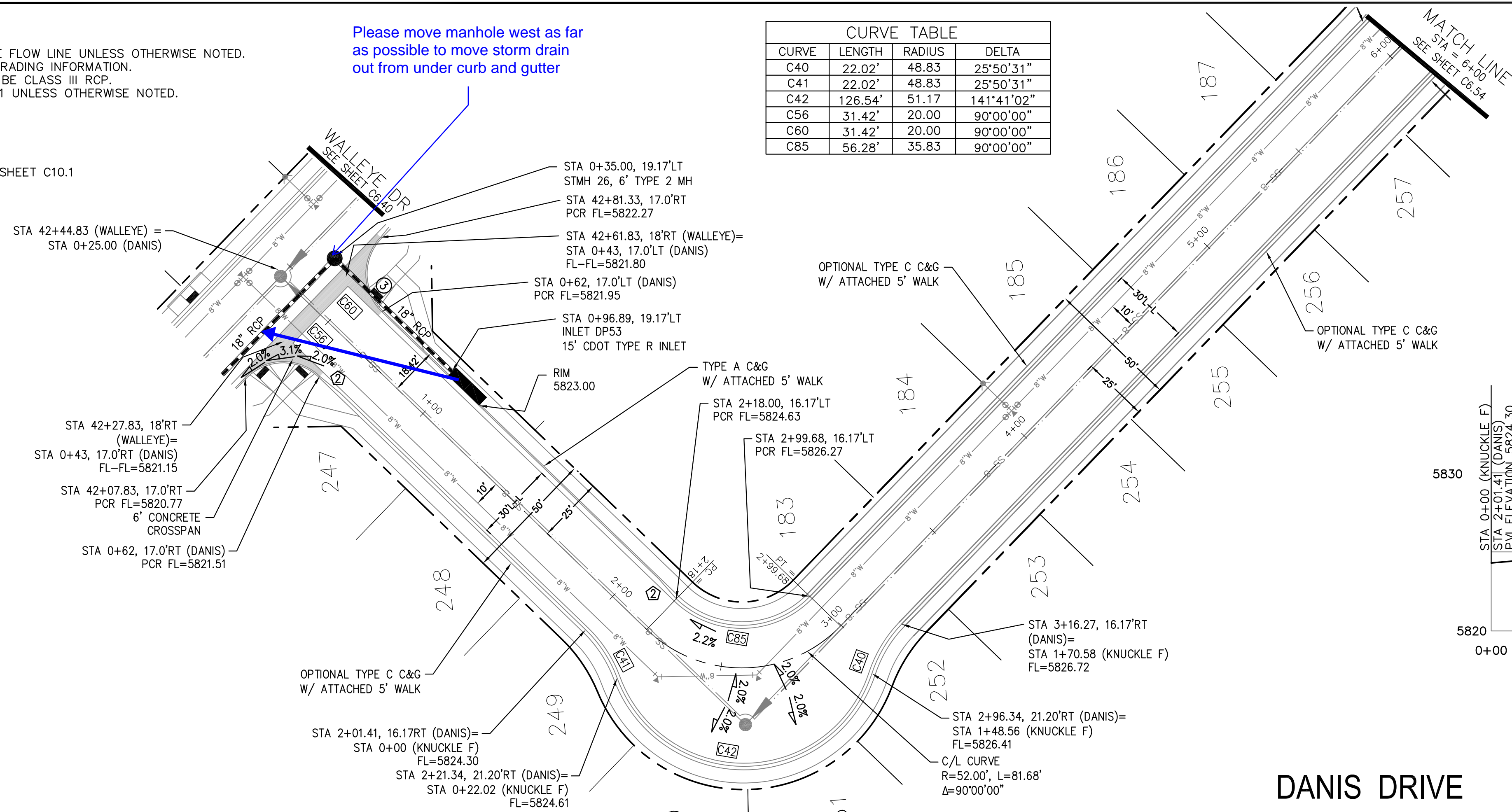

DANIS DRIVE

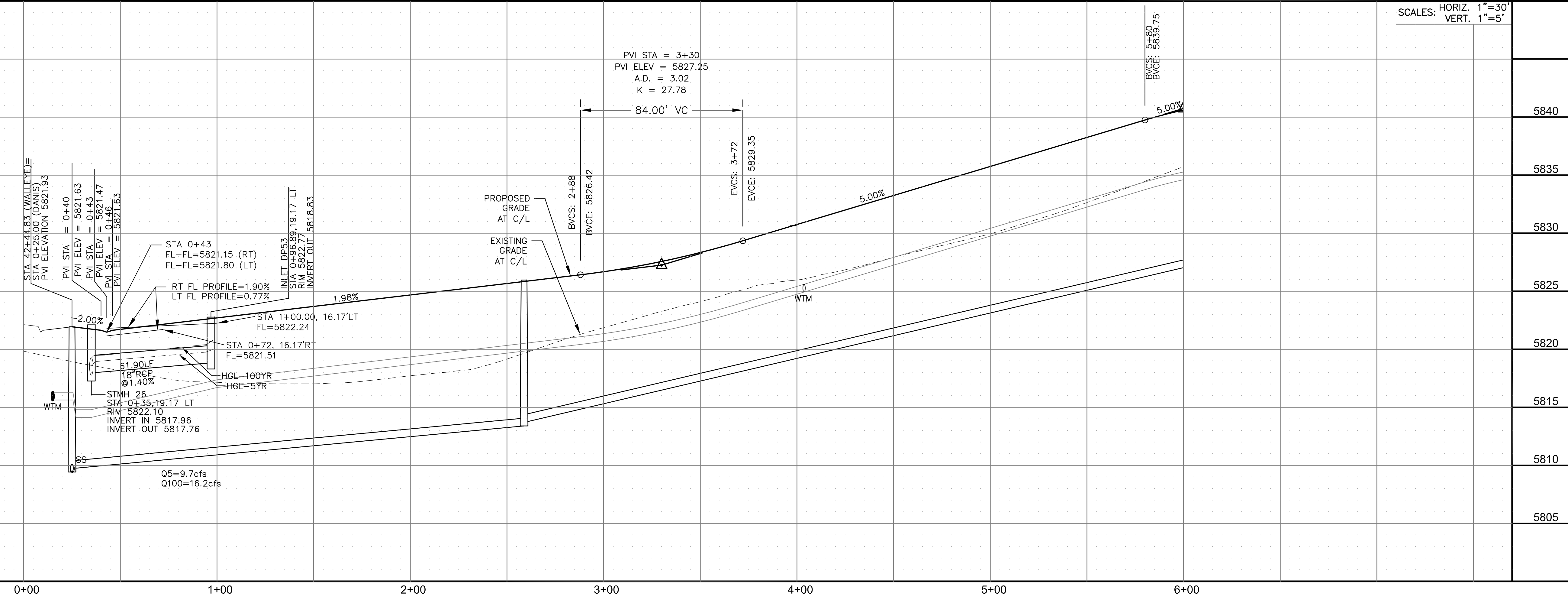
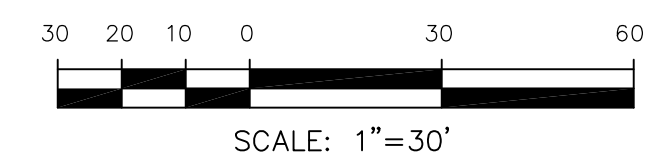

**CORE ENGINEERING GROUP**  
 15004 1ST AVENUE S.  
 BURNING WOOD, CO 80906  
 PH: 719.570.1100  
 CONTACT: RICHARD L. SCHINDLER, P.E.  
 EMAIL: Rich@cegi.com

DATE: \_\_\_\_\_

DESCRIPTION: \_\_\_\_\_

NO. \_\_\_\_\_

PROJECT: **THE RIDGE AT LORSON RANCH**  
 212 N. WAHSATCH AVE., SUITE 301  
 COLORADO SPRINGS, COLORADO 80903  
 FONTAINE BLVD - WALLEYE DR  
 COLORADO SPRINGS, COLORADO  
 CONTACT: JEFF MARK

PREPARED FOR: **LORSON, LLC**  
 212 N. WAHSATCH AVE., SUITE 301  
 COLORADO SPRINGS, COLORADO 80903  
 CONTACT: JEFF MARK

DRAWN: RLS  
 DESIGNED: RLS  
 CHECKED: RLS

STREET / STORM - NORTH AREA  
 DANIS DRIVE  
 STA 0+00 TO 6+00

DATE: JULY, 2021

PROJECT NO. 100.064

SHEET NUMBER C6.53

TOTAL SHEETS: 70



- NOTES
1. ALL SPOT ELEVATIONS ARE FLOW LINE UNLESS OTHERWISE NOTED.
  2. SEE GRADING PLAN FOR GRADING INFORMATION.
  3. ALL STORM SEWER SHALL BE CLASS III RCP.
  4. ALL MHS SHALL BE TYPE 1 UNLESS OTHERWISE NOTED.

- ① CURVE DATA ID
- ② CURB TRANSITIONS
- ③ PEDESTRIAN RAMP, SEE SHEET C10.1

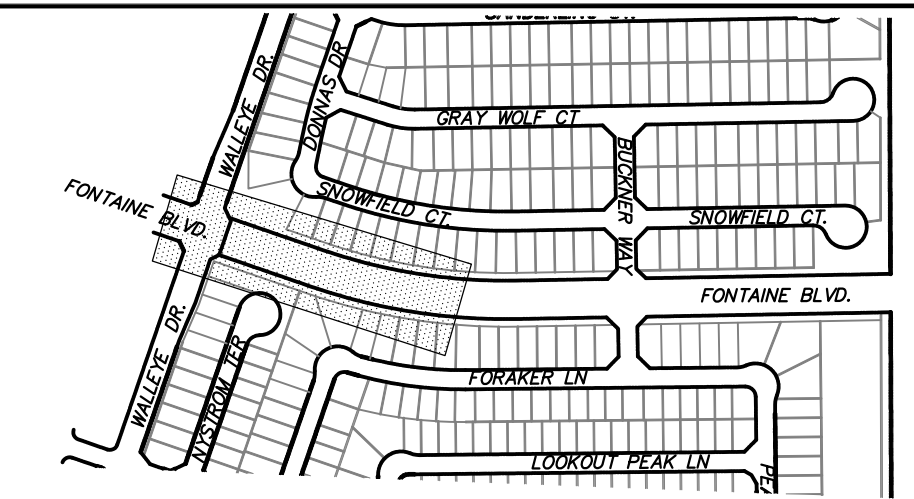

KEY MAP  
NORTH AREA

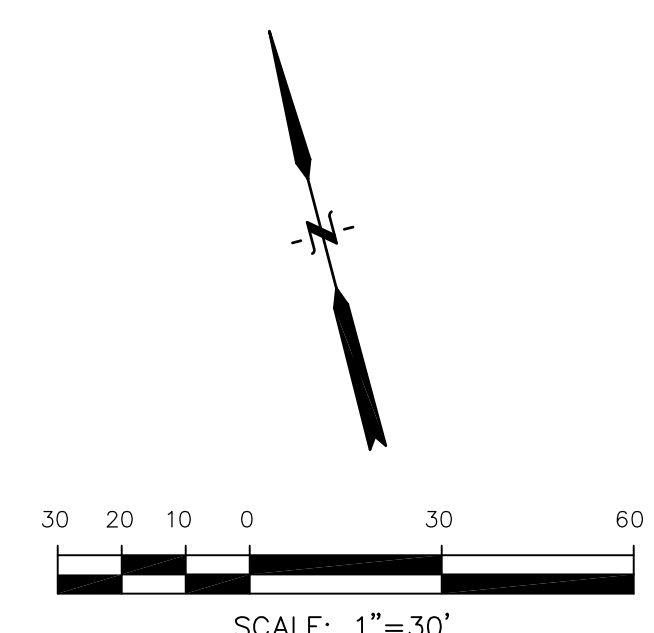
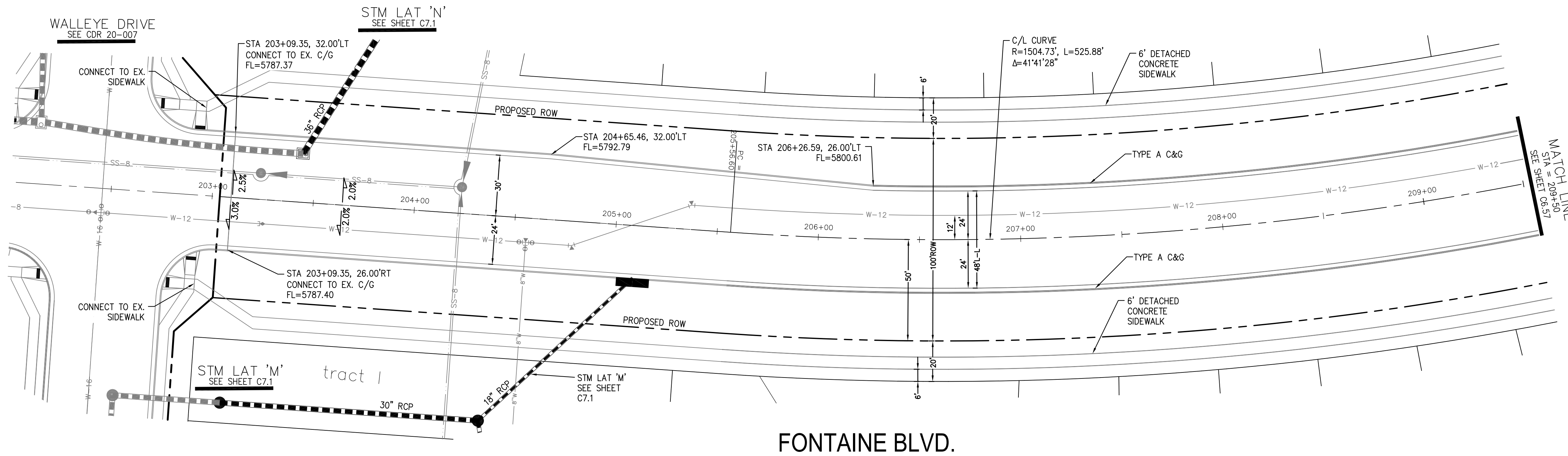

**CORE**  
ENGINEERING GROUP  
15004 1ST AVENUE S.  
DENVER, CO 80202  
PHONE: 303.750.1100  
CONTACT: RICHARD L. SCHINDLER, P.E.  
EMAIL: Rich@cegi.com

DATE: \_\_\_\_\_  
DESCRIPTION: \_\_\_\_\_  
NO. \_\_\_\_\_  
DRAWN: RLS  
DESIGNED: RLS  
CHECKED: RLS

PREPARED FOR:  
**LORSON, LLC**  
212 N. WAHSATCH AVE., SUITE 301  
COLORADO SPRINGS, COLORADO 80903  
CONTACT: JEFF MARK

PROJECT:  
**THE RIDGE AT LORSON RANCH**  
FONTAINE BLVD - WALLEYE DR  
COLORADO SPRINGS, COLORADO

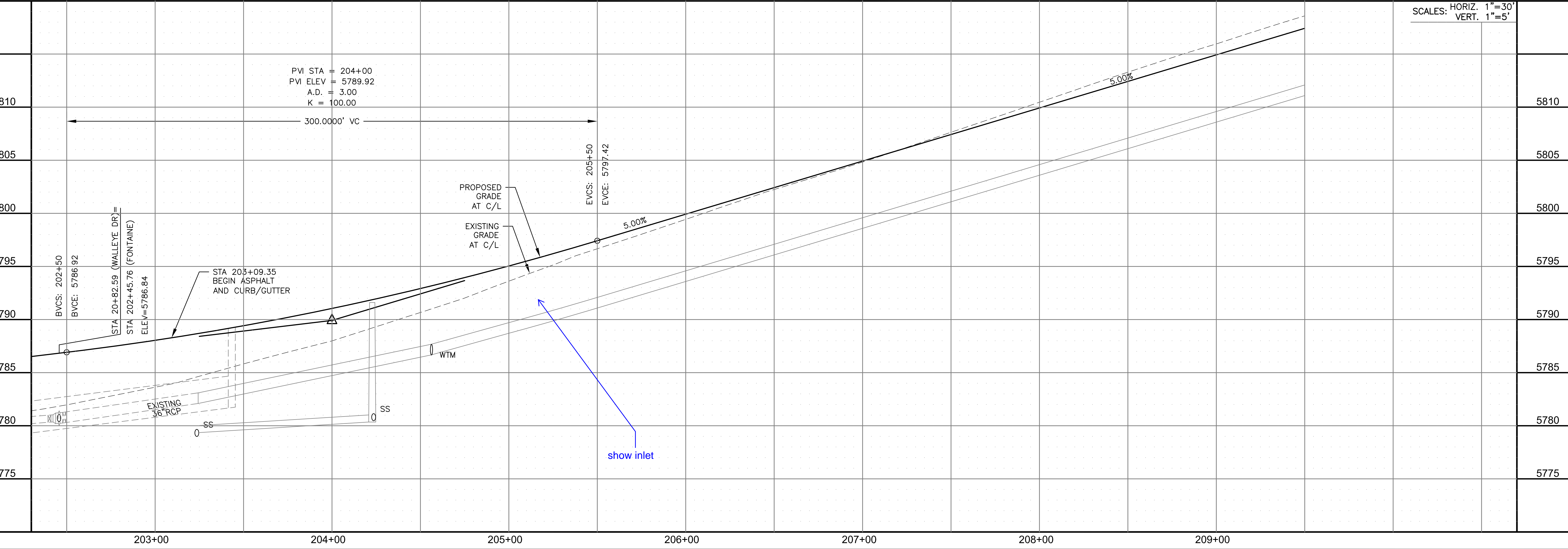

STREET / STORM - NORTH AREA  
FONTAINE BLVD.  
STA 203+00 TO 209+50

SCALE: HORIZ. 1"=30'  
VERT. 1"=5'

DATE:  
JULY, 2021

PROJECT NO.  
100.064

SHEET NUMBER  
C6.56

TOTAL SHEETS: 70