

August 24, 2020

Dear Property Owner,

This letter is being sent to you because Aeroplaza Fountain LLC is proposing a land use project in El Paso County located within the western portion of the Paint Brush Hills development. This information is being provided to you prior to a submittal with the El Paso County Planning and Community Development Department. Please direct any questions on the proposal to the referenced contact(s) as listed below. Prior to any public hearing on this proposal a notification of the time and place of the public hearing will be sent to the adjacent property owners by the El Paso County Planning and Community Development Department. At that time, you will be given the El Paso County contact information, the file number and an opportunity to respond either for, against or expressing no opinion in writing or in person at the public hearing for this proposal.

The proposal being submitted to El Paso County is seeking approval of an application for a final plat and preliminary plan known as Paint Brush Hills Filing 14 development. This filing is a continuation of the existing Paint Brush Hills community.

The preliminary plan and final plat illustrate 224 total units on 88.632 acres for a density of 2.53 Dwelling Units per Acre. The design includes a mix of lot sizes with lots averaging 1-acre in size along the perimeter. The interior lots are a minimum size of 6,000 square feet to remain congruent with existing development within Paint Brush Hills. The preliminary plan shows the detailed design of the single-family detached residential lots and describes the lot sizes, transportation systems, public rights-of way, and easements necessary for development. As part of the final plat, construction documents and utility plans have been provided for review. The site is suitable for the intended use of single family residential and is compatible with both the existing and allowed land uses found within the area. The site is undeveloped, vacant land with native grasslands and rolling topography. There are no deviations being requested at this time.

For questions please contact:

Aeroplaza Fountain LLC
212 N. Wahsatch Ave. #301
Colorado Springs, CO 80903
Attn: Jeff Mark
(719) 635-3200

El Paso County Planning Department
2880 International Circle
Colorado Springs, CO 80910
Attn: Kari Parsons
(719) 520-6300

Sincerely,

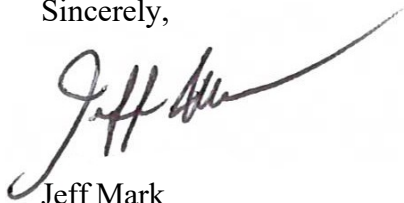

Jeff Mark
Aeroplaza Fountain LLC

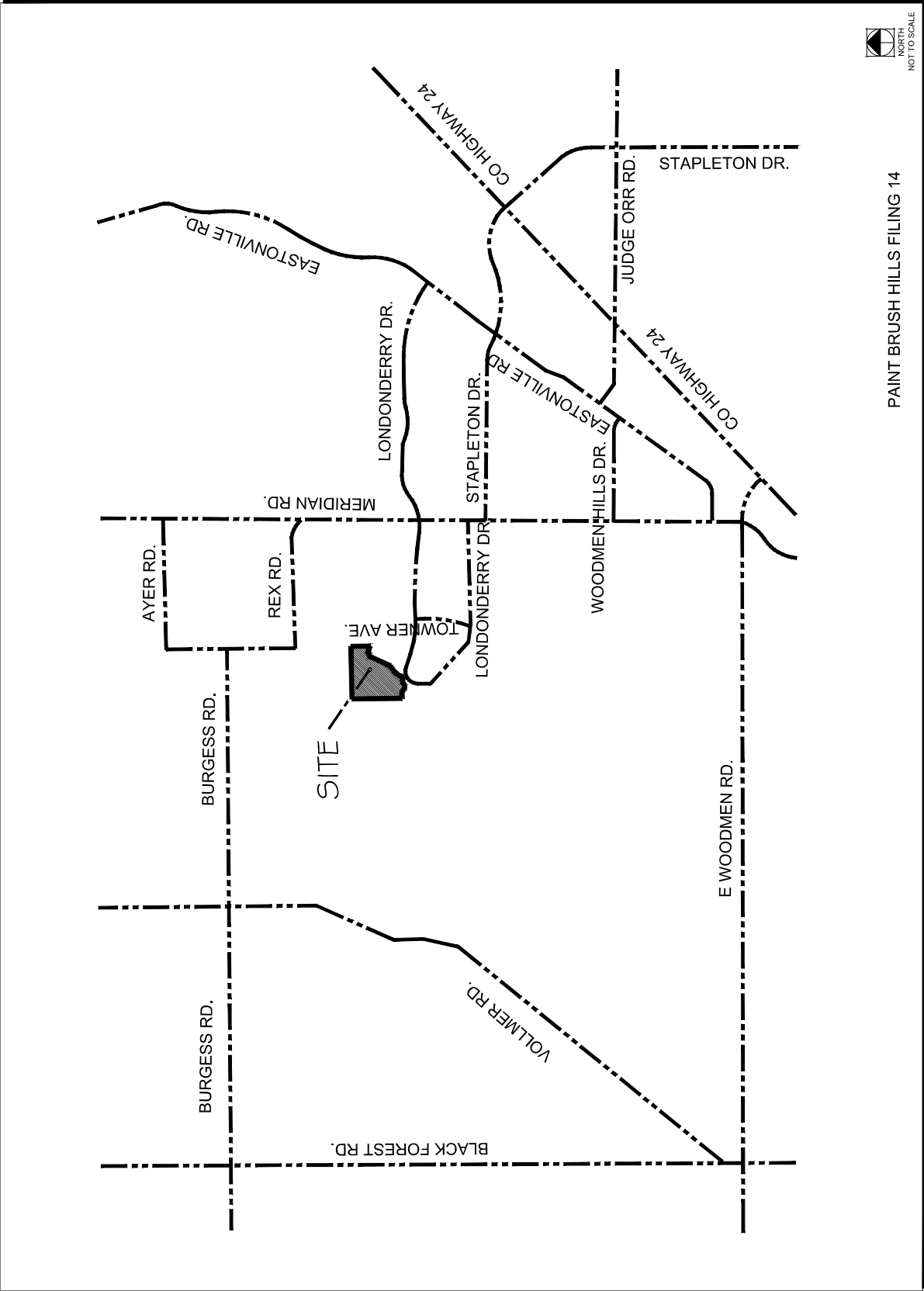

PAINT BRUSH HILLS FILING 14



2435 Research Parkway Suite 300
Colorado Springs CO 80920

CERTIFIED MAIL



7019 1640 0001 6941 4263

Roy & Abigail Keiser
10111 Keating Dr
Peyton Co 80831



FIRST-CLASS



02 7H
0001228852 AUG 24 2020
MAILED FROM ZIP CODE 80920

US POSTAGE

\$ 004.05⁰



2435 Research Parkway Suite 300
Colorado Springs CO 80920

CERTIFIED MAIL

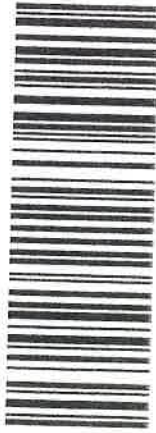

7019 1640 0001 6941 4256

Paint Brush Hills Land Holdings
11427 Rojas Dr.
El Paso Tx, 79936



FIRST-CLASS



02 7H
0001228852 AUG 24 2020
MAILED FROM ZIP CODE 80920

US POSTAGE

\$ 004.05⁰



2435 Research Parkway, Suite 300
Colorado Springs, CO 80920

CERTIFIED MAIL



7019 1640 0001 6941 4249

Mara & Aaren Strobel
10223 Keating Dr.
Peyton Co 80831



02 7H
0001228852 AUG 24 2020
MAILED FROM ZIP CODE 80920



FIRST-CLASS



2435 Research Parkway, Suite 300
Colorado Springs, CO 80920

CERTIFIED MAIL



7019 1640 0001 6941 4232

Campbell Homes Llc
4850 Austin Bluffs Pkwy
Colorado Springs Co, 80918



02 7H
0001228852 AUG 24 2020
MAILED FROM ZIP CODE 80920



FIRST-CLASS



2435 Research Parkway Suite 300
Colorado Springs, CO 80920

CERTIFIED MAIL



7019 1640 0001 6941 4218

Pamela & Matthew Backeberg
9946 Rockingham Dr
Peyton Co 80831



2435 Research Parkway Suite 300
Colorado Springs, CO 80920

CERTIFIED MAIL



7019 1640 0001 6941 4225

Monika & David Wells
10015 Keating Dr
Peyton Co 80831



FIRST-CLASS

02 7H
0001228852 AUG 24 2020
MAILED FROM ZIP CODE 80920
US POSTAGE
\$ 004.05⁰



FIRST-CLASS

02 7H
0001228852 AUG 24 2020
MAILED FROM ZIP CODE 80920
US POSTAGE
\$ 004.05⁰



2435 Research Parkway, Suite 300
Colorado Springs, CO 80920

CERTIFIED MAIL®



7019 1640 0001 6941 4195

Rex & Laura Caraway
10365 Arrowgrass Loop
Peyton Co 80831



02 7H
0001228852 AUG 24 2020
MAILED FROM ZIP CODE 80920
US POSTAGE
\$ 004.05⁰



2435 Research Parkway, Suite 300
Colorado Springs, CO 80920

CERTIFIED MAIL®

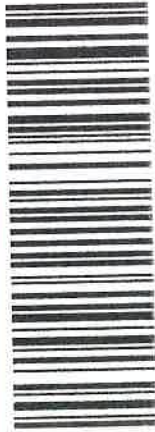

7019 1640 0001 6941 4201

Paint Brush Hills Metro District
9985 Tower Ave.
Peyton Co 80831



02 7H
0001228852 AUG 24 2020
MAILED FROM ZIP CODE 80920
US POSTAGE
\$ 004.05⁰



2435 Research Parkway, Suite 300
Colorado Springs, CO 80920

CERTIFIED MAIL



7019 1640 0001 6941 4171

Cory & Jacey
10271 Keating Dr.
Peyton Co 80831

FIRST-CLASS



02 7H
0001228852 AUG 24 2020
MAILED FROM ZIP CODE 80920

US POSTAGE
\$ 004.05⁰



2435 Research Parkway, Suite 300
Colorado Springs, CO 80920

CERTIFIED MAIL



7019 1640 0001 6941 4171

Donald Blasius
10585 Arrowgrass Loop
Peyton Co 80831

FIRST-CLASS

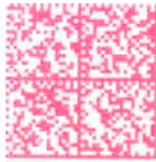

02 7H
0001228852 AUG 24 2020
MAILED FROM ZIP CODE 80920

US POSTAGE
\$ 004.05⁰



2435 Research Parkway, Suite 300
Colorado Springs, CO 80920

CERTIFIED MAIL



7019 1640 0001 6941 4157

Falcon Trust
10385 Arrowgrass Loop
Peyton Co 80831



2435 Research Parkway, Suite 300
Colorado Springs, CO 80920

CERTIFIED MAIL



7019 1640 0001 6941 4154

Darron Ohrman
10485 Arrowgrass Loop
Peyton Co 80831





2435 Research Parkway, Suite 300
Colorado Springs, CO 80920

CERTIFIED MAIL®



7019 1640 0001 6941 2870

Jerry Landress
12585 Bridle Bit Rd
Colorado Springs Co 80908



FIRST-CLASS



2435 Research Parkway, Suite 300
Colorado Springs, CO 80920

CERTIFIED MAIL®

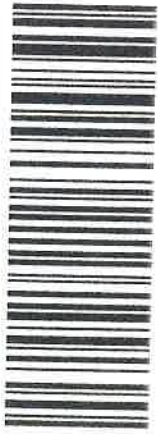

7019 1640 0001 6941 2887

Donald Vinson & Margaret Lee
9932 Rockingham Dr
Peyton Co 80831



FIRST-CLASS

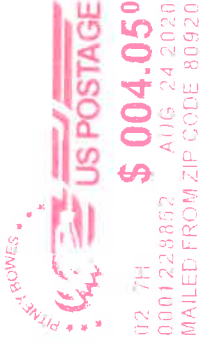



2435 Research Parkway, Suite 300
Colorado Springs, CO 80920

CERTIFIED MAIL®



7019 1640 0001 6941 2853

Tucker Family Trust
9974 Rockingham Dr
Peyton Co 80831

FIRST-CLASS



PRIME BOWIES
02 7H
0001228852
AUG 24 2020
MAILED FROM ZIP CODE 80920
US POSTAGE
\$ 004.05⁰



2435 Research Parkway, Suite 300
Colorado Springs, CO 80920

CERTIFIED MAIL®



7019 1640 0001 6941 2856

Michael & Virginia Carl
10047 Keating Dr
Peyton Co 80831

FIRST-CLASS



PRIME BOWIES
02 7H
0001228852
AUG 24 2020
MAILED FROM ZIP CODE 80920
US POSTAGE
\$ 004.05⁰



2435 Research Parkway, Suite 300
Colorado Springs, CO 80920

CERTIFIED MAIL®



7019 1640 0001 6941 2832

Fredric & Erika Maxwell
7390 Clovis Way
Colorado Springs Co 80908



2435 Research Parkway, Suite 300
Colorado Springs CO 80920

CERTIFIED MAIL®



7019 1640 0001 6941 2849

Kevin & Robin Robbins
10555 Arrowgrass Loop
Peyton Co 80831





2435 Research Parkway, Suite 300
Colorado Springs, CO 80920

CERTIFIED MAIL®



7019 1640 0001 6941 2818

Dal & Ssang Lee
10425 Arrowgrass Loop
Peyton Co 80831



FIRST-CLASS



02 7H
0001228852 AUG 24 2020
MAILED FROM ZIP CODE 80920

US POSTAGE
\$ 004.05⁰



2435 Research Parkway, Suite 300
Colorado Springs, CO 80920

CERTIFIED MAIL®



7019 1640 0001 6941 2825

Bruce Gorski & Kelly Ledbetter
10525 Arrowgrass Loop
Peyton Co 80831



FIRST-CLASS



02 7H
0001228852 AUG 24 2020
MAILED FROM ZIP CODE 80920

US POSTAGE
\$ 004.05⁰



2435 Research Parkway, Suite 300
Colorado Springs, CO 80920

CERTIFIED MAIL®



7019 1640 0001 6941 2801

Jeremy & Jami Mares
9960 Rockingham Dr
Peyton Co 80831



FIRST-CLASS
02 7H
0001228852 AUG 24 2020
MAILED FROM ZIP CODE 80920
PERRY BOWEN
US POSTAGE
\$ 004.05⁰



2435 Research Parkway, Suite 300
Colorado Springs, CO 80920

CERTIFIED MAIL®



7019 1640 0001 6941 2801

Larry Ferrell & Kathleen Murphy
10560 Snowbrush Dr
Peyton Co 80831



FIRST-CLASS
02 7H
0001228852 AUG 24 2020
MAILED FROM ZIP CODE 80920
PERRY BOWEN
US POSTAGE
\$ 004.05⁰



2435 Research Parkway, Suite 300
Colorado Springs, CO 80920

CERTIFIED MAIL



7019 1640 0001 6941 2771

Amanda & Jason Matzke
10031 Keating Dr
Peyton Co 80831

FIRST-CLASS



PRIME BROWES
02 7H
0001228852 AUG 24 2020
MAILED FROM ZIP CODE 80920
US POSTAGE
\$ 004.05⁰



2435 Research Parkway, Suite 300
Colorado Springs, CO 80920

CERTIFIED MAIL



7019 1640 0001 6941 2795

Heidi & Kevin Mellon
9918 Rockingham Dr
Peyton Co 80831

FIRST-CLASS



PRIME BROWES
02 7H
0001228852 AUG 24 2020
MAILED FROM ZIP CODE 80920
US POSTAGE
\$ 004.05⁰



2435 Research Parkway, Suite 300
Colorado Springs, CO 80920

CERTIFIED MAIL®



7019 1640 0001 6941 2764

Susan & Kenneth Chambers
10063 Keating Dr
Peyton Co 80831



02 7H
0001228852 AUG 24 2020
MAILED FROM ZIP CODE 80920



FIRST-CLASS



02 7H
0001228852 AUG 24 2020
MAILED FROM ZIP CODE 80920



FIRST-CLASS

CERTIFIED MAIL®



7019 1640 0001 6941 4270

Debra & Steven Gray
10455 Arrowgrass Loop
Peyton Co 80831



2435 Research Parkway, Suite 300
Colorado Springs, CO 80920