

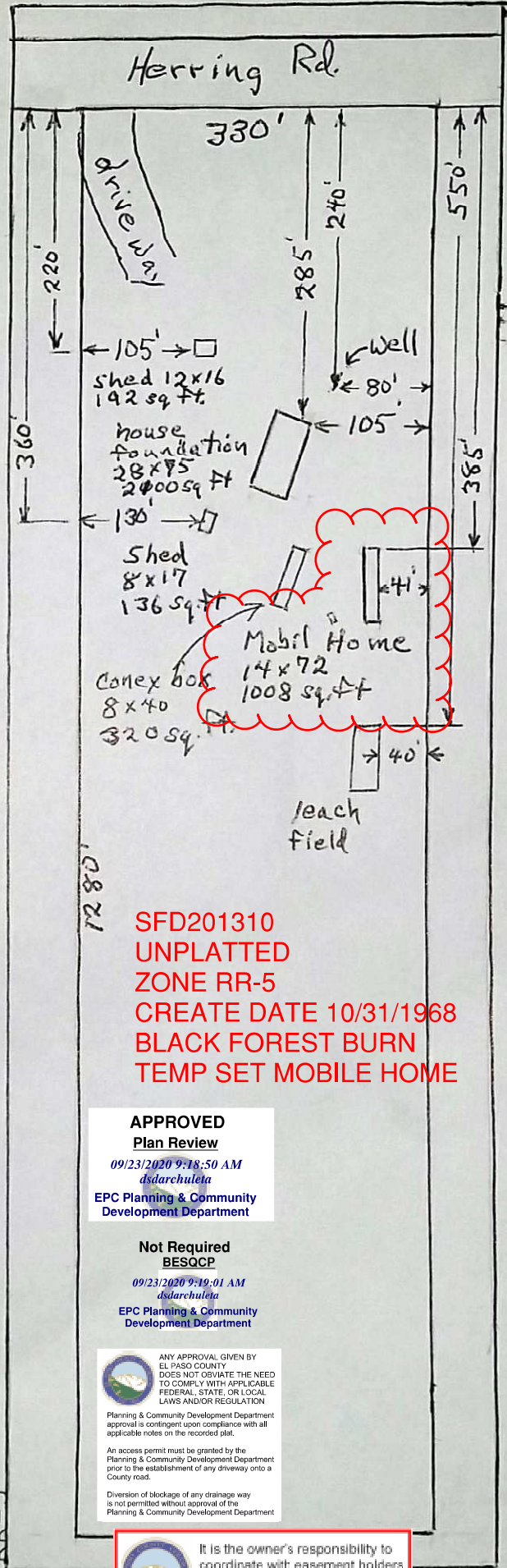

N ←



Released for Permit
09/15/2020 3:44:04 PM

amy
ENUMERATION

12680 HERRING RD
52080-00-069
SEC 08-12-65
RR-5

SFD201310
UNPLATTED
ZONE RR-5
CREATE DATE 10/31/1968
BLACK FOREST BURN
TEMP SET MOBILE HOME

**APPROVED
Plan Review**

09/23/2020 9:18:50 AM
dsdarchuleta

EPC Planning & Community
Development Department

**Not Required
BESQCP**

09/23/2020 9:19:01 AM
dsdarchuleta

EPC Planning & Community
Development Department



ANY APPROVAL GIVEN BY
EL PASO COUNTY
DOES NOT OBTAIN THE NEED
TO COMPLY WITH APPLICABLE
FEDERAL, STATE, OR LOCAL
LAWS AND/OR REGULATION

Planning & Community Development Department
approval is contingent upon compliance with all
applicable notes on the recorded plat.

An access permit must be granted by the
Planning & Community Development Department
prior to the establishment of any driveway onto a
County road.

Division of blockage of any drainage way
is not permitted without approval of the
Planning & Community Development Department



It is the owner's responsibility to
coordinate with easement holders
to avoid impact to utilities that
may be located in the easements.

RESIDENTIAL

2017 PPRBC



Parcel: 5208000069

Address: 12680 HERRING RD, COLORADO SPRINGS

Plan Track #: 134130 Received: 14-Sep-2020 (BECKYA)

Description:

Required PPRBD Departments (4)

MOBILE/MFR HOME - TEMPORARY SET

Contractor: HOMEOWNER

Type of Unit:

Enumeration Released for Permit 09/15/2020 3:45:04 PM amy ENUMERATION	Floodplain (N/A) RBD GIS
Construction	Mechanical Released for Permit 09/17/2020 7:06:43 AM daleh MECHANICAL

Required Outside Departments (2)

County Zoning APPROVED Plan Review 09/23/2020 9:30:42 AM dsdarchuleta EPC Planning & Community Development Department	Health Dept. N/A 09/16/2020 5:14:08 PM El Paso County, CO heabrannonnuce Public Health Health Department
---	--

Release of this plan does not preclude compliance with all applicable codes, ordinances and other pertinent regulations. This plan set must be present on the job site for every inspection.