



COMMISSIONERS:
DARRYL GLENN (PRESIDENT)
MARK WALLER (PRESIDENT PRO TEM)

PEGGY LITTLETON
LONGINOS GONZALEZ, JR.
STAN VANDERWERF

COMMUNITY SERVICES DEPARTMENT

PARKS OPERATIONS ~ PLANNING ~ CSU EXTENSION ~ COMMUNITY OUTREACH
ENVIRONMENTAL SERVICES ~ VETERANS SERVICES ~ RECREATION / CULTURAL SERVICES

May 29, 2018

Gabe Sevigny
Project Manager
El Paso County Development Services Department
2880 International Circle
Colorado Springs, CO 80910

Subject: Rocky Top Rezone, Review #2 (I-18-001)

Hello Gabe,

The Planning Division of the Community Services Department has reviewed the Rocky Top Rezone application, Review #2, and has no additional comments. Please refer to the original review comments below:

"The El Paso County Parks Master Plan (2013) shows the Fountain Creek Regional Trail being impacted by this project. The project site is located on the southeast corner of the intersection of Interstate 25 and Martin Luther King, Jr. Bypass, along the banks of Fountain Creek. This section of the Fountain Creek Regional Trail is maintained by the City of Colorado Springs, and the trail itself is contained within a 50-foot trail easement (Recording No. 099034230), dedicated to the City of Colorado Springs in February 1999. Furthermore, the City of Colorado Springs' proposed Spring Creek Trail is located along the western banks of Spring Creek in the eastern portion of the subject property.

Parks recommends that the applicant consult the City of Colorado Springs Parks staff, since the City not only maintains the Fountain Creek Trail through the applicant's property, but is also actively working on potential trail connections in this area. Dave Dietemeyer would be a good contact there."

These comments are being provided administratively, as this application does not require Park Advisory Board consideration.

Sincerely,

Ross A. Williams
Park Planner
Planning Division
Community Services Department
rosswilliams@elpasoco.com



ROCKY TOP RESOURCES, INC. REZONE REQUEST

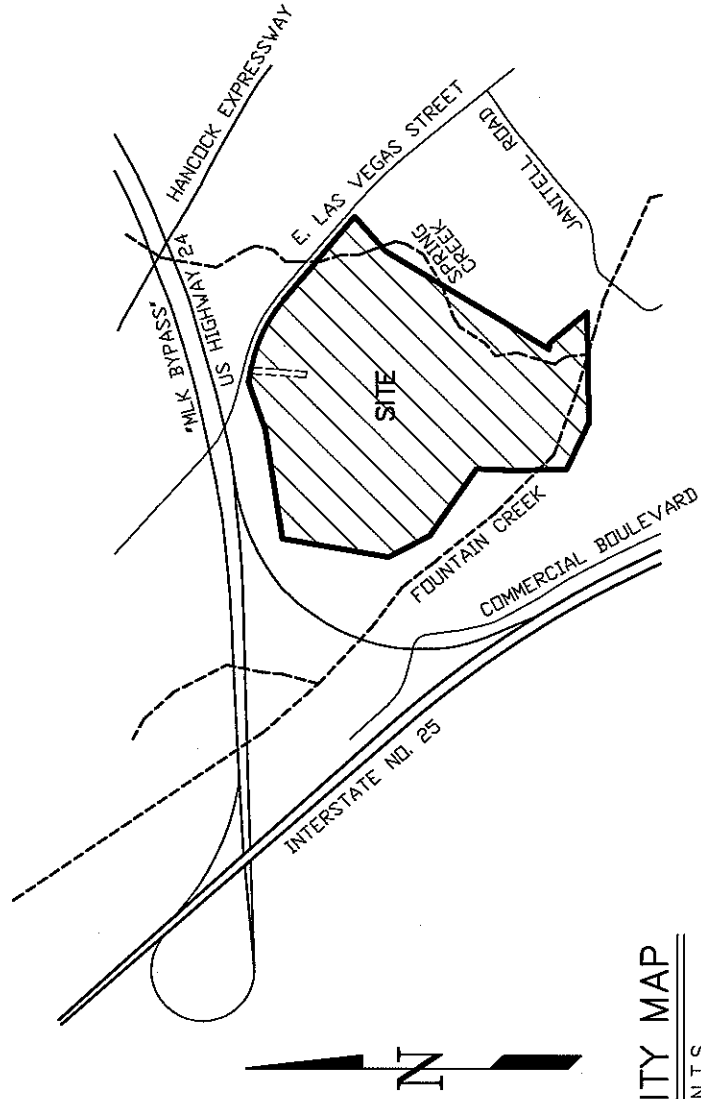

VICINITY MAP
N.T.S.