

LSC Responses to Deviation No 1 Comments

Page: 1

 Number: 1 Author: jchodsdon Subject: Text Box Date: 10/4/2024 18:59:01
LSC Responses to Deviation No. 1 Redline Comments.

OWNER, APPLICANT, AND ENGINEER DECLARATION

To the best of my knowledge, the information on this application and all additional or supplemental documentation is true, factual and complete. I am fully aware that any misrepresentation of any information on this application may be grounds for denial. I have familiarized myself with the rules, regulations and procedures with respect to preparing and filing this application. I also understand that an incorrect submittal will be cause to have the project removed from the agenda of the Planning Commission, Board of County Commissioners and/or Board of Adjustment or delay review until corrections are made, and that any approval of this application is based on the representations made in the application and may be revoked on any breach of representation or condition(s) of approval.

Signature of owner (or authorized representative)

Date

Engineer's Seal, Signature
And Date of Signature

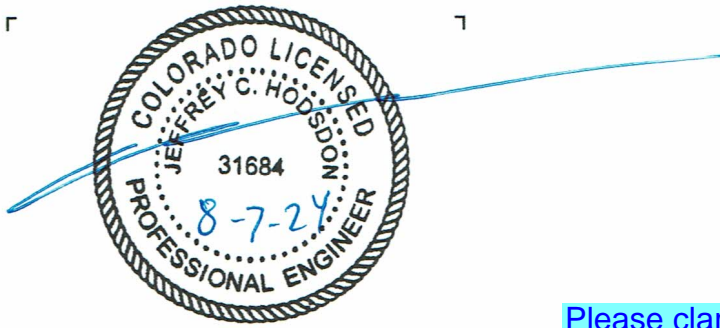

DEVIATION REQUEST (Attach diagrams, figures, and other documentation to clarify request)

Please clarify if section C is being deviated from; not listed below ¹

A deviation from the standards of or in Sections 2.2.5.D. **2.3.2 and 2.3.7.B,C. Collector Access Standards** of the Engineering Criteria Manual (ECM) is requested.

Deviation request is to allow the proposed north access point location: Unbroken Drive to the planned extension of Misty Acres Boulevard. This deviation involves the intersection spacing of Unbroken Drive 395 feet to the north to the future County Line Road/Misty Acres Boulevard intersection.

Please add the sight distance figure from the TIS as an exhibit ²

Please refer to the attached Deviation Exhibit 1.

Identify the specific ECM standard which a deviation is requested:

2.2.5.D. Collector Access Standards. Collector roadways shall intersect another roadway (centerline to centerline) in accordance with the standards in Section 2.3.7. **On major collector roadways, the closest local roadway intersection to an arterial roadway shall be 660 feet (right-of-way line of arterial to centerline of local roadway).**

2.3.2 (Design Standards by Function Classification),
Table 2-7. Roadway Design Standards for Urban Collectors and Locals
Table 2-21. Entering Sight Distance

2.3.7. Intersections:
B. Intersection Spacing and General Access Standards

Spacing of roads accessing an Urban Non-Residential Collector that will result in a full-movement intersection shall be 330 feet. The 330-foot standard is reflected in ECM Table 2-7, which bases the required access spacing on stopping sight distance on the major roadway with a design speed of 40 mph (ECM Table 2-17).

State the reason for the requested deviation:

The deviation is requested as the proposed intersection spacing between County Line Road and the proposed Unbroken Drive is less than the prescribed 660 feet along the future alignment of Misty Acres Boulevard.

Explain the proposed alternative and compare to the ECM standards (May provide applicable regional or national standards used as basis):

As the adjacent intersection to the north is an Arterial (County Line Road), the standard requires an intersection centerline spacing of 660 feet. Centerline spacing on Misty Acres Boulevard between County Line Road and the Unbroken Drive would be 390 feet (see Deviation Exhibit 1).

☰ Number: 1 Author: Bret Subject: Engineer Date: 9/19/2024 15:25:45

Please clarify if section C is being deviated from; not listed below

↩ Author: Jack Subject: Sticky Note Date: 9/27/2024 15:44:59

LSC Response

Removed 2.3.7.C reference, as only 2.3.7.B is being deviated from

☰ Number: 2 Author: Bret Subject: Engineer Date: 9/19/2024 16:13:06

Please add the sight distance figure from the TIS as an exhibit

↩ Author: jchodsdon Subject: Sticky Note Date: 10/4/2024 18:57:32

LSC Response: Added as Requested.



Approximate Scale
1" = 800'

1

Please revise to match the request and TIS

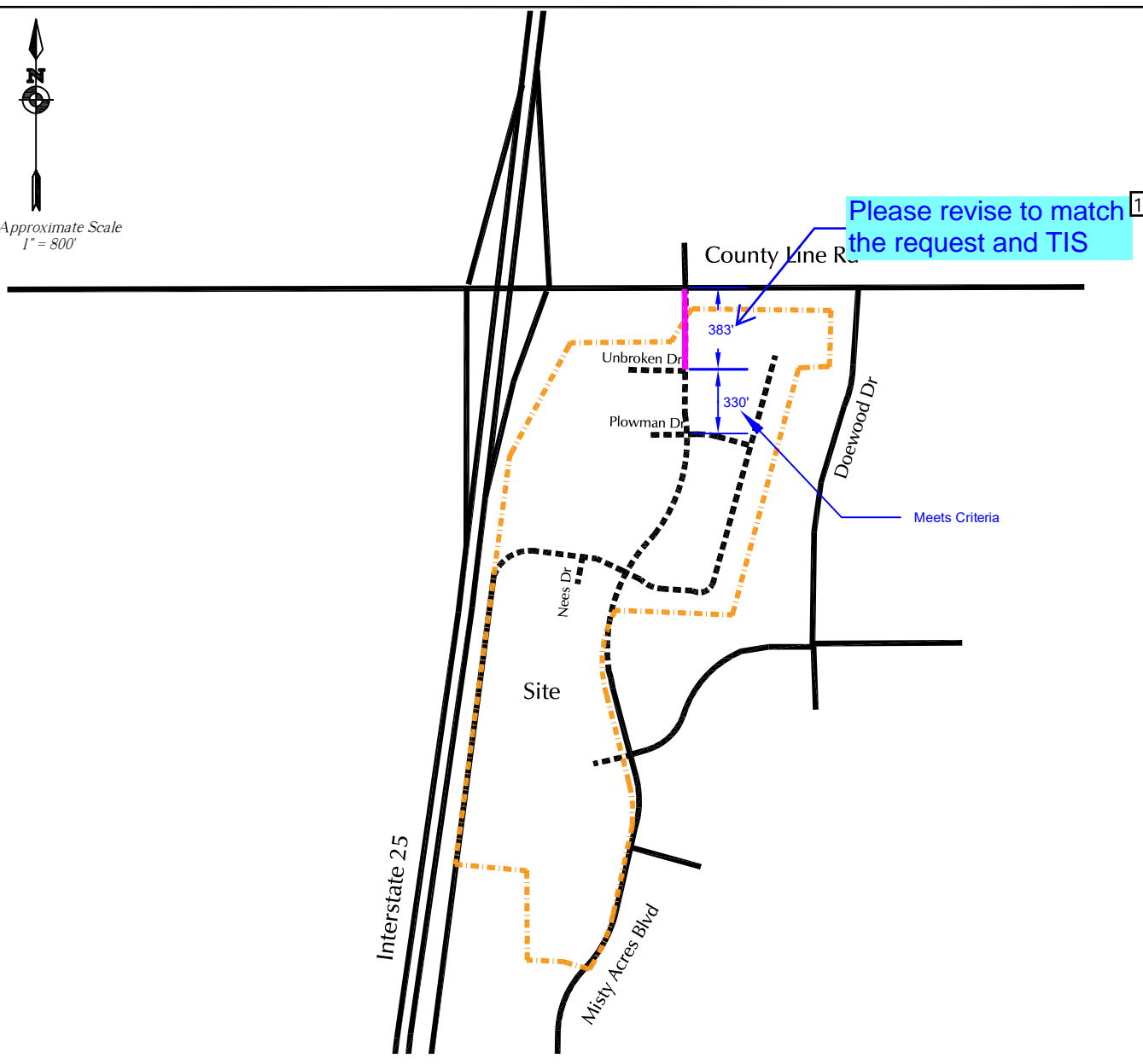

Deviation Request from ECM 2.3.2 -- Design Standards by Function Classification

- Existing roadway
- Proposed roadway
- Portion of proposed roadway for which deviation is requested
- Intersection centerline spacing - 395' proposed, 660' required (Table 2-7)
(660' to the first street intersection from an arterial intersection)
- Site property boundary

Deviation No. 1 - Exhibit 1

Intersection Spacing Along an Urban Major Collector

Monument Ridge East (LSC# S234450)



Number: 1 Author: Bret Subject: Engineer Date: 9/19/2024 15:26:23

Please revise to match the request and TIS

 Author: Jack Subject: Sticky Note Date: 9/27/2024 15:47:58

LSC Response

Spacing has been updated to be 395 ft, which is consistent with other figures