

LIGHT FIXTURE SCHEDULE										
TYPE	MFR	CATALOG NO.	LAMPS			MTG	DESCRIPTION	NOTES	VOLTS	TOTAL WATTS
			QUAN	WATT	TYPE					
A	LITHONIA	WST LED P1 40K VF MVOLT DDBXD	1	11	LED	SURFACE	ARCHITECTURAL WALL SCONCE		120	11
B	LITHONIA	OLWX1 LED 20W 40K DDB	1	20	LED	SURFACE	WALL LUMINAIRE		120	20

GENERAL NOTES:
 FLUORESCENTS SHALL HAVE 0.125" LENS & 10% RAPID START ELECTRONIC BALLASTS.
 FLUORESCENT LAMPS SHALL BE LOW-MERCURY, 3500K, 85 CRI OR BETTER.
 COMPACT FLUORESCENT LAMPS SHALL BE 3500K, 82 CRI OR BETTER.



MOUNT AT 10'-0" AFG

3 TYPE "A" FIXTURE
ES-1



MOUNT AT 10'-0" AFG

2 TYPE "B" FIXTURE
ES-1

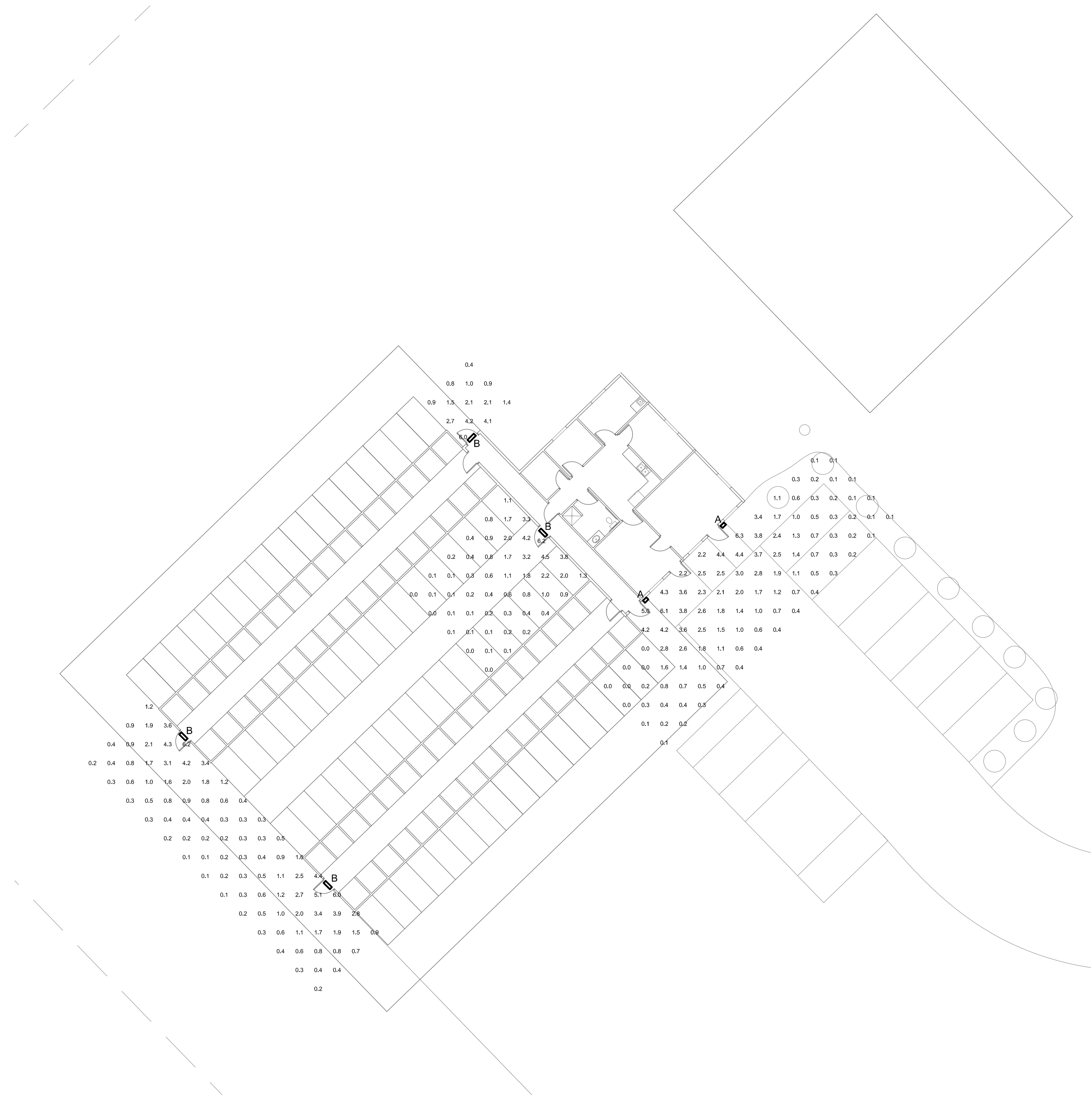

1 SITE PHOTOMETRIC
ES-1 SCALE: 1/32" = 1'-0"

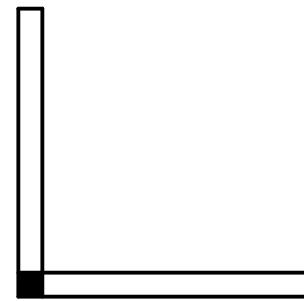
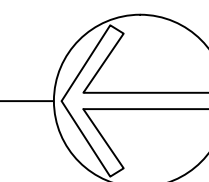

REVISIONS	BY

Kramer Construction, Inc.
 5030 Silver Drive, Colorado Springs, CO 80921
 phone 719-243-4188
Guttenberg Kennel
 14094 E Us Highway 24, Peyton, CO 80831

cShea Consulting, LLC
 MECHANICAL, ELECTRICAL + PLUMBING
 4445 North Academy Dr., Ste. 202
 Colorado Springs, CO 80907
 msheaconsulting.com

OWNERSHIP OF INSTRUMENTS OF SERVICE
 All Drawings, Reports, Plans, Specifications, Computer Files (including CAD files), field information, notes, electronic, and other design materials prepared by the Engineer and his/her consultants as instruments of service shall remain the property of the Engineer. The Engineer shall retain all common law, statutory and other reserved rights, including the Copyright threat.



11/17/2017

SQUARE FOOTAGE
 Office Area 1,410 S.F.
 Kennel Area 1,693 S.F.
 Run Area 1,921 S.F.

DRAWN: DNB
 CHECKED: MRM
 DATE: 11/17/2017
 JOB NO: 17-136
 SHEET NO.

ES-1