

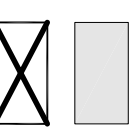



BUILDING NUMBER	LEGEND	QTY
1	HIGH ROPES CHALLENGE COURSE	1
2	SHED	5
3	OUTHOUSE	2
4	OLD HORSE BARN	1
5	CAMPERS CABIN	50
6	MAINTENANCE SHOPS	2
7	STAFF HOUSING	1
8	CARETAKER'S HOUSE	1
9	SHOWER HOUSE	2
10	BATHROOM	4
11	POLE BARN	1
12	LUGGAGE BARN	1
13	DINING HALL, MAIN OFFICE	1
14	OFFICE	1
15	STORAGE, WASH HOUSE	1
16	STONE MANOR	1
17	INFIRMARY	1
18	CAMP STORE	2
19	A-FRAME	1
20	BOAT HOUSE	1
21	PUMP HOUSE	1
22	THUNDER DOME	1
23	FUTURE CREW LODGE or CABINS	1-8
24	CREW TENTS	8
25	RIFLE RANGE	1
26	FUTURE BOAT HOUSE	1
27	FUTURE TRAIL, OUTITTER PAVILION	1
28	FUTURE SHOWER HOUSE	1
29	FUTURE WATERSLIDE PUMP HOUSE	1
30	FUTURE STAFF CABINS	1
31	FUTURE STAFF HOUSING	1
32	FUTURE AMPHITHEATER	1
33	DOCK	1

**LEGEND**

EXISTING BUILDING 

FUTURE BUILDING 

TRAIL 

UNPAVED ROAD 

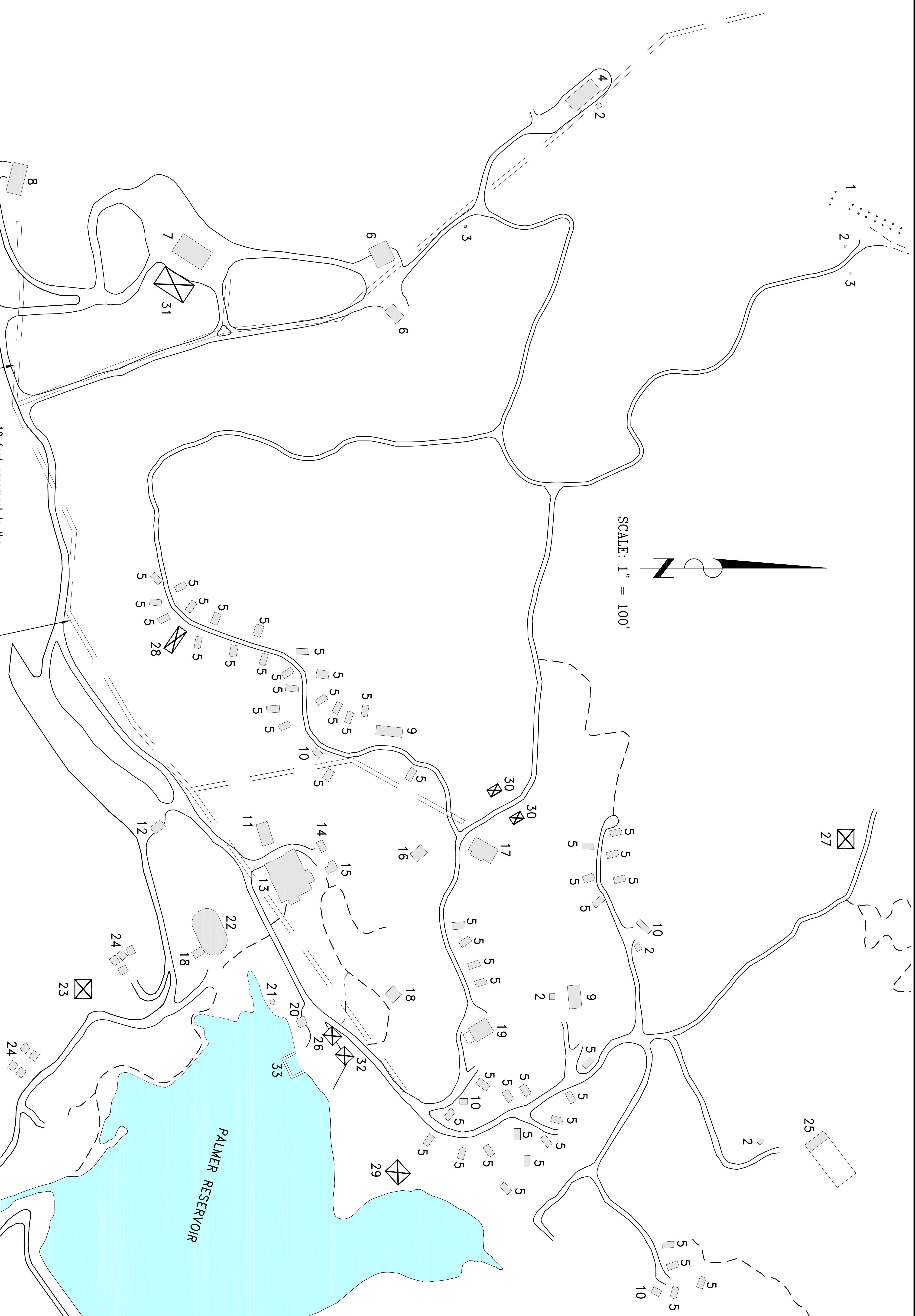

SCALE: 1" = 100'

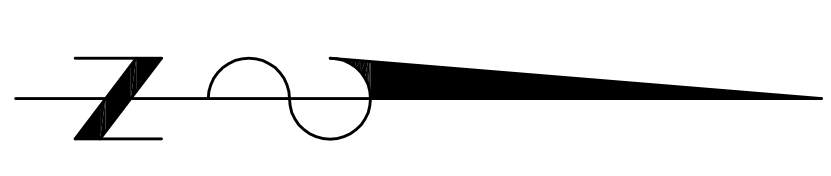

10 foot easement to the City of Colorado Springs for electric service lines. location approx.  
 Recorded: Oct. 2, 1992  
 Book 6051, page 45  
 Document No. 2206120

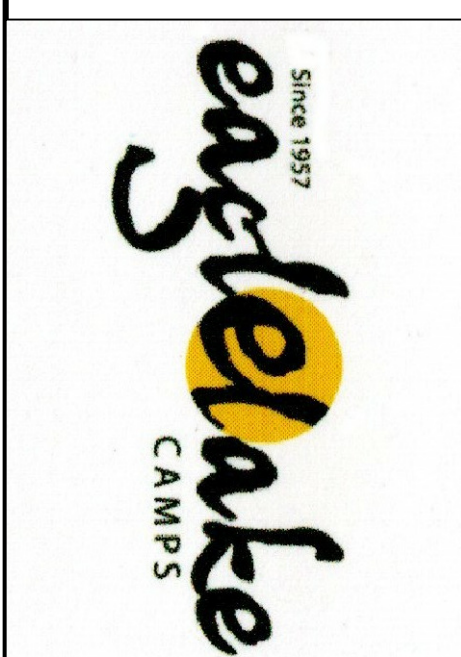

**EAGLE LAKE CAMP**  
 THE NAVIGATORS, COLORADO SPRINGS, COLORADO  
**SPECIAL USE PERMIT EXHIBIT**  
 DRWN: SEPT. 17, 2019  
 DRAWN BY: LJW  
 SHEET:  
 2 of 2