

**STORM WATER MANAGEMENT PLAN
(SWMP)**

**Liberty Tree Academy Phase 2
Project Number: PPR-20-018**

**ACCEPTED for FILE
Engineering Review**

04/06/2021 5:26:47 PM

dsdnijkamp

**EPC Planning & Community
Development Department**

April 2020
Revised June 2020

Prepared for:

Liberty Tree Academy
8579 Eastonville Road
Peyton, CO 80831

Prepared by:

Matrix Design Group, LLC
1601 Blake Street, Suite 200
Denver, CO 80202

Qualified Stormwater Manager

Name of Contact: _____
Company Name: _____
Mailing Address: _____
City, State, Zip Code: _____
Phone Number: _____ FAX Number: _____

Contractor

Name of Contact: _____
Company Name: _____
Mailing Address: _____
City, State, Zip Code: _____
Phone Number: _____ FAX Number: _____

TABLE OF CONTENTS

	<u>Page</u>
TABLE OF CONTENTS-----	2
3. SITE DESCRIPTION-----	3
4. NARRATIVE DESCRIPTION-----	3
5. PHASING PLAN-----	3
6. PROPOSED SEQUENCE -----	3
7. DISTURBANCE AREA -----	4
8. SOIL EROSION POTENTIAL -----	4
9. EXISTING VEGETATION-----	4
10. POTENTIAL POLLUTION, MATERIAL HANDLING, SPILL PREVENTION -----	5
11. MATERIAL HANDLING-----	7
12. SPILL PREVENTION -----	7
13. STORM WATER POLLUTION CONTROL -----	7
14. NON-STORM DISCHARGE-----	7
15. STORM WATER OUTFALL -----	7
16. SWAP MAP-----	7
17. BMP NARRATIVE (STRUCTURAL)-----	7
18. BMP NARRATIVE (NON-STRUCTURAL) -----	8
19. TECHNICAL DETAILS-----	8
20. SWMP REVISION PROCEDURE-----	8
21. FINAL STABILIZATION -----	8
22. VEGETATIVE COVERAGE -----	9
23. INSPECTION PROCEDURE-----	9
24. RECORD KEEPING-----	9
25. ENGINEER'S ESTIMATE FOR INSTALLATION AND MAINTENANCE OF GEC CONTROLS -----	10
APPENDIX A - SWMP CHECKLIST	
APPENDIX B - SWMP INTIAL AND FINAL STAGE PLANS	

3. SITE DESCRIPTION

The approximate latitude and longitude are 38°57'35"N and 104°35'11", which is in Township 12S, and Range 64W, Section 32, SW Quarter. The lot is situated along the east side of Eastonville Road from Motley Road to Snaffle Bit Road. The project area is located east, south, and north of residential parcels. Unplatted agricultural land exists to the east of the site. The project is situated in Woodmen Hills Filing No. 10 (Plat Number 10942). To the north is Woodmen Hills Filing No. 11 (Plat Number 11258).

4. NARRATIVE DESCRIPTION

The construction activity includes, clearing and grubbing and implementation temporary stabilization. Once the initial phase of the storm water management system is in place construction activities include, site grading, & curb gutter and asphalt pavement. Completion of the project will include final stabilization and removal of temporary control measures.

5. PHASING PLAN

The SWMP phasing is proposed to be in 2 phases, Initial Phase and Final Phase. BMP's in the initial phase are to remain until final stabilization is achieved.

6. PROPOSED SEQUENCE

It is anticipated that Liberty Tree Academy Phase 2 will be constructed during the Fall of 2020. The construction for the initial site grading is anticipated to take one month to complete. The final stabilization of the initial site grading is approximate and will likely occur during the spring of 2021.

Anticipated initial construction activities will include; installation of perimeter site erosion controls, clearing and grubbing, excavating and fill placement for the initial site grading plans. The site will be seeded and mulched once the initial site grading has been completed.

The suggested construction approach for erosion control measures:

1. Install construction fence, silt fence, sediment control logs and diversion ditch along the perimeter of the site area to be disturbed as shown on the GEC Plans as well as rock socks in the adjacent Eastonville Rd. These initial measures are to be installed before any construction disturbance starting around September 2020. If any BMP requires modification, the plan shall be red lined and approval shall be obtained from the County's GEC inspector prior to proceeding, unless it is an emergency situation that requires immediate attention. The contractor shall document all changes to the GEC Plans. The contractor shall not disturb any areas that are not identified on the GEC Plans without approval from the agency. Construction debris and trash shall be disposed of in appropriate trash containers. The contractor shall document reoccurring sediment and erosion control problem areas.
2. Once the perimeter erosion controls have been installed, the clearing and grubbing of the site as identified on the GEC Plans may commence. Topsoil to be reused shall be removed and stockpiled in the designated location on site per GEC plans. All soil stockpiles shall be at no slope greater than 3:1 and have perimeter control at all times. Locations must be redlined on the plans and approved by the agency GEC inspector. The stockpiles shall be located more than fifty feet from any drainage way or adjacent swale or ditch and shall have silt fence and or sediment control logs at the toes to prevent

sediment runoff from the stockpile. This phase will take approximately one month to complete starting in September 2020.

3. When the clearing and grubbing is complete, October 2020, the construction of the initial site grading plan may be conducted. This includes excavation and fill of material across the site as required. Additional or modification of existing erosion control facilities will be required. The Final Stage GEC Plans indicate the placement of new erosion control facilities according to the agency GEC criteria that will likely be required. BMP's needed in the final phase include seeding and mulching and inlet protection for the new inlets. The contractor shall be responsible for documenting changes, additions and reoccurring sediment and erosion control problem areas. The contractor shall document the above on the GEC Plans as needed. Timing for these measures should be as when the new inlets are constructed and as necessary when final grading is complete.
4. The initial site grading area can be completely seeded and mulched once the final grading has been completed, this should occur late winter 2021 or early spring 2021. All disturbed areas on the site shall be seeded and mulched according to the agency GEC Criteria.
5. Once approved by the agency, the erosion control measures installed in the Initial and Final Stages can be removed by the contractor. Any disturbance encountered while removal of said erosion control facilities will require the areas to be seeded and mulched. The final site grading stabilization shall be in accordance with the final GEC plans and Standard Notes. This should occur in the Spring of 2021

7. DISTURBANCE AREA

The total parcel area is 10.7 acres of which 3.4 have been developed and an additional 3.06 acres are proposed for this project. The remaining are may be developed at a future date under separate entitlement.

8. SOIL EROSION POTENTIAL

According to National Resources Conservation Service (NRCS) soil datasets, the predominant soil type is Columbine gravelly sandy loam, 0 to 3 percent slopes. This soil type is generally consistent with a Type A hydrologic soil group (HSG). NRCS soil data was obtained from the Soil Survey Geographic (SSURGO) Database for Arapahoe County, Colorado. The spatial dataset was last updated September 23, 2016 (version 7) and the tabular dataset was last updated October 10, 2017 (version 14). The erosion factor from the Web Soil Survey is rated at 0.17. The impacts of erosion should be minimal due to low the factor and the use of a diversion ditch to convey runoff to an existing detention pond where sediment can settle.

Slopes across the property typically range from 1-5%, with some local slopes along the eastern edge of the property at 4:1, which are associated with the drainage channel. There is also a drainage pond in the northeast corner of the site that has slopes at 4:1. Soil erosion is controlled by BMP and storm water discharge is similar to existing conditions.

9. EXISTING VEGETATION

The ground cover currently consists of native grasses, including Blue Grama with a few dispersed alders and other plant species consistent with pasture land in the Colorado Semi-arid plains environment. Willows line the drainageway on the east side of the site. The percent of ground cover is estimated at 85%. An aerial view was used to determine the estimate

10. POTENTIAL POLLUTION, MATERIAL HANDLING, SPILL PREVENTION

All disturbed and stored soils:

Potential during all phases of construction activities, including but not limited to excavating, grading, cutting, filling, landscaping, etc. Potential pollutants include disturbed eroded sediment entering state waterways, inlets and sewers.

BMPs

Sediment control and stockpile containment may include usage of: silt fence, temporary berms, temporary sediment basin, gravel bags, check dams, landforms, asphalt diversion berms, and inlet protection as outlined in the GEC Report.

Erosion Control may include: soil roughening, mulch/mulch tackifier application, seeding/mulching, temporary slope drains, and vegetative buffers.

Administrative BMPs include site management and limiting number and locations of stockpiles. Phased construction to reduce the amount of open area at any given time.

Vehicle tracking of sediments:

Potential during all construction activities.

BMPs

Sediment control including: vehicle tracking pads, street sweeping, and inlet protection.

Administrative BMPs include minimizing the number of entry and exit points, adding orange perimeter fence to define construction entries/exits and establish perimeter control, and require equipment to be cleaned prior to arrival on site.

Management of contaminated soils:

If contaminated soils/water are encountered, all activity shall be stopped until the situation can be assessed. The General Contractor or Superintendent will be contacted for further direction.

Loading and unloading operations:

Potential during delivery and staging of materials, equipment, soil, debris, etc.

BMPs

Loading and unloading operations shall occur within the disturbance limits of the project using designated vehicle tracking pads.

Administrative BMPs include site management to minimize the number of areas at which loading/unloading occurs. Education as to where access points are on the project to prevent vehicle tracking. After each loading and unloading operation, the immediate area should be checked for materials potentially spilled, leaked, or lost and cleaned up.

Outdoor storage activities (building materials, fertilizers, chemicals etc.):

Potential during all phases of construction activities including delivery, staging/storage and use of various materials.

BMPs

Containment of the storage or staging areas using temporary berms. Use of secondary containment device for storage of chemicals and petroleum products. Chemicals shall not be used, stored or stockpiled within 50 feet of state waters.

Administrative BMPs include site management to ensure limited amount of materials are stored on site and are placed in proper designated areas.

Vehicle and equipment maintenance and fueling:

Potential during all phases of construction activities during fueling of equipment or vehicles and equipment or vehicle repair activities.

BMPs

Limit areas where fueling occurs (no less than 50 feet from any state water, inlet, or flowline). Ensure Spill Response Kit is accessible where fueling is taking place. Use of plastic sheeting, drip pans, dirt berms and other measures to contain fluids.

Administrative BMPs include site management to limit equipment and vehicle maintenance that occurs on site.

Significant dust or particulate generating processes:

Potential during clearing and grubbing, cut/fill activities, saw cutting/sanding work, and final stabilization.

BMPs

Water truck for use as needed to minimize dust production, limiting speeds to 30 mph or less, minimizing exposed surfaces, using pickup broom or vacuum during or immediately following saw cutting, and revegetation with seed and mulch.

On-site waste management practices (waste piles, liquid wastes, dumpsters, etc.):

Potential during all phases of construction including clearing and grubbing, demolition, infrastructure construction, etc.

BMPs

Trash receptacles will be placed on site and garbage disposed of when full. Public trash will be routinely picked up around the site (daily) and disposed of in proper containers. Waste piles shall be placed a minimum of 50 feet from state waters contained by earthen berms, silt fence, erosion control logs, and/or landforms. Waste piles shall be placed in areas where stormwater runoff would not result in contamination of state waters.

Liquid wastes will be contained and removed from site and properly disposed of by the contractor/sub-contractor generating wastes.

Concrete truck/equipment washing:

Potential during and after concrete pours.

BMPs

Concrete washout areas will be provided on site prior to any concrete improvements. The BMP will be clearly marked and maintained in accordance with the standard BMP detail contained in the GESC Plan.

Dedicated asphalt and concrete batch plants:

Not applicable. There will not be a dedicated batch plant on site.

Non-industrial waste sources such as worker trash and portable toilets:

Potential during all phases of construction.

BMPs

Cleanup of trash will occur daily. A dumpster will be placed on site at the construction trailer. This will be emptied on a weekly basis and more often if waste amounts warrant extra pick-ups.

Portable toilets will be located a minimum of 50 feet from state waters. They shall be adequately staked and cleaned on a weekly basis. They will be inspected daily for spills.

Administrative BMPs will include site management practices to ensure workers are placing trash in the appropriate dumpsters. Monitoring to ensure trash dumpsters are removed from the site when full. Monitoring to ensure portable toilets are cleaned as needed and repaired or removed if found to be leaking.

11. MATERIAL HANDLING

See previous section Potential pollution, Material Handling, Spill Prevention.

12. SPILL PREVENTION

See previous section Potential pollution, Material Handling, Spill Prevention.

13. STORM WATER POLLUTION CONTROL

See previous section Potential pollution, Material Handling, Spill Prevention.

14. NON-STORM DISCHARGE

There are no existing spring or irrigation located on site. Non-stormwater discharge is not anticipated.

15. STORM WATER OUTFALL

The project falls within the Bennett Ranch Drainage Basin and the major basin is presented and discussed in the Bennett Ranch Drainage Basin Planning Study (El Paso County 2001). No streams cross the project area.

16. SWAP MAP

See appendix B.

17. BMP NARRATIVE (STRUCTURAL)

The listed items below are proposed for this project.

Construction Fence will be used to delineate the limits of construction.

Vehicle Tracking Control will be installed at all construction entrances. Stabilized construction site access must be created for any sites where mud or dirt can be tracked onto public roads, where dust can be problematic during dry weather and on site adjacent to water bodies. The purpose is to reduce or eliminate sediment being tracked onto public roadways by construction vehicles.

Stabilized Staging Area will be provided near the main access point and should connect to the vehicle tracking control. The Stabilized Staging Area should be the location used for chemical storage.

Reinforced Rock Berm for Culvert Protection will be installed upstream of existing and proposed culverts. A reinforced rock berm placed in front of a culvert can reduce sediment in the runoff approaching the culvert.

Erosion Control Blanket will be provided on all slopes steeper than 4:1 and within roadside ditches. Erosion control blanket is a Fibrous blanket of straw, jute, coconut or excelsior material trenched in and staked down over prepared, seeded soil. The blanket reduces both wind and water erosion and helps to establish vegetation.

Surface Roughening shall be provided on all disturbed areas. Surface roughening consists of creating a series of grooves or furrows on the contour in all disturbed, graded areas to trap rainfall and reduce the formation of rill and gully erosion.

Concrete Washout Area must be installed and maintained before any concrete is placed on site. Concrete washout activities must be conducted in a manner that does not contribute pollutants to surface waters or stormwater runoff. The area shall be bermed to totally contain wash water. Water is allowed to infiltrate in the ground or evaporate and the dried concrete waste shall be properly disposed.

Stockpile Management will be provided for all stockpiles. Stockpiles will be located on site as indicated on the GESC Plan; however, exact locations may be adjusted based on current conditions and construction phasing.

Street Sweeping will be provided for paved and impervious surfaces which are adjacent to construction site. Either sweeping by hand or use of Street Sweepers is acceptable. Street sweepers using water while sweeping is preferred in order to minimize dust. Streets shall not be washed with water under any circumstances.

18. BMP NARRATIVE (NON-STRUCTURAL)

Seeding and Mulching shall be provided on all areas that are not to be paved, sodded, landscaped or otherwise stabilized in an approved manner in accordance with Section 3.8 of the GESC Manual. Seeding and mulching consists of drill seeding disturbed areas with grasses and crimping in straw mulch to provide immediate protection against raindrop and wind erosion and, as the grass cover becomes established, to provide long-term stabilization of exposed soils.

19. TECHNICAL DETAILS

See SWMP Plan in Appendix B.

20. SWMP REVISION PROCEDURE

SWMP changes addressing BMP installation and/or implementation are often required to be made in response to changing conditions, or when current BMPs are determined ineffective. The majority of SWMP revisions to address these changes can be made immediately with quick in-the-field revisions to the SWMP. In the less common scenario where more complex development of materials to modify the SWMP is necessary, SWMP revisions shall be made in accordance with the following requirements:

- 1) the SWMP shall be revised as soon as practicable, but in no case more than 72 hours after the change(s) in BMP installation and/or implementation occur at the site, and
- 2) a notation must be included in the SWMP prior to the site change(s) that includes the time and date of the change(s) in the field, an identification of the BMP(s) removed or added, and the location(s) of those BMP(s).

21. FINAL STABILIZATION

After the site grading construction is completed, the provided erosion control facilities identified on the SWMP Plans should effectively stabilize the site and provide permanent stabilization. There is an existing detention pond on site that will help maintain water quality for the new addition to Liberty Tree Academy. Criteria requires that the areas be drill seeded or crimp mulched. Stabilization needs to occur within 30 days from the start of land disturbance activities or within seven days of the substantial completion of grading, whichever comes first. Once the site grading is complete and the Final Stage SWMP Plans have been constructed, previously installed erosion control measures may be removed, but must be approved by the agency. The site is owned and maintained by Liberty Tree Academy and does not rely on control measures owned or operated by another entity.

22. VEGETATIVE COVERAGE

Vegetative coverage is based on the development final landscaped area and the final stabilization plan in the SWMP. Final vegetative cover needs to meet at a minimum 70% density of pre-disturbed levels.

23. INSPECTION PROCEDURE

The qualified stormwater manager, as well as representatives from governing agencies, shall make routine checks of all control measures. The qualified stormwater manager from the General Contractor's staff shall inspect BMPs regularly, not exceeding 7 days and within 24 hours after storm or a snowmelt event that causes erosion. When and where exceptions to the inspection schedule are necessary due to holidays, weather, or other unforeseen incidents, exceptions to the schedule will be documented. Inspections will also be conducted after each storm event. These signed inspections shall be kept on-site in a written or previously approved format and conducted during the progress of the work.

24. RECORD KEEPING

See Inspection Procedures above.

25. ENGINEER'S ESTIMATE FOR INSTALLATION AND MAINTENANCE OF GEC CONTROLS

Liberty Tree Academy Phase 2
GEC Permit - Financial Assurance Estimate
Project # PPR2018

BMP NO.	BMP	ID	Unit	Installation Unit Cost	Quantity	Cost
1	Check Dam	CD	LF	\$ 24.00	0	\$ -
2	Compost Blanket	CB	SF	\$ 0.36	0	\$ -
3	Compost Filter Berm	CFB	LF	\$ 2.00	0	\$ -
4	Concrete Washout Area	CWA	EA	\$ 100.00	1	\$ 100.00
5	Construction Fence	CF	LF	\$ 2.00	0	\$ -
6	Construction Markers	CM	LF	\$ 0.20	0	\$ -
7	Dewatering	DW	EA	\$ 600.00	0	\$ -
8	Diversion Ditch	DD	LF	\$ 1.60	370	\$ 592.00
9	Erosion Control Blanket	ECB	SY	\$ 5.00	0	\$ -
10	Inlet Protection	IP	LF	\$ 20.00	0	\$ -
11	Reinforced Check Dam	RCD	LF	\$ 36.00	0	\$ -
12	Reinforced Rock Berm	RRB	LF	\$ 9.00	0	\$ -
13	RRB for Culvert Protection	RRC	LF	\$ 9.00	10	\$ 90.00
14	Sediment Basin	SB	AC	\$ 1,100.00	0	\$ -
15	Sediment Control Log	SCL	LF	\$ 2.00	580	\$ 1,160.00
16	Sediment Trap	ST	EA	\$ 600.00	0	\$ -
17	Seeding and Mulching	SM	AC	\$ 2,500.00	0.95	\$ 2,375.00
18	Silt Fence	SF	LF	\$ 2.00	1480	\$ 2,960.00
19	Stabilized Staging Area	SSA	SY	\$ 2.00	400	\$ 800.00
20	Surface Roughening	SR	AC	\$ 600.00	0.95	\$ 570.00
21	Temporary Slope Drain	TSD	LF	\$ 30.00	30	\$ 900.00
22	Temporary Stream Crossing	TSC	EA	\$ 1,000.00	0	\$ -
23	Terracing	TER		N/A	0	\$ -
24	Vehicle Tracking Control	VTC	EA	\$ 1,000.00	1	\$ 1,000.00
25	VTC with Wheel Wash	WW		N/A	0	\$ -

Total BMP Cost	\$ 10,547.00
10% Contingency	\$ 1,054.70
Total Cost	\$ 11,601.70

APPENDIX A
SWMP CHECK LIST



2880 International Circle, Suite 110
 Colorado Springs, CO 80910
 Phone 719-520-6300
 Fax 719-520-6695
 www.elpasoco.com

EL PASO COUNTY PLANNING AND COMMUNITY DEVELOPMENT DEPARTMENT

STORMWATER MANAGEMENT PLAN CHECKLIST

Revised: July 2019

		Applicant	PCD
1. STORMWATER MANAGEMENT PLAN (SWMP)			
1	Applicant (owner/designated operator), SWMP Preparer, Qualified Stormwater Manager, and Contractor Information. (On cover/title sheet)	X	
2	Table of Contents	X	
3	Site description and location to include: vicinity map with nearest street/crossroads description.	X	
4	Narrative description of construction activities proposed (e.g., may include clearing and grubbing, temporary stabilization, road grading, utility / storm installation, final grading, final stabilization, and removal of temporary control measures)	X	
5	Phasing plan – may require separate drawings indicating initial, interim, and final site phases for larger projects. Provide “living maps” that can be revised in the field as conditions dictate.	X	
6	Proposed sequence for major activities: Provide a construction schedule of anticipated starting and completion dates for each stage of land-disturbing activity depicting conservation measures anticipated, including the expected date on which the final stabilization will be completed.	X	
7	Estimates of the total site area and area to undergo disturbance; current area of disturbance must be updated on the SWMP as changes occur.	X	
8	Soil erosion potential and impacts on discharge that includes a summary of the data used to determine soil erosion potential	X	
9	A description of existing vegetation at the site and percent ground cover and method used to determine ground cover	X	
10	Location and description of all potential pollution sources including but not limited to: disturbed and stored soils; vehicle tracking; management of contaminated soils; loading and unloading operations; outdoor storage of materials; vehicle and equipment maintenance and fueling; significant dust generating process; routine maintenance activities involving fertilizers, pesticides, herbicides, detergents, fuels, solvents, oils, etc.; on-site waste management; concrete truck/equipment washing; dedicated asphalt, concrete batch plants and masonry mixing stations; non-industrial waste such as trash and portable toilets	X	
11	Material handling to include spill prevention and response plan and procedures.	X	
12	Spill prevention and pollution controls for dedicated batch plants	X	
13	Other SW pollutant control measures to include waste disposal and off site soil tracking	X	
14	Location and description of any anticipated allowable non-stormwater discharge (ground water, springs, irrigation, discharge covered by CDPHE Low Risk Guidance, etc.)	X	
15	Name(s) of ultimate receiving waters; size, type and location of stormwater outfall or storm sewer system discharge	X	
16	Description of all stream crossings located within the project area or statement that no streams cross the project area	X	
17	SWMP Map to include:	X	
17a	construction site boundaries	X	
17b	flow arrows to depict stormwater flow directions	X	
17c	all areas of disturbance	X	
17d	areas of cut and fill	X	
17e	areas used for storage of building materials, soils (stockpiles) or wastes	X	
17f	location of any dedicated asphalt / concrete batch plants	X	



2880 International Circle, Suite 110
 Colorado Springs, CO 80910
 Phone 719-520-6300
 Fax 719-520-6695
 www.elpasoco.com

EL PASO COUNTY PLANNING AND COMMUNITY DEVELOPMENT DEPARTMENT

STORMWATER MANAGEMENT PLAN CHECKLIST

Revised: July 2019

		Applicant	PCD
17g	location of all structural control measures		
17h	location of all non-structural control measures	X	
17i	springs, streams, wetlands and other surface waters, including areas that require maintenance of pre-existing vegetation within 50 feet of a receiving water	X	
18	Narrative description of all structural control measures to be used. Modifications to EPC standard control measures must meet or exceed County-approved details.	X	
19	Description of all non-structural control measures to be used including seeding, mulching, protection of existing vegetation, site watering, sod placement, etc.	X	
20	Technical drawing details for all control measure installation and maintenance; custom or other jurisdiction's details used must meet or exceed EPC standards	X	
21	Procedure describing how the SWMP is to be revised	X	
22	Description of Final Stabilization and Long-term Stormwater Quality (describe nonstructural and structural measures to control SW pollutants after construction operations have been completed, including detention, water quality control measure etc.)	X	
23	Specification that final vegetative cover density is to be 70% of pre-disturbed levels	X	
24	Outline of permit holder inspection procedures to install, maintain, and effectively operate control measures to manage erosion and sediment	X	
25	Record keeping procedures identified to include signature on inspection logs and location of SWMP records on-site	X	
26	If this project relies on control measures owned or operated by another entity, a documented agreement must be included in the SWMP that identifies location, installation and design specifications, and maintenance requirements and responsibility of the control measure(s).	NA	
	Please note: all items above must be addressed. If not applicable, explain why, simply identifying "not applicable" will not satisfy CDPHE requirement of explanation.		
2. ADDITIONAL REPORTS/PERMITS/DOCUMENTS			
a	Grading and Erosion Control Plan (signed)	X	
b	Erosion and Stormwater Quality Control Permit (ESQCP) (signed)	X	
3. Applicant Comments:			
a	No dedicated batch plant is being use.		
b	No control measures are being owned or operated by another entity		
c			
4. Checklist Review Certifications:			



2880 International Circle, Suite 110
Colorado Springs, CO 80910
Phone 719-520-6300
Fax 719-520-6695
www.elpasoco.com

**EL PASO COUNTY PLANNING AND
COMMUNITY DEVELOPMENT
DEPARTMENT**

STORMWATER MANAGEMENT PLAN CHECKLIST

Revised: July 2019

		Applicant	PCD
a	<p>Engineer of Record: The Stormwater Management Plan was prepared under my direction and supervision and is correct to the best of my knowledge and belief. Said Plan has been prepared according to the criteria established by the County and State for Stormwater Management Plans.</p> <p> 12/11/2020</p> <p>Engineer of Record Signature Date</p>	X	
b	<p>Review Engineer: The Stormwater Management Plan was reviewed and found to meet the checklist requirements except where otherwise noted or allowed by an approved deviation request.</p> <p>Review Engineer Date</p>	X	



2880 International Circle, Suite 110
 Colorado Springs, CO 80910
 Phone 719-520-6300
 Fax 719-520-6695
 www.elpasoco.com

EL PASO COUNTY PLANNING AND COMMUNITY DEVELOPMENT DEPARTMENT

GRADING AND EROSION CONTROL PLAN CHECKLIST

Revised: July 2019

		Applicant	PCD
1. GRADING AND EROSION CONTROL PLAN			
a	Vicinity map.	X	
b	Adjacent city/town/jurisdictional boundaries, subdivision names, and property parcel numbers labeled.	X	
c	North arrow and acceptable scale (1"=20' to 1"=100').	X	
d	Legend for all symbols used in the plan.	X	
e	Existing and proposed property lines. Proposed subdivision boundary for subdivision projects.	X	
f	All existing structures.	X	
g	All existing utilities.	X	
h	Construction site boundaries.	X	
i	Existing vegetation (notes are acceptable in cases where there is no notable vegetation, only grasses/weeds, or site has already been stripped).	X	
j	FEMA 100-yr floodplain.	X	
k	Existing and proposed water courses including springs, streams, wetlands, detention ponds, stormwater quality structures, roadside ditches, irrigation ditches and other water surfaces. Show maintenance of pre-existing vegetation within 50 feet of a receiving water.	X	
l	Existing and proposed contours 2 feet or less (except for hillside).	X	
m	Limits of disturbance delineating all anticipated areas of soil disturbance.	X	
n	Identify and protect areas outside of the construction site boundary with existing fencing, construction fencing or other methods as appropriate.	X	
o	Offsite grading clearly shown and called out.	X	
p	Areas of cut and fill identified.	X	
q	Conclusions from soils/geotechnical report and geologic hazards report incorporated in grading design (slopes, embankments, materials, mitigation, etc.)	X	
r	Proposed slopes steeper than 3:1 with top and toe of slope delineated. Erosion control blanketing or other protective covering required.	X	
s	Stormwater flow direction arrows.	X	
t	Location of any dedicated asphalt / concrete batch plants.	X	
u	Areas used for staging, storage of building materials, soils (stockpiles) or wastes. The use of construction office trailers requires PCD permitting.	X	
v	All proposed temporary construction control measures, structural and non-structural. Temporary construction control measures shall be identified by phase of implementation to include "initial," "interim," and "final" or shown on separate phased maps identifying each phase.	X	
w	Vehicle tracking provided at all construction entrances/exits. Construction fencing, barricades, and/or signage provided at access points not to be used for construction.	X	
x	Temporary sediment ponds provided for disturbed drainage areas greater than 1 acre.	X	
y	Dewatering operations to include locations of diversion, pump and discharge(s) as anticipated at time of design.	X	
z	All proposed temporary construction control measure details. Custom or other jurisdiction's details used must meet or exceed EPC standards.	X	

2880 International Circle, Suite 110
Colorado Springs, CO 80910
Phone 719-520-6300
Fax 719-520-6695
www.elpasoco.com

**EL PASO COUNTY PLANNING AND
COMMUNITY DEVELOPMENT
DEPARTMENT**

GRADING AND EROSION CONTROL PLAN CHECKLIST

Revised: July 2019

		Applicant	PCD
aa	Any offsite stormwater control measure proposed for use by the project and not under the direct control or ownership of the Owner or Operator.	X	
bb	Existing and proposed permanent storm water management facilities, including areas proposed for stormwater infiltration or subsurface detention.	X	
cc	Existing and proposed easements (permanent and construction) including required off site easements.	X	
dd	Retaining walls (not to be located in County ROW unless approved via license agreement). Design by P.E. and building permit from Regional Building Department required for walls greater than or equal to 4 feet in height, series of walls, or walls supporting a surcharge.	X	
ee	Plan certified by a Colorado Registered P.E., with EPC standard signature blocks for Engineer, Owner and EPC.	X	
ff	Engineer's Statement (for standalone GEC Plan): This Grading and Erosion Control Plan was prepared under my direction and supervision and is correct to the best of my knowledge and belief. Said Plan has been prepared according to the criteria established by the County for Grading and Erosion Control Plans. I accept responsibility for any liability caused by any negligent acts, errors or omissions on my part in preparing this plan. <u>N/A</u> _____ Engineer of Record Signature Date	X	
gg	Engineer's Statement (for GEC Plan within Construction Drawing set): These detailed plans and specifications were prepared under my direction and supervision. Said plans and specifications have been prepared according to the criteria established by the County for detailed roadway, drainage, grading and erosion control plans and specifications, and said plans and specifications are in conformity with applicable master drainage plans and master transportation plans. Said plans and specifications meet the purposes for which the particular roadway and drainage facilities are designed and are correct to the best of my knowledge and belief. I accept responsibility for any liability caused by any negligent acts, errors or omissions on my part in preparation of these detailed plans and specifications. _____ Engineer of Record Signature  _____ Date 12/11/2020	X	
hh	Owner's Statement (for standalone GEC Plan): I, the owner/developer have read and will comply with the requirements of the Grading and Erosion Control Plan. <u>N/A</u> _____ Owner Signature Date	X	
ii	Owner's Statement (for GEC Plan within Construction Drawing set): I, the owner/developer have read and will comply with the requirements of the grading and erosion control plan and all of the requirements specified in these detailed plans and specifications. _____ Owner Signature Date	X	



2880 International Circle, Suite 110
 Colorado Springs, CO 80910
 Phone 719-520-6300
 Fax 719-520-6695
 www.elpasoco.com

EL PASO COUNTY PLANNING AND COMMUNITY DEVELOPMENT DEPARTMENT

GRADING AND EROSION CONTROL PLAN CHECKLIST

Revised: July 2019

	Applicant	PCD
<p>El Paso County (standalone GEC Plan): County plan review is provided only for general conformance with County Design Criteria. The County is not responsible for the accuracy and adequacy of the design, dimensions, and/ or elevations which shall be confirmed at the job site. The County through the approval of this document assumes no responsibility for completeness and/ or accuracy of this document. Filed in accordance with the requirements of the El Paso County Land Development Code, Drainage Criteria Manual Volumes 1 and 2, and Engineering Criteria Manual, as amended.</p> <p>jj In accordance with ECM Section 1.12, these construction documents will be valid for construction for a period of 2 years from the date signed by the El Paso County Engineer. If construction has not started within those 2 years, the plans will need to be resubmitted for approval, including payment of review fees at the Planning and Community Development Director's discretion.</p> <p>_____ County Project Engineer Signature Date</p>	X	

2. ADDITIONAL REPORTS/PERMITS/DOCUMENTS

a	Soils report / geotechnical investigation as appropriate for grading/utilities/drainage/road construction.		
b	Use Agreement/easement between the Owner or Operator and other third party for use of all offsite grading or stormwater control measures, used by the owner or operator but not under their direct control or ownership.		
c	Floodplain Development Permit		
d	USACE 404/wetlands permit/mitigation plan		
e	FEMA CLOMR		
f	State Engineer's permit/Notice Of Intent to Construct		
g	Stormwater Management Plan (SWMP)		
h	Financial Assurance Estimate (FAE) (signed)		
i	Erosion and Stormwater Quality Control Permit (ESQCP) (signed)		
j	Pre-Development Site Grading Acknowledgement and Right of Access Form (signed)		
k	Conditions of Approval met?		

3. STANDARD NOTES FOR EL PASO COUNTY GRADING AND EROSION CONTROL PLANS

1	Stormwater discharges from construction sites shall not cause or threaten to cause pollution, contamination, or degradation of State Waters. All work and earth disturbance shall be done in a manner that minimizes pollution of any on-site or off-site waters, including wetlands.	X	
2	Notwithstanding anything depicted in these plans in words or graphic representation, all design and construction related to roads, storm drainage and erosion control shall conform to the standards and requirements of the most recent version of the relevant adopted El Paso County standards, including the Land Development Code, the Engineering Criteria Manual, the Drainage Criteria Manual, and the Drainage Criteria Manual Volume 2. Any deviations from regulations and standards must be requested, and approved, in writing.	X	



2880 International Circle, Suite 110
 Colorado Springs, CO 80910
 Phone 719-520-6300
 Fax 719-520-6695
 www.elpasoco.com

EL PASO COUNTY PLANNING AND COMMUNITY DEVELOPMENT DEPARTMENT

GRADING AND EROSION CONTROL PLAN CHECKLIST

Revised: July 2019

		Applicant	PCD
3	A separate Stormwater Management Plan (SMWP) for this project shall be completed and an Erosion and Stormwater Quality Control Permit (ESQCP) issued prior to commencing construction. Management of the SWMP during construction is the responsibility of the designated Qualified Stormwater Manager or Certified Erosion Control Inspector. The SWMP shall be located on site at all times during construction and shall be kept up to date with work progress and changes in the field.	X	
4	Once the ESQCP is approved and a "Notice to Proceed" has been issued, the contractor may install the initial stage erosion and sediment control measures as indicated on the approved GEC. A Preconstruction Meeting between the contractor, engineer, and El Paso County will be held prior to any construction. It is the responsibility of the applicant to coordinate the meeting time and place with County staff.	X	
5	Control measures must be installed prior to commencement of activities that could contribute pollutants to stormwater. control measures for all slopes, channels, ditches, and disturbed land areas shall be installed immediately upon completion of the disturbance.	X	
6	All temporary sediment and erosion control measures shall be maintained and remain in effective operating condition until permanent soil erosion control measures are implemented and final stabilization is established. All persons engaged in land disturbance activities shall assess the adequacy of control measures at the site and identify if changes to those control measures are needed to ensure the continued effective performance of the control measures. All changes to temporary sediment and erosion control measures must be incorporated into the Stormwater Management Plan.	X	
7	Temporary stabilization shall be implemented on disturbed areas and stockpiles where ground disturbing construction activity has permanently ceased or temporarily ceased for longer than 14 days.	X	
8	Final stabilization must be implemented at all applicable construction sites. Final stabilization is achieved when all ground disturbing activities are complete and all disturbed areas either have a uniform vegetative cover with individual plant density of 70 percent of pre-disturbance levels established or equivalent permanent alternative stabilization method is implemented. All temporary sediment and erosion control measures shall be removed upon final stabilization and before permit closure.	X	
9	All permanent stormwater management facilities shall be installed as designed in the approved plans. Any proposed changes that effect the design or function of permanent stormwater management structures must be approved by the ECM Administrator prior to implementation.	X	
10	Earth disturbances shall be conducted in such a manner so as to effectively minimize accelerated soil erosion and resulting sedimentation. All disturbances shall be designed, constructed, and completed so that the exposed area of any disturbed land shall be limited to the shortest practical period of time. Pre-existing vegetation shall be protected and maintained within 50 horizontal feet of a waters of the state unless shown to be infeasible and specifically requested and approved.	X	
11	Compaction of soil must be prevented in areas designated for infiltration control measures or where final stabilization will be achieved by vegetative cover. Areas designated for infiltration control measures shall also be protected from sedimentation during construction until final stabilization is achieved. If compaction prevention is not feasible due to site constraints, all areas designated for infiltration and vegetation control measures must be loosened prior to installation of the control measure(s).	X	
12	Any temporary or permanent facility designed and constructed for the conveyance of stormwater around, through, or from the earth disturbance area shall be a stabilized conveyance designed to minimize erosion and the discharge of sediment off site.	X	



2880 International Circle, Suite 110
 Colorado Springs, CO 80910
 Phone 719-520-6300
 Fax 719-520-6695
 www.elpasoco.com

EL PASO COUNTY PLANNING AND COMMUNITY DEVELOPMENT DEPARTMENT

GRADING AND EROSION CONTROL PLAN CHECKLIST

Revised: July 2019

		Applicant	PCD
13	Concrete wash water shall be contained and disposed of in accordance with the SWMP. No wash water shall be discharged to or allowed to enter State Waters, including any surface or subsurface storm drainage system or facilities. Concrete washouts shall not be located in an area where shallow groundwater may be present, or within 50 feet of a surface water body, creek or stream.	X	
14	During dewatering operations of uncontaminated ground water may be discharged on site, but shall not leave the site in the form of surface runoff unless an approved State dewatering permit is in place.	X	
15	Erosion control blanketing or other protective covering shall be used on slopes steeper than 3:1.	X	
16	Contractor shall be responsible for the removal of all wastes from the construction site for disposal in accordance with local and State regulatory requirements. No construction debris, tree slash, building material wastes or unused building materials shall be buried, dumped, or discharged at the site.	X	
17	Waste materials shall not be temporarily placed or stored in the street, alley, or other public way, unless in accordance with an approved Traffic Control Plan. control measures may be required by El Paso County Engineering if deemed necessary, based on specific conditions and circumstances.	X	
18	Tracking of soils and construction debris off-site shall be minimized. Materials tracked off-site shall be cleaned up and properly disposed of immediately.	X	
19	The owner/developer shall be responsible for the removal of all construction debris, dirt, trash, rock, sediment, soil, and sand that may accumulate in roads, storm drains and other drainage conveyance systems and stormwater appurtenances as a result of site development.	X	
20	The quantity of materials stored on the project site shall be limited, as much as practical, to that quantity required to perform the work in an orderly sequence. All materials stored on-site shall be stored in a neat, orderly manner, in their original containers, with original manufacturer's labels.	X	
21	No chemical(s) having the potential to be released in stormwater are to be stored or used onsite unless permission for the use of such chemical(s) is granted in writing by the ECM Administrator. In granting approval for the use of such chemical(s), special conditions and monitoring may be required.	X	
22	Bulk storage of allowed petroleum products or other allowed liquid chemicals in excess of 55 gallons shall require adequate secondary containment protection to contain all spills onsite and to prevent any spilled materials from entering State Waters, any surface or subsurface storm drainage system or other facilities.	X	
23	No person shall cause the impediment of stormwater flow in the curb and gutter or ditch except with approved sediment control measures.		
24	Owner/developer and their agents shall comply with the "Colorado Water Quality Control Act" (Title 25, Article 8, CRS), and the "Clean Water Act" (33 USC 1344), in addition to the requirements of the Land Development Code, DCM Volume II and the ECM Appendix I. All appropriate permits must be obtained by the contractor prior to construction (1041, NPDES, Floodplain, 404, fugitive dust, etc.). In the event of conflicts between these requirements and other laws, rules, or regulations of other Federal, State, local, or County agencies, the most restrictive laws, rules, or regulations shall apply.	X	
25	All construction traffic must enter/exit the site only at approved construction access points.	X	
26	Prior to construction the permittee shall verify the location of existing utilities.	X	
27	A water source shall be available on site during earthwork operations and shall be utilized as required to minimize dust from earthwork equipment and wind.	X	



2880 International Circle, Suite 110
Colorado Springs, CO 80910
Phone 719-520-6300
Fax 719-520-6695
www.elpasoco.com

**EL PASO COUNTY PLANNING AND
COMMUNITY DEVELOPMENT
DEPARTMENT**

GRADING AND EROSION CONTROL PLAN CHECKLIST

Revised: July 2019

		Applicant	PCD
28	The soils report for this site has been prepared by _____ and shall be considered a part of these plans.	X	
29	At least ten (10) days prior to the anticipated start of construction, for projects that will disturb one (1) acre or more, the owner or operator of construction activity shall submit a permit application for stormwater discharge to the Colorado Department of Public Health and Environment, Water Quality Division. The application contains certification of completion of a stormwater management plan (SWMP), of which this Grading and Erosion Control Plan may be a part. For information or application materials contact: Colorado Department of Public Health and Environment Water Quality Control Division WQCD – Permits 4300 Cherry Creek Drive South Denver, CO 80246-1530 Attn: Permits Unit	X	
4. Applicant Comments:			
a			
b			
c			
5. Checklist Review Certifications:			
a	Engineer of Record: The Grading and Erosion Control Plan was prepared under my direction and supervision and is complete and correct to the best of my knowledge and belief. Said Plan has been prepared according to the criteria established by the County for Grading and Erosion Control Plans.  _____ Engineer of Record Signature 12/11/2020 _____ Date	X	

2880 International Circle, Suite 110
Colorado Springs, CO 80910
Phone 719-520-6300
Fax 719-520-6695
www.elpasoco.com

**EL PASO COUNTY PLANNING AND
COMMUNITY DEVELOPMENT
DEPARTMENT**

GRADING AND EROSION CONTROL PLAN CHECKLIST

Revised: July 2019

Revised: July 2019		Applicant	PCD
b	<p>Review Engineer:</p> <p>The Grading and Erosion Control Plan was reviewed and found to meet the checklist requirements except where otherwise noted or allowed by an approved deviation request.</p>	X	
	<p>Review Engineer _____ Date _____</p>		

APPENDIX B
SWMP



STANDARD NOTES FOR EL PASO COUNTY GRADING AND EROSION CONTROL PLANS:

1. STORMWATER DISCHARGES FROM CONSTRUCTION SITES SHALL NOT CAUSE OR THREATEN TO CAUSE POLLUTION, CONTAMINATION, OR DEGRADATION OF STATE WATERS. ALL WORK AND EARTH DISTURBANCE SHALL BE DONE IN A MANNER THAT MINIMIZES POLLUTION OF ANY ON-SITE OR OFF-SITE WATERS, INCLUDING WETLANDS.

2. NOTWITHSTANDING ANYTHING DEPICTED IN THESE PLANS IN WORDS OR GRAPHIC REPRESENTATION, ALL DESIGN AND CONSTRUCTION RELATED TO ROADS, STORM DRAINAGE AND EROSION CONTROL SHALL CONFORM TO THE STANDARDS AND REQUIREMENTS OF THE MOST RECENT VERSION OF THE RELEVANT ADOPTED EL PASO COUNTY STANDARDS, INCLUDING THE LAND DEVELOPMENT CODE, THE ENGINEERING CRITERIA MANUAL, THE DRAINAGE CRITERIA MANUAL, AND THE DRAINAGE CRITERIA MANUAL VOLUME 2. ANY DEVIATIONS FROM REGULATIONS AND STANDARDS MUST BE REQUESTED, AND APPROVED, IN WRITING.

3. A SEPARATE STORMWATER MANAGEMENT PLAN (SMWP) FOR THIS PROJECT SHALL BE COMPLETED AND AN EROSION AND STORMWATER QUALITY CONTROL PERMIT (ESQCP) ISSUED PRIOR TO COMMENCING CONSTRUCTION. MANAGEMENT OF THE SWMP DURING CONSTRUCTION IS THE RESPONSIBILITY OF THE DESIGNATED QUALIFIED STORMWATER MANAGER OR CERTIFIED EROSION CONTROL INSPECTOR. THE SWMP SHALL BE LOCATED ON SITE AT ALL TIMES DURING CONSTRUCTION AND SHALL BE KEPT UP TO DATE WITH WORK PROGRESS AND CHANGES IN THE FIELD.

4. ONCE THE ESQCP IS APPROVED AND A "NOTICE TO PROCEED" HAS BEEN ISSUED, THE CONTRACTOR MAY INSTALL THE INITIAL STAGE EROSION AND SEDIMENT CONTROL MEASURES AS INDICATED ON THE APPROVED GEC. A PRECONSTRUCTION MEETING BETWEEN THE CONTRACTOR, ENGINEER, AND EL PASO COUNTY WILL BE HELD PRIOR TO ANY CONSTRUCTION. IT IS THE RESPONSIBILITY OF THE APPLICANT TO COORDINATE THE MEETING TIME AND PLACE WITH COUNTY STAFF.

5. CONTROL MEASURES MUST BE INSTALLED PRIOR TO COMMENCEMENT OF ACTIVITIES THAT COULD CONTRIBUTE POLLUTANTS TO STORMWATER. CONTROL MEASURES FOR ALL SLOPES, CHANNELS, DITCHES, AND DISTURBED LAND AREAS SHALL BE INSTALLED IMMEDIATELY UPON COMPLETION OF THE DISTURBANCE.

6. ALL TEMPORARY SEDIMENT AND EROSION CONTROL MEASURES SHALL BE MAINTAINED AND REMAIN IN EFFECTIVE OPERATING CONDITION UNTIL PERMANENT SOIL EROSION CONTROL MEASURES ARE IMPLEMENTED AND FINAL STABILIZATION IS ESTABLISHED. ALL PERSONS ENGAGED IN LAND DISTURBANCE ACTIVITIES SHALL ASSESS THE ADEQUACY OF CONTROL MEASURES AT THE SITE AND IDENTIFY IF CHANGES TO THOSE CONTROL MEASURES ARE NEEDED TO ENSURE THE CONTINUED EFFECTIVE PERFORMANCE OF THE CONTROL MEASURES. ALL CHANGES TO TEMPORARY SEDIMENT AND EROSION CONTROL MEASURES MUST BE INCORPORATED INTO THE STORMWATER MANAGEMENT PLAN.

7. TEMPORARY STABILIZATION SHALL BE IMPLEMENTED ON DISTURBED AREAS AND STOCKPILES WHERE GROUND DISTURBING CONSTRUCTION ACTIVITY HAS PERMANENTLY CEASED OR TEMPORARILY CEASED FOR LONGER THAN 14 DAYS.

8. FINAL STABILIZATION MUST BE IMPLEMENTED AT ALL APPLICABLE CONSTRUCTION SITES. FINAL STABILIZATION IS ACHIEVED WHEN ALL GROUND DISTURBING ACTIVITIES ARE COMPLETE AND ALL DISTURBED AREAS EITHER HAVE A UNIFORM VEGETATIVE COVER WITH INDIVIDUAL PLANT DENSITY OF 70 PERCENT OF PRE-DISTURBANCE LEVELS ESTABLISHED OR EQUIVALENT PERMANENT ALTERNATIVE STABILIZATION METHOD IS IMPLEMENTED. ALL TEMPORARY SEDIMENT AND EROSION CONTROL MEASURES SHALL BE REMOVED UPON FINAL STABILIZATION AND BEFORE PERMIT CLOSURE.

9. ALL PERMANENT STORMWATER MANAGEMENT FACILITIES SHALL BE INSTALLED AS DESIGNED IN THE APPROVED PLANS. ANY PROPOSED CHANGES THAT EFFECT THE DESIGN OR FUNCTION OF PERMANENT STORMWATER MANAGEMENT STRUCTURES MUST BE APPROVED BY THE ECM ADMINISTRATOR PRIOR TO IMPLEMENTATION.

10. EARTH DISTURBANCES SHALL BE CONDUCTED IN SUCH A MANNER SO AS TO EFFECTIVELY MINIMIZE ACCELERATED SOIL EROSION AND RESULTING SEDIMENTATION. ALL DISTURBANCES SHALL BE DESIGNED, CONSTRUCTED, AND COMPLETED SO THAT THE EXPOSED AREA OF ANY DISTURBED LAND SHALL BE LIMITED TO THE SHORTEST PRACTICAL PERIOD OF TIME. PRE-EXISTING VEGETATION SHALL BE PROTECTED AND MAINTAINED WITHIN 50 HORIZONTAL FEET OF A WATERS OF THE STATE UNLESS SHOWN TO BE INFEASIBLE AND SPECIFICALLY REQUESTED AND APPROVED.

11. COMPACTION OF SOIL MUST BE PREVENTED IN AREAS DESIGNATED FOR INFILTRATION CONTROL MEASURES OR WHERE FINAL STABILIZATION WILL BE ACHIEVED BY VEGETATIVE COVER. AREAS DESIGNATED FOR INFILTRATION CONTROL MEASURES SHALL ALSO BE PROTECTED FROM SEDIMENTATION DURING CONSTRUCTION UNTIL FINAL STABILIZATION IS ACHIEVED. IF COMPACTION PREVENTION IS NOT FEASIBLE DUE TO SITE CONSTRAINTS, ALL AREAS DESIGNATED FOR INFILTRATION AND VEGETATION CONTROL MEASURES MUST BE LOOSENED PRIOR TO INSTALLATION OF THE CONTROL MEASURE(S).

12. ANY TEMPORARY OR PERMANENT FACILITY DESIGNED AND CONSTRUCTED FOR THE CONVEYANCE OF STORMWATER AROUND, THROUGH, OR FROM THE EARTH DISTURBANCE AREA SHALL BE A STABILIZED CONVEYANCE DESIGNED TO MINIMIZE EROSION AND THE DISCHARGE OF SEDIMENT OFF SITE.
13. CONCRETE WASH WATER SHALL BE CONTAINED AND DISPOSED OF IN ACCORDANCE WITH THE SWMP. NO WASH WATER SHALL BE DISCHARGED TO OR ALLOWED TO ENTER STATE WATERS, INCLUDING ANY SURFACE OR SUBSURFACE STORM DRAINAGE SYSTEM OR FACILITIES. CONCRETE WASHOUTS SHALL NOT BE LOCATED IN AN AREA WHERE SHALLOW GROUNDWATER MAY BE PRESENT, OR WITHIN 50 FEET OF A SURFACE WATER BODY, CREEK OR STREAM.

14. DURING DEWATERING OPERATIONS OF UNCONTAMINATED GROUND WATER MAY BE DISCHARGED ON SITE, BUT SHALL NOT LEAVE THE SITE IN THE FORM OF SURFACE RUNOFF UNLESS AN APPROVED STATE DEWATERING PERMIT IS IN PLACE.

15. EROSION CONTROL BLANKETING OR OTHER PROTECTIVE COVERING SHALL BE USED ON SLOPES STEEPER THAN 3:1.

16. CONTRACTOR SHALL BE RESPONSIBLE FOR THE REMOVAL OF ALL WASTES FROM THE CONSTRUCTION SITE FOR DISPOSAL IN ACCORDANCE WITH LOCAL AND STATE REGULATORY REQUIREMENTS. NO CONSTRUCTION DEBRIS, TREE SLASH, BUILDING MATERIAL WASTES OR UNUSED BUILDING MATERIALS SHALL BE BURIED, DUMPED, OR DISCHARGED AT THE SITE.

17. WASTE MATERIALS SHALL NOT BE TEMPORARILY PLACED OR STORED IN THE STREET, ALLEY, OR OTHER PUBLIC WAY, UNLESS IN ACCORDANCE WITH AN APPROVED TRAFFIC CONTROL PLAN. CONTROL MEASURES MAY BE REQUIRED BY EL PASO COUNTY ENGINEERING IF DEEMED NECESSARY, BASED ON SPECIFIC CONDITIONS AND CIRCUMSTANCES.

18. TRACKING OF SOILS AND CONSTRUCTION DEBRIS OFF-SITE SHALL BE MINIMIZED. MATERIALS TRACKED OFF-SITE SHALL BE CLEANED UP AND PROPERLY DISPOSED OF IMMEDIATELY.

19. THE OWNER/DEVELOPER SHALL BE RESPONSIBLE FOR THE REMOVAL OF ALL CONSTRUCTION DEBRIS, DIRT, TRASH, ROCK, SEDIMENT, SOIL, AND SAND THAT MAY ACCUMULATE IN ROADS, STORM DRAINS AND OTHER DRAINAGE CONVEYANCE SYSTEMS AND STORMWATER APPURTENANCES AS A RESULT OF SITE DEVELOPMENT.

20. THE QUANTITY OF MATERIALS STORED ON THE PROJECT SITE SHALL BE LIMITED, AS MUCH AS PRACTICAL, TO THAT QUANTITY REQUIRED TO PERFORM THE WORK IN AN ORDERLY SEQUENCE. ALL MATERIALS STORED ON-SITE SHALL BE STORED IN A NEAT, ORDERLY MANNER, IN THEIR ORIGINAL CONTAINERS, WITH ORIGINAL MANUFACTURER'S LABELS.

21. NO CHEMICAL(S) HAVING THE POTENTIAL TO BE RELEASED IN STORMWATER ARE TO BE STORED OR USED ONSITE UNLESS PERMISSION FOR THE USE OF SUCH CHEMICAL(S) IS GRANTED IN WRITING BY THE ECM ADMINISTRATOR. IN GRANTING APPROVAL FOR THE USE OF SUCH CHEMICAL(S), SPECIAL CONDITIONS AND MONITORING MAY BE REQUIRED.

22. BULK STORAGE OF ALLOWED PETROLEUM PRODUCTS OR OTHER ALLOWED LIQUID CHEMICALS IN EXCESS OF 55 GALLONS SHALL REQUIRE ADEQUATE SECONDARY CONTAINMENT PROTECTION TO CONTAIN ALL SPILLS ONSITE AND TO PREVENT ANY SPILLED MATERIALS FROM ENTERING STATE WATERS, ANY SURFACE OR SUBSURFACE STORM DRAINAGE SYSTEM OR OTHER FACILITIES.

23. NO PERSON SHALL CAUSE THE IMPEDIMENT OF STORMWATER FLOW IN THE CURB AND GUTTER OR DITCH EXCEPT WITH APPROVED SEDIMENT CONTROL MEASURES.

24. OWNER/DEVELOPER AND THEIR AGENTS SHALL COMPLY WITH THE "COLORADO WATER QUALITY CONTROL ACT" (TITLE 25, ARTICLE 8, CRS), AND THE "CLEAN WATER ACT" (33 USC 1344), IN ADDITION TO THE REQUIREMENTS OF THE LAND DEVELOPMENT CODE, DCM VOLUME II AND THE ECM APPENDIX I. ALL APPROPRIATE PERMITS MUST BE OBTAINED BY THE CONTRACTOR PRIOR TO CONSTRUCTION (1041, NPDES, FLOODPLAIN, 404, FUGITIVE DUST, ETC.). IN THE EVENT OF CONFLICTS BETWEEN THESE REQUIREMENTS AND OTHER LAWS, RULES, OR REGULATIONS OF OTHER FEDERAL, STATE, LOCAL, OR COUNTY AGENCIES, THE MOST RESTRICTIVE LAWS, RULES, OR REGULATIONS SHALL APPLY.

25. ALL CONSTRUCTION TRAFFIC MUST ENTER/EXIT THE SITE ONLY AT APPROVED CONSTRUCTION ACCESS POINTS.

26. PRIOR TO CONSTRUCTION THE PERMITTEE SHALL VERIFY THE LOCATION OF EXISTING UTILITIES.

27. A WATER SOURCE SHALL BE AVAILABLE ON SITE DURING EARTHWORK OPERATIONS AND SHALL BE UTILIZED AS REQUIRED TO MINIMIZE DUST FROM EARTHWORK EQUIPMENT AND WIND.

28. THE SOILS REPORT FOR THIS SITE HAS BEEN PREPARED BY EARTH ENGINEERING CONSULTANTS, LLC ON APRIL 12, 2018, AND SHALL BE CONSIDERED A PART OF THESE PLANS.

29. AT LEAST TEN (10) DAYS PRIOR TO THE ANTICIPATED START OF CONSTRUCTION, FOR PROJECTS THAT WILL DISTURB ONE (1) ACRE OR MORE, THE OWNER OR OPERATOR OF CONSTRUCTION ACTIVITY SHALL SUBMIT A PERMIT APPLICATION FOR STORMWATER DISCHARGE TO THE COLORADO DEPARTMENT OF PUBLIC HEALTH AND ENVIRONMENT, WATER QUALITY DIVISION. THE APPLICATION CONTAINS CERTIFICATION OF COMPLETION OF A STORMWATER MANAGEMENT PLAN (SWMP), OF WHICH THIS GRADING AND EROSION CONTROL PLAN MAY BE A PART. FOR INFORMATION OR APPLICATION MATERIALS CONTACT:

COLORADO DEPARTMENT OF PUBLIC HEALTH AND ENVIRONMENT
WATER QUALITY CONTROL DIVISION
WQCD - PERMITS
4300 CHERRY CREEK DRIVE SOUTH
DENVER, CO 80246-1530
ATTN: PERMITS UNIT

REFERENCE DRAWINGS X-995.002-MDG22x34				
	No.	DATE	DESCRIPTION REVISIONS	BY
COMPUTER FILE MANAGEMENT				
FILE NAME: R:\20.995.002 (Liberty Tree Academy Additional Svcs)\Dwg\Sheets\CDs\IECGN_PH2.dwg				
CTB FILE: ----				
PLOT DATE: 12/10/2020 11:07 AM				
THIS DRAWING IS CURRENT AS OF PLOT DATE AND MAY BE SUBJECT TO CHANGE.				

SHEET KEY

PREPARED FOR:

LIBERTY TREE
ACADEMY

PREPARED BY:

Excellence by Design

SEAL

FOR AND ON BEHALF OF
MATRIX DESIGN GROUP, INC.
PROJECT No. 20.995.002

LIBERTY TREE ACADEMY - PHASE 2

TOWN OF PEYTON, EL PASO COUNTY
CONSTRUCTION DOCUMENTS, PCD FILE NO. PPR-20-018

EROSION CONTROL GENERAL NOTES

DESIGNED BY:	ACR	SCALE	DATE ISSUED:	DECEMBER 2020	DRAWING No.
CHECKED BY:	DRK	HORIZ. NA VERT. NA	SHEET	9 OF 19	ECGN01

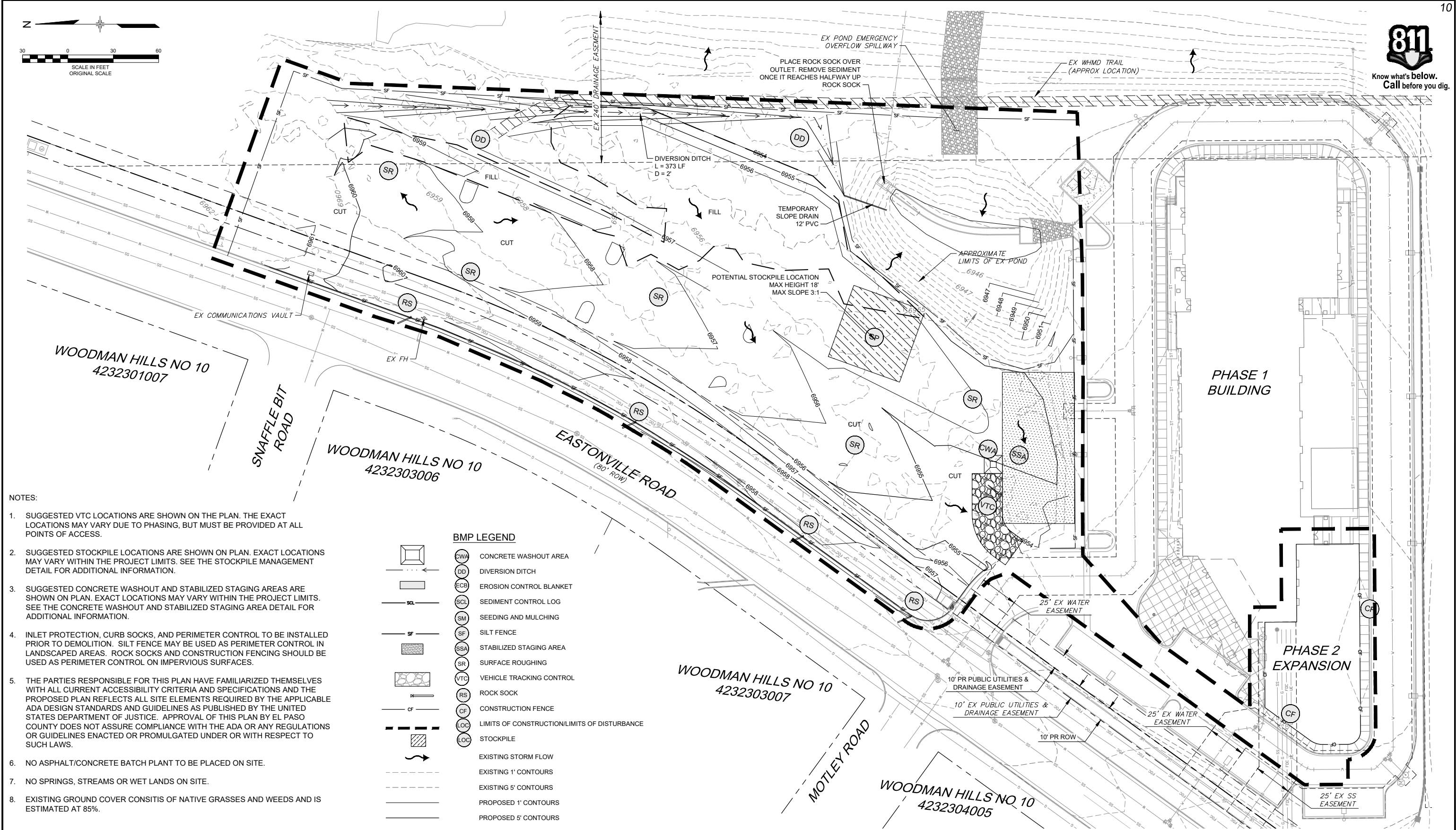
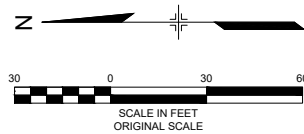

- NOTES:
- SUGGESTED VTC LOCATIONS ARE SHOWN ON THE PLAN. THE EXACT LOCATIONS MAY VARY DUE TO PHASING, BUT MUST BE PROVIDED AT ALL POINTS OF ACCESS.
 - SUGGESTED STOCKPILE LOCATIONS ARE SHOWN ON PLAN. EXACT LOCATIONS MAY VARY WITHIN THE PROJECT LIMITS. SEE THE STOCKPILE MANAGEMENT DETAIL FOR ADDITIONAL INFORMATION.
 - SUGGESTED CONCRETE WASHOUT AND STABILIZED STAGING AREAS ARE SHOWN ON PLAN. EXACT LOCATIONS MAY VARY WITHIN THE PROJECT LIMITS. SEE THE CONCRETE WASHOUT AND STABILIZED STAGING AREA DETAIL FOR ADDITIONAL INFORMATION.
 - INLET PROTECTION, CURB SOCKS, AND PERIMETER CONTROL TO BE INSTALLED PRIOR TO DEMOLITION. SILT FENCE MAY BE USED AS PERIMETER CONTROL IN LANDSCAPED AREAS. ROCK SOCKS AND CONSTRUCTION FENCING SHOULD BE USED AS PERIMETER CONTROL ON IMPERVIOUS SURFACES.
 - THE PARTIES RESPONSIBLE FOR THIS PLAN HAVE FAMILIARIZED THEMSELVES WITH ALL CURRENT ACCESSIBILITY CRITERIA AND SPECIFICATIONS AND THE PROPOSED PLAN REFLECTS ALL SITE ELEMENTS REQUIRED BY THE APPLICABLE ADA DESIGN STANDARDS AND GUIDELINES AS PUBLISHED BY THE UNITED STATES DEPARTMENT OF JUSTICE. APPROVAL OF THIS PLAN BY EL PASO COUNTY DOES NOT ASSURE COMPLIANCE WITH THE ADA OR ANY REGULATIONS OR GUIDELINES ENACTED OR PROMULGATED UNDER OR WITH RESPECT TO SUCH LAWS.
 - NO ASPHALT/CONCRETE BATCH PLANT TO BE PLACED ON SITE.
 - NO SPRINGS, STREAMS OR WET LANDS ON SITE.
 - EXISTING GROUND COVER CONSISTS OF NATIVE GRASSES AND WEEDS AND IS ESTIMATED AT 85%.

BMP LEGEND	
	CWA CONCRETE WASHOUT AREA
	DD DIVERSION DITCH
	ECB EROSION CONTROL BLANKET
	SCL SEDIMENT CONTROL LOG
	SM SEEDING AND MULCHING
	SF SILT FENCE
	SSA STABILIZED STAGING AREA
	SR SURFACE ROUGHING
	VTC VEHICLE TRACKING CONTROL
	RS ROCK SOCK
	CF CONSTRUCTION FENCE
	LOC LIMITS OF CONSTRUCTION/LIMITS OF DISTURBANCE
	LOC STOCKPILE
	EXISTING STORM FLOW
	EXISTING 1' CONTOURS
	EXISTING 5' CONTOURS
	PROPOSED 1' CONTOURS
	PROPOSED 5' CONTOURS

REFERENCE DRAWINGS			
X-995.002-MD22x34			
X-995.002-PR-BASE-PH-2			
X-995.002-EX-BASE			
X-995.002-EX-BASE-PH-1			
X-995.002-EX-MAP			
No.	DATE	DESCRIPTION	BY
COMPUTER FILE MANAGEMENT			
FILE NAME: R:\20.995.002 (Liberty Tree Academy Additional Svcs)\Dwg\Sheets\CDs\IEC01_PH2.dwg			
CTB FILE: ---			
PLOT DATE: 12/10/2020 11:07 AM			
THIS DRAWING IS CURRENT AS OF PLOT DATE AND MAY BE SUBJECT TO CHANGE.			

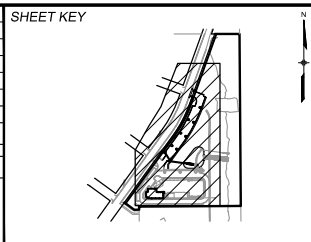

PREPARED FOR:

LIBERTY TREE ACADEMY

PREPARED BY:

Matrix

Excellence by Design

SEAL

FOR AND ON BEHALF OF
MATRIX DESIGN GROUP, INC.
PROJECT No. 20.995.002

LIBERTY TREE ACADEMY - PHASE 2				
TOWN OF PEYTON, EL PASO COUNTY CONSTRUCTION DOCUMENTS, PCD FILE NO. PPR-20-018				
INITIAL EROSION CONTROL PLAN				
DESIGNED BY:	ACR	SCALE	DATE ISSUED:	DRAWING No.
CHECKED BY:	DRK	HORIZ 1" = 30'	DECEMBER 2020	EC01
		VERT. NA	SHEET 10 OF 19	



Know what's below.
Call before you dig.

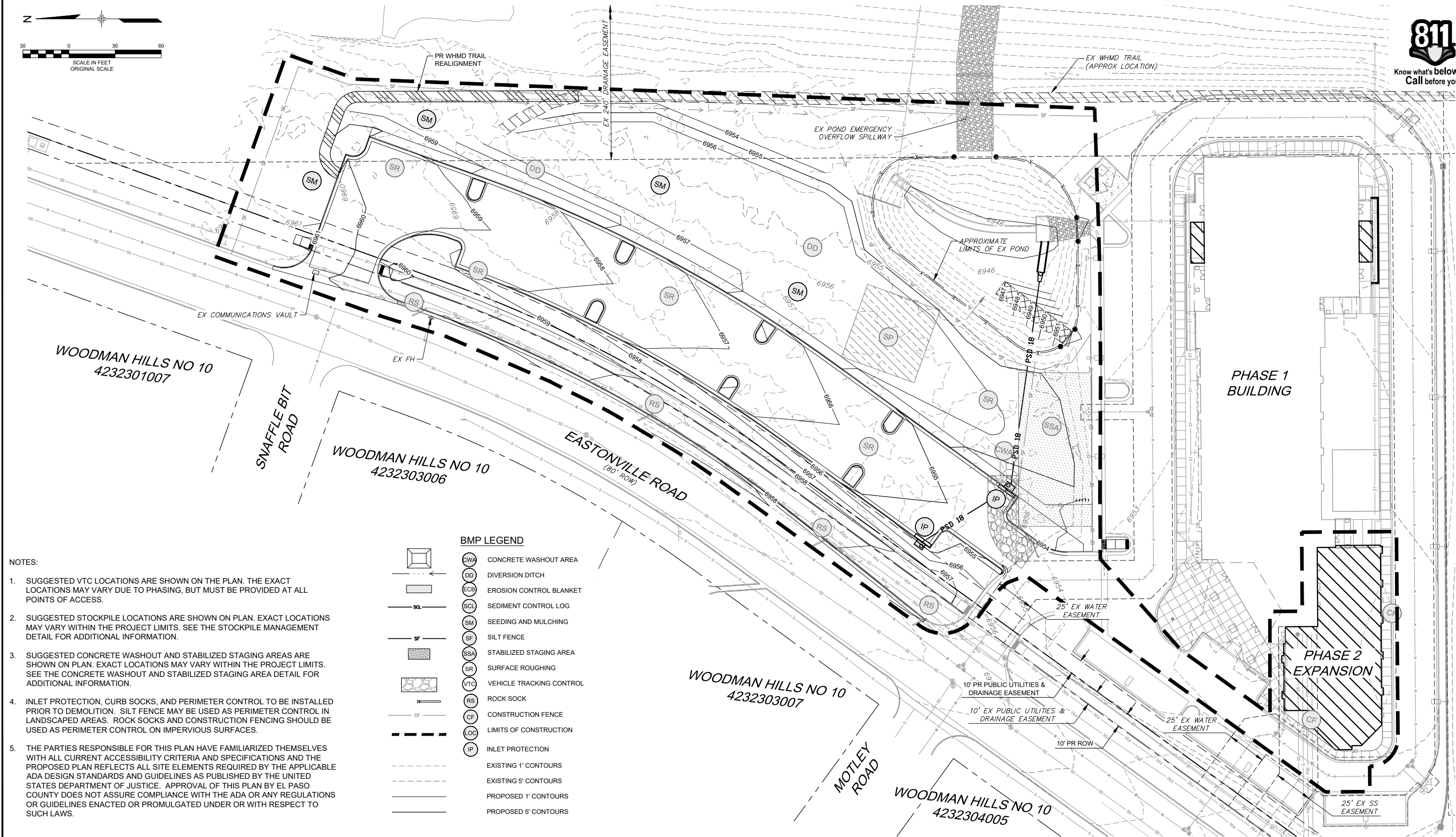
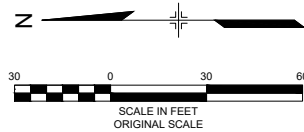

- NOTES:
1. SUGGESTED VTC LOCATIONS ARE SHOWN ON THE PLAN. THE EXACT LOCATIONS MAY VARY DUE TO PHASING, BUT MUST BE PROVIDED AT ALL POINTS OF ACCESS.
 2. SUGGESTED STOCKPILE LOCATIONS ARE SHOWN ON PLAN. EXACT LOCATIONS MAY VARY WITHIN THE PROJECT LIMITS. SEE THE STOCKPILE MANAGEMENT DETAIL FOR ADDITIONAL INFORMATION.
 3. SUGGESTED CONCRETE WASHOUT AND STABILIZED STAGING AREAS ARE SHOWN ON PLAN. EXACT LOCATIONS MAY VARY WITHIN THE PROJECT LIMITS. SEE THE CONCRETE WASHOUT AND STABILIZED STAGING AREA DETAIL FOR ADDITIONAL INFORMATION.
 4. INLET PROTECTION, CURB SOCKS, AND PERIMETER CONTROL TO BE INSTALLED PRIOR TO DEMOLITION. SILT FENCE MAY BE USED AS PERIMETER CONTROL IN LANDSCAPED AREAS. ROCK SOCKS AND CONSTRUCTION FENCING SHOULD BE USED AS PERIMETER CONTROL ON IMPERVIOUS SURFACES.
 5. THE PARTIES RESPONSIBLE FOR THIS PLAN HAVE FAMILIARIZED THEMSELVES WITH ALL CURRENT ACCESSIBILITY CRITERIA AND SPECIFICATIONS AND THE PROPOSED PLAN REFLECTS ALL SITE ELEMENTS REQUIRED BY THE APPLICABLE ADA DESIGN STANDARDS AND GUIDELINES AS PUBLISHED BY THE UNITED STATES DEPARTMENT OF JUSTICE. APPROVAL OF THIS PLAN BY EL PASO COUNTY DOES NOT ASSURE COMPLIANCE WITH THE ADA OR ANY REGULATIONS OR GUIDELINES ENACTED OR PROMULGATED UNDER OR WITH RESPECT TO SUCH LAWS.

REFERENCE DRAWINGS			
X-995.002-MD22x34			
X-995.002-PR-BASE_PH-2			
X-995.002-EX-BASE			
X-995.002-EX-BASE_PH-1			
X-995.002-EX-MAP			
No.	DATE	DESCRIPTION	BY
COMPUTER FILE MANAGEMENT			
FILE NAME: R:\20.995.002 (Liberty Tree Academy Additional Svcs)\Dwg\Sheets\CDs\EC02_PH2.dwg			
CTB FILE: ---			
PLOT DATE: 12/10/2020 11:07 AM			
THIS DRAWING IS CURRENT AS OF PLOT DATE AND MAY BE SUBJECT TO CHANGE.			

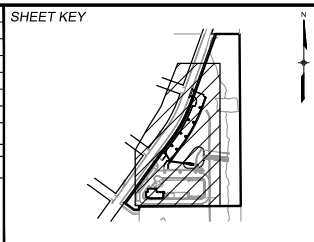

PREPARED FOR:
LIBERTY TREE ACADEMY

PREPARED BY:
Matrix
Excellence by Design

SEAL

FOR AND ON BEHALF OF
MATRIX DESIGN GROUP, INC.
PROJECT No. 20.995.002

LIBERTY TREE ACADEMY - PHASE 2

TOWN OF PEYTON, EL PASO COUNTY
CONSTRUCTION DOCUMENTS, PCD FILE NO. PPR-20-018

FINAL EROSION CONTROL PLAN

DESIGNED BY:	ACR	SCALE	DATE ISSUED:	DRAWING No.
CHECKED BY:	DRK	HORIZ 1" = 30'	DECEMBER 2020	EC02
		VERT. NA	SHEET 11 OF 19	



Vehicle Tracking Control (VTC)

SM-4

VTC-1. AGGREGATE VEHICLE TRACKING CONTROL

November 2010

Urban Drainage and Flood Control District
Urban Storm Drainage Criteria Manual Volume 3

VTC-3

SM-4

Vehicle Tracking Control (VTC)

VTC-2. AGGREGATE VEHICLE TRACKING CONTROL WITH WASH RACK

VTC-4

Urban Drainage and Flood Control District
Urban Storm Drainage Criteria Manual Volume 3

November 2010

Vehicle Tracking Control (VTC)

SM-4

VTC-3. VEHICLE TRACKING CONTROL W/ CONSTRUCTION MAT OR TURF REINFORCEMENT MAT (TRM)

November 2010

Urban Drainage and Flood Control District
Urban Storm Drainage Criteria Manual Volume 3

VTC-5

SM-4

Vehicle Tracking Control (VTC)

STABILIZED CONSTRUCTION ENTRANCE/EXIT INSTALLATION NOTES

- SEE PLAN VIEW FOR LOCATION OF CONSTRUCTION ENTRANCE(S)/EXIT(S). TYPE OF CONSTRUCTION ENTRANCE(S)/EXIT(S) (WITH/WITHOUT WHEEL WASH, CONSTRUCTION MAT OR TRM).
- CONSTRUCTION MAT OR TRM STABILIZED CONSTRUCTION ENTRANCES ARE ONLY TO BE USED ON SHORT DURATION PROJECTS (TYPICALLY RANGING FROM A WEEK TO A MONTH) WHERE THERE WILL BE LIMITED VEHICULAR ACCESS.
- A STABILIZED CONSTRUCTION ENTRANCE/EXIT SHALL BE LOCATED AT ALL ACCESS POINTS WHERE VEHICLES ACCESS THE CONSTRUCTION SITE FROM PAVED RIGHT-OF-WAYS.
- STABILIZED CONSTRUCTION ENTRANCE/EXIT SHALL BE INSTALLED PRIOR TO ANY LAND DISTURBING ACTIVITIES.
- A NON-WOVEN GEOTEXTILE FABRIC SHALL BE PLACED UNDER THE STABILIZED CONSTRUCTION ENTRANCE/EXIT PRIOR TO THE PLACEMENT OF ROCK.
- UNLESS OTHERWISE SPECIFIED BY LOCAL JURISDICTION, ROCK SHALL CONSIST OF DOT SECT. #703, AASHTO #3 COARSE AGGREGATE OR 6" (MINUS) ROCK.

STABILIZED CONSTRUCTION ENTRANCE/EXIT MAINTENANCE NOTES

- INSPECT BMPs EACH WORKDAY, AND MAINTAIN THEM IN EFFECTIVE OPERATING CONDITION. MAINTENANCE OF BMPs SHOULD BE PROACTIVE, NOT REACTIVE. INSPECT BMPs AS SOON AS POSSIBLE (AND ALWAYS WITHIN 24 HOURS) FOLLOWING A STORM THAT CAUSES SURFACE EROSION, AND PERFORM NECESSARY MAINTENANCE.
- FREQUENT OBSERVATIONS AND MAINTENANCE ARE NECESSARY TO MAINTAIN BMPs IN EFFECTIVE OPERATING CONDITION. INSPECTIONS AND CORRECTIVE MEASURES SHOULD BE DOCUMENTED THOROUGHLY.
- WHERE BMPs HAVE FAILED, REPAIR OR REPLACEMENT SHOULD BE INITIATED UPON DISCOVERY OF THE FAILURE.
- ROCK SHALL BE REAPPLIED OR REGRADED AS NECESSARY TO THE STABILIZED ENTRANCE/EXIT TO MAINTAIN A CONSISTENT DEPTH.
- SEDIMENT TRACKED ONTO PAVED ROADS IS TO BE REMOVED THROUGHOUT THE DAY AND AT THE END OF THE DAY BY SHOVELING OR SWEEPING. SEDIMENT MAY NOT BE WASHED DOWN STORM SEWER DRAINS.

NOTE: MANY JURISDICTIONS HAVE BMP DETAILS THAT VARY FROM IUDCD STANDARD DETAILS. CONSULT WITH LOCAL JURISDICTIONS AS TO WHICH DETAIL SHOULD BE USED WHEN DIFFERENCES ARE NOTED.

(DETAILS ADAPTED FROM CITY OF BROOMFIELD, COLORADO, NOT AVAILABLE IN AUTOCAD)

VTC-6

Urban Drainage and Flood Control District
Urban Storm Drainage Criteria Manual Volume 3

November 2010

Earth Dikes and Drainage Swales (ED/DS)

EC-10

ED-1. COMPACTED UNLINED EARTH DIKE FORMED BY BERM

November 2010

Urban Drainage and Flood Control District
Urban Storm Drainage Criteria Manual Volume 3

ED/DS-3

EC-10

Earth Dikes and Drainage Swales (ED/DS)

DS-4. SYNTHETIC LINED SWALE

ED/DS-4

Urban Drainage and Flood Control District
Urban Storm Drainage Criteria Manual Volume 3

November 2010

Earth Dikes and Drainage Swales (ED/DS)

EC-10

EARTH DIKE AND DRAINAGE SWALE INSTALLATION NOTES

- SEE SITE PLAN FOR: - LOCATION OF DIVERSION SWALE - TYPE OF SWALE (UNLINED, COMPACTED AND/OR LINED) - LENGTH OF EACH SWALE - DEPTH, D, AND WIDTH, W, DIMENSIONS. - FOR ECB/TRM LINED DITCH, SEE ECB DETAIL - FOR RIPRAP LINED DITCH, SEE RIPRAP, DSO.
- SEE DRAINAGE PLANS FOR DETAILS OF PERMANENT CONVEYANCE FACILITIES AND/OR DIVERSION SWALES EXCEEDING 2-YEAR FLOW RATE OR 10 CFS.
- EARTH DIKES AND SWALES INDICATED ON SWMP PLAN SHALL BE INSTALLED PRIOR TO LAND-DISTURBING ACTIVITIES IN PROXIMITY.
- EMBANKMENT IS TO BE COMPACTED TO 90% OF MAXIMUM DENSITY AND WITHIN 2% OF OPTIMUM MOISTURE CONTENT ACCORDING TO ASTM D698.
- SWALES ARE TO DRAIN TO A SEDIMENT CONTROL BMP.
- FOR LINED DITCHES, INSTALLATION OF ECB/TRM SHALL CONFORM TO THE REQUIREMENTS OF THE ECB DETAIL.
- WHEN CONSTRUCTION TRAFFIC MUST CROSS A DIVERSION SWALE, INSTALL A TEMPORARY CULVERT WITH A MINIMUM DIAMETER OF 12 INCHES.

November 2010

Urban Drainage and Flood Control District
Urban Storm Drainage Criteria Manual Volume 3

ED/DS-5

EC-4

Mulching (MU)

Description

Mulching consists of evenly applying straw, hay, shredded wood mulch, rock, bark or compost to disturbed soils and securing the mulch by crimping, tackifiers, netting or other measures. Mulching helps reduce erosion by protecting bare soil from rainfall impact, increasing infiltration, and reducing runoff. Although often applied in conjunction with temporary or permanent seeding, it can also be used for temporary stabilization of areas that cannot be reseeded due to seasonal constraints.

Mulch can be applied either using standard mechanical dry application methods or using hydromulching equipment that hydraulically applies a slurry of water, wood fiber mulch, and often a tackifier.

Photograph MU-1. An area that was recently seeded, mulched, and crimped.

Appropriate Uses

Use mulch in conjunction with seeding to help protect the seedbed and stabilize the soil. Mulch can also be used as a temporary cover on low to mild slopes to help temporarily stabilize disturbed areas where growing season constraints prevent effective reseeding. Disturbed areas should be properly mulched and tacked, or seeded, mulched and tacked promptly after final grade is reached (typically within no longer than 14 days) on portions of the site not otherwise permanently stabilized.

Standard dry mulching is encouraged in most jurisdictions; however, hydromulching may not be allowed in certain jurisdictions or may not be allowed near waterways.

Do not apply mulch during windy conditions.

Design and Installation

Prior to mulching, surface-roughen areas by rolling with a crimping or punching type roller or by track walking. Track walking should only be used where other methods are impractical because track walking with heavy equipment typically compacts the soil.

A variety of mulches can be used effectively at construction sites. Consider the following:

Mulch	
Functions	
Erosion Control	Yes
Sediment Control	Moderate
Site/Material Management	No

June 2012

Urban Drainage and Flood Control District
Urban Storm Drainage Criteria Manual Volume 3

MU-1

REFERENCE DRAWINGS

X-995.002-MDG22x34

No.	DATE	DESCRIPTION	BY

COMPUTER FILE MANAGEMENT

FILE NAME: R:\20.995.002 (Liberty Tree Academy Additional Svcs)\Dwg\Sheets\CDs\ECDT_PH2.dwg
CTB FILE: ---
PLOT DATE: 12/10/2020 11:08 AM
THIS DRAWING IS CURRENT AS OF PLOT DATE AND MAY BE SUBJECT TO CHANGE.

SHEET KEY

PREPARED FOR:

LIBERTY TREE ACADEMY

PREPARED BY:

Matrix

Excellence by Design

SEAL

FOR AND ON BEHALF OF
MATRIX DESIGN GROUP, INC.
PROJECT No. 20.995.002

LIBERTY TREE ACADEMY - PHASE 2

TOWN OF PEYTON, EL PASO COUNTY
CONSTRUCTION DOCUMENTS, PCD FILE NO. PPR-20-018

EROSION CONTROL DETAILS

DESIGNED BY:	ACR	SCALE	DATE ISSUED:	DECEMBER 2020	DRAWING No.
DRAWN BY:	ACR	HORIZ	12	OF 19	ECDT01
CHECKED BY:	DRK	VERT.	SHEET		

MU-2 Urban Drainage and Flood Control District June 2012
Urban Storm Drainage Criteria Manual Volume 3

RS-2 Urban Drainage and Flood Control District November 2010
Urban Storm Drainage Criteria Manual Volume 3

November 2010 Urban Drainage and Flood Control District RS-3
Urban Storm Drainage Criteria Manual Volume 3

ST-2 Urban Drainage and Flood Control District November 2010
Urban Storm Drainage Criteria Manual Volume 3

August 2013 Urban Drainage and Flood Control District SB-5
Urban Storm Drainage Criteria Manual Volume 3

SB-6 Urban Drainage and Flood Control District August 2013
Urban Storm Drainage Criteria Manual Volume 3

August 2013 Urban Drainage and Flood Control District SB-7
Urban Storm Drainage Criteria Manual Volume 3

November 2010 Urban Drainage and Flood Control District ST-3
Urban Storm Drainage Criteria Manual Volume 3

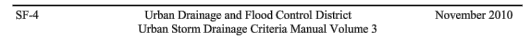
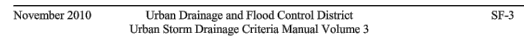
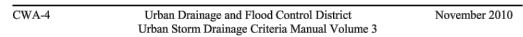
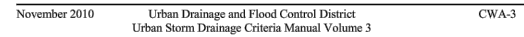
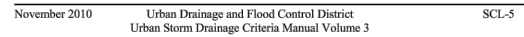
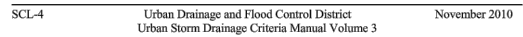
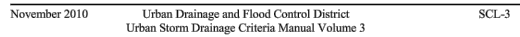

ACCORDING TO NRCS SOILS SURVEY, THE 19--COLUMBINE GRAVELLY SANDY LOAM, 0 TO 3 PERCENT SLOPES IS SOMEWHAT POOR FOR SHALLOW EXCAVATIONS DUE TO UNSTABLE EXCAVATION WALLS. DUE TO THE LIMITATIONS ON THE ABOVE SOIL ON THE SITE, ALTERNATIVES TO MITIGATE THE LIMITATIONS OF THE SOIL WILL BE REQUIRED IN YOUR ENGINEERING DESIGN OR CONSTRUCTION TECHNIQUES.

THERE IS NO INTEGRATED NOXIOUS WEED CONTROL PLAN AND IT IS RECOMMENDED THAT AN INTEGRATED WEED MANAGEMENT PROGRAM BE REVIEWED AND APPROVED BY THE EL PASO COUNTY WEED INSPECTOR AND/OR WEED ADVISORY BOARD, THE COUNTY EXTENSION AGENT, NRCS, OR A QUALIFIED WEED MANAGEMENT PROFESSIONAL PRIOR TO THE LAND USE AUTHORITY APPROVAL.

SLOPES SHOULD BE STRIPPED TO A DEPTH OF 6 INCHES AND ALL STOCKPILES SHOULD HAVE SIDE SLOPES NO STEEPER THAN 3:1 AND SEEDED. ALL DISTURBED AREAS SHOULD BE SEEDED AND MULCHED WITH WEED FREE HAY MULCH AT 4,000 LBS./ACRE. ALL DISTURBED AREAS SHOULD BE RESEEDED BETWEEN THE PLANTING DATES OF NOV. 1-APRIL 30TH. GRASS SEED SHOULD BE DRILLED AT A DEPTH OF 1/2 TO 3/4 INCH DEEP AND IF BROADCASTED, DOUBLE THE RATE. PLEASE FEEL FREE TO UTILIZE THE ATTACHED NATIVE SHOTGUN MIX THAT WILL WORK BEST ON YOUR GRAVELLY FOOTHILL RANGE SITE.

VEHICLE TRACKING CONTROL STATIONS NEED TO BE INSTALLED AT ALL ENTRANCE AND EXIT POINTS ON THE SITE. THE STATION SHOULD CONSIST OF A PAD OF 3 TO 6-INCH ROCK OR A VEHICLE CONTROL PAD/MAT TO STRIP MUD FROM TIRES PRIOR TO VEHICLES LEAVING THE CONSTRUCTION SITE TO PREVENT SPREADING OF NOXIOUS WEEDS.

SILT FENCES OR OTHER FORMS OF EROSION BARRIERS NEED TO BE PLANNED AND INSTALLED AS A TEMPORARY SEDIMENT CONTROL DEVICE USED ON CONSTRUCTION SITES TO PROTECT WATER QUALITY.

THE EL PASO COUNTY CD BOARD STRONGLY RECOMMENDS THAT LOW IMPACT DEVELOPMENT (LID) TECHNIQUES BE IMPLEMENTED FOR ECONOMIC AND CONSERVATION BENEFITS.

REFERENCE DRAWINGS						
X-995.002-MDG22x34						
No.	DATE	DESCRIPTION				BY
REVISIONS						
COMPUTER FILE MANAGEMENT						
FILE NAME: R:\20.995.002 (Liberty Tree Academy Additional Svcs)\Dwg\Sheets\CDs\ECDT_PH2.dwg						
CTB FILE:						
PLOT DATE: 12/10/2020 11:08 AM						
THIS DRAWING IS CURRENT AS OF PLOT DATE AND MAY BE SUBJECT TO CHANGE.						

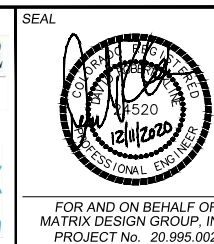
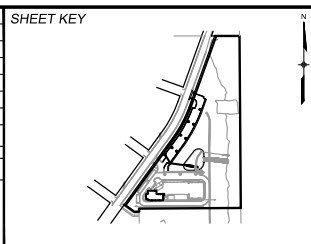

LIBERTY TREE ACADEMY - PHASE 2				
TOWN OF PEYTON, EL PASO COUNTY CONSTRUCTION DOCUMENTS, PCD FILE NO. PPR-20-018				
EROSION CONTROL DETAILS				
DESIGNED BY:	ACR	SCALE	DATE ISSUED:	DECEMBER 2020
DRAWN BY:	ACR	HORIZ	NA	DRAWING No.
CHECKED BY:	DRK	VERT.	NA	SHEET
			14	OF 19
				ECDT03



<div>Stockpile Management (SP)MM-2</div> <div><p>SP-1. STOCKPILE PROTECTION</p><p>STOCKPILE PROTECTION INSTALLATION NOTES</p><ol style="list-style-type: none">SEE PLAN VIEW FOR:<ul style="list-style-type: none">LOCATION OF STOCKPILES.TYPE OF STOCKPILE PROTECTION.INSTALL PERIMETER CONTROLS IN ACCORDANCE WITH THEIR RESPECTIVE DESIGN DETAILS. SILT FENCE IS SHOWN IN THE STOCKPILE PROTECTION DETAILS; HOWEVER, OTHER TYPES OF PERIMETER CONTROLS INCLUDING SEDIMENT CONTROL LOGS OR ROCK SOCKS MAY BE SUITABLE IN SOME CIRCUMSTANCES. CONSIDERATIONS FOR DETERMINING THE APPROPRIATE TYPE OF PERIMETER CONTROL FOR A STOCKPILE INCLUDE WHETHER THE STOCKPILE IS LOCATED ON A PERVIOUS OR IMPERVIOUS SURFACE, THE RELATIVE HEIGHTS OF THE PERIMETER CONTROL AND STOCKPILE, THE ABILITY OF THE PERIMETER CONTROL TO CONTAIN THE STOCKPILE WITHOUT FAILING IN THE EVENT THAT MATERIAL FROM THE STOCKPILE SHIFTS OR SLUMPS AGAINST THE PERIMETER, AND OTHER FACTORS.STABILIZE THE STOCKPILE SURFACE WITH SURFACE ROUGHENING, TEMPORARY SEEDING AND MULCHING, EROSION CONTROL BLANKETS, OR SOIL BINDERS. SOILS STOCKPILED FOR AN EXTENDED PERIOD (TYPICALLY FOR MORE THAN 60 DAYS) SHOULD BE SEED AND MULCHED WITH A TEMPORARY GRASS COVER ONCE THE STOCKPILE IS PLACED (TYPICALLY WITHIN 14 DAYS). USE OF MULCH ONLY OR A SOIL BINDER IS ACCEPTABLE IF THE STOCKPILE WILL BE IN PLACE FOR A MORE LIMITED TIME PERIOD (TYPICALLY 30-60 DAYS).FOR TEMPORARY STOCKPILES ON THE INTERIOR PORTION OF A CONSTRUCTION SITE, WHERE OTHER DOWNSTREAM CONTROLS, INCLUDING PERIMETER CONTROLS, ARE IN PLACE, STOCKPILE PERIMETER CONTROLS MAY NOT BE REQUIRED.</div> <div>November 2010Urban Drainage and Flood Control DistrictUrban Storm Drainage Criteria Manual Volume 3SP-3</div>	<div>MM-2Stockpile Management (SM)</div> <div><p>STOCKPILE PROTECTION MAINTENANCE NOTES</p><ol style="list-style-type: none">INSPECT BMPs EACH WORKDAY, AND MAINTAIN THEM IN EFFECTIVE OPERATING CONDITION. MAINTENANCE OF BMPs SHOULD BE PROACTIVE, NOT REACTIVE. INSPECT BMPs AS SOON AS POSSIBLE (AND ALWAYS WITHIN 24 HOURS) FOLLOWING A STORM THAT CAUSES SURFACE EROSION, AND PERFORM NECESSARY MAINTENANCE.FREQUENT OBSERVATIONS AND MAINTENANCE ARE NECESSARY TO MAINTAIN BMPs IN EFFECTIVE OPERATING CONDITION. INSPECTIONS AND CORRECTIVE MEASURES SHOULD BE DOCUMENTED THOROUGHLY.WHERE BMPs HAVE FAILED, REPAIR OR REPLACEMENT SHOULD BE INITIATED UPON DISCOVERY OF THE FAILURE.<p>STOCKPILE PROTECTION MAINTENANCE NOTES</p><ol style="list-style-type: none">IF PERIMETER PROTECTION MUST BE MOVED TO ACCESS SOIL STOCKPILE, REPLACE PERIMETER CONTROLS BY THE END OF THE WORKDAY.STOCKPILE PERIMETER CONTROLS CAN BE REMOVED ONCE ALL THE MATERIAL FROM THE STOCKPILE HAS BEEN USED.<p>(DETAILS ADAPTED FROM PARKER, COLORADO, NOT AVAILABLE IN AUTOCAD)</p><p>NOTE: MANY JURISDICTIONS HAVE BMP DETAILS THAT VARY FROM UOFCO STANDARD DETAILS. CONSULT WITH LOCAL JURISDICTIONS AS TO WHICH DETAIL SHOULD BE USED WHEN DIFFERENCES ARE NOTED.</p></div> <div>SP-4Urban Drainage and Flood Control DistrictUrban Storm Drainage Criteria Manual Volume 3November 2010</div>	<div>Stockpile Management (SP)MM-2</div> <div><p>SP-2. MATERIALS STAGING IN ROADWAY</p><p>MATERIALS STAGING IN ROADWAYS INSTALLATION NOTES</p><ol style="list-style-type: none">SEE PLAN VIEW FOR:<ul style="list-style-type: none">LOCATION OF MATERIAL STAGING AREA(S).CONTRACTOR MAY ADJUST LOCATION AND SIZE OF STAGING AREA WITH APPROVAL FROM THE LOCAL JURISDICTION.FEATURE MUST BE INSTALLED PRIOR TO EXCAVATION, EARTHWORK OR DELIVERY OF MATERIALS.MATERIALS MUST BE STATIONED ON THE POLY LINER. ANY INCIDENTAL MATERIALS DEPOSITED ON PAVED SECTION OR ALONG CURB LINE MUST BE CLEANED UP PROMPTLY.POLY LINER AND TARP COVER SHOULD BE OF SIGNIFICANT THICKNESS TO PREVENT DAMAGE OR LOSS OF INTEGRITY.SAND BAGS MAY BE SUBSTITUTED TO ANCHOR THE COVER TARP OR PROVIDE BERMING UNDER THE BASE LINER.FEATURE IS NOT INTENDED FOR USE WITH WET MATERIAL THAT WILL BE DRAINING AND/OR SPREADING OUT ON THE POLY LINER OR FOR DEMOLITION MATERIALS.THIS FEATURE CAN BE USED FOR:<ul style="list-style-type: none">UTILITY REPAIRS.WHEN OTHER STAGING LOCATIONS AND OPTIONS ARE LIMITED.OTHER LIMITED APPLICATION AND SHORT DURATION STAGING.</div> <div>November 2010Urban Drainage and Flood Control DistrictUrban Storm Drainage Criteria Manual Volume 3SP-5</div>	<div>MM-2Stockpile Management (SM)</div> <div><p>MATERIALS STAGING IN ROADWAY MAINTENANCE NOTES</p><ol style="list-style-type: none">INSPECT BMPs EACH WORKDAY, AND MAINTAIN THEM IN EFFECTIVE OPERATING CONDITION. MAINTENANCE OF BMPs SHOULD BE PROACTIVE, NOT REACTIVE. INSPECT BMPs AS SOON AS POSSIBLE (AND ALWAYS WITHIN 24 HOURS) FOLLOWING A STORM THAT CAUSES SURFACE EROSION, AND PERFORM NECESSARY MAINTENANCE.FREQUENT OBSERVATIONS AND MAINTENANCE ARE NECESSARY TO MAINTAIN BMPs IN EFFECTIVE OPERATING CONDITION. INSPECTIONS AND CORRECTIVE MEASURES SHOULD BE DOCUMENTED THOROUGHLY.WHERE BMPs HAVE FAILED, REPAIR OR REPLACEMENT SHOULD BE INITIATED UPON DISCOVERY OF THE FAILURE.INSPECT PVC PIPE ALONG CURB LINE FOR CLOGGING AND DEBRIS. REMOVE OBSTRUCTIONS PROMPTLY.CLEAN MATERIAL FROM PAVED SURFACES BY SWEEPING OR VACUUMING.<p>NOTE: MANY JURISDICTIONS HAVE BMP DETAILS THAT VARY FROM UOFCO STANDARD DETAILS. CONSULT WITH LOCAL JURISDICTIONS AS TO WHICH DETAIL SHOULD BE USED WHEN DIFFERENCES ARE NOTED.</p><p>(DETAILS ADAPTED FROM AURORA, COLORADO)</p></div> <div>SP-6Urban Drainage and Flood Control DistrictUrban Storm Drainage Criteria Manual Volume 3November 2010</div>
<div>Surface Roughening (SR)EC-1</div> <div><p>SR-1. SURFACE ROUGHENING FOR STEEP SLOPES (2:1 OR STEEPER)</p><p>SR-2. SURFACE ROUGHENING FOR LOW SLOPES (LESS THAN 3:1)</p></div> <div>November 2010Urban Drainage and Flood Control DistrictUrban Storm Drainage Criteria Manual Volume 3SR-3</div>	<div>EC-1Surface Roughening (SR)</div> <div><p>SURFACE ROUGHENING INSTALLATION NOTES</p><ol style="list-style-type: none">SEE PLAN VIEW FOR:<ul style="list-style-type: none">LOCATION(S) OF SURFACE ROUGHENING.SURFACE ROUGHENING SHALL BE PROVIDED PROMPTLY AFTER COMPLETION OF FINISHED GRADING (FOR AREAS NOT RECEIVING TOPSOIL) OR PRIOR TO TOPSOIL PLACEMENT OR ANY FORECASTED RAIN EVENT.AREAS WHERE BUILDING FOUNDATIONS, PAVEMENT, OR SOIL WILL BE PLACED WITHOUT DELAY IN THE CONSTRUCTION SEQUENCE, SURFACE ROUGHENING IS NOT REQUIRED.DISTURBED SURFACES SHALL BE ROUGHENED USING RIPPING OR TILLING EQUIPMENT ON THE CONTOUR OR TRACKING UP AND DOWN A SLOPE USING EQUIPMENT TRACKS.A FARMING DISK SHALL NOT BE USED FOR SURFACE ROUGHENING.<p>SURFACE ROUGHENING MAINTENANCE NOTES</p><ol style="list-style-type: none">INSPECT BMPs EACH WORKDAY, AND MAINTAIN THEM IN EFFECTIVE OPERATING CONDITION. MAINTENANCE OF BMPs SHOULD BE PROACTIVE, NOT REACTIVE. INSPECT BMPs AS SOON AS POSSIBLE (AND ALWAYS WITHIN 24 HOURS) FOLLOWING A STORM THAT CAUSES SURFACE EROSION, AND PERFORM NECESSARY MAINTENANCE.FREQUENT OBSERVATIONS AND MAINTENANCE ARE NECESSARY TO MAINTAIN BMPs IN EFFECTIVE OPERATING CONDITION. INSPECTIONS AND CORRECTIVE MEASURES SHOULD BE DOCUMENTED THOROUGHLY.WHERE BMPs HAVE FAILED, REPAIR OR REPLACE UPON DISCOVERY OF THE FAILURE.VEHICLES AND EQUIPMENT SHALL NOT BE DRIVEN OVER AREAS THAT HAVE BEEN SURFACE ROUGHENED.IN NON-TURF GRASS FINISHED AREAS, SEEDING AND MULCHING SHALL TAKE PLACE DIRECTLY OVER SURFACE ROUGHENED AREAS WITHOUT FIRST SMOOTHING OUT THE SURFACE.IN AREAS NOT SEED AND MULCHED AFTER SURFACE ROUGHENING, SURFACES SHALL BE RE-ROUGHENED AS NECESSARY TO MAINTAIN GROOVE DEPTH AND SMOOTH OVER RILL EROSION.<p>(DETAILS ADAPTED FROM TOWN OF PARKER, COLORADO, NOT AVAILABLE IN AUTOCAD)</p><p>NOTE: MANY JURISDICTIONS HAVE BMP DETAILS THAT VARY FROM UOFCO STANDARD DETAILS. CONSULT WITH LOCAL JURISDICTIONS AS TO WHICH DETAIL SHOULD BE USED WHEN DIFFERENCES ARE NOTED.</p></div> <div>SR-4Urban Drainage and Flood Control DistrictUrban Storm Drainage Criteria Manual Volume 3November 2010</div>	<div>Stabilized Staging Area (SSA)SM-6</div> <div><p>SSA-1. STABILIZED STAGING AREA</p><p>STABILIZED STAGING AREA INSTALLATION NOTES</p><ol style="list-style-type: none">SEE PLAN VIEW FOR:<ul style="list-style-type: none">LOCATION OF STAGING AREA(S).CONTRACTOR MAY ADJUST LOCATION AND SIZE OF STAGING AREA WITH APPROVAL FROM THE LOCAL JURISDICTION.STABILIZED STAGING AREA SHOULD BE APPROPRIATE FOR THE NEEDS OF THE SITE. OVERSIZING RESULTS IN A LARGER AREA TO STABILIZE FOLLOWING CONSTRUCTION.STAGING AREA SHALL BE STABILIZED PRIOR TO OTHER OPERATIONS ON THE SITE.THE STABILIZED STAGING AREA SHALL CONSIST OF A MINIMUM 3" THICK GRANULAR MATERIAL.UNLESS OTHERWISE SPECIFIED BY LOCAL JURISDICTION, ROCK SHALL CONSIST OF DOT SECT. #703, AASHTO #3 COARSE AGGREGATE OR 6" (MINUS) ROCK.ADDITIONAL PERIMETER BMPs MAY BE REQUIRED INCLUDING BUT NOT LIMITED TO SILT FENCE AND CONSTRUCTION FENCING.<p>STABILIZED STAGING AREA MAINTENANCE NOTES</p><ol style="list-style-type: none">INSPECT BMPs EACH WORKDAY, AND MAINTAIN THEM IN EFFECTIVE OPERATING CONDITION. MAINTENANCE OF BMPs SHOULD BE PROACTIVE, NOT REACTIVE. INSPECT BMPs AS SOON AS POSSIBLE (AND ALWAYS WITHIN 24 HOURS) FOLLOWING A STORM THAT CAUSES SURFACE EROSION, AND PERFORM NECESSARY MAINTENANCE.FREQUENT OBSERVATIONS AND MAINTENANCE ARE NECESSARY TO MAINTAIN BMPs IN EFFECTIVE OPERATING CONDITION. INSPECTIONS AND CORRECTIVE MEASURES SHOULD BE DOCUMENTED THOROUGHLY.WHERE BMPs HAVE FAILED, REPAIR OR REPLACEMENT SHOULD BE INITIATED UPON DISCOVERY OF THE FAILURE.ROCK SHALL BE REAPPLIED OR REGRADED AS NECESSARY IF RUTTING OCCURS OR UNDERLYING SUBGRADE BECOMES EXPOSED.</div> <div>November 2010Urban Drainage and Flood Control DistrictUrban Storm Drainage Criteria Manual Volume 3SSA-3</div>	<div>SM-6Stabilized Staging Area (SSA)</div> <div><p>STABILIZED STAGING AREA MAINTENANCE NOTES</p><ol style="list-style-type: none">STABILIZED STAGING AREA SHALL BE ENLARGED IF NECESSARY TO CONTAIN PARKING, STORAGE, AND UNLOADING/LOADING OPERATIONS.THE STABILIZED STAGING AREA SHALL BE REMOVED AT THE END OF CONSTRUCTION. THE GRANULAR MATERIAL SHALL BE REMOVED OR, IF APPROVED BY THE LOCAL JURISDICTION, USED ON SITE, AND THE AREA COVERED WITH TOPSOIL, SEED AND MULCHED OR OTHERWISE STABILIZED IN A MANNER APPROVED BY LOCAL JURISDICTION.<p>NOTE: MANY MUNICIPALITIES PROHIBIT THE USE OF RECYCLED CONCRETE AS GRANULAR MATERIAL FOR STABILIZED STAGING AREAS DUE TO DIFFICULTIES WITH RE-ESTABLISHMENT OF VEGETATION IN AREAS WHERE RECYCLED CONCRETE WAS PLACED.</p><p>NOTE: MANY JURISDICTIONS HAVE BMP DETAILS THAT VARY FROM UOFCO STANDARD DETAILS. CONSULT WITH LOCAL JURISDICTIONS AS TO WHICH DETAIL SHOULD BE USED WHEN DIFFERENCES ARE NOTED.</p><p>(DETAILS ADAPTED FROM BOULDER COUNTY, COLORADO, NOT AVAILABLE IN AUTOCAD)</p></div> <div>SSA-4Urban Drainage and Flood Control DistrictUrban Storm Drainage Criteria Manual Volume 3November 2010</div>

REFERENCE DRAWINGS

X-995-002-MD22x34

No.	DATE	DESCRIPTION	BY
REVISIONS			

COMPUTER FILE MANAGEMENT

FILE NAME: R:\20.995.002 (Liberty Tree Academy Additional Svcs)\Dwg\Sheets\CDs\ECDT_PH2.dwg

CTB FILE: ---

PLOT DATE: 12/10/2020 11:08 AM

THIS DRAWING IS CURRENT AS OF PLOT DATE AND MAY BE SUBJECT TO CHANGE.

SHEET KEY

PREPARED FOR:

LIBERTY TREE ACADEMY

PREPARED BY:

Matrix

Excellence by Design

SEAL

LIBERTY TREE ACADEMY - PHASE 2

TOWN OF PEYTON, EL PASO COUNTY

CONSTRUCTION DOCUMENTS, PCD FILE NO. PPR-20-018

EROSION CONTROL DETAILS

DESIGNED BY:	ACR	SCALE	DATE ISSUED:	DECEMBER 2020	DRAWING No.
DRAWN BY:	ACR	HORIZ.	15	OF 19	ECDT04
CHECKED BY:	DRK	VERT.			

FOR AND ON BEHALF OF

MATRIX DESIGN GROUP, INC.

PROJECT No. 20.995.002