

EROSION CONTROL LEGEND: LEGEND:

(VTC)	VEHICLE TRACKING CONTROL PAD	---	PROPOSED PROPERTY LINE
(SF)	SILT FENCE	---	EXISTING CONTOURS
(SM)	SEED & MULCH	---	PROPOSED CONTOURS
(CWA)	CONCRETE WASHOUT AREA (TO BE COMPLETELY CONTAINED & REMOVED UPON COMPLETION OF PROJECT)	X 31.5	EXISTING SPOT ELEVATIONS
(IP)	INLET PROTECTION	X 31.5	PROPOSED SPOT ELEVATIONS
(RG)	RAIN GARDEN	-1.0%	PROPOSED GRADES
(RR)	RIPRAP APRON	DS →	ROOF DRAIN DOWNSPOUTS W/SPLASH BLOCKS

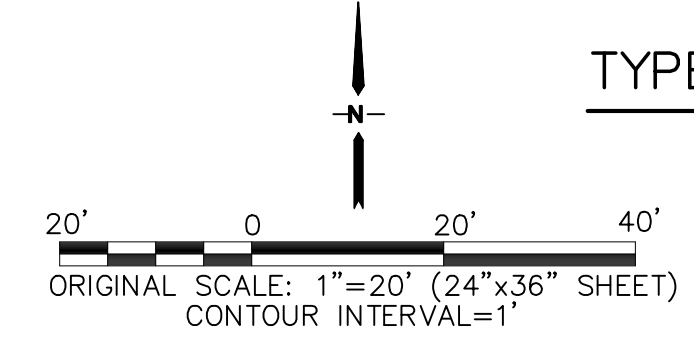
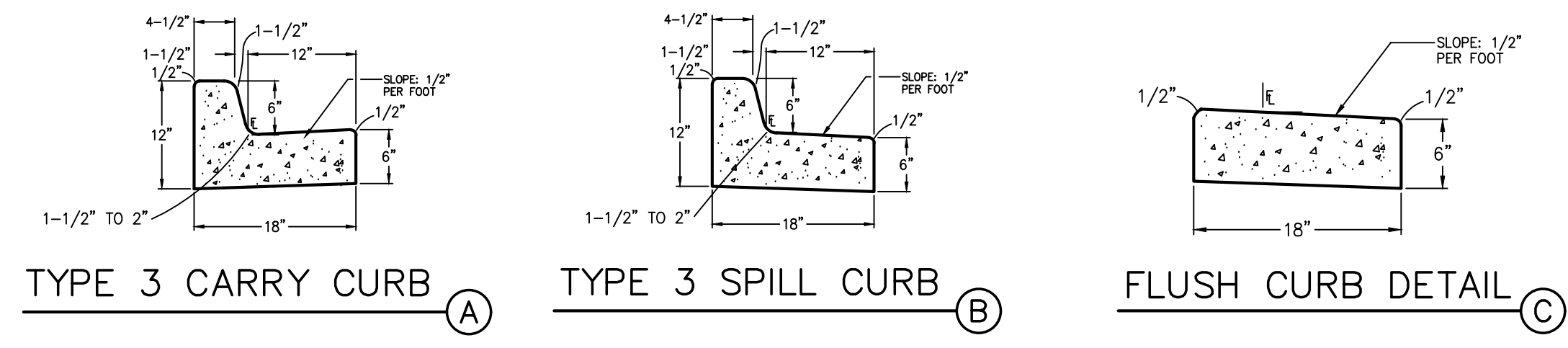

- KEYED NOTES:**
- 1 TOPSOIL STRIPPING / STOCKPILE AREA
 - 2 SITE PAVEMENT (PER GEOTECHNICAL REPORT); MIN. 4" FULL-DEPTH ASPHALT
 - 3 PREPARE & COMPACT BUILDING FOUNDATION PER PROJECT GEOTECHNICAL REPORT

- HANDICAP ACCESS NOTES:**
1. RAMPS ARE NOT TO BE PLACED IN HANDICAP ACCESS AISLES.
 2. ACCESS AISLES MAY NOT EXCEED A 2% (1:48) SLOPE IN ANY DIRECTION.
 3. HANDICAP RAMPS MAY NOT EXCEED A SLOPE OF 8% (1:12).
 4. THE MINIMUM WIDTH FOR HANDICAPPED RAMPS IS 36 INCHES. THE SIDES OF RAMPS MAY NOT EXCEED A SLOPE OF 10% UNLESS PROTECTED WITH A HANDRAIL.
 5. HANDICAPPED PARKING SHALL MEET ALL OTHER APPLICABLE CITY AND ADA CODE REQUIREMENTS.

ESTIMATED EARTHWORK QUANTITY:
 UNCLASSIFIED EXCAVATION (TOTAL CUT) = 45 CY
 * EMBANKMENT FILL = 320 CY
 NET (FILL) = 275 CY
 * (ASSUMES 15% COMPACTION FACTOR)

NOTE: THIS ESTIMATE IS PROVIDED FOR INFORMATION ONLY, REPRESENTING THE CALCULATED BULK EARTHWORK VOLUME TO FINISHED GRADE, EXCLUDING ANY ADJUSTMENT FOR PAVEMENT DEPTHS, ETC. CONTRACTOR SHALL MAKE HIS OWN DETERMINATION OF EARTHWORK QUANTITIES AS BASIS FOR BID PRICING AND NOTIFY ENGINEER OF ANY DISCREPANCIES.

Include the standard signature blocks and a sheet index.

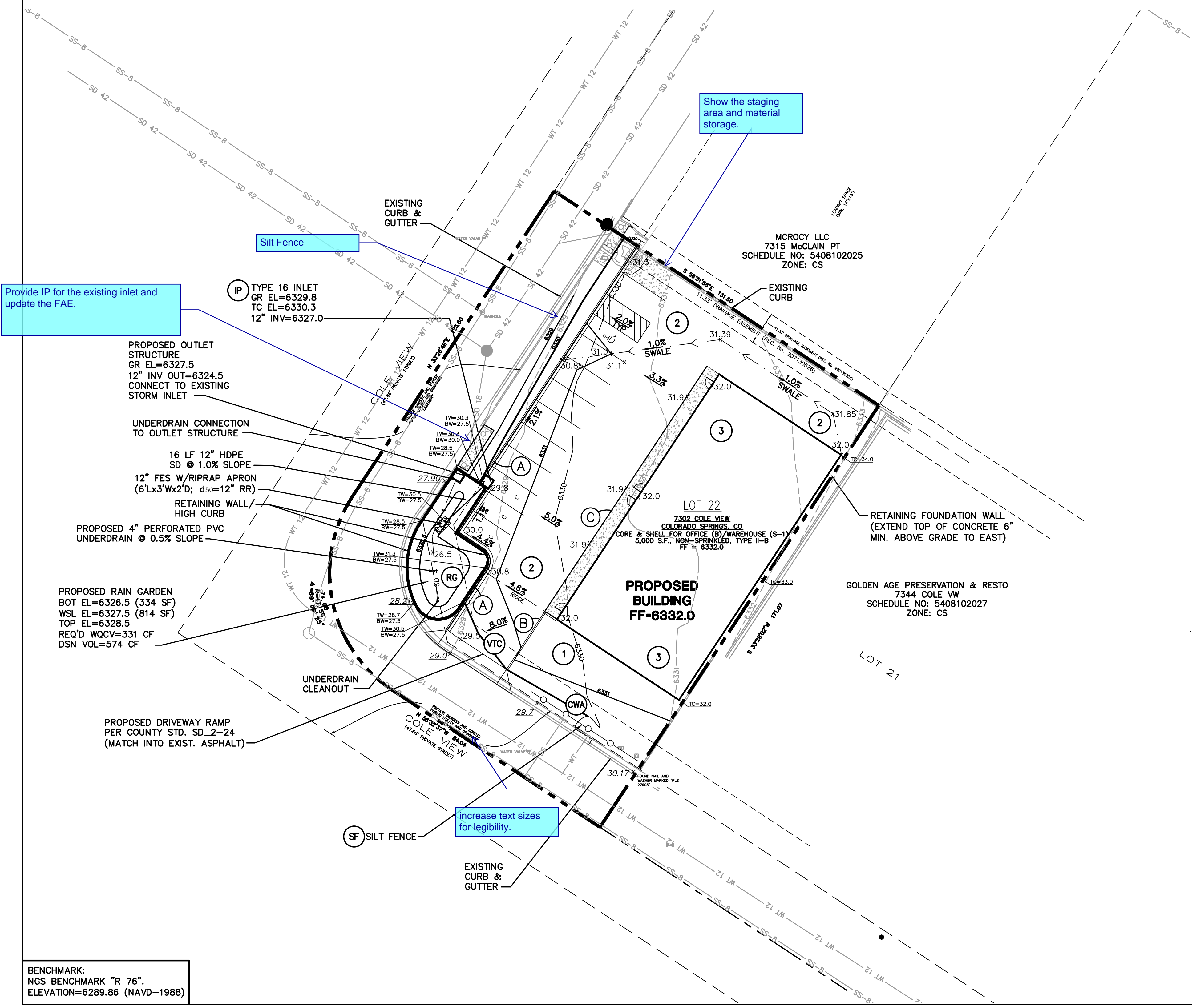

BENCHMARK:
 NGS BENCHMARK "R 76".
 ELEVATION=6289.86 (NAVD-1988)

WETHERBEE OFFICE / WAREHOUSE BUILDING
 7302 COLE VIEW, COLORADO SPRINGS, COLORADO 80915

JPS ENGINEERING
 19 E. Willamette Ave.
 Colorado Springs, CO 80903
 PH: 719-477-9429
 FAX: 719-471-0766
 www.jpsengr.com

CALL UTILITY NOTIFICATION CENTER OF COLORADO
 1-800-922-1987
 CALL 2-BUSINESS DAYS IN ADVANCE BEFORE YOU DIG, GRADE, OR EXCAVATE TO AVOID HAZARDOUS UNDERGROUND MEMBER UTILITIES.

NO.	REVISION	DATE	BY
1	DP SUBMITTAL	10/04/18	JPS

SITE GRADING & EROSION CONTROL PLAN

HORZ. SCALE: 1"=20'	DRAWN: BJJ
VERT. SCALE: N/A	DESIGNED: JPS
SURVEYED: COMPASS	CHECKED: JPS
CREATED: 9/12/18	LAST MODIFIED: 10/04/18
PROJECT NO: 081803	MODIFIED BY: BJJ

C1.1

PCD PROJECT NO. PPR-XX

STANDARD NOTES FOR EL PASO COUNTY GRADING AND EROSION CONTROL PLANS:

- Construction may not commence until a Construction Permit is obtained from Development Services and a Preconstruction Conference is held with Development Services Inspectors.
- Stormwater discharges from construction sites shall not cause or threaten to cause pollution, contamination, or degradation of State Waters. All work and earth disturbance shall be done in a manner that minimizes pollution of any on-site or off site waters, including wetlands.
- Notwithstanding anything depicted in these plans in words or graphic representation, all design and construction related to roads, storm drainage and erosion control shall conform to the standards and requirements of the most recent version of the relevant adopted El Paso County standards, including the Land Development Code, the Engineering Criteria Manual, the Drainage Criteria Manual, and the Drainage Criteria Manual Volume 2. Any deviations to regulations and standards must be requested, and approved, in writing.
- A separate Stormwater Management Plan (SMWP) for this project shall be completed and an Erosion and Stormwater Quality Control Permit (ESQCP) issued prior to commencing construction. During construction the SWMP is the responsibility of the designated Stormwater Manager, shall be located on site at all times and shall be kept up to date with work progress and changes in the field.
- Once the ESQCP has been issued, the contractor may install the initial stage erosion and sediment control BMPs as indicated on the GEC. A preconstruction meeting between the contractor, engineer, and El Paso County will be held prior to any construction. It is the responsibility of the applicant to coordinate the meeting time and place with County DSD inspections staff.
- Soil erosion control measures for all slopes, channels, ditches, or any disturbed land area shall be completed within 21 calendar days after final grading, or final earth disturbance, has been completed. Disturbed areas and stockpiles which are not at final grade but will remain dormant for longer than 30 days shall also be mulched within 21 days after interim grading. An area that is going to remain in an interim state for more than 60 days shall also be seeded. All temporary soil erosion control measures and BMPs shall be maintained until permanent soil erosion control measures are implemented and established.
- Temporary soil erosion control facilities shall be removed and earth disturbance areas graded and stabilized with permanent soil erosion control measures pursuant to standards and specification prescribed in the DCM Volume II and the Engineering Criteria Manual (ECM) appendix I.
- All persons engaged in earth disturbance shall implement and maintain acceptable soil erosion and sediment control measures including BMPs in conformance with the erosion control technical standards of the Drainage Criteria Manual (DCM) Volume II and in accordance with the Stormwater Management Plan (SMWP).
- All temporary erosion control facilities including BMPs and all permanent facilities intended to control erosion of any earth disturbance operations, shall be installed as defined in the approved plans, the SWMP and the DCM Volume II and maintained throughout the duration of the earth disturbance operation.
- Any earth disturbance shall be conducted in such a manner so as to effectively reduce accelerated soil erosion and resulting sedimentation. All disturbances shall be designed, constructed, and completed so that the exposed area of any disturbed land shall be limited to the shortest practical period of time.
- Any temporary or permanent facility designed and constructed for the conveyance of stormwater around, through, or from the earth disturbance area shall be designed to limit the discharge to a non-erosive velocity.
- Concrete wash water shall be contained and disposed of in accordance with the SWMP. No wash water shall be discharged to or allowed to runoff to State Waters, including any surface or subsurface storm drainage system or facilities.
- Erosion control blanketing is to be used on slopes steeper than 3:1.
- Building, construction, excavation, or other waste materials shall not be temporarily placed or stored in the street, alley, or other public way, unless in accordance with an approved Traffic Control Plan. BMPs may be required by El Paso County Engineering if deemed necessary, based on specific conditions and circumstances.
- Vehicle tracking of soils and construction debris off-site shall be minimized. Materials tracked offsite shall be cleaned up and properly disposed of immediately.
- Contractor shall be responsible for the removal of all wastes from the construction site for disposal in accordance with local and State regulatory requirements. No construction debris, tree slash, building material wastes or unused building materials shall be buried, dumped, or discharged at the site.
- The owner, site developer, contractor, and/or their authorized agents shall be responsible for the removal of all construction debris, dirt, trash, rock, sediment, and sand that may accumulate in the storm sewer or other drainage conveyance system and stormwater appurtenances as a result of site development.
- The quantity of materials stored on the project site shall be limited, as much as practical, to that quantity required to perform the work in an orderly sequence. All materials stored on-site shall be stored in a neat, orderly manner, in their original containers, with original manufacturer's labels.
- No chemicals are to be used by the contractor, which have the potential to be released in stormwater unless permission for the use of a specific chemical is granted in writing by the ECM Administrator. In granting the use of such chemicals, special conditions and monitoring may be required.
- Bulk storage structures for petroleum products and other chemicals shall have adequate protection so as to contain all spills and prevent any spilled material from entering State Waters, including any surface or subsurface storm drainage system or facilities.
- No person shall cause the impediment of stormwater flow in the flow line of the curb and gutter or in the ditchline.
- Individuals shall comply with the "Colorado Water Quality Control Act" (Title 25, Article 8, CRS), and the "Clean Water Act" (33 USC 1344), in addition to the requirements included in the DCM Volume II and the ECM Appendix I. All appropriate permits must be obtained by the contractor prior to construction (NPDES, Floodplain, 404, fugitive dust, etc.). In the event of conflicts between these requirements and laws, rules, or regulations of other Federal, State, or County agencies, the more restrictive laws, rules, or regulations shall apply.
- All construction traffic must enter/exit the site at approved construction access points.
- Prior to actual construction the permittee shall verify the location of existing utilities.
- A water source shall be available on site during earthwork operations and utilized as required to minimize dust from earthwork equipment and wind.
- The preliminary soils report for this site prepared by Entech Engineering, dated 2/18/13 shall be considered a part of these plans.
- At least ten days prior to the anticipated start of construction, for projects that will disturb 1 acre or more, the owner or operator of construction activity shall submit a permit application for stormwater discharge to the Colorado Department of Public Health and Environment, Water Quality Division. The application contains certification of completion of a stormwater management plan (SWMP), of which this grading and erosion control plan may be a part. For information or application materials contact:

Colorado Department of Public Health and Environment
 Water Quality Control Division
 WQCD - Permits
 4300 Cherry Creek Drive South
 Denver, CO 80246-1530
 Attn: Permits Unit

ESTIMATED TIME SCHEDULE:

INSTALL BMP'S NOVEMBER, 2018
 SITE GRADING NOVEMBER, 2018
 SEEDING & MULCHING AUGUST, 2019
 STABILIZATION AUGUST, 2020
 TOTAL DISTURBED AREA: 0.5 ACRES
 RECEIVING WATERS: SAND CREEK

EXISTING VEGETATION:

NATIVE GRASSES (APPROXIMATELY 70 PERCENT COVERAGE)

SEEDING MIX:

GRASS	VARIETY	AMOUNT IN PLS LBS. PER ACRE
CRESTED WHEAT GRASS	EPHRAIM OR HYCREST	4.0 LBS.
PERENNIAL RYE	LINN	2.0 LBS.
WESTERN WHEATGRASS	SARTON	3.0 LBS.
SMOOTH BROME GRASS	LINCOLN OR MANCHAR	5.0 LBS.
SIDEOATS GRAMA	EPHRAIM	2.5 LBS.
TOTAL:		16.5 LBS.

SEEDING & FERTILIZER APPLICATION: DRILL SEED OR HYDRO-SEED PER CDOT SPEC. SECTION 212.

MULCHING APPLICATION: CONFORM TO CDOT SPEC-SECTION 213.

SEDIMENT CONTROL MAINTENANCE PROGRAM:

PERIODIC SITE INSPECTIONS BI-WEEKLY
 RE-VEGETATION OF EXPOSED SOILS WITHIN 21 DAYS OF GRADING
 SEDIMENT REMOVAL FROM BMP'S MONTHLY
 REMOVAL OF BMP'S AFTER STABILIZATION ACHIEVED

- AND AFTER ANY PRECIPITATION OR SNOW MELT EVENT THAT CAUSES SURFACE EROSION.
- ACCUMULATED SEDIMENT AND DEBRIS SHALL BE REMOVED WHEN THE SEDIMENT LEVEL REACHES ONE HALF THE HEIGHT OF THE BMP OR AT ANY TIME THAT SEDIMENT OR DEBRIS ADVERSELY IMPACTS THE FUNCTION OF THE BMP.

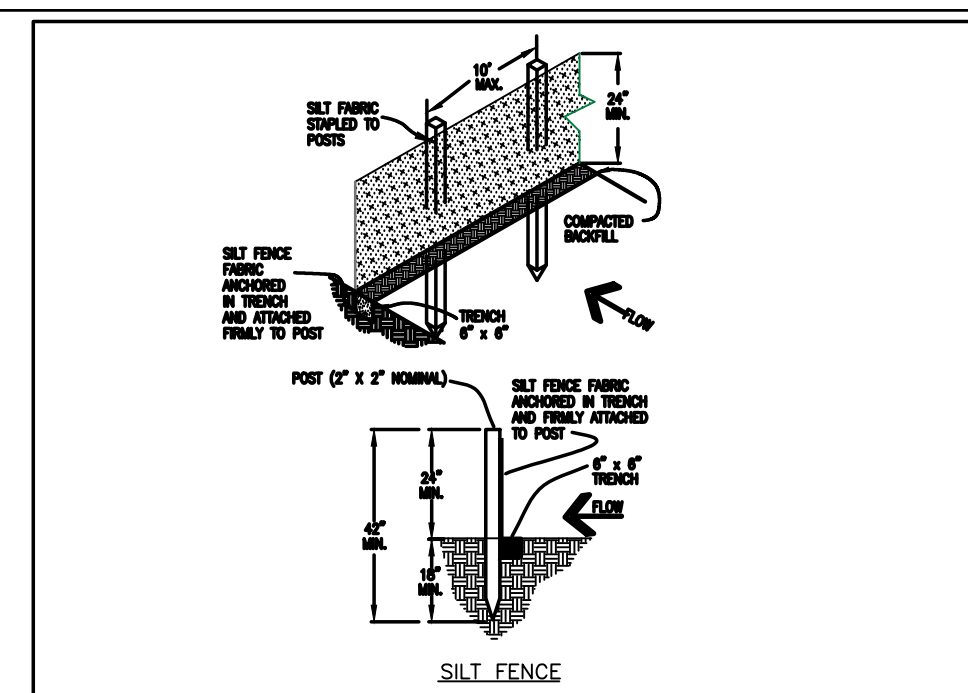

SILT FENCE NOTES

INSTALLATION REQUIREMENTS

- SILT FENCES SHALL BE INSTALLED PRIOR TO ANY LAND DISTURBANCE ACTIVITIES.
- WHEN JOISTS ARE NECESSARY, SILT FENCE GEOTEXTILE SHALL BE SPACED TOGETHER ONLY AT SUPPORT POSTS AND SECURELY SEALED.
- METAL POSTS SHALL BE "STUDDIED TEE" OR "C" TYPE WITH MINIMUM HEIGHT OF 1.33 FEET PER LINEAR FOOT. WOOD POSTS SHALL HAVE A MINIMUM DIAMETER OF CROSS SECTION DIMENSION OF 2 INCHES.
- THE FILTER MATERIAL SHALL BE FASTENED SECURELY TO METAL OR WOOD POSTS USING WIRE TIES, OR TO WOOD POSTS WITH 3/4" LONG BY 1/4" DIA. NAILS. THE SILT FENCE GEOTEXTILE SHALL NOT BE STAPLED TO EXISTING TREES.
- WHILE NOT REQUIRED, WIRE MESH FENCE MAY BE USED TO SUPPORT THE GEOTEXTILE. WIRE FENCE SHALL BE FASTENED SECURELY TO THE UPDROPE SIDE OF THE POSTS USING HEAVY DUTY WIRE STAPLES AT LEAST 1/4" LONG. THE WIRE OR HOE RINGS, THE WIRE SHALL EXTEND INTO THE FENCE A MINIMUM OF 3" AND SHALL NOT EXTEND MORE THAN 7" ABOVE THE ORIGINAL GROUND SURFACE.
- ALONG THE TOE OF FILL, INSTALL THE SILT FENCE AS LINE AT ELEV. CONTROL AND PROVIDE AN AREA BEHIND THE FENCE FOR RUNOFF TO POND AND SEDIMENT TO SETTLE. A MINIMUM DISTANCE OF 5 FEET FROM THE TOE OF THE FILL IS RECOMMENDED.
- THE HEIGHT OF THE SILT FENCE FROM THE GROUND SURFACE SHALL BE MINIMUM OF 2 FEET AND SHALL NOT EXCEED 36 INCHES. HIGHER FENCES MAY IMPROVE VOLUMES OF WATER SUFFICIENT TO CAUSE FAILURE OF THE STRUCTURE.

MAINTENANCE REQUIREMENTS

- CONTRACTOR SHALL INSPECT SILT FENCES DAILY DURING PROLONGED RAINFALL AND WEEKLY DURING OTHER WEATHER CONDITIONS. DAMAGED OR INEFFECTIVE SILT FENCES SHALL BE PROMPTLY REPAIRED OR REPLACED.
- SEDIMENT SHALL BE REMOVED FROM BEHIND SILT FENCE WHEN IT ACCUMULATES TO 1/2 THE EXPOSED GEOTEXTILE HEIGHT.
- SILT FENCES SHALL BE REMOVED WHEN ADEQUATE VEGETATIVE COVER IS ATTAINED AS APPROVED BY THE CITY.

City of Colorado Springs Stormwater Quality Figure SF-2 Silt Fence Construction Detail and Maintenance Requirements

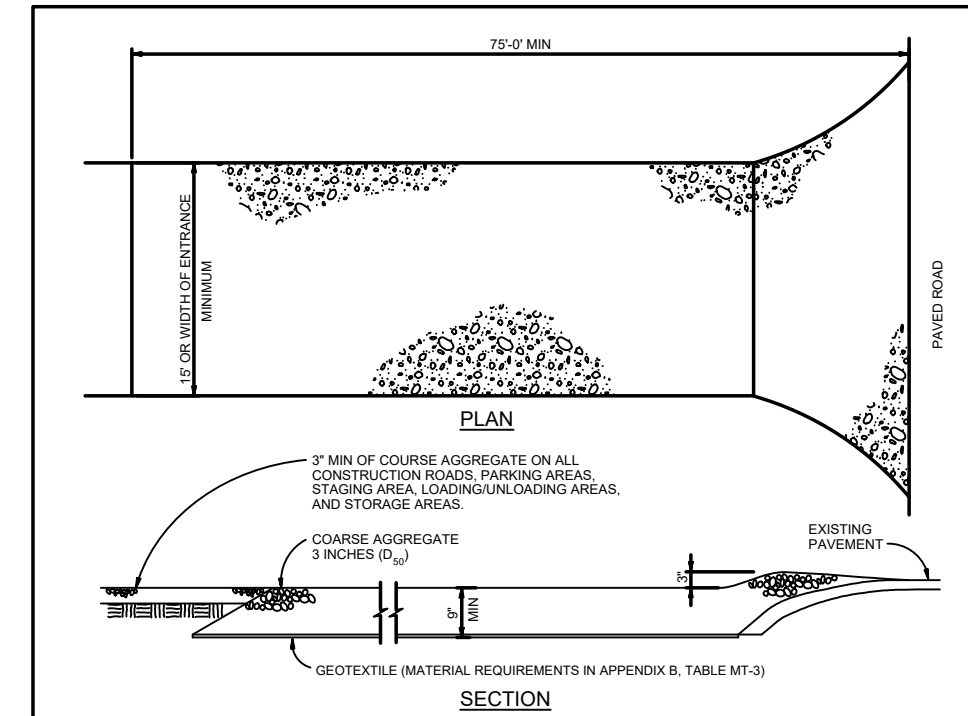

VEHICLE TRACKING

INSTALLATION REQUIREMENTS

- ALL ENTRANCES TO THE CONSTRUCTION SITE ARE TO BE STABILIZED PRIOR TO CONSTRUCTION BEGINNING.
- CONSTRUCTION ENTRANCES ARE TO BE BUILT WITH AN APPROX. 1/4" DEPTH OF CURBING TRAFFIC, BUT SHOULD NOT BE BUILT OVER EXISTING PAVEMENT EXCEPT FOR A SHORT OVERLAP.
- AREAS TO BE STABILIZED ARE TO BE PROPERLY GRADED AND COMPACTED PRIOR TO LAYING DOWN GEOTEXTILE AND STONE.
- CONSTRUCTION ROADWAYS, PARKING AREAS, LOADING/UNLOADING ZONES, STORAGE AREAS, AND STAGING AREAS ARE TO BE STABILIZED.
- CONSTRUCTION ROADS ARE TO BE BUILT TO CONFORM TO 8:1 GRADES, BUT SHOULD NOT HAVE SIDE SLOPES OR ROAD GRADES THAT ARE EXCESSIVELY STEEP.

MAINTENANCE REQUIREMENTS

- REGULAR INSPECTIONS ARE TO BE MADE OF ALL STABILIZED AREAS, ESPECIALLY AFTER STORM EVENTS.
- STONES ARE TO BE REAPPLIED PERIODICALLY AND WHEN REPAIR IS NECESSARY.
- SEDIMENT TRACKED OVER PAVED ROADWAYS IS TO BE REMOVED DAILY BY SHOVELING OR SWEEPING. SEDIMENT IS NOT TO BE WASHED DOWN STORM SEWER DRAINS.
- STORM SEWER INLET PROTECTION IS TO BE IN PLACE, INSPECTED, AND CLEANED IF NECESSARY.
- OTHER ASSOCIATED SEDIMENT CONTROL MEASURES ARE TO BE INSPECTED TO ENSURE GOOD WORKING CONDITION.

City of Colorado Springs Stormwater Quality Figure VT-2 Vehicle Tracking Application Examples

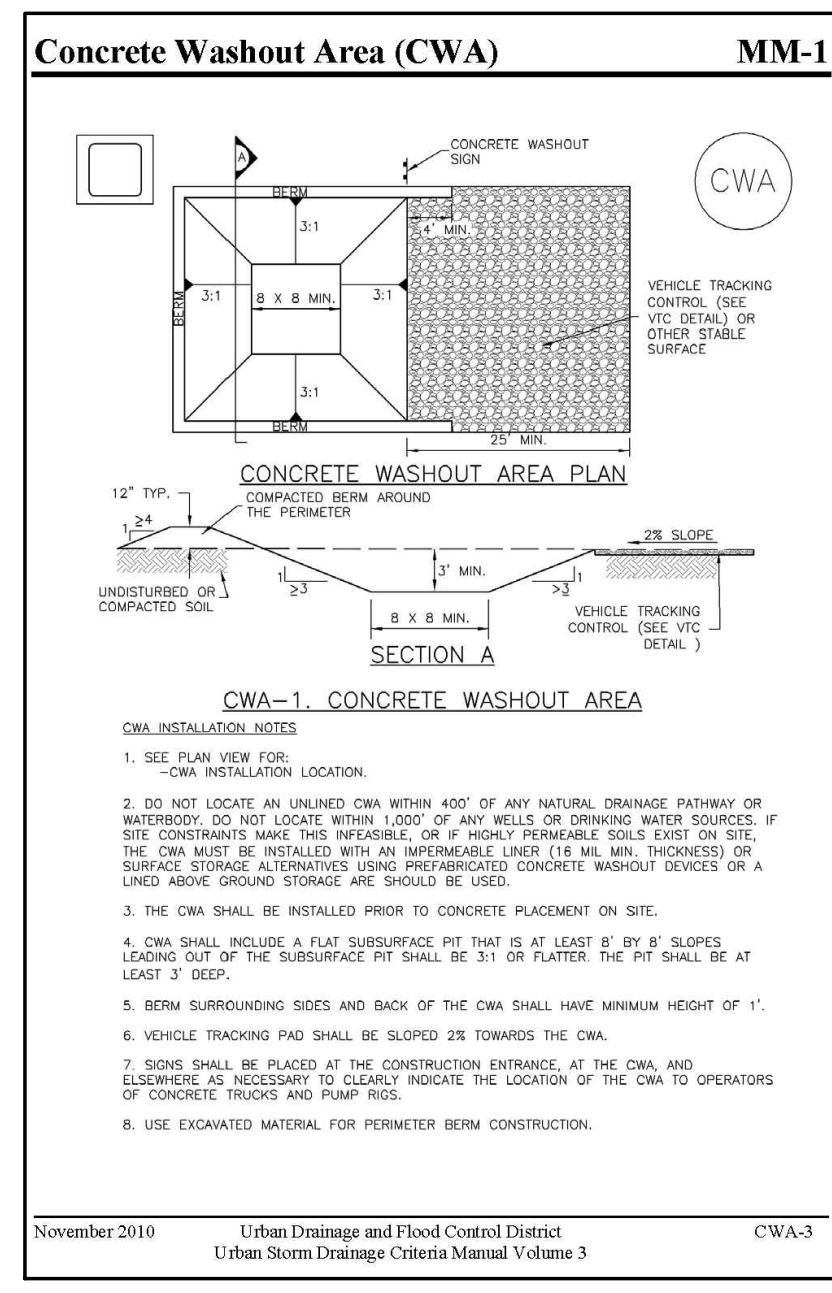

CONCRETE WASHOUT AREA (CWA) MM-1

CONCRETE WASHOUT AREA PLAN

SECTION A

CWA-1, CONCRETE WASHOUT AREA

CWA INSTALLATION NOTES

- SEE PLAN VIEW FOR "CWA" INSTALLATION LOCATION.
- DO NOT LOCATE AN UNLINED CWA WITHIN 400' OF ANY NATURAL DRAINAGE PATHWAY OR WATERBODY. DO NOT LOCATE WITHIN 1,000' OF ANY WELLS OR DRINKING WATER SOURCES. IF SITE CONDITIONS MAKE THIS IMPOSSIBLE, OR IF HIGHLY PERMEABLE SOILS EXIST ON SITE, THE CWA MUST BE INSTALLED WITH AN IMPERMEABLE LINER (16 MIL MIN. THICKNESS) OR SURFACE STORAGE AS DETAILED USING PRECAST CONCRETE WASHOUT DEVICES OR A LINED ABOVE GROUND STORAGE TANK AS SHOWN ON THESE PLANS.
- THE CWA SHALL BE INSTALLED PRIOR TO CONCRETE PLACEMENT ON SITE.
- CWA SHALL INCLUDE A FLAT SUBSURFACE PIT THAT IS AT LEAST 8" BY 8" SLOPES LEADING OUT OF THE SUBSURFACE PIT SHALL BE 3:1 OR FLATTER. THE PIT SHALL BE AT LEAST 3' DEEP.
- BENCH SURROUNDING SIDES AND BACK OF THE CWA SHALL HAVE MINIMUM HEIGHT OF 1'.
- VEHICLE TRACKING PAD SHALL BE SLOPED 2% TOWARDS THE CWA.
- SEWER SHALL BE PLACED AT THE CONSTRUCTION ENTRANCE AT THE CWA, AND CLEARANCE AS NECESSARY TO CLEARLY REMOVE THE LOCATION OF THE CWA TO OPERATORS OF CONCRETE TRUCKS AND PUMP TRUCKS.
- USE EXCAVATED MATERIAL FOR PERIMETER BENCH CONSTRUCTION.

November 2010 Urban Drainage and Flood Control District Urban Storm Drainage Criteria Manual Volume 3 CWA-3

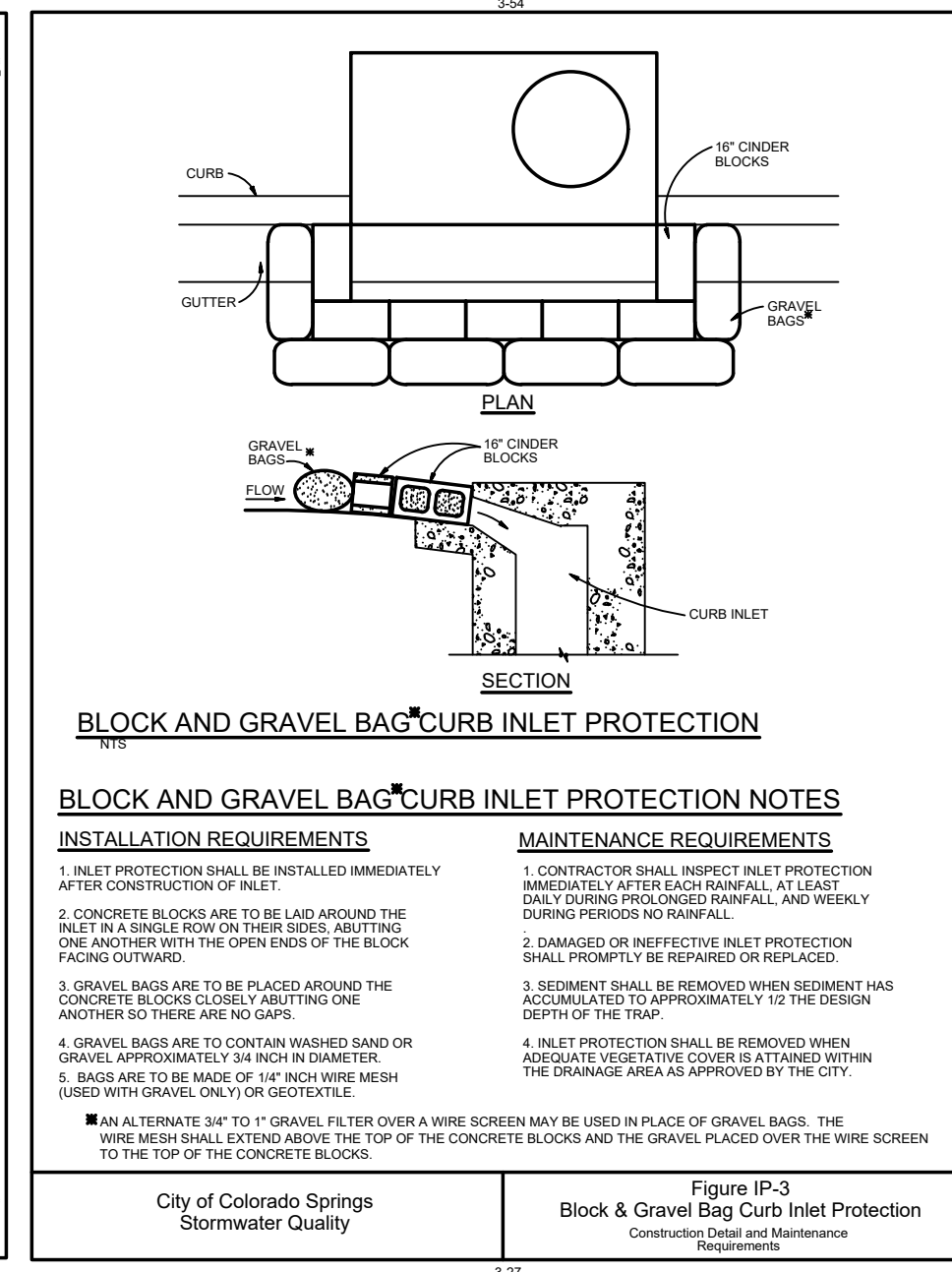

BLOCK AND GRAVEL BAG CURB INLET PROTECTION

BLOCK AND GRAVEL BAG CURB INLET PROTECTION NOTES

INSTALLATION REQUIREMENTS

- INLET PROTECTION SHALL BE INSTALLED IMMEDIATELY AFTER CONSTRUCTION OF INLET.
- CONCRETE BLOCKS ARE TO BE Laid AROUND THE INLET IN A SINGLE ROW ON THEIR SIDES ADJACENT ONE ANOTHER WITH THE OPEN ENDS OF THE BLOCK FACING OUTWARD.
- GRAVEL BAGS ARE TO BE PLACED AROUND THE CONCRETE BLOCKS CLOSELY ADJACENT ONE ANOTHER SO THERE ARE NO GAPS.
- GRAVEL BAGS ARE TO COVER HANDED SAND OR GRAVEL APPROXIMATELY 3/4 INCH IN DIAMETER.
- BAGS ARE TO BE MADE OF 1/4" WIRE WIRE MESH (USED WITH GRAVEL ONLY) OR GEOTEXTILE.
- ALL ALTERNATE 3/4" TO 1" GRAVEL FILTER OVER A WIRE SCREEN MAY BE USED IN PLACE OF GRAVEL BAGS. THE WIRE MESH SHALL EXTEND ABOVE THE TOP OF THE CONCRETE BLOCKS AND THE GRAVEL PLACED OVER THE WIRE SCREEN TO THE TOP OF THE CONCRETE BLOCKS.

MAINTENANCE REQUIREMENTS

- INLET PROTECTION SHALL BE REMOVED IMMEDIATELY AFTER EACH RAINFALL AT LEAST ONE DAY DURING PROLONGED RAINFALL AND WEEKLY DURING PERIODS NO RAINFALL.
- DAMAGED OR INEFFECTIVE INLET PROTECTION SHALL PROMPTLY BE REPAIRED OR REPLACED.
- SEDIMENT SHALL BE REMOVED WHEN SEDIMENT HAS ACCUMULATED TO APPROXIMATELY 1/2 THE DESIGN DEPTH OF THE TRAP.
- INLET PROTECTIVE SHALL BE REMOVED WHEN ADEQUATE VEGETATIVE COVER IS ATTAINED WITHIN THE DRAINAGE AREA AS APPROVED BY THE CITY.

City of Colorado Springs Stormwater Quality Figure IP-3 Block & Gravel Bag Curb Inlet Protection Construction Detail and Maintenance Requirements

WETHERBEE OFFICE / WAREHOUSE BUILDING
 7302 COLE VIEW, COLORADO SPRINGS, COLORADO 80915

GRADING & EROSION CONTROL NOTES & DETAILS

CALL UTILITY NOTIFICATION CENTER OF COLORADO
 1-800-922-1987
 CALL TO DETERMINE DEPT. IN ADVANCE BEFORE YOU DIG, GRADE, OR EXCAVATE FOR THE MARKING OF UNDERGROUND MEMBER UTILITIES.

NO.	REVISION	DATE

HORIZ. SCALE: N/A DRAWN: BJJ
 VERT. SCALE: N/A DESIGNED: JPS
 SURVEYED: N/A CHECKED: JPS
 CREATED: COMPASS 10/04/18 LAST MODIFIED: 10/04/18
 PROJECT NO: 081803 MODIFIED BY: BJJ
 SHEET: C3

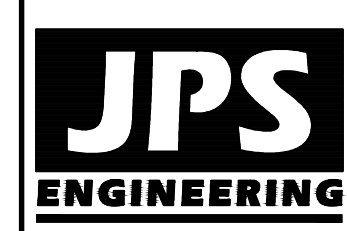

19 E. Willamette Ave.
 Colorado Springs, CO 80903
 PH: 719-477-9429
 FAX: 719-471-0766
 www.jpsegr.com

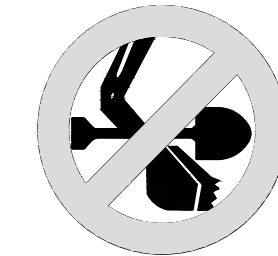

CALL UTILITY NOTIFICATION CENTER OF COLORADO
 1-800-922-1987
 CALL TO DETERMINE DEPT. IN ADVANCE BEFORE YOU DIG, GRADE, OR EXCAVATE FOR THE MARKING OF UNDERGROUND MEMBER UTILITIES.

GRADING & EROSION CONTROL NOTES & DETAILS

HORIZ. SCALE: N/A DRAWN: BJJ
 VERT. SCALE: N/A DESIGNED: JPS
 SURVEYED: N/A CHECKED: JPS
 CREATED: COMPASS 10/04/18 LAST MODIFIED: 10/04/18
 PROJECT NO: 081803 MODIFIED BY: BJJ
 SHEET: C3