

# Widefield Parks and Recreation Facility Expansion Widefield School District 3 Site Development Plan

**General Information:**

Project Address:  
755 Aspen Drive, Colorado Springs, CO 80911

Tax Schedule number:  
Exempt/Political Subs/Pub Schl

Parcel Size:  
39.26 Acres

Existing/Proposed Land Use and Zoning:  
AS CAD-0/AS CAD-0

Total Gross Building Sq Footage (New Building):  
61,145 SF

Total Gross Building Coverage Area  
New Building: 44,676 SF  
Existing Buildings: 24,498 SF

Lot Coverage Calculation (69,174/1,729,429) = 4%

Open Space	Landscaping	Impermeable
4%	61%	18%

Parking spaces to be provided:  
On-Site: 415  
Adjacent-Street: 52 (Widlock)

Total Spaces	Bid Alternate
467	52

Parking per LDC/Use

Requirement	Building Area/Qty	Total
22 (per field)	5 fields	110
1 sp/400 sf	5,840	15
1 sp/150 sf	3,744	25
1 sp/200 sf	936	10
1 sp/150 sf	2,744	18
1 sp/150 sf	56,544	378
1 sp/400 sf	1,505	4
1 sp/200 sf	3,096	16
<b>Total</b>		<b>576</b>

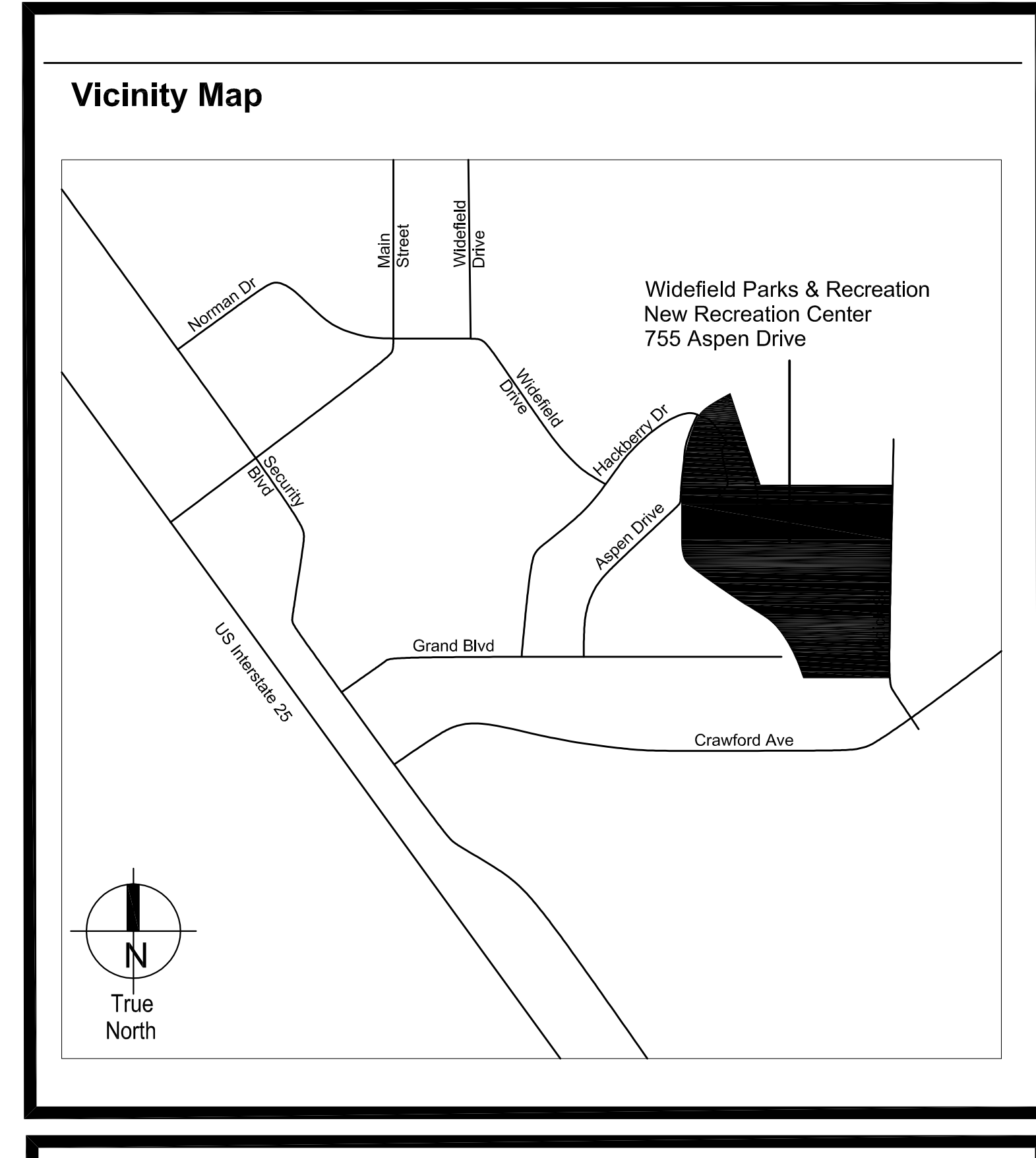

**LEGAL DESCRIPTIONS**

**PARCEL A - BOOK 3000, PAGE 506**

A TRACT OF LAND LYING IN THE SOUTHEAST 1/4 OF THE SOUTHWEST 1/4 OF SECTION 12, THE NORTHEAST 1/4 OF THE NORTHWEST 1/4 OF SECTION 13, AND THE NORTHWEST 1/4 OF THE NORTHEAST 1/4 OF SECTION 13, TOWNSHIP 15 SOUTH, RANGE 66 WEST OF THE 6TH P.M., EL PASO COUNTY, COLORADO, BEING MORE PARTICULARLY DESCRIBED AS FOLLOWS:

BEGINNING AT THE SOUTHEAST CORNER OF SECURITY, COLORADO ADDITION NO. 5, EL PASO COUNTY, COLORADO AS SHOWN ON THE RECORDED PLAT THEREOF AS RECORDED IN PLAT BOOK V AT PAGE 64 OF THE RECORDS OF EL PASO COUNTY; THENCE, ALONG AND IDENTICAL WITH THE EASTERLY LINE OF ADDITION NO. 5 AS FOLLOWS:

NORTHWESTERLY, A DISTANCE OF 191.75 FEET; THENCE, ANGLE LEFT 15° 5' 15", A DISTANCE OF 152.95 FEET; THENCE, ANGLE LEFT 7° 33', A DISTANCE OF 197.36 FEET; THENCE ANGLE LEFT 12° 48', A DISTANCE OF 405.34 FEET; THENCE, ANGLE RIGHT 10° 14', A DISTANCE OF 220.29 FEET; THENCE, ANGLE RIGHT 43° 25' 30", A DISTANCE OF 209.81 FEET TO THE SOUTHEAST CORNER OF REFLING OF LOT 1, BLOCK 8, LOTS 1 AND 2, BLOCK 9, AND LOT 1, BLOCK 13, SECURITY, COLORADO ADDITION NO. 5 AS SHOWN ON THE RECORDED PLAT THEREOF AS RECORDED IN PLAT BOOK X AT PAGE 49 OF THE RECORDS OF EL PASO COUNTY;

THENCE, CONTINUING ALONG AND IDENTICAL WITH THE EASTERLY LINE OF SAID REFLING, ANGLE LEFT 6° 00' 45", A DISTANCE OF 108.89 FEET; THENCE, ANGLE LEFT 4° 50' 30", A DISTANCE OF 38.78 FEET; THENCE, ALONG A CURVE TO THE LEFT WHOSE RADIUS IS 132.55 FEET, WHOSE CENTRAL ANGLE IS 47° 42' 20", AND WHOSE TANGENT ANGLES RIGHT 62° 05' 25" AN ARC DISTANCE OF 110.40 FEET; THENCE, ALONG THE TANGENT PRODUCED, NORTHERLY, A DISTANCE OF 127.66 FEET; THENCE, ALONG A CURVE TO THE RIGHT WHOSE RADIUS IS 315.52 FEET AND WHOSE CENTRAL ANGLE IS 73° 30', AN ARC DISTANCE OF 41.90 FEET; THENCE, ALONG THE TANGENT PRODUCED, NORTHERLY, A DISTANCE OF 160.49 FEET; THENCE, ALONG A CURVE TO THE RIGHT WHOSE RADIUS IS 266.08 FEET AND WHOSE CENTRAL ANGLE IS 17° 24' 15", AN ARC DISTANCE OF 81.01 FEET; THENCE, ALONG THE TANGENT PRODUCED, NORTHEASTERLY, A DISTANCE OF 110.27 FEET TO A POINT ON THE SOUTH LINE OF A TRACT OF LAND PREVIOUSLY CONVEYED BY ELMER C. SPROUL TO THE COLORADO DISTRICT - CHURCH OF THE NAZARENE, A COLORADO CORPORATION BY A DEED DATED MAY 17, 1962 AND RECORDED IN BOOK 1911 AT PAGE 992 OF THE RECORDS OF EL PASO COUNTY;

THENCE, CONTINUED ALONG AND IDENTICAL WITH THE SOUTHEAST LINE OF THE AFORESAID TRACT, ANGLE RIGHT 2° 29' 28", A DISTANCE OF 232.99 FEET; THENCE, ANGLE RIGHT 30° 07' 32", A DISTANCE OF 180.38 FEET; THENCE, DEPARTING FROM SAID TRACT, ANGLE RIGHT 110° 15' 55", SOUTHERLY, A DISTANCE OF 219.81 FEET TO THE POINT OF BEGINNING, EXCEPTING THEREFROM ANY PART THEREOF LYING WEST OF THE BOUNDARY LINE AS DELINEATED IN THE BOUNDARY AGREEMENT RECORDED DECEMBER 20, 1956 IN BOOK 1607 AT PAGE 387.

**PARCEL B - BOOK 6560, PAGE 12**

A TRACT OF LAND LOCATED IN THE NORTH ONE-HALF (1/2) OF SECTION 13, TOWNSHIP 15 SOUTH, RANGE 66 WEST OF THE 6TH P.M., EL PASO COUNTY, COLORADO, BEING MORE PARTICULARLY DESCRIBED AS FOLLOWS:

BEARINGS FOR THIS DESCRIPTION ARE BASED ON THE NORTHEASTERLY RIGHT-OF-WAY LINE OF WIDOCK STREET, AS SHOWN ON THE RECORDED PLAT OF FOUNTAIN VALLEY RANCH SUBDIVISION FILING NO. 1, AS RECORDED IN PLAT BOOK Z-3, AT PAGE 40 OF THE RECORDS OF EL PASO COUNTY, COLORADO, BEING N 36°08'02" W, A DISTANCE OF 153.16 FEET.

BEGINNING AT THE NORTHWEST CORNER OF THAT TRACT OF LAND DESCRIBED IN BOOK 5426 AT PAGE 118 OF SAID RECORDS, HEREAFTER BEING KNOWN AS TRACT 'A'; SAID POINT BEING ALSO ON THE EAST LINE OF THAT PARCEL OF LAND DESCRIBED IN BOOK 2088 AT PAGE 22 OF SAID RECORDS; THENCE ALONG SAID EAST LINE N 11°57'34" W, A DISTANCE OF 204.34 FEET; THENCE N 89°51'58" E, A DISTANCE OF 876.92 FEET; THENCE S 00°08'02" E, A DISTANCE OF 200.00 FEET TO THE NORTH LINE OF SAID TRACT 'A'; THENCE ALONG SAID NORTH LINE S 89°51'58" W, A DISTANCE OF 835.05 FEET TO THE POINT OF BEGINNING, CONTAINING 3.93 ACRES, MORE OR LESS.

**PARCEL C - BOOK 5426, PAGE 118**

A TRACT OF LAND LOCATED IN SECTION 13, TOWNSHIP 15 SOUTH, RANGE 66 WEST OF THE 6TH P.M., EL PASO COUNTY, COLORADO:

BEGINNING AT THE NORTHWEST CORNER OF THAT PARCEL OF LAND DESCRIBED IN BOOK 3939 AT PAGE 881 OF THE RECORDS OF SAID COUNTY; THENCE ALONG THE EASTERLY LINE OF THAT PARCEL DESCRIBED IN BOOK 2088 AT PAGE 22, NORTH 11°57'34" WEST A DISTANCE OF 363.59 FEET; THENCE NORTH 89°51'58" EAST A DISTANCE OF 891.31 FEET TO A POINT ON THE WESTERLY RIGHT-OF-WAY LINE OF PROPOSED WIDOCK STREET, SAID POINT BEING ON A NON-TANGENT CURVE CONCAVE TO THE EAST, HAVING A CENTRAL ANGLE OF 20°28'54", A RADIUS OF 890.00 FEET, AND THE CHORD OF WHICH BEARS SOUTH 10°06'25" WEST A DISTANCE OF 316.46 FEET; THENCE ALONG THE ARC OF SAID CURVE, BEING SAID WESTERLY RIGHT-OF-WAY LINE, A DISTANCE OF 318.15 FEET; THENCE ALONG SAID WESTERLY RIGHT-OF-WAY LINE, SOUTH 00°08'02" EAST A DISTANCE OF 44.45 FEET TO A POINT ON THE NORTH LINE OF THAT PARCEL OF LAND DESCRIBED IN BOOK 3939 AT PAGE 881 OF THE RECORDS OF SAID COUNTY; THENCE ALONG SAID NORTH LINE, SOUTH 89°51'58" WEST A DISTANCE OF 760.53 FEET TO THE POINT OF BEGINNING, CONTAINING 6.65 ACRES, MORE OR LESS.

**PARCEL D - RECEPTION NO. 96087895 (Previous deed of Book 3939, Page 881)**

A TRACT OF LAND LOCATED IN THE NORTH HALF OF SECTION 13, TOWNSHIP 15 SOUTH, RANGE 66 WEST OF THE 6TH P.M., EL PASO COUNTY, COLORADO, MORE PARTICULARLY DESCRIBED AS FOLLOWS:

BEGINNING AT THE SOUTHEAST CORNER OF LOT 47 IN BLOCK 14 OF SECURITY, COLORADO ADDITION NO. 5 AS RECORDED IN PLAT BOOK V AT PAGE 64 OF THE RECORDS OF SAID COUNTY:

(1) THENCE N 89 DEGREES 51 MINUTES 58 SECONDS E, 600.00 FEET; (ALL BEARINGS IN THIS DESCRIPTION ARE RELATIVE TO THE SOUTH LINE OF LOTS 11-47 IN SAID BLOCK 14 WHICH WAS ASSUMED TO BE N 89 DEGREES 48 MINUTES 24 SECONDS E)

(2) THENCE N 00 DEGREES 08 MINUTES 02 SECONDS W, 768.34 FEET;

(3) THENCE S 89 DEGREES 51 MINUTES 58 SECONDS W, 760.87 FEET;

(4) THENCE S 11 DEGREES 57 MINUTES 34 SECONDS E, 785.00 FEET; TO THE POINT OF BEGINNING.

**Sheet Index**

TS1.0	TITLE SHEET
21521-00	LAND SURVEY PLAT - SHEETS 1-6

**SITE DEVELOPMENT**

SD0.0	SITE PLAN FOR PLANNING
SD0.1	EXISTING OVERALL SITE PLAN, NOTES, LEGEND
SD0.2	DEMOLITION PLAN
SD1.1	BASE SITE PLAN
SD1.2	ENLARGED SITE PLAN
SD3.1	SITE DETAILS

**Contacts**

**OWNER**  
Widefield School District 3  
1820 Main Street  
Colorado Springs, CO 80911  
Contact: David Gish (gishd@wsd3.org)

**CIVIL ENGINEER**  
Kimley-Horn and Associates, Inc.  
2 North Nevada Street, Suite 300  
Colorado Springs, CO 80903  
(719) 391-3530  
Contact: Eric Gunderson, P.E.

**EL PASO COUNTY**  
El Paso County  
Planning & Community Development Department  
2880 International Circle, Suite 110  
Colorado Springs, CO 80910  
(719) 520-6300  
Contact: Ryan Hower

**ARCHITECT**  
The LKA Partners, Inc.  
430 North Tejon Street  
Colorado Springs, CO 80903  
(719) 473-8446  
Contact: Todd Kimes (toddkimes@lkapartners.com)

**SURVEYOR**  
Drexel, Barrel & Co.  
3 South 7th Street  
Colorado Springs, CO 80905  
(719) 260-0887  
Contact: Tim McConnell, P.E.

**Planning and Community Development Director Approval**

**Approved**  
For the PCD Director  
By: *Justin Kilgore,*  
PCD Planning Manager  
Date: 10/20/2022  
El Paso County Planning & Community Development

© Copyright 2022 The LKA Partners, Inc. This document and the information contained herein may not be reproduced or excerpted from without the express written permission of The LKA Partners, Inc. Unauthorized copying, disclosure or construction use are prohibited by copyright law.

**Widefield Parks and Recreation Facility Expansion**  
755 Aspen Drive, Colorado Springs, CO 80911

**Widefield School District 3**  
1820 Main Street  
Colorado Springs, CO 80911



**Construction Documents**

Drawn: \_\_\_\_\_ TEK  
Checked: \_\_\_\_\_ DKO  
Issued: \_\_\_\_\_ 30 March 2022  
Revised: \_\_\_\_\_

EPC Resubmittal 20 April 2022  
EPC Resubmittal \_\_\_\_\_ June 2022

**Area Key Plan**

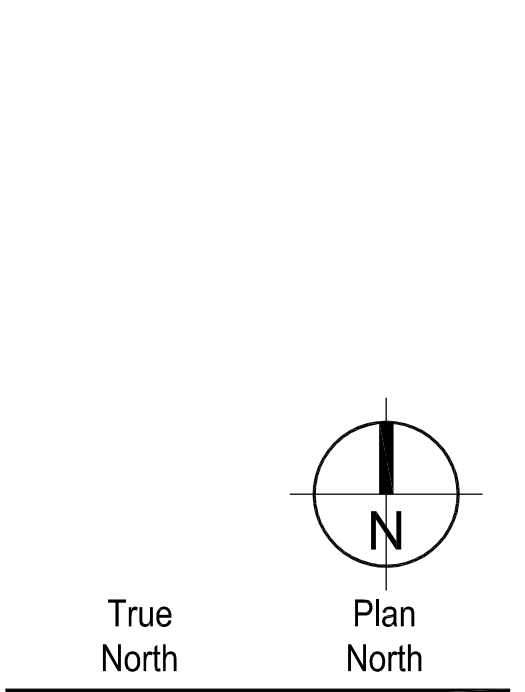

**Title Sheet**

**TS1.0**



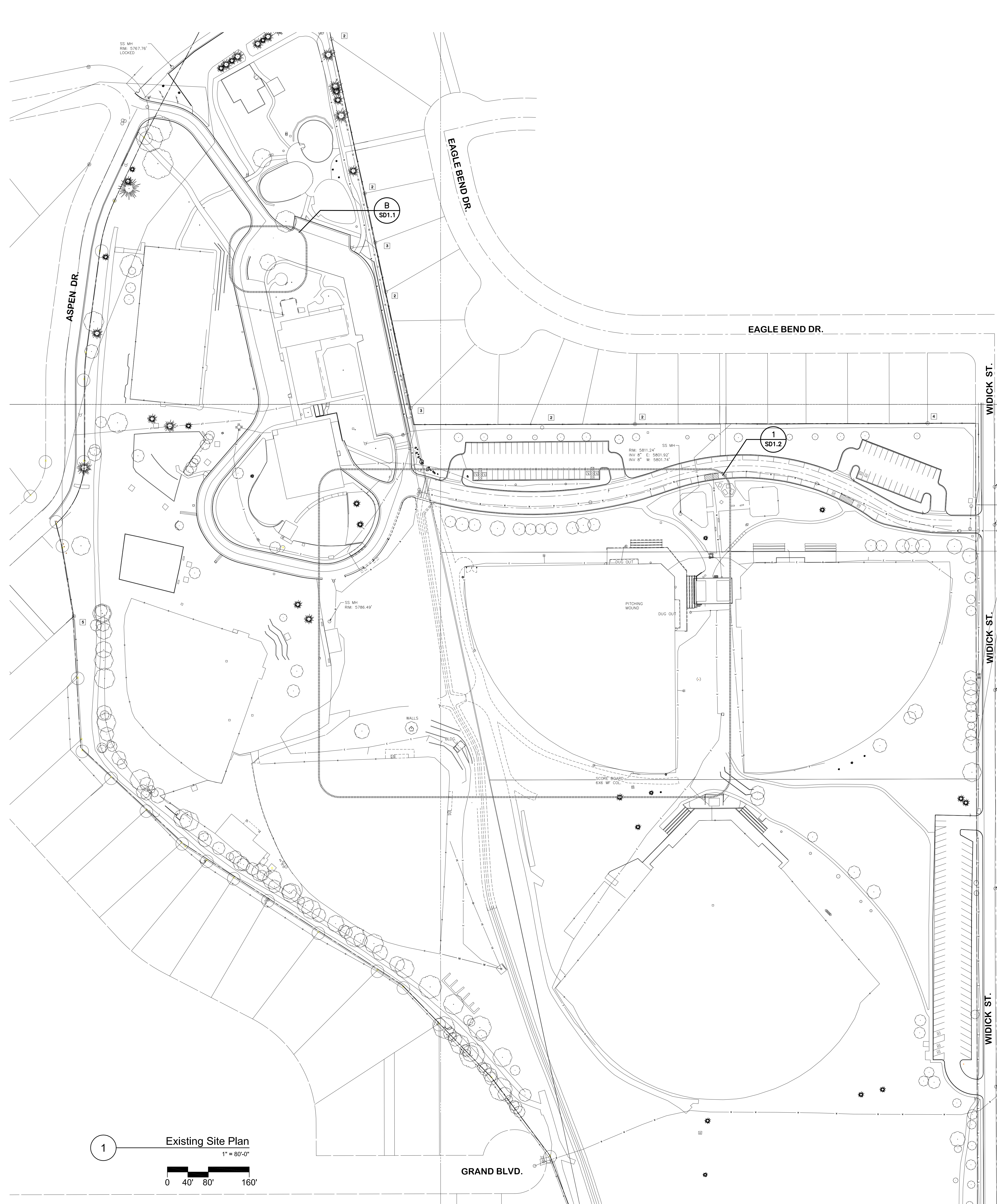

- ### SITE PLAN SPECIFIC NOTES
- 2.2.a IRRIGATION AND ELECTRICAL CONTROL PANELS
  - 2.2.b IRRIGATION AND ELECTRICAL WIRING (BURIED)
  - 2.4.a EXISTING CONCRETE SIDEWALK
  - 4.1.a NOT USED.
  - 4.1.b CMU WALL WITH 4" THICK PRECAST CONCRETE CAP. (7/SD3.1) SEE STRUCTURAL.
  - 5.26.a STEEL PIPE BOLLARD (9A/SD3.1).
  - 5.26.d STEEL PIPE STAIR HANDRAILS AND SUPPORT POSTS.
  - 5.26.e ACTUATOR POST.
  - 8.22.a KNOX BOX - MOUNT 6'-0" ABOVE FLOOR.
  - 10.7.a 30' FLAGPOLE (8/SD3.1).
  - 11.8.a TRASH DUMPSTER BY OWNER.
  - 12.18.a BICYCLE RACK (4/SD3.1).
  - 12.18.b LITTER AND RECYCLING RECEPTACLE.
  - 21.1.a FIRE DEPARTMENT CONNECTION.
  - 21.1.b FIRE HYDRANT.
  - 26.3.c ALUMINUM LIGHT POLE AND FIXTURE WITH CONCRETE BASE. SEE ELECTRICAL.
  - 26.3.e ARCHITECTURAL BOLLARD.
  - 26.12.a ELECTRIC TRANSFORMER WITH 8'-8" x 8'-8" x 8" THICK REINFORCED CONCRETE PAD. SEE ELECTRICAL.
  - 32.1.a EXISTING ASPHALT PAVING.
  - 32.1.b APPLY SEAL COAT OVER EXISTING ASPHALT PAVING.
  - 32.1.d PARKING AREA PAVEMENT. 6" FULL DEPTH ASPHALT ON PREPARED SUBGRADE.
  - 32.1.e DRIVE LANE PAVEMENT. 7" FULL DEPTH ASPHALT ON PREPARED SUBGRADE.
  - 32.1.g NEW ROADWAY ASPHALT. SEE CIVIL.
  - 32.1.h TEMPORARY 4' ASPHALT CURB.
  - 32.1.i HEAVY TRUCK TRAFFIC PAVEMENT. 8" FULL DEPTH ASPHALT ON PREPARED SUBGRADE.
  - 32.2.a BASE BID FIRE DEPARTMENT ACCESS DRIVE. 12" CLASS 6 AGGREGATE BASE COURSE ON PREPARED SUBGRADE OR 8" CLASS 6 AGGREGATE BASE COURSE ON GEOTEXTILE FABRIC ON PREPARED SUBGRADE.
  - 32.2.b 4" THICK COMPACTED GRANITE CRUSHER FINES (BREEZE) WALKWAY. WIDTH AS INDICATED.
  - 32.2.c EXISTING ± 4" THICK COMPACTED GRANITE CRUSHER FINES (BREEZE).
  - 32.2.d INSTALL SALVAGED INFILLED MIX MATERIAL 4" THICK. PROVIDE ADDITIONAL MATCHING MATERIAL REQUIRED TO COVER AREA.
  - 32.3.a CONCRETE PAVING. 7" THICK CONCRETE WITH 6 X 6 W1.9 X 1.9 W.W.F. REINFORCING ON 6" AGGREGATE BASE COURSE.
  - 32.4.a CONCRETE CURB AND CUTTER. RE: 25A/SD3.1.
  - 32.4.b CONCRETE DRIVE CROSS PAN.
  - 32.4.c CONCRETE FLUSH CURB (10/SD3.1).
  - 32.4.d CONCRETE SLOPED DRIVE OVER CURB (20a/SD3.1).
  - 32.4.e TRENCH DRAIN (15/SD3.1).
  - 32.4.f EXISTING CONCRETE CURB AND CUTTER.
  - 32.4.g EXISTING HC CURB RAMP.
  - 32.4.h 8" WIDE X 8" DEEP CONCRETE AT EDGE OF ASPHALT. MATCH ASPHALT ELEV.
  - 32.5.a CONCRETE SIDEWALK WITH ISOLATION, EXPANSION AND CONTRACTION JOINTS AS SHOWN (1/4" PER FOOT MAXIMUM CROSS SLOPE. SEE DETAILS 24a, 24b, 29a and 29b/SD3.1).
  - 32.5.b HANDICAPPED CURB RAMP. RE: 17, 22, 23/SD3.1.
  - 32.5.c CONCRETE STAIR.
  - 32.5.d SIDEWALK CATCH BASIN.
  - 32.12.c CHAIN LINK FENCE (4'-0" HIGH). CHAIN LINK FABRIC, POSTS AND RAILS VINYL COATED (4a/SD3.1.SIM).
  - 32.12.e DUMPSTER ENCLOSURE CHAIN LINK FENCE (6'-0" HIGH). HIGH DENSITY CHAIN LINK FABRIC, POSTS AND RAILS VINYL COATED (4a/SD3.1.SIM).
  - 32.12.j EXISTING CHAIN LINK FENCE TO REMAIN.
  - 32.12.k EXISTING CHAIN LINK GATE.
  - 32.17 TRAFFIC CONTROL AND PARKING STRIPING.
    - a AUTO PARKING STALL LINES: 4" WIDE, SOLID WHITE, TYP 9' WIDE X 18' LONG.
    - b HANDICAP / DISABLED PARKING STALL PARKING STRIPING AND LOADING AREA LINES: 4" WIDE, SOLID WHITE PERIMETER AND 24" APART AT CROSS HATCH.
    - c PEDESTRIAN CROSS WALK: 2' X 8' SOLID WHITE BARS, 3" APART.
    - d STOP BARS: 24" WIDE, 8" LONG.
    - e NEW PAVEMENT MARKING STRIPING: 4" WIDE, SOLID WHITE PERIMETER AND 24" APART AT CROSS HATCH.
    - f CHANNELIZING LINES: 8" WIDE SOLID WHITE.
    - g CENTER LINES: 4" WIDE DASHED WHITE, 10' LONG WITH 10' GAPS.
    - h FIRE LANE: PAINT CURB RED.
    - i AUTO PARKING STALL LINES: 4" WIDE, SOLID WHITE, TYP 9' WIDE X 15' LONG X 15' LONG.
    - j AUTO PARKING STALL LINES: 4" WIDE, SOLID WHITE, TYP 9' WIDE X 22' LONG.
    - k AUTO PARKING STALL LINES: 4" WIDE, SOLID WHITE, TYP 9' WIDE X 22' LONG.
  - 32.19.a NEW LOOSE LAID UNIT MASONRY RETAINING WALL SYSTEM (21 & 26 /SD3.1).
  - 33.8.a STORM WATER DRAIN INLET. SEE CIVIL.
  - 33.8.b CURB INLET. SEE CIVIL.
  - 33.12.e EXISTING UNDERGROUND GAS LINE. SEE CIVIL.
  - 33.12.f NEW UNDERGROUND GAS LINE. SEE CIVIL.
  - 33.12.g GAS METER. SEE MECHANICAL.
  - 33.12.h EXISTING 3" DIAMETER X 10' LONG PROPANE TANK.

- ### Demolition Legend:
- LEGEND:
- REMOVE.
  - WITH \* SYMBOL CAREFULLY REMOVE, SALVAGE AND RETURN ITEM TO OWNER.
  - REMAINS. (ALL EXISTING CONSTRUCTION NOT INDICATED TO BE REMOVED OR RELOCATED SHALL REMAIN. FOR CLARITY, THIS SYMBOL MAY BE USED).
  - △ REMOVE & REINSTALL WITH EXISTING IN EXISTING LOCATION.
  - ◇ REMOVE & REPLACE WITH NEW.
  - EXISTING CONSTRUCTION TO REMAIN
  - EXISTING CONSTRUCTION TO BE DEMOLISHED
- ### SITE PLAN DEMOLITION NOTES
- 2.1.a INFILLED MIX (± 4" THICK). SALVAGE MATERIAL FOR REINSTALLATION.
  - 2.1.b ROAD BASE SURFACING.
  - 2.2.a BEOUDOUS TREE.
  - 2.2.b PINE TREE.
  - 2.2.c BALLFIELD IRRIGATION SYSTEM INCLUDING BUT NOT LIMITED TO SPRINKLER HEADS, BRANCH PIPING, MAIN LINES, CONTROL VALVES, VALVE BOXES AND CONTROL WIRING.
  - 2.2.d IRRIGATION CONTROL VALVE AND BOX.
  - 2.2.e IRRIGATION CONTROL WIRING, PANELS AND CHAIN LINK ENCLOSURE.
  - 2.2.f LANDSCAPE BOUNDARIES.
  - 2.3.a WOOD TIMBER RETAINING WALL.
  - 2.3.b WOOD TIMBER CURB AND ROAD BASE SURFACING.
  - 2.3.c WOOD TIMBER RETAINING WALLS AT TIERED SEATING PLATFORMS WITH ASPHALT PAVING AT PLATFORMS.
  - 2.3.d FOUL POLE AND CONCRETE BASE.
  - 2.3.e TRASH RECEPTACLE.
  - 2.3.f SWINGING STEEL GATE WITH HINGE POST, LATCH POST AND CONCRETE FOOTINGS.
  - 2.3.g TRAFFIC CONTROL SIGN.
  - 2.3.h STOP SIGN.
  - 2.3.i STEEL PIPE BOLLARD.
  - 2.3.j ALUMINUM BENCH SEATS.
  - 2.4.a CONCRETE SIDEWALK.
  - 2.4.b CONCRETE CURB AND CUTTER.
  - 2.4.c CONCRETE STORM DRAINAGE CHANNEL.
  - 2.4.d CONCRETE PAD WITH TIMBER EDGE.
  - 2.4.e ASPHALT PAVING.
  - 2.4.f CONCRETE HANDICAPPED CURB RAMP.
  - 2.4.g CONCRETE CURBED RAISED ISLAND.
  - 2.4.h CONCRETE DRAIN PAN.
  - 2.4.i WOOD TIMBER ASPHALT EDGE.
  - 2.4.j WOOD TIMBER ASPHALT EDGE. REMOVE AS INDICATED. SAW CUT EXISTING ASPHALT TO PROVIDE STRAIGHT SMOOTH EDGE.
  - 2.4.k CURB CUT CONCRETE CROSS PAN.
  - 2.4.l PRECAST CONCRETE BARRIER.
  - 2.4.m PRECAST CONCRETE PARKING BUMPERS AT EACH EXISTING PARKING SPACE.
  - 2.4.n ASPHALT CURB.
  - 2.5.a CHAIN LINK FENCE (10' TALL) INCLUDING CHAIN LINK FABRIC, METAL POSTS, RAILS AND CONCRETE FOOTINGS.
  - 2.5.b CHAIN LINK FENCE (8' TALL) INCLUDING CHAIN LINK FABRIC, METAL POSTS, RAILS, GATES AND CONCRETE FOOTINGS.
  - 2.5.c BALLFIELD BACKSTOP (20' TALL) INCLUDING CHAIN LINK FABRIC, METAL POSTS, RAILS AND CONCRETE FOOTINGS.
  - 2.5.d CHAIN LINK FABRIC AND METAL POST / RAIL ROLLING GATE (SIZE AS INDICATED).
  - 2.5.e CHAIN LINK FABRIC AND METAL POST / RAIL SWINGING GATE (SIZE AS INDICATED).
  - 2.6.a 6" CORRUGATED PLASTIC DRAIN PIPE THROUGH CONCRETE DRAINAGE CHANNEL.
  - 2.6.b SIDE WALL.
  - 2.6.c STORM DRAIN INLET.
  - 2.6.d FIRE HYDRANT.
  - 2.7.a NOT USED.
  - 2.7.b SPORTS FIELD LIGHTING INCLUDING POLES, ELECTRICAL EQUIPMENT, LIGHT FIXTURES AND UNDERGROUND / OVERHEAD POWER CABLE. SALVAGE POLES AND RELOCATE ON SITE PER OWNER.
  - 2.7.c ELECTRONIC SCOREBOARD INCLUDING BUT NOT LIMITED TO SCOREBOARD UNIT (15'-0" WIDE) STEEL SUPPORT POSTS, CONCRETE FOUNDATIONS, ELECTRIC SERVICE LINE AND CONTROL WIRING. SALVAGE SCOREBOARD AND RELOCATE ON SITE PER OWNER.
  - 2.8.a NOT USED.
  - 2.8.b SKATEBOARD PARK, INCLUDING WOOD RAMPS; CONCRETE SLAB TO REMAIN (BURIED).
  - 2.8.c BASEBALL FIELD DUGOUT, INCLUDING BUT NOT LIMITED TO CONCRETE FLOOR SLAB; CHAIN LINK FABRIC, POSTS, RAILS AND CONCRETE FOOTINGS; ROOF SUPPORT STRUCTURE; STANDING SEAM METAL ROOFING; METAL DECK AND STEEL FRAMING; ALUMINUM BENCH WITH SUPPORT POST CONCRETE FOOTINGS.

### Key Notes List

3.1 CONC FOUNDATION	9.3 VENEER PLASTER
3.2 CONC BRICK BEAM	9.4 AGGREGATE
3.3 CONC SLAB	9.5 PORTLAND CEMENT STUCCO
3.4 UNDERSLAB GRAVEL BED	9.6 STUCCO
3.5 UNDERSLAB VAPOR RETARDER	9.7 ACoustICAL INSUL
3.6 UNDERSLAB BOARD	9.8 ABUSE RESISTANT
3.7 CONC COLUMN	9.9 WATER RESISTANT GYPSUM BOARD
3.8 CONC BEAM	9.10 SHAPETWALL SYSTEM
3.9 CONC WALL	9.11 SUSPENDED CEILING
3.10 PRECAST CONC COL BEAM	9.12 SUSPENDED CEILING SYSTEM
3.11 PRECAST CONC WALL PANEL	9.13 AGGREGATE TILE
3.12 PRECAST CONC DOUBLE TEE	9.14 QUARRY TILE
3.13 PRECAST CONC QUARRY TILE BASE	9.15 QUARRY TILE
3.14 CONC SPLASH BLOCK	9.16 QUARRY TILE BASE
3.15 1" WEIGHT CONC	9.17 CERAMIC TILE
3.16 REINFORCING BAR	9.18 CERAMIC TILE BASE
3.17 WELDED WIRE	9.19 PORCELAIN TILE
3.18 PREMADE JOINT FILLER	9.20 WOOD FLOOR
3.19 WATERSTOP	9.21 VAPOR BARRIER
4.1 CMU	9.22 WOOD COMPOSITION TILE
4.2 CMU-SOLID UNIT	9.23 SHEET VINYL FLOORING
4.3 CMU-ROUTED SOLID	9.24 SEAMLESS TROWELED FLOORING
4.4 CMU-SAND FILLED	9.25 FACE BRICK
4.5 FACE BRICK	9.26 RUBBER TREADS & RISERS
4.6 BOND BEAM	9.27 RUBBER STAR SHORT
4.7 FACE BRICK	9.28 MASONRY ANCHOR
4.8 GLASS BLOCK	9.29 MASONRY VENEER
4.9 GROUT FILL	9.30 MASONRY ANCHOR
4.10 HORIZ MASONRY	9.31 MASONRY VENEER
4.11 MASONRY ANCHOR	9.32 MASONRY VENEER
4.12 MASONRY ANCHOR	9.33 MASONRY VENEER
4.13 MASONRY VENEER	9.34 PAINT
4.14 MASONRY VENEER	9.35 MASONRY VENEER
4.15 MASONRY VENEER	9.36 MASONRY VENEER
4.16 MASONRY VENEER	9.37 MASONRY VENEER
4.17 MASONRY VENEER	9.38 MASONRY VENEER
4.18 MASONRY VENEER	9.39 MASONRY VENEER
4.19 MASONRY VENEER	9.40 MASONRY VENEER
5.1 STEEL COLUMN	10.1 METAL TOILET PARTITION
5.2 STEEL BEAM	10.2 METAL TOILET PARTITION
5.3 STEEL JOIST	10.3 METAL TOILET PARTITION
5.4 STEEL ANGLE BRACE	10.4 METAL TOILET PARTITION
5.5 WELD PLATE	10.5 METAL TOILET PARTITION
5.6 STEEL ROOF DECK	10.6 METAL TOILET PARTITION
5.7 STEEL ROOF DECK	10.7 METAL TOILET PARTITION
5.8 CORRUGATED METAL ROOF DECK	10.8 METAL TOILET PARTITION
5.9 STRUCTURAL STUD/JOIST	10.9 METAL TOILET PARTITION
5.10 COLD-FORMED METAL FRAMING	10.10 METAL TOILET PARTITION
5.11 STEEL LADDER	10.11 METAL TOILET PARTITION
5.12 CONC FILLED STEEL PAN STAIR TREAD & WRITTON	10.12 METAL TOILET PARTITION
5.13 PRE-MANUFACTURED STEEL STAIR SYSTEM	10.13 METAL TOILET PARTITION
5.14 ABRASIVE STAR	10.14 METAL TOILET PARTITION
5.15 STEEL RAILING	10.15 METAL TOILET PARTITION
5.16 STEEL RAILING	10.16 METAL TOILET PARTITION
5.17 SUMP PAN	10.17 METAL TOILET PARTITION
5.18 GRATING	10.18 METAL TOILET PARTITION
5.19 CHECKERED PLATE	10.19 METAL TOILET PARTITION
5.20 STEEL COIL COVER	10.20 METAL TOILET PARTITION
5.21 EXP JOINT COVER	10.21 METAL TOILET PARTITION
5.22 INFILL JOINT	10.22 METAL TOILET PARTITION
6.1 WOOD FRAMING	10.23 METAL TOILET PARTITION
6.2 WOOD STUD / JOIST	10.24 METAL TOILET PARTITION
6.3 WOOD BLOCKING	10.25 METAL TOILET PARTITION
6.4 WOOD FLOORING	10.26 METAL TOILET PARTITION
6.5 WOOD WALKER	10.27 METAL TOILET PARTITION
6.6 WOOD SHIM	10.28 METAL TOILET PARTITION
6.7 WOOD TRUSS	10.29 METAL TOILET PARTITION
6.8 GULF LAMINATED TIMBER	10.30 METAL TOILET PARTITION
6.9 LAMINATED VENEER LUMBER	10.31 METAL TOILET PARTITION
6.10 FLUORID SHEETING	10.32 METAL TOILET PARTITION
6.11 STORAGE CABINET	10.33 METAL TOILET PARTITION
6.12 BOARD SHEATHING	10.34 METAL TOILET PARTITION
6.13 PARTICLE BOARD	10.35 METAL TOILET PARTITION
6.14 PLASTIC LAMINATE	10.36 METAL TOILET PARTITION
6.15 WOOD CURB	10.37 METAL TOILET PARTITION
6.16 WOOD FLOORING	10.38 METAL TOILET PARTITION
6.17 WOOD CEILING	10.39 METAL TOILET PARTITION
6.18 WOOD HANDRAIL	10.40 METAL TOILET PARTITION
6.19 WOOD TRIM	10.41 METAL TOILET PARTITION
6.20 WOOD SHELF	10.42 METAL TOILET PARTITION
7.1 DAMPROOFING	10.43 METAL TOILET PARTITION
7.2 SELF-ADHERED SHEET MEMBRANE	10.44 METAL TOILET PARTITION
7.3 FLUID APPLIED WATERPROOFING	10.45 METAL TOILET PARTITION
7.4 WATER REPELLENT / COATING CONTROL	10.46 METAL TOILET PARTITION
7.5 ROOF INSULATION	10.47 METAL TOILET PARTITION
7.6 TAPERED INSUL	10.48 METAL TOILET PARTITION
7.7 BATT INSULATION	10.49 METAL TOILET PARTITION
7.8 BLANKET INSULATION	10.50 METAL TOILET PARTITION
7.9 LOOSE FILL INSUL	10.51 METAL TOILET PARTITION
7.10 FLOW INSULATION	10.52 METAL TOILET PARTITION
7.11 BLANKET PREFOAM (DUST WOOD)	10.53 METAL TOILET PARTITION
7.12 METAL BUILDING PANEL	10.54 METAL TOILET PARTITION
7.13 METAL BUILDING PANEL	10.55 METAL TOILET PARTITION
7.14 WOOD SIDING	10.56 METAL TOILET PARTITION
7.15 FIBERGLASS SHINGLES	10.57 METAL TOILET PARTITION
7.16 OPEN METAL ROOFING	10.58 METAL TOILET PARTITION
7.17 PRIN METAL SOFFIT	10.59 METAL TOILET PARTITION
7.18 BUILT-UP ROOFING	10.60 METAL TOILET PARTITION
7.19 MEMBRANE ROOFING	10.61 METAL TOILET PARTITION
7.20 UNDERLAMENT	10.62 METAL TOILET PARTITION
7.21 SELF-ADHERED UNDERLAMENT	10.63 METAL TOILET PARTITION
7.22 2" FIBRING	10.64 METAL TOILET PARTITION
7.23 EXT KICK COATING	10.65 METAL TOILET PARTITION
7.24 ROOF WALKWAY	10.66 METAL TOILET PARTITION
7.25 ROOF WALKWAY PADS	10.67 METAL TOILET PARTITION
7.26 ROOF WALKWAY	10.68 METAL TOILET PARTITION
7.27 BASE FLASHING	10.69 METAL TOILET PARTITION
7.28 DRAIN FLASHING	10.70 METAL TOILET PARTITION
7.29 MET FLASHING	10.71 METAL TOILET PARTITION
7.30 MET FLASHING	10.72 METAL TOILET PARTITION
7.31 MET FLASHING	10.73 METAL TOILET PARTITION
7.32 MET FLASHING	10.74 METAL TOILET PARTITION
7.33 MET FLASHING	10.75 METAL TOILET PARTITION
7.34 MET FLASHING	10.76 METAL TOILET PARTITION
7.35 MET FLASHING	10.77 METAL TOILET PARTITION
7.36 MET FLASHING	10.78 METAL TOILET PARTITION
7.37 MET FLASHING	10.79 METAL TOILET PARTITION
7.38 MET FLASHING	10.80 METAL TOILET PARTITION
7.39 MET FLASHING	10.81 METAL TOILET PARTITION
7.40 MET FLASHING	10.82 METAL TOILET PARTITION
7.41 MET FLASHING	10.83 METAL TOILET PARTITION
7.42 MET FLASHING	10.84 METAL TOILET PARTITION
7.43 MET FLASHING	10.85 METAL TOILET PARTITION
7.44 MET FLASHING	10.86 METAL TOILET PARTITION
7.45 MET FLASHING	10.87 METAL TOILET PARTITION
7.46 MET FLASHING	10.88 METAL TOILET PARTITION
7.47 MET FLASHING	10.89 METAL TOILET PARTITION
7.48 MET FLASHING	10.90 METAL TOILET PARTITION
7.49 MET FLASHING	10.91 METAL TOILET PARTITION
7.50 MET FLASHING	10.92 METAL TOILET PARTITION
7.51 MET FLASHING	10.93 METAL TOILET PARTITION
7.52 MET FLASHING	10.94 METAL TOILET PARTITION
7.53 MET FLASHING	10.95 METAL TOILET PARTITION
7.54 MET FLASHING	10.96 METAL TOILET PARTITION
7.55 MET FLASHING	10.97 METAL TOILET PARTITION
7.56 MET FLASHING	10.98 METAL TOILET PARTITION
7.57 MET FLASHING	10.99 METAL TOILET PARTITION
7.58 MET FLASHING	10.100 METAL TOILET PARTITION

Widefield Parks and Recreation Facility Expansion  
755 Aspen Drive, Colorado Springs, CO 80911  
Widefield School District 3  
1820 Main Street  
Colorado Springs, CO. 80911

**L K A PART N E R S**  
INCORPORATED  
A Professional Corporation for Architecture and Planning  
430 North Tejon Street Suite 208  
Colorado Springs, Colorado 80903  
tele: 719.473.9446 fax: 719.473.9448  
web: www.lkapartners.com

Copyright 2022 The LKA Partners, Inc. This document and the information contained herein may not be reproduced or excerpted from without the express written permission of The LKA Partners, Inc. Unauthorized copying, disclosure or construction use are prohibited by copyright law.

**WIDEFIELD SCHOOL DISTRICT 3**  
PRIDE. TRADITION. INNOVATION.

**STATE OF COLORADO**  
JAMES R. STRANGE  
201758  
06/03/2022  
LICENSED ARCHITECT

Construction Documents  
Drawn: TAAH  
Checked: DKO  
Issued: 30 March 2022  
Revised:  
CCD #001 13 April 2022  
EPC Resubmittal 20 April 2022

Area Key Plan  
True North  
Plan North

Site Notes and Legend  
**SD0.1**  
Project No. 21-004  
The LKA Partners Incorporated

NOTE: THE KEYNOTE REFERENCE NUMBERS SHOWN ABOVE MAY OR MAY NOT CORRESPOND TO SPECIFICATION SECTIONS IN THE PROJECT MANUAL.



© Copyright 2022 The LKA Partners, Inc. This document and the information contained herein may not be reproduced or excerpted from without the express written permission of The LKA Partners, Inc. Unauthorized copying, disclosure or construction use are prohibited by copyright law.

**Widefield Parks and Recreation Facility Expansion**  
 755 Aspen Drive, Colorado Springs, CO 80911  
 Widefield School District 3  
 1820 Main Street  
 Colorado Springs, CO 80911



**Construction Documents**

Drawn:	SLH, TAH
Checked:	DKO
Issued:	30 March 2022
Revised:	
CCD #001	13 April 2022
EPC Resubmittal	20 April 2022

**Area Key Plan**

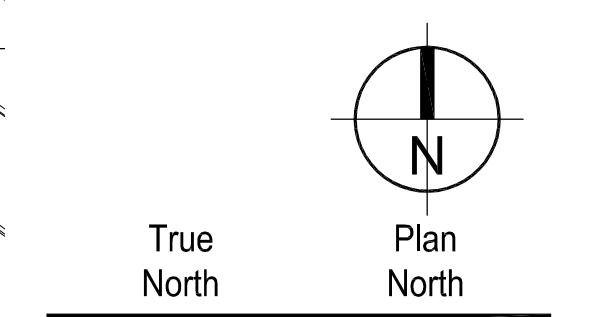

**Demolition Plan**

**SD0.2**

Project No. 21-004  
 The LKA Partners Incorporated

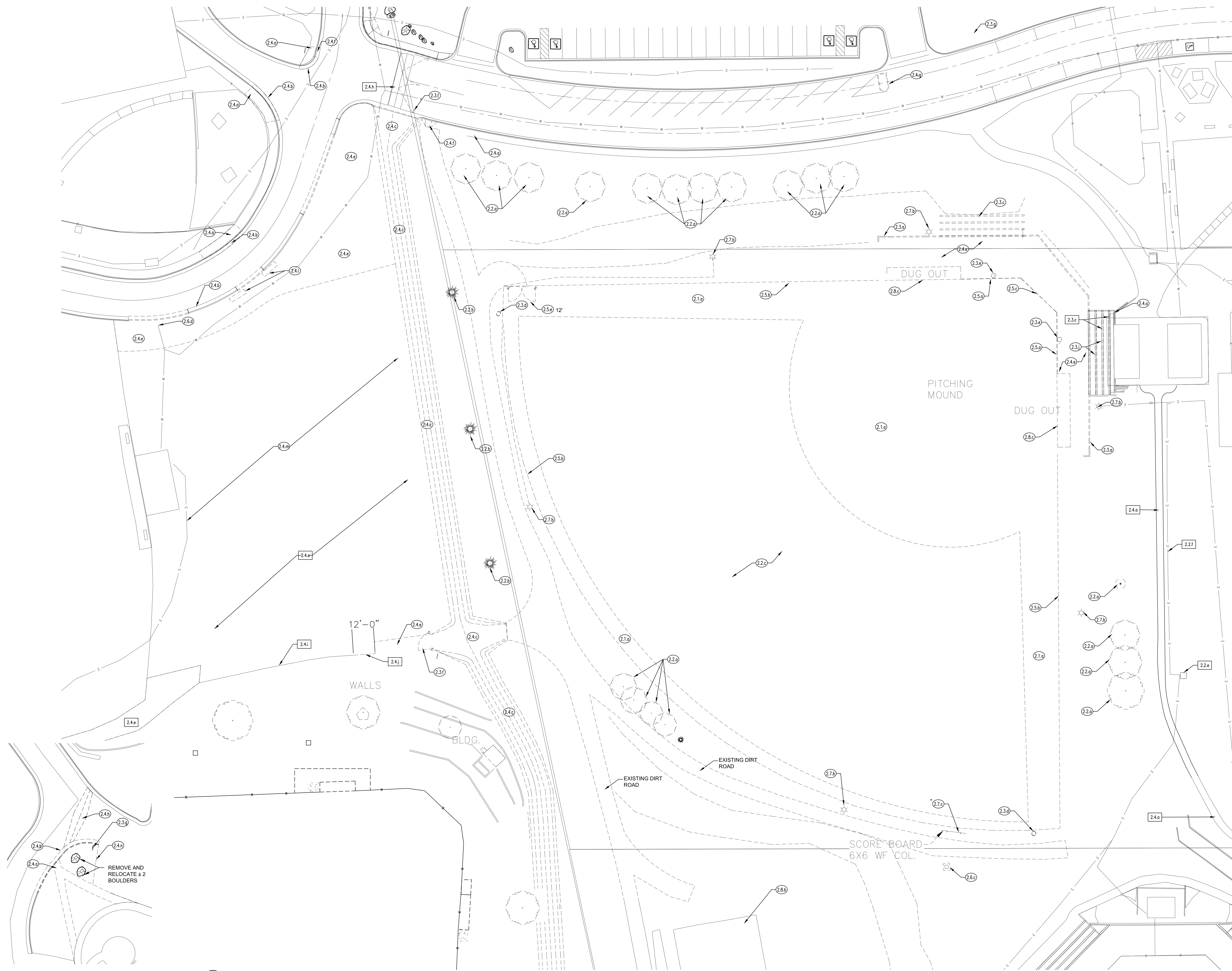







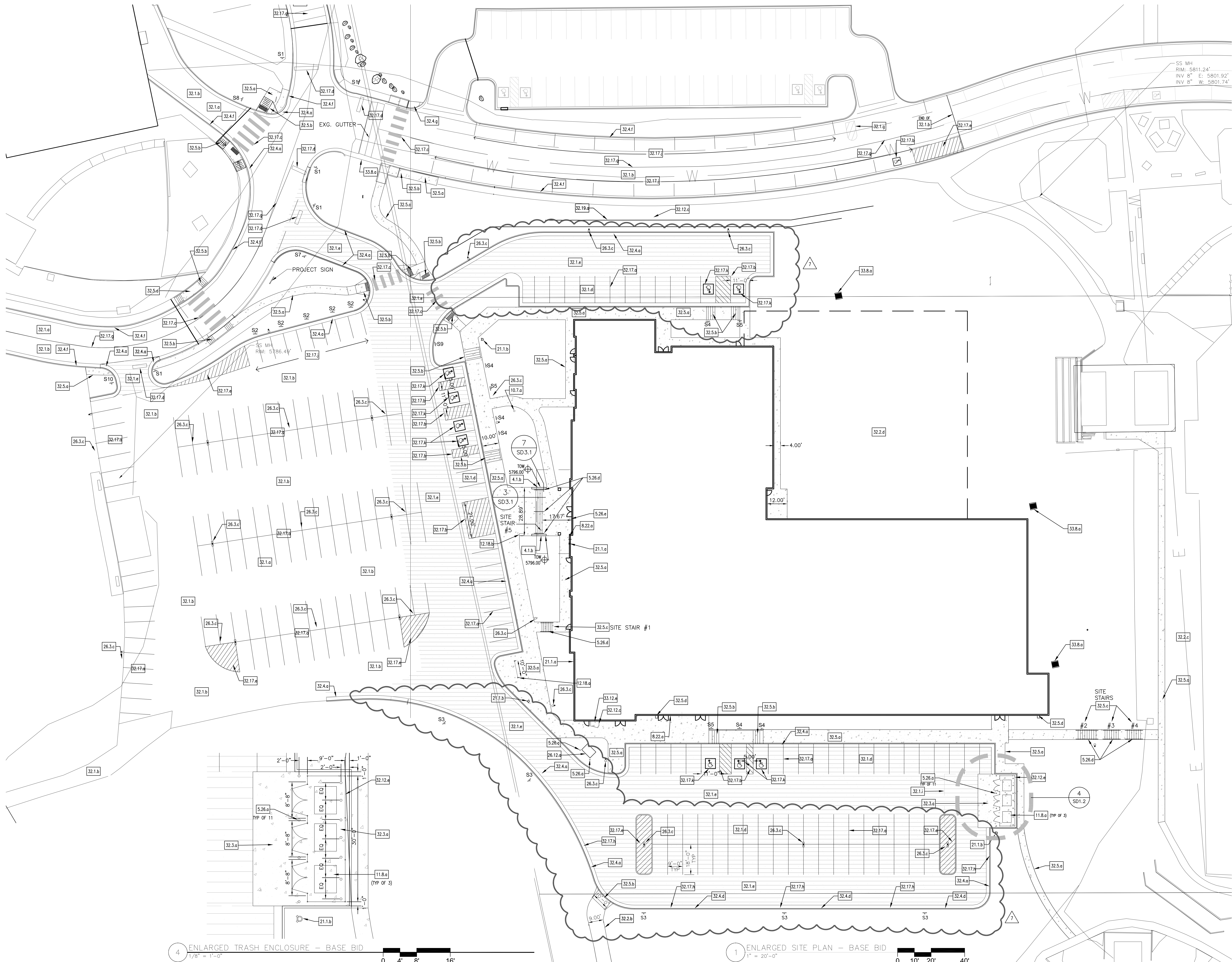

4 ENLARGED TRASH ENCLOSURE - BASE BID  
1/8" = 1'-0"

1 ENLARGED SITE PLAN - BASE BID  
1" = 20'-0"



**Construction Documents**

Drawn: \_\_\_\_\_ TAH  
Checked: \_\_\_\_\_ DKO  
Issued: \_\_\_\_\_ 30 March 2022  
Revised: \_\_\_\_\_  
EPC Resubmittal 20 April 2022  
EPC Resubmittal 02 December 2022

**Area Key Plan**

True North  
Plan North  
**Enlarged Base Plan**

**SD1.2**  
Project No. 21-004  
The LKA Partners Incorporated



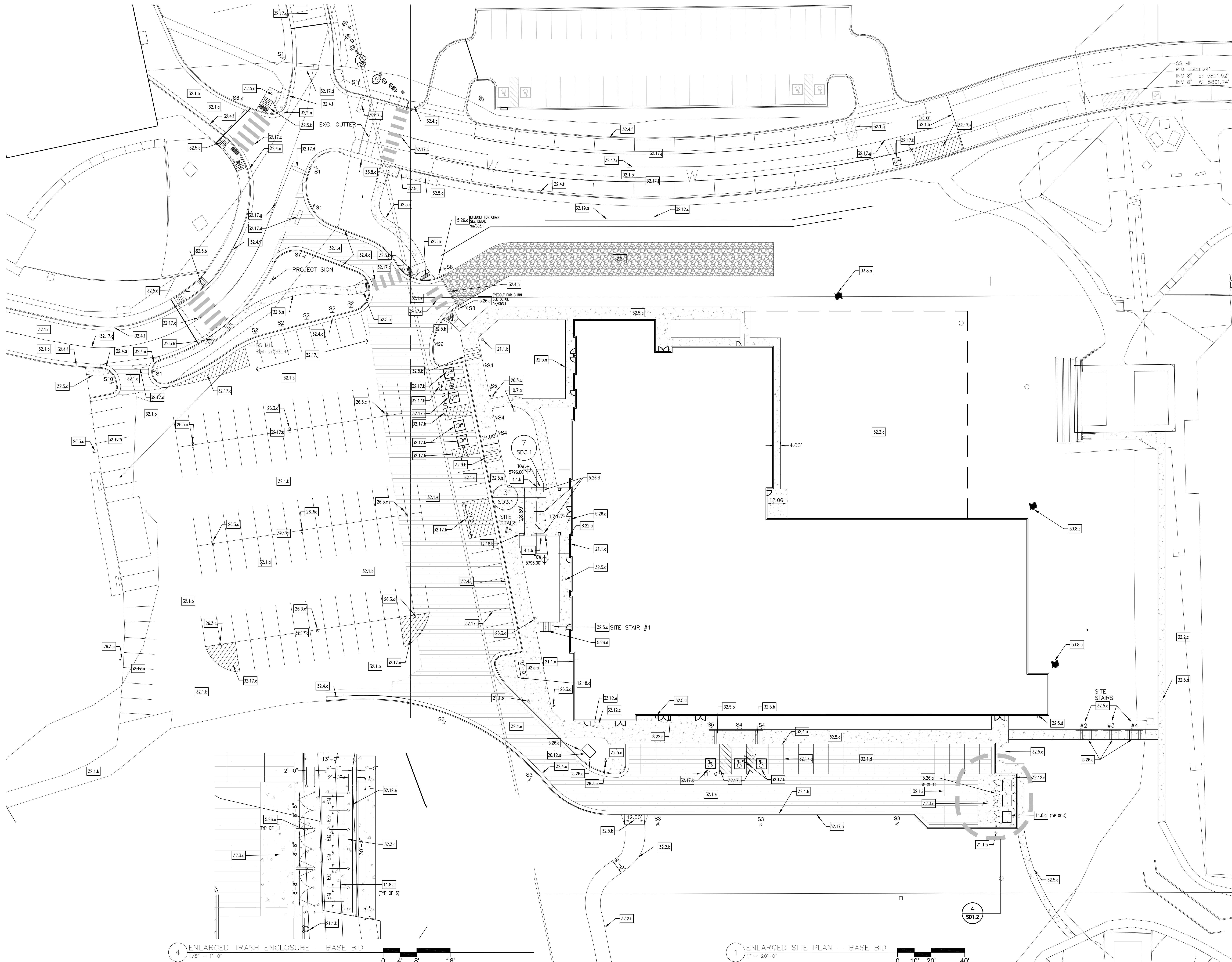

4 ENLARGED TRASH ENCLOSURE - BASE BID  
1/8" = 1'-0"

1 ENLARGED SITE PLAN - BASE BID  
1" = 20'-0"



Construction Documents

Drawn:	TAH
Checked:	DKO
Issued:	30 March 2022
Revised:	
EPC Resubmittal	20 April 2022
CCD #002	05 May 2022
CCD #003	25 May 2022

Area Key Plan

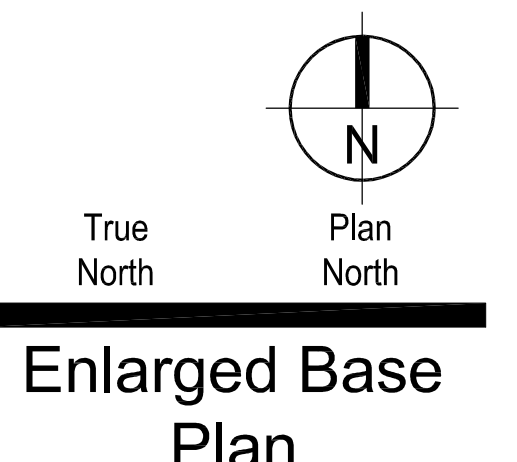

Enlarged Base Plan  
**SD1.2**  
 Project No. 21-004  
 The LKA Partners Incorporated



**Curb and Gutter General Notes**

- PROVIDE EJ AT EACH END OF CURB AND DIRECTIONAL CHANGES
- CATCH OR SPILL GUTTER TO MATCH THE SLOPE OF ADJACENT PAVEMENT

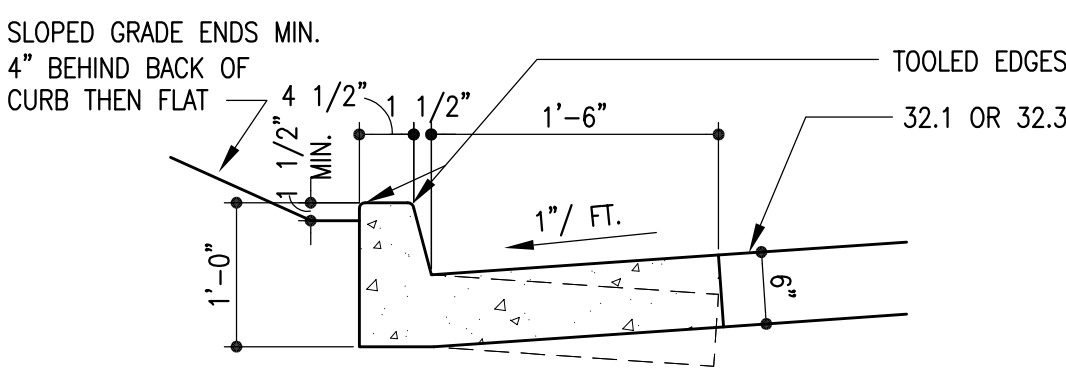

**25a** Typ Catch / Spill Curb  
Scale: 3/4" = 1'-0"

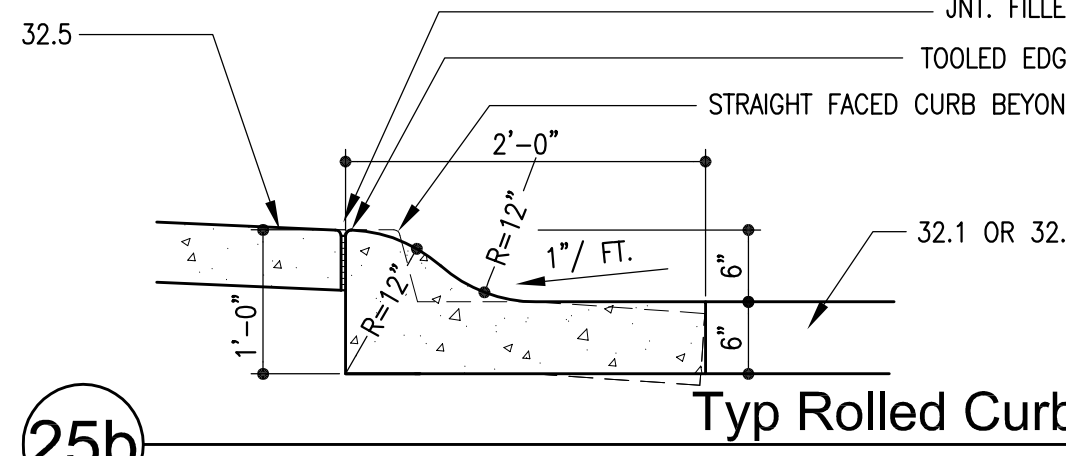

**25b** Typ Rolled Curb  
Scale: 3/4" = 1'-0"

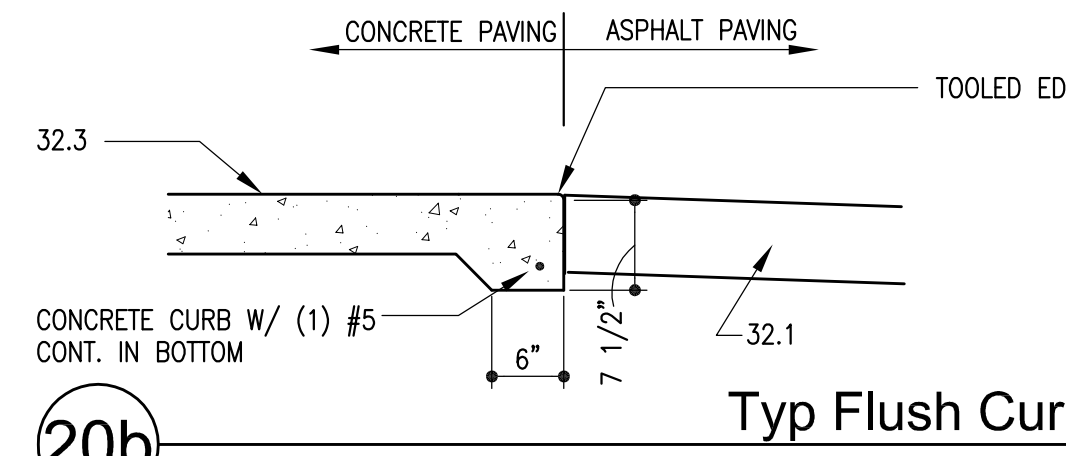

**20b** Typ Flush Curb  
Scale: 3/4" = 1'-0"

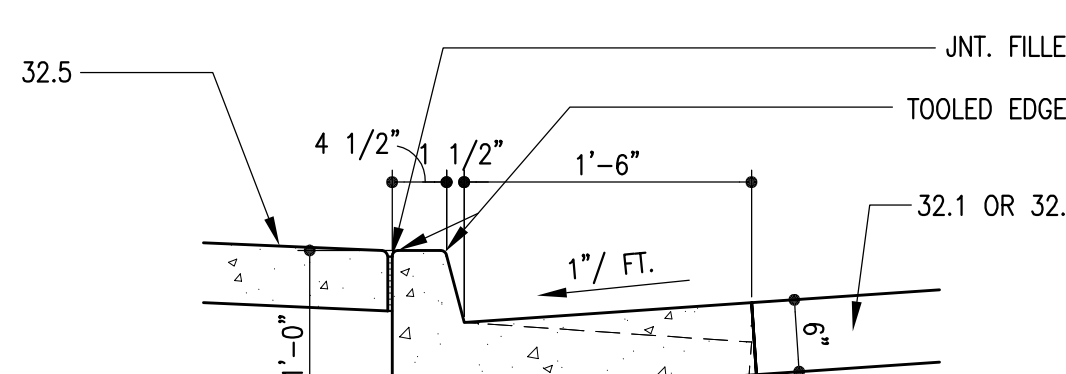

**25a** Typ Catch / Spill Curb  
Scale: 3/4" = 1'-0"

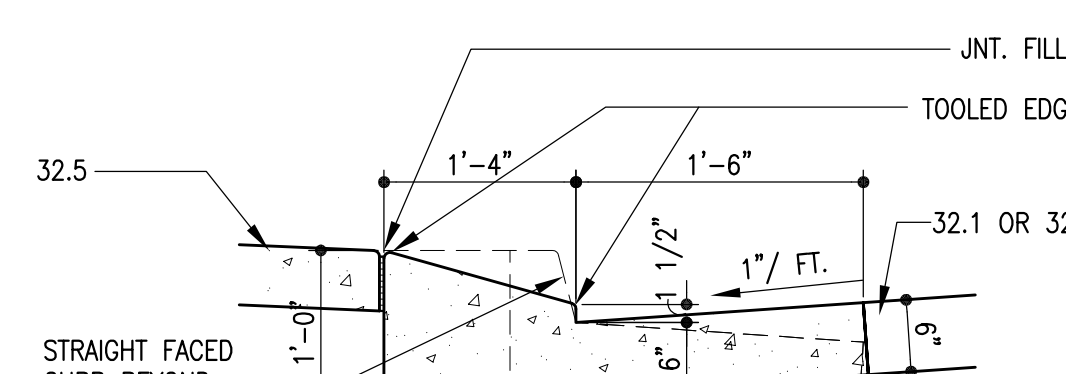

**20a** Typ Ramped Curb  
Scale: 3/4" = 1'-0"

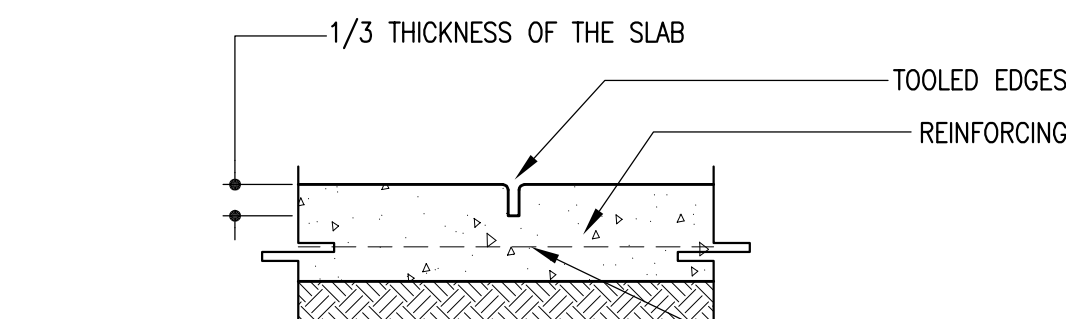

**29b** Typ Contraction Joint  
Scale: 1 1/2" = 1'-0"

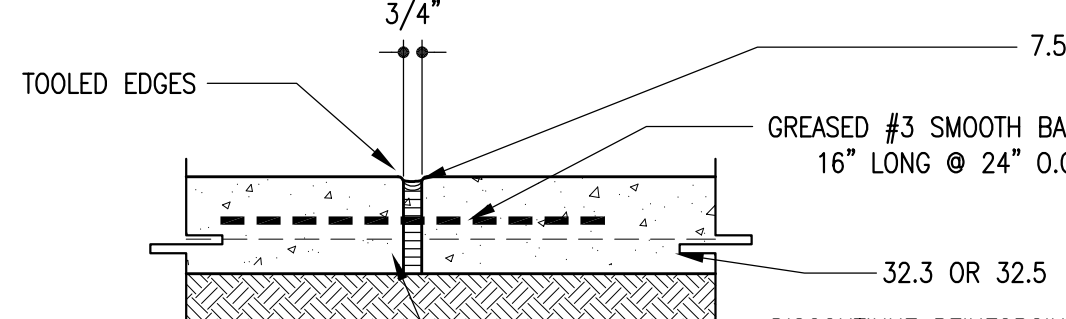

**24b** Typ Isolation / Expansion Joint  
Scale: 1 1/2" = 1'-0"

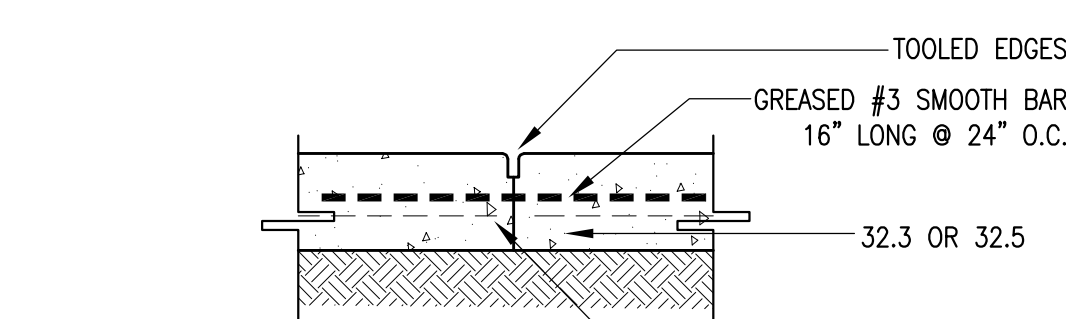

**29a** Typ Construction Joint  
Scale: 1 1/2" = 1'-0"

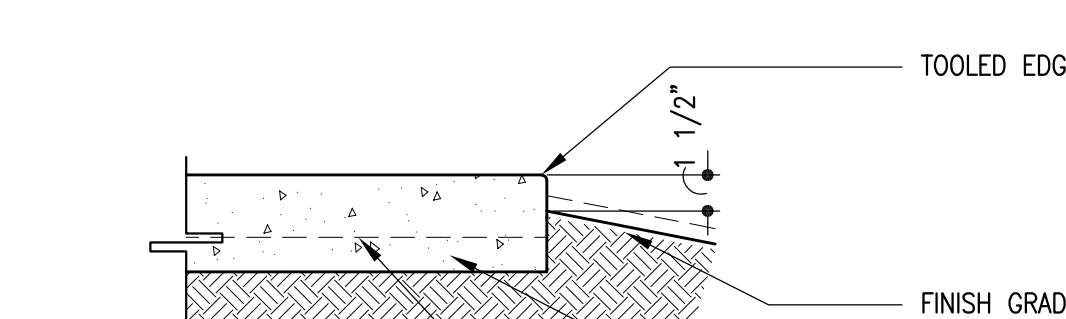

**24a** Typ Sidewalk Edge  
Scale: 1 1/2" = 1'-0"

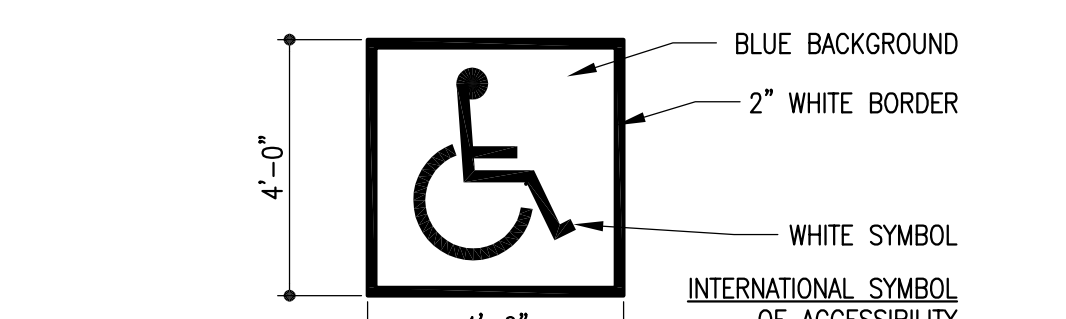

**19** Typical Pavement Markings  
No Scale

**EXTERIOR SIGN SCHEDULE**

Type	Text / Graphic	Size	Vulcan / MUTCD Number	Comment
S1	STOP	30"x30" OCTAGON	R1-1	
S2	COMPACT CARS ONLY	6"x12"	R7-6-9	
S3	NO PARKING FIRE LANE	12"x18"	R7-6-9	
S4	HANDICAPPED PARKING GRAPHIC	18"x18"	D9-6	
S5	VAN ACCESSIBLE	12"x6"	R7-6-9	
S7	DO NOT ENTER	30"x30"	R5-1	
S8	AUTHORIZED VEHICLES ONLY	12"x18"	R8-31	
S9	ONE WAY	36"x12"	R6-1	SEE SITE PLAN FOR DIRECTION
S10	USE OF TOOLS PRODUCTS PROHIBITED ON ALL SCHOOL PROPERTY.	18"x12"	C-1 (SIMILAR)	



**10** Typ Flush Curb  
Scale: 3/4" = 1'-0"

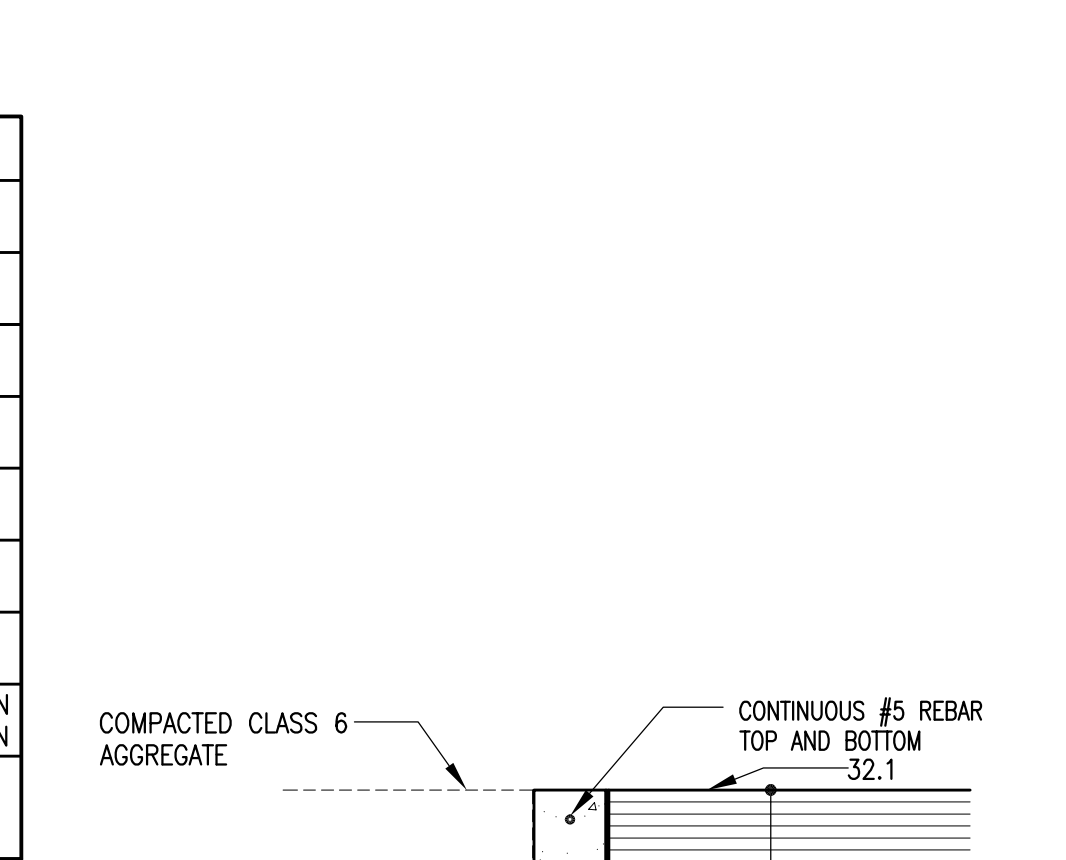

**5** Conc. Catch Basin  
Scale: 1/2" = 1'-0"

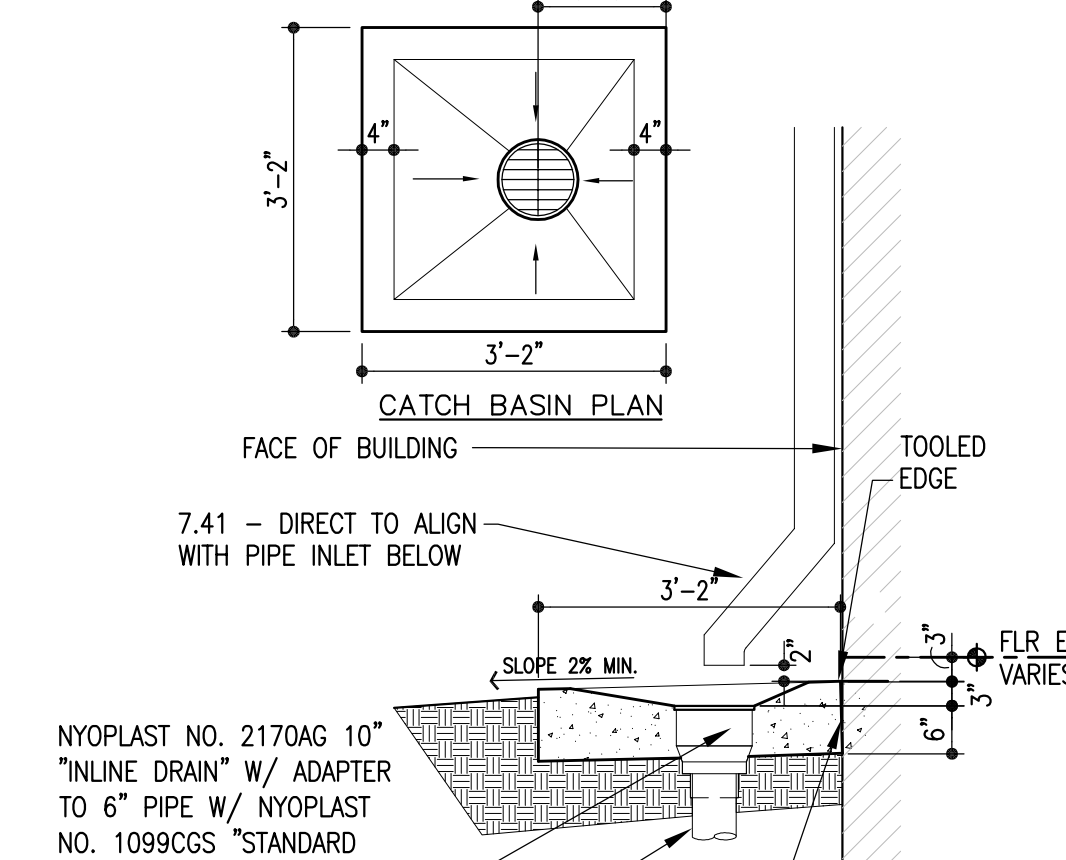

**9a** Typ Bollard Post  
Scale: 1/2" = 1'-0"

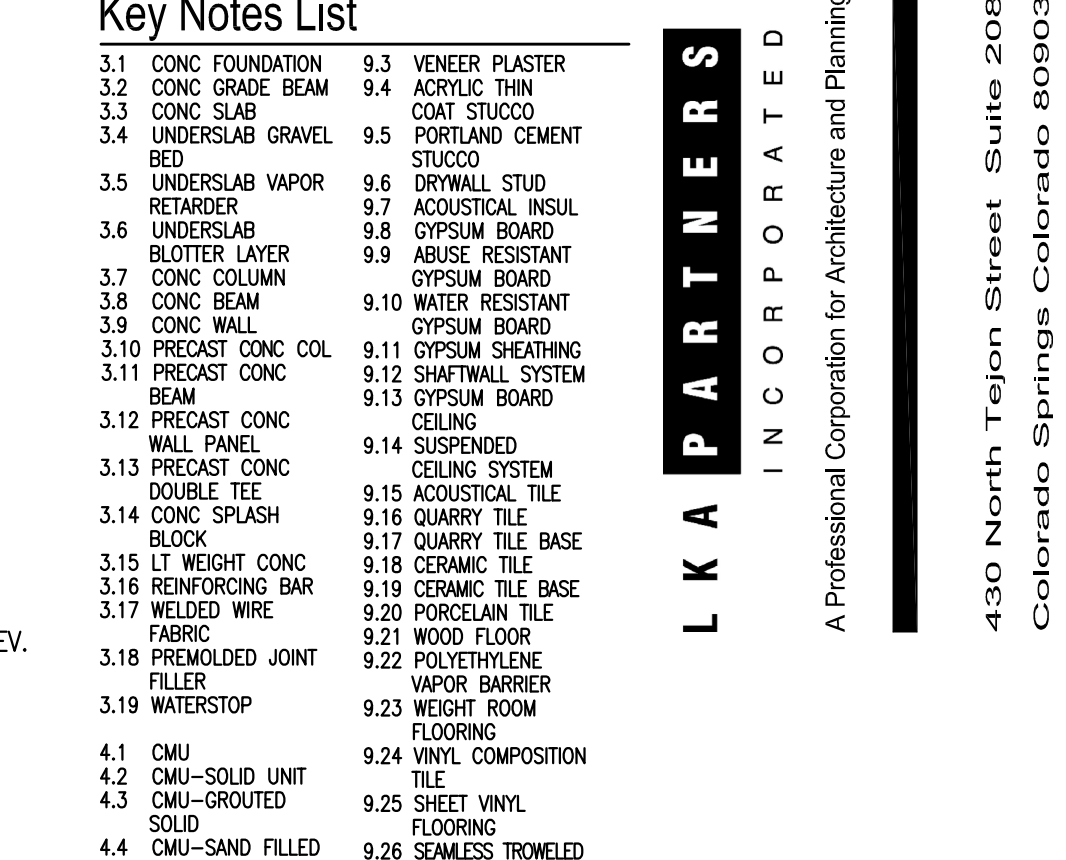

**4** Bike Rack Post Base  
Scale: 1/2" = 1'-0"

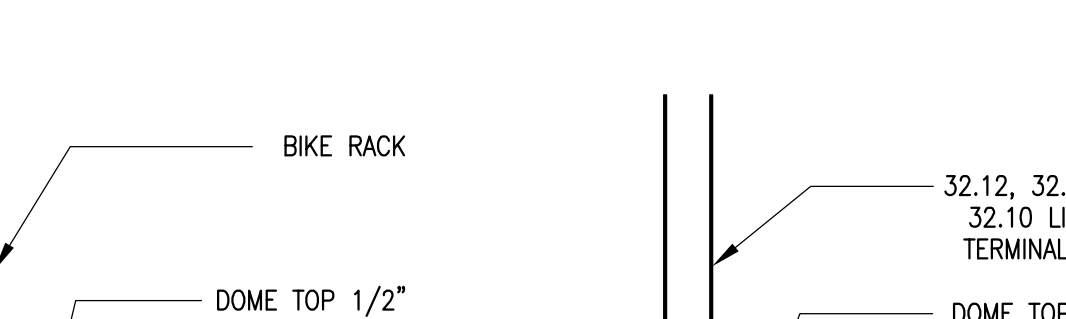

**4a** Typ Fence Post Base  
Scale: 1/2" = 1'-0"

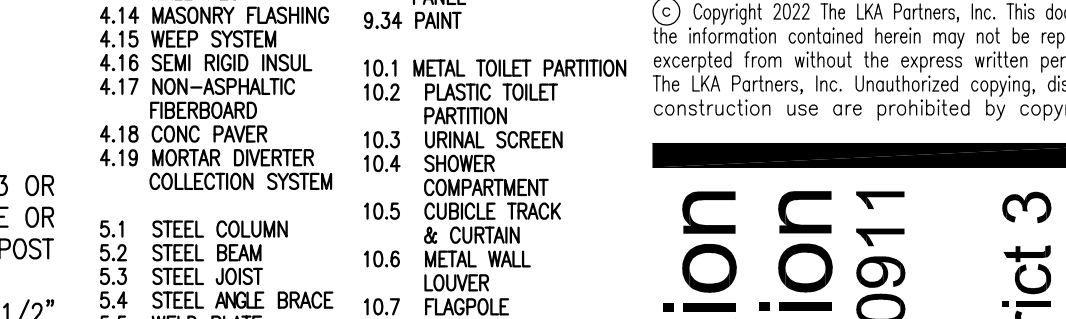

**8** Flagpole Detail  
Scale: 1/2" = 1'-0"

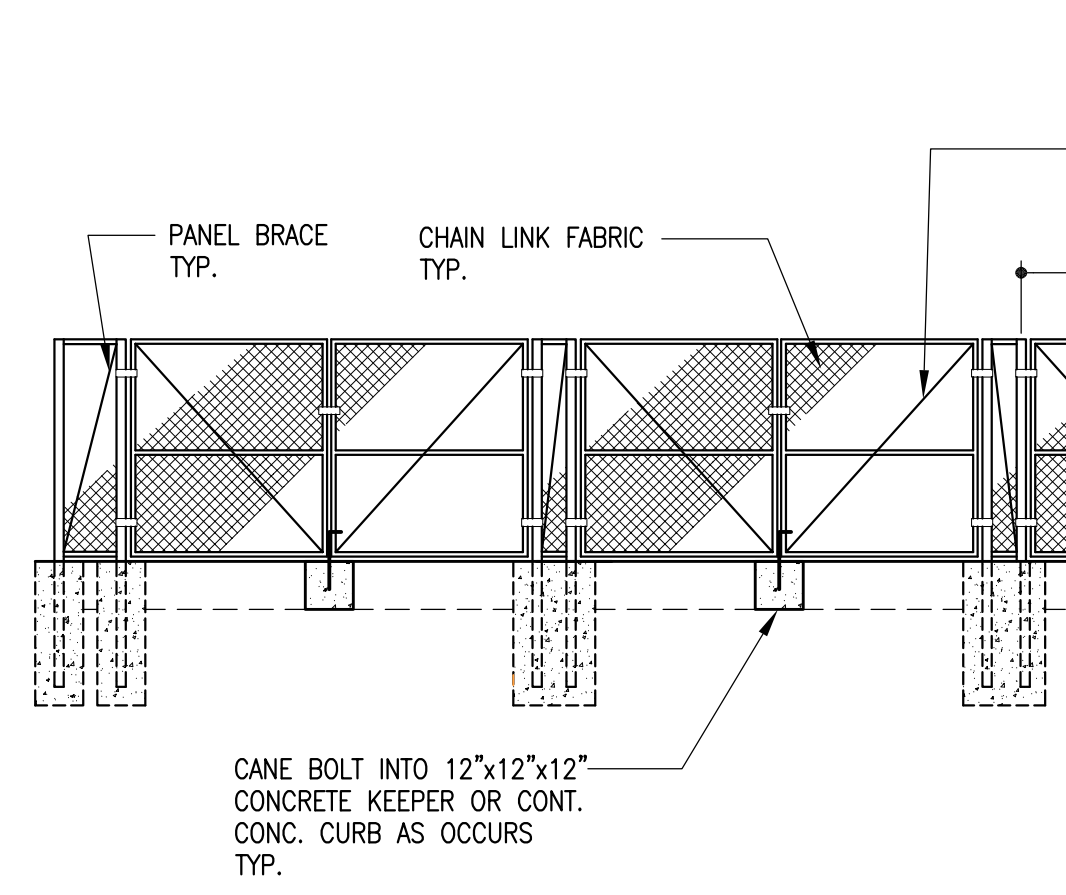

**28** Trash Enclosure  
Scale: 1/4" = 1'-0"

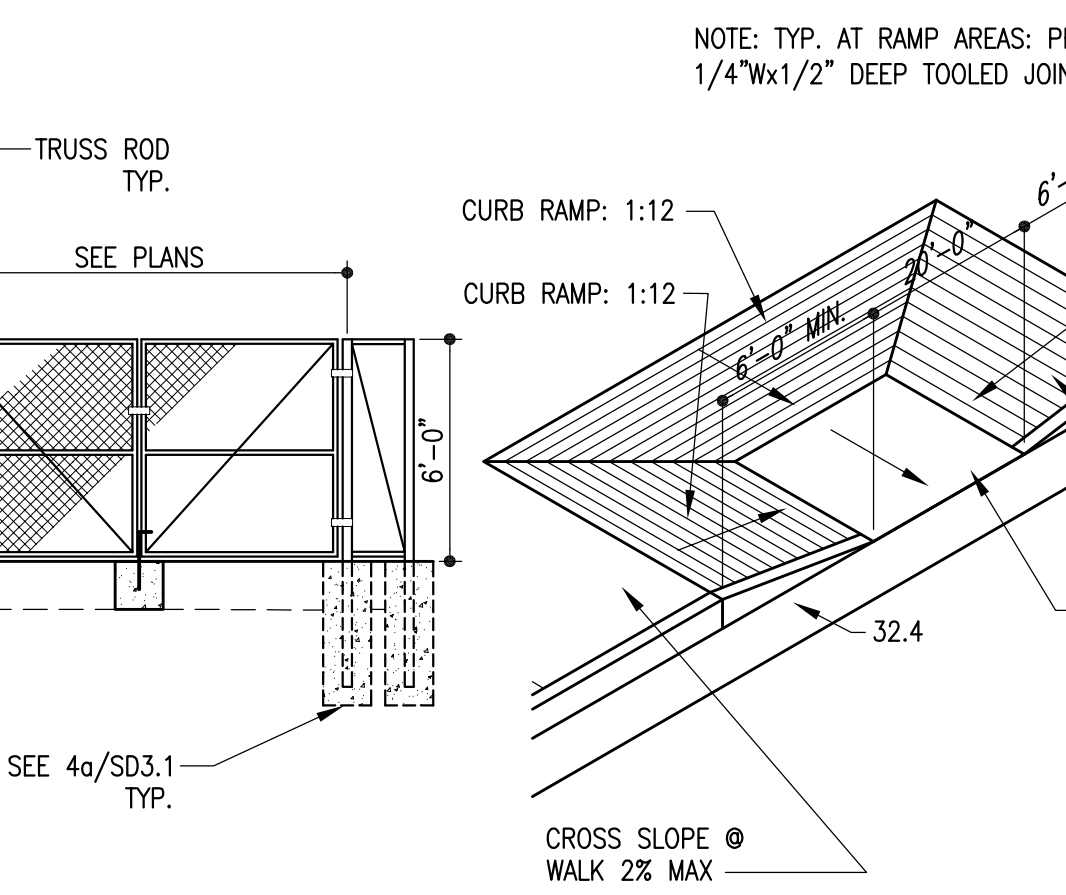

**23** Passenger Loading Zone Detail  
NTS

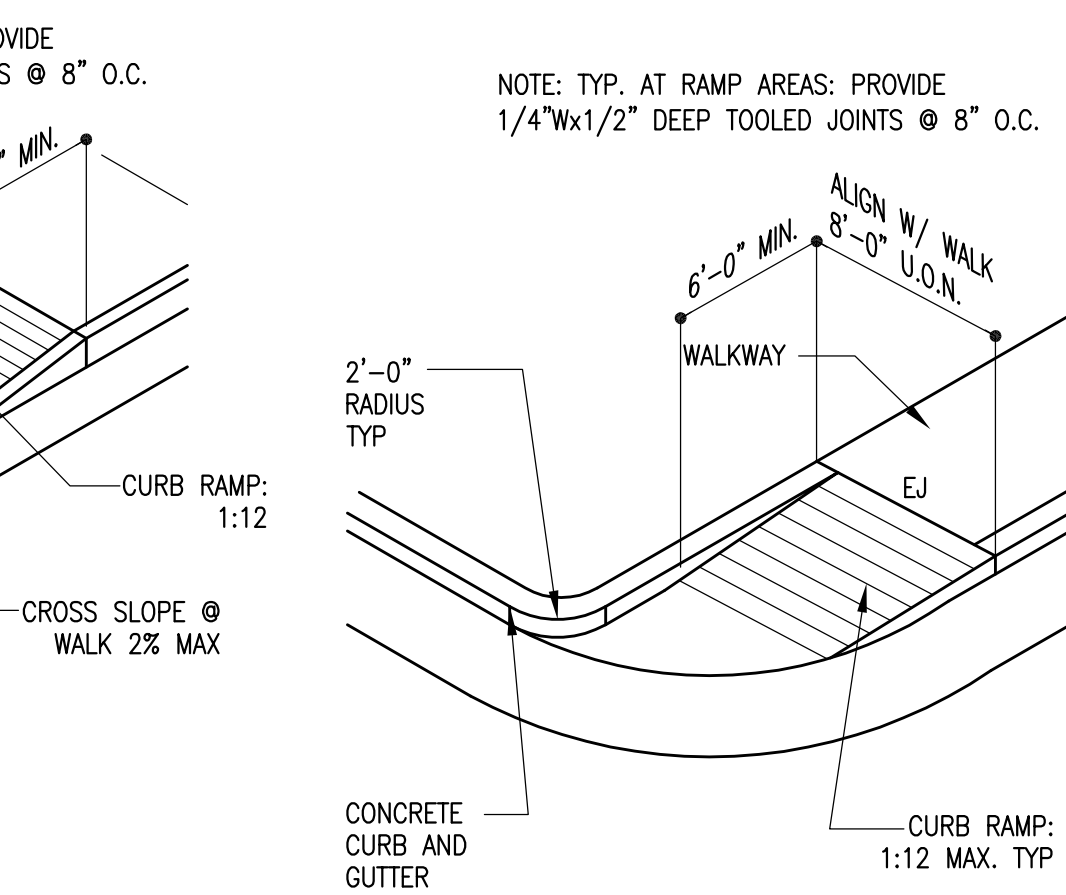

**17** Typical Accessible Ramp Details  
NTS

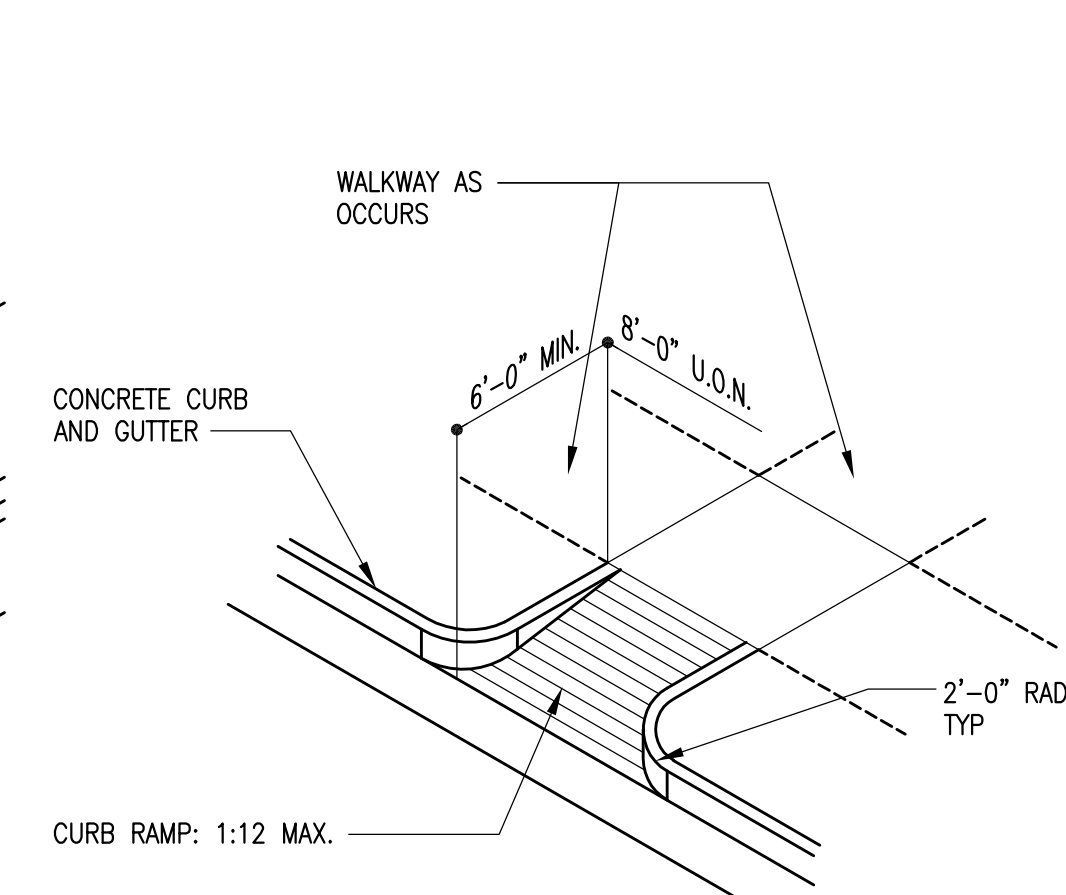

**7** Front Entrance Wall Detail  
Scale: 1-1/2" = 1'-0"

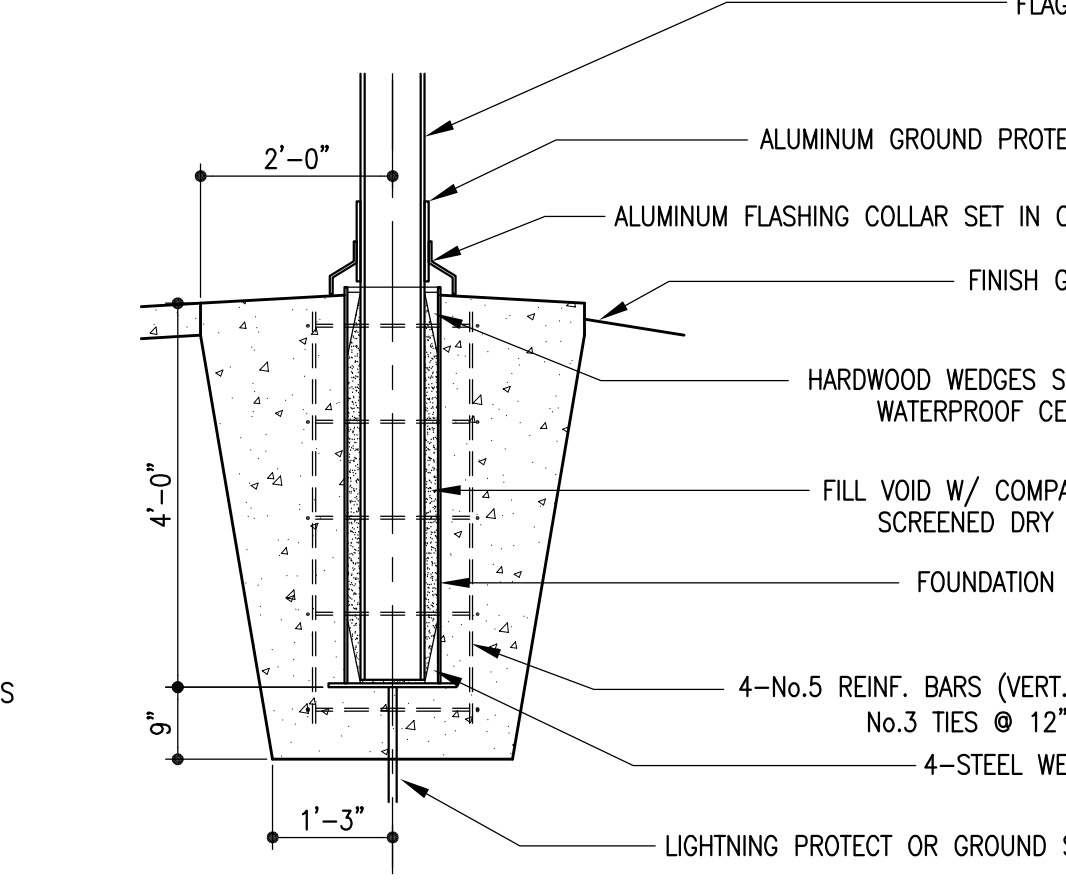

**2** Typ. Sign Mounting Graphic and Sched.  
1/4" = 1'-0"

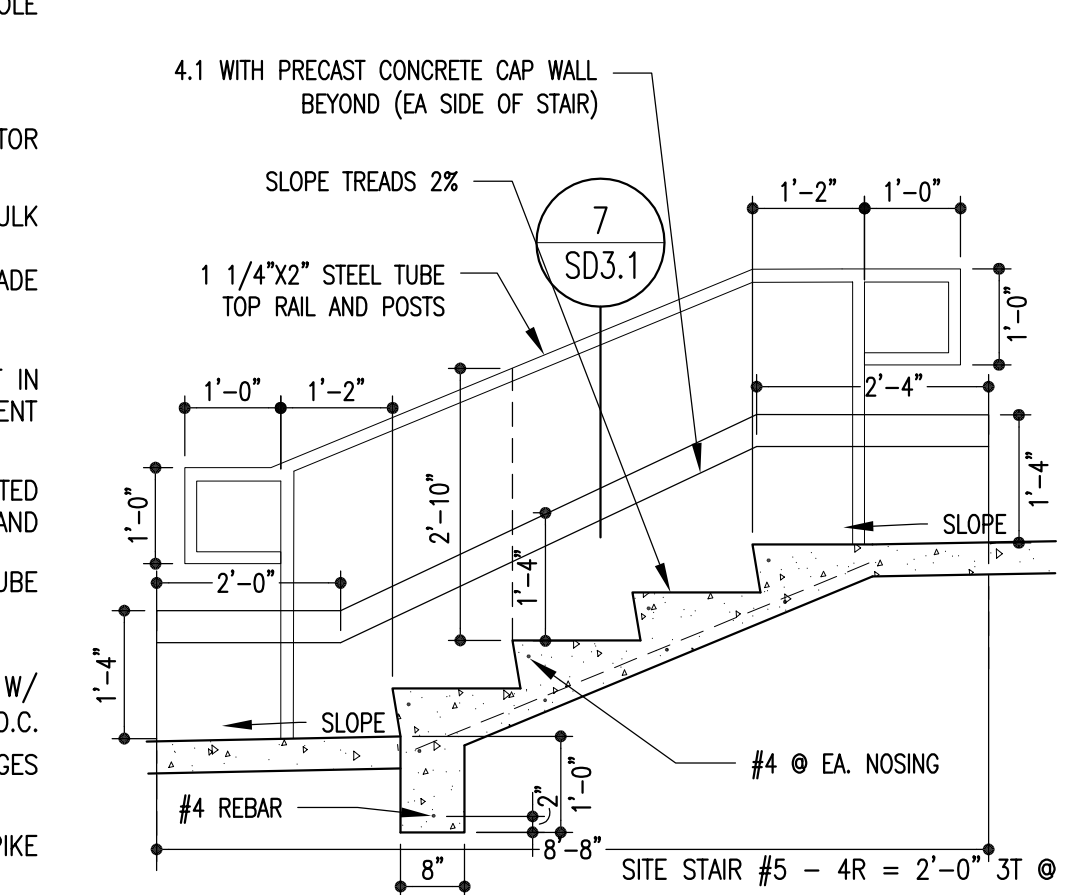

**3** Concrete Stair Detail  
Scale: 1/2" = 1'-0"

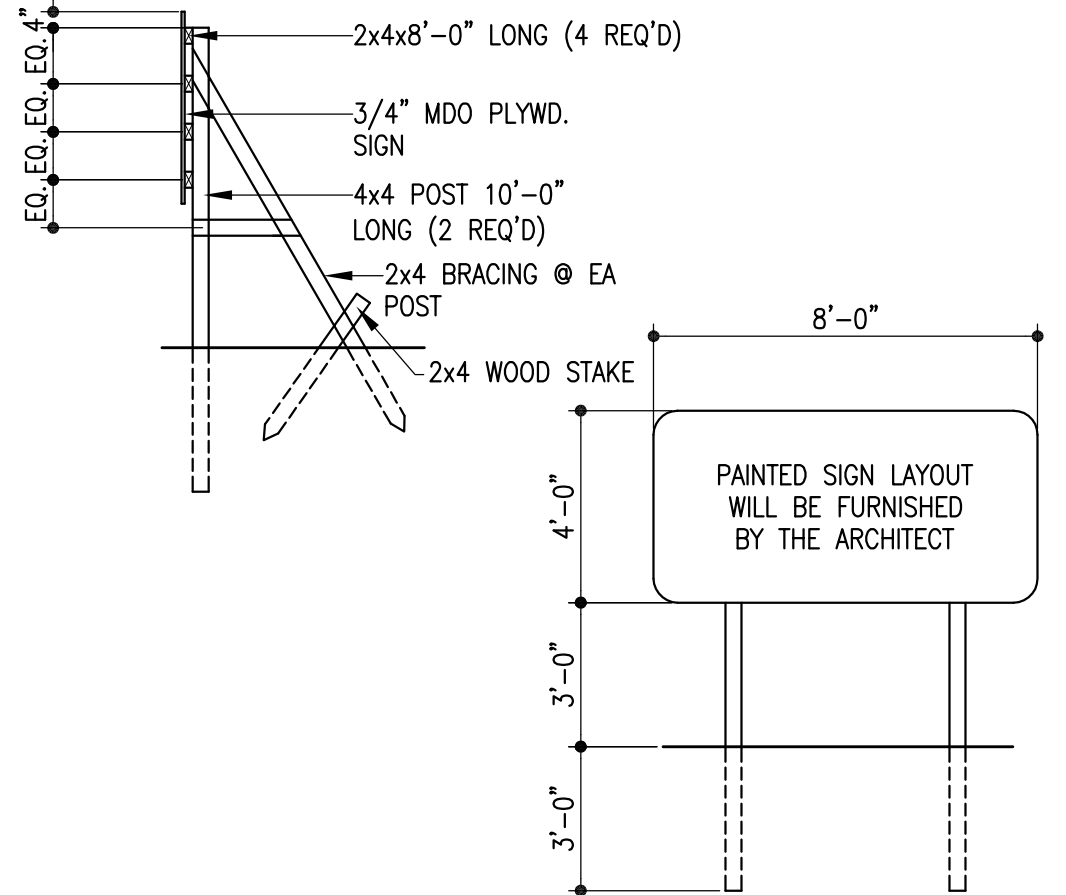

**27** Project Sign Detail  
Scale: 1/4" = 1'-0"

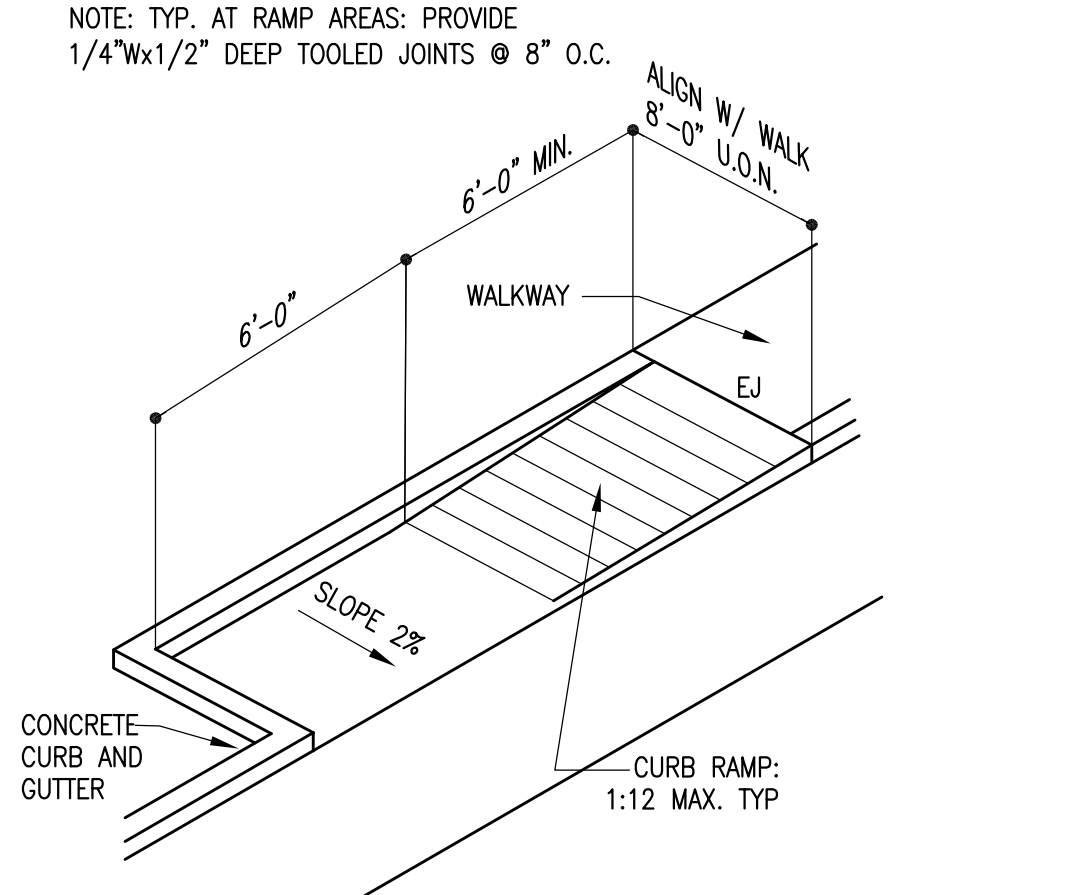

**22** HC Parking Ramp Detail  
NTS

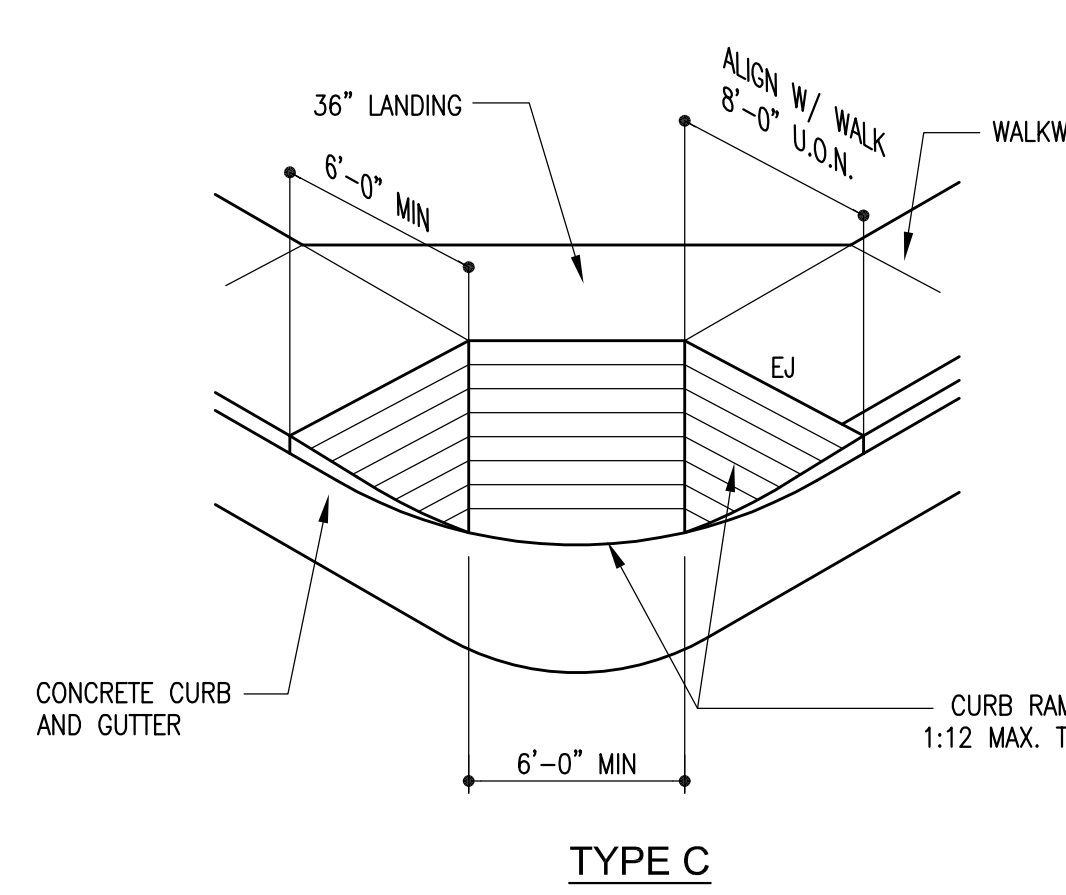

**17** Typical Accessible Ramp Details  
NTS

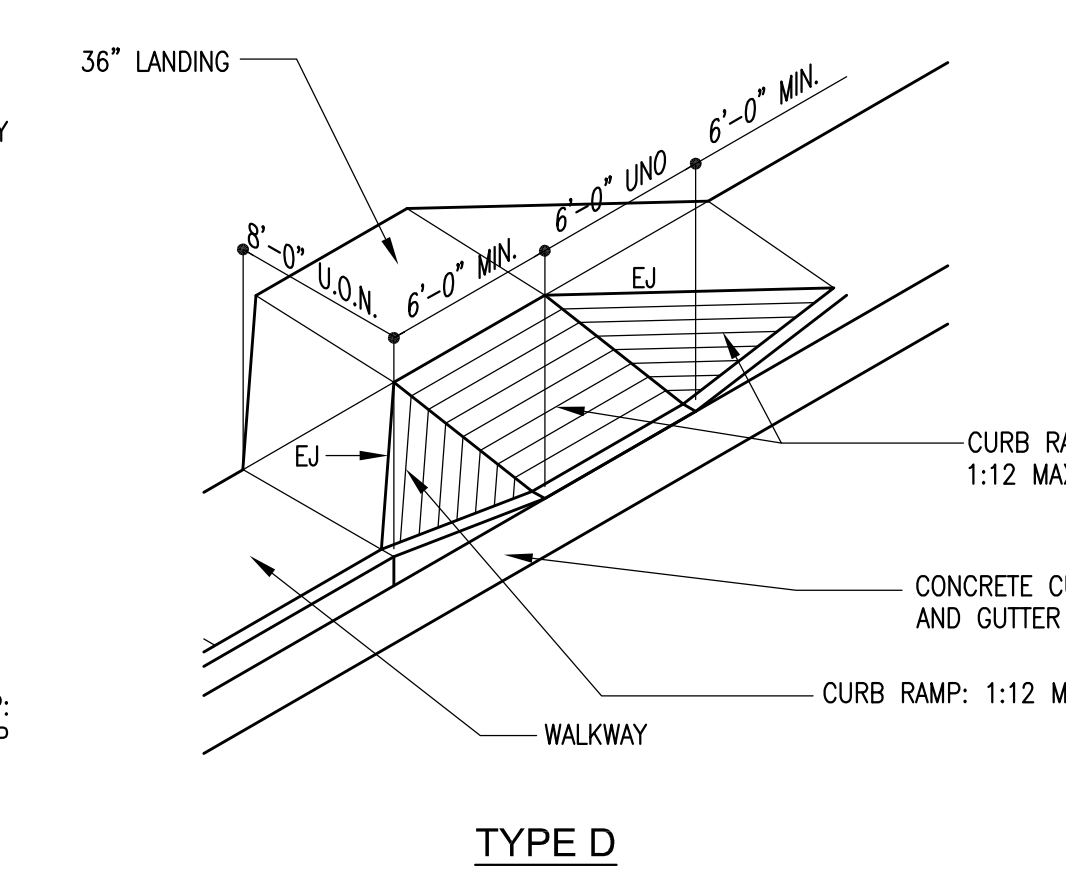

**7** Front Entrance Wall Detail  
Scale: 1-1/2" = 1'-0"

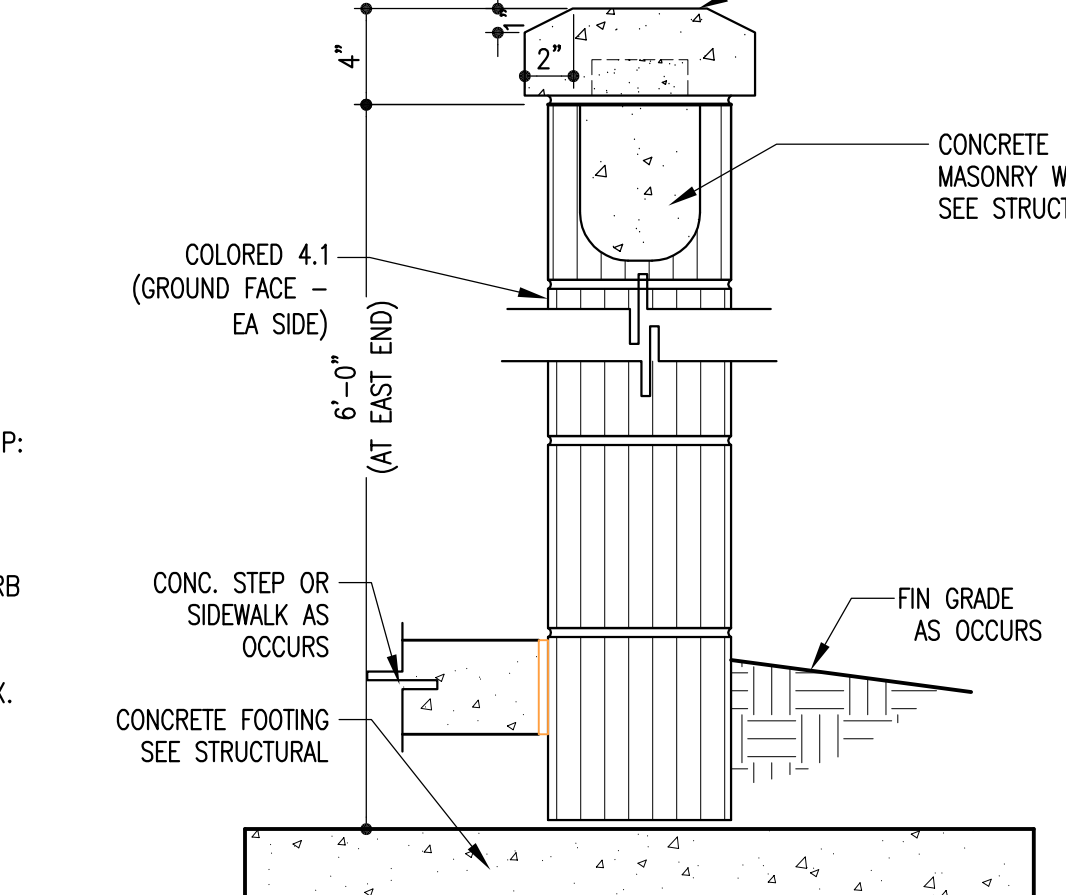

**2** Typ. Sign Mounting Graphic and Sched.  
1/4" = 1'-0"

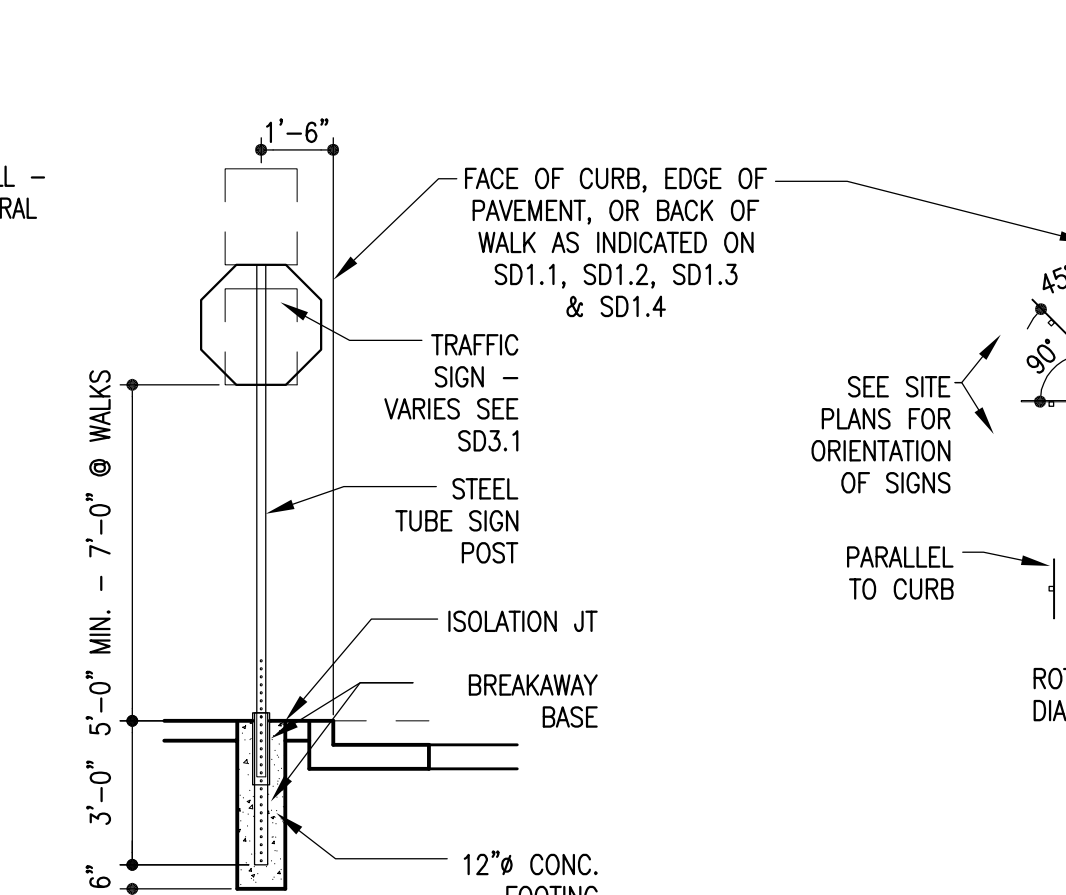

**3** Concrete Stair Detail  
Scale: 1/2" = 1'-0"

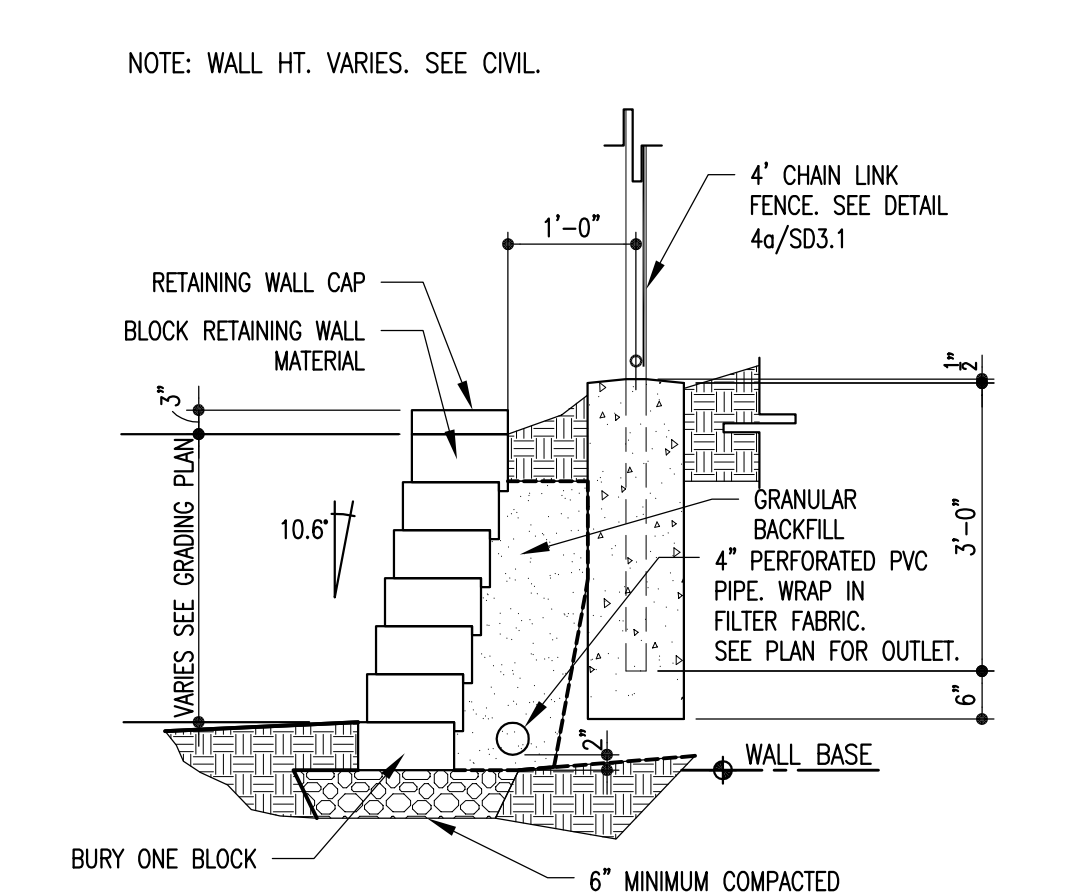

**26** Retaining Wall Detail  
Scale: 1/2" = 1'-0"

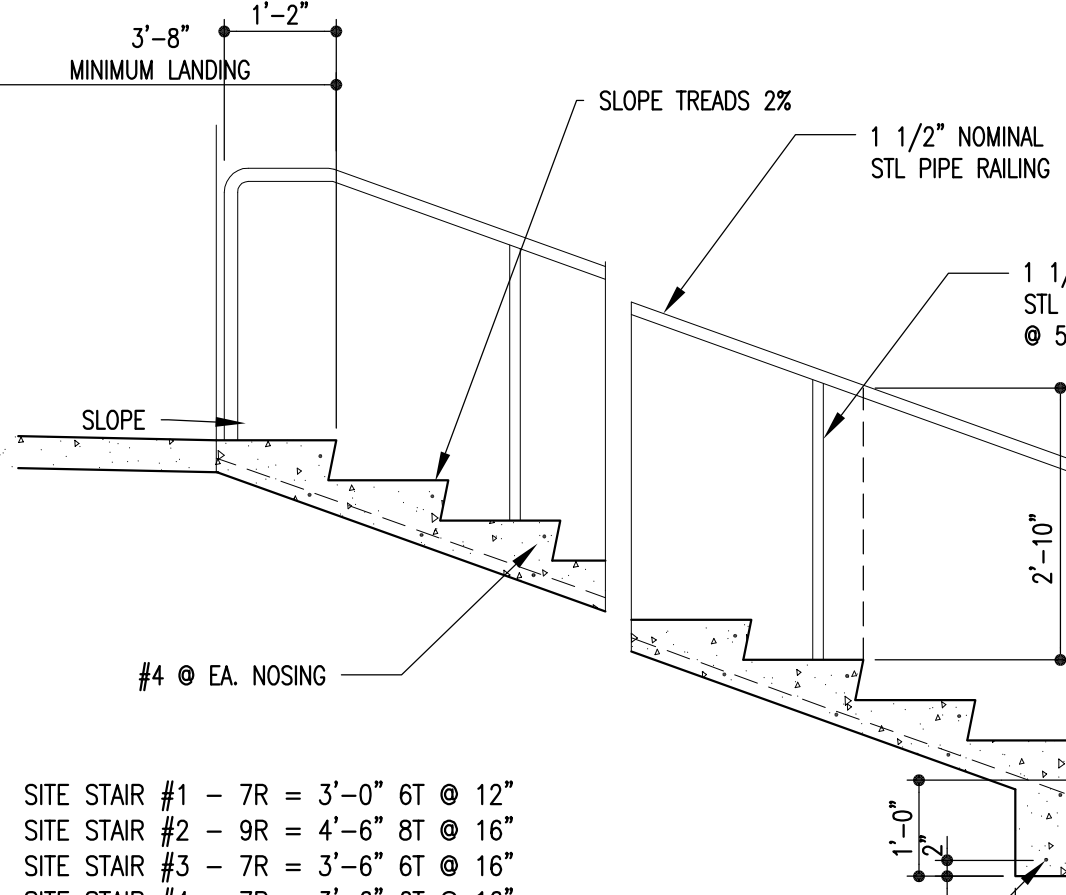

**21** Concrete Stair Detail  
Scale: 1/2" = 1'-0"

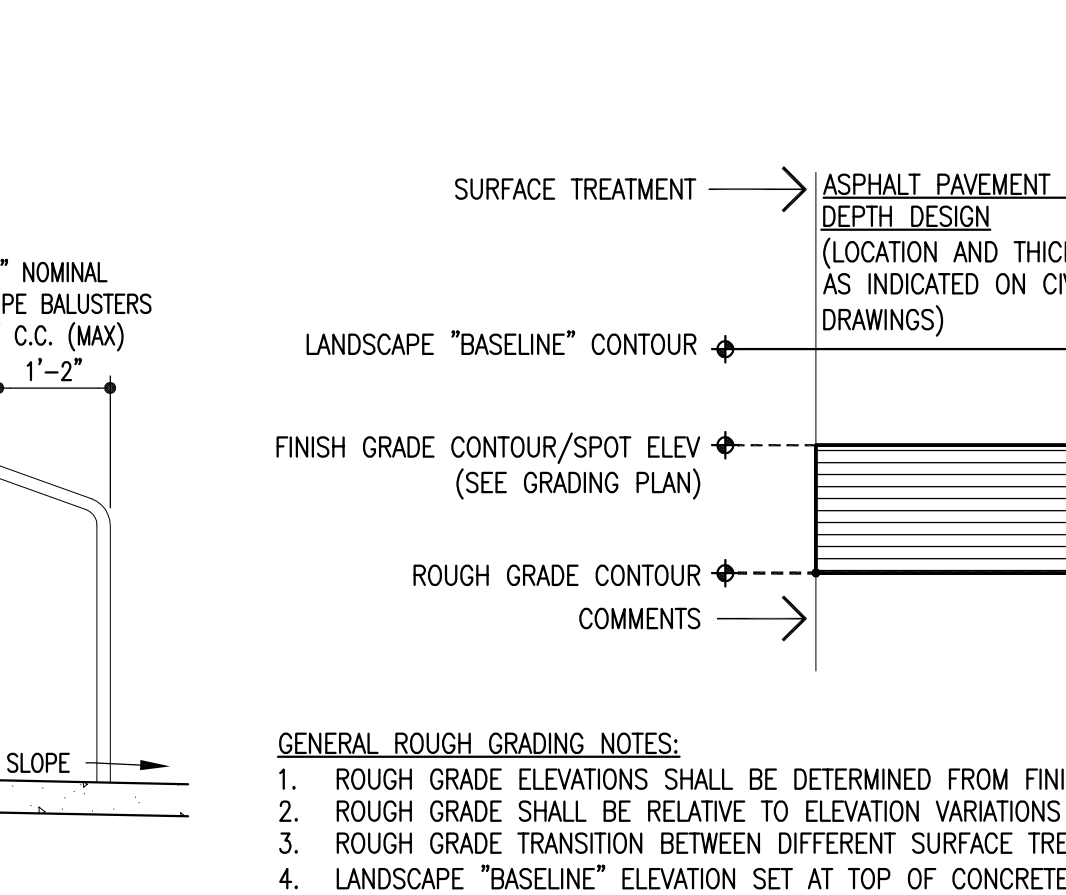

**16** Typical Accessible Ramp Details  
Scale: 1/2" = 1'-0"

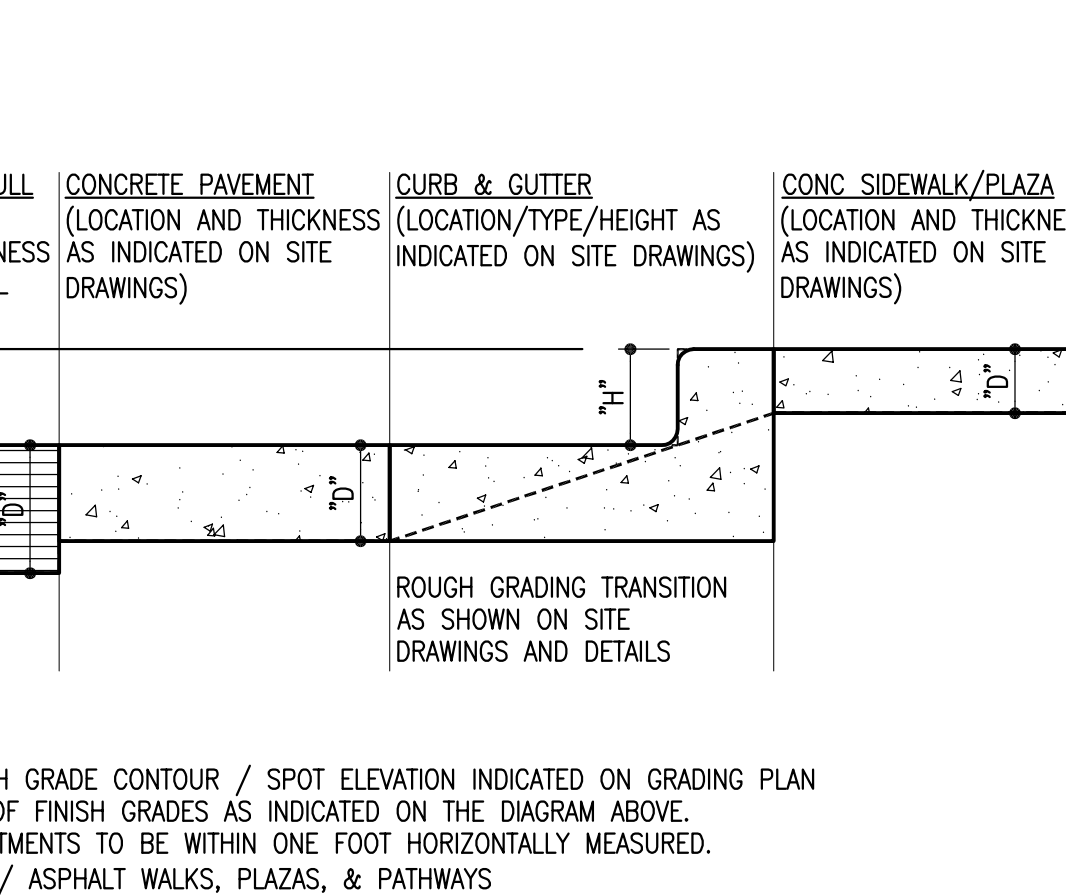

**16** Contour Grading and Relationship Detail  
Scale: 1" = 1'-0"

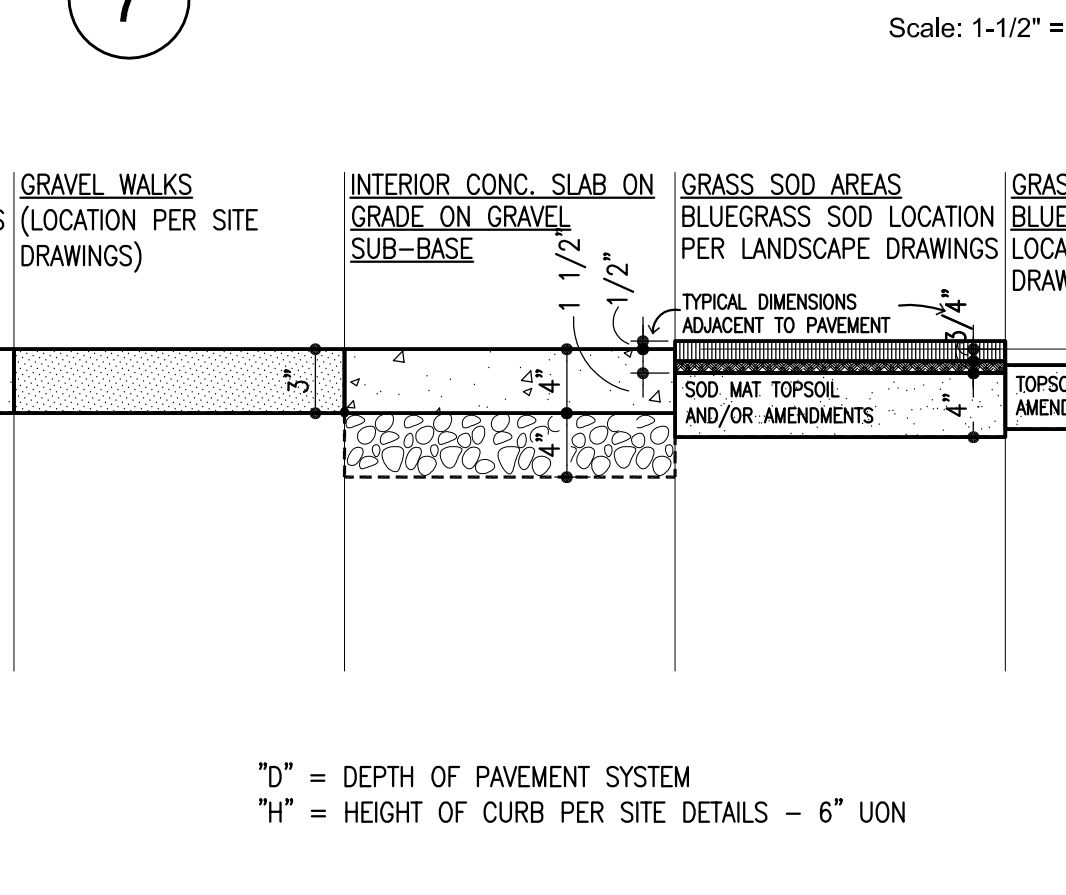

**16** Contour Grading and Relationship Detail  
Scale: 1" = 1'-0"

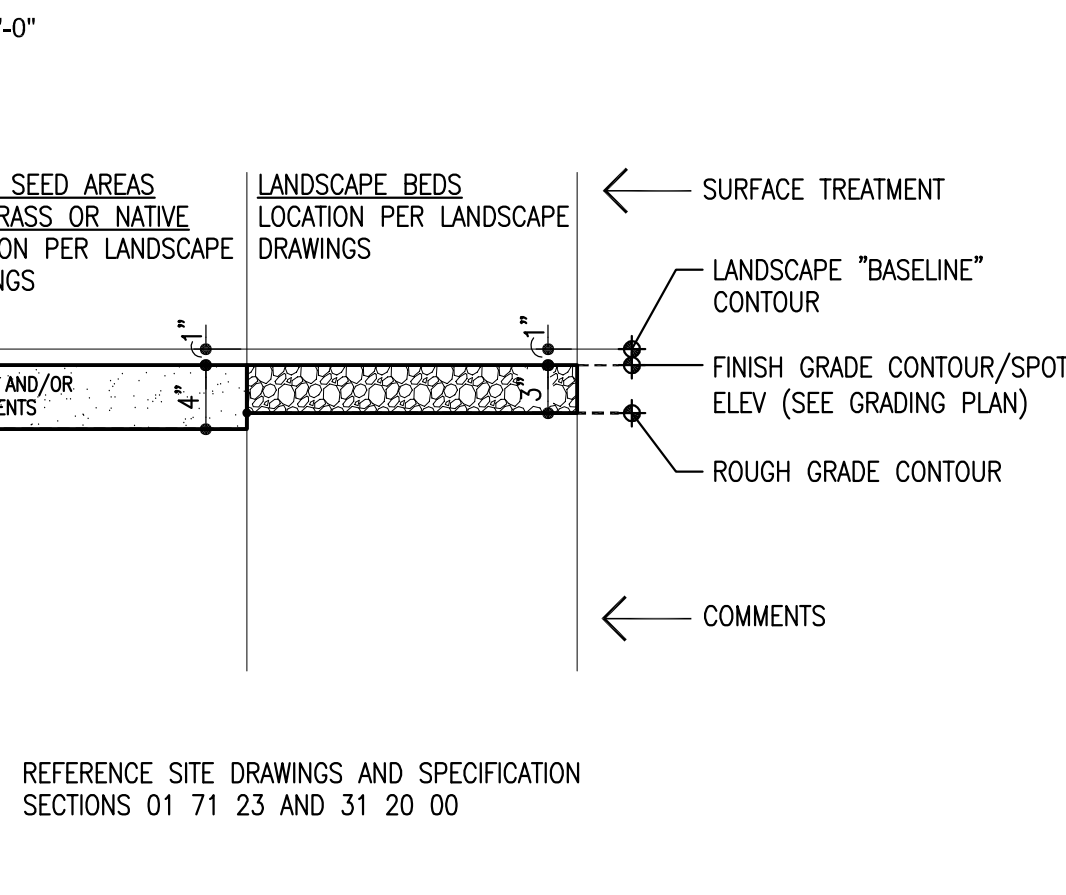

**16** Contour Grading and Relationship Detail  
Scale: 1" = 1'-0"

**Key Notes List**

3.1 CONG FOUNDATION	9.3 VENEER PLASTER
3.2 CONG BRICK	9.4 ACQUACIL TILE
3.3 CONG SLAB	9.5 COAT STUCCO
3.4 UNDERSLAB GRAVEL	9.6 POLYURETHANE CONCRETE
3.5 UNDERSLAB VAPOR	9.7 STUCCO
3.6 UNDERSLAB BOARD	9.8 FLOWN STUCCO
3.7 BUTTER LAYER	9.9 ACQUACIL INSUL
3.8 CONG COLUMN	9.10 ABUSE RESISTANT
3.9 CONG BEAM	9.11 WATER RESISTANT
3.10 PRECAST CONG COL	9.12 GYPSUM BOARD
3.11 PRECAST CONG BEAM	9.13 GYPSUM BOARD
3.12 PRECAST CONG WALL PANEL	9.14 GYPSUM BOARD
3.13 PRECAST CONG DOUBLE TEE	9.15 ACQUACIL CEILING
3.14 CONG SPLASH BLOCK	9.16 CEILING SYSTEM
3.15 1/2" WGT CONG	9.17 QUARRY TILE BASE
3.16 REINFORCING BAR	9.18 CERAMIC TILE
3.17 WELDED WIRE	9.19 CERAMIC TILE BASE
3.18 PREMADE JOINT FILLER	9.20 PORCELAIN TILE
3.19 INTERSTOP	9.21 WOOD FLOOR
3.20 W/OUT COMPOSITION TILE	9.22 WOOD FLOOR
3.21 SOLID FLOORING	9.23 WOOD FLOOR
3.22 SHEET VINYL FLOORING	9.24 WOOD FLOOR
3.23 CONG FLOORING	9.25 RUBBER TREADS & CARPETS
3.24 CONG SAND FILL	9.26 RUBBER TREADS & CARPETS
3.25 CONG FLOORING	9.27 RUBBER TREADS & CARPETS
3.26 CONG FLOORING	9.28 RUBBER TREADS & CARPETS
3.27 CONG FLOORING	9.29 RUBBER TREADS & CARPETS
3.28 CONG FLOORING	9.30 RUBBER TREADS & CARPETS
3.29 CONG FLOORING	9.31 RUBBER TREADS & CARPETS
3.30 CONG FLOORING	9.32 RUBBER TREADS & CARPETS
3.31 CONG FLOORING	9.33 RUBBER TREADS & CARPETS
3.32 CONG FLOORING	9.34 RUBBER TREADS & CARPETS
3.33 CONG FLOORING	9.35 RUBBER TREADS & CARPETS
3.34 CONG FLOORING	9.36 RUBBER TREADS & CARPETS
3.35 CONG FLOORING	9.37 RUBBER TREADS & CARPETS
3.36 CONG FLOORING	9.38 RUBBER TREADS & CARPETS
3.37 CONG FLOORING	9.39 RUBBER TREADS & CARPETS
3.38 CONG FLOORING	9.40 RUBBER TREADS & CARPETS
3.39 CONG FLOORING	9.41 RUBBER TREADS & CARPETS
3.40 CONG FLOORING	9.42 RUBBER TREADS & CARPETS
3.41 CONG FLOORING	9.43 RUBBER TREADS & CARPETS
3.42 CONG FLOORING	9.44 RUBBER TREADS & CARPETS
3.43 CONG FLOORING	9.45 RUBBER TREADS & CARPETS
3.44 CONG FLOORING	9.46 RUBBER TREADS & CARPETS
3.45 CONG FLOORING	9.47 RUBBER TREADS & CARPETS
3.46 CONG FLOORING	9.48 RUBBER TREADS & CARPETS
3.47 CONG FLOORING	9.49 RUBBER TREADS & CARPETS
3.48 CONG FLOORING	9.50 RUBBER TREADS & CARPETS
3.49 CONG FLOORING	9.51 RUBBER TREADS & CARPETS
3.50 CONG FLOORING	9.52 RUBBER TREADS & CARPETS
3.51 CONG FLOORING	9.53 RUBBER TREADS & CARPETS
3.52 CONG FLOORING	9.54 RUBBER TREADS & CARPETS
3.53 CONG FLOORING	9.55 RUBBER TREADS & CARPETS
3.54 CONG FLOORING	9.56 RUBBER TREADS & CARPETS
3.55 CONG FLOORING	9.57 RUBBER TREADS & CARPETS
3.56 CONG FLOORING	9.58 RUBBER TREADS & CARPETS
3.57 CONG FLOORING	9.59 RUBBER TREADS & CARPETS
3.58 CONG FLOORING	9.60 RUBBER TREADS & CARPETS
3.59 CONG FLOORING	9.61 RUBBER TREADS & CARPETS
3.60 CONG FLOORING	9.62 RUBBER TREADS & CARPETS
3.61 CONG FLOORING	9.63 RUBBER TREADS & CARPETS
3.62 CONG FLOORING	9.64 RUBBER TREADS & CARPETS
3.63 CONG FLOORING	9.65 RUBBER TREADS & CARPETS
3.64 CONG FLOORING	9.66 RUBBER TREADS & CARPETS
3.65 CONG FLOORING	9.67 RUBBER TREADS & CARPETS
3.66 CONG FLOORING	9.68 RUBBER TREADS & CARPETS
3.67 CONG FLOORING	9.69 RUBBER TREADS & CARPETS
3.68 CONG FLOORING	9.70 RUBBER TREADS & CARPETS
3.69 CONG FLOORING	9.71 RUBBER TREADS & CARPETS
3.70 CONG FLOORING	9.72 RUBBER TREADS & CARPETS
3.71 CONG FLOORING	9.73 RUBBER TREADS & CARPETS
3.72 CONG FLOORING	9.74 RUBBER TREADS & CARPETS
3.73 CONG FLOORING	9.75 RUBBER TREADS & CARPETS
3.74 CONG FLOORING	9.76 RUBBER TREADS & CARPETS
3.75 CONG FLOORING	9.77 RUBBER TREADS & CARPETS
3.76 CONG FLOORING	9.78 RUBBER TREADS & CARPETS
3.77 CONG FLOORING	9.79 RUBBER TREADS & CARPETS
3.78 CONG FLOORING	9.80 RUBBER TREADS & CARPETS
3.79 CONG FLOORING	9.81 RUBBER TREADS & CARPETS
3.80 CONG FLOORING	9.82 RUBBER TREADS & CARPETS
3.81 CONG FLOORING	9.83 RUBBER TREADS & CARPETS
3.82 CONG FLOORING	9.84 RUBBER TREADS & CARPETS
3.83 CONG FLOORING	9.85 RUBBER TREADS & CARPETS
3.84 CONG FLOORING	9.86 RUBBER TREADS & CARPETS
3.85 CONG FLOORING	9.87 RUBBER TREADS & CARPETS
3.86 CONG FLOORING	9.88 RUBBER TREADS & CARPETS
3.87 CONG FLOORING	9.89 RUBBER TREADS & CARPETS
3.88 CONG FLOORING	9.90 RUBBER TREADS & CARPETS
3.89 CONG FLOORING	9.91 RUBBER TREADS & CARPETS
3.90 CONG FLOORING	9.92 RUBBER TREADS & CARPETS
3.91 CONG FLOORING	9.93 RUBBER TREADS & CARPETS
3.92 CONG FLOORING	9.94 RUBBER TREADS & CARPETS
3.93 CONG FLOORING	9.95 RUBBER TREADS & CARPETS
3.94 CONG FLOORING	9.96 RUBBER TREADS & CARPETS
3.95 CONG FLOORING	9.97 RUBBER TREADS & CARPETS
3.96 CONG FLOORING	9.98 RUBBER TREADS & CARPETS
3.97 CONG FLOORING	9.99 RUBBER TREADS & CARPETS
3.98 CONG FLOORING	10.00 RUBBER TREADS & CARPETS
3.99 CONG FLOORING	10.01 RUBBER TREADS & CARPETS
4.00 CONG FLOORING	10.02 RUBBER TREADS & CARPETS

**L K A PART N E R S**  
INCORPORATED  
A Professional Corporation for Architecture and Planning  
430 North Tejon Street Suite 208  
Colorado Springs, Colorado 80903  
tele: 719.473.9446 fax: 719.473.9448  
web: www.lkapartners.com

Copyright 2022 The LKA Partners, Inc. This document and the information contained herein may not be reproduced or excerpted from without the express written permission of The LKA Partners, Inc. Unauthorized copying, disclosure or construction use are prohibited by copyright law.

**Widefield Parks and Recreation Facility Expansion**  
755 Aspen Drive, Colorado Springs, CO 80911  
**Widefield School District 3**  
1820 Main Street  
Colorado Springs, CO 80911



**Construction Documents**  
Drawn: TAH  
Checked: DKO  
Issued: 30 March 2022  
Revised:  
EPC Resubmittal 20 April 2022  
CCD #002 05 May 2022  
CCD #003 25 May 2022

**Area Key Plan**

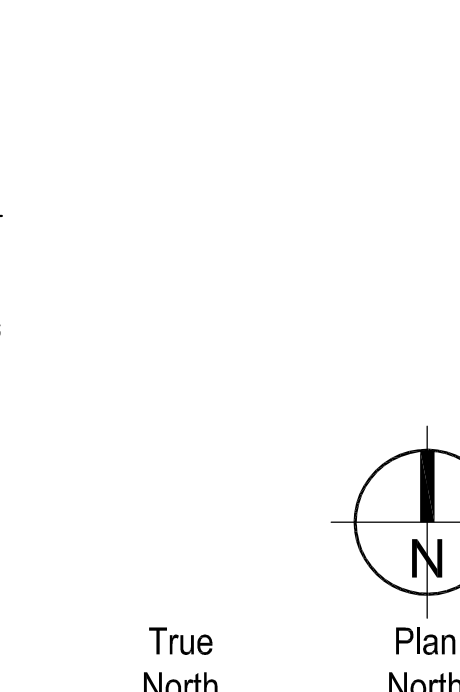

**Site Details**

**SD3.1**  
Project No. 21-004  
The LKA Partners Incorporated

NOTE: THE VENUE REFERENCE NUMBERS SHOWN ABOVE MAY OR MAY NOT CORRESPOND TO SPECIFICATION SECTIONS IN THE PROJECT MANUAL.



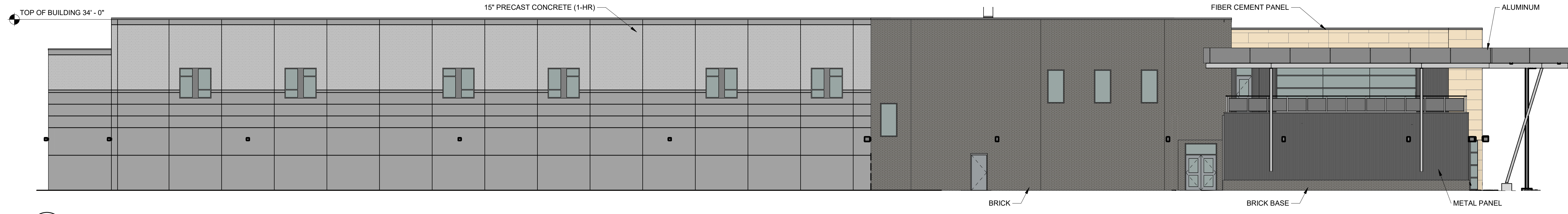

**29 NORTH ELEVATION**  
Scale: 3/32" = 1'-0"

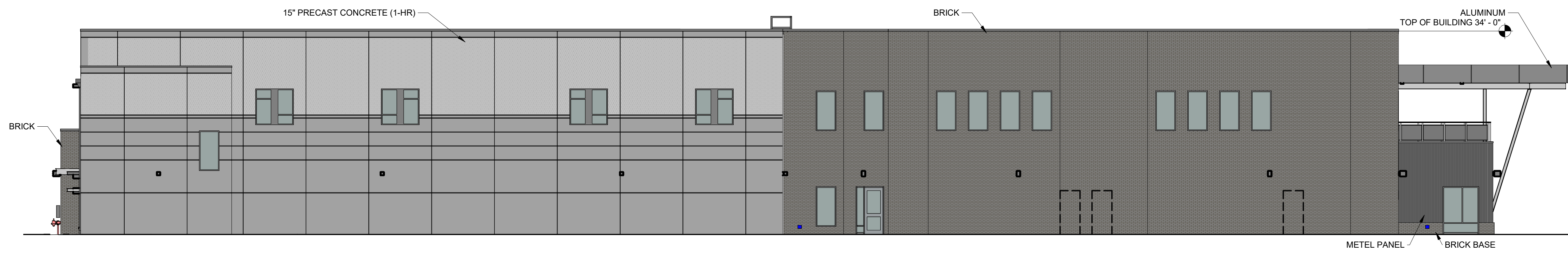

**28 EAST ELEVATION**  
Scale: 3/32" = 1'-0"

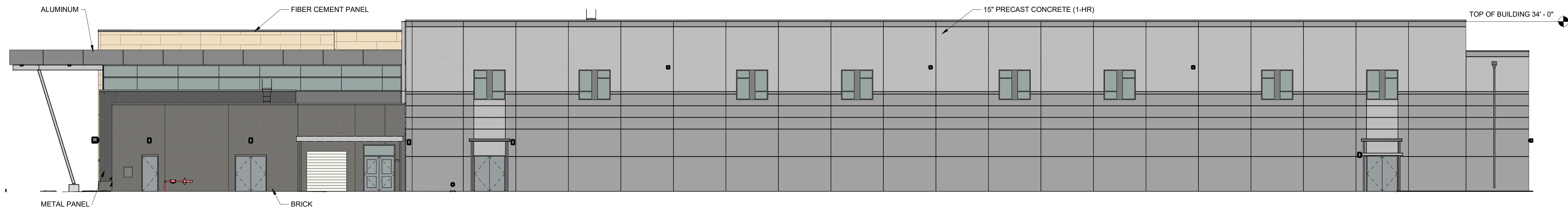

**27 SOUTH ELEVATION**  
Scale: 3/32" = 1'-0"

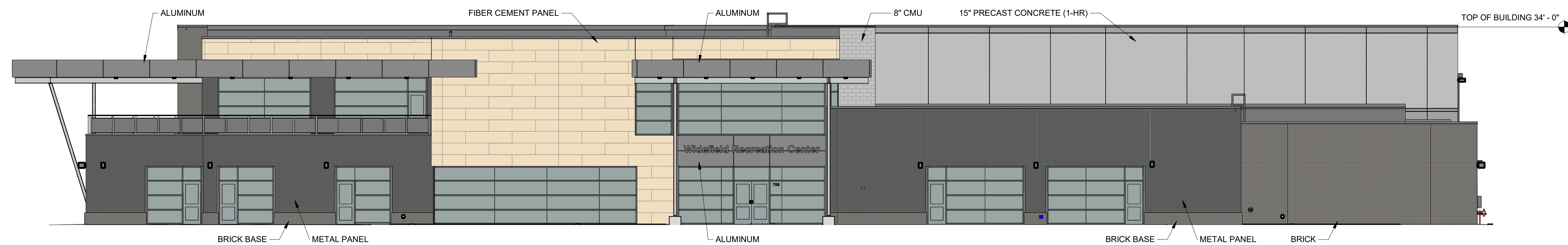

**26 WEST ELEVATION**  
Scale: 3/32" = 1'-0"



**Construction Documents**

Drawn: \_\_\_\_\_ DH  
Checked: \_\_\_\_\_ KO  
Issued: 28 January 2022  
Revised: \_\_\_\_\_

**Area Key Plan**

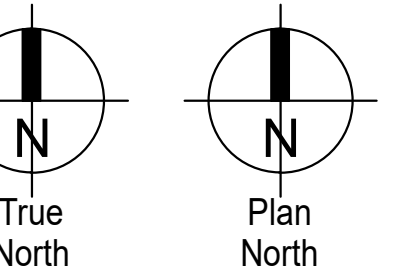
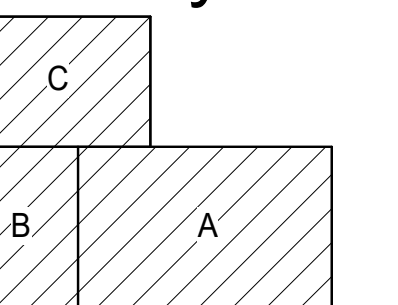

**BUILDING ELEVATIONS - OVERALL**

**A3**