

GATEWAY TRUCKING SITE DEVELOPMENT PLAN

LOCATED IN NW 1/4 OF NW 1/4 OF SECTION 20, TOWNSHIP 14 WEST, RANGE 6 WEST OF THE 6TH P.M.

CITY OF COLORADO SPRINGS, COUNTY OF EL PASO

STATE OF COLORADO

GRADING AND EROSION CONTROL PLAN

GRADING AND EROSION CONTROL STANDARD NOTES

- STORMWATER DISCHARGES FROM CONSTRUCTION SITES SHALL NOT CAUSE OR THREATEN TO CAUSE POLLUTION, CONTAMINATION, OR DEGRADATION OF STATE WATERS. ALL WORK AND EARTH DISTURBANCE SHALL BE DONE IN A MANNER THAT MINIMIZES POLLUTION OF ANY ON-SITE OR OFF-SITE WATERS, INCLUDING WETLANDS.
- NOTWITHSTANDING ANYTHING DEPICTED IN THESE PLANS IN WORDS OR GRAPHIC REPRESENTATION, ALL DESIGN AND CONSTRUCTION RELATED TO ROADS, STORM DRAINAGE AND EROSION CONTROL SHALL CONFORM TO THE STANDARDS AND REQUIREMENTS OF THE MOST RECENT VERSION OF THE RELEVANT ADOPTED EL PASO COUNTY STANDARDS, INCLUDING THE LAND DEVELOPMENT CODE, THE ENGINEERING CRITERIA MANUAL, THE DRAINAGE CRITERIA MANUAL, AND THE DRAINAGE CRITERIA MANUAL VOLUME 2. ANY DEVIATIONS FROM REGULATIONS AND STANDARDS MUST BE REQUESTED, AND APPROVED, IN WRITING.
- A SEPARATE STORMWATER MANAGEMENT PLAN (SMWP) FOR THIS PROJECT SHALL BE COMPLETED AND AN EROSION AND STORMWATER QUALITY CONTROL PERMIT (ESQCP) ISSUED PRIOR TO COMMENCING CONSTRUCTION. MANAGEMENT OF THE SWMP DURING CONSTRUCTION IS THE RESPONSIBILITY OF THE DESIGNATED QUALIFIED STORMWATER MANAGER OR CERTIFIED EROSION CONTROL INSPECTOR. THE SWMP SHALL BE LOCATED ON SITE AT ALL TIMES DURING CONSTRUCTION AND SHALL BE KEPT UP TO DATE WITH WORK PROGRESS AND CHANGES IN THE FIELD.
- ONCE THE ESQCP IS APPROVED AND A 'NOTICE TO PROCEED' HAS BEEN ISSUED, THE CONTRACTOR MAY INSTALL THE INITIAL STAGE EROSION AND SEDIMENT CONTROL MEASURES AS INDICATED ON THE APPROVED GEC. A PRECONSTRUCTION MEETING BETWEEN THE CONTRACTOR, ENGINEER, AND EL PASO COUNTY WILL BE HELD PRIOR TO ANY CONSTRUCTION. IT IS THE RESPONSIBILITY OF THE APPLICANT TO COORDINATE THE MEETING TIME AND PLACE WITH COUNTY STAFF.
- CONTROL MEASURES MUST BE INSTALLED PRIOR TO COMMENCEMENT OF ACTIVITIES THAT COULD CONTRIBUTE POLLUTANTS TO STORMWATER. CONTROL MEASURES FOR ALL SLOPES, CHANNELS, DITCHES, AND DISTURBED LAND AREAS SHALL BE INSTALLED IMMEDIATELY UPON COMPLETION OF THE DISTURBANCE.
- ALL TEMPORARY SEDIMENT AND EROSION CONTROL MEASURES SHALL BE MAINTAINED AND REMAIN IN EFFECTIVE OPERATING CONDITION UNTIL PERMANENT SOIL EROSION CONTROL MEASURES ARE IMPLEMENTED AND FINAL STABILIZATION IS ESTABLISHED. ALL PERSONS ENGAGED IN AND DISTURBANCE ACTIVITIES SHALL ASSESS THE ADEQUACY OF CONTROL MEASURES AT THE SITE AND IDENTIFY IF CHANGES TO THOSE CONTROL MEASURES ARE NEEDED TO ENSURE THE CONTINUED EFFECTIVE PERFORMANCE OF THE CONTROL MEASURES. ALL CHANGES TO TEMPORARY SEDIMENT AND EROSION CONTROL MEASURES MUST BE INCORPORATED INTO THE STORMWATER MANAGEMENT PLAN.
- TEMPORARY STABILIZATION SHALL BE IMPLEMENTED ON DISTURBED AREAS AND STOCKPILES WHERE GROUND DISTURBING CONSTRUCTION ACTIVITY HAS PERMANENTLY CEASED OR TEMPORARILY CEASED FOR LONGER THAN 14 DAYS.
- FINAL STABILIZATION MUST BE IMPLEMENTED AT ALL APPLICABLE CONSTRUCTION SITES. FINAL STABILIZATION IS ACHIEVED WHEN ALL GROUND DISTURBING ACTIVITIES ARE COMPLETE AND ALL DISTURBED AREAS EITHER HAVE A UNIFORM VEGETATIVE COVER WITH INDIVIDUAL PLANT DENSITY OF 70 PERCENT OF PRE-DISTURBANCE LEVELS ESTABLISHED OR EQUIVALENT PERMANENT ALTERNATIVE STABILIZATION METHOD IS IMPLEMENTED. ALL TEMPORARY SEDIMENT AND EROSION CONTROL MEASURES SHALL BE REMOVED UPON FINAL STABILIZATION AND BEFORE PERMIT CLOSURE.
- ALL PERMANENT STORMWATER MANAGEMENT FACILITIES SHALL BE INSTALLED AS DESIGNED IN THE APPROVED PLANS. ANY PROPOSED CHANGES THAT AFFECT THE DESIGN OR FUNCTION OF PERMANENT STORMWATER MANAGEMENT STRUCTURES MUST BE APPROVED BY THE ECM ADMINISTRATOR PRIOR TO IMPLEMENTATION.
- EARTH DISTURBANCES SHALL BE CONDUCTED IN SUCH A MANNER SO AS TO EFFECTIVELY MINIMIZE ACCELERATED SOIL EROSION AND RESULTING SEDIMENTATION. ALL DISTURBANCES SHALL BE DESIGNED, CONSTRUCTED, AND COMPLETED SO THAT THE EXPOSED AREA OF ANY DISTURBED LAND SHALL BE LIMITED TO THE SHORTEST PRACTICAL PERIOD OF TIME. PRE-EXISTING VEGETATION SHALL BE PROTECTED AND MAINTAINED WITHIN 50 HORIZONTAL FEET OF A WATERS OF THE STATE UNLESS SHOWN TO BE INFEASIBLE AND SPECIFICALLY REQUESTED AND APPROVED.
- COMPACTION OF SOIL MUST BE PREVENTED IN AREAS DESIGNATED FOR INFILTRATION CONTROL MEASURES OR WHERE FINAL STABILIZATION WILL BE ACHIEVED BY VEGETATIVE COVER. AREAS DESIGNATED FOR INFILTRATION CONTROL MEASURES SHALL ALSO BE PROTECTED FROM SEDIMENTATION DURING CONSTRUCTION UNTIL FINAL STABILIZATION IS ACHIEVED. IF COMPACTION PREVENTION IS NOT FEASIBLE DUE TO SITE CONSTRAINTS, ALL AREAS DESIGNATED FOR INFILTRATION AND VEGETATION CONTROL MEASURES MUST BE LOOSENED PRIOR TO INSTALLATION OF THE CONTROL MEASURE(S).
- ANY TEMPORARY OR PERMANENT FACILITY DESIGNED AND CONSTRUCTED FOR THE CONVEYANCE OF STORMWATER AROUND, THROUGH, OR FROM THE EARTH DISTURBANCE AREA SHALL BE A STABILIZED CONVEYANCE DESIGNED TO MINIMIZE EROSION AND THE DISCHARGE OF SEDIMENT OFF SITE.
- CONCRETE WASH WATER SHALL BE CONTAINED AND DISPOSED OF IN ACCORDANCE WITH THE SWMP. NO WASH WATER SHALL BE DISCHARGED TO OR ALLOWED TO ENTER STATE WATERS, INCLUDING ANY SURFACE OR SUBSURFACE STORM DRAINAGE SYSTEM OR FACILITIES. CONCRETE WASHOUTS SHALL NOT BE LOCATED IN AN AREA WHERE SHALLOW GROUNDWATER MAY BE PRESENT, OR WITHIN 50 FEET OF A SURFACE WATER BODY, CREEK OR STREAM.
- DURING DEWATERING OPERATIONS OF UNCONTAMINATED GROUND WATER MAY BE DISCHARGED ON SITE, BUT SHALL NOT LEAVE THE SITE IN THE FORM OF SURFACE RUNOFF UNLESS AN APPROVED STATE DEWATERING PERMIT IS IN PLACE.
- EROSION CONTROL BLANKETING OR OTHER PROTECTIVE COVERING SHALL BE USED ON SLOPES STEEPER THAN 3:1.
- CONTRACTOR SHALL BE RESPONSIBLE FOR THE REMOVAL OF ALL WASTES FROM THE CONSTRUCTION SITE FOR DISPOSAL IN ACCORDANCE WITH LOCAL AND STATE REGULATORY REQUIREMENTS. NO CONSTRUCTION DEBRIS, TREE SLASH, BUILDING MATERIAL WASTES OR UNUSED BUILDING MATERIALS SHALL BE BURIED, DUMPED, OR DISCHARGED AT THE SITE.
- WASTE MATERIALS SHALL NOT BE TEMPORARILY PLACED OR STORED IN THE STREET, ALLEY, OR OTHER PUBLIC WAY, UNLESS IN ACCORDANCE WITH AN APPROVED TRAFFIC CONTROL PLAN. CONTROL MEASURES MAY BE REQUIRED BY EL PASO COUNTY ENGINEERING IF DEEMED NECESSARY, BASED ON SPECIFIC CONDITIONS AND CIRCUMSTANCES.
- TRACKING OF SOILS AND CONSTRUCTION DEBRIS OFF-SITE SHALL BE MINIMIZED. MATERIALS TRACKED OFF-SITE SHALL BE CLEANED UP AND PROPERLY DISPOSED OF IMMEDIATELY.
- THE OWNER/DEVELOPER SHALL BE RESPONSIBLE FOR THE REMOVAL OF ALL CONSTRUCTION DEBRIS, DIRT, TRASH, ROCK, SEDIMENT, SOIL, AND SAND THAT MAY ACCUMULATE IN ROADS, STORM DRAINS AND OTHER DRAINAGE CONVEYANCE SYSTEMS AND STORMWATER APPURTENANCES AS A RESULT OF SITE DEVELOPMENT.
- THE QUANTITY OF MATERIALS STORED ON THE PROJECT SITE SHALL BE LIMITED, AS MUCH AS PRACTICAL, TO THAT QUANTITY REQUIRED TO PERFORM THE WORK IN AN ORDERLY SEQUENCE. ALL MATERIALS STORED ON-SITE SHALL BE STORED IN A NEAT, ORDERLY MANNER, IN THEIR ORIGINAL CONTAINERS, WITH ORIGINAL MANUFACTURER'S LABELS.
- NO CHEMICAL(S) HAVING THE POTENTIAL TO BE RELEASED IN STORMWATER ARE TO BE STORED OR USED ONSITE UNLESS PERMISSION FOR THE USE OF SUCH CHEMICAL(S) IS GRANTED IN WRITING BY THE ECM ADMINISTRATOR. IN GRANTING APPROVAL FOR THE USE OF SUCH CHEMICAL(S), SPECIAL CONDITIONS AND MONITORING MAY BE REQUIRED.
- BULK STORAGE OF ALLOWED PETROLEUM PRODUCTS OR OTHER ALLOWED LIQUID CHEMICALS IN EXCESS OF 55 GALLONS SHALL REQUIRE ADEQUATE SECONDARY CONTAINMENT PROTECTION TO CONTAIN ALL SPILLS ONSITE AND TO PREVENT ANY SPILLED MATERIALS FROM ENTERING STATE WATERS, ANY SURFACE OR SUBSURFACE STORM DRAINAGE SYSTEM OR OTHER FACILITIES.
- NO PERSON SHALL CAUSE THE IMPEDIMENT OF STORMWATER FLOW IN THE CURB AND GUTTER OR DITCH EXCEPT WITH APPROVED SEDIMENT CONTROL MEASURES.
- OWNER/DEVELOPER AND THEIR AGENTS SHALL COMPLY WITH THE "COLORADO WATER QUALITY CONTROL ACT" (TITLE 25, ARTICLE B, CRS), AND THE "CLEAN WATER ACT" (33 USC 1344), IN ADDITION TO THE REQUIREMENTS OF THE LAND DEVELOPMENT CODE, DCM VOLUME II AND THE ECM APPENDIX I. ALL APPROPRIATE PERMITS MUST BE OBTAINED BY THE CONTRACTOR PRIOR TO CONSTRUCTION (1041, NPDES, FLOODPLAIN, 404, FUGITIVE DUST, ETC.). IN THE EVENT OF CONFLICTS BETWEEN THESE REQUIREMENTS AND OTHER LAWS, RULES, OR REGULATIONS OF OTHER FEDERAL, STATE, LOCAL, OR COUNTY AGENCIES, THE MOST RESTRICTIVE LAWS, RULES, OR REGULATIONS SHALL APPLY.
- ALL CONSTRUCTION TRAFFIC MUST ENTER/EXIT THE SITE ONLY AT APPROVED CONSTRUCTION ACCESS POINTS.
- PRIOR TO CONSTRUCTION THE PERMITTEE SHALL VERIFY THE LOCATION OF EXISTING UTILITIES.
- A WATER SOURCE SHALL BE AVAILABLE ON SITE DURING EARTHWORK OPERATIONS AND SHALL BE UTILIZED AS REQUIRED TO MINIMIZE DUST FROM EARTHWORK EQUIPMENT AND MWD.
- THE SOILS REPORT FOR THIS SITE HAS BEEN PREPARED BY NRCS SOIL SURVEY AND SHALL BE CONSIDERED A PART OF THESE PLANS.
- AT LEAST TEN (10) DAYS PRIOR TO THE ANTICIPATED START OF CONSTRUCTION, FOR PROJECTS THAT WILL DISTURB ONE (1) ACRE OR MORE, THE OWNER OR OPERATOR OF CONSTRUCTION ACTIVITY SHALL SUBMIT A PERMIT APPLICATION FOR STORMWATER DISCHARGE TO THE COLORADO DEPARTMENT OF PUBLIC HEALTH AND ENVIRONMENT, WATER QUALITY DIVISION. THE APPLICATION CONTAINS CERTIFICATION OF COMPLETION OF A STORMWATER MANAGEMENT PLAN (SMWP), OF WHICH THIS GRADING AND EROSION CONTROL PLAN MAY BE A PART. FOR INFORMATION OR APPLICATION MATERIALS CONTACT:
 COLORADO DEPARTMENT OF PUBLIC HEALTH AND ENVIRONMENT
 WATER QUALITY CONTROL DIVISION
 WQCD - PERMITS
 4300 CHERRY CREEK DRIVE SOUTH
 DENVER, CO 80246-1530
 ATTN: PERMITS UNIT

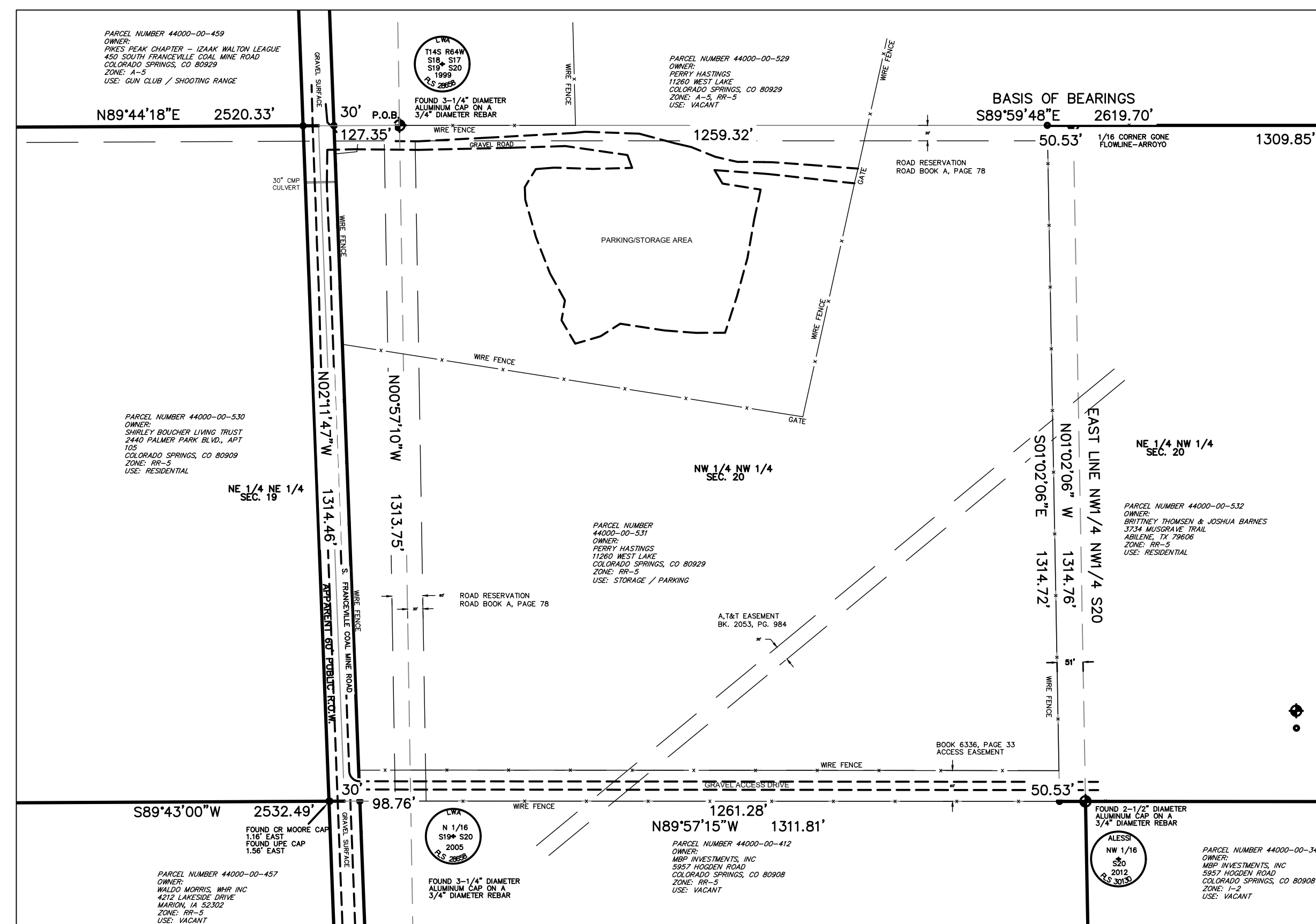
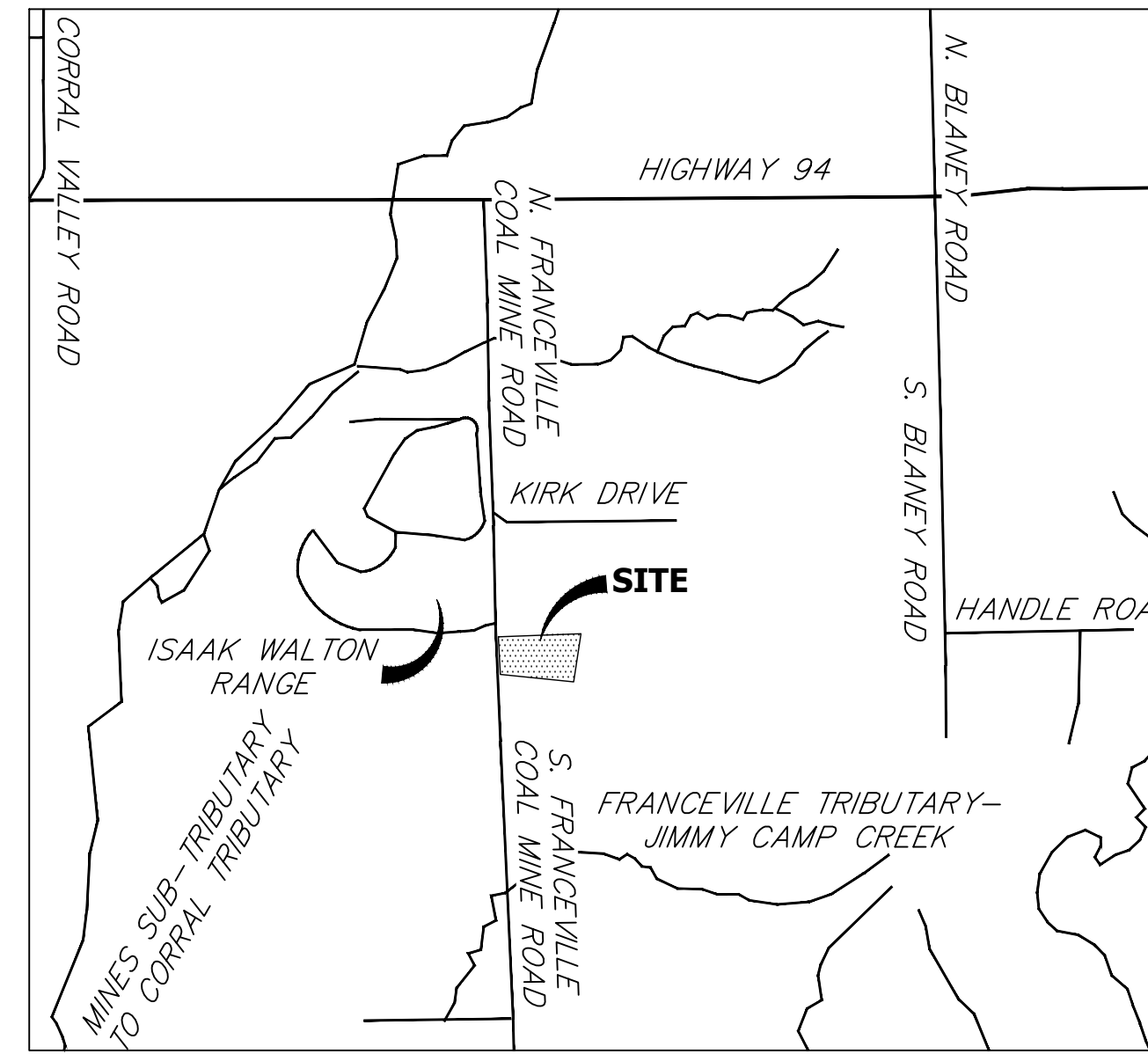

CONTACTS:

OWNER/DEVELOPER: GATEWAY TRUCKING, LLC
 ATTN: PERRY HASTINGS
 235 S. FRANCEVILLE COAL MINE ROAD
 COLORADO SPRINGS, CO 80929

ENGINEER/SURVEYOR: JR ENGINEERING LLC
 ATTN: MIKE A. BRAMLETT
 5475 TECH CENTER DRIVE, SUITE 235
 COLORADO SPRINGS, CO 80919
 P~(303) 267-6204

SHEET INDEX

1	- COVER SHEET
2	- LEGEND
3	- GRADING AND EROSION CONTROL PLAN
4-5	- POND DETAILS
6-9	- GEC DETAILS

EL PASO COUNTY STATEMENT

COUNTY PLAN REVIEW IS PROVIDED ONLY FOR GENERAL CONFORMANCE WITH COUNTY DESIGN CRITERIA. THE COUNTY IS NOT RESPONSIBLE FOR THE ACCURACY AND ADEQUACY OF THE DESIGN, DIMENSIONS, AND/OR ELEVATIONS WHICH SHALL BE CONFIRMED AT THE JOB SITE. THE COUNTY THROUGH THE APPROVAL OF THIS DOCUMENT ASSUMES NO RESPONSIBILITY FOR COMPLETENESS AND/OR ACCURACY OF THIS DOCUMENT.

FILED IN ACCORDANCE WITH THE REQUIREMENTS OF THE EL PASO COUNTY LAND DEVELOPMENT CODE, DRAINAGE CRITERIA MANUAL, VOLUMES 1 AND 2, AND ENGINEERING CRITERIA MANUAL AS AMENDED.

IN ACCORDANCE WITH ECM SECTION 1.12, THESE CONSTRUCTION DOCUMENTS WILL BE VALID FOR CONSTRUCTION FOR A PERIOD OF 2 YEARS FROM THE DATE SIGNED BY THE EL PASO COUNTY ENGINEER. IF CONSTRUCTION HAS NOT STARTED WITHIN THOSE 2 YEARS, THE PLANS WILL NEED TO BE RESUBMITTED FOR APPROVAL, INCLUDING PAYMENT OF REVIEW FEES AT THE PLANNING AND COMMUNITY DEVELOPMENT DIRECTORS DISCRETION.

JENNIFER IRVINE, P.E. DATE _____
 COUNTY ENGINEER/ECM ADMINISTRATOR

ENGINEER'S STATEMENT

THIS GRADING AND EROSION CONTROL PLAN WAS PREPARED UNDER MY DIRECTION AND SUPERVISION AND IS CORRECT TO THE BEST OF MY KNOWLEDGE AND BELIEF. SAID PLAN HAS BEEN PREPARED ACCORDING TO THE CRITERIA ESTABLISHED BY THE COUNTY FOR GRADING AND EROSION CONTROL PLANS. I ACCEPT RESPONSIBILITY FOR ANY LIABILITY CAUSED BY ANY NEGLIGENT ACTS, ERRORS OR OMISSIONS ON MY PART IN PREPARING THIS PLANS.

Mike Bramlett
 MIKE A. BRAMLETT, P.E.
 32314
 COLORADO P.E. 32314
 FOR AND ON BEHALF OF JR ENGINEERING, LLC
 LOCAL ENGINEER

6/14/2022

PCD FILE NO. PPR-21-033

OWNER/DEVELOPER STATEMENT

I, THE OWNER/DEVELOPER HAVE READ AND WILL COMPLY WITH THE REQUIREMENT OF THE GRADING AND EROSION CONTROL PLANS.

PERRY HASTINGS DATE _____
 GATEWAY TRUCKING, LLC
 235 S. FRANCEVILLE COAL MINE RD
 COLORADO SPRINGS, CO 80929

UNTIL SUCH TIME AS THESE DRAWINGS ARE APPROVED BY THE APPROPRIATE REVIEWING AGENCIES, OR ENGINEERING THEIR USE AND APPROVALS DESIGNATED BY WRITTEN AUTHORIZATION.

PREPARED FOR:
GATEWAY TRUCKING, LLC
 235 S. FRANCEVILLE COAL MINE RD
 COLORADO SPRINGS, CO 80929
 ATTN: PERRY HASTINGS
 602-558-0846
 HASTINGSCONTRACTINGCO@GMAIL.COM

J.R. ENGINEERING
 A Westman Company
 Central 303-740-9888 • Colorado Springs 719-583-2593
 Fort Collins 970-491-9888 • www.jrengineering.com

BY	DATE	REVISION	No.

H-SCALE	N/A	V-SCALE	N/A	DATE	05/24/22	DESIGNED BY	N/A	DRAWN BY	N/A	CHECKED BY	N/A

GATEWAY TRUCKING SITE DEVELOPMENT PLAN COVER SHEET		
SHEET 1	OF 9	JOB NO. 25215.00

LAYER LINETYPE LEGEND

Table with 3 columns: Layer Name, Existing Linetype, Proposed Linetype. Includes items like PHASE LINE, MATCH LINE, PROPERTY LINE, EASEMENT LINE, etc.

UTILITIES LEGEND

Table with 4 columns: Utility Type, Existing Symbol, Proposed Symbol. Includes STORM SEWER, SANITARY SEWER, WATER LINE, GAS LINE, and MISC. UTILITIES.

MONUMENTATION LEGEND

Table with 2 columns: Monumentation Type, Symbol. Includes ALUMINUM CAP - FOUND, BRASS CAP - FOUND, BENCHMARK - FOUND, etc.

TRAFFIC LEGEND

Table with 3 columns: Traffic Item, Existing Symbol, Proposed Symbol. Includes PARKING METER, TRAFFIC SIGNAL BOX, TRAFFIC SIGNAL POLE, etc.

STORM WATER MANAGEMENT

Table with 3 columns: Storm Water Item, Key, Symbol. Includes CHECK DAM, CONSTRUCTION ROAD STABILIZATION, CURB SOCK INLET PROTECTION, etc.

DRAINAGE REPORT PLANS

Table with 3 columns: Drainage Report Plan Item, Key, Symbol. Includes BASIN DESIGNATION (NO COEFFICIENT), BASIN DESIGNATION (1 COEFFICIENT), etc.

LANDSCAPE LEGEND

Table with 3 columns: Landscape Item, Existing Symbol, Proposed Symbol. Includes TREE - CONIFEROUS, TREE - DECIDUOUS, SHRUB/BUSH, etc.

UNTIL SUCH TIME AS THESE DRAWINGS ARE APPROVED BY THE APPROPRIATE REVIEWING AGENCIES, OR ENGINEERING APPROVES THEIR USE. THESE DRAWINGS ARE DESIGNATED BY WRITTEN AUTHORIZATION.

PREPARED FOR: GATEWAY TRUCKING, LLC. 235 S. FRANCISVILLE COAL MINE RD. COLORADO SPRINGS, CO 80929. ATTN: PERRY HASTINGS. 602-558-0846. HASTINGSCONTRACTING@GMAIL.COM

J.R. ENGINEERING. A Westman Company. Centennial 300-740-9383. Colorado Springs 719-583-2593. Fort Collins 970-491-9888. www.jrengineering.com

Table with columns: No., REVISION, DATE. Includes rows for revisions and dates.

Table with columns: H-SCALE, V-SCALE, DATE, DESIGNED BY, DRAWN BY, CHECKED BY. Includes values like N/A, 05/24/22, N/A, N/A, N/A.

GATEWAY TRUCKING SITE DEVELOPMENT PLAN LEGEND



Know what's below. Call before you dig.

X:\25215000\25215000\Drawings\Sheet\Drawings\25215000\01.dwg, Legend, 5/24/2022, 10:32:22 AM, CS

PARCEL NUMBER 44000-00-459
 OWNER:
 PIKES PEAK CHAPTER -
 IZAAK WALTON LEAGUE
 450 SOUTH FRANCEVILLE
 COAL MINE ROAD
 COLORADO SPRINGS, CO 80929
 ZONE: A-5
 USE: GUN CLUB/
 SHOOTING RANGE

PARCEL NUMBER 44000-00-529
 OWNER:
 PERRY HASTINGS
 11260 WEST LAKE
 COLORADO SPRINGS, CO 80929
 ZONE: A-5, RR-5
 USE: VACANT

EXISTING PROPERTY LINE (TYP.)
 PROPOSED OUTLET STRUCTURE
 SEE DETAIL ON SHEET 5
 PROPOSED 24" OUTLET PIPE W/24" FES
 SEE PROFILE ON SHEET 4
 PROPOSED EMERGENCY SPILLWAY
 SPILLWAY CREST: 6237.50'
 TOP OF POND: 6239.00'
 SEE DETAIL ON SHEET 4
 EXISTING 30" CMP ENDS
 ASSUMED INVERTS:
 6229.75' (E)
 6228.08' (W)

PROPOSED TYPE L SOIL RIPRAP
 W1=6.0', W2=3.5', L=±12.5', MIN. DEPTH=18"
 APPARENT
 60.00'
 PUBLIC R.O.W.

PROPOSED TRICKLE CHANNEL
 6" CONCRETE W/ 0.5' DEPTH
 TYP. SECTION ON SHEET 4
 RIPRAP RUNDOWN INTO FOREBAY
 TYPE L SOIL RIPRAP (MIN. 18" DEPTH)
 SEE TYP. SECTION ON SHEET 4
 AND DETAIL ON SHEET 5

PARCEL NUMBER 44000-00-530
 OWNER:
 SHIRLEY BOUCHER LIVING TRUST
 2440 PALMER PARK BLVD., APT 105
 COLORADO SPRINGS, CO 80909
 ZONE: RR-5
 USE: RESIDENTIAL

PARCEL NUMBER 44000-00-531
 OWNER:
 PERRY HASTINGS
 11260 WEST LAKE
 COLORADO SPRINGS, CO 80929
 ZONE: RR-5
 USE: STORAGE / PARKING

LEGEND

SILT FENCE	(SF) — SF	PROPOSED FLOW PATH	→
STABILIZED STAGING AREA	(SSA) [Pattern]	EXISTING FLOW PATH	⇨
VEHICLE TRACKING CONTROL	(VTC) [Pattern]	LIMITS OF CONSTRUCTION/ DISTURBANCE	(LOD) - - - - -
CONCRETE WASHOUT AREA	(CWA) [Pattern]	PERMANENT SEEDING AND MULCHING	(SM) [Pattern]
OUTLET PROTECTION	(OP) [Symbol]	TEMPORARY SEDIMENT BASIN	(TSB) [Symbol]
CHECK DAM	(CD) [Symbol]	TEMPORARY SLOPE DRAIN	(TSD) [Symbol]

GEC NOTES:

1. THE EXISTING VEGETATION ON THE SITE IS LIMITED DUE TO THE LOCATION'S ARID CLIMATE. ADDITIONALLY, THE SITE AND DRIVE HAVE BEEN STABILIZED W/ ASPHALT AND GRAVEL FOR USE.
2. THE INITIAL BMPs INCLUDE: SF, VTC, SSA, CWA, CD, TSD, AND TSB. THE INTERIM BMPs INCLUDE: OP. THE FINAL PHASE BMPs INCLUDE: SM AND REMOVAL OF TEMPORARY BMPs ONCE FINAL STABILIZATION IS COMPLETED.

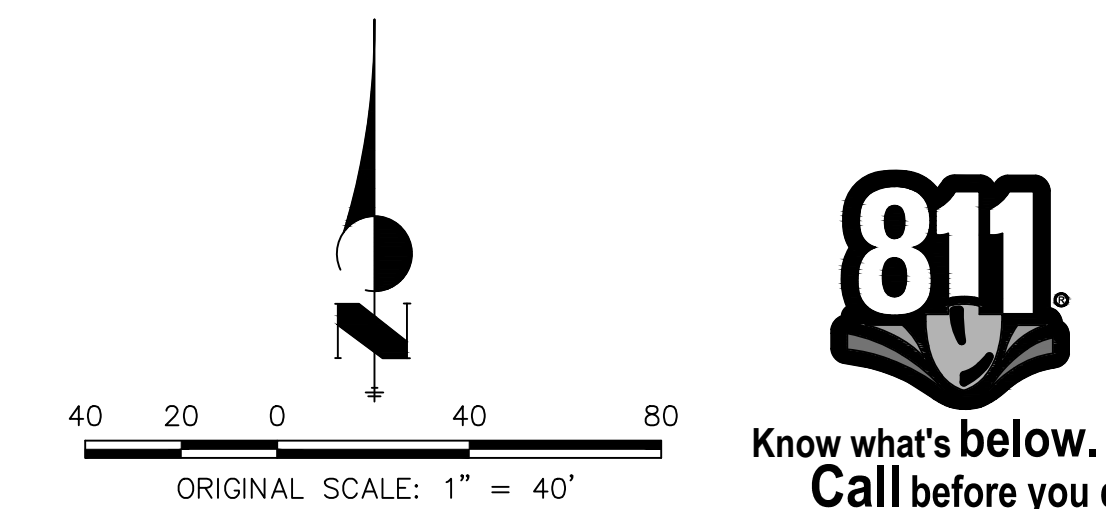

811
 Know what's below.
 Call before you dig.

UNTIL SUCH TIME AS THESE DRAWINGS ARE APPROVED BY THE APPROPRIATE REVIEWING AGENCIES, OR ENGINEERING APPROVES THEIR USE, THESE DRAWINGS ARE DESIGNATED BY WRITTEN AUTHORIZATION.

PREPARED FOR
GATEWAY TRUCKING, LLC
 235 S. FRANCEVILLE COAL MINE RD
 COLORADO SPRINGS, CO 80929
 ATTN: PERRY HASTINGS
 602-558-0846
 HASTINGS@GATEWAYTRUCKING.COM

J.R. ENGINEERING
 A Westman Company
 Central 303-740-9383 • Colorado Springs 719-583-2593
 Fort Collins 970-491-9888 • www.jrengineering.com

No.	REVISION	BY	DATE

H-SCALE	V-SCALE	DATE	DESIGNED BY	DRAWN BY	CHECKED BY
1"=40'	N/A	05/24/22	GAG	GAG	

**GATEWAY TRUCKING SITE
 DEVELOPMENT PLAN
 GRADING AND EROSION
 CONTROL PLAN**

SHEET 3 OF 9
 JOB NO. 25215.00

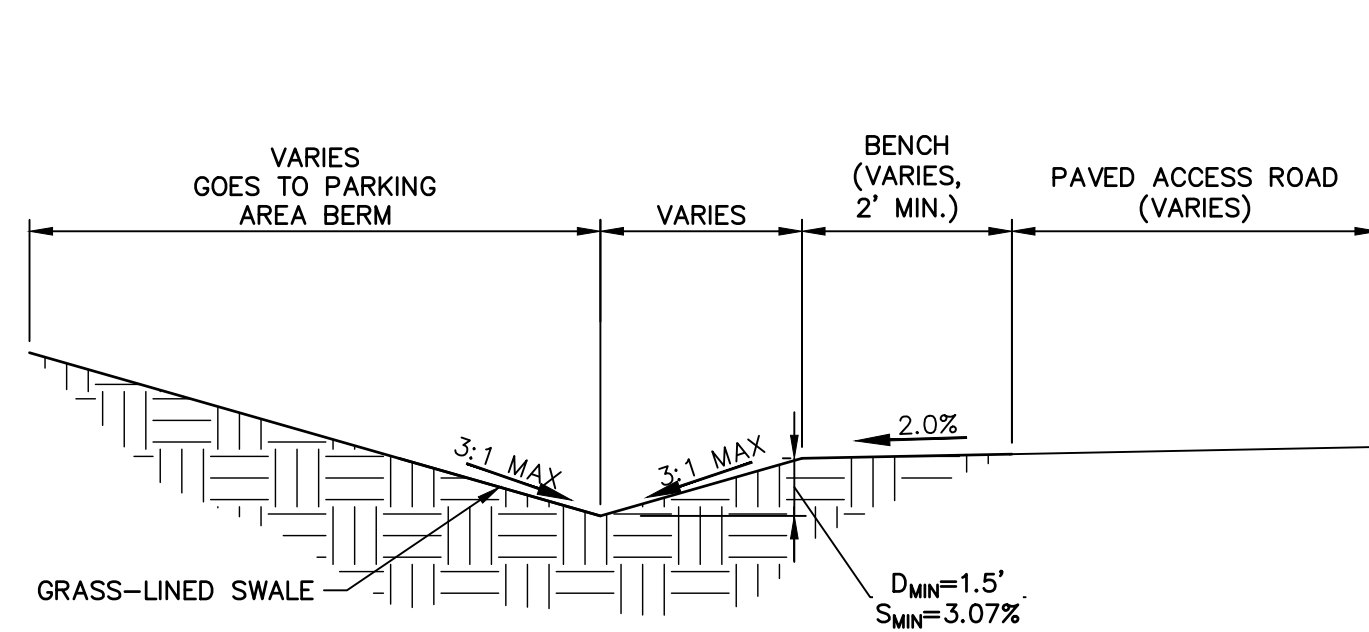

N. DRIVEWAY SWALE
TYP. SECTION

SCALE: N.T.S.

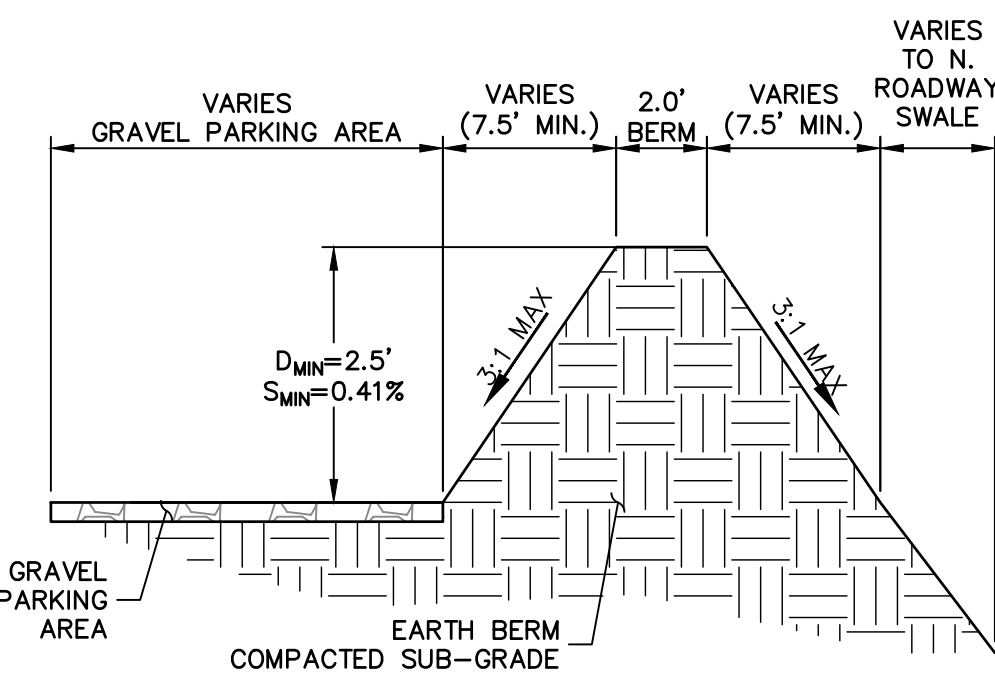

N. PARKING AREA BERM
TYP. SECTION

SCALE: N.T.S.

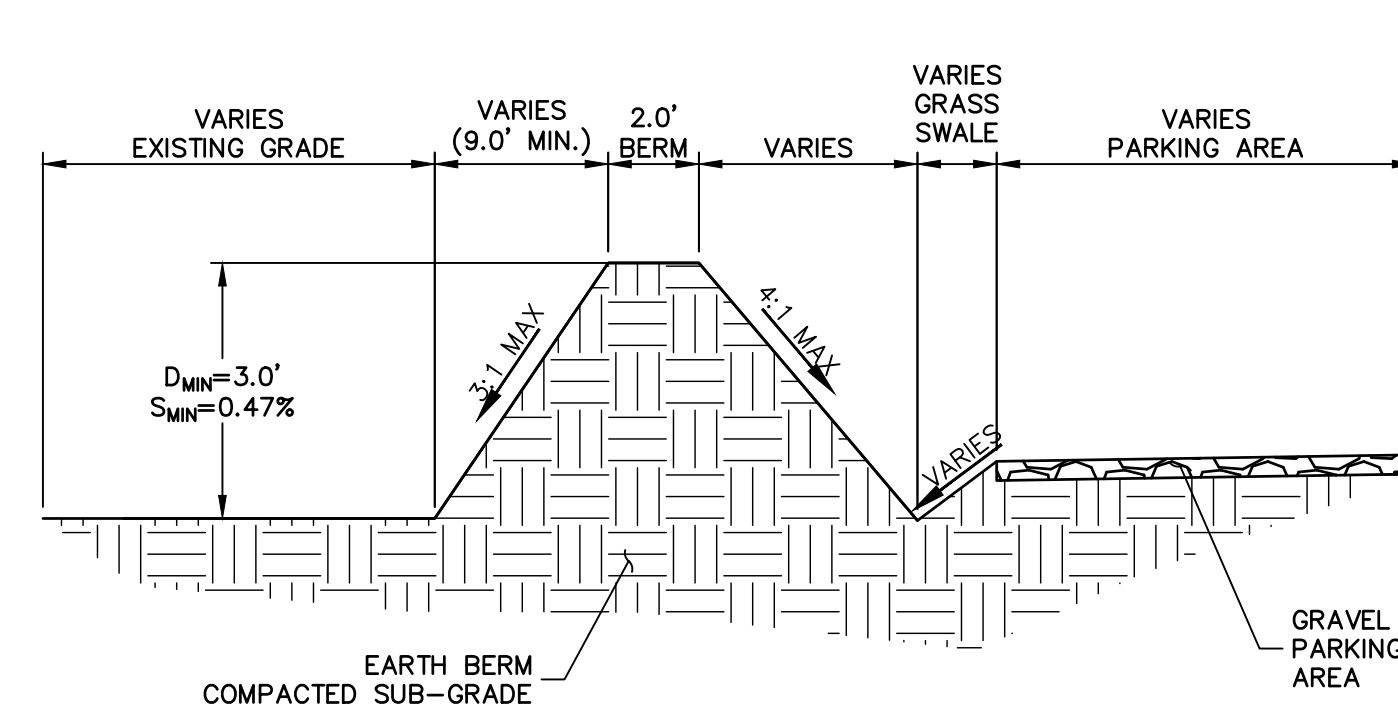

S. PARKING AREA BERM
TYP. SECTION

SCALE: N.T.S.

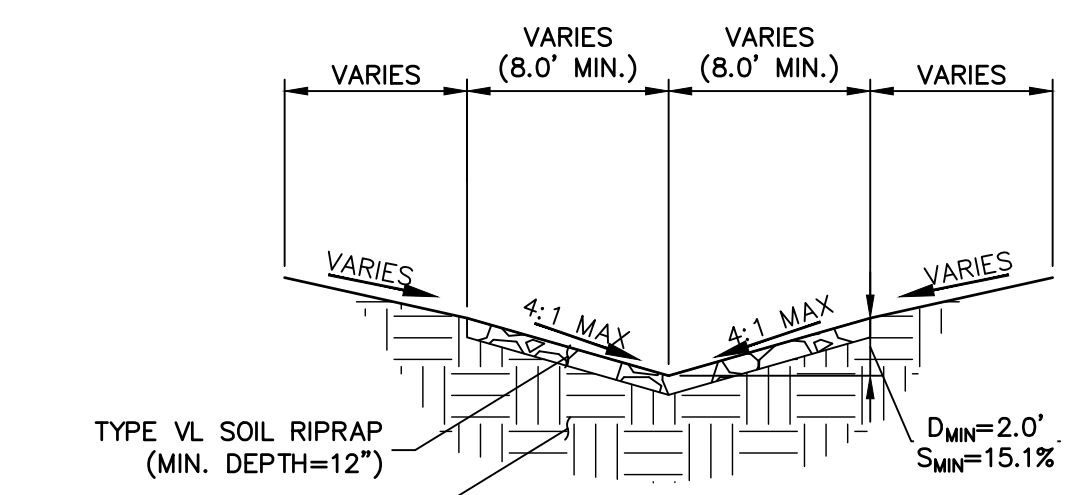

N. PARKING AREA SWALE (TO RUNDOWN)
TYP. SECTION

SCALE: N.T.S.

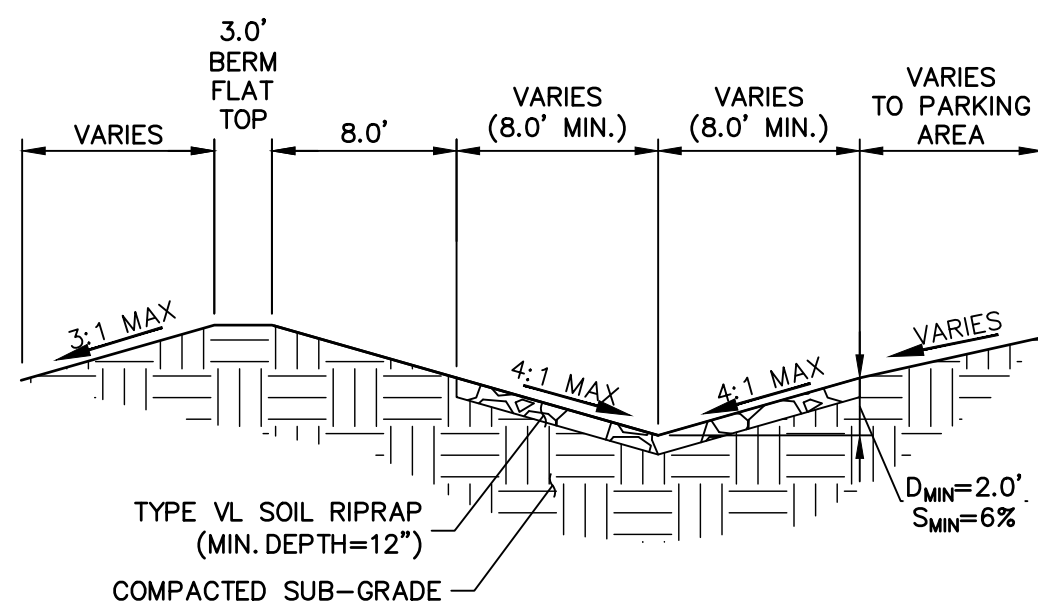

S. SWALE (TO RUNDOWN)
TYP. SECTION

SCALE: N.T.S.

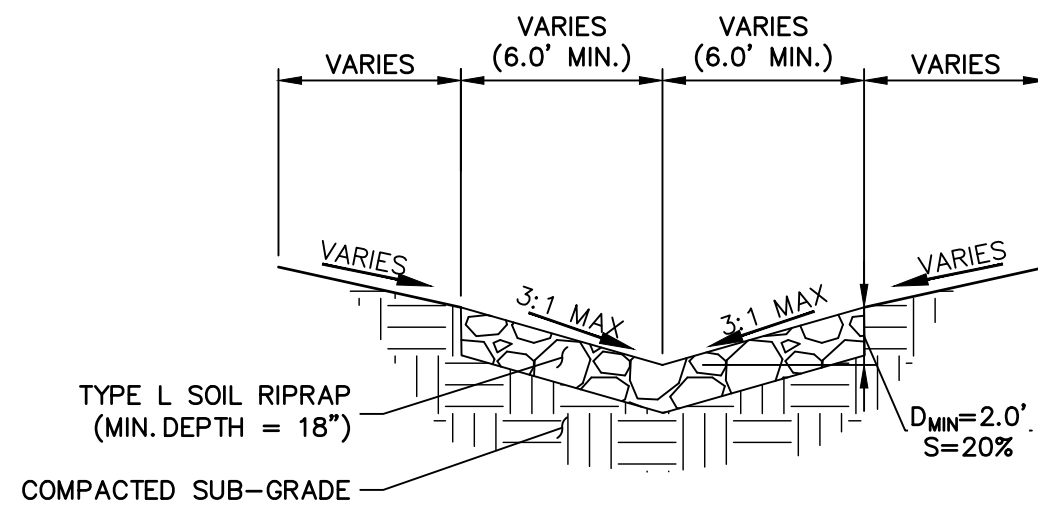

RIPRAP RUNDOWN
INTO FOREBAY

SCALE: 1"=10'

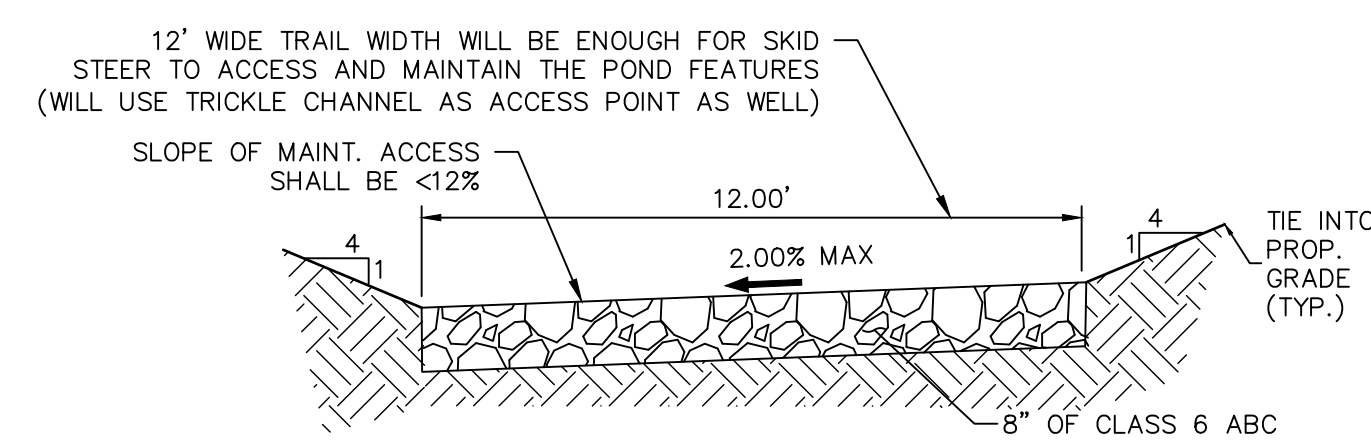

12' GRAVEL MAINTENANCE
ACCESS ROAD TYPICAL SECTION

N.T.S.

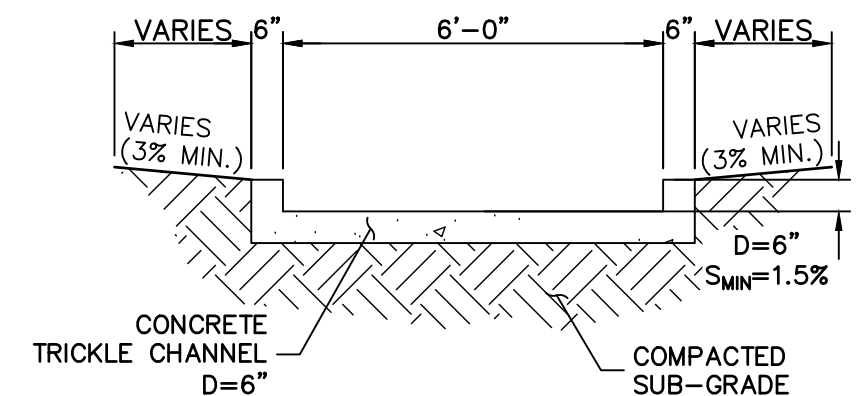

POND TRICKLE CHANNEL

SCALE: 1"=3'

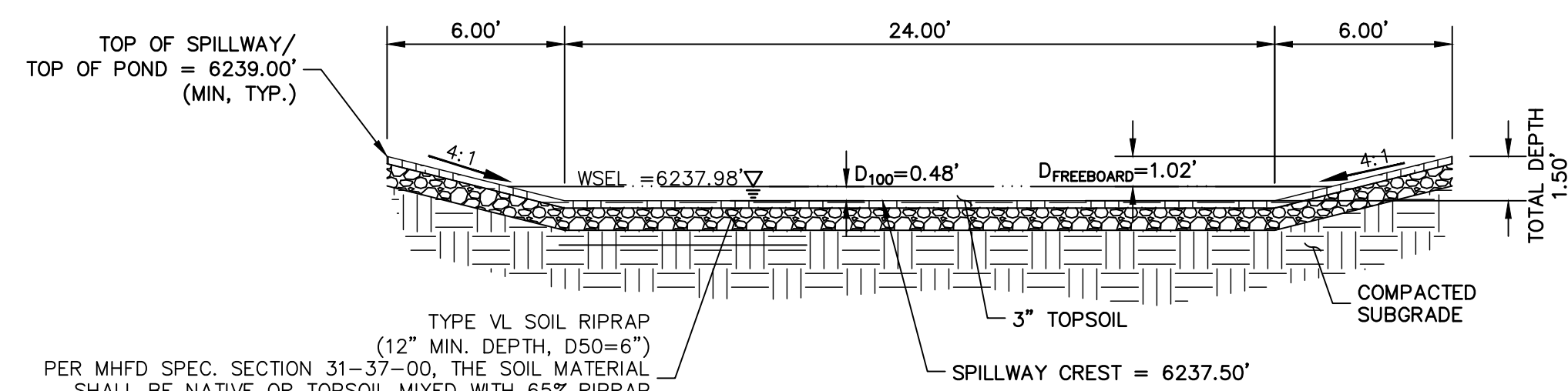

POND EMERGENCY SPILLWAY
TYP. SECTION

SCALE: 1"=5'

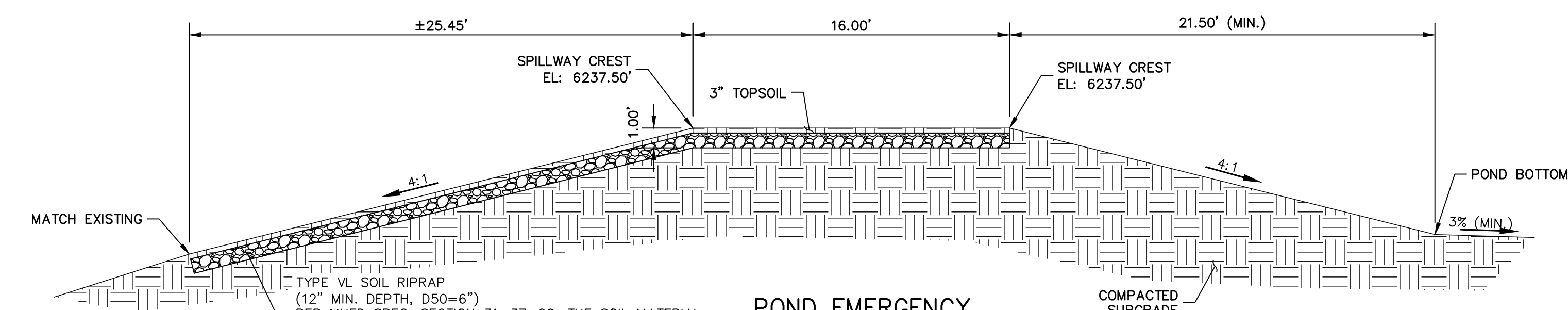

POND EMERGENCY
SPILLWAY SECTION

SCALE: 1"=5'

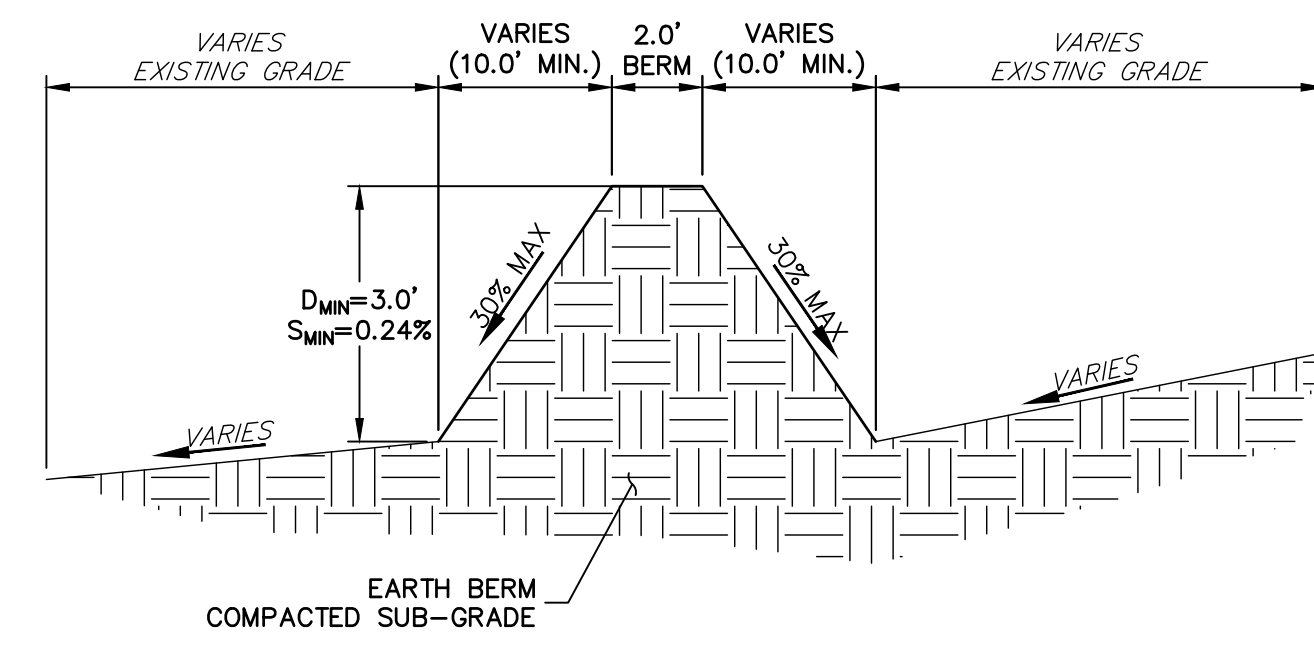

NE BERM
TYP. SECTION

SCALE: N.T.S.

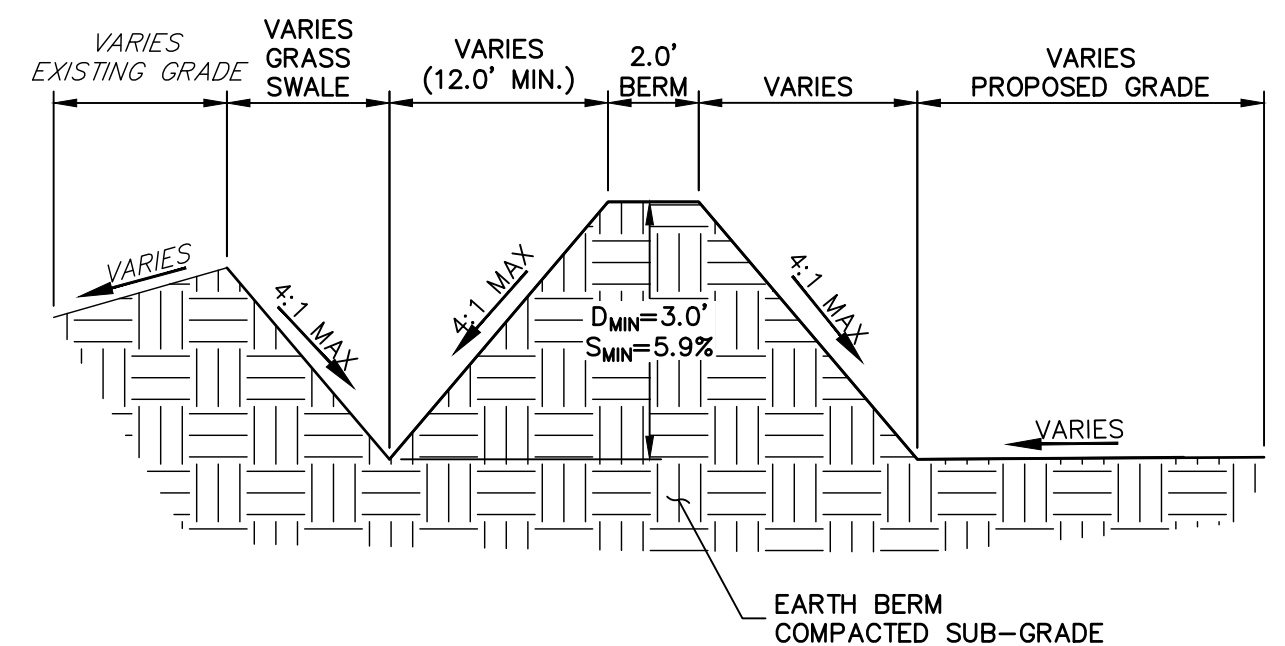

SW BERM
TYP. SECTION

SCALE: N.T.S.

POND PROFILE
STA 1+00.00 TO 1+88.51

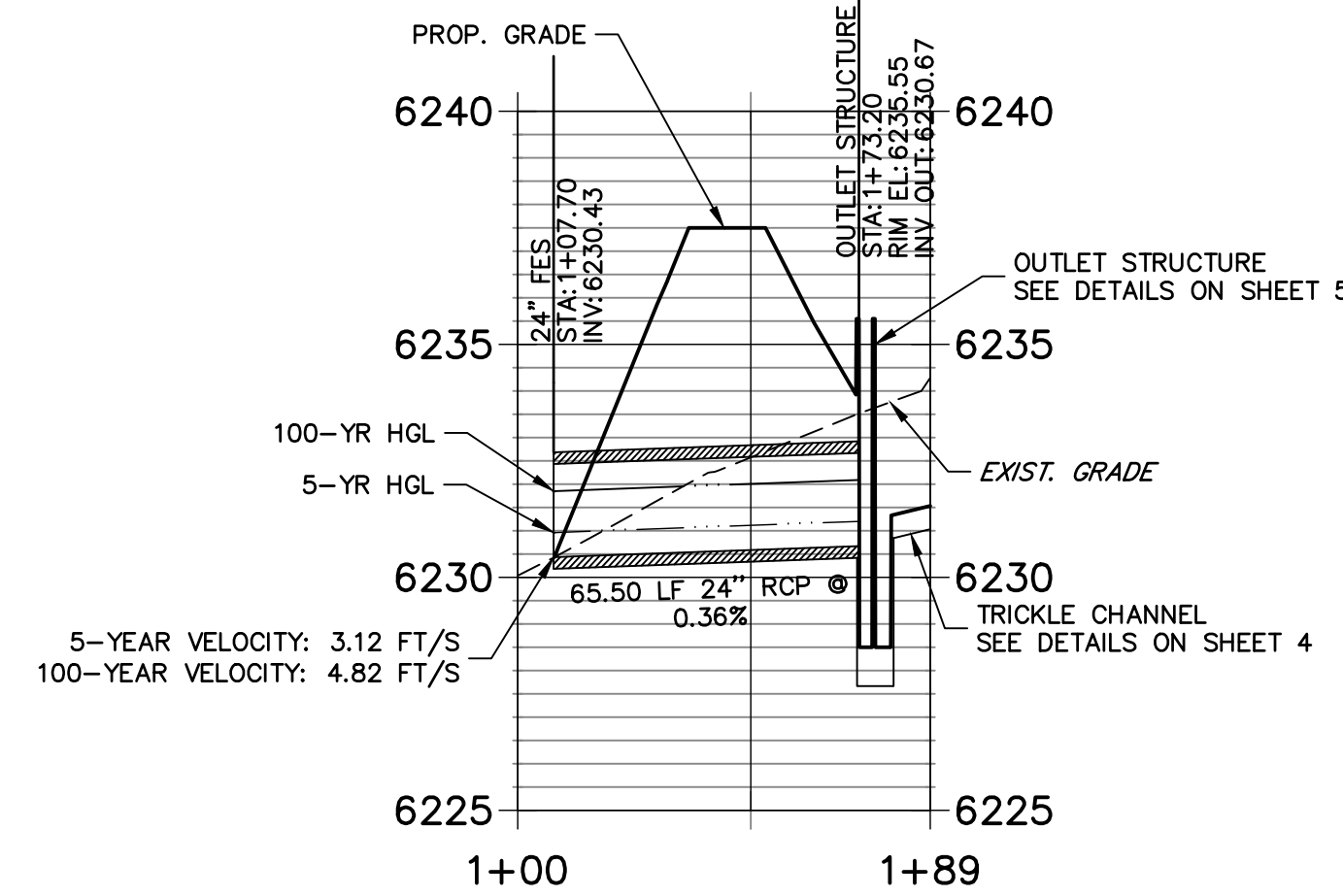

Know what's below.
Call before you dig.

UNTIL SUCH TIME AS THESE DRAWINGS ARE APPROVED BY THE APPROPRIATE REVIEWING AGENCIES, OR ENGINEERING APPROVES THEIR USE, THESE DRAWINGS ARE DESIGNATED BY WRITTEN AUTHORIZATION.

PREPARED FOR
GATEWAY TRUCKING, LLC
235 S. FRANCEVILLE COAL MINE RD
COLORADO SPRINGS, CO 80929
ATTN: PERRY HASTINGS
602-558-0846
HASTINGSCONTRACTING@GMAIL.COM

J.R. ENGINEERING
A Westman Company
Central 303-740-9888 • Colorado Springs 719-583-2583
Fort Collins 970-491-9888 • www.jrengineering.com

NO.	REVISION	BY	DATE

H-SCALE	V-SCALE	DATE	DESIGNED BY	DRAWN BY	CHECKED BY
		05/24/22	GAG	GAG	

GATEWAY TRUCKING SITE
DEVELOPMENT PLAN
POND DETAILS

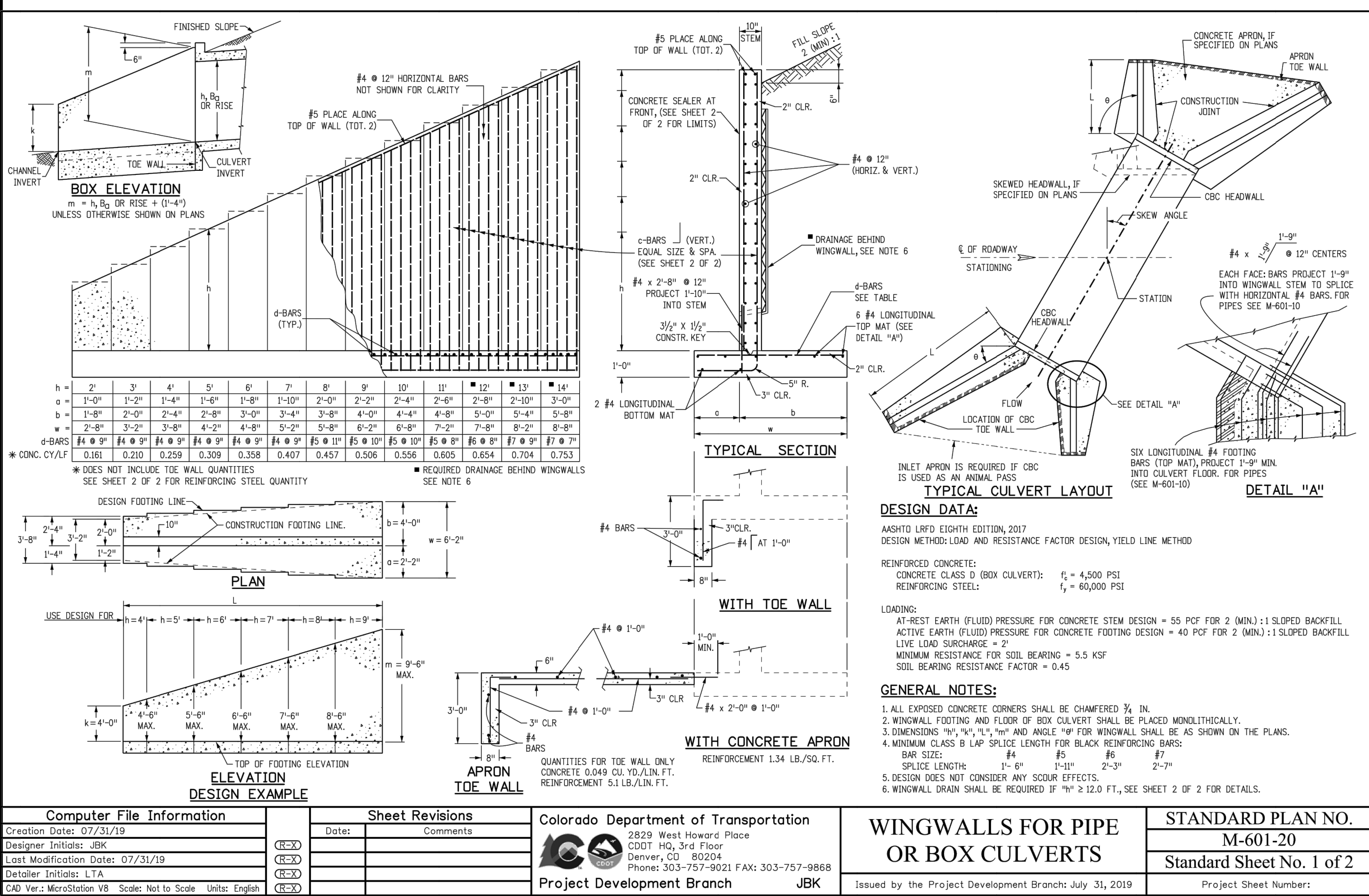

c-BARS AND REINFORCING STEEL QUANTITY (EXCLUDE TOE WALL) * REINFORCING STEEL QUANTITY INCLUDES STEM AND FITTING QUANTITIES, BUT DOES NOT INCLUDE TOE WALL QUANTITIES. Table with columns for L (MULTIPLE OF m) and k (FT) and rows for various L and k values. Includes a table for REINFORCING STEEL QUANTITY BY USING THE TABLE.

EXAMPLE: SELECT THE c-BARS SIZE, SPACING AND STEEL QUANTITY FOR A 25.0 FEET LONG WINGWALL WITH m = 11.8 FT AND k = 6.3 FT. SOLUTION: 1. DETERMINE WINGWALL LENGTH IN MULTIPLE OF m: L/m = 25.0 / 11.8 = 2.12 L = (2.12 x m), USE L ≤ (2.25 x m) L = 11.8 FT, USE m = 12.0 FT. k = 6.3 FT, USE k = 6.0 FT. 2. DETERMINE REINFORCING STEEL QUANTITY OF WHOLE WINGWALL: REINFORCING STEEL QUANTITY = 25.0 x 60.60 = 1,515 LB.

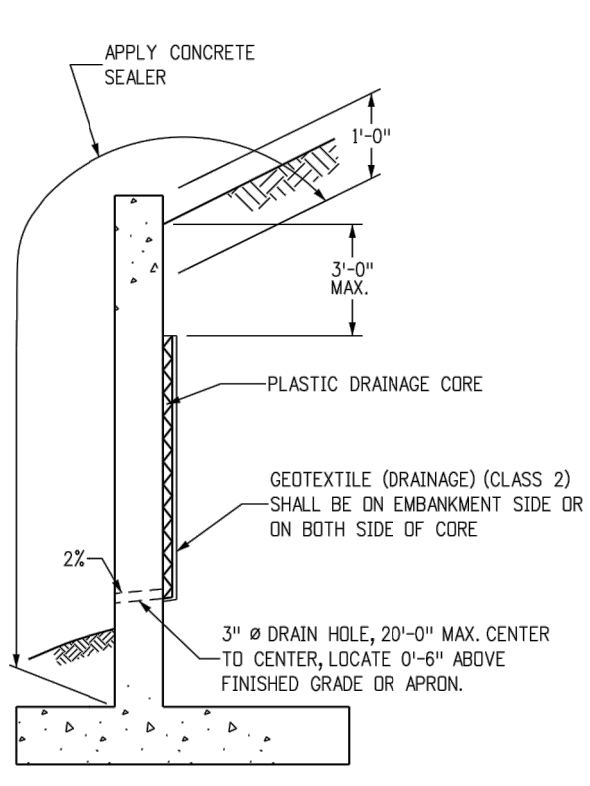

Computer File Information table: Creation Date: 07/31/19, Designer: JJB, Last Modification: 07/31/19, Dattler: LTA, CAD Ver: MicroStation V8 Scale: Not to Scale Units: English

Sheet Revisions table: Date, Comments

Colorado Department of Transportation 2829 West Howard Place COOT HQ, 3rd Floor Denver, CO 80204 Phone: 303-757-8021 FAX: 303-757-8868 Project Development Branch JBK

WINGWALLS FOR PIPE OR BOX CULVERTS STANDARD PLAN NO. M-601-20 Standard Sheet No. 1 of 2 Issued by the Project Development Branch July 31, 2019 Project Sheet Number:

Computer File Information table: Creation Date: 07/31/19, Designer: JJB, Last Modification: 07/31/19, Dattler: LTA, CAD Ver: MicroStation V8 Scale: Not to Scale Units: English

Sheet Revisions table: Date, Comments

Colorado Department of Transportation 2829 West Howard Place COOT HQ, 3rd Floor Denver, CO 80204 Phone: 303-757-8021 FAX: 303-757-8868 Project Development Branch JBK

WINGWALLS FOR PIPE OR BOX CULVERTS STANDARD PLAN NO. M-601-20 Standard Sheet No. 2 of 2 Issued by the Project Development Branch July 31, 2019 Project Sheet Number:

Vertical sidebar containing project information: GATEWAY TRUCKING SITE DEVELOPMENT PLAN POND DETAILS, SHEET 7 OF 9, JOB NO. 25215.00, and logos for GATEWAY TRUCKING, LLC and J.R. ENGINEERING.



CONCRETE WASHOUT AREA PLAN

CONCRETE WASHOUT SIGN
8'x8' MIN
10' MIN
COMPACTED BERM (SEE TEMPORARY COMPACTED BERM DETAIL)

SECTION A-A'

2% SLOPE
6" MINUS ROCK
3' MIN
8'x8' MIN
COMPACTED BERM AROUND THE PERIMETER

*ROCK REQUIRED BASED ON SITE CONDITIONS AT THE DISCRETION OF THE GEC INSPECTOR

CWA		CONCRETE WASHOUT AREA	
ISSUED:	REVISION:	DESIGN MANAGER:	DRAWING NO:
10/7/19	8/18/2020	[Signature]	900-CWA-1

INSTALLATION NOTES

- SEE PLAN VIEW FOR:
 - LOCATION OF CONCRETE WASHOUT AREA
 - LOCATE AT LEAST 50' AWAY FROM STATE WATERS MEASURED HORIZONTALLY.
 - AN IMPERMEABLE LINER (16 MIL. MINIMUM THICKNESS) IS REQUIRED IF CONCRETE WASH AREA IS LOCATED WITHIN 400' OF STATE WATERS OR 1000' OF WELLS OR DRINKING WATER SOURCES.
 - DO NOT LOCATE IN AREAS WHERE SHALLOW GROUNDWATER MAY BE PRESENT.
 - THE CONCRETE WASH AREA SHALL BE INSTALLED PRIOR TO CONCRETE PLACEMENT ON SITE.
 - CONCRETE WASH AREA SHALL INCLUDE A FLAT SUBSURFACE PIT THAT IS AT LEAST 8' BY 8'.
 - BERM SURROUNDING SIDES AND BACK OF CONCRETE WASH AREA SHALL HAVE A MINIMUM HEIGHT OF 2 FEET.
 - CONCRETE WASH AREA ENTRANCE SHALL BE SLOPED 2% TOWARDS THE CONCRETE WASH AREA.
 - SIGNS SHALL BE PLACED AT THE CONCRETE WASH AREA.
 - USE EXCAVATED MATERIAL FOR PERIMETER BERM CONSTRUCTION.

MAINTENANCE NOTES

- FREQUENT OBSERVATIONS AND MAINTENANCE ARE NECESSARY TO MAINTAIN CONTROL MEASURES IN EFFECTIVE OPERATING CONDITION. INSPECTIONS AND CORRECTIVE MEASURES SHOULD BE DOCUMENTED THOROUGHLY.
- THE CONCRETE WASH AREA SHALL BE REPAIRED, CLEANED, OR ENLARGED AS NECESSARY TO MAINTAIN CAPACITY FOR CONCRETE WASTE. CONCRETE MATERIALS ACCUMULATED IN THE PIT SHALL BE REMOVED ONCE THE MATERIALS HAVE REACHED A DEPTH OF 3/4 THE HEIGHT OF THE CONCRETE WASH AREA.
- CONCRETE WASHOUT WATER, WASTED PIECES OF CONCRETE, AND ALL OTHER DEBRIS IN THE SUBSURFACE PIT SHALL BE TRANSPORTED FROM THE JOB SITE IN A WATER-TIGHT CONTAINER AND DISPOSED OF PROPERLY.
- THE CONCRETE WASH AREA SHALL REMAIN IN PLACE UNTIL ALL CONCRETE FOR THE PROJECT IS PLACED.
- PERMANENTLY STABILIZE AREA AFTER CONCRETE WASH AREA IS REMOVED.

CWA		CONCRETE WASHOUT AREA	
ISSUED:	REVISION:	DESIGN MANAGER:	DRAWING NO:
10/7/19	8/18/2020	[Signature]	900-CWA-2

SEEDING & MULCHING

ALL SOIL TESTING, SOILS AMENDMENT AND FERTILIZER DOCUMENTATION, AND SEED LOAD AND BAG TICKETS MUST BE ADDED TO THE CSMP.

SOIL PREPARATION

- IN AREAS TO BE SEEDED, THE UPPER 6 INCHES OF THE SOIL MUST NOT BE HEAVILY COMPACTED, AND SHOULD BE IN FRABLE CONDITION. LESS THAN 85% STANDARD PROCTOR DENSITY IS ACCEPTABLE. AREAS OF COMPACTION OR GENERAL CONSTRUCTION ACTIVITY MUST BE SCARIFIED TO A DEPTH OF 6 TO 12 INCHES PRIOR TO SPREADING TOPSOIL TO BREAK UP COMPACTED LAYERS AND PROVIDE A BLENDING ZONE BETWEEN DIFFERENT SOIL LAYERS.
- AREAS TO BE PLANTED SHALL HAVE AT LEAST 4 INCHES OF TOPSOIL SUITABLE TO SUPPORT PLANT GROWTH.
- THE CITY RECOMMENDS THAT EXISTING AND/OR IMPORTED TOPSOIL BE TESTED TO IDENTIFY SOIL DEFICIENCIES AND ANY SOIL AMENDMENTS NECESSARY TO ADDRESS THESE DEFICIENCIES. SOIL AMENDMENTS AND/OR FERTILIZERS SHOULD BE ADDED TO CORRECT TOPSOIL DEFICIENCIES BASED ON SOIL TESTING RESULTS.
- TOPSOIL SHALL BE PROTECTED DURING THE CONSTRUCTION PERIOD TO RETAIN ITS STRUCTURE. AVOID COMPACTION, AND TO PREVENT EROSION AND CONTAMINATION. STRIPPED TOPSOIL MUST BE STORED IN AN AREA AWAY FROM MACHINERY AND CONSTRUCTION OPERATIONS, AND CARE MUST BE TAKEN TO PROTECT THE TOPSOIL AS A VALUABLE COMMODITY. TOPSOIL MUST NOT BE STRIPPED DURING UNDESIRABLE WORKING CONDITIONS (E.G. DURING WET WEATHER OR WHEN SOILS ARE SATURATED). TOPSOIL SHALL NOT BE STORED IN SWALES OR IN AREAS WITH POOR DRAINAGE.

SEEDING

- ALLOWABLE SEED MIXES ARE INCLUDED IN THE CITY OF COLORADO SPRINGS STORMWATER CONSTRUCTION MANUAL. ALTERNATIVE SEED MIXES ARE ACCEPTABLE IF INCLUDED IN AN APPROVED LANDSCAPING PLAN.
- SEED SHOULD BE DRILL-SEEDED WHENEVER POSSIBLE.
- SEED DEPTH MUST BE 1/2 TO 3/4 INCHES WHEN DRILL-SEEDED IS USED.
- BROADCAST SEEDING OR HYDRO-SEEDED WITH TACKIFIER MAY BE SUBSTITUTED ON SLOPES STEEPER THAN 3:1 OR ON OTHER AREAS NOT PRACTICAL TO DRILL SEED.
- SEEDING RATES MUST BE DOUBLED FOR BROADCAST SEEDING OR INCREASED BY 50% IF USING A BRILLION DRILL OR HYDRO-SEEDED.
 - BROADCAST SEEDING MUST BE LIGHTLY HAND-RAKED INTO THE SOIL.

MULCHING

- MULCHING SHOULD BE COMPLETED AS SOON AS PRACTICABLE AFTER SEEDING, HOWEVER PLANTED AREAS MUST BE MULCHED NO LATER THAN 14 DAYS AFTER PLANTING.
- MULCHING REQUIREMENTS INCLUDE:
 - HAY OR STRAW MULCH:
 - ONLY CERTIFIED WEED-FREE AND CERTIFIED SEED-FREE MULCH MAY BE USED. MULCH MUST BE APPLIED AT 2 TONS/ACRE AND ADEQUATELY SECURED BY CRIMPING AND/OR TACKIFIER.
 - CRIMPING MUST NOT BE USED ON SLOPES GREATER THAN 3:1 AND MULCH FIBERS MUST BE TUCKED INTO THE SOIL TO A DEPTH OF 3 TO 4 INCHES.
 - TACKIFIER MUST BE USED IN PLACE OF CRIMPING ON SLOPES STEEPER THAN 3:1.
 - HYDRAULIC MULCHING IS AN OPTION ON STEEP SLOPES OR WHERE ACCESS IS LIMITED.
 - IF HYDRO-SEEDED IS USED, MULCHING MUST BE APPLIED AS A SEPARATE, SECOND OPERATION.
 - WOOD CELLULOSE FIBERS MIXED WITH WATER MUST BE APPLIED AT A RATE OF 2,000 TO 2,500 POUNDS/ACRE, AND TACKIFIER MUST BE APPLIED AT A RATE OF 100 POUNDS/ACRE.
 - EROSION CONTROL BLANKET
 - EROSION CONTROL BLANKET MAY BE USED IN PLACE OF TRADITIONAL MULCHING METHODS.

SM		SEEDING & MULCHING	
ISSUED:	REVISION:	DESIGN MANAGER:	DRAWING NO:
10/7/19	8/18/2020	[Signature]	900-SM

SILT FENCE

J-HOOK INSTALLATION

SECTION A-A'

INSTALLATION NOTES

- SILT FENCE MUST BE PLACED ON A FLAT SURFACE 2'-5' AWAY FROM TOE OF THE SLOPE TO ALLOW FOR PONDING AND DEPOSITION.
- COMPACT THE TRENCH USING A JUMPING JACK OR WHEEL ROLLING TO THE POINT THAT THE FENCE RESISTS BEING PULLED OUT OF THE GROUND BY HAND.
- SILT FENCE SHALL BE TAUT WITH NO SAGS AFTER IT HAS BEEN ANCHORED.
- FABRIC SHALL BE ATTACHED TO POSTS WITH 1" HEAVY DUTY STAPLES OR 1" NAILS. THESE SHOULD BE PLACED VERTICALLY DOWN THE POST, 3" APART. THE PREFERRED INSTALLATION METHOD USES A TRENCHER OR SILT FENCE INSTALLATION DEVICE.
- INSTALL SILT FENCE ALONG THE CONTOUR OF THE SLOPES OR IN A MANNER TO AVOID CREATING CONCENTRATED FLOW (SUCH AS A "J-HOOK" INSTALLATION).

MAINTENANCE NOTES

- FREQUENT OBSERVATIONS AND MAINTENANCE ARE NECESSARY TO MAINTAIN CONTROL MEASURES IN EFFECTIVE OPERATING CONDITION. INSPECTIONS AND CORRECTIVE MEASURES SHOULD BE DOCUMENTED THOROUGHLY.
- ACCUMULATED SEDIMENT MUST BE REMOVED WHEN THE HEIGHT REACHES 2/3 OF THE DESIGN HEIGHT OF THE SILT FENCE.
- SILT FENCE MUST REMAIN UNTIL THE UPSTREAM DISTURBANCE AREA IS STABILIZED.
- PERMANENTLY STABILIZE AREA AFTER SILT FENCE IS REMOVED.

SF		SILT FENCE	
ISSUED:	REVISION:	DESIGN MANAGER:	DRAWING NO:
10/7/19	8/18/2020	[Signature]	900-SF

VEHICLE TRACKING

VEHICLE TRACKING NOTES

INSTALLATION REQUIREMENTS

- ALL ENTRANCES TO THE CONSTRUCTION SITE ARE TO BE STABILIZED PRIOR TO CONSTRUCTION BEGINNING.
- CONSTRUCTION ENTRANCES ARE TO BE BUILT WITH AN APRON TO ALLOW FOR TURNING TRAFFIC, BUT SHOULD NOT BE BUILT OVER EXISTING PAVEMENT EXCEPT FOR A SLIGHT OVERLAP.
- AREAS TO BE STABILIZED ARE TO BE PROPERLY GRADED AND COMPACTED PRIOR TO LAYING DOWN GEOTEXTILE AND STONE.
- CONSTRUCTION ROADS, PARKING AREAS, LOADING/UNLOADING ZONES, STORAGE AREAS, AND STAGING AREAS ARE TO BE STABILIZED.
- CONSTRUCTION ROADS ARE TO BE BUILT TO CONFORM TO SITE GRADES, BUT SHOULD NOT HAVE SIDE SLOPES OR ROAD GRADES THAT ARE EXCESSIVELY STEEP.

MAINTENANCE REQUIREMENTS

- REGULAR INSPECTIONS ARE TO BE MADE OF ALL STABILIZED AREAS, ESPECIALLY AFTER STORM EVENTS.
- STONES ARE TO BE REPLACED PERIODICALLY AND WHEN REPAIR IS NECESSARY.
- SEDIMENT TRACKED ONTO PAVED ROADS IS TO BE REMOVED DAILY BY SHOVELING OR SWEEPING. SEDIMENT IS NOT TO BE WASHED DOWN STORM SEWER DRAINS.
- STORM SEWER INLET PROTECTION IS TO BE IN PLACE, INSPECTED, AND CLEANED IF NECESSARY.
- OTHER ASSOCIATED SEDIMENT CONTROL MEASURES ARE TO BE INSPECTED TO ENSURE GOOD WORKING CONDITION.

City of Colorado Springs
Stormwater Quality

Figure VT-2
Vehicle Tracking
Application Examples

CWA		CONCRETE WASHOUT AREA	
ISSUED:	REVISION:	DESIGN MANAGER:	DRAWING NO:
10/7/19	8/18/2020	[Signature]	900-CWA-1

TEMPORARY SEDIMENT BASIN

INSTALLATION NOTES

- FOR STANDARD BASIN, BOTTOM DIMENSION MAY BE MODIFIED AS LONG AS BOTTOM AREA IS NOT REDUCED.
- EMBANKMENT MATERIAL SHALL CONSIST OF SOIL FREE OF DEBRIS, ORGANIC MATERIAL, AND ROCKS OR CONCRETE, GREATER THAN 3 INCHES, AND SHALL HAVE A MINIMUM OF 15 PERCENT BY WEIGHT PASSING THE NO. 200 SEVE.
- EMBANKMENT MATERIAL SHALL BE COMPACTED TO AT LEAST 95 PERCENT OF MAXIMUM DENSITY IN ACCORDANCE WITH ASTM D-698. PIPE SCHEDULE 40 OR GREATER SHALL BE USED.
- THE DETAILS SHOWN ON THESE SHEETS PERTAIN TO STANDARD SEDIMENT BASIN(S) FOR DRAINAGE AREAS LESS THAN 15 ACRES. SEE CONSTRUCTION DRAWINGS FOR EMBANKMENT, STORAGE VOLUME, SPILLWAY, OUTLET, AND OUTLET PROTECTION DETAILS FOR ANY SEDIMENT BASIN(S) THAT HAVE BEEN INDIVIDUALLY DESIGNED FOR DRAINAGE AREAS LARGER THAN 15 ACRES. DESIGN CALCULATIONS MUST BE APPROVED PRIOR TO IMPLEMENTATION.

MAINTENANCE NOTES

- FREQUENT OBSERVATIONS AND MAINTENANCE ARE NECESSARY TO MAINTAIN CONTROL MEASURES IN EFFECTIVE OPERATING CONDITION. INSPECTIONS AND CORRECTIVE MEASURES SHOULD BE DOCUMENTED THOROUGHLY.
- SEDIMENT ACCUMULATED IN BASIN SHALL BE REMOVED AS NEEDED TO MAINTAIN CONTROL MEASURE EFFECTIVENESS, TYPICALLY WHEN SEDIMENT DEPTH REACHES ONE FOOT (I.E. TWO FEET BELOW SPILLWAY CREST).
- SEDIMENT BASINS ARE TO REMAIN IN PLACE UNTIL THE UPSTREAM DISTURBED AREA IS PERMANENTLY STABILIZED.
- PERMANENTLY STABILIZE AREA AFTER SEDIMENT BASIN REMOVAL.

TSB		TEMPORARY SEDIMENT BASIN	
ISSUED:	REVISION:	DESIGN MANAGER:	DRAWING NO:
10/7/19	8/18/2020	[Signature]	900-TSB-1

TABLE SB-1; SIZING INFORMATION FOR STANDARD SEDIMENT BASIN

UPSTREAM DRAINAGE AREA (ROUNDED TO NEAREST ACRE), (AC)	BASIN BOTTOM WIDTH (W), (FT)	SPILLWAY CREST LENGTH (CL), (FT)	HOLE DIAMETER (HD), (IN)
1	12 $\frac{1}{2}$	2	3 $\frac{1}{2}$
2	21	3	15 $\frac{1}{16}$
3	28	5	3 $\frac{1}{2}$
4	33	8	5 $\frac{1}{2}$
5	38 $\frac{1}{2}$	8	2 $\frac{5}{16}$
6	47 $\frac{1}{2}$	9	2 $\frac{1}{2}$
8	51	12	2 $\frac{1}{2}$
9	55	13	1 $\frac{1}{2}$
10	58 $\frac{1}{2}$	15	1 $\frac{1}{2}$
11	61	16	3 $\frac{1}{2}$
12	64	18	3 $\frac{1}{2}$
13	67 $\frac{1}{2}$	19	1 $\frac{1}{2}$
14	70 $\frac{1}{2}$	21	1 $\frac{1}{2}$
15	73 $\frac{1}{2}$	22	1 $\frac{1}{2}$

INSTALLATION NOTES

MAINTENANCE NOTES

TSB		TEMPORARY SEDIMENT BASIN	
ISSUED:	REVISION:	DESIGN MANAGER:	DRAWING NO:
10/7/19	8/18/2020	[Signature]	900-TSB-2

CHECK DAM

INSTALLATION NOTES

- CHECK DAMS SHOULD BE INSTALLED BEFORE UPSTREAM LAND DISTURBING ACTIVITIES.
- RIPPRAP PAD SHOULD BE TRENCHED INTO GROUND BY A MINIMUM OF 6".

MAINTENANCE NOTES

- FREQUENT OBSERVATIONS AND MAINTENANCE ARE NECESSARY TO MAINTAIN CONTROL MEASURES IN EFFECTIVE OPERATING CONDITION. INSPECTIONS AND CORRECTIVE MEASURES SHOULD BE DOCUMENTED THOROUGHLY.
- ACCUMULATED SEDIMENT MUST BE REMOVED WHEN THE HEIGHT REACHES 2/3 OF THE CHECK DAM CREST.
- CHECK DAMS MUST REMAIN UNTIL THE UPSTREAM DISTURBANCE AREA IS STABILIZED.
- PERMANENTLY STABILIZE AREA AFTER CHECK DAMS ARE REMOVED, IF REMOVAL IS REQUIRED.

CD		CHECK DAM	
ISSUED:	REVISION:	DESIGN MANAGER:	DRAWING NO:
10/7/19	8/18/2020	[Signature]	900-CD

UNTIL SUCH TIME AS THESE DRAWINGS ARE APPROVED BY THE APPROPRIATE REVIEWING AGENCIES, OR ENGINEERING APPROVES THEIR USE, THESE DRAWINGS ARE DESIGNATED BY WRITTEN AUTHORIZATION.

PREPARED FOR
GATEWAY TRUCKING, LLC
235 S. FRANCEVILLE COAL MINE RD
COLORADO SPRINGS, CO 80929
ATTN: PERRY HASTINGS
602-558-0846
HASTINGSCONTRACTINGCO@GMAIL.COM

J.R. ENGINEERING
A Westman Company
Central 303-740-9383 • Colorado Springs 719-583-2593
Fort Collins 970-491-9888 • www.jrengineering.com

BY	DATE	No.	REVISION	H-SCALE	N/A	V-SCALE	N/A	DATE	DESIGNED BY	DRAWN BY	CHECKED BY
					N/A		N/A	05/24/22	GAG	GAG	GAG

GATEWAY TRUCKING SITE DEVELOPMENT PLAN
GEC DETAILS

811
Know what's below.
Call before you dig.

SHEET 8 OF 9
JOB NO. 25215.00

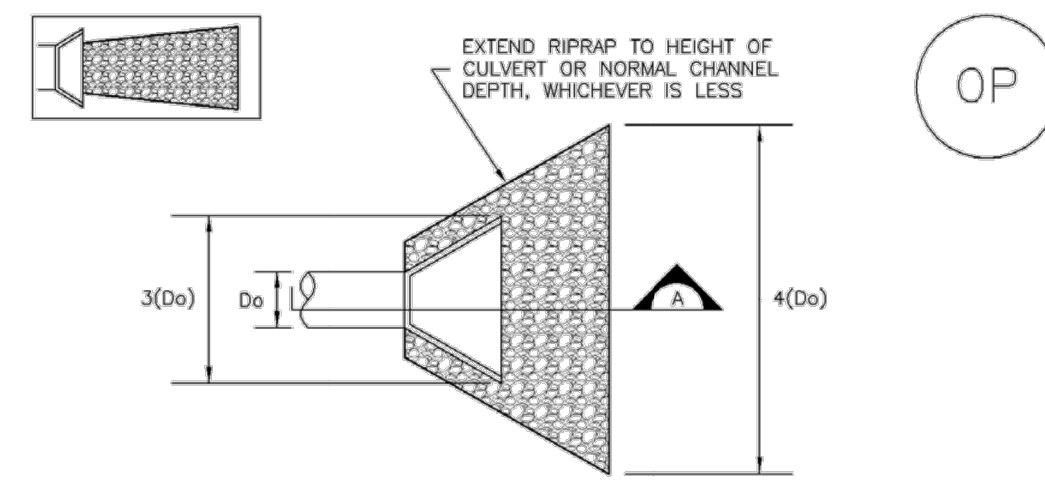

TEMPORARY OUTLET PROTECTION PLAN

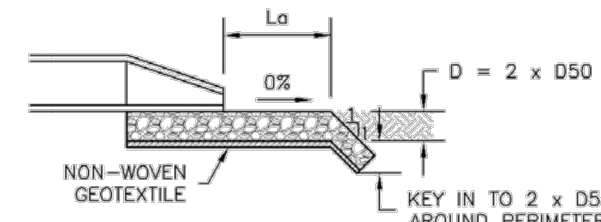

SECTION A

PIPE DIAMETER, D _o (INCHES)	DISCHARGE, Q (CFS)	APRON LENGTH, L _o (FT)	RIPRAP D ₅₀ DIAMETER MIN (INCHES)
8	2.5	5	4
12	5	10	6
18	10	15	6
24	20	16	9
	30	23	12
	40	26	16
	50	26	12
60	30	16	16

OP-1. TEMPORARY OUTLET PROTECTION

- TEMPORARY OUTLET PROTECTION INSTALLATION NOTES**
- SEE PLAN VIEW FOR
 - LOCATION OF OUTLET PROTECTION.
 - DIMENSIONS OF OUTLET PROTECTION.
 - DETAIL IS INTENDED FOR PIPES WITH SLOPE \leq 10%. ADDITIONAL EVALUATION OF RIPRAP SIZING AND OUTLET PROTECTION DIMENSIONS REQUIRED FOR STEEPER SLOPES.
 - TEMPORARY OUTLET PROTECTION INFORMATION IS FOR OUTLETS INTENDED TO BE UTILIZED LESS THAN 2 YEARS.
- TEMPORARY OUTLET PROTECTION INSPECTION AND MAINTENANCE NOTES**
- INSPECT BMPs EACH WORKDAY, AND MAINTAIN THEM IN EFFECTIVE OPERATING CONDITION. MAINTENANCE OF BMPs SHOULD BE PROACTIVE, NOT REACTIVE. INSPECT BMPs AS SOON AS POSSIBLE (AND ALWAYS WITHIN 24 HOURS) FOLLOWING A STORM THAT CAUSES SURFACE EROSION, AND PERFORM NECESSARY MAINTENANCE.
 - FREQUENT OBSERVATIONS AND MAINTENANCE ARE NECESSARY TO MAINTAIN BMPs IN EFFECTIVE OPERATING CONDITION. INSPECTIONS AND CORRECTIVE MEASURES SHOULD BE DOCUMENTED THOROUGHLY.
 - WHERE BMPs HAVE FAILED, REPAIR OR REPLACEMENT SHOULD BE INITIATED UPON DISCOVERY OF THE FAILURE.
- NOTE:** MANY JURISDICTIONS HAVE BMP DETAILS THAT VARY FROM UDFCD STANDARD DETAILS. CONSULT WITH LOCAL JURISDICTIONS AS TO WHICH DETAIL SHOULD BE USED WHEN DIFFERENCES ARE NOTED.
- (DETAILS ADAPTED FROM AURORA, COLORADO AND PREVIOUS VERSION OF VOLUME 3, NOT AVAILABLE IN AUTOCAD)

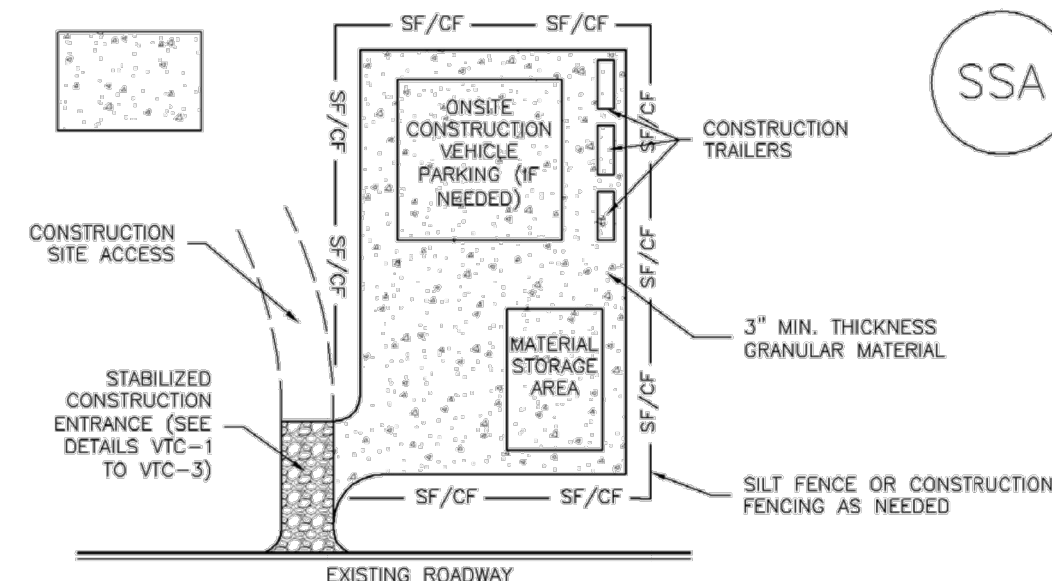

SSA-1. STABILIZED STAGING AREA

- STABILIZED STAGING AREA INSTALLATION NOTES**
- SEE PLAN VIEW FOR
 - LOCATION OF STAGING AREA(S).
 - CONTRACTOR MAY ADJUST LOCATION AND SIZE OF STAGING AREA WITH APPROVAL FROM THE LOCAL JURISDICTION.
 - STABILIZED STAGING AREA SHOULD BE APPROPRIATE FOR THE NEEDS OF THE SITE. OVERSIZING RESULTS IN A LARGER AREA TO STABILIZE FOLLOWING CONSTRUCTION.
 - STAGING AREA SHALL BE STABILIZED PRIOR TO OTHER OPERATIONS ON THE SITE.
 - THE STABILIZED STAGING AREA SHALL CONSIST OF A MINIMUM 3" THICK GRANULAR MATERIAL.
 - UNLESS OTHERWISE SPECIFIED BY LOCAL JURISDICTION, ROCK SHALL CONSIST OF DOT SECT. #703, AASHTO #3 COARSE AGGREGATE OR 6" (MINUS) ROCK.
 - ADDITIONAL PERIMETER BMPs MAY BE REQUIRED INCLUDING BUT NOT LIMITED TO SILT FENCE AND CONSTRUCTION FENCING.
- STABILIZED STAGING AREA MAINTENANCE NOTES**
- INSPECT BMPs EACH WORKDAY, AND MAINTAIN THEM IN EFFECTIVE OPERATING CONDITION. MAINTENANCE OF BMPs SHOULD BE PROACTIVE, NOT REACTIVE. INSPECT BMPs AS SOON AS POSSIBLE (AND ALWAYS WITHIN 24 HOURS) FOLLOWING A STORM THAT CAUSES SURFACE EROSION, AND PERFORM NECESSARY MAINTENANCE.
 - FREQUENT OBSERVATIONS AND MAINTENANCE ARE NECESSARY TO MAINTAIN BMPs IN EFFECTIVE OPERATING CONDITION. INSPECTIONS AND CORRECTIVE MEASURES SHOULD BE DOCUMENTED THOROUGHLY.
 - WHERE BMPs HAVE FAILED, REPAIR OR REPLACEMENT SHOULD BE INITIATED UPON DISCOVERY OF THE FAILURE.
 - ROCK SHALL BE REAPPLIED OR REGRADED AS NECESSARY IF RUTTING OCCURS OR UNDERLYING SUBGRADE BECOMES EXPOSED.

- STABILIZED STAGING AREA MAINTENANCE NOTES**
- STABILIZED STAGING AREA SHALL BE ENLARGED IF NECESSARY TO CONTAIN PARKING, STORAGE, AND UNLOADING/LOADING OPERATIONS.
 - THE STABILIZED STAGING AREA SHALL BE REMOVED AT THE END OF CONSTRUCTION. THE GRANULAR MATERIAL SHALL BE REMOVED OR, IF APPROVED BY THE LOCAL JURISDICTION, USED ON SITE, AND THE AREA COVERED WITH TOPSOIL, SEEDED AND MULCHED OR OTHERWISE STABILIZED IN A MANNER APPROVED BY LOCAL JURISDICTION.
- NOTE:** MANY MUNICIPALITIES PROHIBIT THE USE OF RECYCLED CONCRETE AS GRANULAR MATERIAL FOR STABILIZED STAGING AREAS DUE TO DIFFICULTIES WITH RE-ESTABLISHMENT OF VEGETATION IN AREAS WHERE RECYCLED CONCRETE WAS PLACED.
- NOTE:** MANY JURISDICTIONS HAVE BMP DETAILS THAT VARY FROM UDFCD STANDARD DETAILS. CONSULT WITH LOCAL JURISDICTIONS AS TO WHICH DETAIL SHOULD BE USED WHEN DIFFERENCES ARE NOTED.
- (DETAILS ADAPTED FROM DOUGLAS COUNTY, COLORADO, NOT AVAILABLE IN AUTOCAD)

UNTIL SUCH TIME AS THESE DRAWINGS ARE APPROVED BY THE APPROPRIATE REVIEWING AGENCIES, OR ENGINEERING APPROVES THEIR USE, THESE DRAWINGS ARE DESIGNATED BY WRITTEN AUTHORIZATION.

PREPARED FOR
GATEWAY TRUCKING, LLC
235 S. FRANCEVILLE COAL MINE RD
COLORADO SPRINGS, CO 80929
ATTN: PERRY HASTINGS
602-558-0846
HASTINGCONTRACTING@GMAIL.COM

J.R. ENGINEERING
A Westman Company
Central 303-740-9383 • Colorado Springs 719-583-2593
Fort Collins 970-491-9888 • www.jrengineering.com

H-SCALE	V-SCALE	DATE	DESIGNED BY	DRAWN BY	CHECKED BY	No.	REVISION	BY	DATE
N/A	N/A	05/24/22	GAG	GAG					

GATEWAY TRUCKING SITE DEVELOPMENT PLAN
GEC DETAILS



Know what's below.
Call before you dig.

X:\2520000\al25215000\Drawings\Sheet\Drawings\GEC\25215000101.dwg, GEC-DWG, 22/05/2022, 10:35:17 AM, CS