

See PUDSP  
comments



comments are same  
for both filings 1 and  
2

## Midtown Collection at Hannah Ridge Filing No. 1 and 2 Letter of Intent

### OWNER:

Feathergrass Investments, LLC  
4715 N. Chestnut Street  
Colorado Springs, CO 80907  
(719) 651-9133

### DEVELOPER: (Contract Purchaser)

Elite Properties of America, Inc.  
6385 Corporate Drive, Suite 200  
Colorado Springs, CO 80919  
(719) 592-9333

### APPLICANT/CONSULTANT:

Classic Consulting Engineers & Surveyors, LLC  
619 N. Cascade Ave., Suite 200  
Colorado Springs, CO 80903  
(719) 785-0790

### SITE LOCATION:

Both filings are generally located north and west of Hannah Ridge Drive and Constitution Avenue in two previously platted Tracts (Tracts AA and BB, Hannah Ridge at Feathergrass Filing No. 1)

### Size:

Filing No. 1: 9.123 Acres  
Filing No. 2: 3.260 Acres

### Zoning:

RM-30 CAD-0 (Existing)

No the PUD will be  
approved. So State  
that a rezone to PUD  
is proposed.

### REQUEST:

Applicant requests that the 2 previously platted Tracts AA (Filing No. 2) and BB (Filing No. 1) be replatted to reflect a total of 89 lots. The breakdown per filing is:

- Filing No. 1: 61 Lots
- Filing No. 2: 28 Lots

The following tracts are also proposed:

Filing 1:	Tract A	3,720 Ac
	Tract B	3,418 sf
	Tract C	7,094 sf
	Tract D	8,072sf
	Tract E	7,350 sf
	Tract F	12,149 sf
	Tract G	5,229 sf

Filing 2:	Tract A	42,914 sf
	Tract B	745 sf
	Tract C	2,192 sf
	Tract D	11,716 sf

All tracts will be for parks, open space, public drainage, private access and public utilities as defined on the final plats and be owned and maintained by the Midtown Collection at Hannah Ridge Home Owners Association (HOA).

**PHASED CONSTRUCTION AND ANTICIPATED DEVELOPMENT SCHEDULE:**

Overall development phasing will begin on the east side of Filing No. 1 adjacent to Hannah Ridge Drive and continue west to Filing No. 2. All open space tracts will be developed with the adjacent residential phases as they occur. Commercial phases are to be designed and developed as demand dictates. All directly adjacent single-family development (Filing 2, 3 and 4) are either built out or under construction.

**DEVIATION REQUESTS:**

A PUD Modification request for both filings for lot frontage along a public street of less than 30' and to allow lot access to private roadways is proposed and included in this submittal.

Speak to this being requested and anticipated approval with PUDSP

**JUSTIFICATION:**

The proposed Filings 1 and 2 are the final residential phases of this previously approved Master Planned Residential Community. The layout of the proposed street network conforms to the previously approved anticipated design with the exception of one additional eastern public street.

Conforms to the requested PUDSP Fil No. PUD19

The proposed PUD plan and plats within the developing Hannah Ridge at Feathergrass community are proposed under the anticipated residential density reflected on the approved Hannah Ridge at Feathergrass sketch plan. 89 residential homes are proposed where 205 had been anticipated. Development will also be in accordance with the proposed Midtown Collection at Hannah Ridge PUD Plan. The PUD Guidelines, with which the development will conform, are being concurrently reviewed with the final plats.

See PUD comments for clarification

The proposed development will provide a new buyer option for single family residential housing lots. The unique building orientation and rear-loaded garages, along with a unique "small lot" community design provides for an alternative community type not seen in El Paso County. Adequate provisions for drainage and utilities and continued build-out of the proposed Preliminary plan and PUD plan will enhance the public health, safety and general welfare within this portion of El Paso County.

The owner understands and agrees to certain Conditions of Approval including payment of School Fees, payment of Park Fees, payment of Drainage and Bridge Fees, and payment of road impact fees that now include signal costs, negating the need for the prior escrow agreement for the Constitution and Hannah Ridge Drive intersection. Required fees will be paid at time of plat recording.

This application meets the final plat submittal requirements, the standards for Divisions of Land in Chapter 7, and the standards for Subdivision in Chapter 8 of the El Paso County Land Development Code (2016). Final Plats are reviewed and approved in consideration of the review criteria found in the El Paso County Land Development Code.

1. *The subdivision is in conformance with the goals, objectives, and policies of the Master Plan.*

The Master Plan is comprised of several elements. One of the elements is the El Paso County Policy Plan (1998), which does not include site-specific land use policies, but establishes broad policies and goals which are intended to serve as a framework for decision-making regarding development of the County. The project satisfies the following relevant policies from the Policy Plan as they specifically relate to this request: **Policy 6.1.3** – Encourage new development which is contiguous and compatible with previously developed areas in terms of factors such as density, land use and access. **Policy 6.1.4** – Encourage the logical timing and phasing of development to allow for the efficient and economical provision of facilities and services. **Policy 6.1.2** – Utilize buffer zones to provide mutually compatible transitions between neighborhoods and adjoining development with differing uses or densities. **Policy 6.2.11** – Encourage compatible physical character, density and scale in existing neighborhoods.

The proposed subdivision is consistent with the surrounding single-family residential zoned properties to the north. The proposed subdivisions are adjacent to and is the logical extension of the recently platted Hannah Ridge at Feathergrass Filing No's 2, 3 and 4. A pre-cast wall along the southerly boundary of the Filings 2, 3 and 4 sites will mitigate the impacts to the residential development along Hunter Jumper Drive to the north and will be maintained by the HOA. A 6' wall is also proposed along Constitution Avenue to reduce the noise impact from the arterial roadway. The proposed subdivision is the continuation of the ongoing Hannah Ridge at Feathergrass development. The site is not contained within any Small Area Plans of the County. The proposed subdivision plat is in compliance with the Parks Master Plan, which does not call for trails or parks in the site vicinity. The proposed subdivisions are also in compliance with the Master Plan for Mineral Extraction as no separate mineral estate owners were found for the property and the existing development on surrounding properties is not compatible with any potential mineral extraction operations.

2. *The subdivision is in substantial conformances with the approved preliminary plan.*

The proposed Final Plat is consistent and in conformance with the concurrently proposed Preliminary Plan for the Midtown Collection at Hannah Ridge development.

3. *The subdivision is consistent with the subdivision design standards and regulations and meets all planning, engineering, and surveying requirements of the County for maps, data, surveys, analyses, studies, reports, plans, designs, documents, and other supporting materials.*

The proposed Final Plat is prepared in accordance with all applicable subdivision design standards.

4. *A sufficient water supply has been acquired in terms of quantity, quality, and dependability for the type of subdivision proposed, as determined in accordance with the standards set forth in the water supply standards [C.R.S. 30-28-133(6)(a)] and the requirements of Chapter 8 if this Code.*

The site is contained within the service area of Cherokee Metropolitan District and the District has agreed to serve the property. The Owner has secured water rights for the district, which are reserved for use in this development. Existing and directly adjacent water mains will be utilized.

5. *A public sewage disposal system has been established and, if other methods of sewage disposal are proposed, the system complies with State and local laws and regulations, [C.R.S. 30-28-133(6)(b)] and the requirements of Chapter 8 of this Code.*

The site is contained within the service area of Cherokee Metropolitan District and the District has agreed to serve the property. The sanitary sewer mains to serve the proposed site will be extended from existing adjacent mains already constructed in Filing No's 1, 2, 3 and 4, which were approved by the District.

6. *All areas of the proposed subdivision which may involve soil or topographical conditions presenting hazards or requiring special precautions have been identified and that the proposed subdivision is compatible with such conditions [C.R.S. 30-28-133(6)(c)].*

A soils report has been prepared for the site and the owner will comply with the recommendations of the report.

7. *Adequate drainage improvements are proposed that comply with State Statute [C.R.S. 30-28-133(3)(c)(VIII)] and the requirements of this Code and the ECM.*

The Midtown Collection at Hannah Ridge development has planned a comprehensive drainage system. Public drainage infrastructure built within Filings 1, 2, 3 and 4 have adequate capacity necessary to serve this subdivision. The drainage improvements will be consistent with the operable Drainage Basin Planning Study (DBPS), The Master Development Drainage Plan (MDDP) for Hannah Ridge at Feathergrass, the Preliminary Drainage Report and the Final Drainage Reports for each subdivision filing.

8. *Legal and physical access is provided to all parcels by public rights-of-way or recorded easement, acceptable to the County in Compliance with this Code and the ECM.*

Each proposed lot on the site will access a public street either directly or via a private tract and there are multiple exit and entry points available for the safety of the future residents. Four public cul-de-sacs are proposed as a part of these filings.

9. *Necessary services, including police and fire protection, recreation, utilities, and transportation systems, are or will be made available to serve the proposed subdivision.*

The site is located within the jurisdiction of the El Paso County Sheriff's Office. The Sheriff's office currently provided police protection for the site and surrounding area. Midtown Collection at Hannah Ridge Filing No. 1 is located within the Falcon Fire Protection District. Filing No 2 is within the Cimarron Hills Fire Department coverage area. Fire Hydrant locations for the site are being reviewed and approved by both fire departments. Water and Sanitary Sewer infrastructure is being provided by the developer in accordance with Cherokee Metropolitan District standards. The completed development will include natural open space and open space areas. Transportation is provided by the adjacent existing and proposed roadway system.

10. *The final plans provide evidence to show that the proposed methods for fire protection comply with Chapter 6 of this Code.*

Midtown Collection at Hannah Ridge Filings No. 1 and 2 are located within two fire protection districts (1 is within Falcon), and the Cimarron Hills Fire Department on the west for Filing No. 2. The water main system is designed to provide adequate fire flows at the site as reviewed by Cherokee Metropolitan District. Fire Hydrant locations for the site are being reviewed and approved by both fire departments.

11. *Off-site impacts were evaluated and related off-site improvements are roughly proportional and will mitigate the impacts of the subdivision in accordance with applicable requirements of Chapter 8.*

Off-site transportation and drainage impacts are considered and mitigated by the recommendations of the Final Drainage Report and Traffic Impact Study Update Memo. The developer will make

improvements to Constitution Avenue by adding sidewalk along the development frontage. With the recent amendment to the El Paso County Road Impact Fee, a separate escrow for the future signal at Hannah Ridge Drive and Constitution Avenue will no longer be required. The owner has requested the property be admitted to PID #2.

12. *Adequate public facilities or infrastructure, or cash-in-lieu, for impacts reasonably related to the proposed subdivision have been constructed or are financially guaranteed through the SIA so the impacts of the subdivision will be adequately mitigated.*

The Subdivision Improvement Agreement (SIA) includes provision to guarantee construction of the necessary infrastructure. The platting of the site will include the collection of the applicable Drainage Fees, School Fees and Park Fees.

13. *The subdivision meets other applicable sections of Chapter 6 and 8.*

The subdivision meets the requirements of the Land Development Code other than the PUD Modification request pending with this application.

14. *The extraction of any known commercial mining deposit shall not be impeded by this subdivision [C.R.S. 34-1-302(1), et seq.].*

No separate mineral estate owners were found for the property and the existing development on surrounding properties is not compatible with any potential mineral extraction operations.

#### **EXISTING AND PROPOSED FACILITIES, STRUCTURES, ROADS, ETC.:**

All adjacent roadway and utility infrastructure are in place to support the development for this residential community.

Existing offsite roads include Constitution Avenue (160' row) to which this developer has made previous improvements, Akers Drive (80' row) constructed by this owner/developer in cooperation with El Paso County. Other existing facilities include the storm drain line along the north side of Constitution Avenue, the box culvert crossing of Constitution Avenue at Akers Drive and various utility line stub-outs in Akers Drive and Constitution Avenue that were previously constructed by this owner/developer. Hannah Ridge at Feathergrass Filing No. 5 will also include additional improvements to Akers Drive at the proposed Electronic Drive intersection, including curb returns, sound wall and public sidewalks.

Existing facilities provided in Hannah Ridge at Feathergrass include Hunter Jumper Drive (60-80' row), Winslow Park Drive (60; row) and all of Shawnee Drive, as well as the associated mainline utilities and utility services for the lots. Storm drainage and stormwater quality facilities were also provided.

Existing facilities provided in adjacent Hannah Ridge at Feathergrass Filing No. 2 include a portion of Hunter Jumper Drive (60-80' row), a portion of Winslow Park Drive (60' row), all of Half Chaps Court (60' row), and a portion of Hannah Ridge Drive (60'-90' row) as well as the associated mainline utilities and utility services for the lots. Storm drain in Hannah Ridge Drive and Half Chaps Court, the Hannah Ridge Drive concrete box culvert, and stormwater quality facilities were also provided.

Facilities provided in Filing No. 3 include a portion of Hunter Jumper Drive (60' row), a portion of Winslow Park Drive (60' row), a portion of Grand Prix Court (50' row), and all of Horsemanship Court (50' row). Filing No. 3 facilities included the associated mainline utilities and utility services for the lots, the major storm drain line that conveys the Sand Creek Tributary 6 storm flows south to the Constitution Avenue channel, and storm drain lines in Hunter Jumper Drive and the necessary stormwater quality facilities.

Facilities provide in Filing No. 4 include the westerly portion of Hunter Jumper Drive (60' row), the westerly portion of Winslow Park Drive (60' row), all of Shawnee Drive (60' row) from Constitution Avenue to Winslow Park Drive, and a portion of Pony Club Lane (50' row). Filing No. 4 facilities include the associated mainline utilities and utility services for the lots, storm drain facilities in Shawnee Drive and the necessary stormwater quality facilities.

Utility Providers:

Water and Wastewater:	Cherokee Metro District
Gas:	Colorado Springs Utilities
Electrical:	Mountain View Electric

**UTILITIES- WATER AND SEWER:**

Water and sewer will be provided by Cherokee Metropolitan District. The district has provided a detailed Service Commitment letter which explains how capacity is available for the planned development. The developer has purchased water rights and transferred these rights to Cherokee Metropolitan District, which has in turn reserved this water for use in the Hannah Ridge at Feather grass development. The developer will construct all streets, utilities and storm drainage improvements. Utilities will be routed underground in the public streets and utility easement per El Paso County design standard. Cherokee Metropolitan District will provide maintenance of proposed water and sewer system.

**FIRE PROTECTION:**

Midtown Collection at Hannah Ridge Filing No. 1 is located completely within the Falcon Fire Protection District and the District has provided a letter of agreement to serve. Additionally, Filing No. 2 is located within the Cimarron Hills Fire Department service area on the east. This boundary between the two is located along Shawnee Drive.

**PROPOSED USES, RELATIONSHIP BETWEEN USES AND DENSITIES:**

Existing single-family residential development exist to the north on the opposite side of the adjacent Hunter Jumper Drive. Densities of this proposal are less than previously anticipated for this multi-family site.

**LANDSCAPING AND BUFFERING:**

Frontage of Constitution Avenue will be landscaped in accordance with the proposed PUD plan. Landscape trees will be planted and pre-cast concrete wall will be constructed along Constitution Avenue.

Street right-of-way's and entries will also be landscaped as indicated on the PUD Plan. The landscaping, wall and open space tracts are to be installed by the Developer of the project and will be maintained by the Midtown Collection at Hannah Ridge Homeowners Association.

**PROPOSED ACCESS LOCATIONS:**

Access locations have been previously identified on the approved sketch plan. All proposed access points are full movement. A Traffic Impact Study update memo for the proposed development is provided with this application.

**TRAFFIC IMPACT FEES:**

This development is subject to fees established by the El Paso County Road Impact Fee Program per El Paso County Resolution Number 12-382. The owner is petitioning for inclusion of the new residential lots into the Public Improvements District No. 2 (the 10 mil PID). Fees at building permit for each Single-family Detached dwelling in the 10mil PID is \$1,221.00. This fee will be paid at the time of building permit issuance. The Midtown Collection at Hannah Ridge property is also contained within the Constitution Heights Metropolitan

District and lots subject to traffic impact related building permit fees pursuant to a 2009 IGA. The fee in Midtown Collection at Hannah Ridge is \$923.00 per single family residential lot to be paid at the building permit issuance. However, the lots in Midtown Collection at Hannah Ridge are also eligible for credit in the El Paso County Road Impact Fee Program as established by El Paso County Resolution Number 12-389. The credit is designed to offset the contribution mandated by the IGA as well as amounts already contributed to the County's transportation system in the form of road construction and dedication of right of way for portions of Constitution Avenue and Akers Drive by the developer.

A summary of the fees for each single-family lot in the subdivision is provided below:

The development enters Public Improvements District No. 2 (the 10 mil PID) and is subject to the requirements thereof. The developer will pay the \$923.00 fee to El Paso County pursuant to the 2009 IGA and Resolution 12-389. The county will reimburse Pikes Peak Rural Transportation Authority from this fee payment. The accrual and use of any credit in the El Paso County Road Impact Fee Program is governed according to Resolution 12-389.

Sm/111630/letter of intent

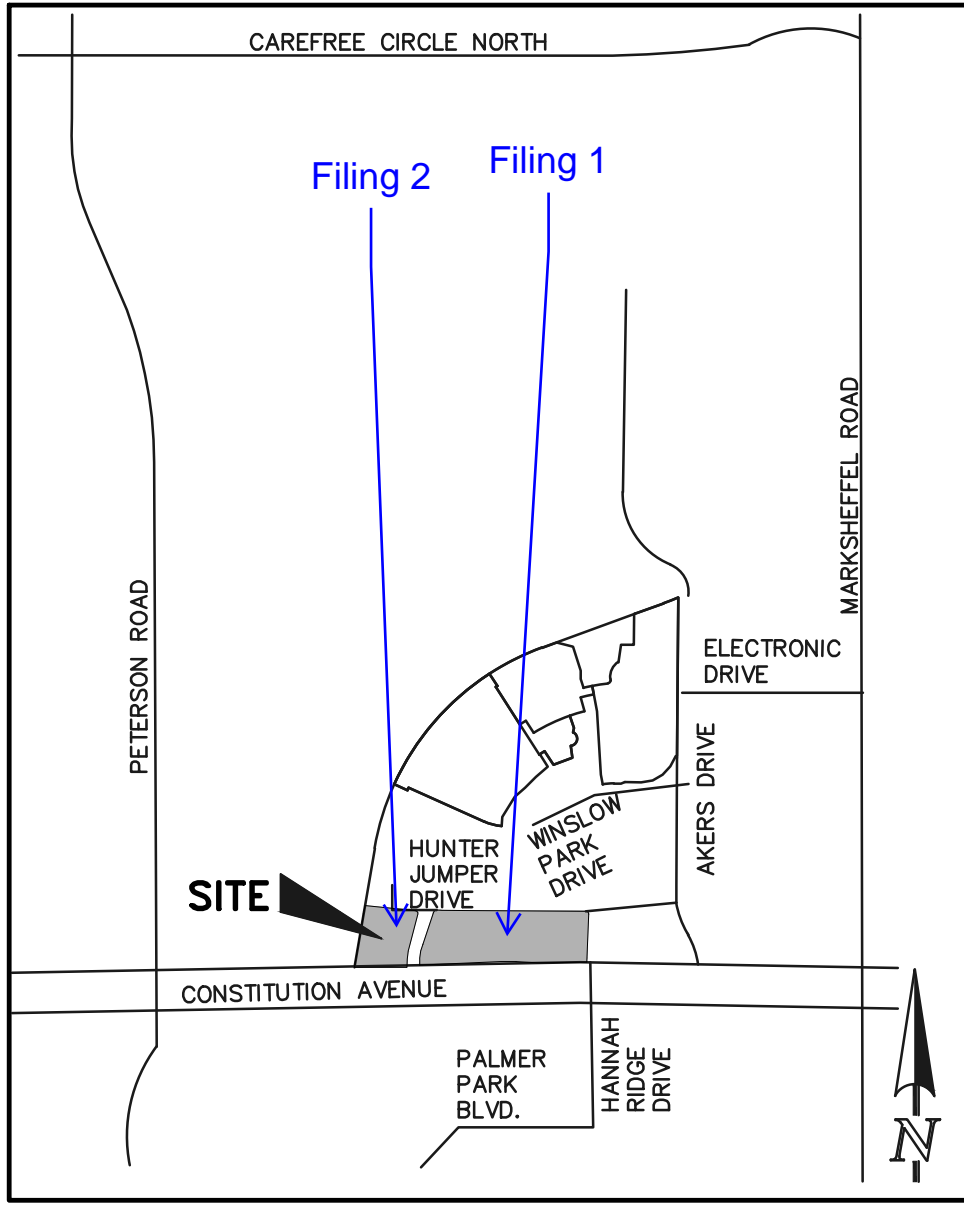

VICINITY MAP

N.T.S.



# Hamak Ridge at Feathergrass

AMENDMENT TO THE SAND CREEK COMMUNITIES SKETCH PLAN - EL PASO COUNTY, COLORADO

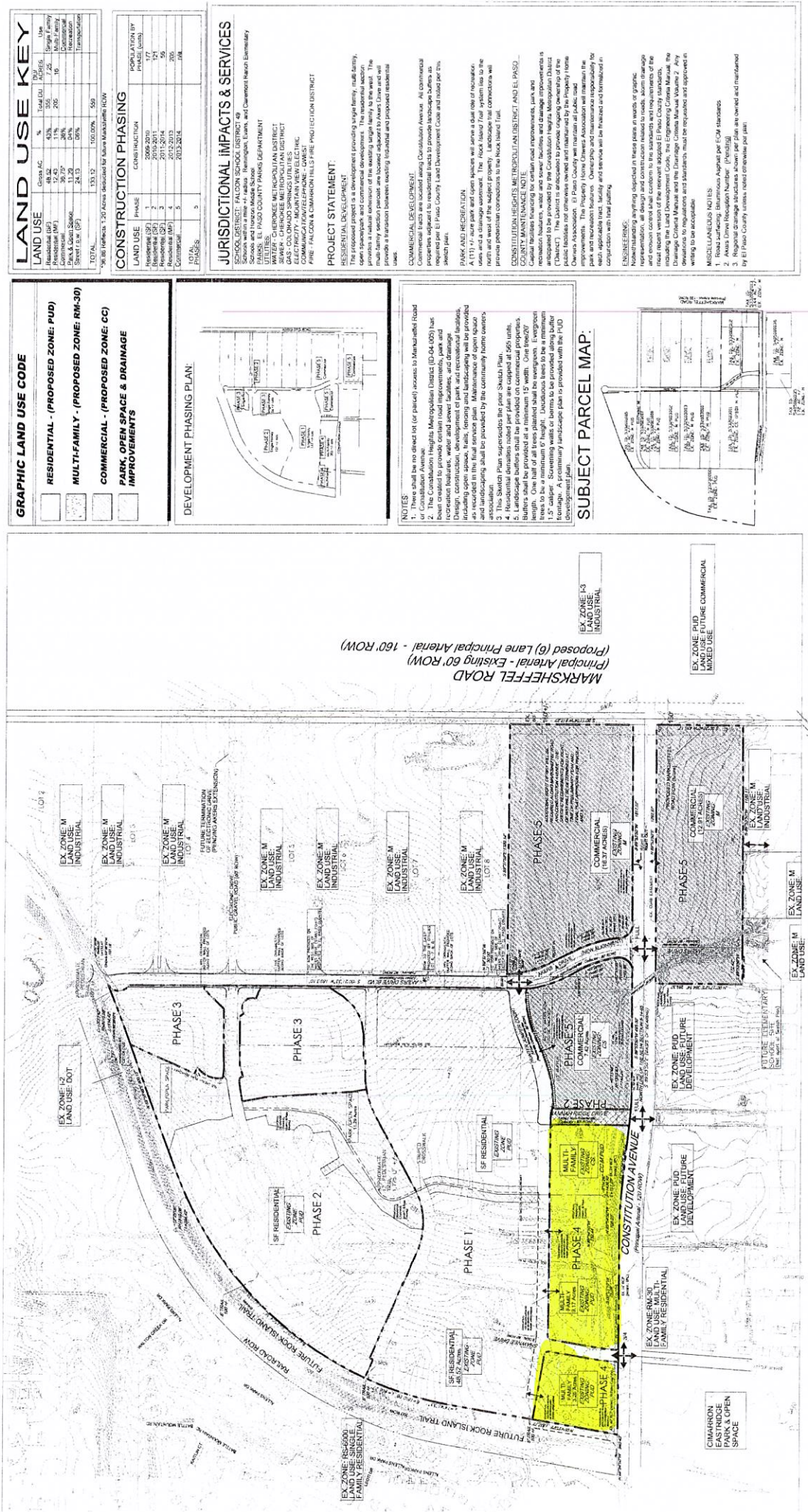

### LAND USE KEY

LAND USE	AREA AC	%	TOTAL ACRES	DISTRICT
Residential (R)	48.32	43%	100.00	Single Family
Residential (M)	1.74	1%	200	Multi-Family
Multi-Family (M)	1.74	1%	200	Multi-Family
Street (S)	11.22	10%	200	Street
Street (S)	24.13	22%	200	Street
<b>TOTAL</b>	<b>133.12</b>	<b>100.00%</b>	<b>530</b>	

### CONSTRUCTION PHASING

LAND USE	PHASE	CONSTRUCTION PHASE	POPULATION BY PHASE (2014)
Residential (R)	1	2006-2011	177
Residential (M)	2	2011-2014	50
Residential (S)	3	2015-2017	50
Commercial (C)	4	2018-2020	50
Commercial (M)	5	2021-2023	50
<b>TOTAL PHASES</b>	<b>5</b>	<b>2024-2027</b>	<b>376</b>

### JURISDICTIONAL IMPACTS & SERVICES

SCHOOL DISTRICT: FALCON SCHOOL DISTRICT No. 1  
 FIRE: EL PASO COUNTY FIRE DEPARTMENT  
 UTILITIES: SERRANO METROPOLITAN DISTRICT  
 SEWER: CHEYENNE METROPOLITAN DISTRICT  
 GAS: COLORADO SPRINGS UTILITIES  
 COMMUNICATIONS/TELEPHONE: QWEST  
 AIR: FALCON & CHAMBERLAIN FIRE PROTECTION DISTRICT

### PROJECT STATEMENT

**RESIDENTIAL DEVELOPMENT**  
 This proposed project is a development providing single family, multi-family, open space/park and commercial development. The residential section will be developed in five phases. The multi-family section will be developed in one phase. The multi-family section will be located adjacent to the residential section and will provide a transition between existing residential and proposed residential uses.

### COMMERCIAL DEVELOPMENT

Commercial tracts are located along Constitution Avenue. All commercial tracts are located along Constitution Avenue. All commercial tracts are located along Constitution Avenue. All commercial tracts are located along Constitution Avenue.

### PARK AND RECREATION

A (11) 1/2 acre park and open spaces will serve a dual role of recreation, uses and a drainage easement. The rock heavy final system lies to the north and west of the subject property. Landscape final contractors will provide a transition between existing residential and proposed residential uses.

### CONSTITUTION HEIGHTS METROPOLITAN DISTRICT AND EL PASO COUNTY

Constitution Heights Metropolitan District and El Paso County are required to provide certain road improvements, park and recreation facilities, water and sewer facilities and drainage improvements as stipulated by the Constitution Heights Metropolitan District. The District has approved the proposed project and has provided a public facilities not otherwise provided and maintained by the property owner. El Paso County will maintain all public road, park and recreation facilities. The County will maintain all public road, park and recreation facilities. The County will maintain all public road, park and recreation facilities.

### MISCELLANEOUS NOTES

1. Road surfacing. Estimate August per E.C.M. standards.
2. Area Under Reclamation Number (PUD/111)
3. All areas shown as to be owned and maintained by El Paso County unless noted otherwise per plan.

### GRAPHIC LAND USE CODE

[Symbol]	RESIDENTIAL - (PROPOSED ZONE: PUD)
[Symbol]	MULTI-FAMILY - (PROPOSED ZONE: RM-30)
[Symbol]	COMMERCIAL - (PROPOSED ZONE: CC)
[Symbol]	PARK, OPEN SPACE & DRAINAGE IMPROVEMENTS



### SUBJECT PARCEL MAP

1. There shall be no direct lot (or parcel) access to Marksheffel Road or Constitution Avenue.  
 2. The Constitution Heights Metropolitan District (D-04-005) has approved the proposed project and has provided a public facilities not otherwise provided and maintained by the property owner. El Paso County will maintain all public road, park and recreation facilities. The County will maintain all public road, park and recreation facilities. The County will maintain all public road, park and recreation facilities.

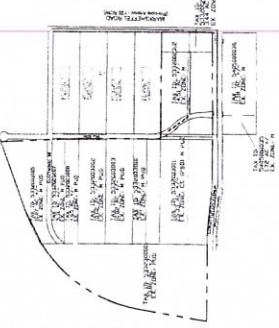

MA-SKP-07-004

**SHEET:**

2 of 2

DATE: 10/15/2014  
 BY: J. HAYES  
 TITLE: PLANS

SCALE: 1"=200'

North

1470 MILLBROOK COURT  
 GLEN HILL, CO 80120  
 PHONE: 303.401.1100  
 FAX: 303.401.1101  
 WWW.NATURALDESIGN.COM

**EQUITY**

**MONUMENT VALLEY ENGINEERS, INC.**

Hamak Ridge at Feathergrass

