

**1 | FLOOR PLAN - FIRST FLOOR, SDP**  
 SDP-08 | 1/8" = 1'-0"

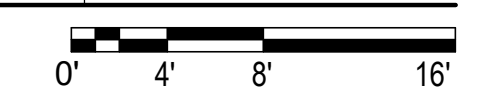

D2C ARCHITECTS, INC.  
 DENVER, COLORADO  
 COPYRIGHT © 2022  
 THESE DRAWINGS AND PLANS ARE  
 COPYRIGHTED AND ARE NOT TO BE USED  
 OR REPRODUCED WHOLLY OR IN PART  
 WITHOUT THE WRITTEN PERMISSION OF  
 D2C ARCHITECTS, INC.

MARK	DATE	APPROVED

DESIGN BY: BD	ISSUE DATE: NOVEMBER 14, 2022
D2C PROJECT NUMBER 202207	CONSULTANT'S PROJECT #
DRAWN BY: BD	CHKD BY: HK
PLOT DATE: 11/18/2022	FILE NUMBER:
CONTRACT NO.:	FILE NAME:
SIZE: 22" x 34"	

**SITE DEVELOPMENT PLAN**

El Paso County Sheriff's Department  
**Falcon Substation**  
 12072 Royal County Down Rd, Falcon, Colorado 80831  
**FLOOR PLAN - FIRST FLOOR**

**SHEET IDENTIFICATION**  
 SDP-08  
 SHEET 8 OF 14

PCD FILE # PPR-20-029

SDP-08

D

C

B

A

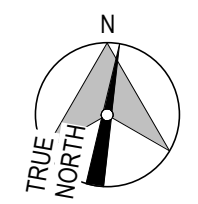
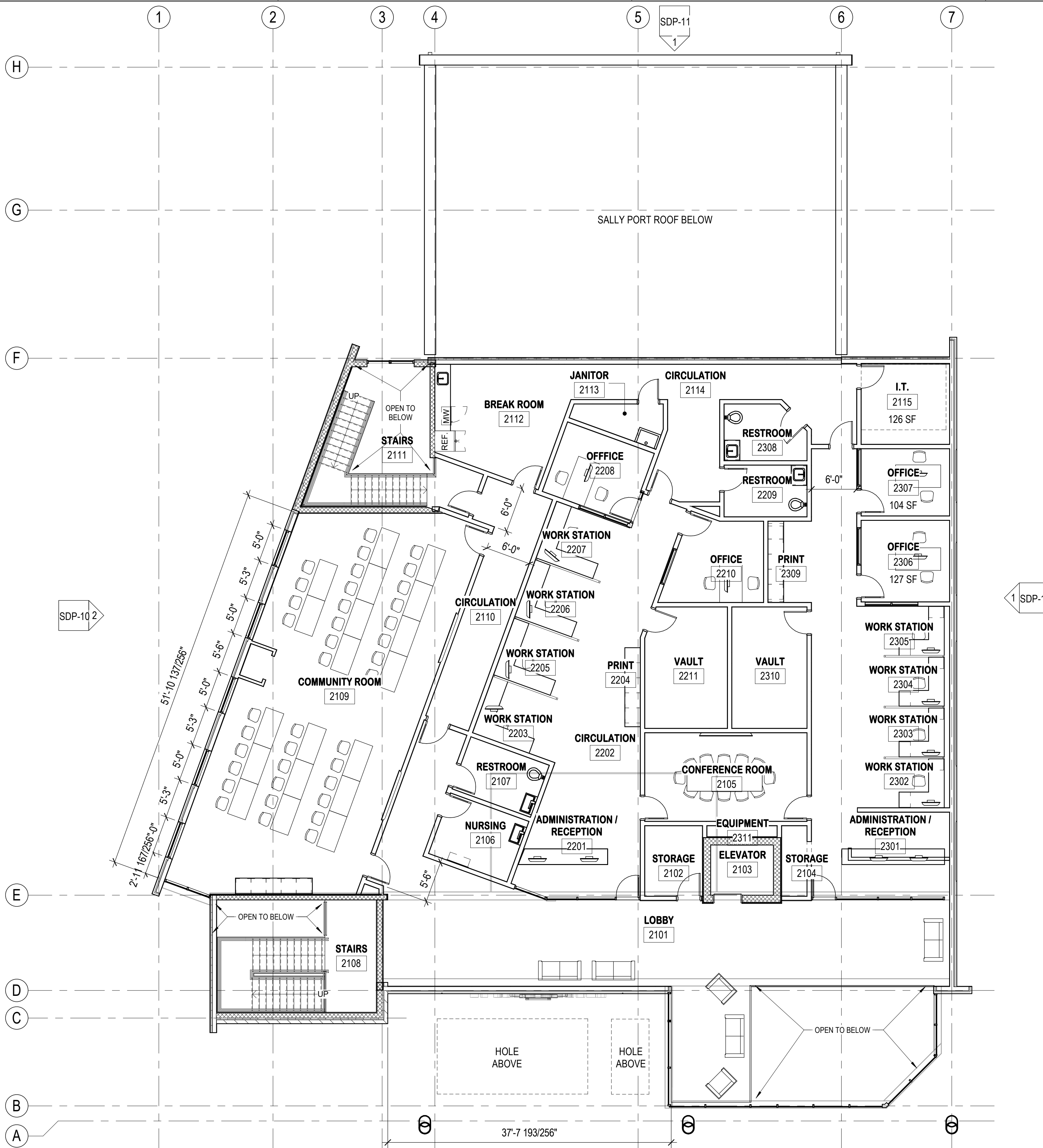

1 | FLOOR PLAN - SECOND FLOOR, SDP  
SDP-09 1/8" = 1'-0"



D2C ARCHITECTS, INC.  
DENVER, COLORADO  
COPYRIGHT © YYYY  
THESE DRAWINGS AND PLANS ARE  
COPYRIGHTED AND ARE NOT TO BE USED  
OR REPRODUCED WHOLLY OR IN PART  
WITHOUT THE WRITTEN PERMISSION OF  
D2C ARCHITECTS, INC.

MARK	DESCRIPTION	DATE	APP'D

DESIGN BY:	ISSUE DATE:
Designer D2C PROJECT NUMBER 202207	<b>NOVEMBER 14, 2022</b> CONSULTANT'S PROJECT #
DRAWN BY: Author CHK BY: Checker	SOLICITATION NO.:
SEAL BY: Approver	CONTRACT NO.:
PLOT SCALE: 1/8" = 1'-0"	FILE NUMBER:
FILE NAME: 22' x 34'	

El Paso County Sheriff's Department  
**Falcon Substation**  
12072 Royal County Down Rd, Falcon, Colorado 80831  
FLOOR PLAN - SECOND FLOOR

SHEET IDENTIFICATION  
**SDP-09**  
SHEET 9 OF 14