

2021/07/01 3:07 PM By: Andrew Hood J:\JDS-Hydro\Project Files\151 Meridian Service Metropolitan District\151.48 Well Site 5-7-8 Drawings\Working\EP\151.48-1 Civil.dwg

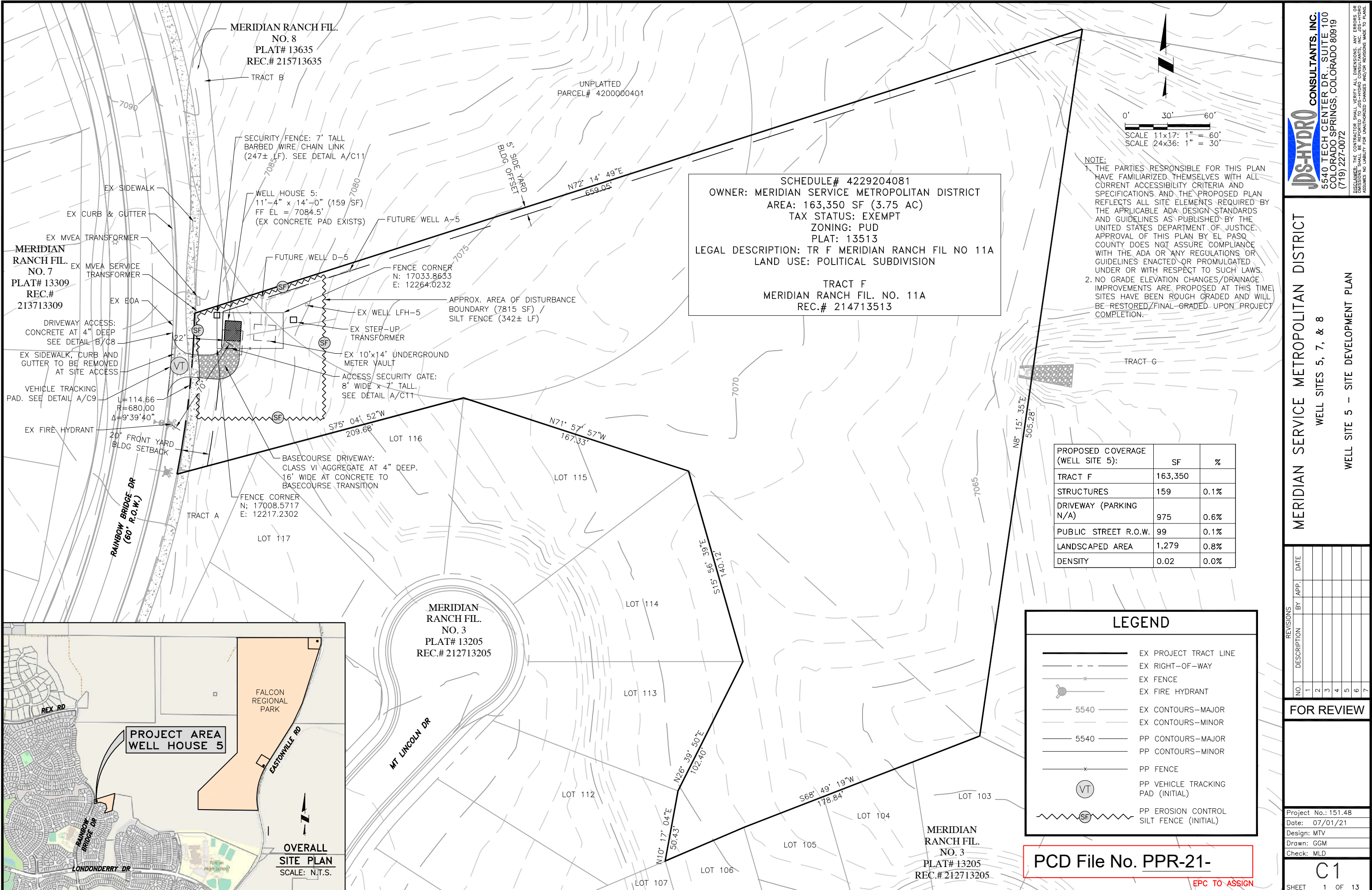

**NOTE:**

- THE PARTIES RESPONSIBLE FOR THIS PLAN HAVE FAMILIARIZED THEMSELVES WITH ALL CURRENT ACCESSIBILITY CRITERIA AND SPECIFICATIONS AND THE PROPOSED PLAN REFLECTS ALL SITE ELEMENTS REQUIRED BY THE APPLICABLE ADA DESIGN STANDARDS AND GUIDELINES AS PUBLISHED BY THE UNITED STATES DEPARTMENT OF JUSTICE. APPROVAL OF THIS PLAN BY EL PASO COUNTY DOES NOT ASSURE COMPLIANCE WITH THE ADA OR ANY REGULATIONS OR GUIDELINES ENACTED OR PROMULGATED UNDER OR WITH RESPECT TO SUCH LAWS.
- NO GRADE ELEVATION CHANGES/DRAINAGE IMPROVEMENTS ARE PROPOSED AT THIS TIME. SITES HAVE BEEN ROUGH GRADED AND WILL BE RESTORED/FINAL GRADED UPON PROJECT COMPLETION.

**JDS-HYDRO CONSULTANTS, INC.**  
5540 TECH CENTER DR., SUITE 100  
COLORADO SPRINGS, COLORADO 80919  
(719) 227-0072

**Meridian Service Metropolitan District**  
WELL SITES 5, 7, & 8  
WELL SITE 5 – SITE DEVELOPMENT PLAN













NO.	DESCRIPTION	BY	APP.	DATE
1				
2				
3				
4				
5				
6				
7				

**FOR REVIEW**

Project No.: 151.48  
Date: 07/01/21  
Design: MTV  
Drawn: GGM  
Check: MLD

**C1**  
SHEET 1 OF 13

# LEGEND

	EX PROJECT WELL EASEMENT
	LINE
	EX RIGHT-OF-WAY
	EX FENCE
	EX FIRE HYDRANT
	EX CONTOURS—MAJOR
	EX CONTOURS—MINOR
	PP CONTOURS—MAJOR
	PP CONTOURS—MINOR
	PP FENCE
	PP VEHICLE TRACKING PAD (INITIAL)
	PP EROSION CONTROL SILT FENCE (INITIAL)

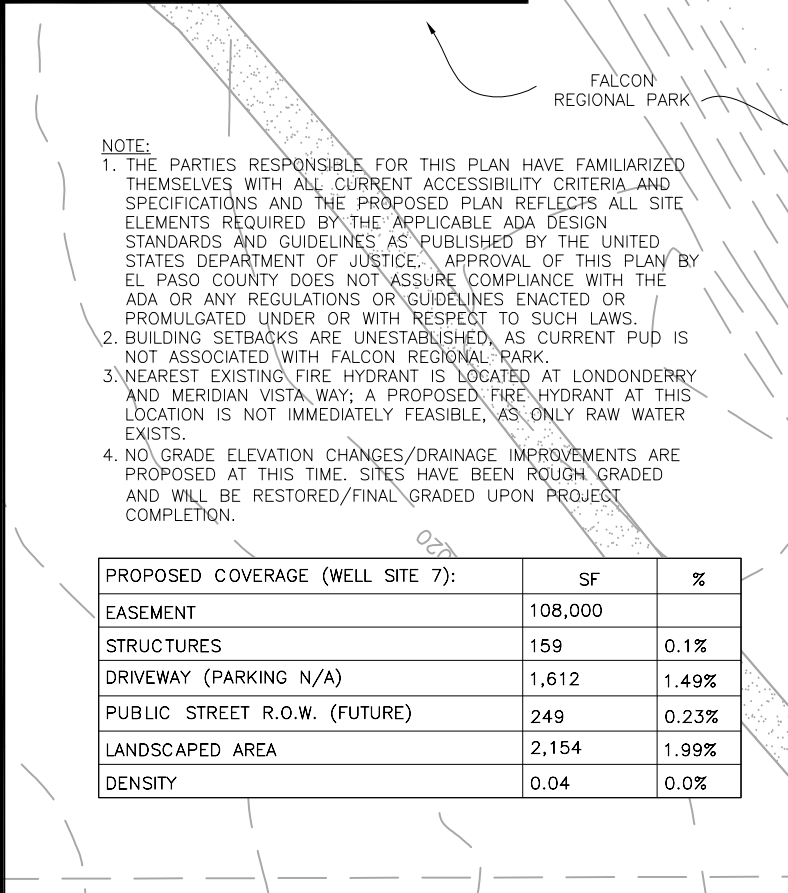

REX RD

RAINBOW BRIDGE DR

LONDONDERRY DR

FALCON REGIONAL PARK

EASTONVILLE RD

**SITE: EASEMENT WELL HOUSE 7**

**OVERALL SITE PLAN**

SCALE: N.T.S.



EPC TO ASSIGN



J:\jds-hydro\project Files\151 Meridian Service Metropolitan District\151.48 Well Site 5-7-8\Drawings\Working\EPC\15148\_3\_Civil.dwg 2021/07/01 3:07 PM By: Andrew Hood

## LEGEND

- EX PROJECT WELL EASEMENT LINE
- EX RIGHT-OF-WAY
- EX FENCE
- EX FIRE HYDRANT
- 5540 EX CONTOURS-MAJOR
- 5540 EX CONTOURS-MINOR
- 5540 PP CONTOURS-MAJOR
- 5540 PP CONTOURS-MINOR
- PP FENCE
- PP VEHICLE TRACKING PAD (INITIAL)
- PP EROSION CONTROL SILT FENCE (INITIAL)

### NOTE:

- THE PARTIES RESPONSIBLE FOR THIS PLAN HAVE FAMILIARIZED THEMSELVES WITH ALL CURRENT ACCESSIBILITY CRITERIA AND SPECIFICATIONS AND THE PROPOSED PLAN REFLECTS ALL SITE ELEMENTS REQUIRED BY THE APPLICABLE ADA DESIGN STANDARDS AND GUIDELINES AS PUBLISHED BY THE UNITED STATES DEPARTMENT OF JUSTICE. APPROVAL OF THIS PLAN BY EL PASO COUNTY DOES NOT ASSURE COMPLIANCE WITH THE ADA OR ANY REGULATIONS OR GUIDELINES ENACTED OR PROMULGATED UNDER OR WITH RESPECT TO SUCH LAWS.
- BUILDING SETBACKS ARE UNESTABLISHED, AS CURRENT PUD IS NOT ASSOCIATED WITH FALCON REGIONAL PARK.
- NEAREST EXISTING FIRE HYDRANT IS LOCATED AT LONDONDERRY AND MERIDIAN VISTA WAY; A PROPOSED FIRE HYDRANT AT THIS LOCATION IS NOT IMMEDIATELY FEASIBLE, AS ONLY RAW WATER EXISTS.
- NO GRADE ELEVATION CHANGES/DRAINAGE IMPROVEMENTS ARE PROPOSED AT THIS TIME. SITES HAVE BEEN ROUGH GRADED AND WILL BE RESTORED/FINAL GRADED UPON PROJECT COMPLETION.

PROPOSED COVERAGE (WELL SITE 8):	SF	%
EASEMENT	131,554	
STRUCTURES	159	0.1%
DRIVEWAY (PARKING N/A)	2,795	2.12%
PUBLIC STREET R.O.W. (FUTURE)	771	0.59%
LANDSCAPED AREA	1,701	1.29%
DENSITY	0.04	0.0%

SITE: EASEMENT  
WELL HOUSE 8

FALCON  
REGIONAL  
PARK

OVERALL  
SITE PLAN  
SCALE: N.T.S.

ADJACENT PROPERTY  
SCH.# 4200000345  
OWNER: FALCON LATIGO LLC  
AREA: 9,004,723 SF  
(207 AC)  
ZONING: RR-2.5  
LAND USE: VACANT LAND > 100 AC

ADJACENT PROPERTY  
SCH.# 4200000304  
OWNER: JMK HOLDINGS LLC  
AREA: 35,580,679 SF  
(817 AC)  
ZONING: A-35 RR-2.5  
LAND USE: AG. GRAZING

SCHEDULE#: 4200000400  
OWNER: BOARD OF COUNTY COMMISSIONERS OF EL PASO COUNTY  
AREA: 9,732,611 (223 AC)  
TAX STATUS: EXEMPT  
ZONING: PUD  
PLAT: N/A  
LEGAL DESCRIPTION: SEE SUPPLEMENTAL DOCUMENTATION  
LAND USE: COUNTY

WELL SITE EASEMENT  
FALCON REGIONAL PARK  
AREA: 131,554 SF (3.0 AC)  
REC.#: 214086535

PCD File No. PPR-21-

EPC TO ASSIGN

JDS-HYDRO CONSULTANTS, INC.  
5540 TECH CENTER DR., SUITE 100  
COLORADO SPRINGS, COLORADO 80919  
(719) 227-0072

DISCLAIMER: THE CONTRACTOR SHALL VERIFY ALL DIMENSIONS. ANY ERRORS OR OMISSIONS SHALL BE REPORTED TO JDS-HYDRO CONSULTANTS, INC. JDS-HYDRO ASSUMES NO LIABILITY FOR UNAUTHORIZED CHANGES AND/OR REVISIONS MADE TO PLANS.

MERIDIAN SERVICE METROPOLITAN DISTRICT

WELL SITES 5, 7, & 8

WELL SITE 8 - SITE DEVELOPMENT PLAN

NO.	DESCRIPTION	BY	APP.	DATE
1				
2				
3				
4				
5				
6				
7				

FOR REVIEW

Project No.: 151.48  
Date: 07/01/21  
Design: MTV  
Drawn: GGM  
Check: MLD

C3

SHEET 3 OF 13

2021/07/01 3:08 PM By: Andrew Hood j:\jds-hydro\project Files\151 Meridian Service Metropolitan District\151.48 Well Site 5-7-8 Drawings\Working\EPC\151.48\_Civil\_Details.dwg

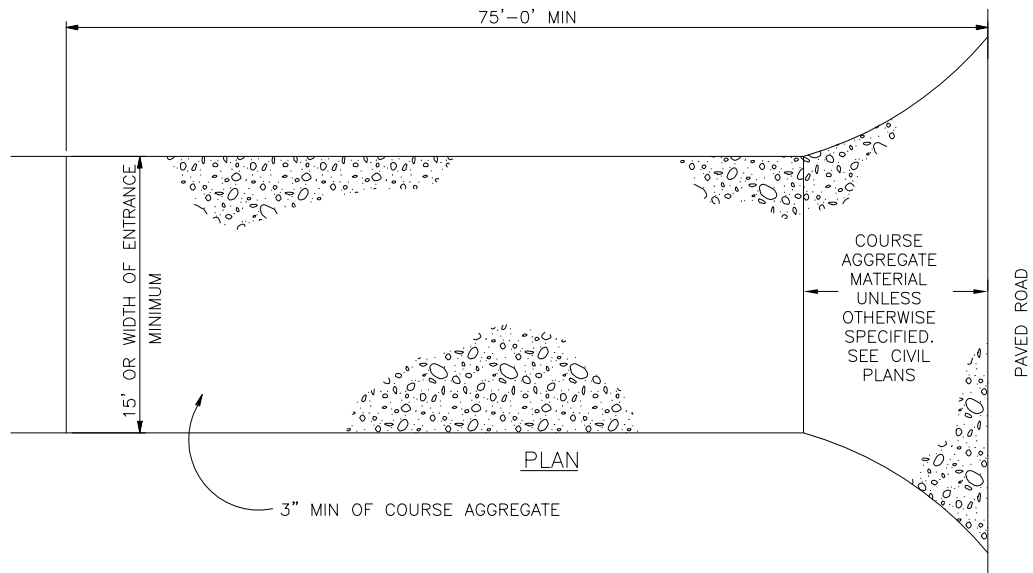

VEHICLE TRACKING PAD PLAN

INSTALLATION REQUIREMENTS:

1. ALL ENTRANCES TO THE CONSTRUCTION SITE ARE TO BE STABILIZED PRIOR TO COMMENCEMENT OF CONSTRUCTION.
2. CONSTRUCTION ENTRANCES ARE TO BE BUILT WITH AN APRON TO ALLOW FOR TURNING TRAFFIC, BUT SHOULD NOT BE BUILT OVER EXISTING PAVEMENT EXCEPT FOR A SLIGHT OVERLAP.
3. AREAS TO BE STABILIZED ARE TO BE PROPERLY GRADED AND COMPACTED.
4. CONSTRUCTION ROADS, PARKING AREAS, LOADING/UNLOADING ZONES, STORAGE AREAS, AND STAGING AREAS ARE TO BE STABILIZED.
5. CONSTRUCTION ROADS ARE TO BE BUILT TO CONFORM TO SITE GRADES, BUT SHOULD NOT HAVE SIDE SLOPES OR ROAD GRADES THAT ARE EXCESSIVELY STEEP.

MAINTENANCE REQUIREMENTS

1. REGULAR INSPECTIONS ARE TO BE MADE OF ALL STABILIZED AREAS, ESPECIALLY AFTER STORM EVENTS.
2. STONES ARE TO BE REAPPLIED PERIODICALLY AND WHEN REPAIR IS NECESSARY.
3. SEDIMENT TRACKED ONTO PAVED ROADS IS TO BE REMOVED DAILY BY SHOVELING OR SWEEPING. SEDIMENT IS NOT TO BE WASHED DOWN STORM SEWER DRAINS.
4. OTHER ASSOCIATED SEDIMENT CONTROL MEASURES ARE TO BE INSPECTED TO ENSURE GOOD WORKING CONDITION.
5. TO BE REMOVED JUST PRIOR TO FINAL SURFACING AND STABILIZATION.

**A**  
**C8** VEHICLE TRACKING PAD  
SCALE: N.T.S.

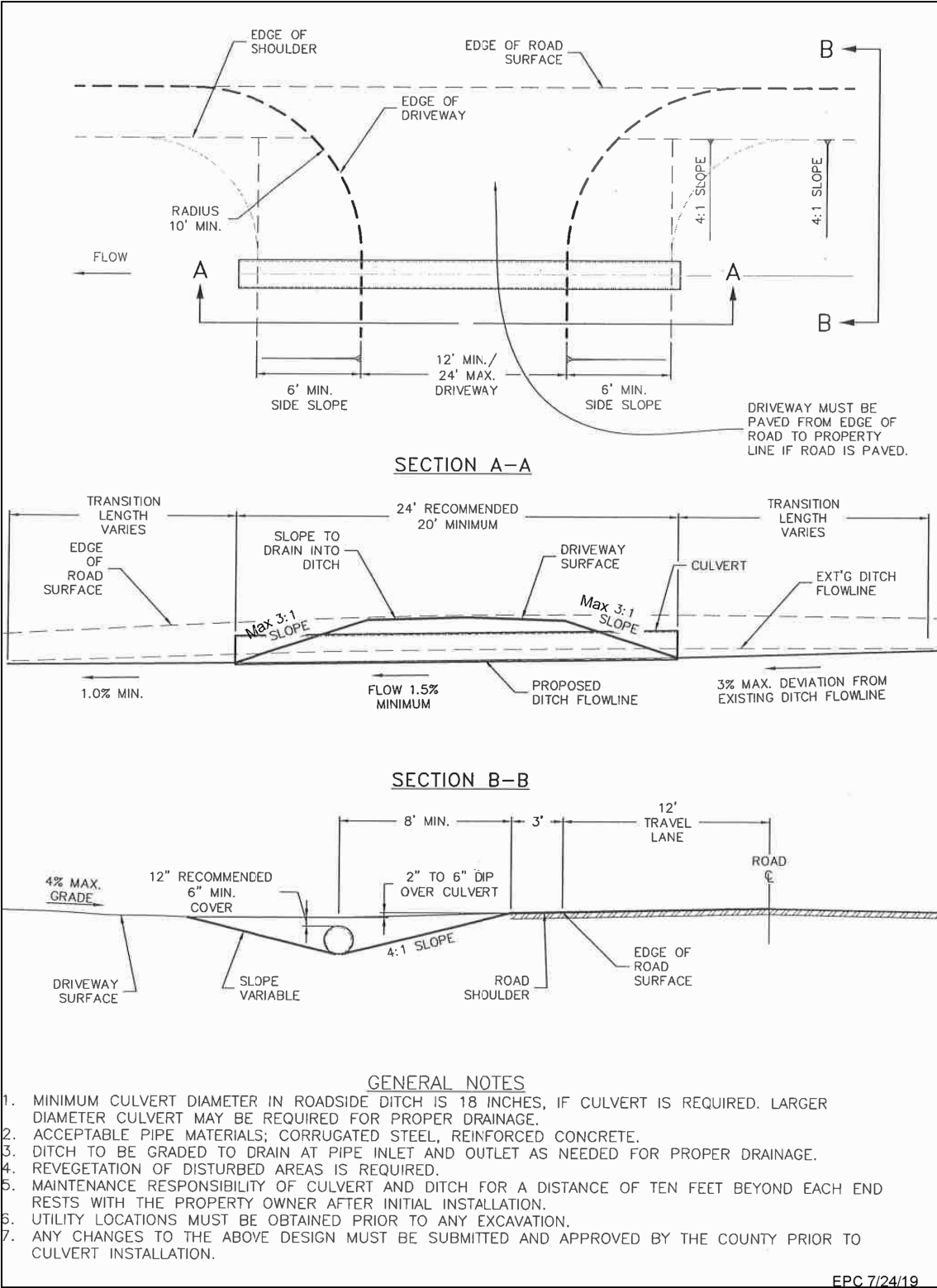

**B**  
**C8** DRIVEWAY DETAIL  
SCALE: N.T.S.

PCD File No. PPR-21-

EPC TO ASSIGN

NO.	DESCRIPTION	BY	APP.	DATE
1				
2				
3				
4				
5				
6				
7				

FOR REVIEW

Project No.: 151.48  
Date: 07/01/21  
Design: MTV  
Drawn: GGM  
Check: MLD



2021/07/01 3:08 PM By: Andrew Hood J:\jds-hydro\project\_Files\151 Meridian Service Metropolitan District\151.48 Well Site 5-7-8\Drawings\Working\EPC\15148\_Civil\_Details.dwg

EROSION CONTROL NOTES:

1. STORMWATER DISCHARGES FROM CONSTRUCTION SITES SHALL NOT CAUSE OR THREATEN TO CAUSE POLLUTION, CONTAMINATION, OR DEGRADATION OF STATE WATERS. ALL WORK AND EARTH DISTURBANCE SHALL BE DONE IN A MANNER THAT MINIMIZES POLLUTION OF ANY ON-SITE OR OFF-SITE WATERS, INCLUDING WETLANDS.
2. NOTWITHSTANDING ANYTHING DEPICTED IN THESE PLANS IN WORDS OR GRAPHIC REPRESENTATION, ALL DESIGN AND CONSTRUCTION RELATED TO ROADS, STORM DRAINAGE AND EROSION CONTROL SHALL CONFORM TO THE STANDARDS AND REQUIREMENTS OF THE MOST RECENT VERSION OF THE RELEVANT ADOPTED EL PASO COUNTY STANDARDS, INCLUDING THE LAND DEVELOPMENT CODE, THE ENGINEERING CRITERIA MANUAL, THE DRAINAGE CRITERIA MANUAL, AND THE DRAINAGE CRITERIA MANUAL VOLUME 2. ANY DEVIATIONS FROM REGULATIONS AND STANDARDS MUST BE REQUESTED, AND APPROVED, IN WRITING.
3. A SEPARATE STORMWATER MANAGEMENT PLAN (SWMP) FOR THIS PROJECT SHALL BE COMPLETED AND AN EROSION AND STORMWATER QUALITY CONTROL PERMIT (ESQCP) ISSUED PRIOR TO COMMENCING CONSTRUCTION. MANAGEMENT OF THE SWMP DURING CONSTRUCTION IS THE RESPONSIBILITY OF THE DESIGNATED QUALIFIED STORMWATER MANAGER OR CERTIFIED EROSION CONTROL INSPECTOR. THE SWMP SHALL BE LOCATED ON SITE AT ALL TIMES DURING CONSTRUCTION AND SHALL BE KEPT UP TO DATE WITH WORK PROGRESS AND CHANGES IN THE FIELD.
4. ONCE THE ESQCP IS APPROVED AND A "NOTICE TO PROCEED" HAS BEEN ISSUED, THE CONTRACTOR MAY INSTALL THE INITIAL STAGE EROSION AND SEDIMENT CONTROL MEASURES AS INDICATED ON THE APPROVED GEC. A PRECONSTRUCTION MEETING BETWEEN THE CONTRACTOR, ENGINEER, AND EL PASO COUNTY WILL BE HELD PRIOR TO ANY CONSTRUCTION. IT IS THE RESPONSIBILITY OF THE APPLICANT TO COORDINATE THE MEETING TIME AND PLACE WITH COUNTY STAFF.
5. CONTROL MEASURES MUST BE INSTALLED PRIOR TO COMMENCEMENT OF ACTIVITIES THAT COULD CONTRIBUTE POLLUTANTS TO STORMWATER. CONTROL MEASURES FOR ALL SLOPES, CHANNELS, DITCHES, AND DISTURBED LAND AREAS SHALL BE INSTALLED IMMEDIATELY UPON COMPLETION OF THE DISTURBANCE.
6. ALL TEMPORARY SEDIMENT AND EROSION CONTROL MEASURES SHALL BE MAINTAINED AND REMAIN IN EFFECTIVE OPERATING CONDITION UNTIL PERMANENT SOIL EROSION CONTROL MEASURES ARE IMPLEMENTED AND FINAL STABILIZATION IS ESTABLISHED. ALL PERSONS ENGAGED IN LAND DISTURBANCE ACTIVITIES SHALL ASSESS THE ADEQUACY OF CONTROL MEASURES AT THE SITE AND IDENTIFY IF CHANGES TO THOSE CONTROL MEASURES ARE NEEDED TO ENSURE THE CONTINUED EFFECTIVE PERFORMANCE OF THE CONTROL MEASURES. ALL CHANGES TO TEMPORARY SEDIMENT AND EROSION CONTROL MEASURES MUST BE INCORPORATED INTO THE STORMWATER MANAGEMENT PLAN.
7. TEMPORARY STABILIZATION SHALL BE IMPLEMENTED ON DISTURBED AREAS AND STOCKPILES WHERE GROUND DISTURBING CONSTRUCTION ACTIVITY HAS PERMANENTLY CEASED OR TEMPORARILY CEASED FOR LONGER THAN 14 DAYS.
8. FINAL STABILIZATION MUST BE IMPLEMENTED AT ALL APPLICABLE CONSTRUCTION SITES. FINAL STABILIZATION IS ACHIEVED WHEN ALL GROUND DISTURBING ACTIVITIES ARE COMPLETE AND ALL DISTURBED AREAS EITHER HAVE A UNIFORM VEGETATIVE COVER WITH INDIVIDUAL PLANT DENSITY OF 70 PERCENT OF PRE-DISTURBANCE LEVELS ESTABLISHED OR EQUIVALENT PERMANENT ALTERNATIVE STABILIZATION METHOD IS IMPLEMENTED. ALL TEMPORARY SEDIMENT AND EROSION CONTROL MEASURES SHALL BE REMOVED UPON FINAL STABILIZATION AND BEFORE PERMIT CLOSURE.
9. ALL PERMANENT STORMWATER MANAGEMENT FACILITIES SHALL BE INSTALLED AS DESIGNED IN THE APPROVED PLANS. ANY PROPOSED CHANGES THAT EFFECT THE DESIGN OR FUNCTION OF PERMANENT STORMWATER MANAGEMENT STRUCTURES MUST BE APPROVED BY THE ECM ADMINISTRATOR PRIOR TO IMPLEMENTATION.
10. EARTH DISTURBANCES SHALL BE CONDUCTED IN SUCH A MANNER SO AS TO EFFECTIVELY MINIMIZE ACCELERATED SOIL EROSION AND RESULTING SEDIMENTATION. ALL DISTURBANCES SHALL BE DESIGNED, CONSTRUCTED, AND COMPLETED SO THAT THE EXPOSED AREA OF ANY DISTURBED LAND SHALL BE LIMITED TO THE SHORTEST PRACTICAL PERIOD OF TIME. PRE-EXISTING VEGETATION SHALL BE PROTECTED AND MAINTAINED WITHIN 50 HORIZONTAL FEET OF A WATERS OF THE STATE UNLESS SHOWN TO BE INFEASIBLE AND SPECIFICALLY REQUESTED AND APPROVED.
11. COMPACTION OF SOIL MUST BE PREVENTED IN AREAS DESIGNATED FOR INFILTRATION CONTROL MEASURES OR WHERE FINAL STABILIZATION WILL BE ACHIEVED BY VEGETATIVE COVER. AREAS DESIGNATED FOR INFILTRATION CONTROL MEASURES SHALL ALSO BE PROTECTED FROM SEDIMENTATION DURING CONSTRUCTION UNTIL FINAL STABILIZATION IS ACHIEVED. IF COMPACTION PREVENTION IS NOT FEASIBLE DUE TO SITE CONSTRAINTS, ALL AREAS DESIGNATED FOR INFILTRATION AND VEGETATION CONTROL MEASURES MUST BE LOOSENEED PRIOR TO INSTALLATION OF THE CONTROL MEASURE(S).
12. ANY TEMPORARY OR PERMANENT FACILITY DESIGNED AND CONSTRUCTED FOR THE CONVEYANCE OF STORMWATER AROUND, THROUGH, OR FROM THE EARTH DISTURBANCE AREA SHALL BE A STABILIZED CONVEYANCE DESIGNED TO MINIMIZE EROSION AND THE DISCHARGE OF SEDIMENT OFF SITE.
13. CONCRETE WASH WATER SHALL BE CONTAINED AND DISPOSED OF IN ACCORDANCE WITH THE SWMP. NO WASH WATER SHALL BE DISCHARGED TO OR ALLOWED TO ENTER STATE WATERS, INCLUDING ANY SURFACE OR SUBSURFACE STORM DRAINAGE SYSTEM OR FACILITIES. CONCRETE WASHOUTS SHALL NOT BE LOCATED IN AN AREA WHERE SHALLOW GROUNDWATER MAY BE PRESENT, OR WITHIN 50 FEET OF A SURFACE WATER BODY, CREEK OR STREAM.
14. DURING DEWATERING OPERATIONS OF UNCONTAMINATED GROUND WATER MAY BE DISCHARGED ON SITE, BUT SHALL NOT LEAVE THE SITE IN THE FORM OF SURFACE RUNOFF UNLESS AN APPROVED STATE DEWATERING PERMIT IS IN PLACE.
15. EROSION CONTROL BLANKETING OR OTHER PROTECTIVE COVERING SHALL BE USED ON SLOPES STEEPER THAN 3:1.
16. CONTRACTOR SHALL BE RESPONSIBLE FOR THE REMOVAL OF ALL WASTES FROM THE CONSTRUCTION SITE FOR DISPOSAL IN ACCORDANCE WITH LOCAL AND STATE REGULATORY REQUIREMENTS. NO CONSTRUCTION DEBRIS, TREE SLASH, BUILDING MATERIAL WASTES OR UNUSED BUILDING MATERIALS SHALL BE BURIED, DUMPED, OR DISCHARGED AT THE SITE.
17. WASTE MATERIALS SHALL NOT BE TEMPORARILY PLACED OR STORED IN THE STREET, ALLEY, OR OTHER PUBLIC WAY, UNLESS IN ACCORDANCE WITH AN APPROVED TRAFFIC CONTROL PLAN. CONTROL MEASURES MAY BE REQUIRED BY EL PASO COUNTY ENGINEERING IF DEEMED NECESSARY, BASED ON SPECIFIC CONDITIONS AND CIRCUMSTANCES.
18. TRACKING OF SOILS AND CONSTRUCTION DEBRIS OFF-SITE SHALL BE MINIMIZED. MATERIALS TRACKED OFF-SITE SHALL BE CLEANED UP AND PROPERLY DISPOSED OF IMMEDIATELY.
19. THE OWNER/DEVELOPER SHALL BE RESPONSIBLE FOR THE REMOVAL OF ALL CONSTRUCTION DEBRIS, DIRT, TRASH, ROCK, SEDIMENT, SOIL, AND SAND THAT MAY ACCUMULATE IN ROADS, STORM DRAINS AND OTHER DRAINAGE CONVEYANCE SYSTEMS AND STORMWATER APPURTENANCES AS A RESULT OF SITE DEVELOPMENT.
20. THE QUANTITY OF MATERIALS STORED ON THE PROJECT SITE SHALL BE LIMITED, AS MUCH AS PRACTICAL, TO THAT QUANTITY REQUIRED TO PERFORM THE WORK IN AN ORDERLY SEQUENCE. ALL MATERIALS STORED ON-SITE SHALL BE STORED IN A NEAT, ORDERLY MANNER, IN THEIR ORIGINAL CONTAINERS, WITH ORIGINAL MANUFACTURER'S LABELS.
21. NO CHEMICAL(S) HAVING THE POTENTIAL TO BE RELEASED IN STORMWATER ARE TO BE STORED OR USED ONSITE UNLESS PERMISSION FOR THE USE OF SUCH CHEMICAL(S) IS GRANTED IN WRITING BY THE ECM ADMINISTRATOR. IN GRANTING APPROVAL FOR THE USE OF SUCH CHEMICAL(S), SPECIAL CONDITIONS AND MONITORING MAY BE REQUIRED.
22. BULK STORAGE OF ALLOWED PETROLEUM PRODUCTS OR OTHER ALLOWED LIQUID CHEMICALS IN EXCESS OF 55 GALLONS SHALL REQUIRE ADEQUATE SECONDARY CONTAINMENT PROTECTION TO CONTAIN ALL SPILLS ONSITE AND TO PREVENT ANY SPILLED MATERIALS FROM ENTERING STATE WATERS, ANY SURFACE OR SUBSURFACE STORM DRAINAGE SYSTEM OR OTHER FACILITIES.
23. NO PERSON SHALL CAUSE THE IMPEDIMENT OF STORMWATER FLOW IN THE CURB AND GUTTER OR DITCH EXCEPT WITH APPROVED SEDIMENT CONTROL MEASURES.
24. OWNER/DEVELOPER AND THEIR AGENTS SHALL COMPLY WITH THE "COLORADO WATER QUALITY CONTROL ACT" (TITLE 25, ARTICLE 8, CRS), AND THE "CLEAN WATER ACT" (33 USC 1344), IN ADDITION TO THE REQUIREMENTS OF THE LAND DEVELOPMENT CODE, DCM VOLUME II AND THE ECM APPENDIX I. ALL APPROPRIATE PERMITS MUST BE OBTAINED BY THE CONTRACTOR PRIOR TO CONSTRUCTION (1041, NPDES, FLOODPLAIN, 404, FUGITIVE DUST, ETC.). IN THE EVENT OF CONFLICTS BETWEEN THESE REQUIREMENTS AND OTHER LAWS, RULES, OR REGULATIONS OF OTHER FEDERAL, STATE, LOCAL, OR COUNTY AGENCIES, THE MOST RESTRICTIVE LAWS, RULES, OR REGULATIONS SHALL APPLY.

25. ALL CONSTRUCTION TRAFFIC MUST ENTER/EXIT THE SITE ONLY AT APPROVED CONSTRUCTION ACCESS POINTS.
26. PRIOR TO CONSTRUCTION THE PERMITTEE SHALL VERIFY THE LOCATION OF EXISTING UTILITIES.
27. A WATER SOURCE SHALL BE AVAILABLE ON SITE DURING EARTHWORK OPERATIONS AND SHALL BE UTILIZED AS REQUIRED TO MINIMIZE DUST FROM EARTHWORK EQUIPMENT AND WIND.
28. THE SOILS REPORT FOR THIS SITE WAS PREPARED BY VIVID ENGINEERING GROUP (DATED 11/06/2020) AND SHALL BE CONSIDERED A PART OF THESE PLANS.
29. AT LEAST TEN (10) DAYS PRIOR TO THE ANTICIPATED START OF CONSTRUCTION, FOR PROJECTS THAT WILL DISTURB ONE (1) ACRE OR MORE, THE OWNER OR OPERATOR OF CONSTRUCTION ACTIVITY SHALL SUBMIT A PERMIT APPLICATION FOR STORMWATER DISCHARGE TO THE COLORADO DEPARTMENT OF PUBLIC HEALTH AND ENVIRONMENT, WATER QUALITY DIVISION. THE APPLICATION CONTAINS CERTIFICATION OF COMPLETION OF A STORMWATER MANAGEMENT PLAN (SWMP), OF WHICH THIS GRADING AND EROSION CONTROL PLAN MAY BE A PART. FOR INFORMATION OR APPLICATION MATERIALS CONTACT:

COLORADO DEPARTMENT OF PUBLIC HEALTH AND ENVIRONMENT  
WATER QUALITY CONTROL DIVISION  
WQCD – PERMITS  
4300 CHERRY CREEK DRIVE SOUTH  
DENVER, CO 80246–1530  
ATTN: PERMITS UNIT

TIMING, CONSTRUCTION STAGING AND SEQUENCING:

EXPECTED START DATE: JULY 2020  
INSTALL TEMPORARY EROSION CONTROL – 2 DAYS  
– PERIMETER SILT FENCING  
– VEHICLE TRACKING CONTROL PAD

INSTALL FINAL SITE IMPROVEMENTS – 6 MONTHS  
REMOVE TEMPORARY EROSION CONTROL – 5 DAYS

MINIMUM BEST MANAGEMENT PRACTICES ELEMENTS:

- STEP 1– EROSION AND SEDIMENT CONTROL  
INSTALL SEDIMENT TRAPPING DEVICES (PERIMETER CONTROLS) PRIOR TO THE START OF CONSTRUCTION.
- STEP 2– SPILL PREVENTION AND RESPONSE
- STEP 3– MATERIAL MANAGEMENT  
MATERIAL AND EQUIPMENT STORAGE AREAS SHALL BE SECURE AND CONTAINED TO PREVENT DISCHARGE OF ANY MATERIAL IN RUNOFF. WASTE SHALL BE CONTAINED AND DISPOSED OF PROPERLY. MAINTAIN BMP’S DURING BUILDING AND UTILITY CONSTRUCTION.
- STEP 4– INSPECTION AND MAINTENANCE  
(SEE EROSION CONTROL NOTES)
- STEP 5– INSTALL FINAL STABILIZATION – BASE COURSE, LANDSCAPING, EROSION CONTROL BLANKETS, AND SEEDING.
- STEP 6– REMOVE TEMPORARY CONTROLS – SILT FENCING AFTER PERMANENT FEATURES ARE INSTALLED.

FINAL STABILIZATION AND LONG-TERM STORMWATER MANAGEMENT:

FINAL STABILIZATION MEASURES INCLUDE BASE COURSE, PARTIAL LANDSCAPE, AND REVEGETATION

EARTHWORK SUMMARY:

PROPOSED EACH WELL SITE:  
CUT – <10 CY  
FILL – <10 CY  
NET – 0 CY CUT/FILL

DISTURBED AREA  
WELL SITE 5 – 0.18 ACRES  
WELL SITE 7 – 1.05 ACRES  
WELL SITE 8 – 0.42 ACRES

EROSION CONTROL FACILITIES:

SILT FENCE (SF)  
WELL SITE 5 – 342 LF  
WELL SITE 7 – 891 LF  
WELL SITE 8 – 539 LF  
VEHICLE TRACKING PAD (VT) – 1 EACH SITE  
CONCRETE WASHOUT – 1 EACH SITE

ALL AREAS DISTURBED BY EARTHWORK SHALL BE PERMANENTLY REVEGETATED WITH GRASS MIX. SEED MIX FOR THIS PROJECT SHALL BE AS FOLLOWS (SEE RIGHT):

TYPE: ALR FOOTHILLS MIX		
COMMON NAME (TYPE & VARIETY)		
	PURE (%)	ORIGIN
ANNUAL RYEGRASS	15.72	OR
SLENDER WHEATGRASS	11.80	WA
OATS	10.00	WY
PERENNIAL RYEGRASS	9.82	OR
CRESTED WHEATGRASS	8.73	SD
MOUNTAIN BROME	7.93	WY
HARD FESCUE	7.92	OR
CANADA BLUEGRASS	7.80	WA
SIDEOATS GRAMA	4.59	MN
SWITCHGRASS	3.99	MN
BIG BLUESTEM	3.23	MN
BLUE GRAMA	1.89	MN
SAND DROPSEED	0.80	CO
CROP: .32%, INERT: 5.32%, WEEDS (NON-NOXIOUS), .14%		
TOTAL	100.00	

PCD File No. PPR-21-

EPC TO ASSIGN

JDSD-HYDRO

CONSULTANTS, INC.

5640 TECH CENTER DR. SUITE 100  
COLORADO SPRINGS, COLORADO 80919  
(719) 227-0072

DISCLAIMER: THE CONTRACTOR SHALL VERIFY ALL DIMENSIONS. ANY ERRORS OR OMISSIONS SHALL BE REPORTED TO JDS-HYDRO CONSULTANTS, INC. JDS-HYDRO ASSUMES NO LIABILITY FOR UNAUTHORIZED CHANGES AND/OR REVISIONS MADE TO PLANS.

MERIDIAN SERVICE METROPOLITAN DISTRICT

WELL SITES 5, 7, & 8

EROSION CONTROL NOTES

NO.	REVISIONS		DATE	BY	APP.
	DESCRIPTION				
1					
2					
3					
4					
5					
6					
7					

FOR REVIEW

Project No.: 151.48  
Date: 07/01/21  
Design: MTV  
Drawn: GGM  
Check: MLD

2021/07/01 3:08 PM By: Andrew Hood j:\ds-hydro\project Files\151 Meridian Service Metropolitan District\151.48 Well Site 5-7-8\Drawings\Working\EPC\15148\_Civil\_Details.dwg

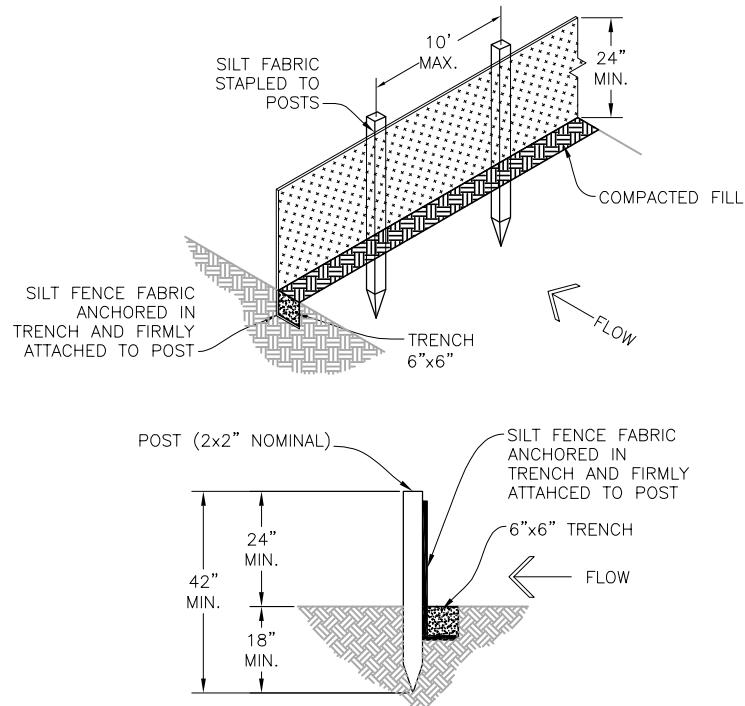

**SILT FENCE DETAIL**

**INSTALLATION REQUIREMENTS:**

1. SILT FENCES SHALL BE INSTALLED PRIOR TO ANY LAND DISTURBING ACTIVITIES.
2. WHEN JOINTS ARE NECESSARY, SILT FENCE GEOTEXTILE SHALL BE SPICED TOGETHER ONLY AT SUPPORT POST AND SECURELY SEALED.
3. METAL POSTS SHALL BE "STUDDED TEE" OR "U" TYPE WITH MINIMUM WEIGHT OF 1.33 POUNDS PER LINEAR FOOT. WOOD POSTS SHALL HAVE A MINIMUM DIAMETER OR CROSS SECTION DIMENSION OF 2 INCHES.
4. THE FILTER MATERIAL SHALL BE FASTENED SECURELY TO METAL POSTS USING WIRE TIES, OR TO WOOD POSTS WITH 3/4" LONG #9 HEAVY-DUTY STAPLES. THE SILT FENCE GEOTEXTILE SHALL NOT BE STAPLED TO EXISTING TREES.
5. WHILE NOT REQUIRED, WIRE MESH FENCE MAY BE USED TO SUPPORT THE GEOTEXTILE. WIRE FENCE SHALL BE FASTENED SECURELY TO THE UPSLOPE SIDE OF THE POSTS USING HEAVY-DUTY WIRE STAPLES AT LEAST 3/4" LONG, TIE WIRES OR HOG RINGS. THE WIRE SHALL EXTEND INTO THE TRENCH A MINIMUM OF 6 INCHES AND SHALL NOT EXTEND MORE THAN 3 FEET ABOVE THE ORIGINAL GROUND SURFACE.

6. ALONG THE TOE OF FILLS, INSTALL THE SILT FENCE ALONG A LEVEL CONTOUR AND PROVIDE AN AREA BEHIND THE FENCE FOR RUNOFF TO POND AND SEDIMENT TO SETTLE. A MINIMUM DISTANCE OF 5 FEET FROM THE TOE OF THE FILL IS RECOMMENDED.
7. THE HEIGHT OF THE SILT FENCE FROM THE GROUND SURFACE SHALL BE MINIMUM OF 24 INCHES AND SHALL NOT EXCEED 36 INCHES. HIGHER FENCES MAY IMPOUND VOLUMES OF WATER SUFFICIENT TO CAUSE FAILURE OF THE STRUCTURE.

**MAINTENANCE REQUIREMENTS:**

1. CONTRACTOR SHALL INSPECT SILT FENCES IMMEDIATELY AFTER EACH RAINFALL, AT LEAST DAILY DURING PROLONGED RAINFALL, AND WEEKLY DURING PERIODS OF NO RAINFALL. DAMAGED, COLLAPSED, UNENTRENCHED OR INEFFECTIVE SILT FENCES SHALL BE PROMPTLY REPAIRED OR REPLACED.
2. SEDIMENT SHALL BE REMOVED FROM BEHIND SILT FENCE WHEN IT ACCUMULATES TO HALF THE EXPOSED GEOTEXTILE HEIGHT.
3. SILT FENCES SHALL BE REMOVED WHEN ADEQUATE VEGETATIVE COVER IS ATTAINED.

**A**  
**C10** **SILT FENCE**  
SCALE: N.T.S.

**TOP VIEW**

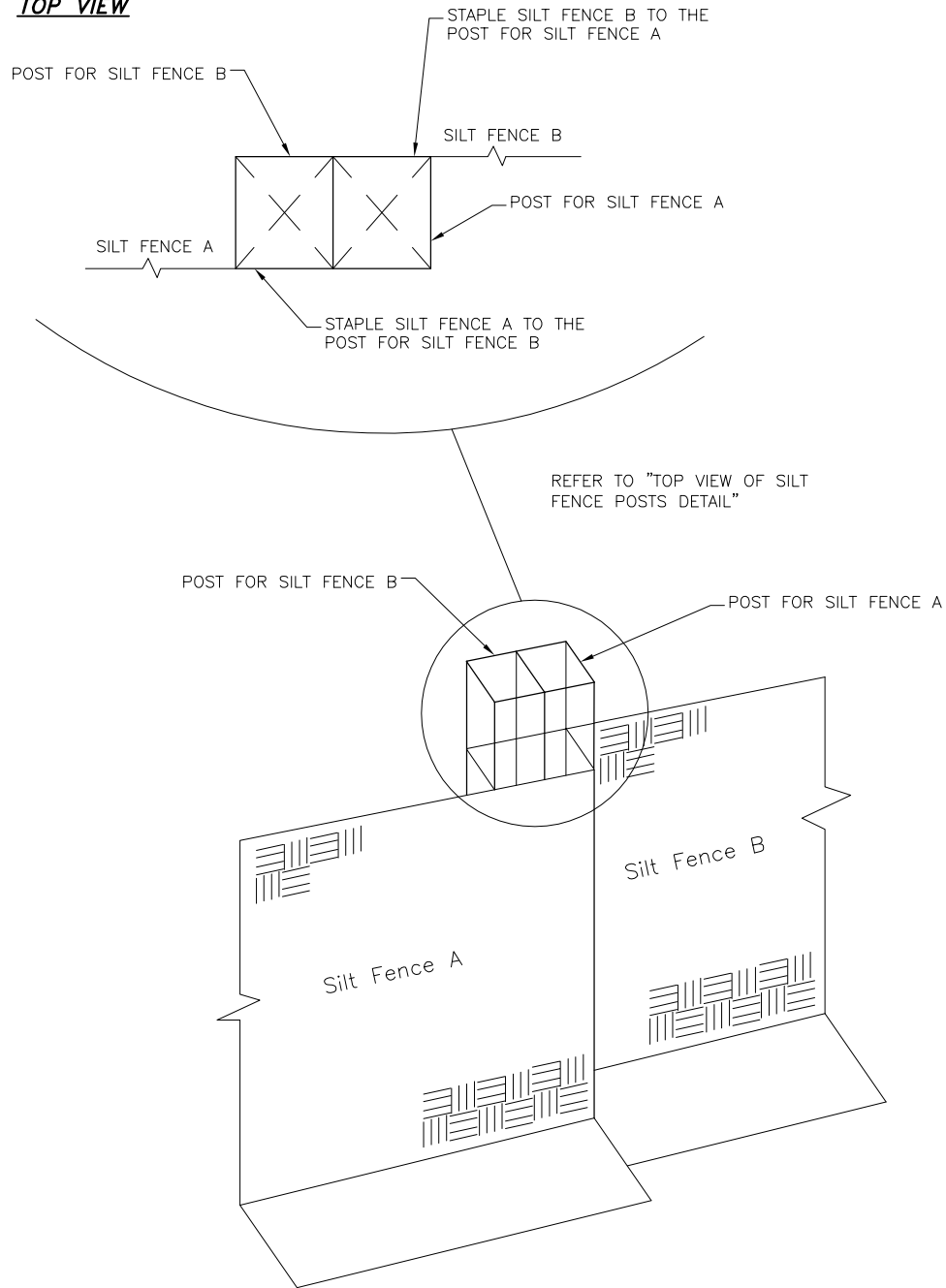

**B**  
**C10** **SILT FENCE POSTS**  
SCALE: N.T.S.

PCD File No. PPR-21-

EPC TO ASSIGN

REVISIONS		DESCRIPTION	BY	APP.	DATE
NO.					
1					
2					
3					
4					
5					
6					
7					

FOR REVIEW

Project No.: 151.48  
Date: 07/01/21  
Design: ----  
Drawn: ----  
Check: MLD

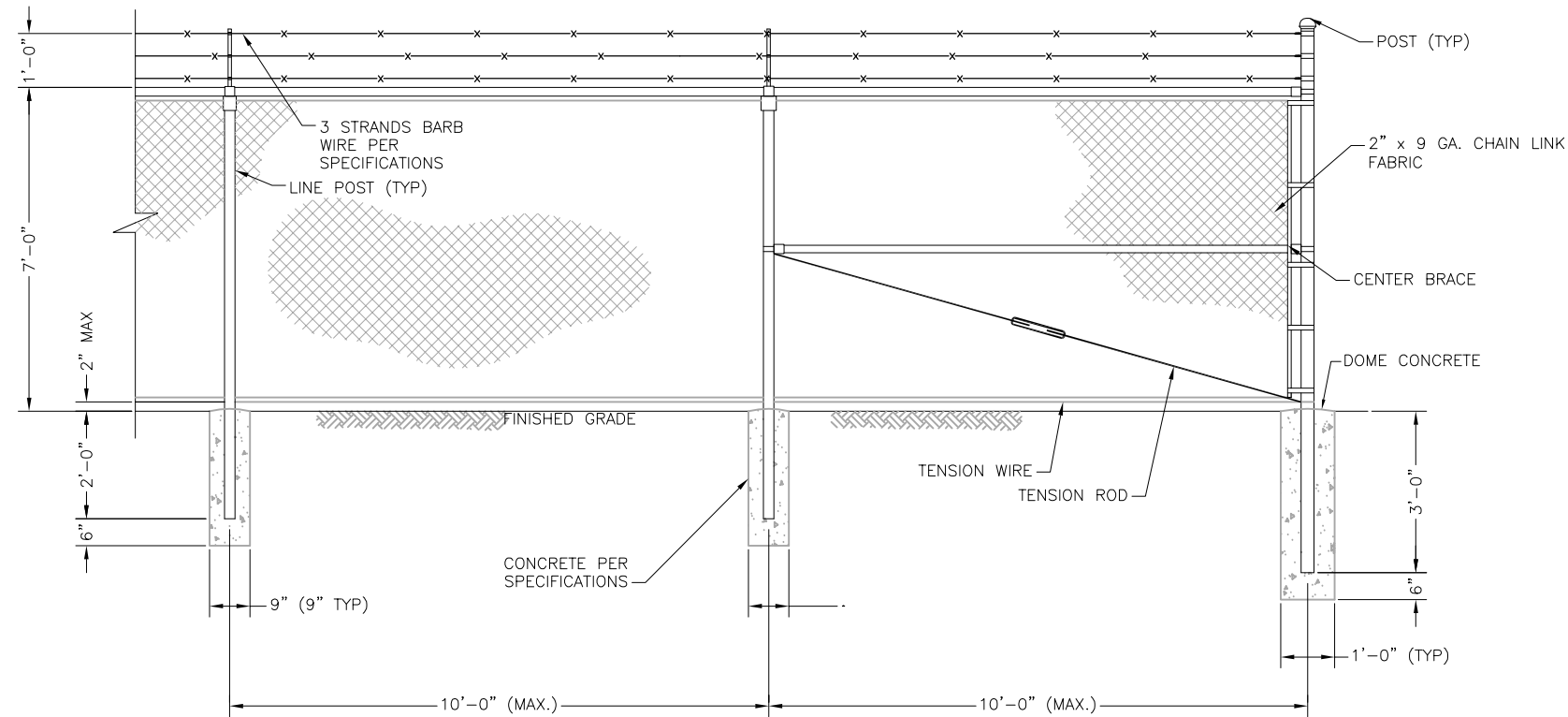

### ELEVATION WITH CORNER POST

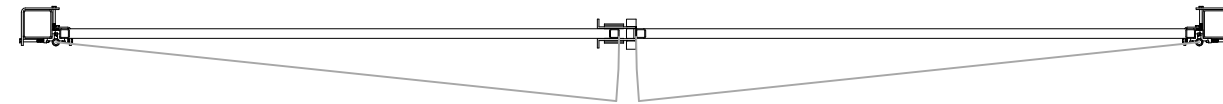

DOUBLE SWING GATE PLAN

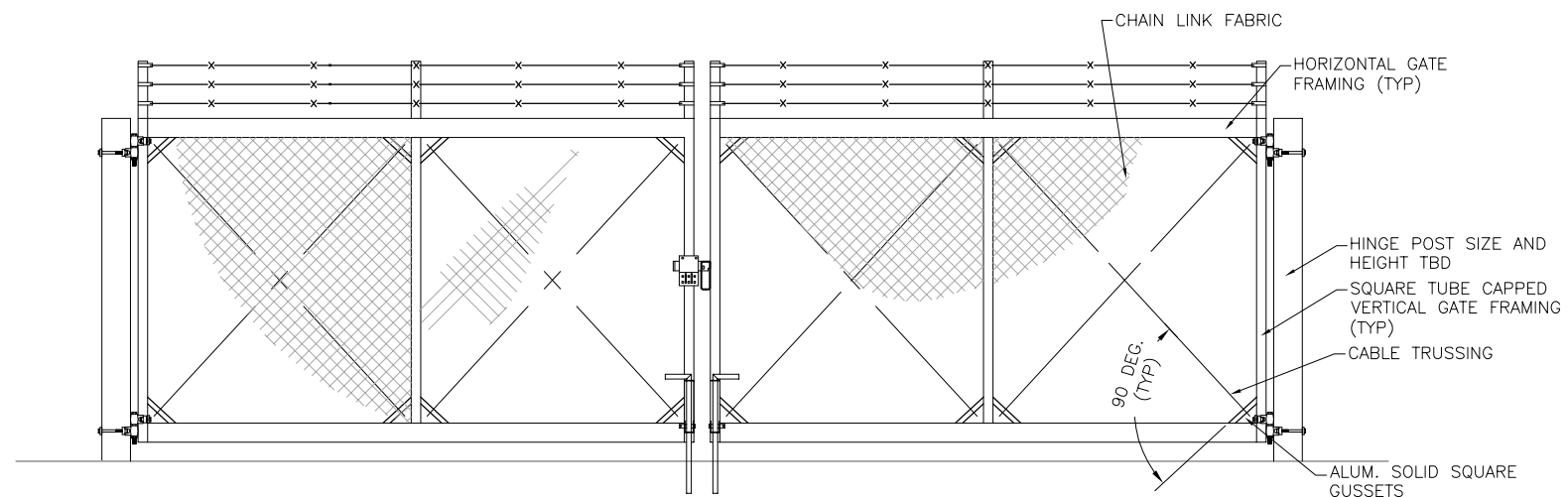

8' WIDE DOUBLE SWING GATE ELEVATION

FENCING NOTES:

1. CHAIN LINK FENCE SHALL CONFORM TO THE REQUIREMENTS OF AASHTO M 181.
2. CHAIN LINK FABRIC SHALL BE 2" MESH NO. 9 GAGE GALVANIZED OR ALUMINUM COATED WIRE SECURELY FASTENED TO TENSION WIRE, LINE POSTS, RAILS, BRACES AND STRETCHER BARS SPACED AS SHOWN HEREON. WIRE FASTENERS AND TIE CLIPS SHALL BE NO. 11 GAGE (W&M) GALVANIZED STEEL WIRE OR NO. 7 GAGE (B&S) ALUMINUM WIRE, AND HOG RINGS SHALL BE NO. 9 GAGE, ALL IN CONFORMANCE WITH ASTM F 626.
3. STEEL POSTS, RAILS AND GATE FRAMES SHALL CONFORM TO AASHTO M 181 TYPE 1, GRADE 1 OR GRADE 2.
4. TENSION WIRE SHALL BE CONTINUOUS BETWEEN END OR CORNER POST AND LINE BRACE POST. A TURNBUCKLE OR OTHER APPROVED TIGHTENING DEVICE SHALL BE USED FOR EACH CONTINUOUS SPAN OF TENSION WIRE.
5. TENSION WIRE SHALL BE AS SPECIFIED IN AASHTO M 181.
6. CONCRETE FOOTINGS SHALL HAVE TOPS CROWNED AT GROUND LEVEL AND SHALL BE CLASS A, AX, OR B.
7. CHAIN LINK FABRIC OVER 5 FEET HIGH SHALL BE TWISTED AND BARBED ON THE TOP SELVAGE AND KNUCKLED ON THE BOTTOM SELVAGE.
8. ATTACH FABRIC TO ALL FENCE & GATE STRUCTURES AT 12" INTERVALS VERTICALLY & AT 20" HORIZONTALLY.
9. MATCH EXISTING SITE BARB WIRE 45° ARM SUPPORTS.
10. DETAILS ARE FOR REFERENCE ONLY – CONTRACTOR TO SUBMIT FENCE DETAILS.
11. DISTRICT IDENTIFICATION SIGNAGE TO BE INSTALLED ON FENCE PER PLANS. KNOXBOX INSTALLED ON GATE FOR FIRE DEPARTMENT ACCESS.

NO.	DESCRIPTION	BY	APP.	DATE
1				
2				
3				
4				
5				
6				
7				

FOR REVIEW

Project No.: 151.48
Date: 07/01/21
Design: GGM
Drawn: GGM
Check: MLD