



William Gaman & Associates, Ltd.

Bill Guman, PLA, ASLA, APA | Principal

Colorado Springs City Councilman 1993-2001
Colorado Springs City Planning Commissioner 1992-1993
Pikes Peak Regional Building Commissioner 1997-2001

URBAN PLANNING | COMMUNITY DESIGN | LANDSCAPE ARCHITECTURE

ENTITLEMENT COORDINATION | CONTRACT ADMINISTRATION

731 North Weber Street, Suite 10 | Colorado Springs, CO 80903 | (719) 633-9700

Licensed Landscape Architects (PLA) American Society of Landscape Architects (ASLA) American Planning Association (APA)



Wastewater – Central Services may be developed in conjunction with annexation into the **BOCES Metropolitan District**, which is being planned for adjacent to the *Esteban Rodriguez Subdivision* site. See accompanying Vicinity Map.

For this Sketch Plan submittal, a Wastewater Disposal Report is being submitted which supports development of on-site septic for the 144 residential lots to be developed at the *Esteban Rodriguez Subdivision*.

BOCES METROPOLITAN DISTRICT STUDY AREA

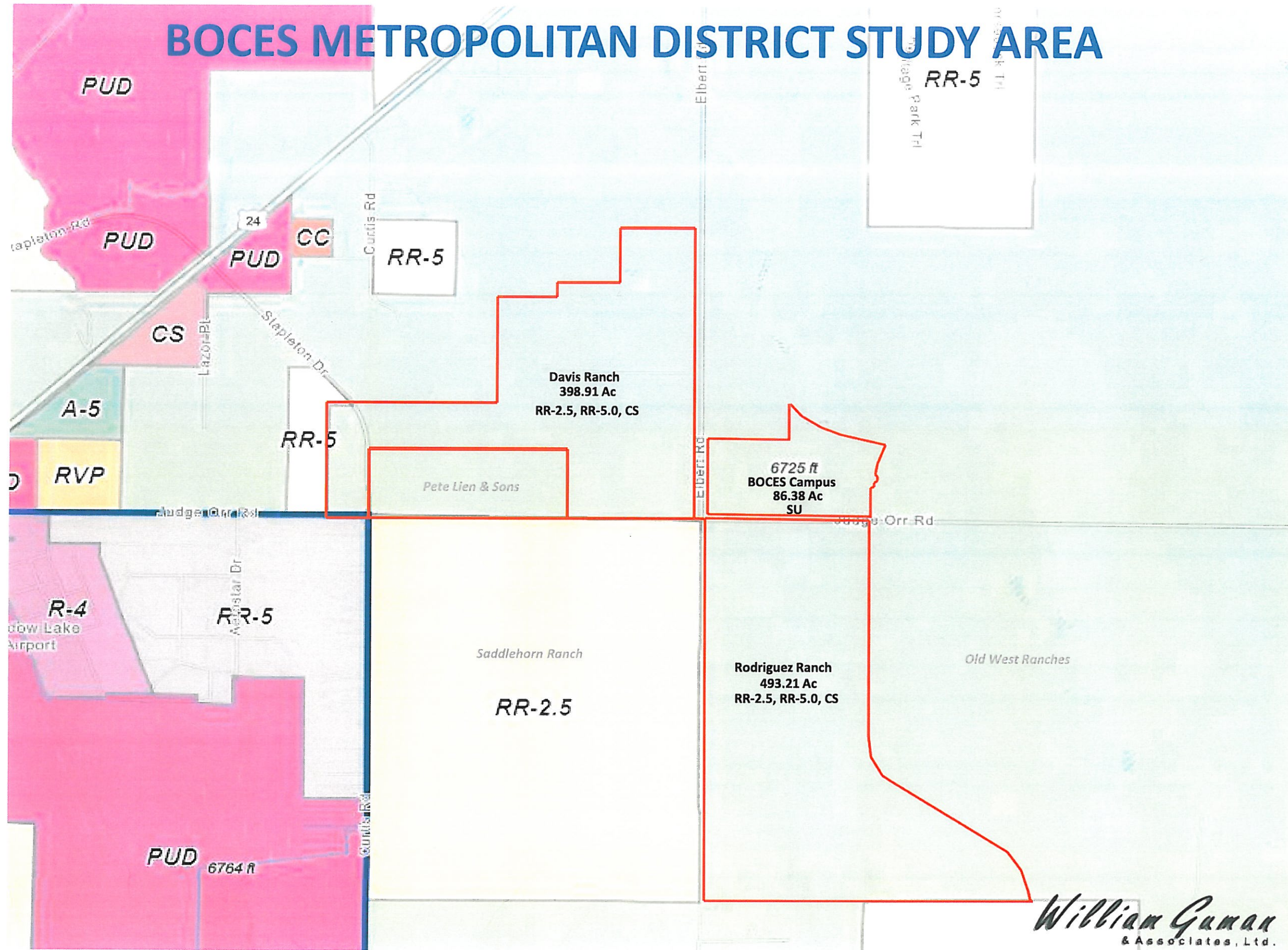

William Gunn
& Associates, Ltd.