

AREA MAP

SCALE: 1" = 1000'

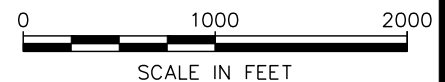

SW1/4 OF SEC. 17
T15S, R65W, 6TH P.M.
COUNTY OF EL PASO
COLORADO

PROPOSED TELECOMMUNICATION
FACILITY BY HORIZON TOWER

NOTES:

1. THE BASIS OF THE MERIDIANS AND COORDINATES FOR THIS PLAT IS THE COLORADO STATE PLANE COORDINATE SYSTEM, NORTH AMERICAN DATUM 1983 (NAD83).
2. VERTICAL INFORMATION SHOWN, BASED ON THE NORTH AMERICAN VERTICAL DATUM OF 1988 (NAVD 88).
3. ALL DISTANCES ARE GROUND UNLESS OTHERWISE NOTED.
4. THE TOWER IS LOCATED IN AN AREA DESIGNATED AS ZONE X, AREAS OF MINIMUM FLOOD HAZARD (FEMA MAP # 08041C0952F).

1-A COORDINATES

LATITUDE: 38° 44' 27.29" N (NAD83)
LONGITUDE: 104° 41' 36.69" W (NAD83)
GROUND ELEVATION: 5,886' (NAVD88)

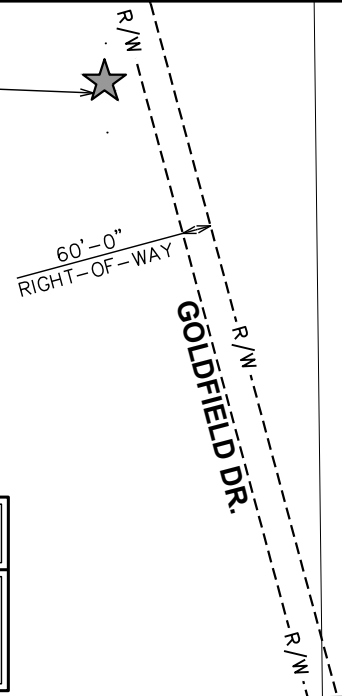

SITE PLAN

SCALE: 1" = 500'

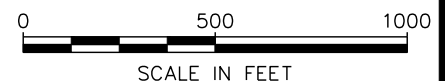

PREPARED BY:

TOWER ENGINEERING PROFESSIONALS
500 E. 84TH AVE, SUITE C10
THORNTON, CO 80229
(303) 566-9914
www.tepgroup.net

PREPARED FOR:

HORIZON TOWER, LLC

PROJECT INFORMATION:

**FOUNTAIN VALLEY
CO4714**

FONTAINE BLVD &
GOLDFIELD DR.
COLORADO SPRINGS, CO 80911
(EL PASO COUNTY)

REVISION: 0

TEP JOB #: 66886

SHEET NUMBER:

MAP#1