

5819 PALMER PARK BLVD.
COLORADO SPRINGS, COLORADO 80915

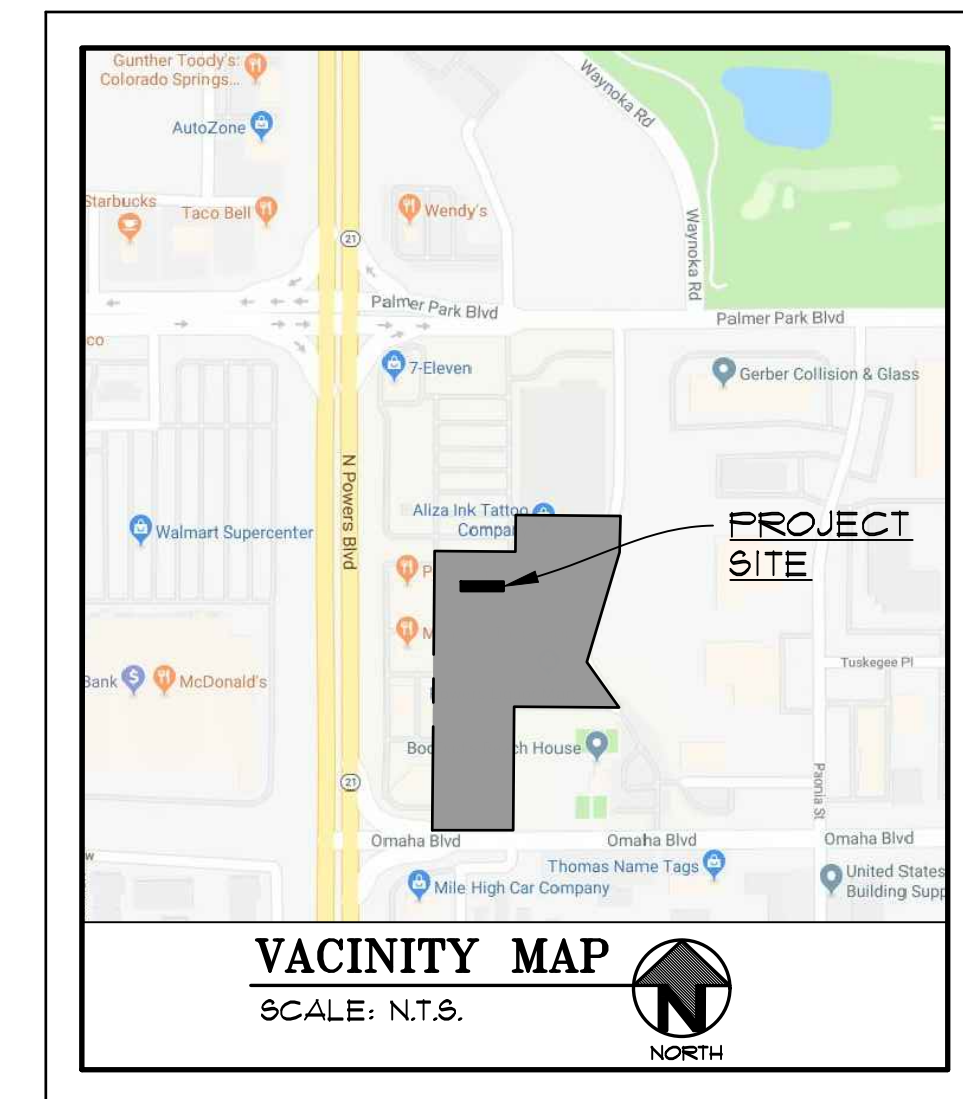

LOT 1 POWERS CENTRE FIL NO 3

Lot 1: Front - 50' from lot line
Side - 25' from perimeter of PBC district boundary
Rear - 25' from perimeter of PBC district boundary

PARKING SUMMARY:		
USE	RATIO	PARKING REQ'D.
COMMERCIAL	1/250	179
TOTAL PARKING PROVIDED		314

OWNER: COREVET INVESTMENT GROUP LLC P.O. BOX 38175 COLORADO SPRINGS, CO. 80931-8175	TAX ID#: 5406304050 ZONING: CR
PROJECT ADDRESS: 5819 PALMER PARK BLVD. COLORADO SPRINGS, CO	PROPOSED BUILDING USE: RESTAURANT
LOT SIZE (SF): 2.55 ACRES (241,758 SF)	EXISTING LOT COVERAGE: 41% PROPOSED LOT COVERAGE: NO CHANGE

CPC NV XX-XXXXX

PROJECT NO.

PREPARED BY: _____
 DATE: _____
 REVISIONS: _____

ISSUE
DATE: 10-05-18
SHEET:

SD-1

