

SITE PLAN DISCLAIMER:
 PROPERTY LINES AND STRUCTURES HAVE BEEN DIGITIZED FROM PREVIOUS PLAN SETS. CROWN CASTLE USA INC. HAS NOT COMPLETED A SITE SURVEY AND THEREFORE MAKES NO CLAIMS AS TO THE ACCURACY OF INFORMATION DEPICTED ON THIS SHEET.

JURISDICTIONAL APPROVAL:

verizon
 3245 158TH AVENUE MS 231
 BELLEVUE, WA 98008

CROWN CASTLE
 1505 WESTLAKE AVENUE NORTH, SUITE 800
 SEATTLE, WA 98109

Trylon
 1825 W. WALNUT HILL LANE, SUITE 120
 IRVING, TEXAS 75038

VERIZON SITE NUMBER: 411836
 BU #: 877055
SCHUBERT PROPERTY
 7445 TEMPLETON GAP RD
 COLORADO SPRINGS, CO 80922
 EXISTING 100' MONOPOLE TOWER

ISSUED FOR:

REV	DATE	DRWN	DESCRIPTION	DES./QA
B	06/08/2022	DIN	PRELIMINARY	EAN
0	06/29/2022	DIN	PRELIMINARY	EAN
1	08/25/2022	DIN	FINAL	TRP
2	10/29/2022	DIN	FINAL	AMT



IT IS A VIOLATION OF LAW FOR ANY PERSON, UNLESS THEY ARE ACTING UNDER THE DIRECTION OF A LICENSED PROFESSIONAL ENGINEER, TO ALTER THIS DOCUMENT.

SHEET NUMBER: **C-1.1** REVISION: **2**

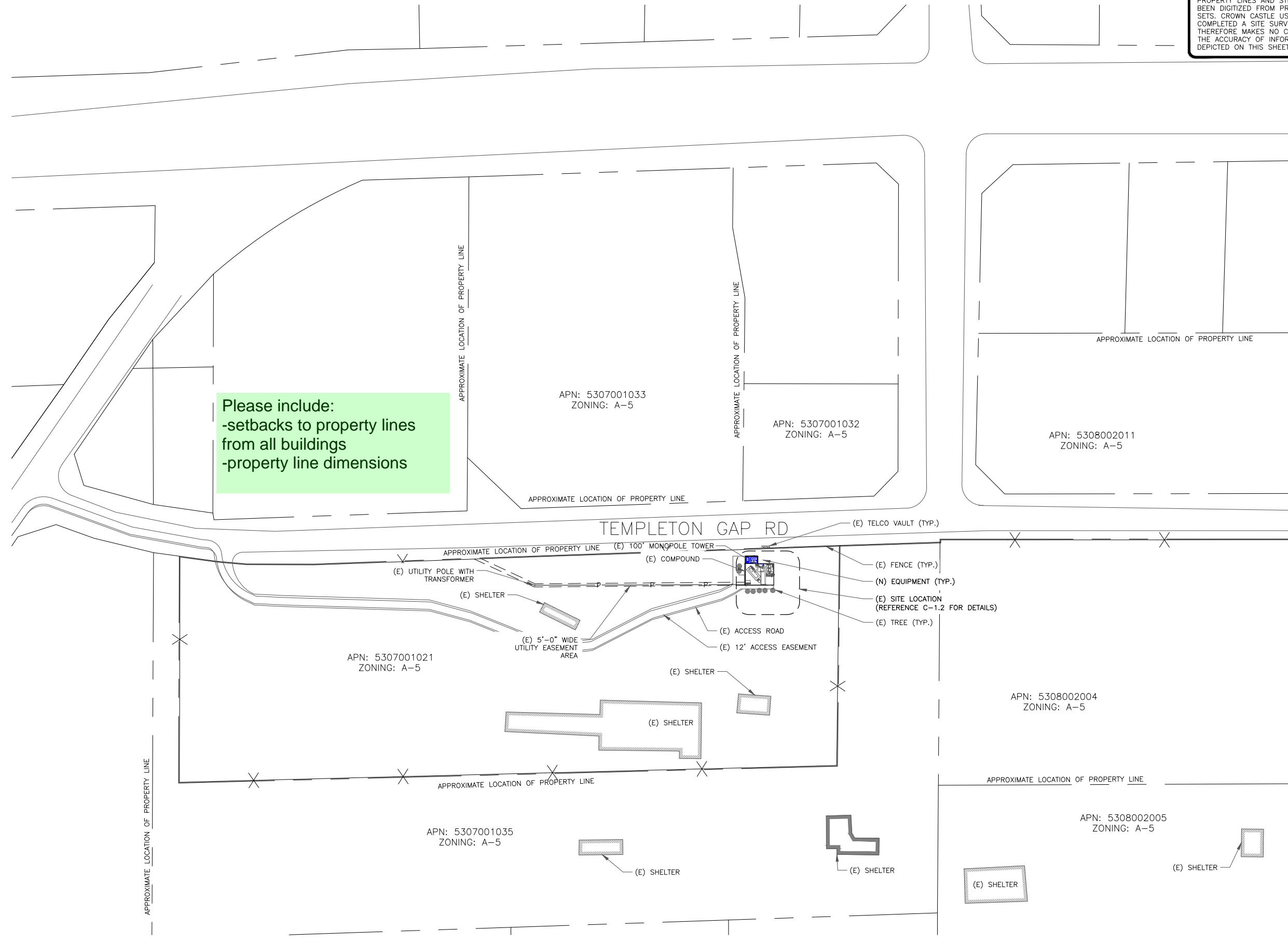

Please include:
 -setbacks to property lines
 -property line dimensions

1 OVERALL SITE PLAN
 SCALE: 1"=40'-0" (FULL SIZE)
 1"=80'-0" (11x17)



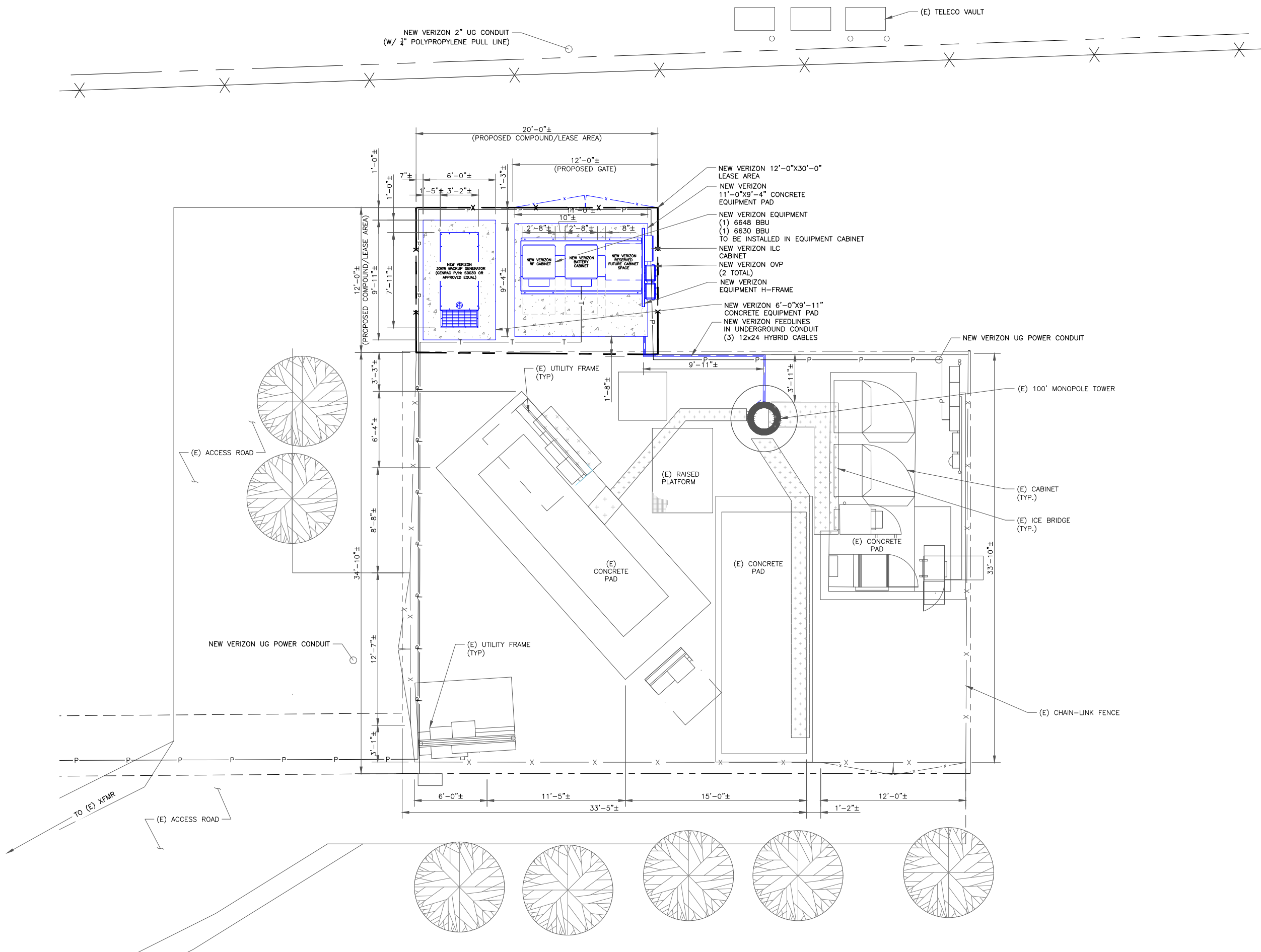

JURISDICTIONAL APPROVAL:



VERIZON SITE NUMBER: 411836

BU #: 877055

SCHUBERT PROPERTY
7445 TEMPLETON GAP RD
COLORADO SPRINGS, CO 80922
EXISTING 100' MONOPOLE TOWER

ISSUED FOR:

REV	DATE	DRWN	DESCRIPTION	DES./QA
B	06/08/2022	DIN	PRELIMINARY	EAN
0	06/29/2022	DIN	PRELIMINARY	EAN
1	08/25/2022	DIN	FINAL	TRP
2	10/29/2022	DIN	FINAL	AMT



IT IS A VIOLATION OF LAW FOR ANY PERSON, UNLESS THEY ARE ACTING UNDER THE DIRECTION OF A LICENSED PROFESSIONAL ENGINEER, TO ALTER THIS DOCUMENT.

SHEET NUMBER: **C-1.2** REVISION: **2**

1 SITE PLAN
SCALE: 1/2"=1'-0" (FULL SIZE)
1/4"=1'-0" (11x17)