

Site Plan Notes:

1. Property Limits are Not Precise. Based on El Paso County Assessor Map
2. Existing Septic Sized For Two Bedrooms Per 1990 Permit
3. New House Requires Variance in Setbacks to Fit on Site

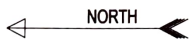

Site Plan Details:

1. Tax Schedule: 5208232028
2. Current Zoning: RR-5
3. Legal Description: Lot 3, Block 31, Brentwood Country Club and Cabin Sites Tract No. 1 According to the Plat Thereof Recorded in Plat Book P at Page 46, and as Amended by Resolution No. 88-237 Recorded September 12, 1988 in Book 5553 at Page 103, El Paso County, Colorado
4. Proposed Land Use: Single Family Residence, RR-5
5. Parcel Size 178,678 Sq Feet

This equals 4.1 acres. please change this to 0.41 acres

Show setbacks from the closest point of the house to the front property line



Project No.	19-025
Date	10 Feb 2025
Drawn by	cem
Checked by	cem

Project Name and Address
Diane Gilstrap
 Site Plan
 13285 Ravine Drive West
 El Paso County, Colorado
 (719) 675-7308
 lizadiane64@gmail.com

V2 - Site Plan - RLR.pdf Markup Summary

Arrow (1)



Subject: Arrow
Page Label: 1
Author: Lisa Elgin
Date: 6/19/2025 12:55:32 PM
Status:
Color: ■
Layer:
Space:

Callout (1)

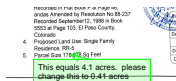

Subject: Callout
Page Label: 1
Author: Lisa Elgin
Date: 6/19/2025 12:58:39 PM
Status:
Color: ■
Layer:
Space:

This equals 4.1 acres. please change this to 0.41 acres

Line (1)



Subject: Line
Page Label: 1
Author: Lisa Elgin
Date: 6/19/2025 12:54:30 PM
Status:
Color: ■
Layer:
Space:

Text Box (1)



Subject: Text Box
Page Label: 1
Author: Lisa Elgin
Date: 6/19/2025 12:55:23 PM
Status:
Color: ■
Layer:
Space:

Show setbacks from the closest point of the house to the front property line