

BENT GRASS RESIDENTIAL FILING NO. 2

MODIFICATION NO. 1 TO PERMIT NO. COR407559

NORTH OF BENT GRASS MEADOWS DR AND WOODMEN RD
UNINCORPORATED EL PASO COUNTY, CO 80831



Environmental Solutions
ENVIRONMENTAL COMPLIANCE MADE SIMPLE

1778 S. Broadway
Denver, CO 80210
P: (303) 593-2107
F: (303) 923-3416

OWNER/PERMITEE: CHALLENGER HOMES

LATITUDE 38.94587°, LONGITUDE -104.62466°

DATE: 05/10/2021

NOTICE OF MODIFICATION

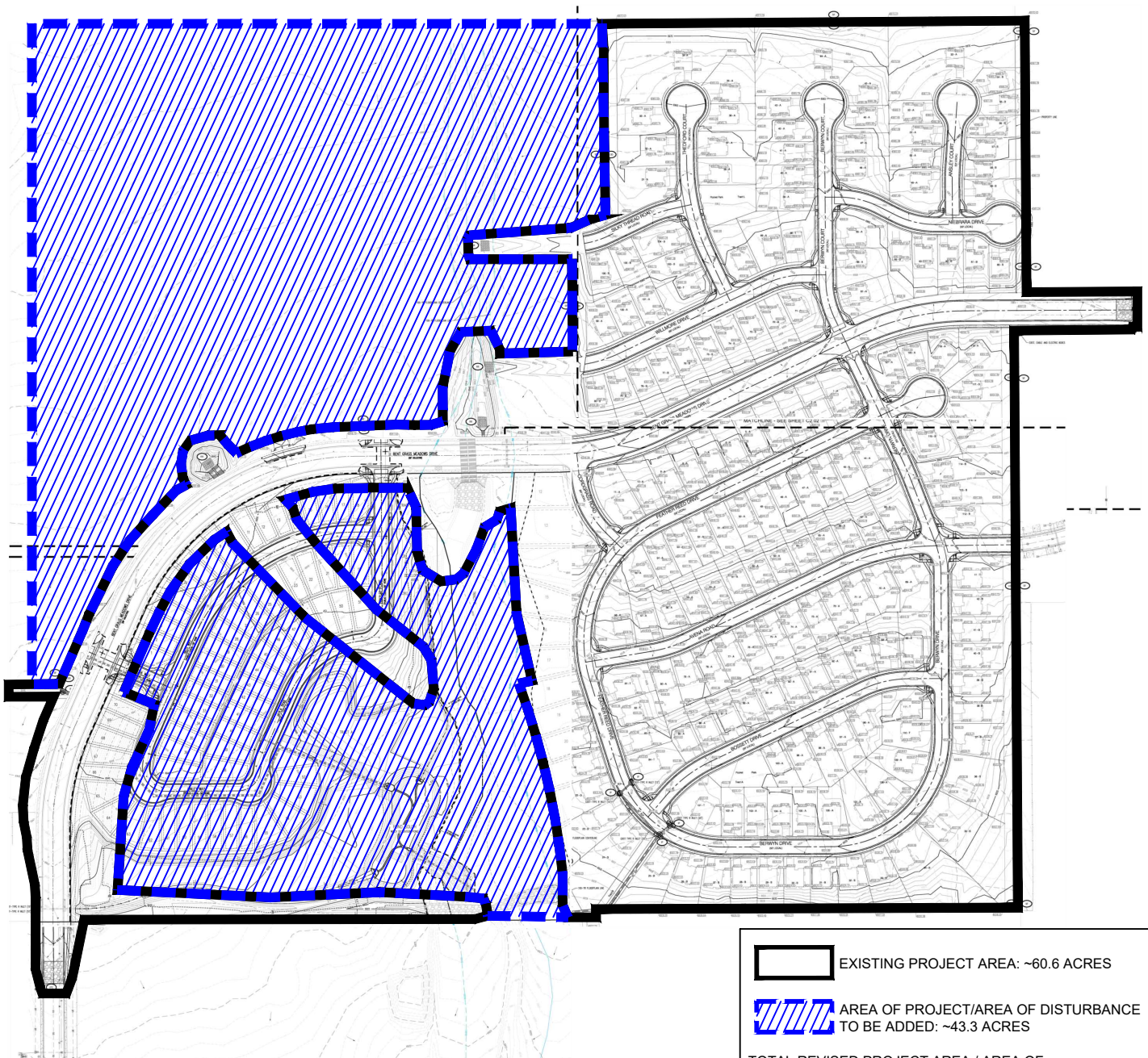
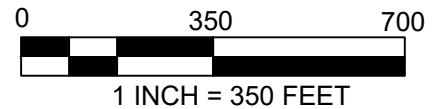

 EXISTING PROJECT AREA: ~60.6 ACRES

 AREA OF PROJECT/AREA OF DISTURBANCE
TO BE ADDED: ~43.3 ACRES

TOTAL REVISED PROJECT AREA / AREA OF
DISTURBANCE ON PERMIT NO. COR407559: ~103.9 ACRES