

DONNY J
RORSCHACH

513 MAIN STREET, SUITE 300
FORT WORTH, TEXAS 76102
(817) 860-0463

THIS DOCUMENT IS RELEASED
FOR THE PURPOSE OF REVIEW
UNDER THE AUTHORITY OF:
ROGUE ARCHITECTS. IT IS NOT
TO BE USED FOR
CONSTRUCTION, BIDDING OR
PERMIT PURPOSES.

PRELIM DRAWINGS

CONTRACTOR SHALL VERIFY ALL CONDITIONS
AND DIMENSIONS AT THE JOB SITE AND
NOTIFY THE ARCHITECT OF ANY DISCREPANCIES
BEFORE BEGINNING OR FABRICATING ANY
WORK. DO NOT SCALE DRAWINGS.



PROJECT NAME:
PROPOSED DRIVE THRU SHELL
PROJECT ADDRESS:
**NWC STRUTHERS RD & NORTH GATE BLVD
COLORADO SPRINGS, CO 80921**

REVISION SCHEDULE		
REV	DATE	BY DESCRIPTIONS

PROJECT #: 16-0349
ORIGINAL ISSUE: 06-26-17
DATE: JLP
PRODUCTION: JLP
DESIGNER BY: JLP
CHECKED BY: JLP

SHEET TITLE:
**PRELIM INTERIOR
LAYOUT**

SCALE:

SHEET NUMBER:

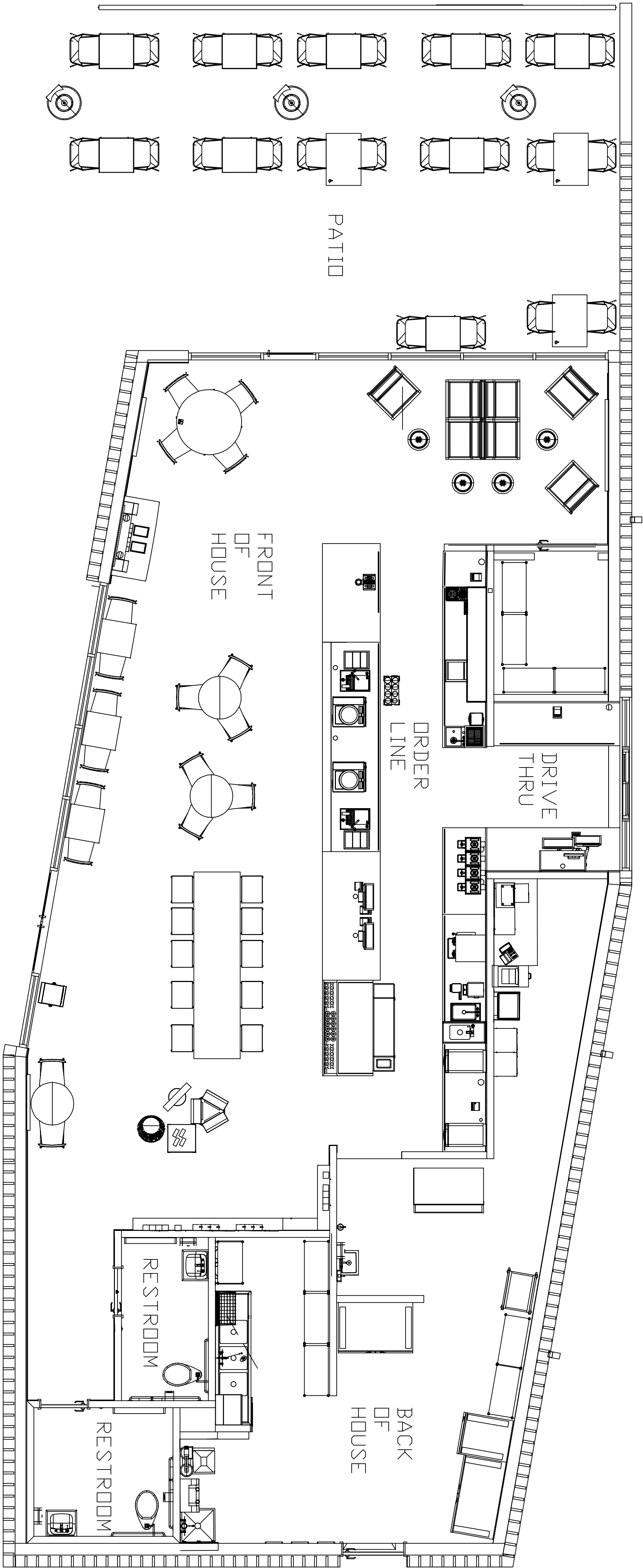

PRELIM INTERIOR PLAN
SCALE: 1/4" = 1'