

**EROSION AND STORMWATER QUALITY CONTROL PERMIT (ESQCP)
EL PASO COUNTY
APPLICATION AND PERMIT**

PERMIT NUMBER TBD

APPLICANT INFORMATION

Applicant Contact Information	
Owner	James Barash
Name (person of responsibility)	Josh Taylor
Company/Agency	Vertical Construction Management
Position of Applicant	Construction Manager
Address (physical address, not PO Box)	1209 South White Chapel Blvd. Ste. 180
City	South Lake
State	TX
Zip Code	76092
Mailing address, if different from above	
Telephone	817.912.5572
FAX number	
Email Address	j.taylor@verticalcm.com
Cellular Phone number	

CONTRACTOR INFORMATION

Contractor	
Name (person of responsibility)	TBD
Company	
Address (physical address, not PO Box)	
City	
State	
Zip Code	
Mailing address, if different from above	
Telephone	
FAX number	
Email Address	
Cellular Phone number	
Erosion Control Supervisor (ECS)*	
ECS Phone number*	
ECS Cellular Phone number*	

*Required for all applicants. May be provided at later date pending securing a contract when applicable.

PROJECT INFORMATION

Project Specifications	
Project Name	
Legal Description	Lot 2, Academy Gateway Subdivision Filing No. 1 El Paso County, CO
Address (or nearest major cross streets)	Struthers Rd & North Gate Blvd.
Acreage (total and disturbed)	Total: acres 0.985 Disturbed: acres 0.985
Schedule	Start of Construction: TBD Completion of Construction: TBD Final Stabilization: TBD
Project Purpose	@SR, commercial development
Description of Project	Proposed 2,200 SF restaurant
Tax Schedule Number	TBD

FOR OFFICE USE ONLY

The following signature from the ECM Administrator signifies the approval of this ESQCP. All work shall be performed in accordance with the permit, the El Paso County Engineering Criteria Manual (ECM) Standards, City of Colorado Springs Drainage Criteria Manual, Volume 2 (DCM2) as adopted by El Paso County Addendum, approved plans, and any attached conditions. The approved plans are an enforceable part of the ESQCP. Construction activity, except for the installation of initial construction BMPs is not permitted until issuance of a Construction permit and Notice to Proceed.

Signature of ECM Administrator: _____ Date _____

1.1 REQUIRED SUBMISSIONS

In addition to this completed and signed application, the following items must be submitted to obtain an ESQCP:

- Permit fees
- Stormwater Management Plan (SWMP) meeting the requirements of DCM2 and ECM either as part of the plan set or as a separate document;
- Cost estimates of construction and maintenance of construction and permanent stormwater control measures (Cost estimates shall be provided on a unit cost basis for all stormwater BMPs);
- Financial surety in an amount agreeable to the ECM Administrator based on the cost estimates of the stormwater quality protection measures provided. The financial surety shall be provided in the form of a Letter of Credit, Surety with a Bonding Company, or other forms acceptable to El Paso County;
- Operation and Maintenance Plan for any proposed permanent BMPs; and
- Signed Private Detention Basin/Stormwater Quality Best Management Practice Maintenance Agreement and Easement, if any permanent Best Management Practices are to be located on site.

1.2 RESPONSIBILITY FOR DAMAGE

The County and its officers and employees, including but not limited to the ECM Administrator, shall not be answerable or accountable in any manner, for injury to or death of any person, including but not limited to a permit holder, persons employed by the permit holder, persons acting in behalf of the permit holder, or for damage to property resulting from any activities undertaken by a permit holder or under the direction of a permit holder. The permit holder shall be responsible for any liability imposed by law and for injuries to or death of any person, including but not limited to the permit holder, persons employed by the permit holder, persons acting in behalf of the permit holder, or damage to property arising out of work or other activity permitted and done by the permit holder under a permit, or arising out of the failure on the permit holder's part to perform the obligations under any permit in respect to maintenance or any other obligations, or resulting from defects or obstructions, or from any cause whatsoever during the progress of the work, or other activity, or at any subsequent time work or other activity is being performed under the obligations provided by and contemplated by the permit.

To the extent allowed by law, the permit holder shall indemnify, save, and hold harmless the County and its officers and employees, including but not limited to the BOCC and ECM Administrator, from all claims, suits or actions of every name, kind and description brought for or on account of injuries to or death of any person, including but not limited to the permit holder, persons employed by the permit holder, persons acting in behalf of the permit holder and the public, or damage to property resulting from the performance of work or other activity under the permit, or arising out of the failure on the permit holder's part to perform his obligations under any permit in respect to maintenance or any other obligations, or resulting from defects or obstructions, or from any cause whatsoever during the progress of the work, or other activity or at any subsequent time work or other activity is being performed under the obligations provided by and contemplated by the permit, except as otherwise provided by state law. The permit holder waives any and all rights to any type of expressed or implied indemnity against the County, its officers or employees.

1.3 APPLICATION CERTIFICATION

I, as the Applicant or the representative of the Applicant, hereby certify that this application is correct and complete as per the requirements presented in this application and the El Paso County Engineering Criteria Manual and Drainage Criteria Manual, Volume 2 and El Paso County Addendum.

I, as the Applicant or the representative of the Applicant, have read and will comply with all of the requirements of the specified Stormwater Management Plan and any other documents specifying stormwater best management practices to be used on the site including permit conditions that may be required by the ECM Administrator. I understand that the Best Management Practices are to be maintained on the site and revised as necessary to protect stormwater quality as the project progresses. I further understand that a Construction Permit must be obtained and all necessary stormwater quality control BMPs are to be installed in accordance with the SWMP and the El Paso County Engineering Criteria Manual and Drainage Criteria Manual, Volume 2 and El Paso County Addendum before land disturbance begins and that failure to comply will result in a Stop Work Order and may result in other penalties as allowed by law. I further understand and agree to indemnify, save, and hold harmless the County and its officers and employees, including but not limited to the BOCC and ECM Administrator, from all claims, suits or actions of every name, kind and description as outlined in Section 1.2 Responsibility for Damage.



Signature of Applicant or Representative

Date: 6/22/17

Jonathan Spencer (Agent for Applicant)

Print Name of Applicant or Representative

Permit Fee \$ _____

Surcharge \$ _____

Financial Surety \$ _____

Type of Surety _____

Total \$ _____

SOIL PREPARATION NOTE

SOIL PREPARATION SHALL BE PER RECOMMENDATIONS FROM A GEOTECHNICAL ENGINEERING REPORT PREPARED FOR THIS SITE AS FOLLOWS

GEOTECHNICAL ENGINEER: ENTECH ENGINEERING, INC.
REPORT NO. 171002

THE CONTRACTOR MUST FULLY REVIEW THIS REPORT PRIOR TO CONSTRUCTION INFORMATION IN THE GEOTECHNICAL REPORT SUPERSEDES ANY CONFLICTING INFORMATION CONTAINED IN THE CONSTRUCTION PLANS AND SPECIFICATIONS

ACADEMY GATEWAY SUBDIVISION FILING NO. 1 LOT 2

A SUBDIVISION OF A PORTION OF THE SOUTHEAST QUARTER OF SECTION 1,
TOWNSHIP 12 SOUTH, RANGE 67 AND THE SOUTHWEST QUARTER OF SECTION 6

TOWNSHIP 12 SOUTH RANGE 66, ALL WEST OF THE SIXTH PRINCIPAL

MERIDIAN, EL PASO COUNTY, COLORADO

MAJOR SITE DEVELOPMENT PLAN

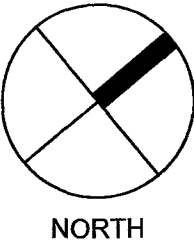
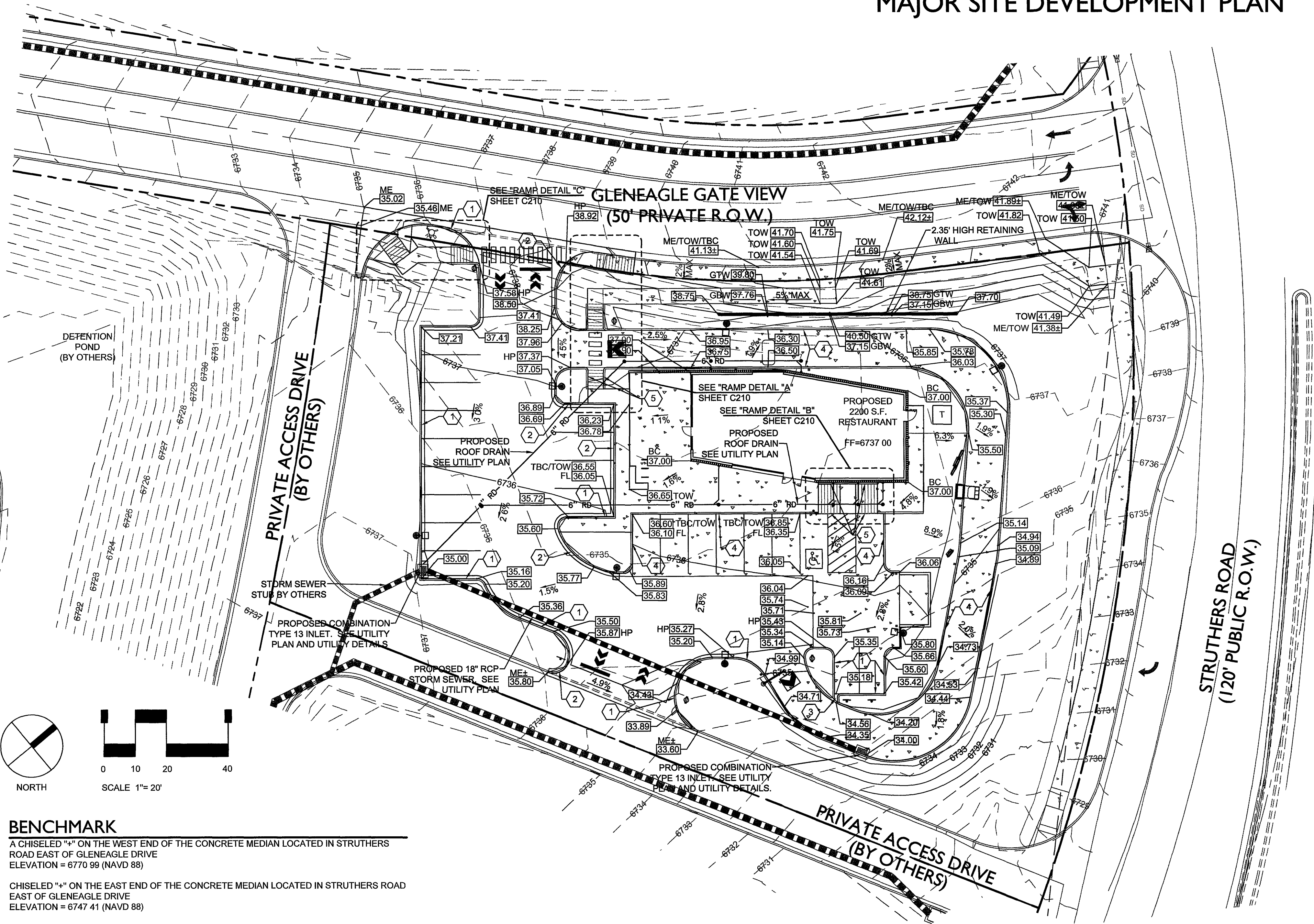

NORTH

SCALE 1"= 20'

BENCHMARK

A CHISELED "X" ON THE WEST END OF THE CONCRETE MEDIAN LOCATED IN STRUTHERS ROAD EAST OF GLENEAGLE DRIVE
ELEVATION = 6770.99 (NAVD 88)

CHISELED "X" ON THE EAST END OF THE CONCRETE MEDIAN LOCATED IN STRUTHERS ROAD EAST OF GLENEAGLE DRIVE
ELEVATION = 6747.41 (NAVD 88)

PROPOSED WITHIN DISTURBED AREA

TOTAL LAND DISTURBANCE FOR PROJECT 37,794 SQ. FT. ± 0.87 ACRES ±

CAUTION - NOTICE TO CONTRACTOR

THE CONTRACTOR IS SPECIFICALLY CAUTIONED THAT THE LOCATION AND/OR ELEVATION OF EXISTING UTILITIES AS SHOWN ON THESE PLANS IS BASED ON RECORDS OF THE VARIOUS UTILITY COMPANIES AND WHERE POSSIBLE, MEASUREMENTS TAKEN IN THE FIELD. THE INFORMATION IS NOT TO BE RELIED ON AS BEING EXACT OR COMPLETE. THE CONTRACTOR MUST CALL THE LOCAL UTILITY LOCATION CENTER AT LEAST 48 HOURS BEFORE ANY EXCAVATION TO REQUEST EXACT FIELD LOCATIONS OF THE UTILITIES. IT SHALL BE THE RESPONSIBILITY OF THE CONTRACTOR TO RELOCATE ALL EXISTING UTILITIES WHICH CONFLICT WITH THE PROPOSED IMPROVEMENTS SHOWN ON THE PLANS.

THE CONTRACTOR SHALL BE RESPONSIBLE FOR ANY DAMAGE TO EXISTING IMPROVEMENTS AND UTILITIES AND SHALL REPAIR ANY DAMAGE AT HIS EXPENSE.

GRADING LEGEND

---	R.O.W. / PROPERTY LINE	⊙	EXIST. MANHOLE
---	ADJOINING PROPERTY	⚡	EXIST. FIRE HYDRANT
---	EASEMENT LINE	⚙	EXIST. WATER VALVE
---	EXISTING TO REMAIN	TBC	TOP BACK OF CURB
---	PROP. CURB AND GUTTER	HP	HIGH POINT
---	PROPOSED STORM SEWER	TOW	TOP OF WALK
---	PROPOSED UNDERGROUND ROOF DRAIN LINE	ME	MATCH EXISTING
---	PROPOSED STORM INLET	EC	EDGE OF CONCRETE
---	EXIST. CONTOUR	GTW	GRADE AT TOP OF WALL
---	PROP. CONTOUR	GBW	GRADE AT BOTTOM OF WALL
---	EXIST. SPOT ELEVATION	FL	FLOW LINE
---	PROP. SPOT ELEVATION	GB	GRADE BREAK
---	EXIST. SPOT ELEVATION	BC	BUILDING CORNER
---	PROP. SLOPE		

SCHEDULE NOTES

- CONSTRUCT 6" VERTICAL CONCRETE CURB AND GUTTER WITH 1-FOOT CATCH PAN. SEE SITE DETAILS.
- CONSTRUCT 6" VERTICAL CONCRETE CURB AND GUTTER WITH 1-FOOT SPILL PAN. SEE SITE DETAILS.
- CONSTRUCT 10-FOOT WIDE CONCRETE RUNDOWN. SEE SITE DETAILS.
- CONSTRUCT 6-INCH VERTICAL CONCRETE CURB. CONTRACTOR MAY ELECT TO CONSTRUCT MONOLITHICALLY TO THE ADJOINING CONCRETE PAVING. SEE SITE DETAILS.
- CURB VARIES IN HEIGHT FROM 0-INCHES TO 6-INCHES.
- CONSTRUCT HANDICAP PARKING AREA. NO GRADES GREATER THAN 2.0% IN ANY DIRECTION. CONTRACTOR TO VERIFY WITH CONSTRUCTION MANAGER AT FORM SET OR REMAIN SOLELY RESPONSIBLE FOR REMOVAL AND REPLACEMENT OF ANY NON-ADA CONFORMING INSTALLATION.

GENERAL GRADING NOTES

- REFER TO SHEET 2 FOR ADDITIONAL PROJECT GENERAL NOTES.
- IF, DURING THE OVERLOT GRADING PROCESS, CONDITIONS ARE ENCOUNTERED BY THE CONTRACTOR, HIS SUBCONTRACTORS, OR OTHER AFFECTED PARTIES, WHICH COULD INDICATE A SITUATION THAT IS NOT IDENTIFIED IN THE PLANS OR SPECIFICATIONS, THE CONTRACTOR SHALL CONTACT THE GEOTECHNICAL ENGINEER IMMEDIATELY FOR RECOMMENDATIONS.
- ALL EARTHWORK, GRADING, OVERLOT GRADING, BACKFILLING, FILLING, EXCAVATION, COMPACTION, PAVEMENT, AND FLATWORK CONSTRUCTION WILL BE IN ACCORDANCE WITH THE RECOMMENDATIONS FROM THE GEOTECHNICAL INVESTIGATION PREPARED SPECIFICALLY FOR THIS SITE.
- ALL CONCRETE PAVEMENT, CONCRETE FLATWORK, CONCRETE STRUCTURES AND CONCRETE UTILITIES SHALL BE IN ACCORDANCE WITH THE MATERIAL RECOMMENDATIONS FROM THE GEOTECHNICAL INVESTIGATION PREPARED SPECIFICALLY FOR THIS SITE.
- THE EARTHWORK FOR ALL BUILDING FOUNDATIONS AND SLABS SHALL BE IN ACCORDANCE WITH ARCHITECTURAL AND STRUCTURAL PLANS AND SPECIFICATIONS, AND THE GEOTECHNICAL INVESTIGATION.
- SPOT ELEVATIONS SHALL TAKE PRECEDENCE OVER CONTOURS AND SLOPES SHOWN. THE CONTRACTOR SHALL NOTIFY THE ENGINEER OF SPOT ELEVATIONS WHICH DO NOT APPEAR TO BE CONSISTENT WITH THE CONTOURS AND SLOPES. SPOT ELEVATIONS AND SPECIFIC PROFILE DESIGN SHALL BE USED FOR SETTING ELEVATIONS OF CURB AND GUTTER AND UTILITIES.
- SPOT ELEVATIONS REPRESENT FLOWLINE (BOTTOM FACE OF CURB) WHERE SHOWN AT CURB AND GUTTER UNLESS OTHERWISE NOTED.
- CONTOURS SHOWN ARE FOR FINISHED PAVING, SIDEWALK, SLAB, OR GROUND ADJUSTMENT TO SUBGRADE IS THE CONTRACTOR'S RESPONSIBILITY.
- THE CONTRACTOR IS RESPONSIBLE FOR PROVIDING HIS OWN ESTIMATE OF EARTHWORK QUANTITIES.
- REFER TO SITE PLAN FOR EXTENT OF PAVEMENT AND PAVEMENT SECTIONS.
- GRADES WITHIN ASPHALT PAVING AREAS SHALL BE CONSTRUCTED TO WITHIN 0.10 FEET OF THE DESIGN GRADE. HOWEVER, THE CONTRACTOR SHALL MAINTAIN POSITIVE DRAINAGE IN ALL PAVEMENT AREAS AND ALONG CURBS. ALL CURBS SHALL BE BUILT IN ACCORDANCE WITH THE PLAN. CURBS OR PAVEMENT AREAS WHICH DO NOT PROVIDE PROPER DRAINAGE MUST BE REMOVED AND REPLACED AT THE CONTRACTOR'S EXPENSE.
- THE CONTRACTOR SHALL HAVE FORMS CHECKED BY A SURVEYOR FOR CURB AND GUTTER ADJACENT TO EXISTING ASPHALT OR CONCRETE. THE CROSS SLOPE SHALL NOT BE LESS THAN 2% OR GREATER THAN 4% FROM THE EXISTING SAWCUT LINE TO THE PROPOSED LIP OF GUTTER. DO NOT PLACE CONCRETE IN FORMS THAT HAVE BEEN CHECKED TO BE OR APPEAR IN ANY WAY INCORRECT. CONTACT THE ENGINEER IMMEDIATELY IF A PROBLEM SHOULD ARISE.
- THE CONTRACTOR SHALL ADJUST AND/OR CUT EXISTING PAVEMENT AS NECESSARY TO ASSURE A SMOOTH FIT AND CONTINUOUS GRADE.
- THE CONTRACTOR SHALL ASSURE POSITIVE DRAINAGE AWAY FROM BUILDINGS FOR ALL LANDSCAPED AND PAVED AREA.
- ALL DISTURBED AREAS THAT ARE NOT DESIGNATED TO BE PAVED SHALL BE LANDSCAPED OR SEEDED, ACCORDING TO THE LANDSCAPE PLAN.
- EXISTING DRAINAGE STRUCTURES SHALL BE INSPECTED AND REPAIRED AS NEEDED, AND EXISTING PIPES CLEANED OUT TO REMOVE ALL SILT AND DEBRIS.
- IF ANY EXISTING STRUCTURES, SIDEWALK, AND/OR CURB AND GUTTER MODIFIED OR TO REMAIN ARE DAMAGED DURING CONSTRUCTION, IT SHALL BE THE CONTRACTOR'S RESPONSIBILITY TO REPAIR AND/OR REPLACE THE EXISTING STRUCTURE AS NECESSARY TO RETURN IT TO EXISTING CONDITIONS OR BETTER PRIOR TO PROJECT CLOSEOUT.
- ALL GRATES, MANHOLE RIMS, VALVE BOXES, VALVE COVERS, CLEANOUTS, AND VAULT OR BOX COVERS SHALL BE ADJUSTED TO "AS CONSTRUCTED" FINISHED GRADE PRIOR TO THE FINAL LIFT OF ASPHALT.
- NO PROPOSED SLOPE IN LANDSCAPED AREAS OR OPEN SPACE SHALL EXCEED THREE (3) HORIZONTAL FEET TO ONE (1) VERTICAL FOOT, OR AS OTHERWISE SPECIFIED BY LOCAL CRITERIA.
- THE CONTRACTOR SHALL PROTECT THE PROJECT BENCHMARK THROUGHOUT CONSTRUCTION AND SET ADDITIONAL PROJECT BENCHMARKS AS NECESSARY TO MAINTAIN VERTICAL CONTROL THROUGHOUT THE DURATION OF THE PROJECT.
- THE CONTRACTOR SHALL FILL AND COMPACT BASEMENTS, CESSPOOLS, AND OTHER LARGE EXCAVATED AREAS WITH CLEAN FILL SUITABLE TO THE OWNER, AND IN ACCORDANCE WITH RECOMMENDATIONS OBTAINED FROM THE GEOTECHNICAL INVESTIGATION OR GEOTECHNICAL ENGINEER AND GRADE TO MATCH EXISTING OR PROPOSED FINISH GRADE, OR CONFIRM SUCH WORK HAS BEEN PERFORMED PRIOR TO CONSTRUCTION.

ENGINEER'S STATEMENT

THIS GRADING AND EROSION CONTROL PLAN WAS PREPARED UNDER MY DIRECTION AND SUPERVISION AND IS CORRECT TO THE BEST OF MY KNOWLEDGE AND BELIEF. SAID PLAN HAS BEEN PREPARED TO THE CRITERIA ESTABLISHED BY THE COUNTY FOR GRADING AND EROSION CONTROL PLANS. I ACCEPT RESPONSIBILITY FOR ANY LIABILITY CAUSED BY ANY NEGLIGENT ACTS, ERRORS, OR OMISSIONS ON MY PART IN PREPARING THIS REPORT.

DATE 10/3/2017
NAME _____ DATE _____

OWNER'S STATEMENT

THE OWNER WILL COMPLY WITH THE REQUIREMENTS OF THE GRADING AND EROSION CONTROL PLAN.

DATE 10/19/17
NAME _____ DATE _____

EL PASO COUNTY

COUNTY PLAN REVIEW IS PROVIDED ONLY FOR GENERAL CONFORMANCE WITH COUNTY DESIGN CRITERIA. THE COUNTY IS NOT RESPONSIBLE FOR THE ACCURACY AND ADEQUACY OF THE DESIGN, DIMENSIONS, AND/OR ELEVATIONS WHICH SHALL BE CONFIRMED AT THE JOB SITE. THE COUNTY THROUGH THE APPROVAL OF THIS DOCUMENT ASSUMES NO RESPONSIBILITY FOR COMPLETENESS AND/OR ACCURACY OF THIS DOCUMENT.

FILED IN ACCORDANCE WITH THE REQUIREMENTS OF THE EL PASO COUNTY LAND DEVELOPMENT CODE, DRAINAGE CRITERIA AND ENGINEERING CRITERIA MANUAL AS AMENDED.

COUNTY ENGINEER / DIRECTOR _____ DATE _____

Sterling Design Associates, LLC
CIVIL ENGINEERS - LANDSCAPE ARCHITECTS

2009 W. Littleton Blvd #300
Littleton, CO 80120
303.794.4727 ph
www.SterlingDesignAssociates.com

PREPARED UNDER THE DIRECT SUPERVISION OF
JOSEPH SCHIEL, PE
COLORADO REGISTRATION 0048332
FOR & ON BEHALF OF STERLING DESIGN ASSOCIATES, LLC



STERLING DESIGN ASSOCIATES, LLC

ISSUES & REVISIONS		
NO. 1	DATE 5/16/2017	BY JDS
DESCRIPTION 1ST MAJOR SDP SUBMITTAL		
NO. 2	DATE 8/24/2017	BY JDS
DESCRIPTION 2ND MAJOR SDP SUBMITTAL		
NO. 3	DATE 9/13/2017	BY JDS
DESCRIPTION 3RD MAJOR SDP SUBMITTAL		
NO. 4	DATE -	BY -
DESCRIPTION -		
NO. 5	DATE -	BY -
DESCRIPTION -		
NO. 6	DATE -	BY -
DESCRIPTION -		

DATE 9/13/2017	SCALE 1" = 20'
PROJECT MANAGER JDS	PROJECT NO. -
DRAWN BY -	DRAWING FILE -

PROJECT

PROPOSED COFFEE SHOP
209 GLENEAGLE GATE VIEW
COLORADO SPRINGS, CO

CLIENT
VERTICAL CONSTRUCTION MANAGEMENT
1209 SOUTH WHITE CHAPEL BLVD, SUITE 180
SOUTHLAKE, TX 76092

TEL: (817) 527-8421

SHEET TITLE
GRADING PLAN

SHEET NUMBER

6 OF 21

COUNTY PROJECT NUMBER PPR-17-030

ACADEMY GATEWAY SUBDIVISION FILING NO. 1 LOT 2
A SUBDIVISION OF A PORTION OF THE SOUTHEAST QUARTER OF SECTION 1,
TOWNSHIP 12 SOUTH, RANGE 67 AND THE SOUTHWEST QUARTER OF SECTION 6
TOWNSHIP 12 SOUTH RANGE 66, ALL WEST OF THE SIXTH PRINCIPAL
MERIDIAN, EL PASO COUNTY, COLORADO
MAJOR SITE DEVELOPMENT PLAN

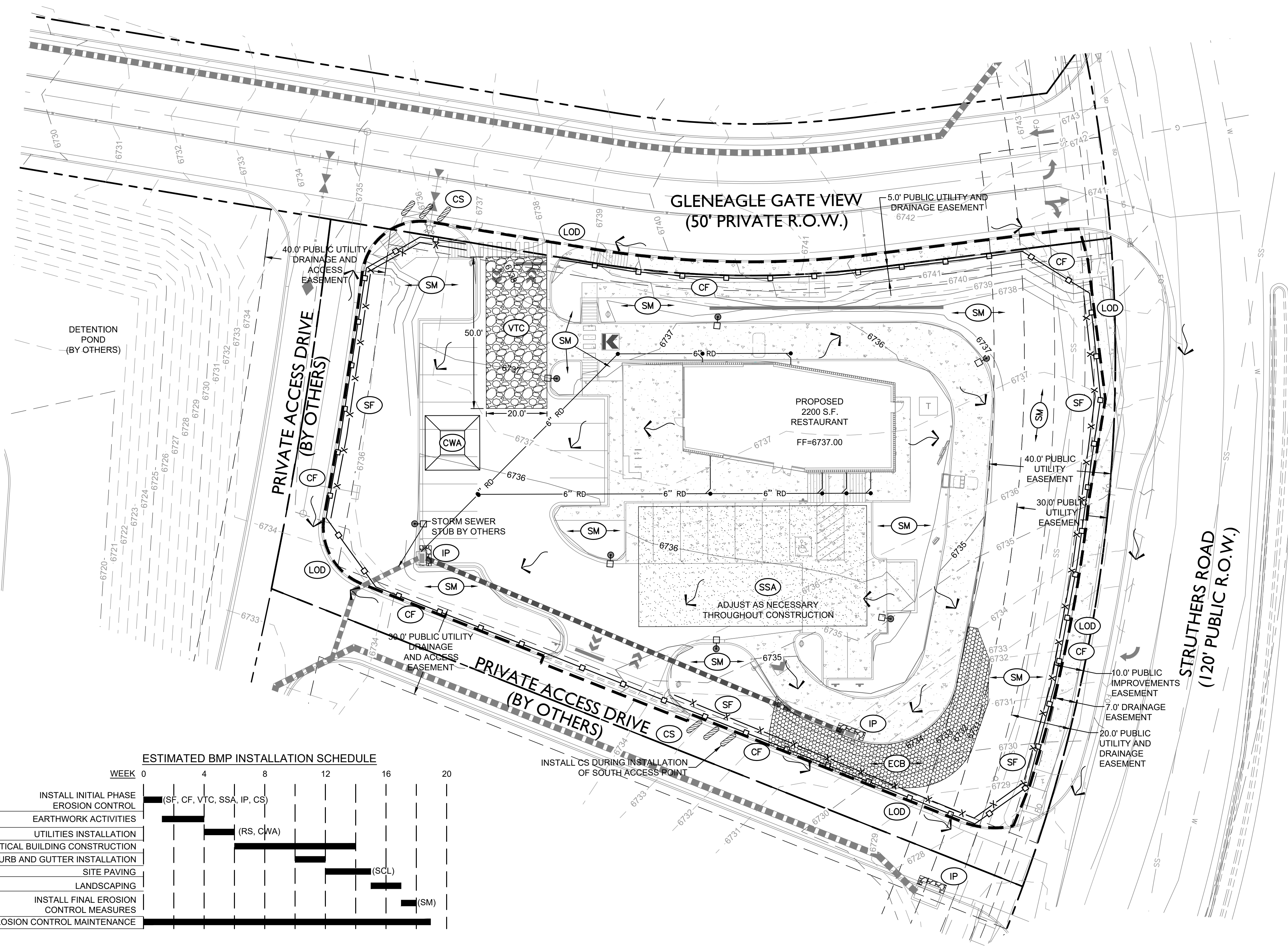

VICINITY MAP

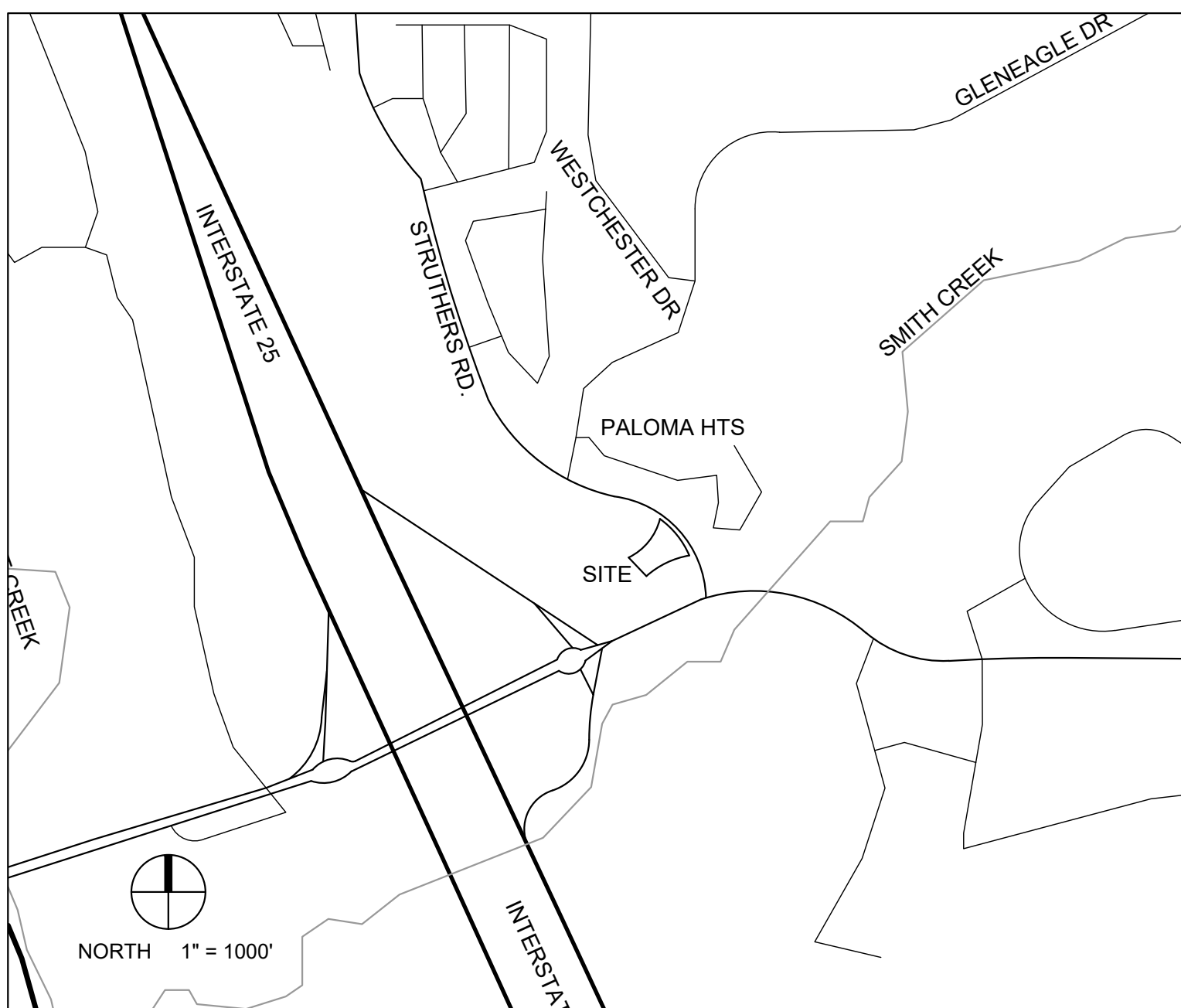

PROPOSED WITHIN DISTURBED AREA

TOTAL LAND DISTURBANCE FOR PROJECT: 37,794 SQ. FT. ± 0.87 ACRES

BASIS OF BEARINGS

BEARINGS ARE BASED ON A PORTION OF THE EASTERLY BOUNDARY OF THE UNITED STATES AIR FORCE ACADEMY AS RECORDED IN PLAT BOOK O-2 AT PAGE 84, RECORDS OF EL PASO COUNTY, COLORADO, BEING MONUMENTED AT THE NORTHERLY END BY A3.5" BRASS CAP STAMPED "BDY 43" IS ASSUMED TO BEAR N 56°38'25"W, A DISTANCE OF 630.29 FEET.

BENCHMARK

A CHISELED "X" ON THE WEST END OF THE CONCRETE MEDIAN LOCATED IN STRUTHERS ROAD EAST OF GLENEAGLE DRIVE ELEVATION = 6770.99 (NAVD 88)

CHISELED "X" ON THE EAST END OF THE CONCRETE MEDIAN LOCATED IN STRUTHERS ROAD EAST OF GLENEAGLE DRIVE ELEVATION = 6747.41 (NAVD 88)

BMP LEGEND

	(LOD)	LIMITS OF DISTURBANCE
	(VTC)	VEHICLE TRACKING PAD
	(SSA)	STABILIZED STAGING AREA (MATERIAL, HAZARDOUS MATERIAL, EQUIPMENT, FUEL, LUBRICANT, CHEMICAL, WASTE & SANITARY FACILITY STORAGE AND MAINTENANCE AREA)
	(IP)	INLET PROTECTION
	(CS)	CURB SOCKS
	(CWA)	CONCRETE WASHOUT AREA
	(SM)	SEED AND MULCH
		FLOW DIRECTION ARROW
	(SF)	SILT FENCE
	(CF)	CONSTRUCTION FENCE
	(ECB)	EROSION CONTROL BLANKET

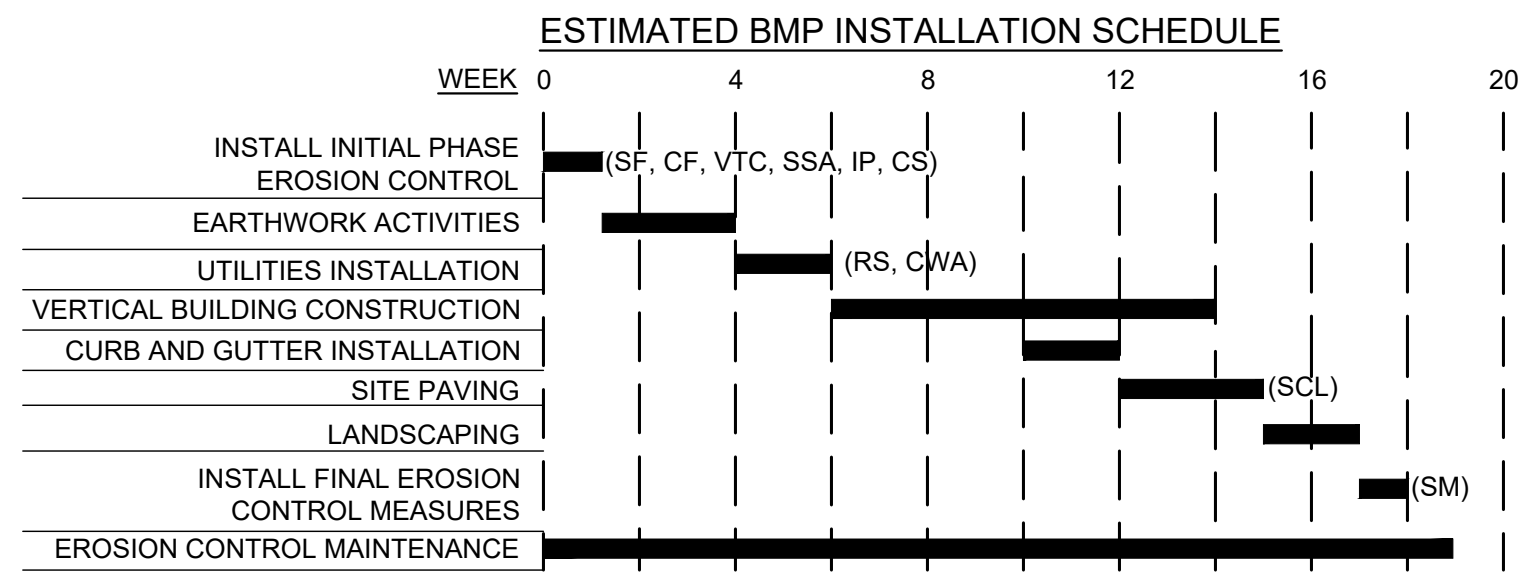

CAUTION - NOTICE TO CONTRACTOR

THE CONTRACTOR IS SPECIFICALLY CAUTIONED THAT THE LOCATION AND/OR ELEVATION OF EXISTING UTILITIES AS SHOWN ON THESE PLANS IS BASED ON RECORDS OF THE VARIOUS UTILITY COMPANIES AND, WHERE POSSIBLE, MEASUREMENTS TAKEN IN THE FIELD. THE INFORMATION IS NOT TO BE RELIED ON AS BEING EXACT OR COMPLETE. THE CONTRACTOR MUST CALL THE LOCAL UTILITY LOCATION CENTER AT LEAST 48 HOURS BEFORE ANY EXCAVATION TO REQUEST EXACT FIELD LOCATIONS OF THE UTILITIES. IT SHALL BE THE RESPONSIBILITY OF THE CONTRACTOR TO RELOCATE ALL EXISTING UTILITIES WHICH CONFLICT WITH THE PROPOSED IMPROVEMENTS SHOWN ON THE PLANS.

THE CONTRACTOR SHALL BE RESPONSIBLE FOR ANY DAMAGE TO EXISTING IMPROVEMENTS AND UTILITIES AND SHALL REPAIR ANY DAMAGE AT HIS EXPENSE.

GRADING LEGEND

	R.O.W. / PROPERTY LINE		8" W		EXIST. MANHOLE
	ADJOINING PROPERTY		8" SS		EXIST. FIRE HYDRANT
	EASEMENT LINE		G		EXISTING WATER LINE
	EXISTING TO REMAIN		E		EXISTING SANITARY SEWER
	PROP. CURB AND GUTTER		STS		EXISTING GAS LINE
	EXIST. CONTOUR		FO		EXISTING ELECTRIC LINE
	PROP. CONTOUR				EXISTING STORM SEWER
	PROPOSED STORM SEWER				EXISTING FIBER OPTIC LINE



Sterling Design Associates, Inc
CIVIL ENGINEERS - LANDSCAPE ARCHITECTS

2009 W. Littleton Blvd. #300
Littleton, CO 80130
303.794.4727 ph
www.SterlingDesignAssociates.com

PREPARED UNDER THE DIRECT SUPERVISION OF
JOSEPH SCHIEL, PE
COLORADO REGISTRATION 0048332
FOR & ON BEHALF OF STERLING DESIGN ASSOCIATES, LLC



STERLING DESIGN ASSOCIATES, LLC

ISSUES & REVISIONS		
NO. 1	DATE: 5/16/2017	BY: JDS
DESCRIPTION: 1ST MAJOR SDP SUBMITTAL		
NO. 2	DATE: 8/24/2017	BY: JDS
DESCRIPTION: 2ND MAJOR SDP SUBMITTAL		
NO. 3	DATE: 9/13/2017	BY: JDS
DESCRIPTION: 3RD MAJOR SDP SUBMITTAL		
NO. 4	DATE: -	BY: -
DESCRIPTION: -		
NO. 5	DATE: -	BY: -
DESCRIPTION: -		
NO. 6	DATE: -	BY: -
DESCRIPTION: -		

DATE: 9/13/2017	SCALE: 1" = 20'
PROJECT MANAGER: JDS	PROJECT NO.: -
DRAWN BY: -	DRAWING FILE: -

PROPOSED COFFEE SHOP
209 GLENEAGLE GATE VIEW
COLORADO SPRINGS, CO

CLIENT:
VERTICAL CONSTRUCTION MANAGEMENT
1209 SOUTH WHITE CHAPEL BLVD, SUITE 180
SOUTHLAKE, TX 76092

TEL: (817) 527-8421

SHEET TITLE:
EROSION AND STORMWATER
QUALITY CONTROL PLAN

SHEET NUMBER:

7 OF 21

COUNTY PROJECT NUMBER PPR-17-030

GENERAL NOTES

1. REFER TO SHEET C100, C101, C304, AND C402 FOR ADDITIONAL PROJECT NOTES.
2. THE OWNER, SITE DEVELOPER, CONTRACTOR AND/OR THEIR AUTHORIZED AGENTS SHALL REMOVE ALL SEDIMENT, MUD, CONSTRUCTION DEBRIS, OR OTHER POTENTIAL POLLUTANTS THAT MAY HAVE BEEN DISCHARGED TO OR, ACCUMULATE IN, THE FLOWLINES AND PUBLIC RIGHTS OF WAYS OF THE CITY AS A RESULT OF CONSTRUCTION ACTIVITIES ASSOCIATED WITH THIS SITE DEVELOPMENT OR CONSTRUCTION PROJECT. SAID REMOVAL SHALL BE CONDUCTED IN A TIMELY MANNER.
3. ADDITIONAL EROSION AND SEDIMENT CONTROL MEASURES MAY BE REQUIRED OF THE OWNER AND HIS OR HER AGENTS DUE TO UNFORESEEN EROSION PROBLEMS OR IF THE PLAN AS SUBMITTED AND APPROVED DOES NOT FUNCTION AS INTENDED. THE REQUIREMENTS OF THIS PLAN SHALL BE THE OBLIGATION OF THE LAND OWNER AND/OR HIS SUCCESSORS OR HEIRS; UNTIL SUCH TIME AS THE PLAN IS PROPERLY COMPLETED, MODIFIED, OR VOIDED.
4. THE CONTRACTOR SHALL PREVENT SEDIMENT, DEBRIS AND ALL OTHER POLLUTANTS FROM ENTERING THE STORM SEWER SYSTEM DURING ALL DEMOLITION, EXCAVATION, TRENCHING, BORING, GRADING OR OTHER CONSTRUCTION OPERATIONS THAT ARE PART OF THIS PROJECT. THE CONTRACTOR SHALL BE HELD RESPONSIBLE FOR REMEDIATION OF ANY ADVERSE IMPACTS TO ADJACENT WATERWAYS, WETLANDS, ETC., RESULTING FROM WORK DONE AS PART OF THIS PROJECT.
5. THE CONTRACTOR SHALL LOCATE, INSTALL, AND MAINTAIN ALL EROSION CONTROL AND WATER QUALITY "BEST MANAGEMENT PRACTICES" AS INDICATED ON THE APPROVED PLAN.
6. THE DEVELOPER, GENERAL CONTRACTOR, GRADING CONTRACTOR AND/OR THEIR AUTHORIZED AGENTS SHALL INSURE THAT ALL LOADS OF CUT AND FILL MATERIAL IMPORTED TO OR EXPORTED FROM THIS SITE SHALL BE PROPERLY COVERED TO PREVENT LOSS OF THE MATERIAL DURING TRANSPORT ON PUBLIC RIGHTS OF WAYS.
7. THE USE OF REBAR, STEEL STAKES, OR STEEL FENCE POSTS TO STAKE DOWN STRAW OR HAY BALES; OR TO SUPPORT SILT FENCING USED AS AN EROSION CONTROL MEASURE; IS PROHIBITED. THE USE OF OSHA APPROVED COLORED WARNING CAPS ON REBAR OR FENCE POSTS USED WITH EROSION CONTROL MEASURES IS NOT ACCEPTABLE.
8. APPROVED EROSION AND SEDIMENT CONTROL "BEST MANAGEMENT PRACTICES" (BMP) SHALL BE MAINTAINED AND KEPT IN GOOD REPAIR FOR THE DURATION OF THIS PROJECT. AT A MINIMUM, THE CONTRACTOR OR HIS AGENT SHALL INSPECT ALL BMPS WEEKLY AND WITHIN 24 HOURS AFTER SIGNIFICANT PRECIPITATION EVENTS. ALL NECESSARY MAINTENANCE AND REPAIR SHALL BE COMPLETED IN A TIMELY MANNER. SEDIMENT WILL BE REMOVED AND DEVICES REPAIRED AS SOON AS PRACTICABLE. ACCUMULATED SEDIMENT AND DEBRIS SHALL BE REMOVED FROM A BMP WHEN THE SEDIMENT LEVEL REACHES ONE HALF THE HEIGHT OF THE BMP, AT ANY TIME THAT SEDIMENT OR DEBRIS ADVERSELY IMPACTS THE FUNCTIONING OF THE BMP, OR IN ACCORDANCE WITH LOCAL, STATE, AND FEDERAL REGULATIONS. ALL INSPECTION, MAINTENANCE, AND REPAIR PRACTICES SHALL MEET APPLICABLE LOCAL, STATE, AND FEDERAL REGULATIONS.
9. THE CONTRACTOR SHALL PROVIDE CONTROL MEASURES TO PREVENT OR MINIMIZE THE IMPACT TO RECEIVING WATERS BY THE PLANS. THE CONTRACTOR SHALL EFFECTIVELY PREVENT AND CONTROL EROSION AND SEDIMENTATION ON CONSTRUCTION SITES AT THE EARLIEST PRACTICABLE TIME. IN GENERAL, CONTROL MEASURES WILL BE IMPLEMENTED PRIOR TO THE COMMENCEMENT OF EACH CONSTRUCTION OPERATION OR IMMEDIATELY AFTER THE AREA HAS BEEN DISTURBED. CONSTRUCTION STAGING AREAS AND VEHICLE MAINTENANCE ACTIVITIES SHALL BE MANAGED AND CONTROLLED SO AS TO MINIMIZE THE RUNOFF OF POLLUTANTS. DISTURBANCE OF VEGETATION SHALL BE MINIMIZED AND LIMITED TO ONLY WHAT IS SHOWN ON THE CONSTRUCTION PLANS. ALL EROSION, SEDIMENT AND WATER POLLUTION CONTROLS WILL BE MAINTAINED IN GOOD WORKING ORDER.
10. WATER USED IN THE CLEANING OF CEMENT TRUCK DELIVERY CHUTES SHALL BE DISCHARGED INTO A PREDEFINED, CONTAINMENT AREA ON THE JOB SITE. THE DISCHARGE OF WATER CONTAINING CEMENT TO THE STORM SEWER SYSTEM IS PROHIBITED.
11. THE CONTRACTOR SHALL PROTECT ALL STORM SEWER FACILITIES ADJACENT TO ANY LOCATION WHERE PAVEMENT CUTTING OPERATIONS INVOLVING WHEEL CUTTING, SAW CUTTING OR ABRASIVE WATER JET CUTTING ARE TO TAKE PLACE. THE CONTRACTOR SHALL REMOVE AND PROPERLY DISPOSE OF ALL WASTE PRODUCTS GENERATED BY SAID CUTTING OPERATIONS ON A DAILY BASIS. THE DISCHARGE OF ANY WATER CONTAMINATED BY WASTE PRODUCTS FROM CUTTING OPERATIONS TO THE STORM SEWER SYSTEM IS PROHIBITED.
12. PAVED SURFACES WHICH ARE ADJACENT TO CONSTRUCTION SITES SHALL BE SWEEPED IN A TIMELY MANNER WHEN SEDIMENT AND OTHER MATERIALS ARE TRACKED OR DISCHARGED ON TO THEM. EITHER SWEEPING BY HAND OR USE OF STREET SWEEPERS IS ACCEPTABLE. STREET SWEEPERS USING WATER WHILE SWEEPING IS PREFERRED IN ORDER TO MINIMIZE DUST. FLUSHING OFF PAVED SURFACES WITH WATER IS PROHIBITED.
13. THE CONTRACTOR SHALL PROVIDE A DETAILED CONSTRUCTION SCHEDULE. THE SCHEDULE SHALL INCLUDE ALL MAJOR CONSTRUCTION ACTIVITIES AS WELL AS THE INSTALLATION OF PROPOSED EROSION CONTROL MEASURES, SEDIMENT/POLLUTANT CONTROL MEASURES, INTERIM AND FINAL SITE STABILIZATION MEASURES, PERMANENT EROSION PREVENTION MEASURES, AND PERMANENT WATER QUALITY ENHANCEMENT FACILITIES.
14. THE CONTRACTOR SHALL SUBMIT A SPILL PREVENTION AND MANAGEMENT PLAN. THE PLAN SHALL IDENTIFY THE MEASURES PROPOSED TO PREVENT THE DISCHARGE OF POLLUTANTS RESULTING FROM SPILLS AND EXPEDITE THE CLEANUP AND PROPER DISPOSAL OF SOILS CONTAMINATED BY CHEMICAL, PETROLEUM OR HAZARDOUS MATERIALS.
15. EXPOSURE OF SPOIL PILES CREATED DURING UTILITY TRENCHING SHOULD BE MINIMIZED. LOCATION OF SPOIL PILES SHOULD BE ON THE UPHILL SIDE OF THE TRENCH AND OUT OF THE WAY OF VISIBLE DRAINAGE PATHS.
16. STOCKPILES AND AREAS DISTURBED BY GRADING OPERATIONS SHALL BE STABILIZED FROM WIND AND WATER EROSION THROUGH THE USE OF A LAYER OF SUITABLE MULCH, TEMPORARY REVEGETATION, OR EROSION CONTROL MATTING/GEOTEXTILES AT A MINIMUM. ANY OF THESE METHODS SHALL BE APPLIED AT TIMES AND FREQUENCIES IN ACCORDANCE WITH LOCAL, STATE, AND FEDERAL REGULATIONS: (1) TO DISTURBED AREAS AND STOCKPILES AFTER FINAL GRADING IS REACHED, (2) TO DISTURBED AREAS WHICH MAY NOT BE AT FINAL GRADE, BUT WHICH WILL REMAIN DORMANT, AND (3) TO STOCKPILE CONSTRUCTION ON ANY STOCKPILE WHICH WILL REMAIN DORMANT. SAID STABILIZATION PRACTICES SHALL BE APPLIED PER MANUFACTURER AND/OR SUPPLIER RECOMMENDATIONS AND SHALL BE TACKED OR FASTENED BY AN APPROVED METHOD SUITABLE FOR THE TYPE OF PRODUCT USED.

BMP MAINTENANCE NOTE

ALL EROSION AND SEDIMENT CONTROL PRACTICES AND OTHER PROTECTIVE MEASURES IDENTIFIED IN THE SWMP MUST BE MAINTAINED IN EFFECTIVE OPERATING CONDITION. PROPER SELECTION AND INSTALLATION OF BMPS AND IMPLEMENTATION OF COMPREHENSIVE INSPECTION AND MAINTENANCE PROCEDURES, IN ACCORDANCE WITH THE SWMP, SHOULD BE ADEQUATE TO MEET THIS CONDITION. BMPS THAT ARE NOT ADEQUATELY MAINTAINED IN ACCORDANCE WITH GOOD ENGINEERING, HYDROLOGIC AND POLLUTION CONTROL PRACTICES, INCLUDING REMOVAL OF COLLECTED SEDIMENT OUTSIDE THE ACCEPTABLE TOLERANCES OF THE BMPS, ARE CONSIDERED TO BE NO LONGER OPERATING EFFECTIVELY AND MUST BE ADDRESSED.

ACADEMY GATEWAY SUBDIVISION FILING NO. 1 LOT 2

A SUBDIVISION OF A PORTION OF THE SOUTHEAST QUARTER OF SECTION 1,
TOWNSHIP 12 SOUTH, RANGE 67 AND THE SOUTHWEST QUARTER OF SECTION 6
TOWNSHIP 12 SOUTH RANGE 66, ALL WEST OF THE SIXTH PRINCIPAL
MERIDIAN, EL PASO COUNTY, COLORADO
MAJOR SITE DEVELOPMENT PLAN

EL PASO COUNTY STANDARD NOTES FOR GRADING AND EROSION CONTROL PLANS

1. CONSTRUCTION MAY NOT COMMENCE UNTIL A CONSTRUCTION PERMIT IS OBTAINED FROM PLANNING AND COMMUNITY DEVELOPMENT (PCD) AND A PRECONSTRUCTION CONFERENCE IS HELD WITH PCD INSPECTIONS.
2. STORMWATER DISCHARGES FROM CONSTRUCTION SITES SHALL NOT CAUSE OR THREATEN TO CAUSE POLLUTION, CONTAMINATION, OR DEGRADATION OF STATE WATERS. ALL WORK AND EARTH DISTURBANCE SHALL BE DONE IN A MANNER THAT MINIMIZES POLLUTION OF ANY ON-SITE OR OFF SITE WATERS, INCLUDING WETLANDS.
3. NOTWITHSTANDING ANYTHING DEPICTED IN THESE PLANS IN WORDS OR GRAPHIC REPRESENTATION, ALL DESIGN AND CONSTRUCTION RELATED TO ROADS, STORM DRAINAGE AND EROSION CONTROL SHALL CONFORM TO THE STANDARDS AND REQUIREMENTS OF THE MOST RECENT VERSION OF THE RELEVANT ADOPTED EL PASO COUNTY STANDARDS, INCLUDING THE LAND DEVELOPMENT CODE, THE ENGINEERING CRITERIA MANUAL, THE DRAINAGE CRITERIA MANUAL, AND THE DRAINAGE CRITERIA MANUAL VOLUME 2. ANY DEVIATIONS TO REGULATIONS AND STANDARDS MUST BE REQUESTED, AND APPROVED, IN WRITING.
4. A SEPARATE STORMWATER MANAGEMENT PLAN (SMWP) FOR THIS PROJECT SHALL BE COMPLETED AND AN EROSION AND STORMWATER QUALITY CONTROL PERMIT (ESQCP) ISSUED PRIOR TO COMMENCING CONSTRUCTION. DURING CONSTRUCTION THE SWMP IS THE RESPONSIBILITY OF THE DESIGNATED STORMWATER MANAGER, SHALL BE LOCATED ON SITE AT ALL TIMES AND SHALL BE KEPT UP TO DATE WITH WORK PROGRESS AND CHANGES IN THE FIELD.
5. ONCE THE ESQCP HAS BEEN ISSUED, THE CONTRACTOR MAY INSTALL THE INITIAL STAGE EROSION AND SEDIMENT CONTROL BMPS AS INDICATED ON THE GEC. A PRECONSTRUCTION MEETING BETWEEN THE CONTRACTOR, ENGINEER, AND EL PASO COUNTY WILL BE HELD PRIOR TO ANY CONSTRUCTION. IT IS THE RESPONSIBILITY OF THE APPLICANT TO COORDINATE THE MEETING TIME AND PLACE WITH COUNTY DS INSPECTIONS STAFF.
6. SOIL EROSION CONTROL MEASURES FOR ALL SLOPES, CHANNELS, DITCHES, OR ANY DISTURBED LAND AREA SHALL BE COMPLETED WITHIN 21 CALENDAR DAYS AFTER FINAL GRADING, OR FINAL EARTH DISTURBANCE, HAS BEEN COMPLETED. DISTURBED AREAS AND STOCKPILES WHICH ARE NOT AT FINAL GRADE BUT WILL REMAIN DORMANT FOR LONGER THAN 30 DAYS SHALL ALSO BE MULCHED WITHIN 21 DAYS AFTER INTERIM GRADING. AN AREA THAT IS GOING TO REMAIN IN AN INTERIM STATE FOR MORE THAN 60 DAYS SHALL ALSO BE SEEDED. ALL TEMPORARY SOIL EROSION CONTROL MEASURES AND BMPS SHALL BE MAINTAINED UNTIL PERMANENT SOIL EROSION CONTROL MEASURES ARE IMPLEMENTED AND ESTABLISHED.
7. TEMPORARY SOIL EROSION CONTROL FACILITIES SHALL BE REMOVED AND EARTH DISTURBANCE AREAS GRADED AND STABILIZED WITH PERMANENT SOIL EROSION CONTROL MEASURES PURSUANT TO STANDARDS AND SPECIFICATION PRESCRIBED IN THE DCM VOLUME II AND THE ENGINEERING CRITERIA MANUAL (ECM) APPENDIX I.
8. ALL PERSONS ENGAGED IN EARTH DISTURBANCE SHALL IMPLEMENT AND MAINTAIN ACCEPTABLE SOIL EROSION AND SEDIMENT CONTROL MEASURES INCLUDING BMPS IN CONFORMANCE WITH THE EROSION CONTROL TECHNICAL STANDARDS OF THE DRAINAGE CRITERIA MANUAL (DCM) VOLUME II AND IN ACCORDANCE WITH THE STORMWATER MANAGEMENT PLAN (SWMP).
9. ALL TEMPORARY EROSION CONTROL FACILITIES INCLUDING BMPS AND ALL PERMANENT FACILITIES INTENDED TO CONTRA EROSION OF ANY EARTH DISTURBANCE OPERATIONS, SHALL BE INSTALLED AS DEFINED IN THE APPROVED PLANS. THE SWMP AND THE DCM VOLUME II AND MAINTAINED THROUGHOUT THE DURATION OF THE EARTH DISTURBANCE OPERATION.
10. ANY EARTH DISTURBANCE SHALL BE CONDUCTED IN SUCH A MANNER SO AS TO EFFECTIVELY REDUCE ACCELERATED SOIL EROSION AND RESULTING SEDIMENTATION. ALL DISTURBANCES SHALL BE DESIGNED, CONSTRUCTED, AND COMPLETED SO THAT THE EXPOSED AREA OF ANY DISTURBED LAND SHALL BE LIMITED TO THE SHORTEST PRACTICAL PERIOD OF TIME.
11. ANY TEMPORARY OR PERMANENT FACILITY DESIGNED AND CONSTRUCTED FOR THE CONVEYANCE OF STORMWATER AROUND, THROUGH, OR FROM THE EARTH DISTURBANCE AREA SHALL BE DESIGNED TO LIMIT THE DISCHARGE TO A NON-EROSIVE VELOCITY.
12. CONCRETE WASH WATER SHALL BE CONTAINED AND DISPOSED OF IN ACCORDANCE WITH THE SWMP. NO WASH WATER SHALL BE DISCHARGED TO OR ALLOWED TO RUNOFF TO STATE WATERS, INCLUDING ANY SURFACE OR SUBSURFACE STORM DRAINAGE SYSTEM OR FACILITIES.
13. EROSION CONTROL BLANKETING IS TO BE USED ON SLOPES STEEPER THAN 3:1.
14. BUILDING, CONSTRUCTION, EXCAVATION, OR OTHER WASTE MATERIALS SHALL NOT BE TEMPORARILY PLACED OR STORED IN THE STREET, ALLEY, OR OTHER PUBLIC WAY, UNLESS IN ACCORDANCE WITH AN APPROVED TRAFFIC CONTROL PLAN. BMPS MAY BE REQUIRED BY EL PASO COUNTY ENGINEERING IF DEEMED NECESSARY, BASED ON SPECIFIC CONDITIONS AND CIRCUMSTANCES.
15. VEHICLE TRACKING OF SOILS AND CONSTRUCTION DEBRIS OFF-SITE SHALL BE MINIMIZED. MATERIALS TRACKED OFFSITE SHALL BE CLEANED UP AND PROPERLY DISPOSED OF IMMEDIATELY.
16. CONTRACTOR SHALL BE RESPONSIBLE FOR THE REMOVAL OF ALL WASTES FROM THE CONSTRUCTION SITE FOR DISPOSAL IN ACCORDANCE WITH LOCAL AND STATE REGULATORY REQUIREMENTS. NO CONSTRUCTION DEBRIS, TREE SLASH, BUILDING MATERIAL WASTES OR UNUSED BUILDING MATERIALS SHALL BE BURIED, DUMPED, OR DISCHARGED AT THE SITE.
17. THE OWNER, SITE DEVELOPER, CONTRACTOR, AND/OR THEIR AUTHORIZED AGENTS SHALL BE RESPONSIBLE FOR THE REMOVAL OF ALL CONSTRUCTION DEBRIS, DIRT, TRASH, ROCK, SEDIMENT, AND SAND THAT MAY ACCUMULATE IN THE STORM SEWER OR OTHER DRAINAGE CONVEYANCE SYSTEM AND STORMWATER APPURTENANCES AS A RESULT OF SITE DEVELOPMENT.
18. THE QUANTITY OF MATERIALS STORED ON THE PROJECT SITE SHALL BE LIMITED, AS MUCH AS PRACTICAL, TO THAT QUANTITY REQUIRED TO PERFORM THE WORK IN AN ORDERLY SEQUENCE. ALL MATERIALS STORED ON-SITE SHALL BE STORED IN A NEAT, ORDERLY MANNER, IN THEIR ORIGINAL CONTAINERS, WITH ORIGINAL MANUFACTURER'S LABELS.
19. NO CHEMICALS ARE TO BE USED BY THE CONTRACTOR, WHICH HAVE THE POTENTIAL TO BE RELEASED IN STORMWATER UNLESS PERMISSION FOR THE USE OF A SPECIFIC CHEMICAL IS GRANTED IN WRITING BY THE ECM ADMINISTRATOR. IN GRANTING THE USE OF SUCH CHEMICALS, SPECIAL CONDITIONS AND MONITORING MAY BE REQUIRED.
20. BULK STORAGE STRUCTURES FOR PETROLEUM PRODUCTS AND OTHER CHEMICALS SHALL HAVE ADEQUATE PROTECTION SO AS TO CONTAIN ALL SPILLS AND PREVENT ANY SPILLED MATERIAL FROM ENTERING STATE WATERS, INCLUDING ANY SURFACE OR SUBSURFACE STORM DRAINAGE SYSTEM OR FACILITIES.
21. NO PERSON SHALL CAUSE THE IMPEDIMENT OF STORMWATER FLOW IN THE FLOW LINE OF THE CURB AND GUTTER OR IN THE DITCHLINE.
22. INDIVIDUALS SHALL COMPLY WITH THE "COLORADO WATER QUALITY CONTROL ACT" (TITLE 25, ARTICLE 8, CRS), AND THE "CLEAN WATER ACT" (33 USC 1344), IN ADDITION TO THE REQUIREMENTS INCLUDED IN THE DCM VOLUME II AND THE ECM APPENDIX I. ALL APPROPRIATE PERMITS MUST BE OBTAINED BY THE CONTRACTOR PRIOR TO CONSTRUCTION (NPDES, FLOODPLAIN, 404, FUGITIVE DUST, ETC.). IN THE EVENT OF CONFLICTS BETWEEN THESE REQUIREMENTS AND LAWS, RULES, OR REGULATIONS OF OTHER FEDERAL, STATE, OR COUNTY AGENCIES, THE MORE RESTRICTIVE LAWS, RULES, OR REGULATIONS SHALL APPLY.
23. ALL CONSTRUCTION TRAFFIC MUST ENTER/EXIT THE SITE AT APPROVED CONSTRUCTION ACCESS POINTS.
24. PRIOR TO ACTUAL CONSTRUCTION THE PERMITEE SHALL VERIFY THE LOCATION OF EXISTING UTILITIES.
24. A WATER SOURCE SHALL BE AVAILABLE ON SITE DURING EARTHWORK OPERATIONS AND UTILIZED AS REQUIRED TO MINIMIZE DUST FROM EARTHWORK EQUIPMENT AND WIND.
25. THE SOILS REPORT FOR THIS SITE HAS BEEN PREPARED BY ENTECH ENGINEERING, INC. AND SHALL BE CONSIDERED A PART OF THESE PLANS.
26. AT LEAST TEN DAYS PRIOR TO THE ANTICIPATED START OF CONSTRUCTION, FOR PROJECTS THAT WILL DISTURB 1 ACRE OR MORE, THE OWNER OR OPERATOR OF CONSTRUCTION ACTIVITY SHALL SUBMIT A PERMIT APPLICATION FOR STORMWATER DISCHARGE TO THE COLORADO DEPARTMENT OF PUBLIC HEALTH AND ENVIRONMENT, WATER QUALITY DIVISION. THE APPLICATION CONTAINS CERTIFICATION OF COMPLETION OF A STORMWATER MANAGEMENT PLAN (SWMP), OF WHICH THIS GRADING AND EROSION CONTROL PLAN MAY BE A PART. FOR INFORMATION OR APPLICATION MATERIALS CONTACT:

COLORADO DEPARTMENT OF PUBLIC HEALTH AND ENVIRONMENT
WATER QUALITY CONTROL DIVISION
WCDD - PERMITS
4300 CHERRY CREEK DRIVE SOUTH
DENVER, CO 80246-1530
ATTN: PERMITS UNIT

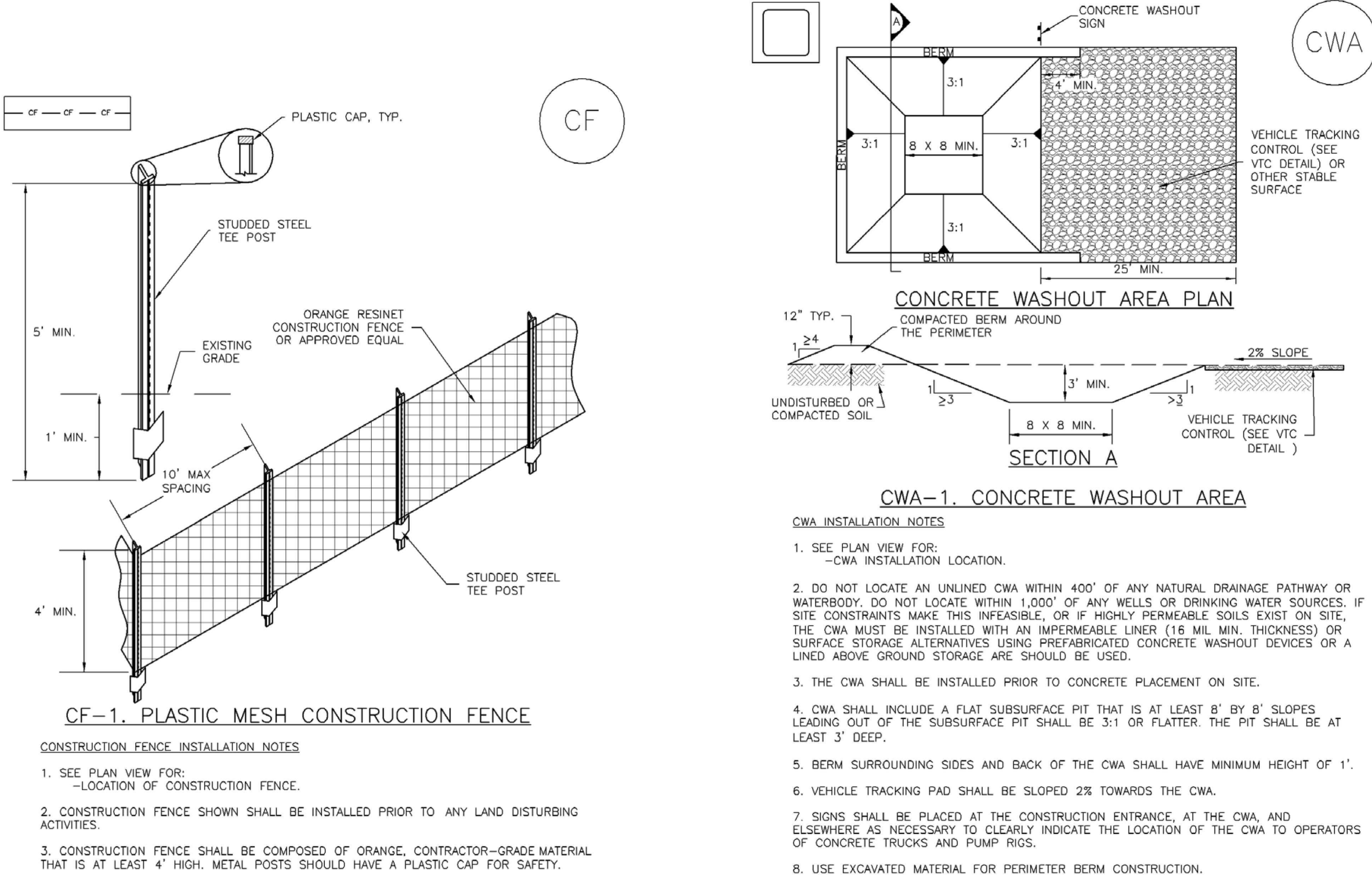

CWA MAINTENANCE NOTES

1. INSPECT BMPs EACH WORKDAY, AND MAINTAIN THEM IN EFFECTIVE OPERATING CONDITION. MAINTENANCE OF BMPS SHOULD BE PROACTIVE, NOT REACTIVE. INSPECT BMPS AS SOON AS POSSIBLE (AND ALWAYS WITHIN 24 HOURS) FOLLOWING A STORM THAT CAUSES SURFACE EROSION, AND PERFORM NECESSARY MAINTENANCE.
2. FREQUENT OBSERVATIONS AND MAINTENANCE ARE NECESSARY TO MAINTAIN BMPS IN EFFECTIVE OPERATING CONDITION. INSPECTIONS AND CORRECTIVE MEASURES SHOULD BE DOCUMENTED THOROUGHLY.
3. WHERE BMPS HAVE FAILED, REPAIR OR REPLACEMENT SHOULD BE INITIATED UPON DISCOVERY OF THE FAILURE.
4. THE CWA SHALL BE REPAIRED, CLEANED, OR ENLARGED AS NECESSARY TO MAINTAIN CAPACITY FOR CONCRETE WASTE. CONCRETE MATERIALS, ACCUMULATED IN PIT, SHALL BE REMOVED ONCE THE MATERIALS HAVE REACHED A DEPTH OF 2'.
5. CONCRETE WASHOUT WATER, WASTED PIECES OF CONCRETE AND ALL OTHER DEBRIS IN THE SUBSURFACE PIT SHALL BE TRANSPORTED FROM THE JOB SITE IN A WATER-TIGHT CONTAINER AND DISPOSED OF PROPERLY.
6. THE CWA SHALL REMAIN IN PLACE UNTIL ALL CONCRETE FOR THE PROJECT IS PLACED.
7. WHEN THE CWA IS REMOVED, COVER THE DISTURBED AREA WITH TOP SOIL, SEED AND MULCH OR OTHERWISE STABILIZED IN A MANNER APPROVED BY THE LOCAL JURISDICTION.

(DETAIL ADAPTED FROM DOUGLAS COUNTY, COLORADO AND THE CITY OF PARKER, COLORADO, NOT AVAILABLE IN AUTOCAD).

NOTE: MANY JURISDICTIONS HAVE BMP DETAILS THAT VARY FROM UDFCD STANDARD DETAILS. CONSULT WITH LOCAL JURISDICTIONS AS TO WHICH DETAIL SHOULD BE USED WHEN DIFFERENCES ARE NOTED.



2009 W. Littleton Blvd. #900
Littleton, CO 80130
303.794.4727 ph
www.SterlingDesignAssociates.com

PREPARED UNDER THE DIRECT SUPERVISION OF
JOSEPH G. SCHIEL, P.E.
COLORADO REGISTRATION 0048332
FOR & ON BEHALF OF STERLING DESIGN ASSOCIATES, LLC



STERLING DESIGN ASSOCIATES, LLC			
ISSUES & REVISIONS			
NO.:	1	DATE: 5/16/2017	BY: JDS
DESCRIPTION: 1ST MAJOR SDP SUBMITTAL			
NO.:	2	DATE: 8/24/2017	BY: JDS
DESCRIPTION: 2ND MAJOR SDP SUBMITTAL			
NO.:	3	DATE: 9/13/2017	BY: JDS
DESCRIPTION: 3RD MAJOR SDP SUBMITTAL			
NO.:	4	DATE: -	BY: -
DESCRIPTION: -			
NO.:	5	DATE: -	BY: -
DESCRIPTION: -			
NO.:	6	DATE: -	BY: -
DESCRIPTION: -			

DATE:	SCALE:
9/13/2017	1" = 20'
PROJECT MANAGER:	PROJECT NO.:
JDS	-
DRAWN BY:	DRAWING FILE:
-	-

PROJECT:

**PROPOSED COFFEE SHOP
209 GLENEAGLE GATE VIEW
COLORADO SPRINGS, CO**

TEL: (817) 527-8421

CUSTOMER:

VERTICAL CONSTRUCTION MANAGEMENT
1209 SOUTH WHITE CHAPEL BLVD, SUITE 180
SOUTHLAKE, TX 76092

SHEET TITLE:

**EROSION AND STORMWATER
QUALITY CONTROL DETAILS**

SHEET NUMBER:

8 OF 21



ACADEMY GATEWAY SUBDIVISION FILING NO. 1 LOT 2
A SUBDIVISION OF A PORTION OF THE SOUTHEAST QUARTER OF SECTION 1,
TOWNSHIP 12 SOUTH, RANGE 67 AND THE SOUTHWEST QUARTER OF SECTION 6
TOWNSHIP 12 SOUTH RANGE 66, ALL WEST OF THE SIXTH PRINCIPAL
MERIDIAN, EL PASO COUNTY, COLORADO
MAJOR SITE DEVELOPMENT PLAN

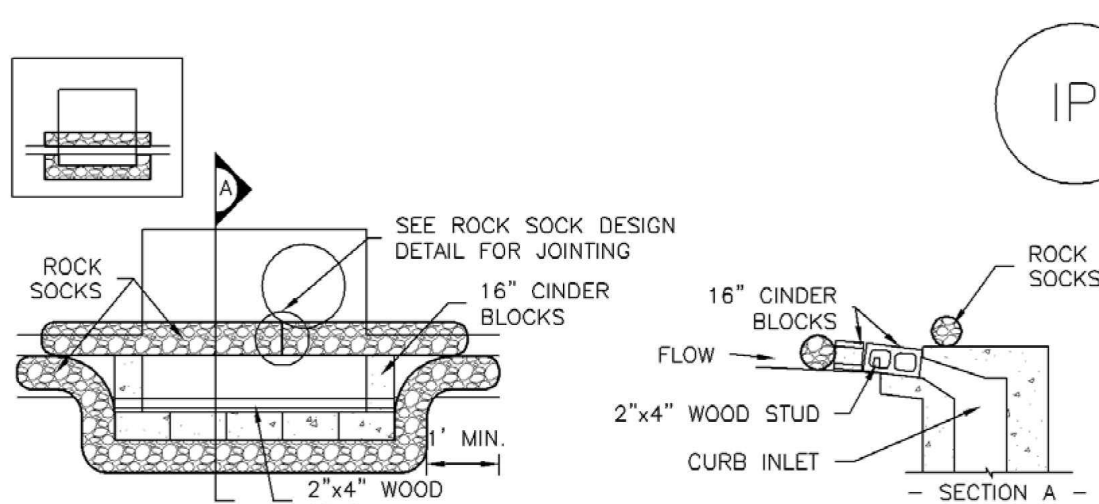

IP-1. BLOCK AND ROCK SOCK SUMP OR ON GRADE
INLET PROTECTION

BLOCK AND CURB SOCK INLET PROTECTION INSTALLATION NOTES

1. SEE ROCK SOCK DESIGN DETAIL FOR INSTALLATION REQUIREMENTS.
2. CONCRETE "CINDER" BLOCKS SHALL BE LAID ON THEIR SIDES AROUND THE INLET IN A SINGLE ROW, ABUTTING ONE ANOTHER WITH THE OPEN END FACING AWAY FROM THE CURB.
3. GRAVEL BAGS SHALL BE PLACED AROUND CONCRETE BLOCKS, CLOSELY ABUTTING ONE ANOTHER AND JOINED TOGETHER IN ACCORDANCE WITH ROCK SOCK DESIGN DETAIL.

INLET PROTECTION MAINTENANCE NOTES

1. INSPECT BMPs EACH WORKDAY, AND MAINTAIN THEM IN EFFECTIVE OPERATING CONDITION. MAINTENANCE OF BMPs SHOULD BE PROACTIVE, NOT REACTIVE. INSPECT BMPs AS SOON AS POSSIBLE (AND ALWAYS WITHIN 24 HOURS) FOLLOWING A STORM THAT CAUSES SURFACE EROSION, AND PERFORM NECESSARY MAINTENANCE.
2. FREQUENT OBSERVATIONS AND MAINTENANCE ARE NECESSARY TO MAINTAIN BMPs IN EFFECTIVE OPERATING CONDITION. INSPECTIONS AND CORRECTIVE MEASURES SHOULD BE DOCUMENTED THOROUGHLY.
3. WHERE BMPs HAVE FAILED, REPAIR OR REPLACEMENT SHOULD BE INITIATED UPON DISCOVERY OF THE FAILURE.
4. SEDIMENT ACCUMULATED UPSTREAM OF INLET PROTECTION SHALL BE REMOVED AS NECESSARY TO MAINTAIN BMP EFFECTIVENESS, TYPICALLY WHEN STORAGE VOLUME REACHES 50% OF CAPACITY, A DEPTH OF 6" WHEN SILT FENCE IS USED, OR $\frac{1}{4}$ OF THE HEIGHT FOR STRAW BALES.
5. INLET PROTECTION IS TO REMAIN IN PLACE UNTIL THE UPSTREAM DISTURBED AREA IS PERMANENTLY STABILIZED, UNLESS THE LOCAL JURISDICTION APPROVES EARLIER REMOVAL OF INLET PROTECTION IN STREETS.
6. WHEN INLET PROTECTION AT AREA INLETS IS REMOVED, THE DISTURBED AREA SHALL BE COVERED WITH TOP SOIL, SEEDED AND MULCHED, OR OTHERWISE STABILIZED IN A MANNER APPROVED BY THE LOCAL JURISDICTION.

(DETAIL ADAPTED FROM TOWN OF PARKER, COLORADO AND CITY OF AURORA, COLORADO, NOT AVAILABLE IN AUTOCAD)

NOTE: MANY JURISDICTIONS HAVE BMP DETAILS THAT VARY FROM UDFCD STANDARD DETAILS. CONSULT WITH LOCAL JURISDICTIONS AS TO WHICH DETAIL SHOULD BE USED WHEN DIFFERENCES ARE NOTED.

NOTE: THE DETAILS INCLUDED WITH THIS FACT SHEET SHOW COMMONLY USED, CONVENTIONAL METHODS OF INLET PROTECTION IN THE DENVER METROPOLITAN AREA. THERE ARE MANY PROPRIETARY INLET PROTECTION METHODS ON THE MARKET. UDFCD NEITHER ENDORSES NOR DISCOURAGES USE OF PROPRIETARY INLET PROTECTION; HOWEVER, IN THE EVENT PROPRIETARY METHODS ARE USED, THE APPROPRIATE DETAIL FROM THE MANUFACTURER MUST BE INCLUDED IN THE SWMP AND THE BMP MUST BE INSTALLED AND MAINTAINED AS SHOWN IN THE MANUFACTURER'S DETAILS.

NOTE: SOME MUNICIPALITIES DISCOURAGE OR PROHIBIT THE USE OF STRAW BALES FOR INLET PROTECTION. CHECK WITH LOCAL JURISDICTION TO DETERMINE IF STRAW BALE INLET PROTECTION IS ACCEPTABLE.

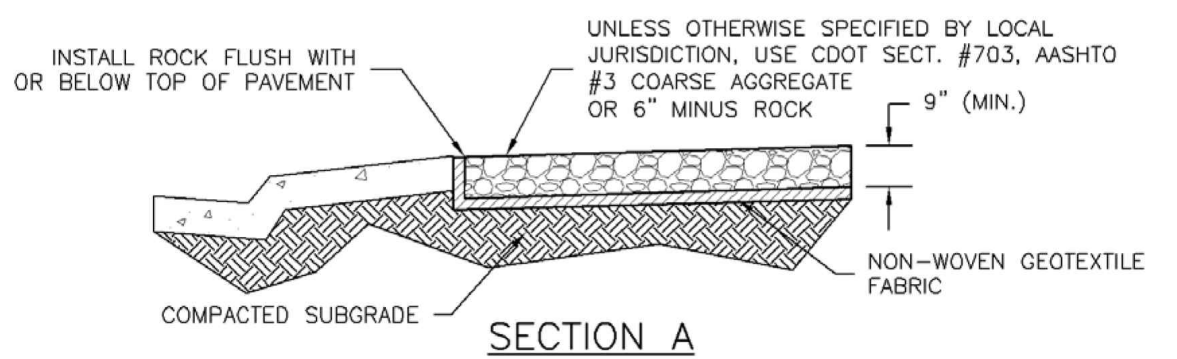
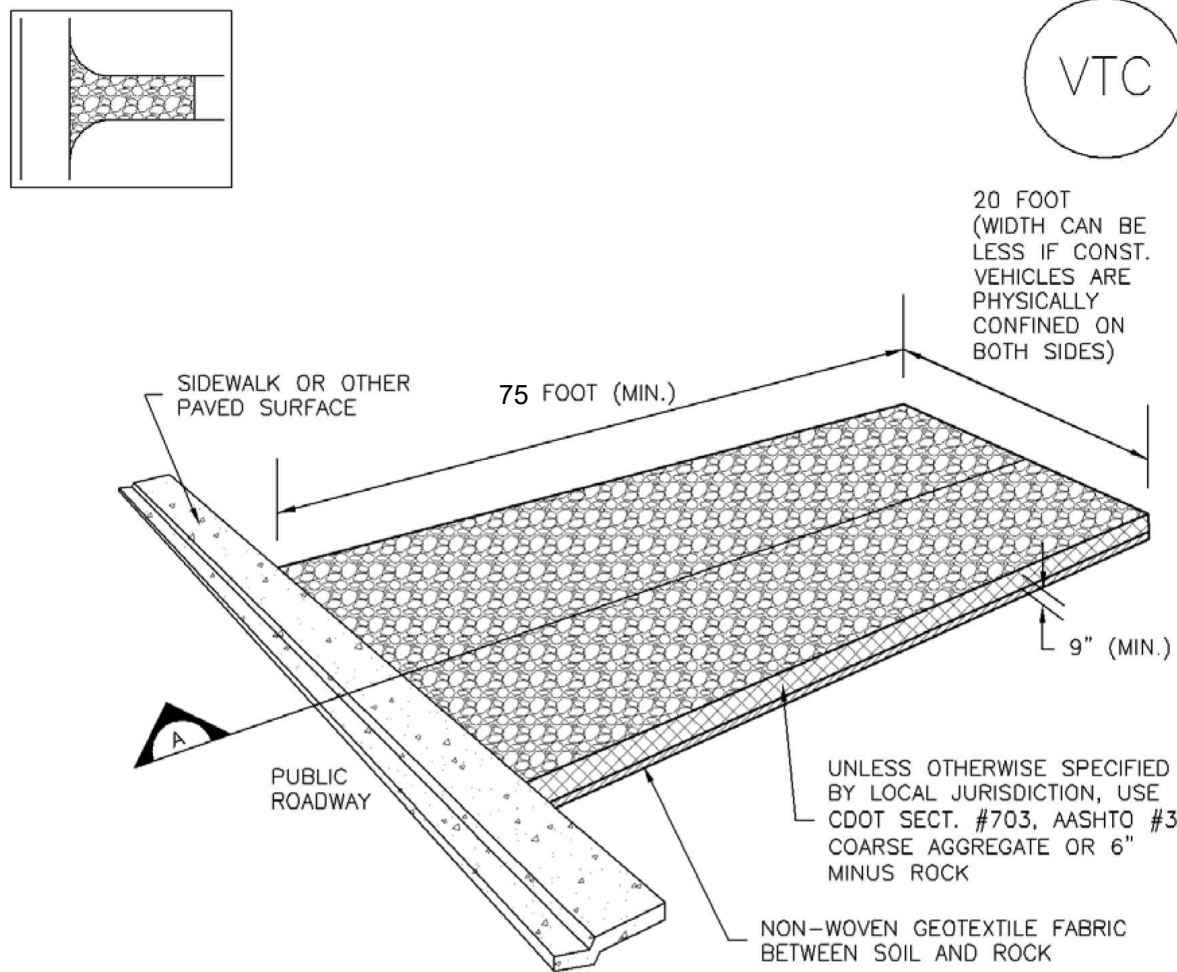

VTC-1. AGGREGATE VEHICLE TRACKING CONTROL

STABILIZED CONSTRUCTION ENTRANCE/EXIT INSTALLATION NOTES

1. SEE PLAN VIEW FOR
-LOCATION OF CONSTRUCTION ENTRANCE(S)/EXIT(S).
-TYPE OF CONSTRUCTION ENTRANCE(S)/EXIT(S) (WITH/WITHOUT WHEEL WASH, CONSTRUCTION MAT OR TRM).
2. CONSTRUCTION MAT OR TRM STABILIZED CONSTRUCTION ENTRANCES ARE ONLY TO BE USED ON SHORT DURATION PROJECTS (TYPICALLY RANGING FROM A WEEK TO A MONTH) WHERE THERE WILL BE LIMITED VEHICULAR ACCESS.
3. A STABILIZED CONSTRUCTION ENTRANCE/EXIT SHALL BE LOCATED AT ALL ACCESS POINTS WHERE VEHICLES ACCESS THE CONSTRUCTION SITE FROM PAVED RIGHT-OF-WAYS.
4. STABILIZED CONSTRUCTION ENTRANCE/EXIT SHALL BE INSTALLED PRIOR TO ANY LAND DISTURBING ACTIVITIES.
5. A NON-WOVEN GEOTEXTILE FABRIC SHALL BE PLACED UNDER THE STABILIZED CONSTRUCTION ENTRANCE/EXIT PRIOR TO THE PLACEMENT OF ROCK.
6. UNLESS OTHERWISE SPECIFIED BY LOCAL JURISDICTION, ROCK SHALL CONSIST OF DOT SECT. #703, AASHTO #3 COARSE AGGREGATE OR 6" (MINUS) ROCK.

STABILIZED CONSTRUCTION ENTRANCE/EXIT MAINTENANCE NOTES

1. INSPECT BMPs EACH WORKDAY, AND MAINTAIN THEM IN EFFECTIVE OPERATING CONDITION. MAINTENANCE OF BMPs SHOULD BE PROACTIVE, NOT REACTIVE. INSPECT BMPs AS SOON AS POSSIBLE (AND ALWAYS WITHIN 24 HOURS) FOLLOWING A STORM THAT CAUSES SURFACE EROSION, AND PERFORM NECESSARY MAINTENANCE.
2. FREQUENT OBSERVATIONS AND MAINTENANCE ARE NECESSARY TO MAINTAIN BMPs IN EFFECTIVE OPERATING CONDITION. INSPECTIONS AND CORRECTIVE MEASURES SHOULD BE DOCUMENTED THOROUGHLY.
3. WHERE BMPs HAVE FAILED, REPAIR OR REPLACEMENT SHOULD BE INITIATED UPON DISCOVERY OF THE FAILURE.
4. ROCK SHALL BE REAPPLIED OR REGRADED AS NECESSARY TO THE STABILIZED ENTRANCE/EXIT TO MAINTAIN A CONSISTENT DEPTH.
5. SEDIMENT TRACKED ONTO PAVED ROADS IS TO BE REMOVED THROUGHOUT THE DAY AND AT THE END OF THE DAY BY SHOVELING OR SWEEPING. SEDIMENT MAY NOT BE WASHED DOWN STORM SEWER DRAINS.

NOTE: MANY JURISDICTIONS HAVE BMP DETAILS THAT VARY FROM UDFCD STANDARD DETAILS. CONSULT WITH LOCAL JURISDICTIONS AS TO WHICH DETAIL SHOULD BE USED WHEN DIFFERENCES ARE NOTED.

(DETAILS ADAPTED FROM CITY OF BROOMFIELD, COLORADO, NOT AVAILABLE IN AUTOCAD)

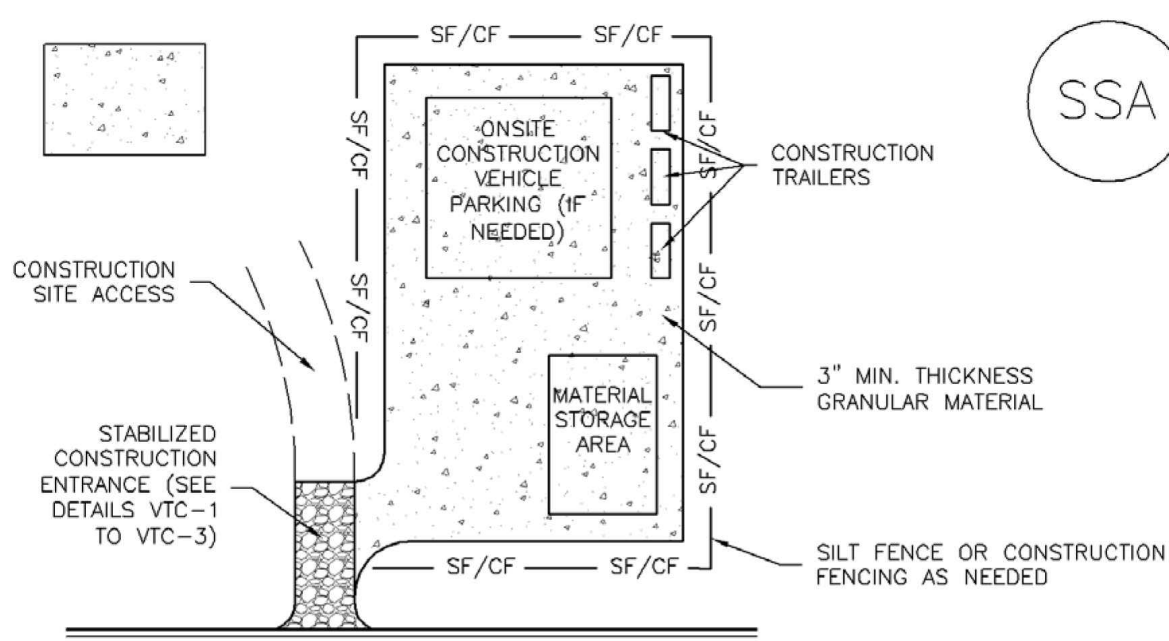

SSA-1. STABILIZED STAGING AREA

STABILIZED STAGING AREA INSTALLATION NOTES

1. SEE PLAN VIEW FOR
-LOCATION OF STAGING AREA(S).
-CONTRACTOR MAY ADJUST LOCATION AND SIZE OF STAGING AREA WITH APPROVAL FROM THE LOCAL JURISDICTION.
2. STABILIZED STAGING AREA SHOULD BE APPROPRIATE FOR THE NEEDS OF THE SITE. OVERSIZING RESULTS IN A LARGER AREA TO STABILIZE FOLLOWING CONSTRUCTION.
3. STAGING AREA SHALL BE STABILIZED PRIOR TO OTHER OPERATIONS ON THE SITE.
4. THE STABILIZED STAGING AREA SHALL CONSIST OF A MINIMUM 3" THICK GRANULAR MATERIAL.
5. UNLESS OTHERWISE SPECIFIED BY LOCAL JURISDICTION, ROCK SHALL CONSIST OF DOT SECT. #703, AASHTO #3 COARSE AGGREGATE OR 6" (MINUS) ROCK.
6. ADDITIONAL PERIMETER BMPs MAY BE REQUIRED INCLUDING BUT NOT LIMITED TO SILT FENCE AND CONSTRUCTION FENCING.

STABILIZED STAGING AREA MAINTENANCE NOTES

1. INSPECT BMPs EACH WORKDAY, AND MAINTAIN THEM IN EFFECTIVE OPERATING CONDITION. MAINTENANCE OF BMPs SHOULD BE PROACTIVE, NOT REACTIVE. INSPECT BMPs AS SOON AS POSSIBLE (AND ALWAYS WITHIN 24 HOURS) FOLLOWING A STORM THAT CAUSES SURFACE EROSION, AND PERFORM NECESSARY MAINTENANCE.
2. FREQUENT OBSERVATIONS AND MAINTENANCE ARE NECESSARY TO MAINTAIN BMPs IN EFFECTIVE OPERATING CONDITION. INSPECTIONS AND CORRECTIVE MEASURES SHOULD BE DOCUMENTED THOROUGHLY.
3. WHERE BMPs HAVE FAILED, REPAIR OR REPLACEMENT SHOULD BE INITIATED UPON DISCOVERY OF THE FAILURE.
4. ROCK SHALL BE REAPPLIED OR REGRADED AS NECESSARY IF RUTTING OCCURS OR UNDERLYING SUBGRADE BECOMES EXPOSED.

STABILIZED STAGING AREA MAINTENANCE NOTES

5. STABILIZED STAGING AREA SHALL BE ENLARGED IF NECESSARY TO CONTAIN PARKING, STORAGE, AND UNLOADING/LOADING OPERATIONS.
6. THE STABILIZED STAGING AREA SHALL BE REMOVED AT THE END OF CONSTRUCTION. THE GRANULAR MATERIAL SHALL BE REMOVED OR, IF APPROVED BY THE LOCAL JURISDICTION, USED ON SITE, AND THE AREA COVERED WITH TOPSOIL, SEEDED AND MULCHED OR OTHERWISE STABILIZED IN A MANNER APPROVED BY LOCAL JURISDICTION.

NOTE: MANY MUNICIPALITIES PROHIBIT THE USE OF RECYCLED CONCRETE AS GRANULAR MATERIAL FOR STABILIZED STAGING AREAS DUE TO DIFFICULTIES WITH RE-ESTABLISHMENT OF VEGETATION IN AREAS WHERE RECYCLED CONCRETE WAS PLACED.

NOTE: MANY JURISDICTIONS HAVE BMP DETAILS THAT VARY FROM UDFCD STANDARD DETAILS. CONSULT WITH LOCAL JURISDICTIONS AS TO WHICH DETAIL SHOULD BE USED WHEN DIFFERENCES ARE NOTED.

(DETAILS ADAPTED FROM DOUGLAS COUNTY, COLORADO, NOT AVAILABLE IN AUTOCAD)

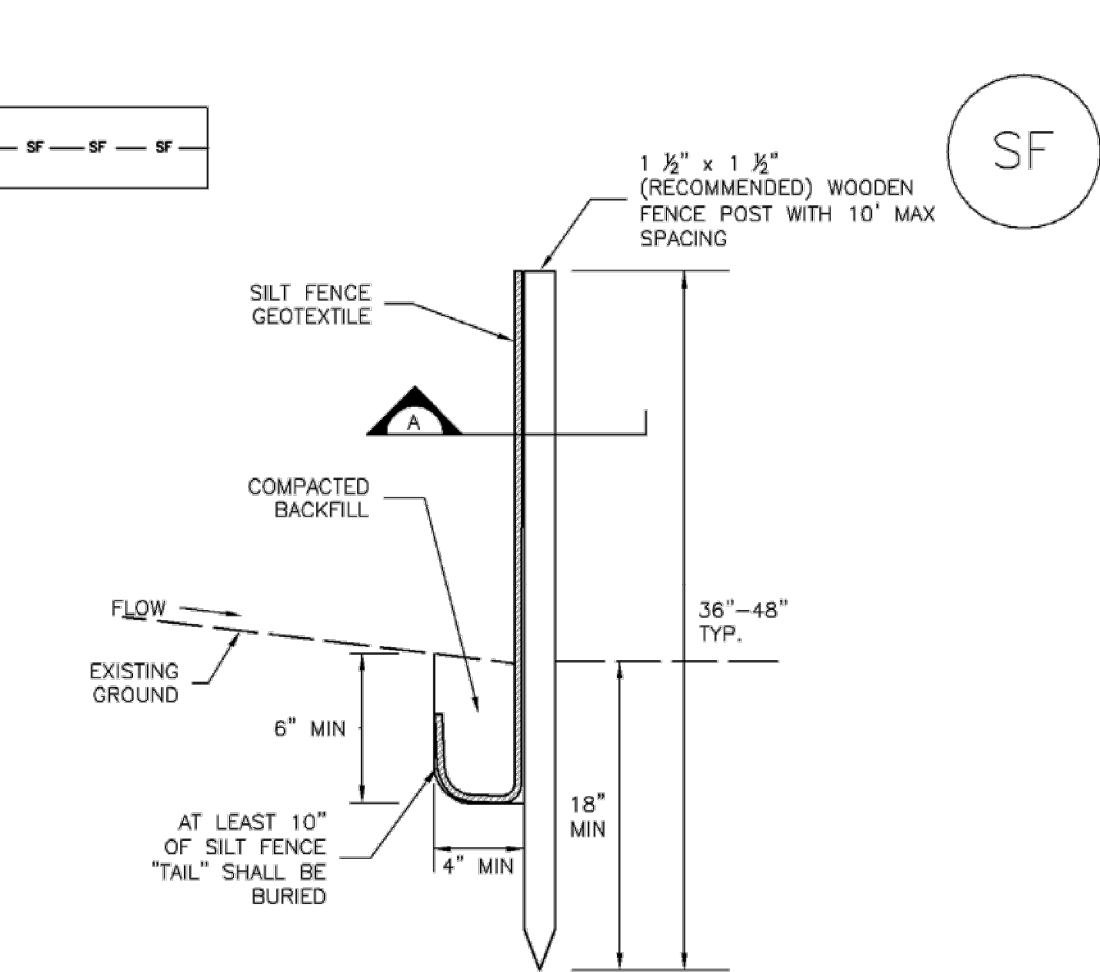

SILT FENCE

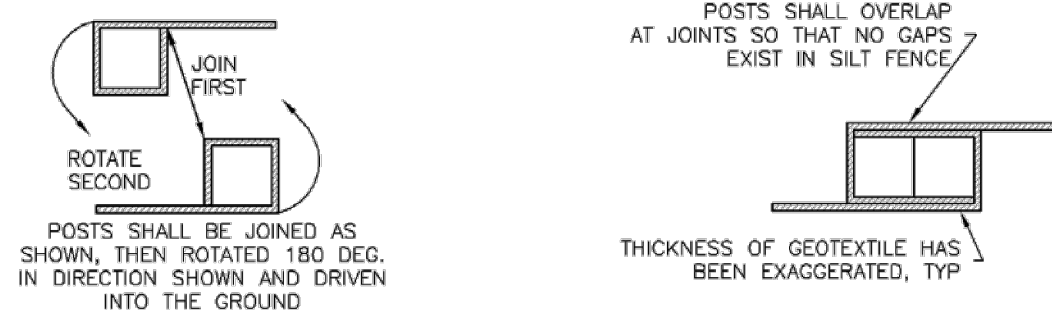

SECTION A

SF-1. SILT FENCE

SILT FENCE INSTALLATION NOTES

1. SILT FENCE MUST BE PLACED AWAY FROM THE TOE OF THE SLOPE TO ALLOW FOR WATER PONDING. SILT FENCE AT THE TOE OF A SLOPE SHOULD BE INSTALLED IN A FLAT LOCATION AT LEAST SEVERAL FEET (2-5 FT) FROM THE TOE OF THE SLOPE TO ALLOW ROOM FOR PONDING AND DEPOSITION.
2. A UNIFORM 6" X 4" ANCHOR TRENCH SHALL BE EXCAVATED USING TRENCHER OR SILT FENCE INSTALLATION DEVICE. NO ROAD GRADERS, BACKHOES, OR SIMILAR EQUIPMENT SHALL BE USED.
3. COMPACT ANCHOR TRENCH BY HAND WITH A "JUMPING JACK" OR BY WHEEL ROLLING. COMPACTION SHALL BE SUCH THAT SILT FENCE RESISTS BEING PULLED OUT OF ANCHOR TRENCH BY HAND.
4. SILT FENCE SHALL BE PULLED TIGHT AS IT IS ANCHORED TO THE STAKES. THERE SHOULD BE NO NOTICEABLE SAG BETWEEN STAKES AFTER IT HAS BEEN ANCHORED TO THE STAKES.
5. SILT FENCE FABRIC SHALL BE ANCHORED TO THE STAKES USING 1" HEAVY DUTY STAPLES OR NAILS WITH 1" HEADS. STAPLES AND NAILS SHOULD BE PLACED 3" ALONG THE FABRIC DOWN THE STAKE.
6. AT THE END OF A RUN OF SILT FENCE ALONG A CONTOUR, THE SILT FENCE SHOULD BE TURNED PERPENDICULAR TO THE CONTOUR TO CREATE A "J-HOOK." THE "J-HOOK" EXTENDING PERPENDICULAR TO THE CONTOUR SHOULD BE OF SUFFICIENT LENGTH TO KEEP RUNOFF FROM FLOWING AROUND THE END OF THE SILT FENCE (TYPICALLY 10' - 20').
7. SILT FENCE SHALL BE INSTALLED PRIOR TO ANY LAND DISTURBING ACTIVITIES.

SILT FENCE MAINTENANCE NOTES

1. INSPECT BMPs EACH WORKDAY, AND MAINTAIN THEM IN EFFECTIVE OPERATING CONDITION. MAINTENANCE OF BMPs SHOULD BE PROACTIVE, NOT REACTIVE. INSPECT BMPs AS SOON AS POSSIBLE (AND ALWAYS WITHIN 24 HOURS) FOLLOWING A STORM THAT CAUSES SURFACE EROSION, AND PERFORM NECESSARY MAINTENANCE.
2. FREQUENT OBSERVATIONS AND MAINTENANCE ARE NECESSARY TO MAINTAIN BMPs IN EFFECTIVE OPERATING CONDITION. INSPECTIONS AND CORRECTIVE MEASURES SHOULD BE DOCUMENTED THOROUGHLY.
3. WHERE BMPs HAVE FAILED, REPAIR OR REPLACEMENT SHOULD BE INITIATED UPON DISCOVERY OF THE FAILURE.
4. SEDIMENT ACCUMULATED UPSTREAM OF THE SILT FENCE SHALL BE REMOVED AS NEEDED TO MAINTAIN THE FUNCTIONALITY OF THE BMP, TYPICALLY WHEN DEPTH OF ACCUMULATED SEDIMENTS IS APPROXIMATELY 6".
5. REPAIR OR REPLACE SILT FENCE WHEN THERE ARE SIGNS OF WEAR, SUCH AS SAGGING, TEARING, OR COLLAPSE.
6. SILT FENCE IS TO REMAIN IN PLACE UNTIL THE UPSTREAM DISTURBED AREA IS STABILIZED AND APPROVED BY THE LOCAL JURISDICTION, OR IS REPLACED BY AN EQUIVALENT PERIMETER SEDIMENT CONTROL BMP.
7. WHEN SILT FENCE IS REMOVED, ALL DISTURBED AREAS SHALL BE COVERED WITH TOPSOIL, SEEDED AND MULCHED OR OTHERWISE STABILIZED AS APPROVED BY LOCAL JURISDICTION.

(DETAIL ADAPTED FROM TOWN OF PARKER, COLORADO AND CITY OF AURORA, NOT AVAILABLE IN AUTOCAD)

NOTE: MANY JURISDICTIONS HAVE BMP DETAILS THAT VARY FROM UDFCD STANDARD DETAILS. CONSULT WITH LOCAL JURISDICTIONS AS TO WHICH DETAIL SHOULD BE USED WHEN DIFFERENCES ARE NOTED.



2009 W. Littleton Blvd. #300
Littleton, CO 80110
303.794.4727 ph
www.SterlingDesignAssociates.com

PREPARED UNDER THE DIRECT SUPERVISION OF
JOSEPH SCHIEL, PE
COLORADO REGISTRATION 0048332
FOR & ON BEHALF OF STERLING DESIGN ASSOCIATES, LLC



STERLING DESIGN ASSOCIATES, LLC

ISSUES & REVISIONS			
NO.:	1	DATE: 5/16/2017	BY: JDS
DESCRIPTION: 1ST MAJOR SDP SUBMITTAL			
NO.:	2	DATE: 8/24/2017	BY: JDS
DESCRIPTION: 2ND MAJOR SDP SUBMITTAL			
NO.:	3	DATE: 9/13/2017	BY: JDS
DESCRIPTION: 3RD MAJOR SDP SUBMITTAL			
NO.:	4	DATE: -	BY: -
DESCRIPTION: -			
NO.:	5	DATE: -	BY: -
DESCRIPTION: -			
NO.:	6	DATE: -	BY: -
DESCRIPTION: -			

DATE:	SCALE:
9/13/2017	1" = 20'
PROJECT MANAGER:	PROJECT NO.:
JDS	-
DRAWN BY:	DRAWING FILE:
-	-

PROJECT:

PROPOSED COFFEE SHOP
209 GLENEAGLE GATE VIEW
COLORADO SPRINGS, CO

CLIENT:

VERTICAL CONSTRUCTION MANAGEMENT
1209 SOUTH WHITE CHAPEL BLVD, SUITE 180
SOUTHLAKE, TX 76092

TEL: (817) 527-8421

SHEET TITLE:

EROSION AND STORMWATER
QUALITY CONTROL DETAILS

SHEET NUMBER:

9 OF 21

COUNTY PROJECT NUMBER PPR-17-030

Temporary and Permanent Seeding (TS/PS) EC-2

Seeding dates for the highest success probability of perennial species along the Front Range are generally in the spring from April through early May and in the fall after the first of September until the ground freezes. If the area is irrigated, seeding may occur in summer months, as well. See Table TS/PS-3 for appropriate seeding dates.

Table TS/PS-1. Minimum Drill Seeding Rates for Various Temporary Annual Grasses

Species* (Common name)	Growth Season ^a	Pounds of Pure Live Seed (PLS)/acre ^c	Planting Depth (inches)
1. Oats	Cool	35 - 50	1 - 2
2. Spring wheat	Cool	25 - 35	1 - 2
3. Spring barley	Cool	25 - 35	1 - 2
4. Annual ryegrass	Cool	10 - 15	½
5. Millet	Warm	3 - 15	½ - ¾
6. Sudangrass	Warm	5 - 10	½ - ¾
7. Sorghum	Warm	5 - 10	½ - ¾
8. Winter wheat	Cool	20 - 35	1 - 2
9. Winter barley	Cool	20 - 35	1 - 2
10. Winter rye	Cool	20 - 35	1 - 2
11. Triticale	Cool	25 - 40	1 - 2

^a Successful seeding of annual grass resulting in adequate plant growth will usually produce enough dead-plant residue to provide protection from wind and water erosion for an additional year. This assumes that the cover is not disturbed or moved closer than 8 inches.

Hydraulic seeding may be substituted for drilling only where slopes are steeper than 3:1 or where access limitations exist. When hydraulic seeding is used, hydraulic mulching should be applied as a separate operation, when practical, to prevent the seeds from being encapsulated in the mulch.

^b See Table TS/PS-3 for seeding dates. Irrigation, if consistently applied, may extend the use of cool season species during the summer months.

^c Seeding rates should be doubled if seed is broadcast, or increased by 50 percent if done using a Brillion Drill or by hydraulic seeding.

Temporary and Permanent Seeding (TS/PS) EC-2

Table TS/PS-2. Minimum Drill Seeding Rates for Perennial Grasses (cont.)

Common Name	Botanical Name	Growth Season ^a	Growth Form	Seeds/Pound	Pounds of PLS/Acre
Sandy Soil Seed Mix					
Blue grama	<i>Bouteloua gracilis</i>	Warm	Sod-forming bunchgrass	825,000	0.5
Camper litle bluestem	<i>Schizachyrium scoparium 'Camper'</i>	Warm	Bunch	240,000	1.0
Prairie sandreed	<i>Calamagrostis longifolia</i>	Warm	Open sod	274,000	1.0
Sand dropseed	<i>Sporobolus cryptandrus</i>	Cool	Bunch	5,290,000	0.25
Vaughn sideoats grama	<i>Bouteloua curtipendula 'Vaughn'</i>	Warm	Sod	191,000	2.0
Arriba western wheatgrass	<i>Agropyron smithii 'Arriba'</i>	Cool	Sod	110,000	5.5
Total					10.25
Heavy Clay, Rocky Foothill Seed Mix					
Mountain rumbly	<i>Muhlenbergia montana</i>	Warm	Bunch	175,000	1.5
Arizona fescue	<i>Festuca arizonica</i>	Cool	Bunch	115,000	5.5
Vaughn sideoats grama ^b	<i>Bouteloua curtipendula 'Vaughn'</i>	Warm	Sod	191,000	2.0
Blue grama	<i>Bouteloua gracilis</i>	Warm	Bunch	130,000	3.0
Arriba western wheatgrass	<i>Agropyron smithii 'Arriba'</i>	Cool	Sod	110,000	5.5
Total					17.5

^a All of the above seeding rates and rates are based on drill seeding followed by crimped straw mulch. These rates should be doubled if seed is broadcast and should be increased by 50 percent if the seeding is done using a Brillion Drill or is applied through hydraulic seeding. Hydraulic seeding may be substituted for drilling only where slopes are steeper than 3:1. If hydraulic seeding is used, hydraulic mulching should be done as a separate operation.

^b See Table TS/PS-3 for seeding dates.

^c If site is to be irrigated, the transition turf seed rates should be doubled.

^d Crested wheatgrass should not be used on slopes steeper than 6:1 to 1V.

^e Can substitute 0.5 lbs PLS of blue grama for the 2.0 lbs PLS of the Vaughn sideoats grama.

EC-2 Temporary and Permanent Seeding (TS/PS)

Table TS/PS-2. Minimum Drill Seeding Rates for Perennial Grasses

Common ^a Name	Botanical Name	Growth Season ^a	Growth Form	Seeds/Pound	Pounds of PLS/Acre
Alkali Soil Seed Mix					
Alkali sacaton	<i>Sporobolus airoides</i>	Cool	Bunch	1,750,000	0.25
Basin wildrye	<i>Elymus cinereus</i>	Cool	Bunch	165,000	2.5
Sodar streambank wheatgrass	<i>Agropyron riparium 'Sodar'</i>	Cool	Sod	170,000	2.5
Jose tall wheatgrass	<i>Agropyron elongatum 'Jose'</i>	Cool	Bunch	79,000	7.0
Arriba western wheatgrass	<i>Agropyron smithii 'Arriba'</i>	Cool	Sod	110,000	5.5
Total					17.75
Fertile Loamy Soil Seed Mix					
Needleandthread	<i>Stipa comata</i>	Warm	Bunch	175,000	2.0
Blue grama	<i>Bouteloua gracilis</i>	Warm	Bunch	565,000	1.0
Thickspike wheatgrass	<i>Elymus lanceolatus</i>	Cool	Sod	130,000	3.0
Sodar streambank wheatgrass	<i>Agropyron riparium 'Sodar'</i>	Cool	Sod	170,000	2.5
Arriba western wheatgrass	<i>Agropyron smithii 'Arriba'</i>	Cool	Sod	110,000	7.0
Total					15.5
High Water Table Soil Seed Mix					
Western wheatgrass	<i>Agropyron repens</i>	Cool	Bunch	900,000	0.5
Redtop	<i>Agrostis alba</i>	Warm	Open sod	5,000,000	0.25
Prairie cordgrass	<i>Spartina pectinata</i>	Cool	Bunch	68,000	0.5
Alkali sacaton	<i>Sporobolus airoides</i>	Warm	Bunch	130,000	3.0
Pathfinder switchgrass	<i>Panicum virgatum 'Pathfinder'</i>	Warm	Sod	389,000	1.0
Slender wheatgrass	<i>Elymus trachycaulus</i>	Cool	Bunch	79,000	5.5
Total					10.75
Transition Turf Seed Mix^c					
Sheep fescue	<i>Festuca ovine</i>	Cool	Bunch	2,500,000	0.5
Idaho fescue	<i>Festuca idahoensis</i>	Cool	Bunch	565,000	1.0
Buffalograss	<i>Bouteloua dactyloides 'Topgun'</i>	Warm	Sod	247,000	3.0
Blue grama	<i>Bouteloua gracilis 'Hachius'</i>	Warm	Bunch	130,000	3.0
Total					7.5

June 2012 Urban Drainage and Flood Control District
Urban Storm Drainage Criteria Manual Volume 3

TS/PS-5

Table TS/PS-3. Seeding Dates for Annual and Perennial Grasses

Seeding Dates	Annual Grasses (Numbers in table reference species in Table TS/PS-1)		Perennial Grasses	
	Warm	Cool	Warm	Cool
January 1–March 15			✓	✓
March 16–April 30	4	1,2,3	✓	✓
May 1–May 15	4		✓	
May 16–June 30	4,5,6,7			
July 1–July 15	5,6,7			
July 16–August 31				
September 1–September 30		8,9,10,11		
October 1–December 31			✓	✓

Mulch

Cover seeded areas with mulch or an appropriate rolled erosion control product to promote establishment of vegetation. Anchor mulch by crimping, netting or use of a non-toxic tackifier. See the Mulching BMP Fact Sheet for additional guidance.

Maintenance and Removal

Monitor and observe seeded areas to identify areas of poor growth or areas that fail to germinate. Reseed and mulch these areas, as needed.

An area that has been permanently seeded should have a good stand of vegetation within one growing season if irrigated and within three growing seasons without irrigation in Colorado. Reseed portions of the site that fail to germinate or remain bare after the first growing season.

Seeded areas may require irrigation, particularly during extended dry periods. Targeted weed control may also be necessary.

Protect seeded areas from construction equipment and vehicle access.

EC-4

Mulching (MU)

- Clean, weed-free and seed-free cereal grain straw should be applied evenly at a rate of 2 tons per acre and must be tacked or fastened by a method suitable for the condition of the site. Straw mulch must be anchored (and not merely placed) on the surface. This can be accomplished mechanically by crimping or with the aid of tackifiers or nets. Anchoring with a crimping implement is preferred, and is the recommended method for areas flatter than 3:1. Mechanical crimpers must be capable of tucking the long mulch fibers into the soil to a depth of 3 inches without cutting them. An agricultural disk, while not an ideal substitute, may work if the disk blades are dull or blunted and set vertically; however, the frame may have to be weighted to afford proper soil penetration.

Maintenance and Removal

After mulching, the bare ground surface should not be more than 10 percent exposed. Reapply mulch, as needed, to cover bare areas.

ACADEMY GATEWAY SUBDIVISION FILING NO. 1 LOT 2

A SUBDIVISION OF A PORTION OF THE SOUTHEAST QUARTER OF SECTION 1,
TOWNSHIP 12 SOUTH, RANGE 67 AND THE SOUTHWEST QUARTER OF SECTION 6
TOWNSHIP 12 SOUTH RANGE 66, ALL WEST OF THE SIXTH PRINCIPAL

MERIDIAN, EL PASO COUNTY, COLORADO MAJOR SITE DEVELOPMENT PLAN

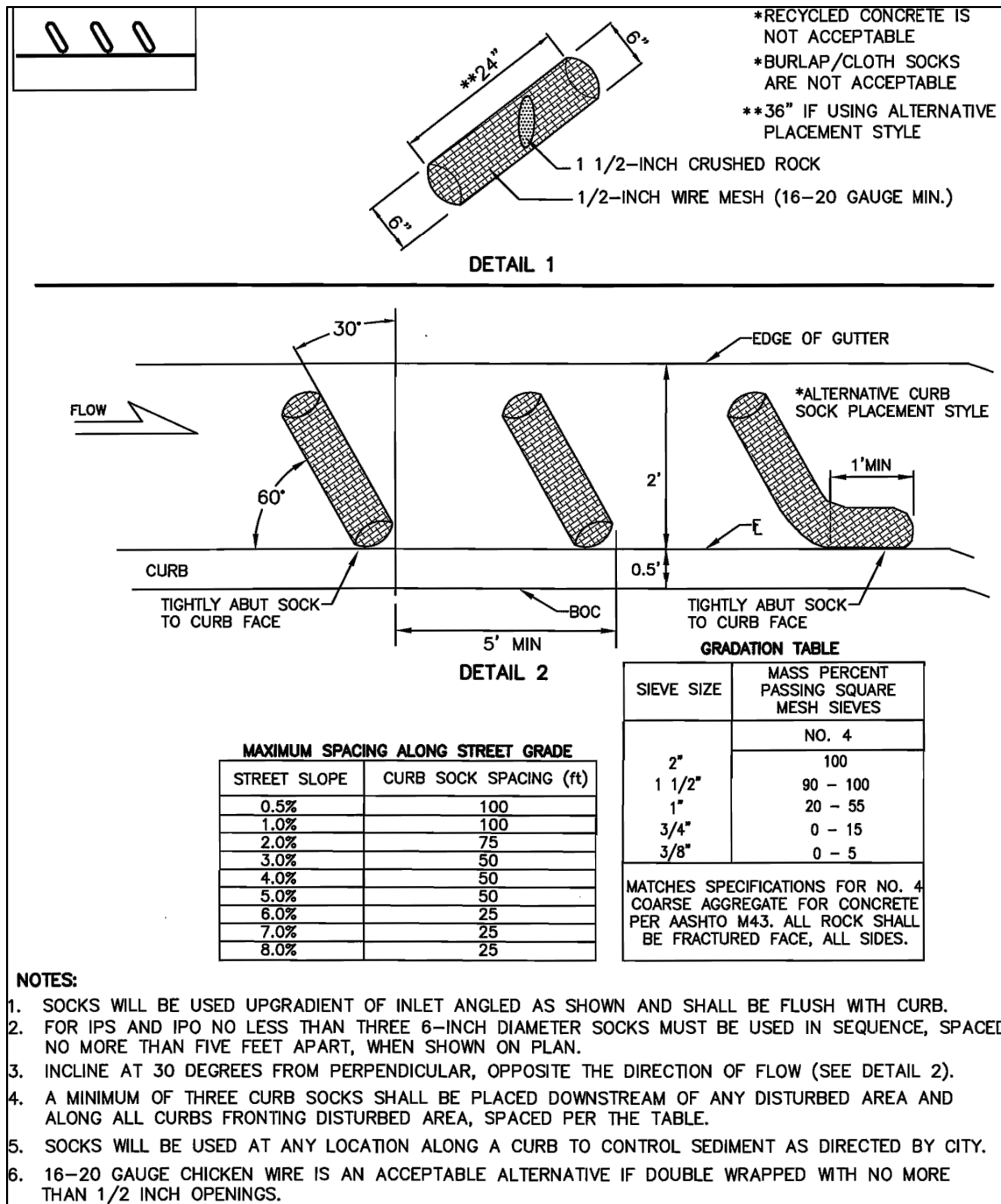

Curb Sock – are installed as curbside check dams and are wire mesh wrapped rock wattles installed for sediment control. Typical installation is a series of socks on a grade in the curb flowline upstream of a curb inlet to filter sediment-laden runoff and reduce the velocity of the flow.

Key Installation and Maintenance Requirements:

- Curb socks shall be constructed such that the final product is a cylindrical shaped filter with ½ - inch mesh filled with 1½ - inch gravel.
- Curb socks shall not exceed 24" in length, 6" in diameter and shall be placed at 60° angles in curb drainage flow lines flush with the curb. The spacing and quantity of the curb socks should be determined by the length and grade of the curb drainage flow line.
- Install delineators with the curb socks for high traffic areas where installations present a potential traffic hazard or where they may be damaged by snow plowing activities.
- Recycled or demolished concrete material is not an acceptable substitute for rock fill.
- Installed features need to be monitored for correct placement or rupture and adjusted, replaced or repaired as needed.



Features are not appropriately spaced in this application. Upgradient erosion control measures need to be implemented to prevent heavy sediment loading. Curb socks are not designed to manage the amount of sediment removal depicted here.



Table RECP-1. ECTC Standard Specification for Temporary Rolled Erosion Control Products
(Adapted from Erosion Control Technology Council 2005)

Product Description	Slope Applications*	Channel Applications*	Minimum Tensile Strength ¹	Expected Longevity
Mulch Control Nets	5:1 (H/V)	≤0.10 @ 5:1 0.25 lbs/ft ² (12 Pa)	5 lbs/ft (0.073 kN/m)	Up to 12 months
Netless Rolled Erosion Control Blankets	4:1 (H/V)	≤0.10 @ 4:1 0.5 lbs/ft ² (24 Pa)	5 lbs/ft (0.073 kN/m)	
Single-net Erosion Control Blankets & Open Weave Textiles	3:1 (H/V)	≤0.15 @ 3:1 1.5 lbs/ft ² (72 Pa)	50 lbs/ft (0.73 kN/m)	
Double-net Erosion Control Blankets	2:1 (H/V)	≤0.20 @ 2:1 1.75 lbs/ft ² (84 Pa)	75 lbs/ft (1.09 kN/m)	24 months
Mulch Control Nets	5:1 (H/V)	≤0.10 @ 5:1 0.25 lbs/ft ² (12 Pa)	25 lbs/ft (0.36 kN/m)	
Erosion Control Blankets & Open Weave Textiles (slowly degrading)	1.5:1 (H/V)	≤0.25 @ 1.5:1 2.00 lbs/ft ² (96 Pa)	100 lbs/ft (1.45 kN/m)	24 months
Erosion Control Blankets & Open Weave Textiles	1:1 (H/V)	≤0.25 @ 1:1 2.25 lbs/ft ² (108 Pa)	125 lbs/ft (1.82 kN/m)	36 months

