



Planning and Community
Development Department
2880 International Circle
Colorado Springs, Colorado 80910
Phone: 719.520.6300
Fax: 719.520.6695
Website www.elpasoco.com

DEVIATION REQUEST AND DECISION FORM

Updated: 6/26/2019

PROJECT INFORMATION

Project Name :	Homestead at Sterling Ranch Filing No. 2
Schedule No.(s):	5233-10-10003
Legal Description:	Replat of Tract E Sterling Ranch Filing No. 1

APPLICANT INFORMATION

Company :	SR Land, LLC
Name :	Jim Morley
<input checked="" type="checkbox"/> Owner <input type="checkbox"/> Consultant <input type="checkbox"/> Contractor	
Mailing Address :	PO Box 1360, Colorado Springs, CO 80903
Phone Number :	719-491-3024
FAX Number :	
Email Address :	jmorley3870@aol.com

ENGINEER INFORMATION

Company :	M&S Civil Consultants, Inc.	Colorado P.E. Number :	37160
Name :	Virgil A. Sanchez		
Mailing Address :	PO Box 1360, Colorado Springs, CO 80903		
Phone Number :	719-491-0818		
FAX Number :			
Email Address :	virgils@mscivil.com		

OWNER, APPLICANT, AND ENGINEER DECLARATION

To the best of my knowledge, the information on this application and all additional or supplemental documentation is true, factual and complete. I am fully aware that any misrepresentation of any information on this application may be grounds for denial. I have familiarized myself with the rules, regulations and procedures with respect to preparing and filing this application. I also understand that an incorrect submittal will be cause to have the project removed from the agenda of the Planning Commission, Board of County Commissioners and/or Board of Adjustment or delay review until corrections are made, and that any approval of this application is based on the representations made in the application and may be revoked on any breach of representation or condition(s) of approval.

Signature of owner (or authorized representative)

Date

Engineer's Seal, Signature
And Date of Signature

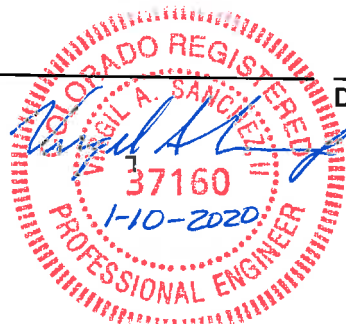

□

DEVIATION REQUEST (Attach diagrams, figures, and other documentation to clarify request)

A deviation from the standards of or in Section **ECM 3.3.1.J.8** of the Engineering Criteria Manual (ECM) is requested.

Identify the specific ECM standard which a deviation is requested:

Maximum Storm Sewer velocity shall be 18 feet per second

State the reason for the requested deviation:

The following sections of storm sewer exceed 18 fps. Storm 3-btw Sta 1+05.38 - Sta 2+58.80. The request of this deviation is due to the hydraulic storm sewer design at the outfall into Sand Creek to avoid excessively deep storm sewer construction and maintenance. This segment of pipe will be made of 5,000 psi concrete pipe to prevent erosion of the pipe material.

Explain the proposed alternative and compare to the ECM standards (May provide applicable regional or national standards used as basis):

To flatten the storm sewer pipe outfall to Sand Creek to achieve a velocity less than 18 fps would create a manhole dept of over 25 feet. The excavation for a 42" RCP pipe over 25' feet deep would be unsafe for the installation and maintenance.

LIMITS OF CONSIDERATION

(At least one of the conditions listed below must be met for this deviation request to be considered.)

- The ECM standard is inapplicable to the particular situation.
- Topography, right-of-way, or other geographical conditions or impediments impose an undue hardship and an equivalent alternative that can accomplish the same design objective is available and does not compromise public safety or accessibility.
- A change to a standard is required to address a specific design or construction problem, and if not modified, the standard will impose an undue hardship on the applicant with little or no material benefit to the public.

Provide justification:

Since this is at the outfall to Sand Creek, a Rip Rap plunge pool will dissipate the higher velocity of the stormwater prior to the conveyance into the Sand Creek channel.

CRITERIA FOR APPROVAL

Per ECM section 5.8.7 the request for a deviation may be considered if the request is **not based exclusively on financial considerations**. The deviation must not be detrimental to public safety or surrounding property. The applicant must include supporting information demonstrating compliance with **all of the following criteria**:

The deviation will achieve the intended result with a comparable or superior design and quality of improvement.

We believe that the proposed design is superior to the alternative design to achieve flows less than 18 fps.

The deviation will not adversely affect safety or operations.

The proposed design will provide a shallower depth at the adjacent manhole for maintenance access. The proposed design shows a ~8.5 foot deep manhole as opposed to a +25 foot deep manhole.

The deviation will not adversely affect maintenance and its associated cost.

The deviation will improve the cost for installation and maintenance. This pipe segment will be owned and maintained by the Sterling Ranch Metropolitan District.

The deviation will not adversely affect aesthetic appearance.

N/A

The deviation meets the design intent and purpose of the ECM standards.

The design and use of 5,000 psi concrete pipe will meet the intention of the ECM to prevent erosion of the pipe material.

The deviation meets the control measure requirements of Part I.E.3 and Part I.E.4 of the County's MS4 permit, as applicable.

The deviation does not negatively affect the County's MS4 permit.

REVIEW AND RECOMMENDATION:

Approved by the ECM Administrator

This request has been determined to have met the criteria for approval. A deviation from Section ECM 3.3.1.J.8 of the ECM is hereby granted based on the justification provided.

□

Approved

By: Elizabeth Nijkamp

Date: 02/19/2020

El Paso County Planning & Community Development



Denied by the ECM Administrator

This request has been determined not to have met criteria for approval. A deviation from Section ECM 3.3.1.J.8 of the ECM is hereby denied.

□

L

ECM ADMINISTRATOR COMMENTS/CONDITIONS:

1.1. PURPOSE

The purpose of this resource is to provide a form for documenting the findings and decision by the ECM Administrator concerning a deviation request. The form is used to document the review and decision concerning a requested deviation. The request and decision concerning each deviation from a specific section of the ECM shall be recorded on a separate form.

1.2. BACKGROUND

A deviation is a critical aspect of the review process and needs to be documented to ensure that the deviations granted are applied to a specific development application in conformance with the criteria for approval and that the action is documented as such requests can point to potential needed revisions to the ECM.

1.3. APPLICABLE STATUTES AND REGULATIONS

Section 5.8 of the ECM establishes a mechanism whereby an engineering design standard can be modified when if strictly adhered to, would cause unnecessary hardship or unsafe design because of topographical or other conditions particular to the site, and that a departure may be made without destroying the intent of such provision.

1.4. APPLICABILITY

All provisions of the ECM are subject to deviation by the ECM Administrator provided that one of the following conditions is met:

- The ECM standard is inapplicable to a particular situation.
- Topography, right-of-way, or other geographical conditions or impediments impose an undue hardship on the applicant, and an equivalent alternative that can accomplish the same design objective is available and does not compromise public safety or accessibility.
- A change to a standard is required to address a specific design or construction problem, and if not modified, the standard will impose an undue hardship on the applicant with little or no material benefit to the public.

1.5. TECHNICAL GUIDANCE

The review shall ensure all criteria for approval are adequately considered and that justification for the deviation is properly documented.

1.6. LIMITS OF APPROVAL

Whether a request for deviation is approved as proposed or with conditions, the approval is for project-specific use and shall not constitute a precedent or general deviation from these Standards.

1.7. REVIEW FEES

A Deviation Review Fee shall be paid in full at the time of submission of a request for deviation. The fee for Deviation Review shall be as determined by resolution of the BoCC.

STORM 3 STA 1+00.00 TO STA 7+63.63



1" = 50'



Scale in Feet

NOTES:
STA 1+05.58 TO STA 1+29.58
(NEXT FULL JOINT) TIE PIPE
SEGMENTS TOGETHER W/4-3"
CANOPY TYPE ROD LUG JOINT
FASTENERS.

REINFORCED CONCRETE PIPE INSTALLED
BETWEEN STA 1+05.58 AND STA 2+58.80
SHALL BE FABRICATED USING A CONCRETE
MIX DESIGN THAT RESULTS IN A MIN. 5000 PSI
COMPRESSIVE STRENGTH.

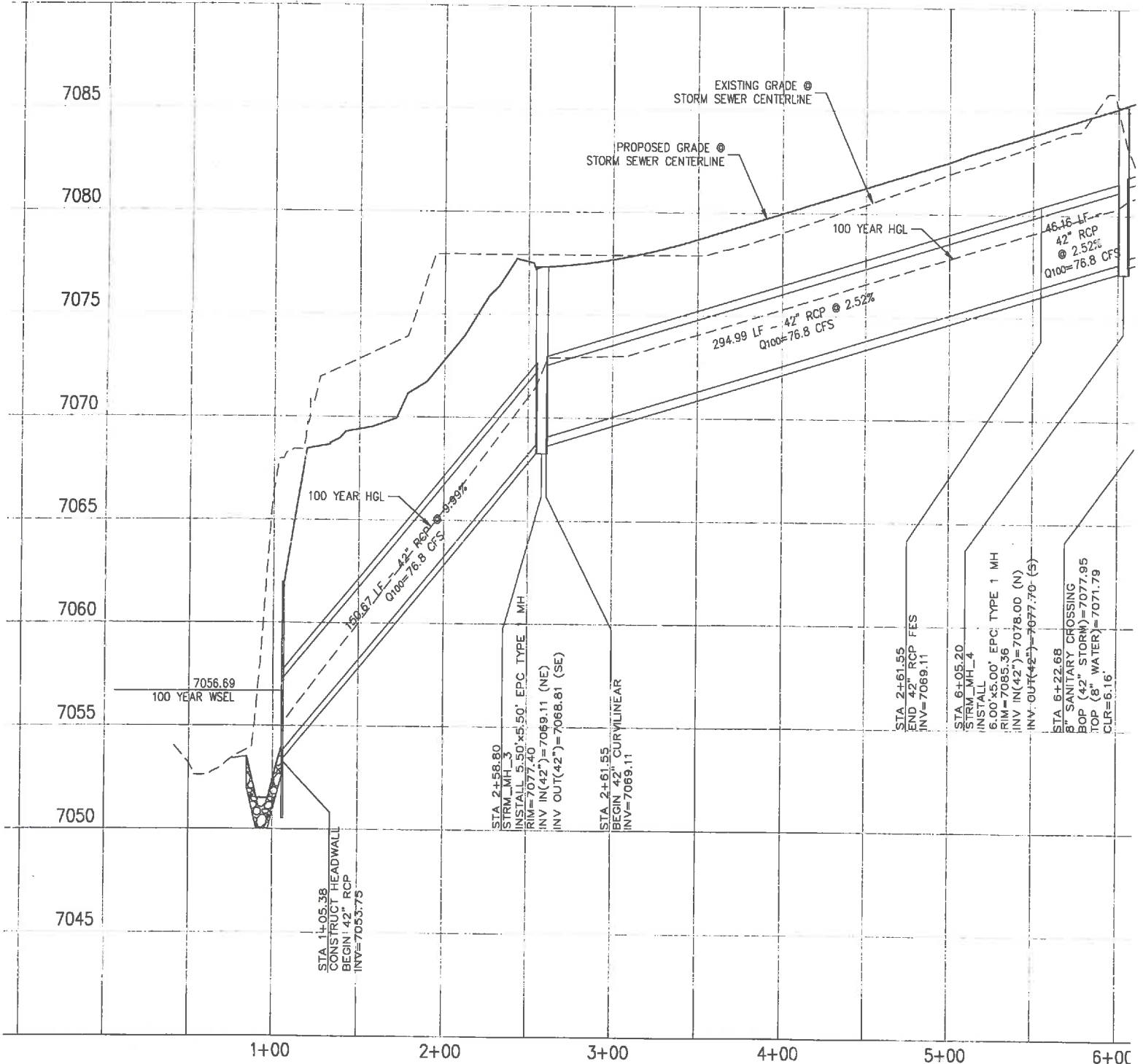

STORM 3 STA 1+00.00 TO STA 7+63.63

**DEVIATION REQUEST EXHIBIT HOMESTEAD AT SR FILING NO.2
ECM 3.3.1.J.8 EXCEEDING MAXIMUM VELOCITY 18 FPS**