

**ADD24657**

**Not Required  
BESQCP**  
10/25/2024 12:28:55 PM  
dsdyounger  
EPC Planning & Community  
Development Department

**APPROVED  
Plan Review**  
10/25/2024 12:28:59 PM  
dsdyounger  
EPC Planning & Community  
Development Department

It is the owner's responsibility to coordinate with easement holders to avoid impact to utilities that may be located in the easements.

ANY APPROVAL GIVEN BY EL PASO COUNTY DOES NOT OVIATE THE NEED TO COMPLY WITH APPLICABLE FEDERAL, STATE, OR LOCAL LAWS AND/OR REGULATION  
Planning & Community Development Department approval is contingent upon compliance with all applicable notes on the recorded plat.  
An access permit must be granted by the Planning & Community Development Department prior to the establishment of any driveway onto a County road.  
Diversion of blockage of any drainage way is not permitted without approval of the Planning & Community Development Department

BONDING CLAMP

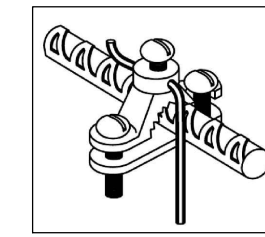

INSTALL IN TWO (2) PLACES , MINIMUM FOR EACH BODY OF WATER. JOIN BOND WIRES

NOTE: A #8 AWG OR LARGER SOLID COPPER BONDING CONDUCTOR, INSULATED, COVERED, OR BARE, SHALL BE CONNECTED BETWEEN THE EQUIPOTENTIAL BONDING GRID AND THE STRUCTURAL REINFORCING STEEL OF A CONCRETE POOL BY MEANS OF A LISTED AND IDENTIFIED CORROSION-RESISTANT WELDING, CONNECTORS, OR CLAMPS INTENDED FOR THE USE AND IN COMPLIANCE WITH NEC 680.26(C).

NOTE- IF A STEEL REINFORCED DECK (I.E. POURED CONCRETE) IS NOT PLACED ON ALL 4 SIDES OF THE POOL SHELL, ADDITIONAL ELECTRICAL BONDING COSTS WILL BE INCURRED

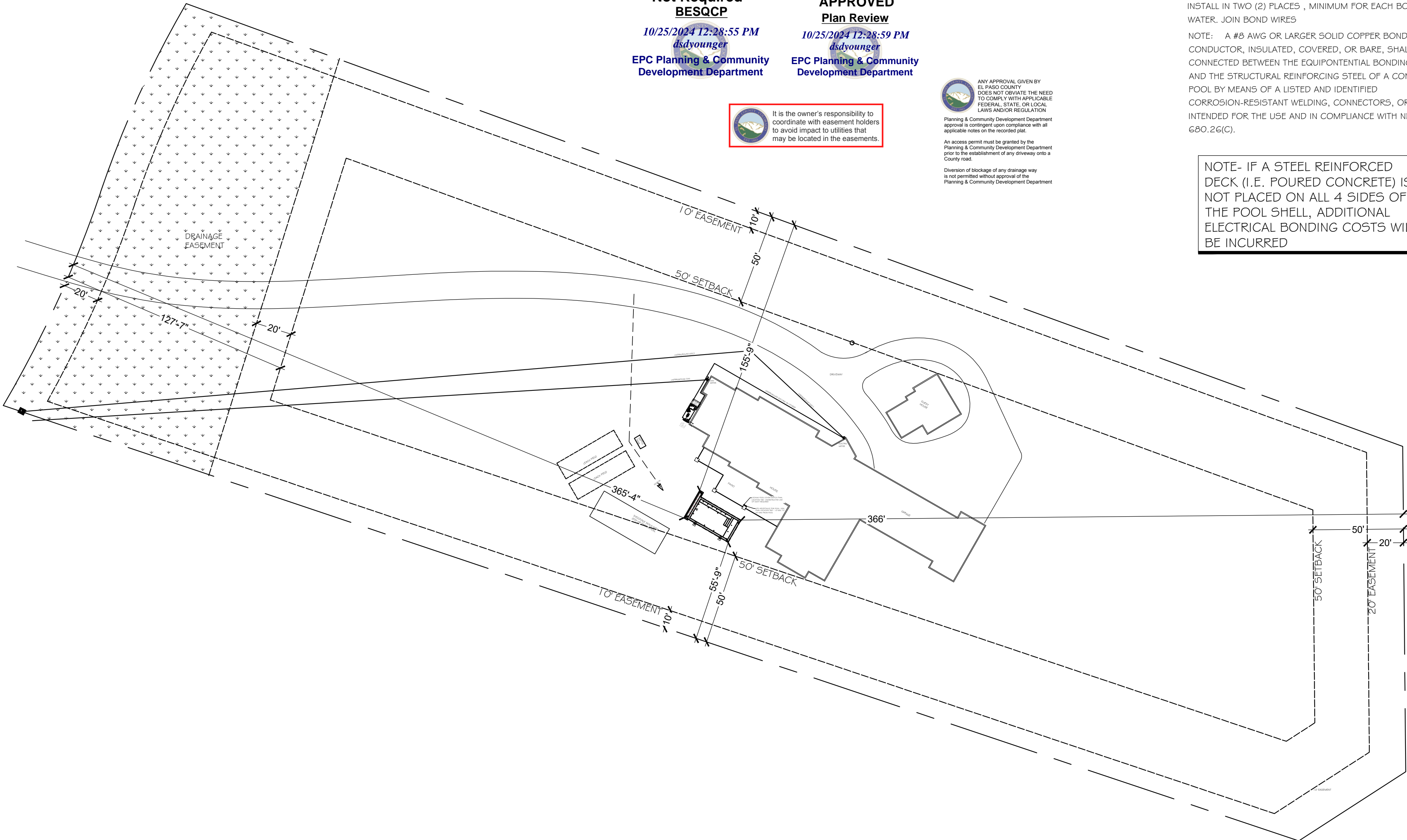

8159 W. BRANDON DRIVE PHONE: 303.789.9435  
LITTLETON, CO 80125 FAX: 303.583.8306

DESIGNED BY: BPRITCHETT

DRAWN BY: KBARRY

DATE: 10/10/24

SCALE: 1"=40'

THOMAS POOL PROJECT  
3565 MEADOW RUN CIR,  
COLORADO SPRINGS, CO 80908

REVISIONS

VERSION:	DATE:	DESCRIPTION:
1.0	10/10/24	Plan Set

SHEET NAME:

SITE PLAN

SHEET NUMBER:

2 OF 7

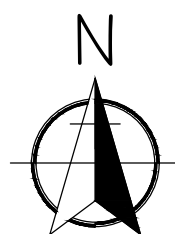
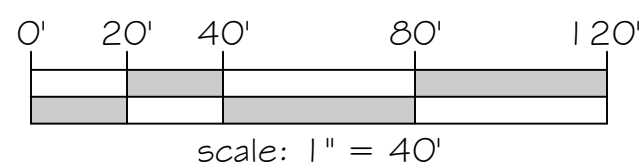

**6210001020  
PLAT 13330  
PUD  
LOT 7 NEW BREED RANCH FIL TWO**

# RESIDENTIAL



2023 PPRBC  
IECC: N/A

Address: 3565 MEADOW RUN CIR, COLORADO SPRINGS

Parcel: 6210001020

Plan Track #: 195451 

Received: 23-Oct-2024 (BRIANNAM)

## Description:

### Residential Pool

Contractor: INTEGRITY POOL BUILDERS, LLC

Type of Unit:

## Required PPRBD Departments (5)

<p><b>Floodplain</b></p> <p>(N/A) RBD GIS</p>	<p><b>Construction</b></p> <p>Released for Permit 10/25/2024 11:15:27 AM</p> 
<p><b>Electrical</b></p>	<p><b>Mechanical</b></p>
<p><b>Plumbing</b></p>	

Release of this plan does not preclude compliance with all applicable codes, ordinances and other pertinent regulations. This plan set must be present on the job site for every inspection.

**Required Outside Departments (1)**

**County Zoning**

**APPROVED**

**Plan Review**

*10/25/2024 12:32:39 PM*

*dsdyounger*

**EPC Planning & Community  
Development Department**