

LIGHT FIXTURE NOTE:

ALL LIGHTING FIXTURES SHALL BE FULL CUT-OFF OR HAVE SHIELDING TO REDUCE OFF-SITE LIGHTING IMPACTS ONTO ADJACENT PROPERTIES AND ROADWAYS. ALL EXTERIOR LIGHTING SHALL BE ARRANGED TO MITIGATE LIGHT DIRECTED AWAY FROM ADJACENT PROPERTIES AND ANY PUBLIC RIGHT-OF-WAY. AN AMENDMENT TO THIS PLAN MAY BE REQUIRED IF THE LIGHTING TYPE IS CHANGED.

LIGHT FIXTURE SCHEDULE

MARK	MANUFACTURER	MODEL	QTY.	WATT	TYPE	MOUNTING	DESCRIPTION	VOLTAGE	TS/FAL	NOTES
AA	LSI INDUSTRIES, INC	SLM-LED-18L-SIL-4-40-70CRI	1	135	LED	POLE @ 15' & 20'	AREA LUMINAIRE	120/277	135	1 - 2
WP1	LITHONIA	DSXW1 LED 10C 350 30K T4M MVOLT	1	13.3	LED	WALL SURFACE @ 15'	WALLPACK	120/277	13.3	1 - 2

- NOTES:
- 1) LIGHTING FIXTURE TO BE CONTROLLED VIA LIGHTING CONTROL PANEL WITH TIME CLOCK AND PHOTOCELL.
 - 2) CONFIRM ALL LIGHT FIXTURE SELECTIONS WITH TENANT PRIOR TO ORDERING. THIS INCLUDES COLORS, COLOR TEMPERATURES, MANUFACTURER, ETC.

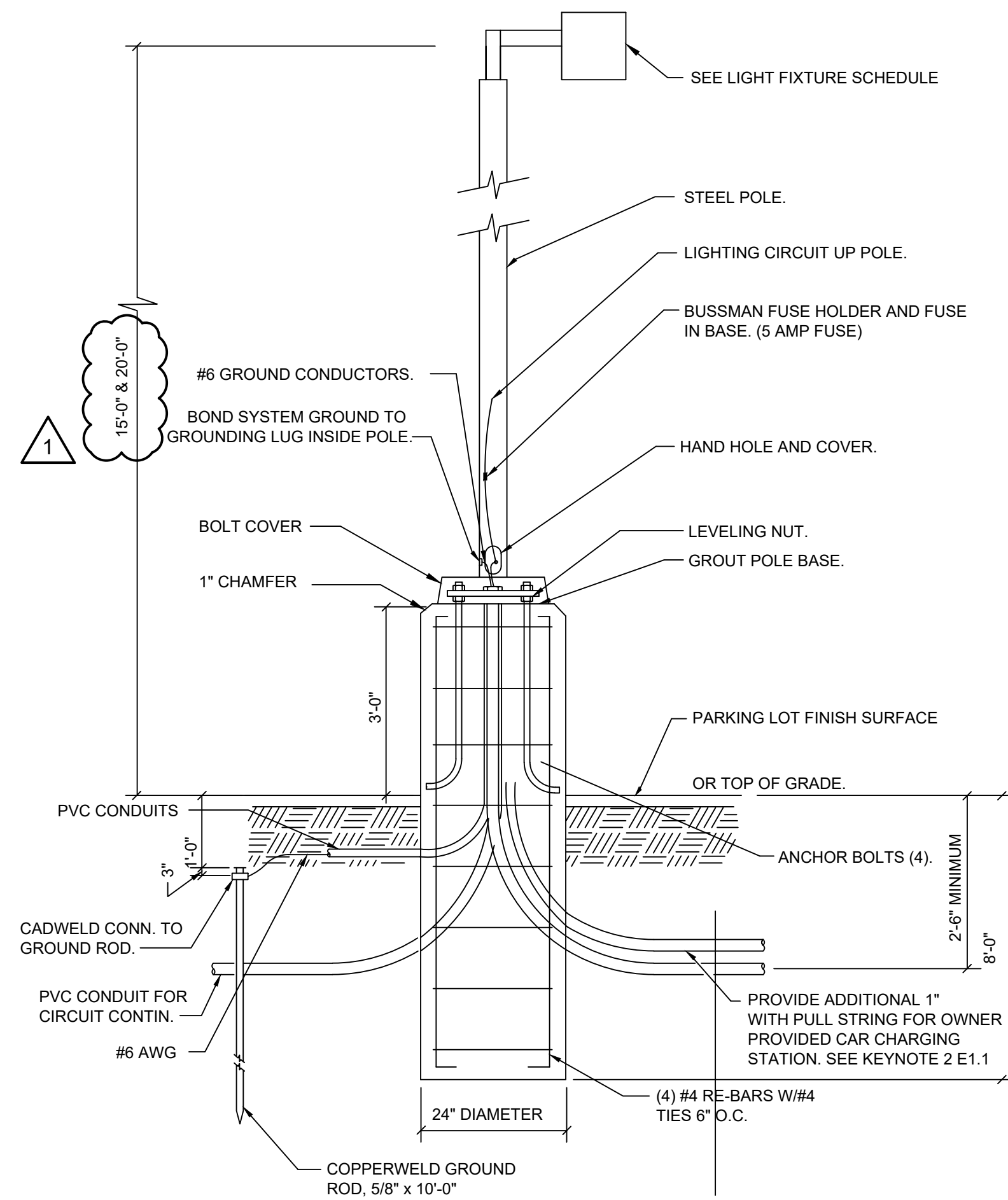

2 TYPICAL POLE BASE DETAIL
ES0.1 SCALE: NONE



4 SLM AREA LUMINAIRE (AA)
ES0.1 SCALE: NONE



3 DSX1 WALLPACK (WP1)
ES0.1 SCALE: NONE

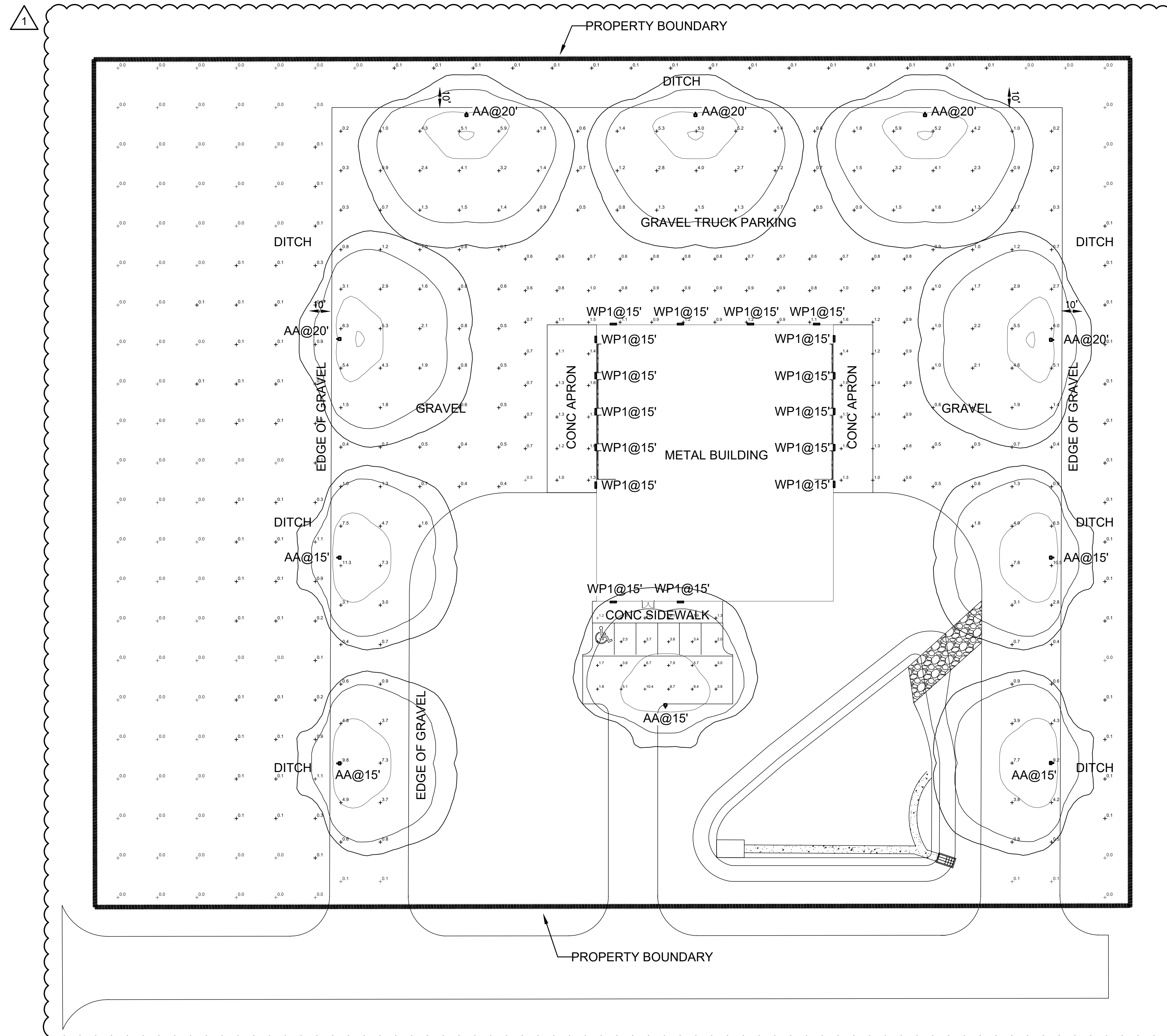

1 SITE PHOTOMETRIC PLAN
ES0.1 SCALE: 1/32"=1'-0"

CLIENT:
ARCHITECT:

McShea Consulting, LLC
MECHANICAL + ELECTRICAL + PLUMBING
4445 Northpark Dr. Suite 200
Colorado Springs, CO 80907
mcsheac consulting.com
Project #: 24-7334



OWNERSHIP OF INSTRUMENTS OF SERVICE
All Drawings, Reports, Plans, Specifications, Computer Files (including CAD files), field information, notes, sketches, and other design materials prepared by the Engineer and his/her consultants as instruments of service shall remain the property of the Engineer. The Engineer shall retain all common law, statutory and other reserved rights, including the Copyright benefits.

-CITY LINK TRUCKING-
225 North Curtis Road,
Colorado Springs, Colorado 80930

FULL SET ISSUE HISTORY:

1 - PERMIT SET	4.23.2024

SHEET REVISION:

1 - FIELD CHANGES	4.23.2024

PROJECT #: 24-7334
DRAWN BY: SH
CHECKED BY: MRM

SHEET

ES0.1

FILE NUMBER: PPR2339

Slice Medium Outdoor LED Area Light

Have questions? Call us at (800) 436-7800

PERFORMANCE

Back to Quick Links

DELIVERED LUMENS*				3000K CCT		4000K CCT		5000K CCT		Wattage	
Lumen Package	Distribution	CR1	Delivered Lumens	BIIG Rating	Delivered Lumens	BIIG Rating	Delivered Lumens	BIIG Rating	BIIG Rating		
91	2	SW	9411	149	82-00-62	9605	152	82-00-62	9605	152	82-00-62
	3	SW	9448	152	82-00-62	9742	155	82-00-62	9742	155	82-00-62
	4	SW	9963	144	81-00-62	9636	135	81-00-62	9411	150	81-00-62
	5	SW	9961	147	81-00-62	9490	150	81-00-62	9490	150	81-00-62
	6	FT	9464	150	82-00-62	9627	135	82-00-62	9627	135	82-00-62
	7	FT	9911	151	82-00-62	9725	134	82-00-62	9725	134	82-00-62
121	2	SW	1949	155	82-00-62	1945	156	82-00-62	1945	156	82-00-62
	3	SW	1949	144	81-00-62	1915	155	81-00-62	1915	155	81-00-62
	4	SW	2253	147	81-00-62	2170	150	81-00-62	2170	150	81-00-62
	5	FT	2274	150	82-00-62	2171	151	82-00-62	2171	151	82-00-62
	6	FT	2295	142	82-00-62	2207	151	82-00-62	2246	148	82-00-62
	7	FT	2333	145	80-00-62	2284	149	80-00-62	2284	149	80-00-62
151	2	SW	3260	149	81-00-62	3260	152	81-00-62	3260	152	81-00-62
	3	SW	3268	151	81-00-62	3111	154	81-00-62	3111	154	81-00-62
	4	SW	3393	137	81-00-62	3266	135	81-00-62	3267	137	81-00-62
	5	SW	3841	136	81-00-62	3879	139	81-00-62	3879	139	81-00-62
	6	FT	3891	138	81-00-62	3872	141	81-00-62	3872	141	81-00-62
	7	FT	3778	137	82-00-62	3768	140	82-00-62	3768	140	82-00-62

Slice Medium Outdoor LED Area Light

Have questions? Call us at (800) 436-7800

ORDERING GUIDE

Back to Quick Links

Prefix	Light Source	Lumen Package	Lens	Distribution	Orientation ¹	Voltage
SIM - Slim Medium	LED	0L - 0.000 lms 12L - 12.000 lms 24L - 24.000 lms 30L - 30.000 lms 36L - 36.000 lms 42L - 42.000 lms 50L - 50.000 lms Custom Lumen Packages ²	SL - Silicone SS - Silicone	2 - Type 2 3 - Type 3 4 - Type 4 5W - Type 5 Wide FT - Forward Throw FMA - Forward Throw Automotive AM - Automotive Mounting LC - Left Corner RC - Right Corner	(Blank) - standard (orientation) L - Optics rotated left 90° R - Optics rotated right 90°	UN - Universal Voltage (220-277V) HV - High Voltage (247-480V)

Driver	Color Temperature	Color Rendering	Controls	Finish	Options
DIM - 0-10V Dimming (0-100%)	50 - 5000 CCT 40 - 4000 CCT 30 - 3000 CCT	70CR - 70 CRI	(Blank) - None Wireless Controls System ALSIC - ActiLink Synapse Control System ³ ALSIC92 - ActiLink Synapse Control System with 12-27 Motion Sensor ⁴ ALSIC94 - ActiLink Synapse Control System with 20-67 Motion Sensor ⁴ ALSIC95 - ActiLink Blue Wireless Motion & Photo Sensor Controller (8-24" mounting height) ALSIC97 - ActiLink Blue Wireless Motion & Photo Sensor Controller (3-24" mounting height) ALSIC98 - ActiLink Blue Wireless Motion & Photo Sensor Controller (25-47" mounting height) Standalone Controls EDP - 0-10V Dimming (built into the housing exterior) CRIP - 7 Pin Control Receiver (ANSI C136.47) IPR312L - Integral Bluetooth ⁵ Motion and Prox Sensor (8-24" Mt) ⁶ IPR312L - Integral Bluetooth ⁵ Motion and Prox Sensor (25-47" Mt) ⁶ Button Type PhotoCell PC200 - 200 PC200-277 - 200 - 277V PC347 - 347V	BLK - Black RZC - Satin Bronze GMC - Gun Metal Gray GPT - Graphite MSV - Metallic Silver PPP - Platinum Plus CWC - Color Wash Green WHF - White	BLK - None IHE - Integral Half Lower (Proxide Side Light Only) IIL - Integral Lower (Sharp Sill Light Only) ⁷

Need more information?

Click Here for our glossary

Have additional questions?

Call us at (800) 436-7800

Essential Ordering Information⁸

CONTROLS ACCESSORIES		FUSING OPTIONS ⁹		SHIELDING OPTIONS	
Description	Order Number	Single Fusing (20V)	Single Fusing (277V)	Mirada Small	
Two Lock PhotoCell (20V) for use with CRIP	122314	Double Fusing (20V)	Double Fusing (277V)	Mirada Medium	See Shields Guide
Two Lock PhotoCell (208-277) for use with CRIP	122315	Double Fusing (20V/240V)	Double Fusing (208V)	Mirada Large	
Two Lock PhotoCell (347V) for use with CRIP	122316	Double Fusing (480V)	Double Fusing (347V)	Zone Large	
Two Lock PhotoCell (480V) for use with CRIP	122310			Zone Medium	
ActiLink 5 Pin Test Controller	64109			Zone Large	
ActiLink Pin Test Lock Controller	64104			Siema Medium	
Shunting Cap for use with CRIP	14932				

¹ Custom lumen and wattage packages available, consult factory files on www.lithonia.com. See factory website for more details.
² Not available for "Type 3" finishes.
³ Control wiring to be installed by customer.
⁴ Motion sensor and photo cell are sold separately. See our website for more details.
⁵ Control wiring and mounting are sold separately. See our website for more details.
⁶ Bluetooth is a registered trademark of Intel Corporation.
⁷ Not available with ALSIC98.
⁸ Lumen and wattage packages available, consult factory files on www.lithonia.com. See factory website for more details.
⁹ See factory website for more details.

LSI Industries Inc. 10000 Alliance Rd. Cincinnati, OH 45242 • (513) 372-3200 • www.lithonia.com
LSI Industries Inc. All Rights Reserved. Specifications and dimensions subject to industry standard tolerances. Specifications subject to change without notice.
Page 4/71 Rev. 01/26/24 SPEC.110.0.1122

Client: _____ Type: _____
Catalog #: _____ Project: _____
Prepared By: _____ Date: _____

Slice Medium (SLM) Outdoor LED Area Light



OVERVIEW	
Lumen Package	9,000 - 55,000
Wattage Range	62 - 436
Efficiency Range (LPW)	114 - 162
Weight (lbs/kg)	27 (12.2)
Control Options	IMSBT, ALB, ALS, 7-Pin, PCI

QUICK LINKS

Ordering Guide Performance Photometrics Dimensions

FEATURES & SPECIFICATIONS

Construction

- Rugged die-cast aluminum housing contains factory prewired driver and optical unit. Cast aluminum wiring access door located underneath.
- Fixtures are finished with LSI's DuraGrip[®] polyester powder coat finishing process. The DuraGrip finish withstands extreme weather changes without cracking or peeling. Other standard LSI finishes are available. Consult factory.
- Shipping weight: 33 lbs in carton.

Optical System

- Available in 5000K, 4000K, and 3000K color temperatures per ANSI C136.31 high vibration applications applications are qualified.
- High-eficiency LEDs mounted to metal-core circuit board to maximize heat dissipation
- Driver is fully encased in potting material for moisture resistance and complies with FCC standards. Driver and key electronic components can easily be accessed.

Controls

- Optional integral passive infrared Bluetooth[®] motion sensor. Fixtures operate independently and can be commissioned via iOS or Android configuration app.
- LSI's AirLink[™] wireless control system options reduce energy and maintenance costs while optimizing light quality 24/7.

Electrical

- High-performance driver features overvoltage, under-voltage, short-circuit and over temperature protection.
- 0-10V dimming (10% - 100%) standard
- Standard Universal Voltage (200-277 VAC) input/50/60 Hz or optional High Voltage (347-480 VAC).
- LBO Calculated Life: >100K Hours (See Lumen Maintenance chart).
- Total harmonic distortion: <20%
- Operating temperature: -40°C to +50°C (-40°F to +122°F). 42L and 40L lumen packages rate to +40°C. 55L lumen packages rate to +35°C.
- Power factor: >90
- Input power stays constant over life.
- Field replaceable iOLV surge protection device meets a minimum Category C Low operation (per ANSI/IEEE C62.41-2).
- High-eficiency LEDs mounted to metal-core circuit board to maximize heat dissipation
- Driver is fully encased in potting material for moisture resistance and complies with FCC standards. Driver and key electronic components can easily be accessed.

Installation

- A single fastener secures the hinged door, underneath the housing and provides quick & easy access to the electrical compartment.
- Included terminal block accepts up to 12 ga. wire.
- Utilizes LSI's traditional B3 direct pattern. (See drawing in plan section)

Warranty

- LSI luminaires carry a 5-year limited warranty. Refer to <https://www.lithonia.com/resources/terms-conditions-warranty/> for more information.

Listings

- Listed to UL 1598 and UL 8750.
- Meets BAA American Act requirements.
- IDA compliant with 3000K color temperature selection.
- Title 24 Compliant: see local ordinance for qualification information.
- IP66 rated luminaire per IEC 60598-1.
- 3G rated for ANSI C136.31 high vibration applications applications are qualified.
- IK08 rated luminaire per IEC 60682 mechanical impact code.
- Designlights Consortium[®] (DLC) qualified product. Not all versions of this product may be DLC qualified. Please check the DLC Qualified Products List at www.designlights.org/GPL to confirm which versions are qualified.
- Patented Silicone Optics (US Patent NO. 10,816,615 B2)



4.23.2024
OWNERSHIP OF INSTRUMENTS OF SERVICE

All Drawings, Reports, Plans, Specifications, Computer Files (including CAD files), field information, notes, sketches, and other design materials prepared by the Engineer and his/her associates are instruments of service that remain the property of the Engineer. The Engineer shall retain all common law, statutory and other reserved rights, including the Copyright.

-CITY LINK TRUCKING-
225 North Curtis Road,
Colorado Springs, Colorado 80930

Performance Data

Lumen Output
Lumen values are from photometric tests performed in accordance with IESNA LM-79-08. Contact factory for performance data on any configurations not shown here.

Axis	Size	Beam	Height	Beam Angle	Beam Type	Beam Diameter	Beam Area	Beam Volume	Beam Length	Beam Width	Beam Depth	Beam Height	Beam Area	Beam Volume	Beam Length	Beam Width	Beam Depth	Beam Height	
350mm	13W	13W	2.0m	1.0m	24°	0.6m	0.34m	0.02m	0.001m	0.001m	0.001m	0.001m	0.001m	0.001m	0.001m	0.001m	0.001m	0.001m	
																			150
																			150
																			150
																			150
																			150
530mm	19W	19W	2.5m	1.5m	24°	0.75m	0.34m	0.02m	0.001m	0.001m	0.001m	0.001m	0.001m	0.001m	0.001m	0.001m	0.001m	0.001m	
																			150
																			150
																			150
																			150
																			150
700mm	26W	26W	3.0m	2.0m	24°	0.95m	0.34m	0.02m	0.001m	0.001m	0.001m	0.001m	0.001m	0.001m	0.001m	0.001m	0.001m	0.001m	
																			150
																			150
																			150
																			150
																			150
1000mm	37W	37W	3.5m	2.5m	24°	1.1m	0.34m	0.02m	0.001m	0.001m	0.001m	0.001m	0.001m	0.001m	0.001m	0.001m	0.001m	0.001m	
																			150
																			150
																			150
																			150
																			150
1500mm	53W	53W	4.0m	3.0m	24°	1.3m	0.34m	0.02m	0.001m	0.001m	0.001m	0.001m	0.001m	0.001m	0.001m	0.001m	0.001m	0.001m	
																			150
																			150
																			150
																			150
																			150
2000mm	70W	70W	4.5m	3.5m	24°	1.5m	0.34m	0.02m	0.001m	0.001m	0.001m	0.001m	0.001m	0.001m	0.001m	0.001m	0.001m	0.001m	
																			150
																			150
																			150
																			150
																			150
3000mm	100W	100W	5.0m	4.0m	24°	1.7m	0.34m	0.02m	0.001m	0.001m	0.001m	0.001m	0.001m	0.001m	0.001m	0.001m	0.001m	0.001m	
																			150
																			150
																			150
																			150
																			150

LSI Industries Inc. 10000 Alliance Rd. Cincinnati, OH 45242 • (513) 372-3200 • www.lithonia.com
LSI Industries Inc. All Rights Reserved. Specifications and dimensions subject to industry standard tolerances. Specifications subject to change without notice.
Page 4/71 Rev. 01/26/24 SPEC.110.0.1122

Performance Data

Lumen Ambient Temperature (LAT) Multipliers
Use these factors to determine relative lumen output for average ambient temperatures from 40°C to 100°C.

Ambient Temperature	Multiplier
40°C	1.00
45°C	0.95
50°C	0.90
55°C	0.85
60°C	0.80
65°C	0.75
70°C	0.70
75°C	0.65
80°C	0.60
85°C	0.55
90°C	0.50
95°C	0.45
100°C	0.40

Projected LED Lumen Maintenance

Data indicates the extrapolated lumen maintenance projection for the DSKW1 LED 20C 1000 fixture in a 20°C ambient temperature, assuming 10,000 hours of LED testing tested per IESNA LM-79-08 and modeled per IESNA TM-21-11.

Operating Hours	0.95	0.90	0.85	0.80
10,000	0.95	0.90	0.85	0.80
20,000	0.95	0.90	0.85	0.80
30,000	0.95	0.90	0.85	0.80
40,000	0.95	0.90	0.85	0.80
50,000	0.95	0.90	0.85	0.80
60,000	0.95	0.90	0.85	0.80
70,000	0.95	0.90	0.85	0.80
80,000	0.95	0.90	0.85	0.80
90,000	0.95	0.90	0.85	0.80
100,000	0.95	0.90	0.85	0.80

Photometric Diagrams

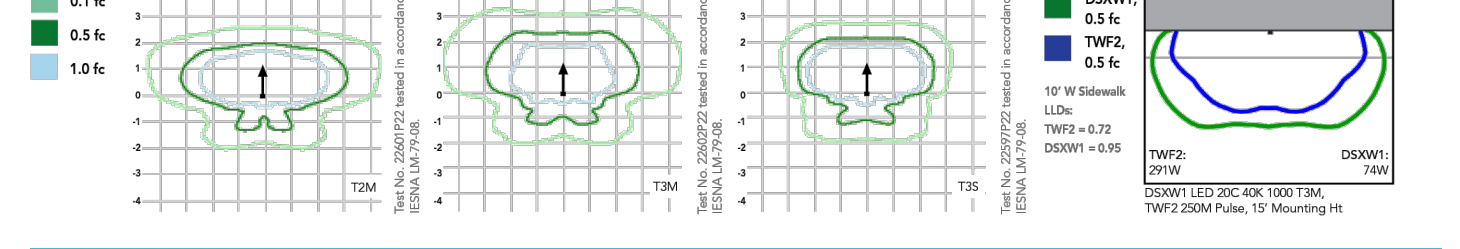

Options and Accessories



INSTALLATION
Included universal mounting bracket attaches securely to any 4" round or square outlet box for quick and easy installation. Luminaire has a slotted gasket wiring and attach to the mounting bracket via corrosion-resistant screws.

CONSTRUCTION
The die-cast aluminum housing has integral heat sink fins to optimize thermal management through conduction and convection cooling. Modular design allows for ease of maintenance. The LED driver is mounted to the door to thermally isolate it from the light engine for the operating temperature during life. Housing is completely sealed against moisture and environmental contaminants (IP66).

FRESH
Exterior parts are protected by a zinc-inflated Super Durable TFC resin-coated powder coat finish that provides superior resistance to corrosion and weathering. A highly controlled multi-stage process ensures a minimum 3 mils thickness for a finish that can withstand extreme climate changes without cracking or peeling. Available in textured and non-textured finishes.

OPTICS
Precision-molded polycarbonate acrylic lenses provide multiple photometric distributions tailored specifically to building-mounted applications. Light engines are available in 3000K CRI, 4000K CRI, 5000K CRI, or 5000K (70 min. CRI) configurations.

ELECTRICAL