

LIGHT FIXTURE NOTE:

ALL LIGHTING FIXTURES SHALL BE FULL CUT-OFF OR HAVE SHIELDING TO REDUCE OFF-SITE LIGHTING IMPACTS ONTO ADJACENT PROPERTIES AND ROADWAYS. ALL EXTERIOR LIGHTING SHALL BE ARRANGED TO MITIGATE LIGHT DIRECTED AWAY FROM ADJACENT PROPERTIES AND ANY PUBLIC RIGHT-OF-WAY. AN AMENDMENT TO THIS PLAN MAY BE REQUIRED IF THE LIGHTING TYPE IS CHANGED.

LIGHT FIXTURE SCHEDULE

MARK	MANUFACTURER	MODEL	LAMP			MOUNTING	DESCRIPTION	VOLTAGE	TOTAL WATTS	NOTES
			QTY.	WATT	TYPE					
P1	LITHONIA	DSX1 LED P2 40K 70CRI BLC4	1	67.8	LED	POLE @ 24'-0"	AREA LUMINAIRE	120/277	67.8	1 - 2
WP1	LITHONIA	DSXW1 LED 10C 350 30K T4M MVOLT	1	13.3	LED	SURFACE	WALLPACK	120/277	13.3	1 - 2

NOTES:

- 1) LIGHTING FIXTURE TO BE CONTROLLED VIA LIGHTING CONTROL PANEL WITH TIME CLOCK AND PHOTOCELL.
- 2) CONFIRM ALL LIGHT FIXTURE SELECTIONS WITH TENANT PRIOR TO ORDERING. THIS INCLUDES COLORS, COLOR TEMPERATURES, MANUFACTURER, ETC.

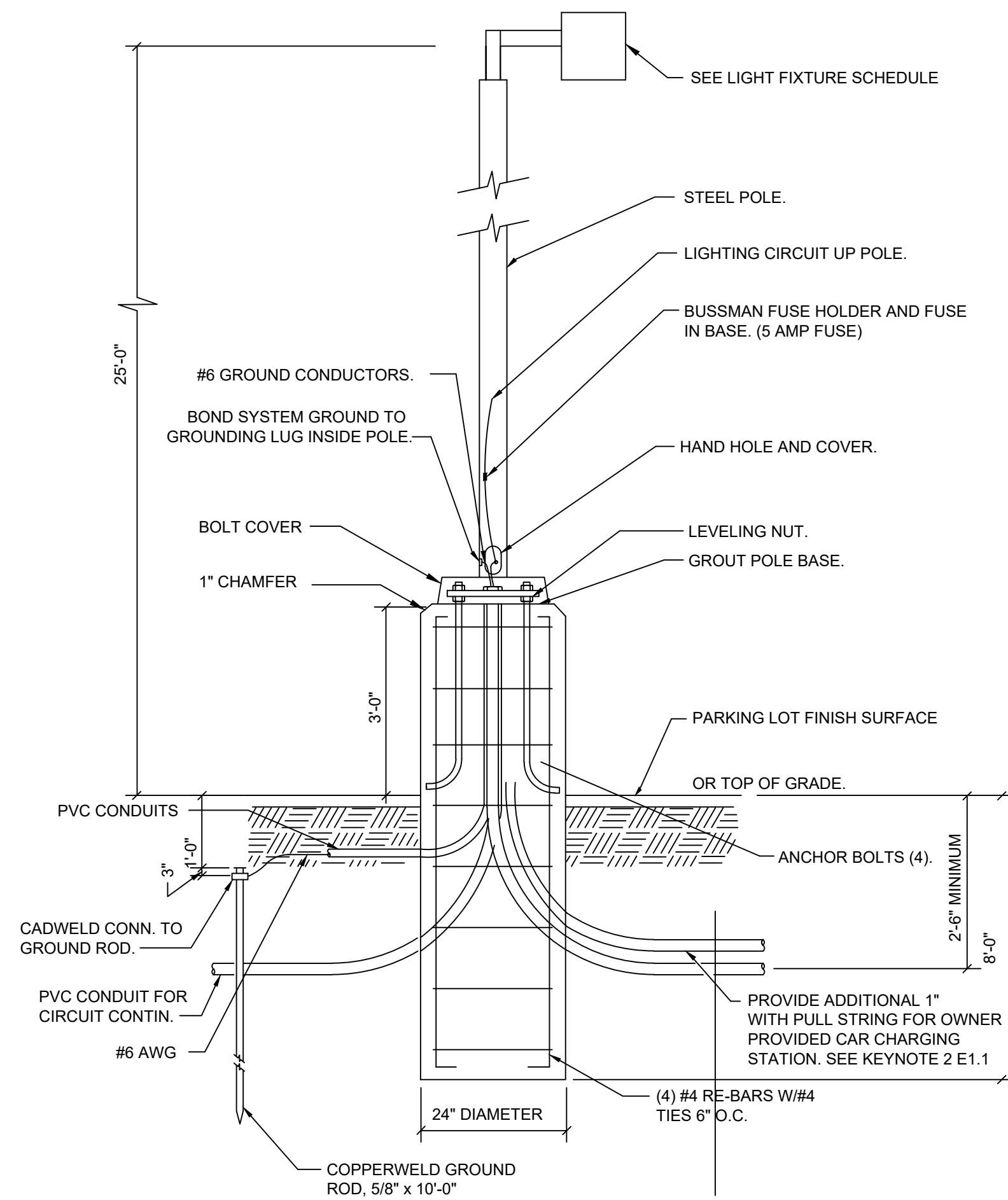

2 TYPICAL POLE BASE DETAIL

ES0.1 SCALE: NONE



4 DSX1 AREA LUMINAIRE (P1)

ES0.1 SCALE: NONE



3 DSX1 WALLPACK (WP1)

ES0.1 SCALE: NONE

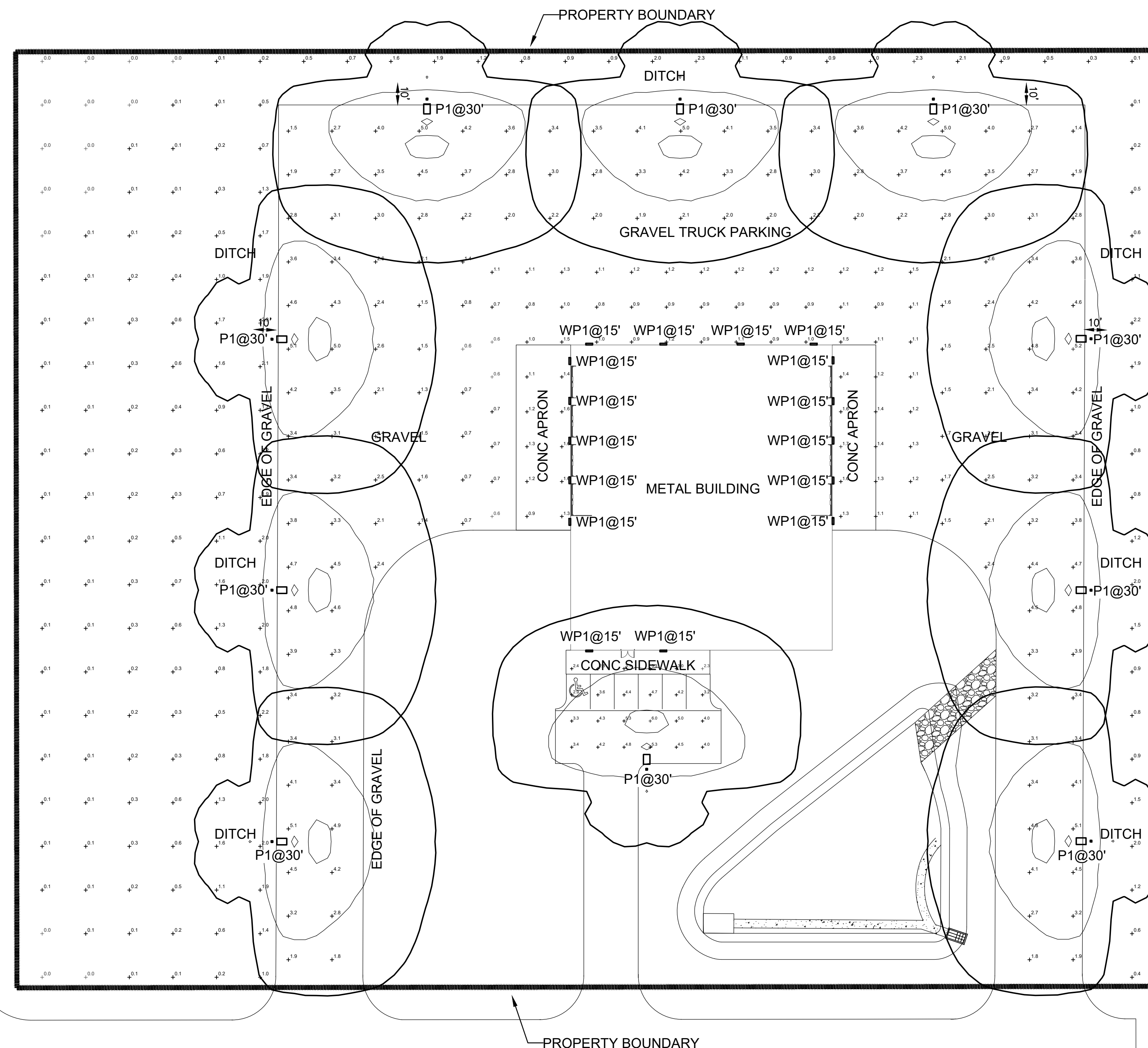

1 SITE PHOTOMETRIC PLAN

ES0.1 SCALE: 1/32"=1'-0"

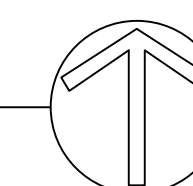

CLIENT:

ARCHITECT:

McShea Consulting, LLC
MECHANICAL + ELECTRICAL + PLUMBING
4445 Northpark Dr. Suite 200
Colorado Springs, CO 80907
mcsheac consulting.com
Project #:

3.18.2024

OWNERSHIP OF INSTRUMENTS OF SERVICE

All Drawings, Reports, Plans, Specifications, Computer Files (including CAD files), field information, notes, sketches, and other design materials prepared by the Engineer and his/her consultants as instruments of service shall remain the property of the Engineer. The Engineer shall retain all common law, statutory and other reserved rights, including the Copyright benefits.

-CITY LINK TRUCKING-

FULL SET ISSUE HISTORY:

1 - PERMIT	3.18.2024

△ SHEET REVISION:

PROJECT #: xxxx
DRAWN BY: SH
CHECKED BY: MRM

SHEET
ES0.1

