



**Final Acceptance Punchlist**  
**El Paso County – Department of Public Works - Stormwater Section**

Project Name:	The Gardens at North Carefree
EDARP Filing Number(s):	SF195, CON2012
ESQCP Number:	ESQ1912
Attendees:	DPW SW: Dylan Finley, Mikayla Hartford, Ben Jones DPW Development Services: Brad Walters, Joe Jackman, Spencer Pirzadeh, David Parkerson Developer: Grace Covington
Date of Walk-Thru:	02/01/2024
Walk-Thru Number:	1 <sup>st</sup>

*When all items below are completed, please let your inspector know as soon as possible so they can come out to the project to confirm.*

**Please complete and return as much of the attached table as possible for the owner and maintenance entity of the PCM(s).**

Findings to be addressed prior to scheduling a follow-up walk-thru:

**Defect Warranty Items for FA**

- **North Pond: (Page 24 of Construction Drawings)**
  - Pond forebay not installed per forebay cross section detail. Re-establish to pond details. Riprap to be installed per plan with a 12” drop between the top of the forebay curb and the riprap.
  - Maintenance road not installed per plan. Re-establish per pond detail, maintenance path to be 12-foot wide and extending to the pond bottom.
  - Orifice plate caulking missing. Re-establish caulking to create a watertight seal.
  - North embankment requires stabilization.
- **South Pond**
  - Pond forebay not installed per forebay cross section detail. Riprap to be installed per plan with a 6” drop between the top of the forebay curb and the riprap.
  - Maintenance road not installed per plan. Re-establish per pond detail, maintenance path to be 12-foot wide and extending to the pond bottom.
  - Reshape the emergency spillway (called overflow weir in plans) so that it is the lowest point along the pond embankments. Properly restabilize.

**Maintenance Items for ESQCP Closure**

- Stabilize disturbed areas and fill holes at north pond overflow weir.
- Remove temporary control measures throughout site.
- Remove sediment from flared end sections and trickle channel.

**Stormwater Inlet Structures:**

- Remove wood forms, sediment, and debris.

Photos:



Photo 1: North pond forebay not installed per spec. (Page 24 Forebay cross section)

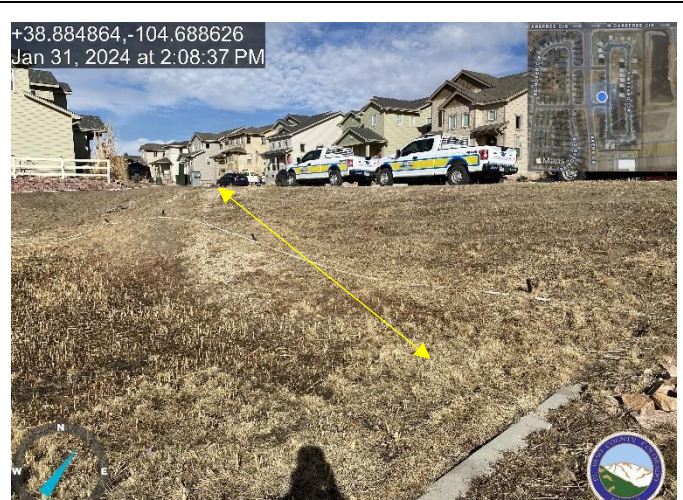

Photo 2: North pond maintenance road not installed per spec. ( 12' wide with 2" rock and extends to forebay)



Photo 3: Trickle channel requires maintenance. Remove sediment and temporary control measures. (North Pond)



Photo 4: Remove sediment from flared end section. (North Pond)



Photo 5: Trickle channel requires maintenance. Remove sediment and temporary control measures. (North Pond)



Photo 6: Stabilize northern pond embankment at north pond.



Photo 7: Re caulk orifice plate at outlet structure.



Photo 8: South pond maintenance road not installed per spec. ( 8' wide with 2" rock and extends to forebay)

+38.884528,-104.688601  
Jan 31, 2024 at 2:27:00 PM



Photo 9: South pond forebay not installed per spec. (Page 25 Forebay cross section)

+38.884528,-104.688601  
Jan 31, 2024 at 2:27:11 PM



Photo 10: Remove sediment and debris from south pond flared end section.

+38.884476,-104.688612  
Jan 31, 2024 at 2:29:37 PM



Photo 11: Reshape the overflow weir so that it is the lowest point along the pond embankments

Photo 12: [Caption]

**Subdivision/Business:**

For sites with PCM(s), please complete and return as much of this table as possible for the PCM(s):

<u>Contact Info</u>	<u>Owner</u>	<u>Responsible Maintenance Entity</u>
Company/Business Name:		
Entity Type: (HOA, Metro District, Trust, Individual, Contractor, Business, etc)		
Mailing Address:		
Primary Contact Name(s):		
Primary Phone Number:		
Primary Email Address:		
Additional Email Addresses to Add to Distribution List:		
Additional Information / Comments:		