

**APPROXIMATE FLOOR AREAS:**

MAIN LEVEL area	= 3754 sf
UPPER LEVEL area	= 3121 sf
Total Interior area	= 6875 sf

Stalls	= 720 sf
Covered entry	= 96 sf
Covered shed	= 772 sf
Future deck	= 772 sf

**GENERAL MAIN LEVEL NOTES:**

XX

**ASSEMBLY NOTES:**

A	ROOF:	ALL ASSEMBLIES AND GENERAL NOTES REFER TO SHEET 'CS1' AND SPECIFICATIONS SHEET 'S61'
B	FASICA/SOFFIT:	
C	EXTERIOR WALL:	
D	EXTERIOR WALL BALLOON FRAME:	
E	FRAMED FLOOR SYSTEM:	
F	EXTERIOR DECK SYSTEM:	
G	RAILING SYSTEM:	
H	STAIRS:	
I	BASEMENT FOUNDATION WALL:	
J	SLAB ON GRADE:	
K	PERIMETER DRAIN SYSTEM:	

**SPECIFIC MAIN LEVEL NOTES:**

B0	4" VENT STACK
B1	NOT USED
B2	NOT USED
B3	NOT USED

NOTE:  
FOR OTHER APPLICABLE KEYNOTES SEE GENERAL NOTE SHEET 'CS1' FOR KEYNOTES 1-30 AND CORRESPONDING ASSEMBLY NOTES.

PRELIMINARY BID REVIEW  
 NOT FOR CONSTRUCTION

REVISIONS

**LGA STUDIOS**  
 409 N. Tejon St. Suite 113  
 Colorado Springs, CO. 80903  
 (719) 635-0880  
 Fax: (719) 694-2088  
 LGAstudiosmailbox@gmail.com  
 www.lgastudios.com

THE  
**BARN AT VENETUCCI**  
 5210 S HIGHWAY 85  
 COMPUTER FILE 612-1002

DRAWN BY LMM  
 CHECKED BY LG  
 PLOT 02/28/13

MAIN LEVEL FLOOR PLAN

Sheet #  
**A1**  
 OF 5 Sheets

**MAIN LEVEL FLOOR PLAN**

SCALE 1/4"=1'

Copyright 1993 by LGA Studios. No part of this plan may be reproduced or transmitted in any form or by any means, electronically or mechanically, including photocopying, recording, or by information retrieval systems without the written approval of LGA Studios and the client. No derivative works of this plan may be made without prior written permission. The client of plans does not warrant the contractor to use for additional construction beyond the scope of one building unless approved in writing by LGA Studios.

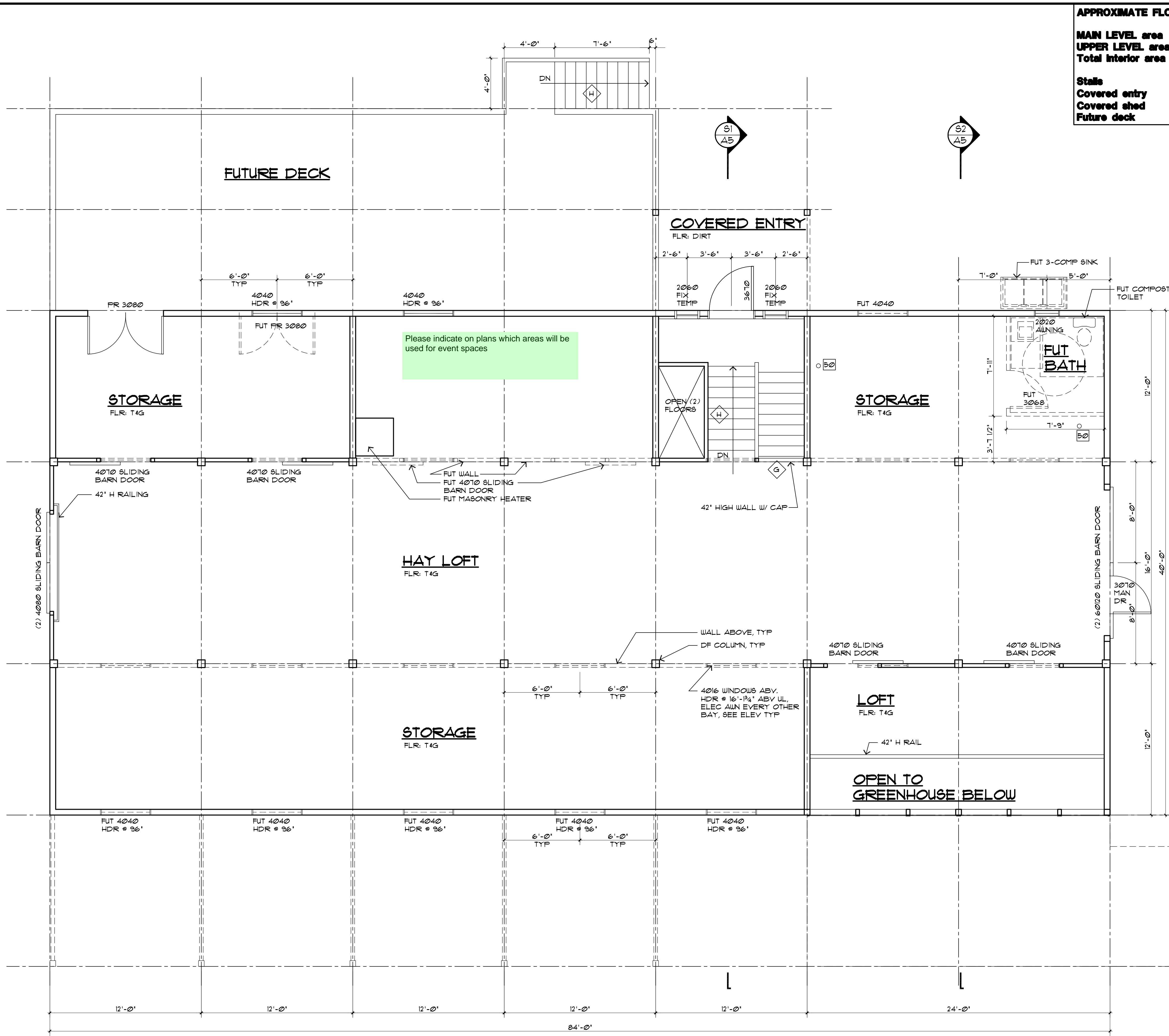

**APPROXIMATE FLOOR AREAS:**

MAIN LEVEL area	= 3754 sf
UPPER LEVEL area	= 3121 sf
Total Interior area	= 6875 sf

Stalls	= 720 sf
Covered entry	= 96 sf
Covered shed	= 772 sf
Future deck	= 772 sf

**GENERAL UPPER LEVEL NOTES:**

XX

- ASSEMBLY NOTES:**
- A ROOF:
  - B FASICA/SOFFIT:
  - C EXTERIOR WALL:
  - D EXTERIOR WALL BALLOON FRAME:
  - E FRAMED FLOOR SYSTEM:
  - F EXTERIOR DECK SYSTEM:
  - G RAILING SYSTEM:
  - H STAIRS:
  - I BASEMENT FOUNDATION WALL:
  - J SLAB ON GRADE:
  - K PERIMETER DRAIN SYSTEM:
- ALL ASSEMBLIES AND GENERAL NOTES REFER TO SHEET 'CS' AND SPECIFICATIONS SHEET 'S6'.

- SPECIFIC UPPER LEVEL NOTES:**
- S6 NOT USED
  - S7 NOT USED
  - S8 NOT USED
  - S9 NOT USED
- NOTE:  
FOR OTHER APPLICABLE KEYNOTES SEE GENERAL NOTE SHEET 'CS' FOR KEYNOTES 1-30 AND CORRESPONDING ASSEMBLY NOTES.

**PRELIMINARY BID REVIEW  
NOT FOR CONSTRUCTION**

REVISIONS

**LGA STUDIOS**  
409 N. Tejon St. Suite 113  
Colorado Springs, CO. 80903  
(719) 635-0880  
Fax: (719) 694-2088  
LGAstudiosmailbox@gmail.com  
www.lgastudios.com

**THE BARN AT VENETUCCI**  
5210 S HIGHWAY 85  
COMPUTER FILE #102-1002

DRAWN BY LMM  
CHECKED BY LG  
PLOT 02/28/13  
UPPER LEVEL FLOOR PLAN