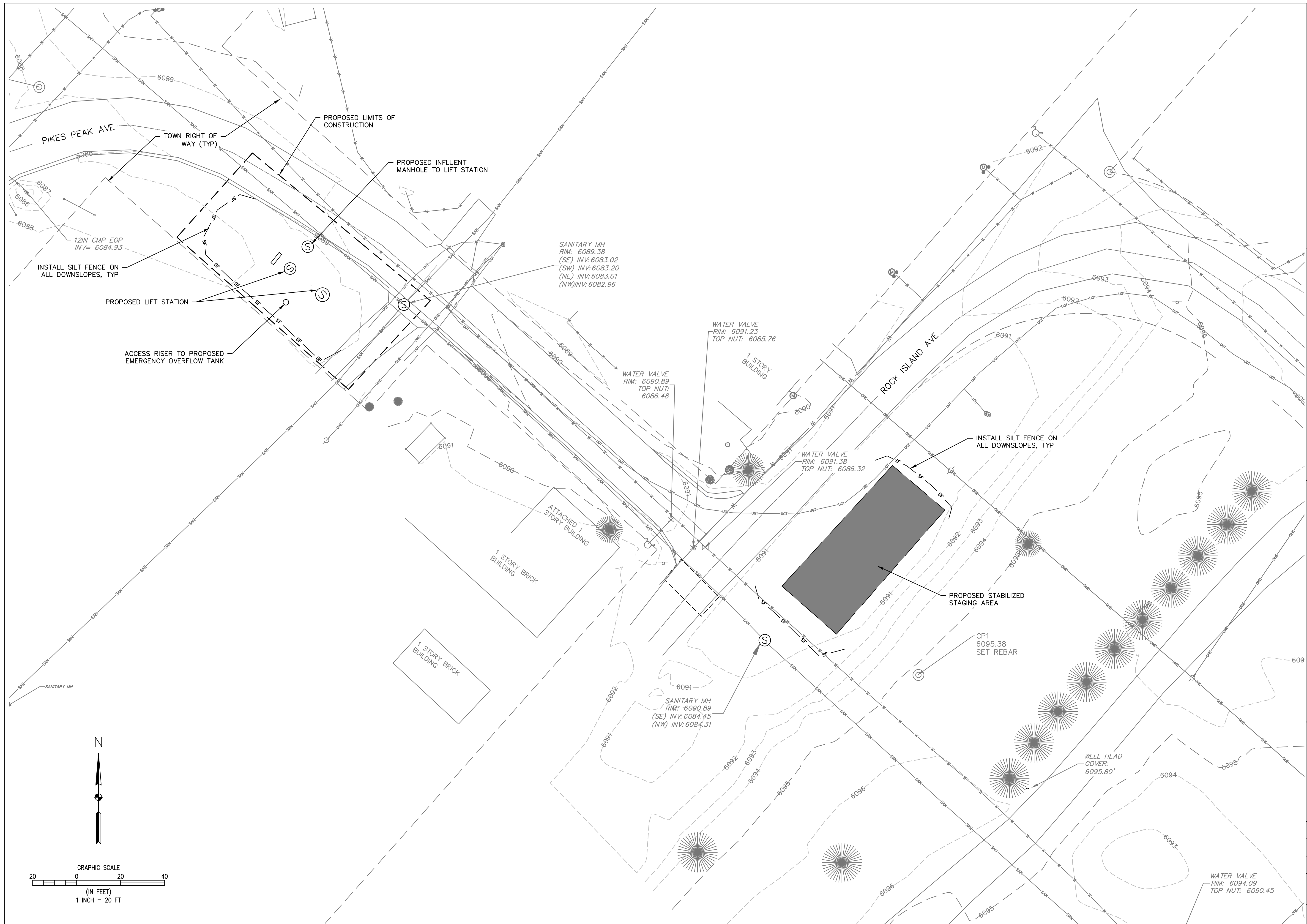

EXHIBIT GG – TEMPORARY LAYDOWN AND STORAGE AREA EXHIBITS



NO.	REVISIONS	DESCRIPTION	DATE	BY

WASTEWATER TREATMENT PLANT
LIFT STATION SITE PLAN
& EROSION CONTROL

TOWN OF RAMAH
113 S. COMMERCIAL STREET
RAMAH, CO 80832

PREPARED UNDER THE DIRECT SUPERVISION OF

FOR AND ON BEHALF OF
ELEMENT ENGINEERING, LLC

DATE
SEPTEMBER 2022

JOB NUMBER
0043.0001

SCALE
1" = 20'

EDITION

PERMITTING

SHEET
C11 of C32

- NOTES:
- POND GRADING SHOWS 6" DEPTH CLEAN ONSITE SANDY MATERIAL COMPACTED OVER LINER.
 - CONTRACTOR TO STRIP TOP 6" OF EXISTING MATERIAL AND VEGETATION AND DISPOSE OF OFF-SITE.
 - CONTRACTOR TO STOCKPILE EXCESS CLEAN MATERIAL AFTER GRADING IS COMPLETE TO USE FOR BALLASTING PONDS AFTER INSTALLATION OF LINER.
 - CONTRACTOR TO COORDINATE WITH THE LINER MANUFACTURER ON PROTECTING THE LINER DURING 6" DEPTH SAND PLACEMENT.

BMP LINE TYPES AND SYMBOLS DESCRIPTIONS

LOC	LIMITS OF CONSTRUCTION
SF	SILT FENCE
SM	SEEDING AND MULCHING
CD	CHECK DAM
SSA	STABILIZED STAGING AREA
VTC	VEHICLE TRACKING CONTROL
CIP	CULVERT INLET PROTECTION
DS	DRAIN SWALE
ECB	EROSION CONTROL BLANKET

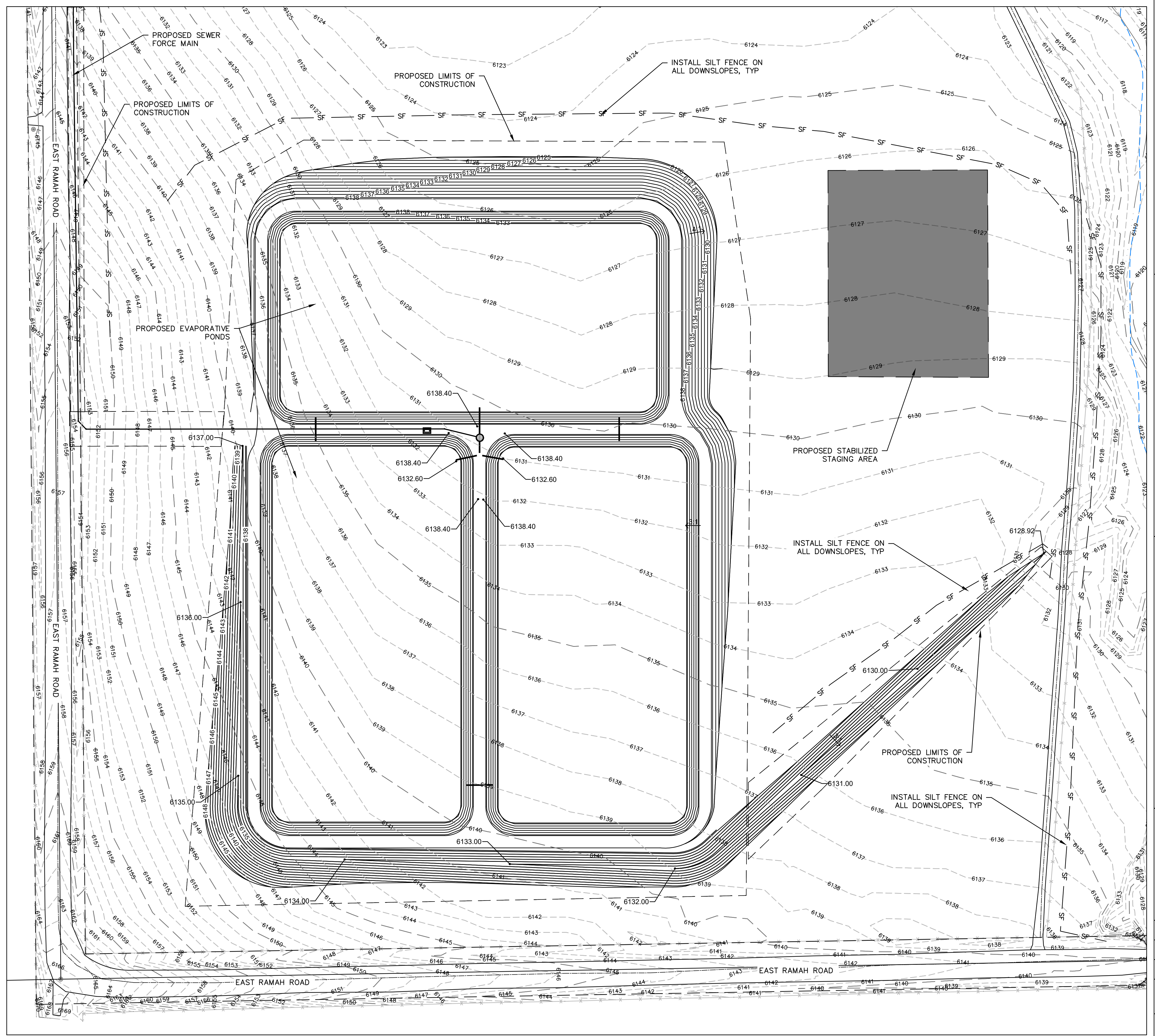
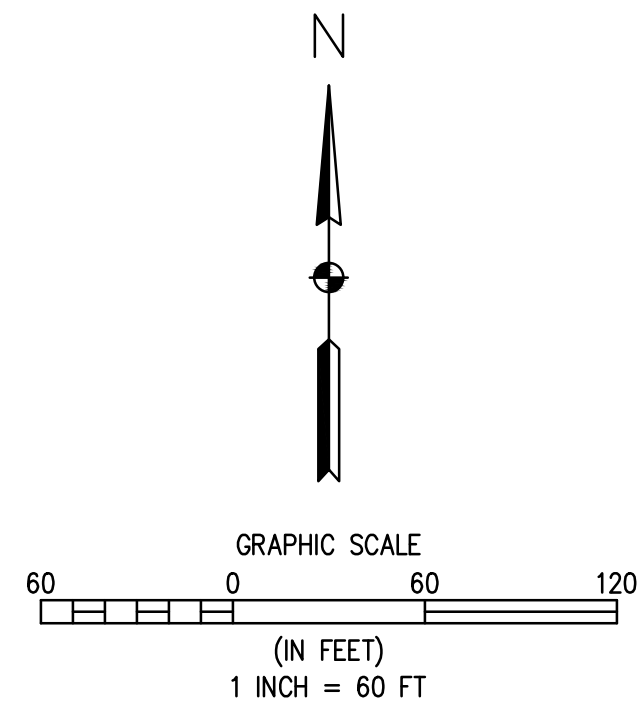

NO.	REVISIONS	DATE	DESCRIPTION

**WASTEWATER TREATMENT PLANT
HORIZONTAL CONTROL &
GRADING**

TOWN OF RAMAH
113 S. COMMERCIAL STREET
RAMAH, CO 80832

FOR AND ON BEHALF OF
ELEMENT ENGINEERING, LLC

DATE
SEPTEMBER 2022

JOB NUMBER
0043.0001

SCALE

EDITION
PERMITTING

SHEET
C22 of C32