



LANDSCAPING NOTES:

1. **PLANT QUANTITY AND SUBSTITUTION:** IN CASE OF DISCREPANCY IN PLANT QUANTITIES SHOWN ON THE PLANT TABLE AND THOSE SHOWN ON THE PLANTING PLAN, THE QUANTITIES SHOWN ON THE PLANTING PLAN SHALL GOVERN. THE MINIMUM ACCEPTABLE SIZES OF PLANTS MEASURED BEFORE PRUNING WITH BRANCHES IN NORMAL POSITION SHALL CONFORM TO THE PLANTING SIZES AS SPECIFIED IN THE SCHEDULE. ANY SUBSTITUTION OF PLANT SIZE OR SPECIES MUST BE SUBMITTED TO THE ENGINEER IN WRITING FOR APPROVAL PRIOR TO INSTALLATION.
2. **ACCEPTABLE PLANT MATERIAL:** ALL PLANTS SHALL MEET OR EXCEED STANDARDS SET BY THE "COLORADO NURSERY ASSOCIATION," AND THE "AMERICAN STANDARD OF NURSERY STOCK." ALL PLANTS SHALL BE TYPICAL OF THEIR SPECIES, HEALTHY, FREE OF DISEASE, INSECT PESTS, MECHANICAL INJURIES, AND HAVE ADEQUATE ROOT SYSTEMS. ALL PLANTINGS SHALL BE INSTALLED PER PLANTING DETAILS. ALL PLANT MATERIAL SHALL BE INSPECTED BY THE ENGINEER OR OWNER PRIOR TO INSTALLATION. STAKING/CONTRACTOR INSPECTION NOTE: ALL PLANTING LOCATIONS TO BE STAKED AND INSPECTED BY CONTRACTOR PRIOR TO INSTALLATION. ALL PLANTS TO BE INSPECTED AT NURSERY LOCATION PRIOR TO TRANSPORTING TO THE SITE.
3. **SITE DISTURBANCE:** ALL AREAS OF SITE DISTURBANCE DUE TO CONSTRUCTION SHALL BE RENOVATED OR PLANTED PER THIS PLAN UNLESS OTHERWISE NOTED.
4. **SOIL AMENDMENTS:** CONTRACTOR SHALL AMENDED PLANTING AREAS AS FOLLOWS:
  - ADD MINIMUM OF 3 CUBIC YARDS OF WELL-COMPOSTED AGED MANURE OR PREMIUM COMPOST PER 1000 S.F.
  - ALL AMENDED AREAS SHALL BE TILLED TO A DEPTH OF 6" PRIOR TO PLANTING.
  - 3 CUBIC YARDS PER 1000 S.F. OF WELL-COMPOSTED AGED MANURE OR PREMIUM COMPOST.
  - ALL AMENDED AREAS SHALL BE TILLED TO A DEPTH OF 6" PRIOR TO PLANTING.
5. **SEEDED TURF:** ALL SEEDED OR HYDOMULCHED AREAS SHALL DEMONSTRATE 95% GERMINATION PRIOR TO FINAL ACCEPTANCE.
6. **IRRIGATION:** OWNER TO HAND WATER FOR ONE TO TWO GROWING SEASONS UNTIL ESTABLISHED AND ON AN AS-NEEDED BASIS THEREAFTER. DISTURBED AREA SEED/GRASS MIXTURE MUST BE IRRIGATED BY OWNER UNTIL ESTABLISHED AND IN TIMES OF DROUGHT. THE ON-GOING MAINTENANCE OF THE NATIVE GRASS IS THE RESPONSIBILITY OF OWNER.
7. **INORGANIC MULCH AND FABRIC:** ALL PLANTINGS TO RECEIVE 3-INCH DEPTH OF INORGANIC MULCH. MULCH RINGS TO BE 15-INCH DIA. FOR (5) GALLON SHRUBS/GRASSES (SEE DETAIL X/X). HIGH QUALITY COMMERCIAL-GRADE (SPUN-BONDED POLYPROPYLENE OR EQUAL) LANDSCAPING FABRIC SHALL BE APPLIED UNDER ALL ROCK BASES.
8. **STEEL EDGE:** ALL EDGER SHALL BE ACME 4" PERFORATED STEEL EDGER "SELF COLORING" 14 GAUGE OR APPROVED EQUAL.
9. **APPROVAL:** ANY FIELD CHANGES OR DEVIATIONS TO THESE PLANS WITHOUT PRIOR APPROVAL OF AN AMENDED DEVELOPMENT PLAN MAY RESULT IN A DELAY OF FINAL APPROVAL AND THE ISSUANCE OF A CERTIFICATE OF OCCUPANCY.
10. **FINAL TREE AND SHRUB LOCATIONS:** ALL TREE LOCATIONS SHALL BE STAKED FOR APPROVAL BY OWNER REPRESENTATIVE/ENGINEER PRIOR TO PLANTING. SHRUBS SHALL BE PLACED IN THEIR LOCATIONS PER THIS PLAN AND APPROVED BY OWNER REPRESENTATIVE/ENGINEER. THE FINAL LOCATION OF TREES TO BE PLANTED MAY REQUIRE ADJUSTMENT BASED ON APPROVAL OF THE FINAL UTILITIES PLANS AND ASSOCIATED FINAL PLAT AND EASEMENTS.

\* BY APPROVING THIS PLAN, THE DIRECTOR IS APPROVING AN ALTERNATE LANDSCAPING DESIGN AS IT RELATES AND CONFORMS TO HOMELAND SECURITY STANDARDS AND PROMOTES WATER CONSERVATION WHILE MEETING THE PURPOSES DESCRIBED IN THE LAND DEVELOPMENT CODE.

SCHEDULE - XERIC/LOW WATER VEGETATION

| SYMBOL  | BOTANICAL NAME                  | COMMON NAME         | QTY. | MATURE SIZE   | PLANTING SIZE (MIN.) | COMMENTS   |
|---|---------------------------------|---------------------|------|---------------|----------------------|--|
|  | GRASS                           |                     |      |               |                      |  |
|   | SCHIZACHRIUM SCOPARIUM          | LITTLE BLUESTEM     | 8    | 2'-0" x 1'-6" | #3 CONT.             | CLUSTER SPACING IN LANDSCAPE CENTERED BETWEEN SHRUBS           |
|  | SHRUB                           |                     |      |               |                      |  |
|   | CERCOCARPUS MONTANUS            | MOUNTAIN MAHOGANY   | 3    | 5'-0" x 4'-0" | #5 CONT.             | MAINTAIN SHAPE AND SIZE BY PRUNING LATE WINTER TO EARLY SPRING |
|  | POTENTILLA FRUTICOSA            | GOLDSTAR POTENTILLA | 3    | 2'-6" x 3'-0" | #5 CONT.             | CENTER WITHIN LANDSCAPE AREA AS SHOWN                          |
|  | JUNIPERUS CHNENSIS "BLUE POINT" | BLUE POINT JUNIPER  | 4    | 8 FT.         | 1-INCH CAL.          | PLACE WITHIN SOUTHERN 20 FEET OF LIFT STATION EASEMENT.        |

- 1 TYP SHRUB/GRASS PLANTING - REF: DETAIL A/C19
- 2 STEEL EDGE, TYP FOR SEPARATION BETWEEN TURF, GRAVEL/MULCH, AND BASECOURSE AREAS - REF: DETAIL B/C19
- 3 MULCH @ 3" DEPTH MIN.

LANDSCAPING

|   |                     |
|---|---------------------|
| INTERNAL                                    |                     |
| NET SITE AREA                               | 14,365 S.F.         |
| % MINIMUM INTERNAL AREA                     | 5                   |
| INTERNAL AREA REQUIRED/PROVIDED             | 718 S.F. / 774 S.F. |
| PARKING LOT LANDSCAPE (N/A)                 |                     |
| ROAD FRONTAGE                               |                     |
| FALCON HWY (MINOR ARTERIAL)                 | 93 LF               |
| FRONTAGE WIDTH REQUIRED/PROVIDED            | 20' / 20'           |
| NUMBER OF TREES REQUIRED @ 1/25 LF/PROVIDED | 4 / 4               |

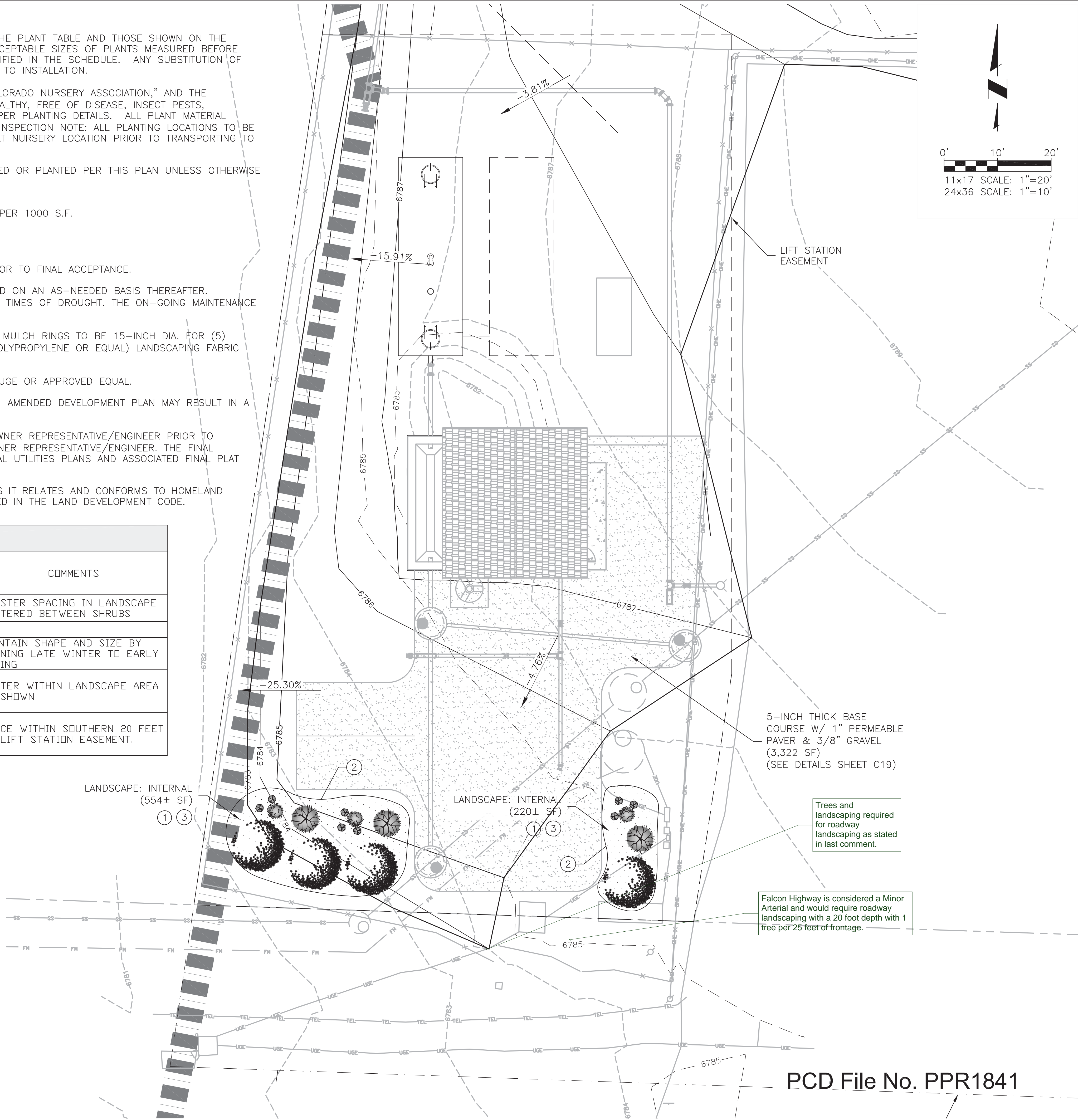

**JDS-HYDRO** CONSULTANTS, INC.  
545 EAST PIKES PEAK AVENUE, SUITE 300  
COLORADO SPRINGS, COLORADO 80903  
(719) 227-0072

DESIGNER: THE CONTRACTOR SHALL VERIFY ALL DIMENSIONS. ANY ERRORS OR OMISSIONS SHALL BE REPORTED TO JDS-HYDRO CONSULTANTS, INC. JDS-HYDRO ASSUMES NO LIABILITY FOR UNAUTHORIZED CHANGES AND/OR REVISIONS MADE TO PLANS.

WOODMEN HILLS METROPOLITAN DISTRICT  
LIFT STATION #1 REPLACEMENT  
LANDSCAPING PLAN & NOTES

| NO. | DESCRIPTION | BY | APP. | DATE |
|-----|-------------|----|------|------|
| 1   |             |    |      |      |
| 2   |             |    |      |      |
| 3   |             |    |      |      |
| 4   |             |    |      |      |
| 5   |             |    |      |      |
| 6   |             |    |      |      |
| 7   |             |    |      |      |

100% DESIGN DRAWINGS



Project No.: 112.96  
Date: 11/19/18  
Design: RMM  
Drawn: RMM  
Check: DES

C18  
SHEET 18 OF 19

PCD File No. PPR1841



2018/12/03 11:22 AM By: RMM J:\JDS-Hydro\Project Files\112 Woodmen Hills\112.96 Lift Station 1 Replacement\Drawings\11296\_1\_GEC.dwg

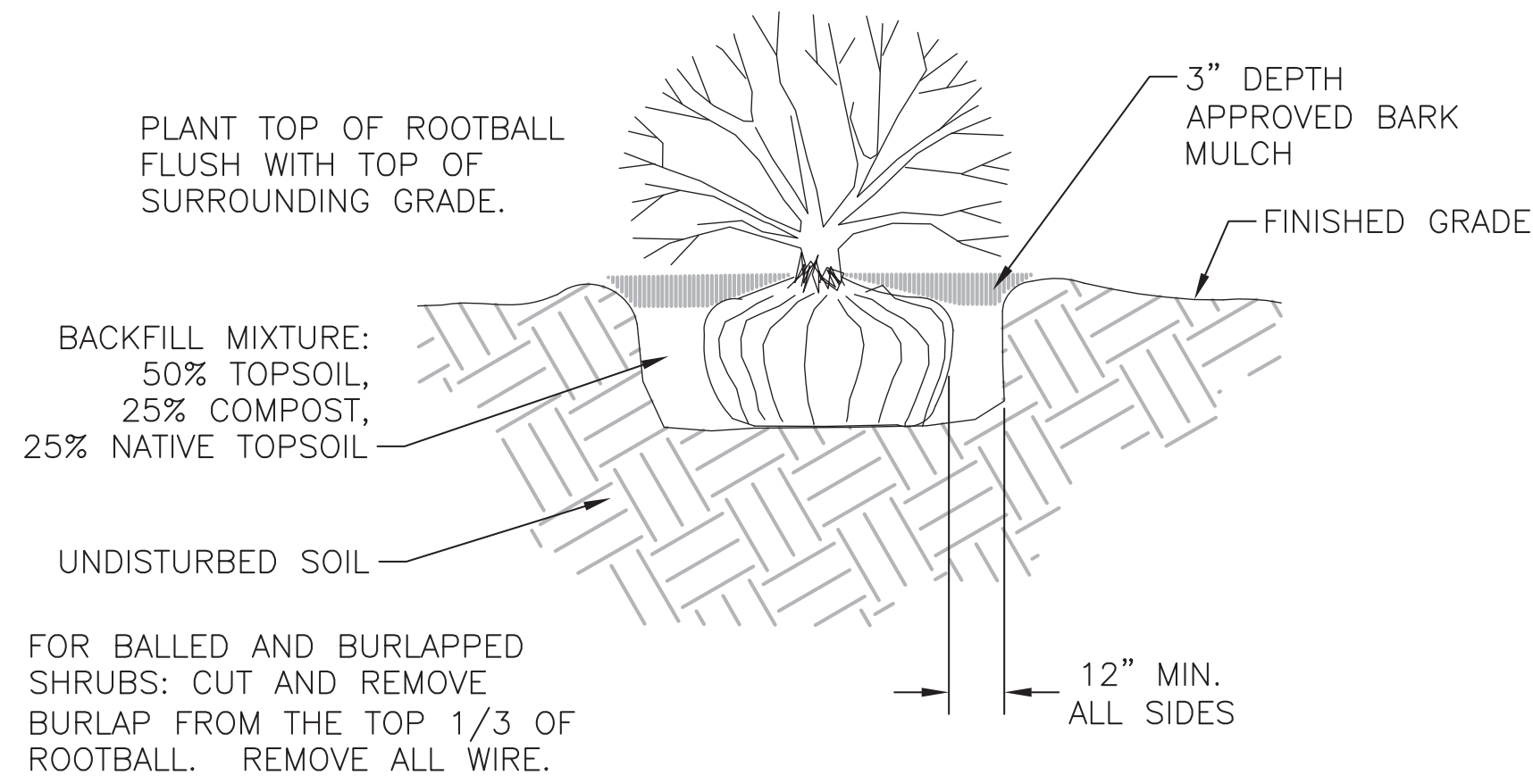

**A** SHRUB DECORATIVE GRASS PLANTING DETAIL  
SCALE: N.T.S.

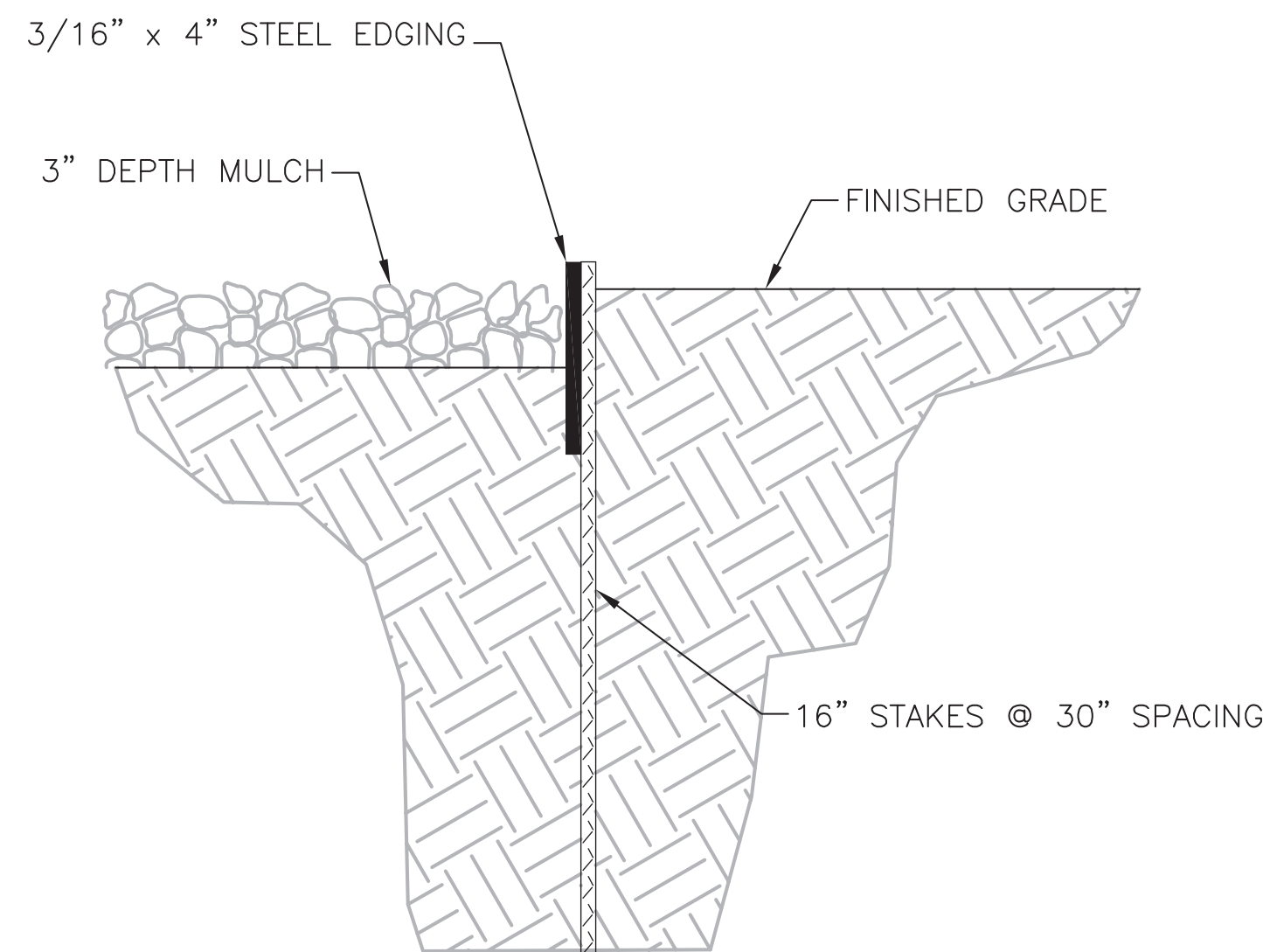

**B** STEEL EDGE DETAIL  
SCALE: N.T.S.

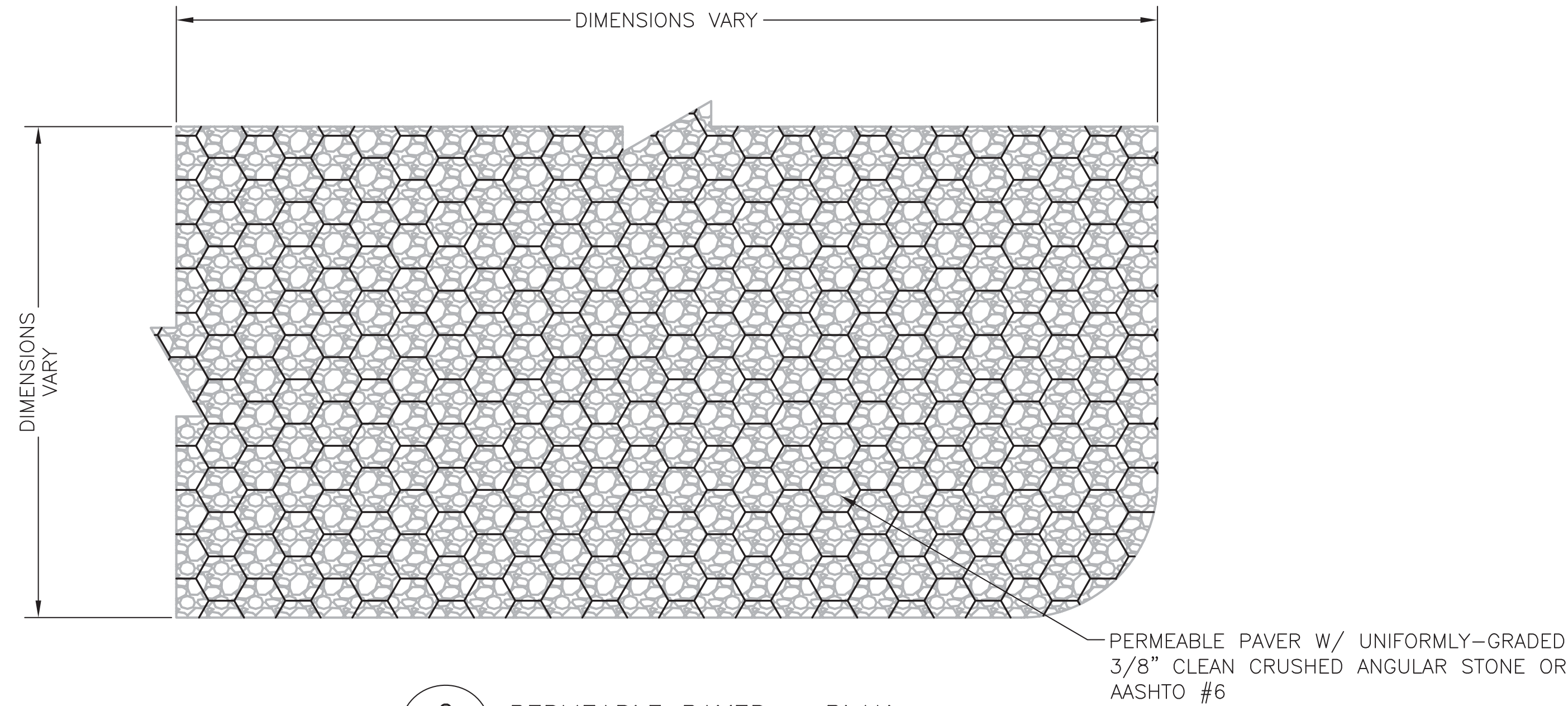

**C** PERMEABLE PAVER - PLAN  
SCALE: N.T.S.

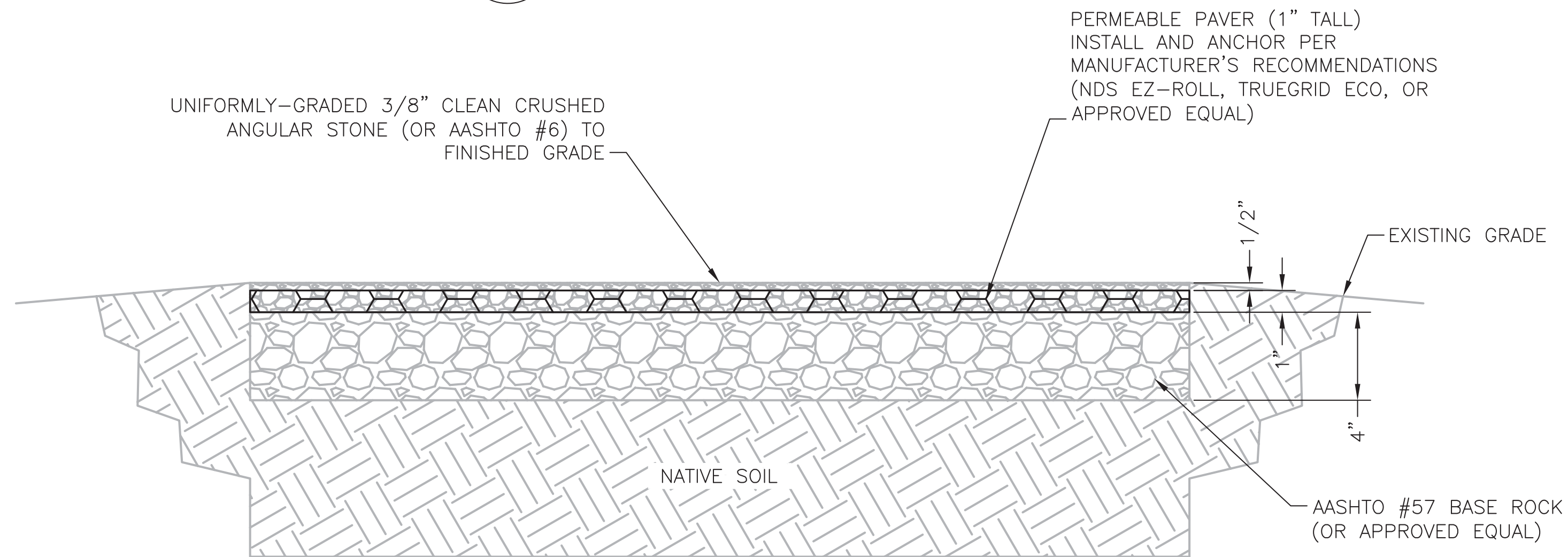

**D** PERMEABLE PAVER - SECTION  
SCALE: N.T.S.

**PERMEABLE PAVER NOTES:**

**ENGINEERING PROPERTIES:**

- COMPRESSIVE STRENGTH:  
EMPTY PAVERS: ULTIMATE LOAD = 53,683 LBS / 373 PSI  
FILLED PAVERS: ULTIMATE LOAD = 500,000 LBS
- POROSITY OF AASHTO #57 AGGREGATE = 0.4

**GRAVEL FILL:**

- UNIFORMLY-GRADED 3/8" CLEAN CRUSHED ANGULAR STONE OR AASHTO #6.
- EXTEND 3/8" GRAVEL INSIDE PAVER AN ADDITIONAL 1/2 INCH ABOVE PAVER SURFACE AND MATCH SURROUNDING GRADE. PROPOSED FINISHED GRADE SLOPE PER PROJECT GRADING PLAN.
- PROVIDE 1" (MIN.) CLEARANCE BETWEEN ANY CONCRETE EDGE AND PAVER.

**AASHTO #57 BASE ROCK:**

- GRADATION OF AASHTO #57 COARSE BASE ROCK: 100% PASSING 1-1/2" SCREEN, 95-100% PASSING 1", 25-60% PASSING 1/2", AND 0-10% PASSING #8 SCREEN.
- THICKNESS OF AGGREGATE LAYER IS AS FOLLOWS: NO BASE REQUIRED FOR EROSION CONTROL AND PEDESTRIAN-ONLY LOADS
- COMPACTION OF NATIVE SOIL RECOMMENDED FOR SLOPES UP TO 3%; 4 INCHES FOR LIGHT LOADS (GOLF CARTS); 6 INCHES FOR MEDIUM LOADS (CARS AND PICKUP TRUCKS); 8 INCHES FOR HEAVY LOADS (FIRE TRUCKS).
- COMPACT WITH ONE TO THREE PASSES OF 5-TON STEEL WHEEL ROLLER. SINCE IT IS DIFFICULT TO MEASURE DENSITY OF COARSE AGGREGATE, APPROACH OF REQUIRING A FIXED DENSITY IS NOT APPLICABLE.

**SUBGRADE NATIVE SOIL:**

- COMPACT SUBGRADE NATIVE SOILS TO 95% STANDARD PROCTOR DENSITY PER ASTM D696
- CONSULT WITH PROJECT GEOTECHNICAL ENGINEER FOR POTENTIAL SOIL MODIFICATION (EG. LIME TREATMENT) AND COMPACTION LEVEL FOR CBR <5% AND R-VALUE <10, AASHTO A-5, A-6, AND A-7 SOILS.

PCD File No. PPR1841

| NO. | REVISIONS   |    |      | DATE |
|-----|-------------|----|------|------|
|     | DESCRIPTION | BY | APP. |      |
| 1   |             |    |      |      |
| 2   |             |    |      |      |
| 3   |             |    |      |      |
| 4   |             |    |      |      |
| 5   |             |    |      |      |
| 6   |             |    |      |      |
| 7   |             |    |      |      |

**100% DESIGN DRAWINGS**



Project No.: 112.96  
Date: 11/19/18  
Design: RMM  
Drawn: RMM  
Check: DES

# Markup Summary

dskendall (2)

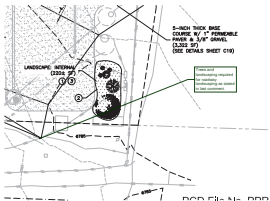

**Subject:** Callout  
**Page Label:** 1  
**Lock:** Unlocked  
**Author:** dskendall  
**Date:** 2/27/2019 7:36:47 AM  
**Color:** ■

Trees and landscaping required for roadway landscaping as stated in last comment.

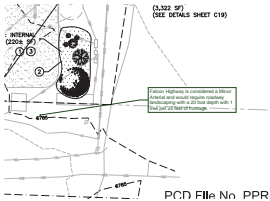

**Subject:** Callout  
**Page Label:** 1  
**Lock:** Unlocked  
**Author:** dskendall  
**Date:** 2/27/2019 7:37:11 AM  
**Color:** ■

Falcon Highway is considered a Minor Arterial and would require roadway landscaping with a 20 foot depth with 1 tree per 25 feet of frontage.