

| Label       | Units | Avg  | Max  | Min | Avg/Min | Max/Min |
|-------------|-------|------|------|-----|---------|---------|
| SITE        | Fc    | 0.48 | 11.9 | 0.0 | N.A.    | N.A.    |
| DRIVE AISLE | Fc    | 1.57 | 3.6  | 0.2 | 7.85    | 18.00   |
| PARKING 1   | Fc    | 1.05 | 1.9  | 0.5 | 2.10    | 3.80    |
| PARKING 2   | Fc    | 1.93 | 3.6  | 1.0 | 1.93    | 3.60    |
| PARKING 3   | Fc    | 2.98 | 5.9  | 1.2 | 2.48    | 4.92    |
| PARKING 4   | Fc    | 2.66 | 4.8  | 1.2 | 2.22    | 4.00    |
| PARKING 5   | Fc    | 2.99 | 5.6  | 1.6 | 1.87    | 3.50    |

| Symbol | Qty | Label                       | Arrangement | Description                 | Tag | LLF   | Luminaire Lumens | Luminaire Watts | Total Watts |
|--------|-----|-----------------------------|-------------|-----------------------------|-----|-------|------------------|-----------------|-------------|
| □      | 2   | DSX0 LED P5 30K 70CRI T5W   | Single      | DSX0 LED P5 30K 70CRI T5W   | A1  | 0.900 | 12308            | 90.12           | 180         |
| □      | 4   | DSX0 LED P3 30K 70CRI TFTM  | Single      | DSX0 LED P3 30K 70CRI TFTM  | A3  | 0.900 | 8624             | 68.95           | 275         |
| □      | 1   | DSX0 LED P3 30K 70CRI RCCO  | Single      | DSX0 LED P3 30K 70CRI RCCO  | A4  | 0.900 | 6194             | 68.95           | 69          |
| □      | 3   | WDGE3 LED P2 70CRI RFT 30K  | Single      | WDGE3 LED P2 70CRI RFT 30K  | A5  | 0.900 | 7922             | 59.2761         | 177         |
| □      | 7   | WDGE2 LED P3 30K 70CRI TFTM | Single      | WDGE2 LED P3 30K 70CRI TFTM | W1  | 0.900 | 3317             | 32.1375         | 225         |
| □      | 2   | WS-W36610-BZ                | Single      | WS-W36610-BZ                | W4  | 0.900 | 557              | 11.0977         | 22          |

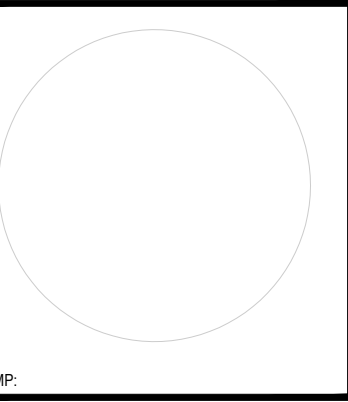
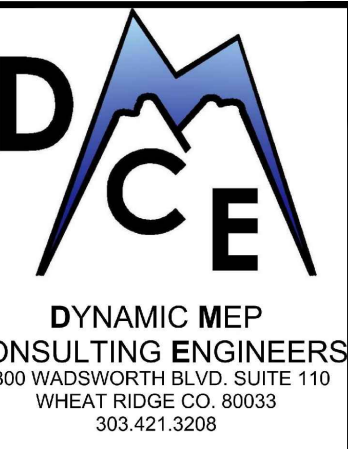

ATTENTION: THESE MATERIALS ARE OWNED AND COPYRIGHTED BY DYNAMIC AND CONTAIN TECHNICAL DESIGN AND CONFIDENTIAL INFORMATION WHICH ARE TRADE SECRETS AS DEFINED BY STATE LAW. ACCESS TO THESE MATERIALS IS GIVEN ONLY TO APPROVED CONTRACTORS AND MATERIAL MEN AND ONLY FOR USE IN THE BIDDING AND CONSTRUCTION OF THE PROJECT SPECIFIED BY THESE MATERIALS. ANY USE OF THE INFORMATION FOR PURPOSES BEYOND THOSE EXPRESSLY PERMITTED BY DYNAMIC IS A VIOLATION OF STATE AND FEDERAL LAW AND MAY SUBJECT THE USER TO CIVIL AND CRIMINAL PENALTIES.

Ensure that lighting levels do not exceed 0.1 foot candles at the property boundaries adjacent to right of way or residential as per Section 6.2.3.1.e. of the Land Development Code.

This square is not included in the parcel boundary. Please correct.

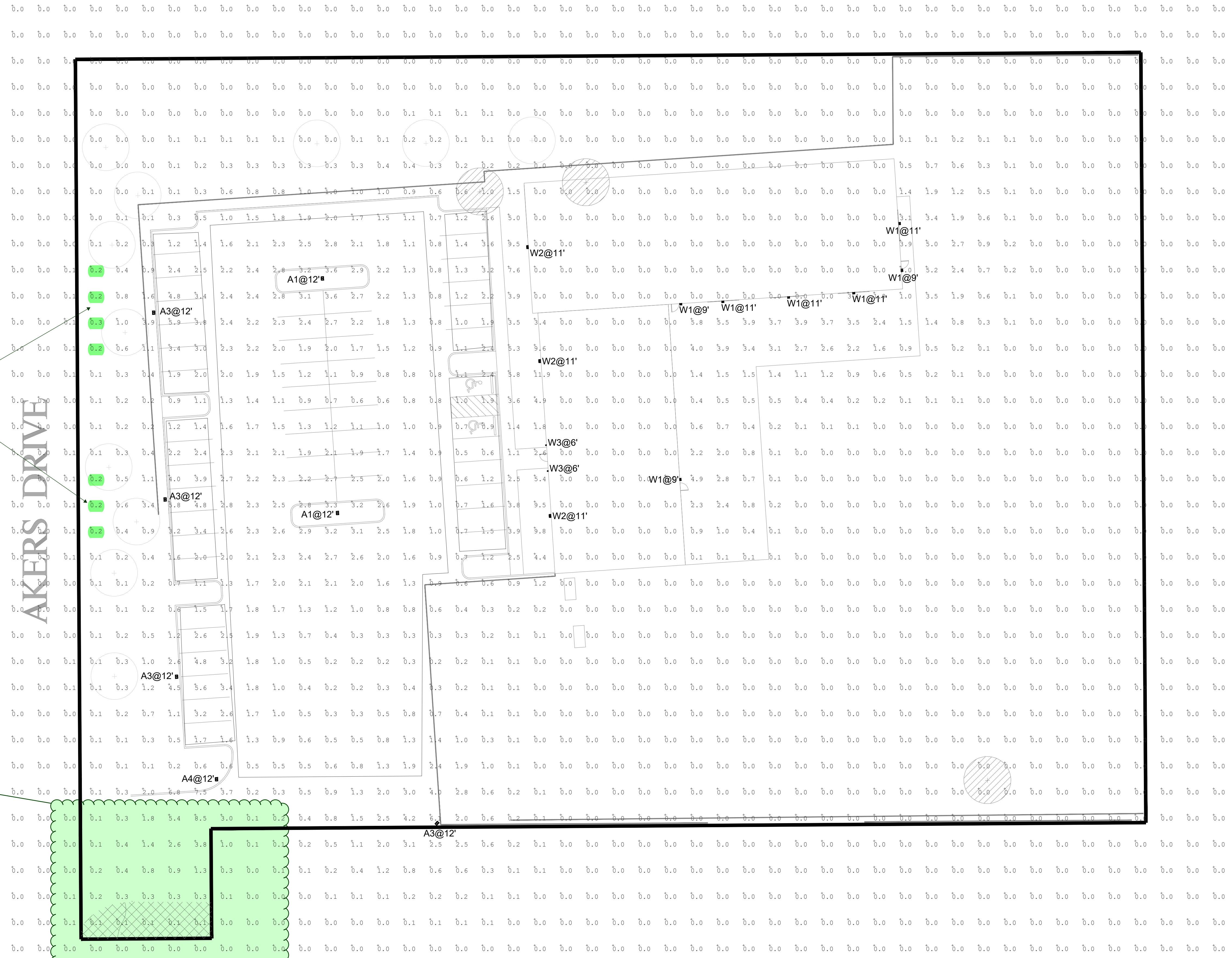

LANDSCAPE ENDEAVORS  
2725 AKERS RD  
COLORADO SPRINGS, CO  
BUCHER DESIGN STUDIO INC  
12325 ORACLE BLVD #101  
COLORADO SPRINGS, CO

These documents are prepared for exclusive use by

| NO. | DATE | REVISIONS DESCRIPTION |
|-----|------|-----------------------|
|     |      |                       |

DRAWN BY: EL  
CHECKED BY: MB  
ISSUE DATE: 1/3/2025

SHEET NO.  
**EP-1**

PCD File No. PPR255



### WDGE3 LED Architectural Wall Sconce

Catalog Number: TYPE W2 FIXTURE



10 See the Tab key or mouse over the page to see all interactive elements.

**Specifications**

Depth (D1): 8"  
Depth (D2): 1.5"  
Height: 9"  
Width: 18"  
Weight: 19.5 lbs (without options)

The WDGE LED family is designed to meet specifier's every wall-mounted lighting need in a widely accepted shape that blends with any architecture. The clean rectangular design comes in four sizes with lumen packages ranging from 1,200 to 25,000 lumens, providing a true site-wide solution. Embedded with nLight® AIR wireless controls, the WDGE family provides additional energy savings and code compliance.

WDGE3 has been designed to deliver up to 12,000 lumens through a precision refractive lens with wide distribution, perfect for augmenting the lighting from pole mounted luminaires.

Items marked by a shaded background qualify for the Design Select program and ship in 15 days or less. To learn more about Design Select, visit [www.aaculitybrands.com/designselect](http://www.aaculitybrands.com/designselect). \*See ordering tree for details.

| Luminaire | Optics               | Standard EM, 0°C | Cold EM, -20°C | Sensor             | F0    | F1     | F2     | F3     | F4     | F5     | F6     |
|-----------|----------------------|------------------|----------------|--------------------|-------|--------|--------|--------|--------|--------|--------|
| WDGE1 LED | Visual Comfort       | 4W               |                |                    | 750   | 1,200  | 2,000  |        |        |        |        |
| WDGE2 LED | Visual Comfort       | 10W              | 18W            | Standalone /nLight | 1,200 | 2,000  | 3,000  | 4,500  | 6,000  |        |        |
| WDGE2 LED | Precision Refractive | 10W              | 18W            | Standalone /nLight | 700   | 1,200  | 2,000  | 3,200  | 4,200  |        |        |
| WDGE3 LED | Precision Refractive | 15W              | 18W            | Standalone /nLight | 6,000 | 7,500  | 8,500  | 10,000 | 12,000 |        |        |
| WDGE4 LED | Precision Refractive |                  |                | Standalone /nLight | --    | 12,000 | 16,000 | 18,000 | 20,000 | 22,000 | 25,000 |

**Ordering Information** EXAMPLE: WDGE3 LED P3 40K 70CRI R3 MVOLT SRM DDBXD

| Series    | Package | Color Temperature | CR    | Distribution      | Voltage | Mounting                                                                                                       |
|-----------|---------|-------------------|-------|-------------------|---------|----------------------------------------------------------------------------------------------------------------|
| WDGE3 LED | P0      | 30K 3000K         | 70CRI | R2 Type 2         | MVOLT   | Shipped included                                                                                               |
|           | P1      | 40K 4000K         | 80CRI | R3 Type 3         | 247     | SRM Surface-mounting bracket                                                                                   |
|           | P2      | 50K 5000K         |       | R4 Type 4         | 480*    | KW Indirect Canopy/Ceiling Washer bracket (dry/damp locations only)                                            |
|           | P3      |                   |       | RFT Forward Throw |         | P88W Surface-mounted back box (top, left, right, conduit entry). Use when there is no junction box available.* |

**Options**

| Options                                                                                               | Stand-alone Sensors/Controls                                                                                                                                            | Finish                        |
|-------------------------------------------------------------------------------------------------------|-------------------------------------------------------------------------------------------------------------------------------------------------------------------------|-------------------------------|
| E15WH Emergency battery backup, Certified in CA Title 20 MADDIS (15W, 5°C min)                        | PIR Bi-level (100/5%) motion sensor for 8-15' mounting heights. Intended for use on switched circuits with external dusk to dawn switching.                             | DDBXD Dark bronze             |
| E20WC Emergency battery backup, Certified in CA Title 20 MADDIS (10W, 20°C min)                       | PIRH Bi-level (100/5%) motion sensor for 15-30' mounting heights. Intended for use on switched circuits with external dusk to dawn switching.                           | DRLXD Black                   |
| PE Photocell, Button Type*                                                                            | PIRHCW Bi-level (100/5%) motion sensor for 8-15' mounting heights with photocell pre-programmed for dusk to dawn operation.                                             | DNAXD Natural aluminum        |
| DMG 0-10V dimming wires pulled outside fixture (for use with an external control, ordered separately) | PIRH2CW Bi-level (100/5%) motion sensor for 15-30' mounting heights with photocell pre-programmed for dusk to dawn operation.                                           | DWHXD White                   |
| BCE Bottom conduit entry for back box (P88W). Total of 4 entry points.                                | <b>Networked Sensors/Controls</b>                                                                                                                                       | DSDX Sandstone                |
| SPI0KV 10KV Surge pack*                                                                               | NLTARZ PIR Embedded wireless controls by nLight with Passive Infrared Occ sensor and on/off photocell for 8-15' mounting heights.                                       | DOBTD Toned dark bronze       |
| CCE Coastal Construction*                                                                             | NLTAR2 PIR Embedded wireless controls by nLight with Passive Infrared Occ sensor and on/off photocell for 15-30' mounting heights.                                      | DLNATD Toned natural aluminum |
|                                                                                                       | NLTAR2 PIRH Embedded wireless controls by nLight with UL924 listed emergency operation, Passive Infrared Occ sensor and on/off photocell for 8-15' mounting heights.    | DNATXD Toned natural aluminum |
|                                                                                                       | NLTAREM2 PIRH Embedded wireless controls by nLight with UL924 listed emergency operation, Passive Infrared Occ sensor and on/off photocell for 15-30' mounting heights. | DWHGD Toned white             |
|                                                                                                       |                                                                                                                                                                         | DSDZD Toned sandstone         |

**Accessories**

WDGE3WB DDBXD WDGE3WB DDBXD (Specify finish)

**Notes**

- 347V and 480V not available with E15WH and E20WC.
- Not qualified for DLC. Not available with emergency battery backup or sensor/controls.
- For P88W and P88W with CCE option, require an RFA.
- Available with MVOLT only and only rated to 25C ambient.
- DMA option not available with sensors/controls.
- Not available with E20WC option.
- 7 Available with MVOLT only and only rated to 25C ambient.

**LITHONIA LIGHTING** COMMERCIAL OUTDOOR One Lithonia Way • Conyers, Georgia 30012 • Phone: 1-800-705-SERV (7378) • [www.lithonia.com](http://www.lithonia.com) WDGE3 LED Rev. 07/08/24 © 2019-2024 Acuity Brands Lighting, Inc. All rights reserved.

### WDGE2 LED Architectural Wall Sconce Precision Refractive Optic

Catalog Number: TYPE W1 FIXTURE



10 See the Tab key or mouse over the page to see all interactive elements.

**Specifications**

Depth (D1): 7"  
Depth (D2): 1.5"  
Height: 9"  
Width: 11.5"  
Weight: 13.5 lbs (without options)

The WDGE LED family is designed to meet specifier's every wall-mounted lighting need in a widely accepted shape that blends with any architecture. The clean rectangular design comes in four sizes with lumen packages ranging from 1,200 to 25,000 lumens, providing a true site-wide solution. Embedded with nLight® AIR wireless controls, the WDGE family provides additional energy savings and code compliance.

WDGE2 with industry leading precision refractive optics provides great uniform distribution and optical control. When combined with multiple integrated emergency battery backup options, including an 18W cold temperature option, the WDGE2 becomes the ideal wall-mounted lighting solution for pedestrian scale applications in any environment.

Items marked by a shaded background qualify for the Design Select program and ship in 15 days or less. To learn more about Design Select, visit [www.aaculitybrands.com/designselect](http://www.aaculitybrands.com/designselect). \*See ordering tree for details.

| Luminaire | Optics               | Standard EM, 0°C | Cold EM, -20°C | Sensor             | F0    | F1     | F2     | F3     | F4     | F5     | F6     |
|-----------|----------------------|------------------|----------------|--------------------|-------|--------|--------|--------|--------|--------|--------|
| WDGE1 LED | Visual Comfort       | 4W               |                |                    | 750   | 1,200  | 2,000  |        |        |        |        |
| WDGE2 LED | Visual Comfort       | 10W              | 18W            | Standalone /nLight | 1,200 | 2,000  | 3,000  | 4,500  | 6,000  |        |        |
| WDGE2 LED | Precision Refractive | 10W              | 18W            | Standalone /nLight | 700   | 1,200  | 2,000  | 3,200  | 4,200  |        |        |
| WDGE3 LED | Precision Refractive | 15W              | 18W            | Standalone /nLight | --    | 7,500  | 8,500  | 10,000 | 12,000 | --     | --     |
| WDGE4 LED | Precision Refractive |                  |                | Standalone /nLight | --    | 12,000 | 16,000 | 18,000 | 20,000 | 22,000 | 25,000 |

**Ordering Information** EXAMPLE: WDGE2 LED P3 40K 80CRI T3M MVOLT SRM DDBXD

| Series    | Package | Color Temperature | CR                    | Distribution       | Voltage | Mounting                                                                                                       |
|-----------|---------|-------------------|-----------------------|--------------------|---------|----------------------------------------------------------------------------------------------------------------|
| WDGE2 LED | P0*     | 27K 2700K         | 70CRI                 | T15 Type 1 Short   | MVOLT   | Shipped included                                                                                               |
|           | P1*     | 30K 3000K         | 80CRI                 | T3M Type 1 Medium  | 247     | SRM Surface-mounting bracket                                                                                   |
|           | P2*     | 40K 4000K         | LW Limited Wavelength | T3M Type II Medium | 480*    | KW Indirect Canopy/Ceiling Washer bracket (dry/damp locations only)                                            |
|           | P3*     | 50K 5000K         |                       | T4M Type IV Medium |         | P88W Surface-mounted back box (top, left, right, conduit entry). Use when there is no junction box available.* |

**Options**

| Options                                                                                               | Stand-alone Sensors/Controls                                                                                                                                            | Finish                        |
|-------------------------------------------------------------------------------------------------------|-------------------------------------------------------------------------------------------------------------------------------------------------------------------------|-------------------------------|
| E15WH Emergency battery backup, Certified in CA Title 20 MADDIS (10W, 5°C min)                        | PIR Bi-level (100/5%) motion sensor for 8-15' mounting heights. Intended for use on switched circuits with external dusk to dawn switching.                             | DDBXD Dark bronze             |
| E20WC Emergency battery backup, Certified in CA Title 20 MADDIS (10W, 20°C min)                       | PIRH Bi-level (100/5%) motion sensor for 15-30' mounting heights. Intended for use on switched circuits with external dusk to dawn switching.                           | DRLXD Black                   |
| PE Photocell, Button Type*                                                                            | PIRHCW Bi-level (100/5%) motion sensor for 8-15' mounting heights with photocell pre-programmed for dusk to dawn operation.                                             | DNAXD Natural aluminum        |
| DMG 0-10V dimming wires pulled outside fixture (for use with an external control, ordered separately) | PIRH2CW Bi-level (100/5%) motion sensor for 15-30' mounting heights with photocell pre-programmed for dusk to dawn operation.                                           | DWHXD White                   |
| BCE Bottom conduit entry for back box (P88W). Total of 4 entry points.                                | <b>Networked Sensors/Controls</b>                                                                                                                                       | DSDX Sandstone                |
| CCE Coastal Construction*                                                                             | NLTARZ PIR Embedded wireless controls by nLight with Passive Infrared Occ sensor and on/off photocell for 8-15' mounting heights.                                       | DOBTD Toned dark bronze       |
|                                                                                                       | NLTAR2 PIR Embedded wireless controls by nLight with Passive Infrared Occ sensor and on/off photocell for 15-30' mounting heights.                                      | DLNATD Toned natural aluminum |
|                                                                                                       | NLTAR2 PIRH Embedded wireless controls by nLight with UL924 listed emergency operation, Passive Infrared Occ sensor and on/off photocell for 8-15' mounting heights.    | DNATXD Toned natural aluminum |
|                                                                                                       | NLTAREM2 PIRH Embedded wireless controls by nLight with UL924 listed emergency operation, Passive Infrared Occ sensor and on/off photocell for 15-30' mounting heights. | DWHGD Toned white             |
|                                                                                                       |                                                                                                                                                                         | DSDZD Toned sandstone         |

**LITHONIA LIGHTING** COMMERCIAL OUTDOOR One Lithonia Way • Conyers, Georgia 30012 • Phone: 1-800-705-SERV (7378) • [www.lithonia.com](http://www.lithonia.com) WDGE2 LED Rev. 07/08/24 © 2019-2024 Acuity Brands Lighting, Inc. All rights reserved.

### D-Series Size 0 LED Area Luminaire

Catalog Number: TYPE A FIXTURES



10 See the Tab key or mouse over the page to see all interactive elements.

**Specifications**

EPA: 0.44 ft² (0.04 m²)  
Length: 26.18" (6.61 m)  
Width: 14.06" (3.57 m)  
Height H1: 2.26" (5.7 cm)  
Height H2: 7.46" (18.9 cm)  
Weight: 23 lbs (10.4 kg)

The modern styling of the D-Series features a highly refined aesthetic that blends seamlessly with its environment. The D-Series offers the benefits of the latest in LED technology into a high performance, high efficacy, long-life luminaire.

The photometric performance results in sites with excellent uniformity, greater pole spacing and lower power density. D-Series outstanding photometry aids in reducing the number of poles required in area lighting applications, with typical energy savings of 70% and expected service life of over 100,000 hours.

Items marked by a shaded background qualify for the Design Select program and ship in 15 days or less. To learn more about Design Select, visit [www.aaculitybrands.com/designselect](http://www.aaculitybrands.com/designselect). \*See ordering tree for details.

| Series                                   | LEDs                                               | Color Temperature                   | Color Rendition Index     | Distribution                           | Voltage                                                                                                                                                                                                                                                                                                                                                                                                                | Mounting                                                                                                                                 |
|------------------------------------------|----------------------------------------------------|-------------------------------------|---------------------------|----------------------------------------|------------------------------------------------------------------------------------------------------------------------------------------------------------------------------------------------------------------------------------------------------------------------------------------------------------------------------------------------------------------------------------------------------------------------|------------------------------------------------------------------------------------------------------------------------------------------|
| DSX0 LED                                 | Forward optics<br>P1 P5<br>P2 P6<br>P3 P7<br>P4 P8 | 30K 3000K<br>40K 4000K<br>50K 5000K | 70CRI<br>70CRI<br>70CRI   | AFR Automotive front                   | MVOLT (ULW-277V)<br>XVOLT (347V-480V)*                                                                                                                                                                                                                                                                                                                                                                                 | Shipped included<br>SPA Square pole mounting (R5 drilling, 3.5" min, 50 pole)<br>RFA Round pole mounting (R5 drilling, 3" min, RND pole) |
|                                          |                                                    |                                     |                           | T15 Type 1 Short                       |                                                                                                                                                                                                                                                                                                                                                                                                                        |                                                                                                                                          |
|                                          |                                                    |                                     |                           | T2M Type II medium                     |                                                                                                                                                                                                                                                                                                                                                                                                                        |                                                                                                                                          |
|                                          |                                                    |                                     |                           | T3M Type III medium                    |                                                                                                                                                                                                                                                                                                                                                                                                                        |                                                                                                                                          |
| Rotated optics<br>P10* P12*<br>P11* P13* | 30K 3000K<br>35K 3500K<br>40K 4000K<br>50K 5000K   | 80CRI<br>80CRI<br>80CRI<br>80CRI    | TSM Type V medium         | MVOLT (ULW-277V)<br>XVOLT (347V-480V)* | Shipped included<br>SPA Square pole mounting (R5 drilling, 3.5" min, 50 pole)<br>RFA Round pole mounting (R5 drilling, 3" min, RND pole)<br>SRMS Square pole mounting (R5 drilling, 3" min, RND pole)<br>RRAS Round pole mounting (R5 drilling, 3" min, RND pole)<br>SMAH Square square pole mounting (R5 drilling, 3" min, 50 pole)<br>WBA Wall bracket**<br>MA Max arm adapter (mounts on 2.38" OD horizontal round) |                                                                                                                                          |
|                                          |                                                    |                                     | T4M Type IV medium        |                                        |                                                                                                                                                                                                                                                                                                                                                                                                                        |                                                                                                                                          |
|                                          |                                                    |                                     | T6C Type VI low glare*    |                                        |                                                                                                                                                                                                                                                                                                                                                                                                                        |                                                                                                                                          |
|                                          |                                                    |                                     | T7TM Forward throw medium |                                        |                                                                                                                                                                                                                                                                                                                                                                                                                        |                                                                                                                                          |

**Control options**

| Control options                                                                                                                       | Other options                                                                                                                                                                                                                                                                                                                           | Finish                                                                                                                                                     |
|---------------------------------------------------------------------------------------------------------------------------------------|-----------------------------------------------------------------------------------------------------------------------------------------------------------------------------------------------------------------------------------------------------------------------------------------------------------------------------------------|------------------------------------------------------------------------------------------------------------------------------------------------------------|
| NLTARZ PIRH nLight AIR gen 2 enabled with Bi-level motion (ambient sensor, 8-47" mounting height, ambient sensor enabled at 20°C min) | PER7 Seven pin receptacle only (ambus ordered separately)**<br>FAO Field adjustable output**<br>BL30 Bi-level adjustable output**<br>CCE Coastal Construction**<br>HA 50% ambient operation**<br>BAA Bay America's Act and/or Build America Buy America Qualified<br>SF Single face (20, 27, 34, 74)<br>DF Double face (26, 24, 40, 90) | DDBXD Dark bronze<br>DRLXD Black<br>DNAXD Natural aluminum<br>DWHXD White<br>DOBTD Toned dark bronze<br>DLNATD Toned natural aluminum<br>DWHGD Toned white |
| PIR High-low, motion/ambient sensor (ambus ordered separately)**                                                                      | PER8 Eight pin receptacle only (ambus ordered separately)**<br>DL50 Bi-level switched dimming 50%**<br>DMG 0-10V dimming wires pulled outside fixture (for use with an external control, ordered separately)**                                                                                                                          |                                                                                                                                                            |
| PER9 High-low, motion/ambient sensor (ambus ordered separately)**                                                                     | PER9 High-low, motion/ambient sensor (ambus ordered separately)**                                                                                                                                                                                                                                                                       |                                                                                                                                                            |
| PER5 Five pin receptacle only (ambus ordered separately)**                                                                            |                                                                                                                                                                                                                                                                                                                                         |                                                                                                                                                            |

**Shipped separately**

ESGR External Gaze Shield (optional, field install required, matches housing finish)  
ESDB Bird Spikes (field install required)

**LITHONIA LIGHTING** COMMERCIAL OUTDOOR One Lithonia Way • Conyers, Georgia 30012 • Phone: 1-800-705-SERV (7378) • [www.lithonia.com](http://www.lithonia.com) DSX0-LED Rev. 11/15/24 Page 1 of 9 © 2019-2024 Acuity Brands Lighting, Inc. All rights reserved.

### WAC LIGHTING

Caliber

Outdoor Wall Sconce 3000K

Model & Size: WS-W36610 10" Light  
Color Temp & CR: 3000K • 90  
Watt: 11W  
Lumens: 560  
Finish:  AL Brushed Aluminum  BK Black  BZ Bronze

Example: WS-W36610-BZ  
For custom requests please contact [customs@wacighting.com](mailto:customs@wacighting.com)

**DESCRIPTION**  
Light projection tuned with precision.

**FEATURES**

- Discrete cylinder with minimal mounting hardware
- Weather-resistant powder coated finish
- WS-W36614 is Up & down light, WS-W36610 is one direction
- Light engine is factory sealed for maximum protection from the elements
- Driver concealed within the fixture
- 5 year warranty

**SPECIFICATIONS**

Color Temp: 3000K  
Input: 120-277V/50/60Hz  
CRI: 90  
Dimming: ELV: 100-10%  
Rated Life: 72,000 Hours  
Mounting: Can be mounted on wall vertically or horizontally  
Standards: ETL, cETL, IP65, ADA, Wet Location Listed  
Construction: Aluminum hardware with lens diffuser

**FINISHES:**

Black Bronze Brushed Aluminum

**LINE DRAWING:**



WS-W36610

**REVISIONS**

| NO. | DATE | DESCRIPTION |
|-----|------|-------------|
|     |      |             |

DRAWN BY: EL  
CHECKED BY: MB  
ISSUE DATE: 1/3/2025

SHEET NO. **EP-2**

[wacighting.com](http://wacighting.com) | Phone: (800) 526-2588 | Fax: (800) 526-2585 | Headquarters/Eastern Distribution Center: 44 Harbor Park Drive, Port Washington, NY 11050  
WAC Lighting retains the right to modify the design of our products at any time as part of the company's continuous improvement program, January 2025

**D M C E**

**DYNAMIC MEP CONSULTING ENGINEERS**  
4800 WADSWORTH BLVD., SUITE 110  
WHEAT RIDGE CO. 80033  
303.421.3208

ATTN: THESE MATERIALS ARE OWNED AND COPYRIGHTED BY DMCE AND CONTAIN TECHNICAL DESIGN AND CONFIDENTIAL INFORMATION WHICH ARE TRADE SECRETS AS DEFINED BY STAT. LAW. ACCESS TO THESE MATERIALS IS GIVEN ONLY TO APPROVED CONTRACTORS AND MATERIAL MEN AND ONLY FOR USE IN THE BIDDING AND CONSTRUCTION OF THE PROJECT SPECIFIED BY THESE MATERIALS. ANY USE OF THE INFORMATION FOR PURPOSE BEYOND THOSE EXPRESSLY PERMITTED BY DMCE IS A VIOLATION OF STATE AND FEDERAL LAW AND MAY SUBJECT THE USER TO CIVIL AND CRIMINAL PENALTIES.

**LANDSCAPE ENDEAVORS**  
2725 AKERS RD  
COLORADO SPRINGS, CO  
BUCHER DESIGN STUDIO INC  
1325 ORACLE BLVD #101  
COLORADO SPRINGS, CO

These documents are prepared for exclusive use by

REVISIONS

| NO. | DATE | DESCRIPTION |
|-----|------|-------------|
|     |      |             |

DRAWN BY: EL  
CHECKED BY: MB  
ISSUE DATE: 1/3/2025

SHEET NO. **EP-2**

JOB # 2416