

LORSON RANCH COMMERCIAL NORTH



Know what's below.
Call before you dig.

INDEX OF SHEETS		SHEET No.
TS01	TITLE SHEET	1
GN01	GENERAL NOTES	2
SG01	SIGNAL POLE & CONDUIT PLAN	3
SG02	TRAFFIC SIGNAL PLAN	4
SN01	SIGNING & STRIPING PLAN	5

EL PASO COUNTY TRAFFIC SIGNAL & SIGNING PLAN PCD FILE NUMBER SF248

CONTACT LIST

OWNER/DEVELOPER
THE LANDHUIS COMPANY
212 N. WAHSATCH AVENUE, SUITE 301
COLORADO SPRINGS, CO 80903
JEFF MARK
(719) 635-3200

CIVIL ENGINEER
MATRIX DESIGN GROUP
2435 RESEARCH PARKWAY, SUITE 300
COLORADO SPRINGS, CO 80920
SCOTT D. BARNHART, P.E.
(719) 575-0100

WATER/SANITARY SERVICES
WIDEFILED WATER AND SANITATION DISTRICT
8495 FONTAINE BOULEVARD
COLORADO SPRINGS, CO 80925
ROBERT BANNISTER, (719) 390-7111

ELECTRIC SERVICES
MOUNTAINVIEW ELECTRIC ASSOCIATION
(719) 495-2283

GAS SERVICES
BLACK HILLS ENERGY
105 S VICTORIA AVENUE
PUEBLO, CO 80817
(800) 303-0752

ENGINEERING
EL PASO COUNTY PUBLIC WORKS DEPARTMENT
3275 AKERS DRIVE
COLORADO SPRINGS, CO 80922
(719) 520-6460

FIRE DEPARTMENT
COLORADO SPRINGS FIRE DEPARTMENT
375 PRINTERS PARKWAY
COLORADO SPRINGS, CO 80910
(719) 444-7000

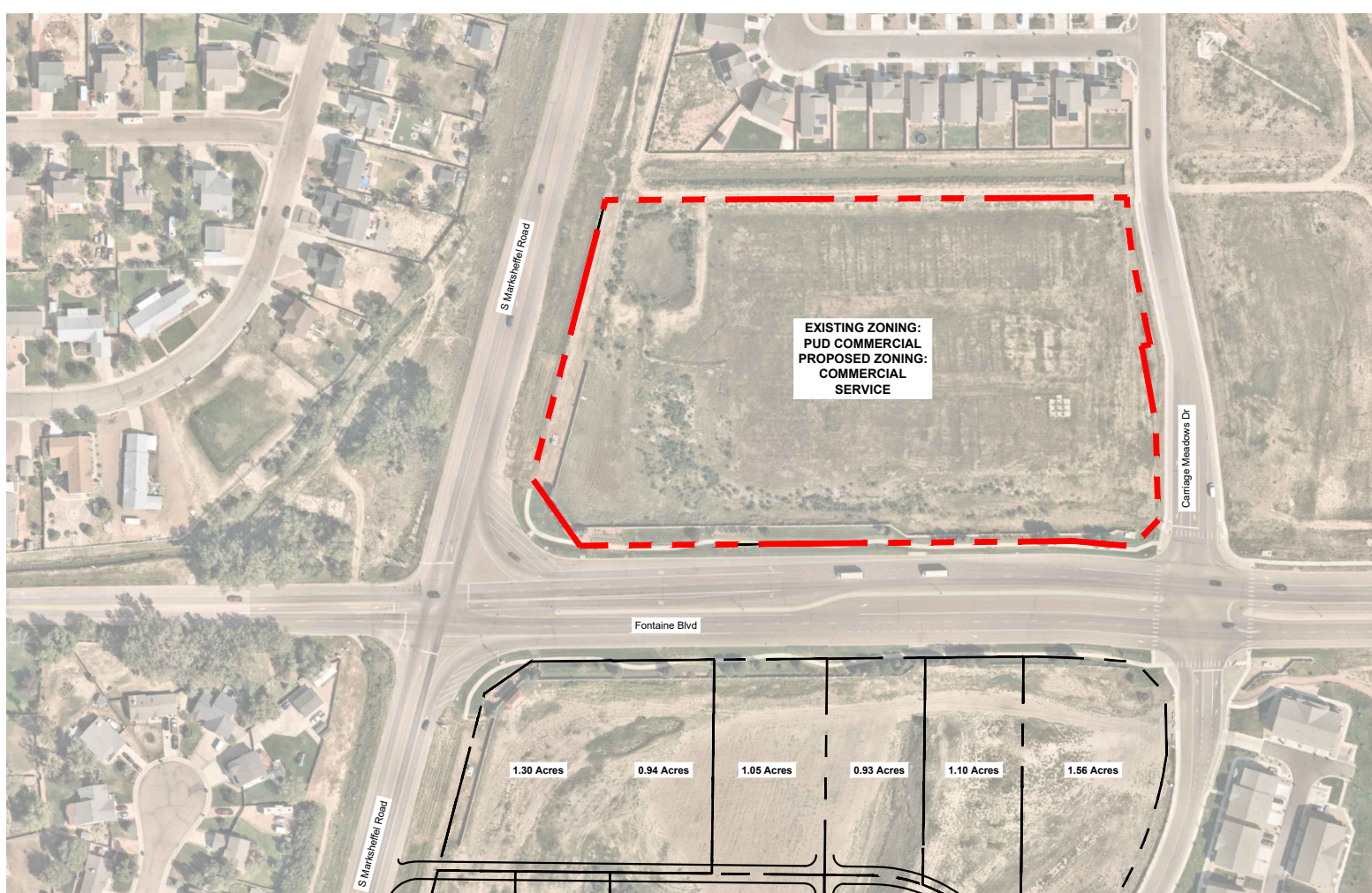
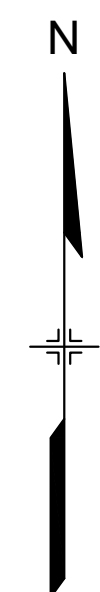

SITE MAP
N.T.S.

VICINITY MAP
N.T.S.

ENGINEER'S STATEMENT

THESE DETAILED PLANS AND SPECIFICATIONS WERE PREPARED UNDER MY DIRECTION AND SUPERVISION. SAID DETAILED PLANS AND SPECIFICATIONS HAVE BEEN PREPARED ACCORDING TO THE CRITERION ESTABLISHED BY THE COUNTY FOR DETAILED DRAINAGE PLANS AND SPECIFICATIONS, AND SAID DETAILED PLANS AND SPECIFICATIONS ARE IN CONFORMITY WITH THE MASTER PLAN OF THE DRAINAGE BASIN. SAID DETAILED DRAINAGE PLANS AND SPECIFICATIONS MEET THE PURPOSE FOR WHICH THE PARTICULAR DRAINAGE FACILITY(S) IS DESIGNED. I ACCEPT RESPONSIBILITY FOR ANY LIABILITY CAUSED BY ANY NEGLIGENT ACTS, ERRORS OR OMISSIONS ON MY PART IN PREPARATION OF THE DETAILED DRAINAGE PLANS AND SPECIFICATIONS.

BY: Scott D. Barnhart DATE: November 4, 2024
SCOTT BARNHART, P.E. #37447
FOR AND ON BEHALF OF MATRIX DESIGN GROUP, INC.

OWNER/DEVELOPER:

I, THE OWNER/DEVELOPER HAVE READ AND WILL COMPLY WITH THE REQUIREMENTS OF THE GRADING AND EROSION CONTROL PLANS AND ALL OF THE REQUIREMENTS SPECIFIED IN THESE DETAILED PLANS AND SPECIFICATIONS

JEFF MARK _____ DATE _____
PROJECT MANAGER
THE LANDHUIS COMPANY
212 N WAHSATCH AVENUE, SUITE 301
COLORADO SPRINGS, CO 80903

EL PASO COUNTY:

COUNTY PLAN REVIEW IS PROVIDED ONLY FOR GENERAL CONFORMANCE WITH COUNTY DESIGN CRITERIA. THE COUNTY IS NOT RESPONSIBLE FOR THE ACCURACY AND ADEQUACY OF THE DESIGN, DIMENSIONS, AND/OR ELEVATIONS WHICH SHALL BE CONFIRMED AT THE JOB SITE. THE COUNTY THROUGH THE APPROVAL OF THIS DOCUMENT ASSUMES NO RESPONSIBILITY FOR COMPLETENESS AND/OR ACCURACY OF THIS DOCUMENT.

FILES IN ACCORDANCE WITH THE REQUIREMENTS OF THE EL PASO COUNTY LAND DEVELOPMENT CODE, DRAINAGE CRITERIA MANUAL, VOLUMES 1 AND 2, AND ENGINEERING CRITERIA MANUAL AMENDED.

IN ACCORDANCE WITH ECM SECTION 1.12, THESE CONSTRUCTION DOCUMENTS WILL BE VALID FOR CONSTRUCTION FOR A PERIOD OF 2 YEARS FROM THE DATE SIGNED BY THE EL PASO COUNTY ENGINEER. IF CONSTRUCTION HAS NOT STARTED WITHIN THOSE 2 YEARS, THE PLANS WILL NEED TO BE RESUBMITTED FOR APPROVAL, INCLUDING PAYMENT OF REVIEW FEES AT THE PLANNING AND COMMUNITY DEVELOPMENT DIRECTORS DISCRETION.

JOSHUA PALMER, P.E. _____ DATE _____
COUNTY ENGINEER/ ECM ADMINISTRATOR

THE PARTIES RESPONSIBLE FOR THIS PLAN HAVE FAMILIARIZED THEMSELVES WITH ALL CURRENT ACCESSIBILITY CRITERIA AND SPECIFICATIONS AND THE PROPOSED PLAN REFLECTS ALL SITE ELEMENTS REQUIRED BY THE APPLICABLE ADA DESIGN STANDARDS AND GUIDELINES AS PUBLISHED BY THE UNITED STATES DEPARTMENT OF JUSTICE. APPROVAL OF THIS PLAN BY EL PASO COUNTY DOES NOT ASSURE COMPLIANCE WITH THE ADA OR ANY REGULATIONS OR GUIDELINES ENACTED OR PROMULGATED UNDER OR WITH RESPECT TO SUCH LAWS.

REFERENCE DRAWINGS	No.	DATE	DESCRIPTION REVISIONS	BY
X-MDG22x34 CD's X-1129-EX-IMAGE Site Map_Lorson Ranch Commercial North				
COMPUTER FILE MANAGEMENT				
FILE NAME: S:\24.1129.026 Lorson Ranch Commercial North\504 CADD\504 Plan Sets\Construction Plans\Signal\TS01.dwg				
CTB FILE: Matrix(black).ctb				
PLOT DATE: November 4, 2024 1:56:26 PM				
THIS DRAWING IS CURRENT AS OF PLOT DATE AND MAY BE SUBJECT TO CHANGE.				

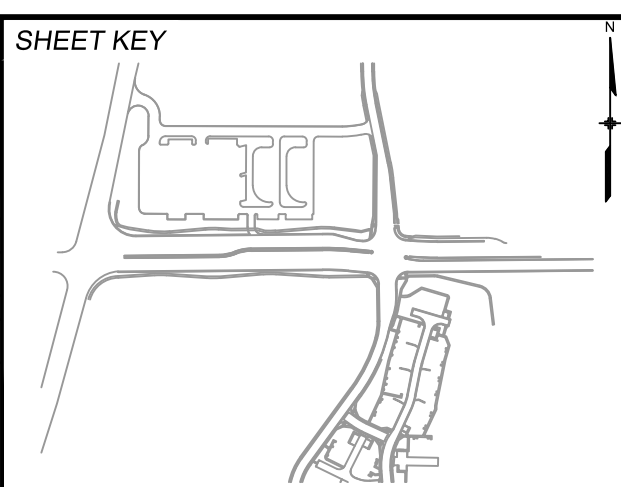

PREPARED FOR:

PREPARED BY:
Matrix
Excellence by Design

SEAL

11/04/2024
FOR AND ON BEHALF OF
MATRIX DESIGN GROUP, INC.
PROJECT No. 24.1129.026

LORSON RANCH COMMERCIAL NORTH
CARRIAGE MEADOWS DRIVE/FONTAINE BOULEVARD
TRAFFIC SIGNAL & SIGNING PLAN

TITLE SHEET

DESIGNED BY:	TJC	SCALE	DATE ISSUED:	NOVEMBER 2024	DRAWING No.
CHECKED BY:	SDB	HORIZ N/A VERT. N/A	SHEET	1 OF 5	TS01



STANDARD NOTES FOR CONSTRUCTION:

1. ALL DRAINAGE AND ROADWAY CONSTRUCTION SHALL MEET THE STANDARDS AND SPECIFICATIONS OF THE CITY OF COLORADO SPRINGS/EL PASO COUNTY DRAINAGE CRITERIA MANUAL, VOLUMES 1 AND 2, AND THE EL PASO COUNTY ENGINEERING CRITERIA MANUAL.
2. CONTRACTOR SHALL BE RESPONSIBLE FOR THE NOTIFICATION AND FIELD NOTIFICATION OF ALL EXISTING UTILITIES, WHETHER SHOWN ON THE PLANS OR NOT, BEFORE BEGINNING CONSTRUCTION. LOCATION OF EXISTING UTILITIES SHALL BE VERIFIED BY THE CONTRACTOR PRIOR TO CONSTRUCTION. CALL 811 TO CONTACT THE UTILITY NOTIFICATION CENTER OF COLORADO (UNCC).
3. CONTRACTOR SHALL KEEP A COPY OF THESE APPROVED PLANS, THE GRADING AND EROSION CONTROL PLAN, THE STORMWATER MANAGEMENT PLAN (SWMP), THE SOILS AND GEOTECHNICAL REPORT, AND THE APPROPRIATE DESIGN AND CONSTRUCTION STANDARDS AND SPECIFICATIONS AT THE JOB SITE AT ALL TIMES, INCLUDING THE FOLLOWING
 - 3.A. EL PASO COUNTY ENGINEERING CRITERIA MANUAL (ECM)
 - 3.B. CITY OF COLORADO SPRINGS/EL PASO COUNTY DRAINAGE CRITERIA MANUAL, VOLUMES 1 & 2
 - 3.C. COLORADO DEPARTMENT OF TRANSPORTATION (CDOT) STANDARD SPECIFICATIONS FOR ROAD AND BRIDGE CONSTRUCTION
 - 3.D. CDOT M & S STANDARDS
4. NOT WITHSTANDING ANYTHING DEPICTED IN THESE PLANS IN WORDS OR GRAPHIC REPRESENTATION, ALL DESIGN AND CONSTRUCTION RELATED TO ROADS, STORM DRAINAGE AND EROSION CONTROL SHALL CONFORM TO THE STANDARDS AND REQUIREMENTS OF THE MOST RECENT VERSION OF THE RELEVANT ADOPTED EL PASO COUNTY STANDARDS, INCLUDING THE LAND DEVELOPMENT CODE, THE ENGINEERING CRITERIA MANUAL, THE DRAINAGE CRITERIA MANUAL, AND THE DRAINAGE CRITERIA MANUAL VOLUME 2. ANY DEVIATIONS FROM REGULATIONS AND STANDARDS MUST BE REQUESTED, AND APPROVED, IN WRITING. ANY MODIFICATIONS NECESSARY TO MEET CRITERIA AFTER-THE-FACT WILL BE ENTIRELY THE DEVELOPER'S RESPONSIBILITY TO RECTIFY.
5. IT IS THE DESIGN ENGINEER'S RESPONSIBILITY TO ACCURATELY SHOW EXISTING CONDITIONS, BOTH ONSITE AND OFFSITE, ON THE CONSTRUCTION PLANS. ANY MODIFICATIONS NECESSARY DUE TO CONFLICTS, OMISSIONS, OR CHANGED CONDITIONS WILL BE ENTIRELY THE DEVELOPER'S RESPONSIBILITY TO RECTIFY.
6. CONTRACTOR SHALL SCHEDULE A PRE-CONSTRUCTION MEETING WITH EL PASO COUNTY PLANNING AND COMMUNITY DEVELOPMENT (PCD)- INSPECTIONS, PRIOR TO STARTING CONSTRUCTION.
7. IT IS THE CONTRACTOR'S RESPONSIBILITY TO UNDERSTAND THE REQUIREMENTS OF ALL JURISDICTIONAL AGENCIES AND TO OBTAIN ALL REQUIRED PERMITS, INCLUDING BUT NOT LIMITED TO EL PASO COUNTY EROSION AND STORMWATER QUALITY CONTROL PERMIT (WSQCP), REGIONAL BUILDING FLOODPLAIN DEVELOPMENT PERMIT, U.S. ARMY CORPS OF ENGINEERS-ISSUED 401 AND/OR 404 PERMITS, AND COUNTY AND STATE FUGITIVE DUST PERMITS.
8. CONTRACTOR SHALL NOT DEVIATE FROM THE PLANS WITHOUT FIRST OBTAINING WRITTEN APPROVAL FROM THE DESIGN ENGINEER AND PCD. CONTRACTOR SHALL NOTIFY THE DESIGN ENGINEER IMMEDIATELY UPON DISCOVERY OF ANY ERRORS OR INCONSISTENCIES.
9. ALL STORM DRAIN PIPE SHALL BE CLASS III RCP UNLESS OTHERWISE NOTED AND APPROVED BY PCD.
10. CONTRACTOR SHALL COORDINATE GEOTECHNICAL TESTING PER ECM STANDARDS. PAVEMENT DESIGN SHALL BE APPROVED BY EL PASO COUNTY PCD PRIOR TO PLACEMENT OF CURB AND GUTTER AND PAVEMENT.
11. ALL CONSTRUCTION TRAFFIC MUST ENTER/EXIT THE SITE AT APPROVED CONSTRUCTION ACCESS POINTS.
12. SIGHT VISIBILITY TRIANGLES AS IDENTIFIED IN THE PLANS SHALL BE PROVIDED AT ALL INTERSECTIONS. OBSTRUCTIONS GREATER THAN 18 INCHES ABOVE FLOWLINE ARE NOT ALLOWED WITHIN SIGHT TRIANGLES.
13. SIGNING AND STRIPING SHALL COMPLY WITH EL PASO COUNTY DOT AND MUTCD CRITERIA. [IF APPLICABLE, ADDITIONAL SIGNING AND STRIPING NOTES WILL BE PROVIDED.]
14. CONTRACTOR SHALL OBTAIN ANY PERMITS REQUIRED BY EL PASO COUNTY DOT, INCLUDING WORK WITHIN THE RIGHT-OF-WAY AND SPECIAL TRANSPORT PERMITS.
15. THE LIMITS OF CONSTRUCTION SHALL REMAIN WITHIN THE PROPERTY LINE UNLESS OTHERWISE NOTED. THE OWNER/DEVELOPER SHALL OBTAIN WRITTEN PERMISSION AND EASEMENTS, WHERE REQUIRED, FROM ADJOINING PROPERTY OWNER(S) PRIOR TO ANY OFF-SITE DISTURBANCE, GRADING, OR CONSTRUCTION.

COLORADO SPRINGS TRAFFIC SIGNAL GENERAL NOTES:

- A. CONTRACTOR SHALL HAVE A COPY OF CURRENT CITY OF COLORADO SPRINGS TRAFFIC SIGNAL INSTALLATION AND PARTS SPECIFICATION ON JOB SITE AT ALL TIMES.
- B. ALL WORK SHALL BE DONE IN ACCORDANCE WITH CURRENT CITY OF COLORADO SPRINGS ENGINEERING DIVISION STANDARD SPECIFICATIONS, COLORADO SPRINGS CITY TRAFFIC SIGNAL INSTALLATION AND PARTS SPECIFICATION, CITY OF COLORADO SPRINGS TRAFFIC CONTROLS FOR STREET CONSTRUCTION, UTILITY WORK, AND MAINTENANCE OPERATIONS FOR CONTRACTORS, AND MANUAL ON UNIFORM TRAFFIC CONTROL DEVICES FOR STREETS AND HIGHWAY.
- C. ALL MATERIALS AND WORKMANSHIP SHALL BE SUBJECT TO INSPECTION AND APPROVAL BY CITY OF COLORADO SPRINGS ENGINEERING REPRESENTATIVE OR CITY TRAFFIC ENGINEER.
- D. REFER TO THE "GROUNDING METHODS" SECTION 18 OF THIS MANUAL FOR INFORMATION ON HOW TO GROUND TRAFFIC SIGNAL SYSTEMS.
- E. ALL MATERIALS AND WORKMANSHIP SHALL BE SUBJECT TO INSPECTION AND APPROVAL BY CITY OF COLORADO SPRINGS ENGINEERING REPRESENTATIVE OR CITY TRAFFIC ENGINEER.
- F. THE CONTRACTOR SHALL CONTACT THE UTILITY NOTIFICATION CENTER OF COLORADO AT 811 THREE BUSINESS DAYS IN ADVANCE OF ANY EXCAVATING OR GRADING.
- G. THE CONTRACTOR SHALL PROTECT AND MAINTAIN UTILITIES AND STRUCTURES AFFECTED BY WORK AND ANY DAMAGE SHALL BE REPAIRED AND RESTORED THE SATISFACTION OF THE CITY OF COLORADO SPRINGS. CONTRACTOR SHALL COORDINATE WITH PROJECT MANAGER OR DESIGNEE TO RESOLVE CONFLICTS.
- H. CONTRACTOR SHALL LIMIT CONSTRUCTION ACTIVITIES TO THOSE AREAS WITHIN THE EXISTING RIGHT-OF-WAY AND TEMPORARY AND PERMANENT EASEMENTS SHOWN ON THE PLANS.
- I. THE CONTRACTOR SHALL PRESERVE ALL MONUMENTS, BENCHMARKS, RANGE TIES, AND PROPERTY MARKERS. THE CONTRACTOR SHALL BE RESPONSIBLE FOR RESETTling ALL DISTURBED SURVEY MARKERS, INCLUDING MONUMENTS, SECTION CORNERS, ALIQUOT CORNERS MARKERS, ETC.
- J. THE CONTRACTOR SHALL BE RESPONSIBLE FOR MAINTENANCE OF PUBLIC RIGHT-OF-WAY, INCLUDING VEHICLE TRAVELED WAY AND PEDESTRIAN PATHS, WITHIN THE PROJECT LIMITS AT ALL TIMES UNTIL ACCEPTANCE BY THE CITY.
- K. INSTALLATION AND MAINTENANCE OF ALL TRAFFIC DEVICES IS THE RESPONSIBILITY OF THE CONTRACTOR.
- L. CONSTRUCTION ACTIVITY SHALL BE SCHEDULED WITH THE MINIMUM IMPACT TO PEDESTRIAN AND VEHICLE TRAFFIC.
- M. THE CONTRACTOR SHALL BE RESPONSIBLE FOR MAINTENANCE OF TRAFFIC SIGNALIZATION AT EXISTING SIGNALIZED INTERSECTION SHOWN ON THE SIGNAL PLANS AT ALL TIMES FROM BEGINNING OF THE PROJECT TO ACCEPTANCE APPROVED BY THE CITY. ALL CHANGES TO THE PHYSICAL LAYOUT OF TRAFFIC SIGNAL OR SIGNAL TIMING SHALL BE APPROVED BY THE CITY BEFORE IMPLEMENTATION.
- N. CONTRACTOR SHALL CONTACT THE CITY TRAFFIC ENGINEERING REPRESENTATIVE FOR INSPECTION OF POLE CAISSON FROM, ANCHOR BOLTS AND CONDUIT STUB OUT 24 HOURS PRIOR TO INTENT OF POUR, AND (2-HOUR MINIMUM CONFORMATION) PRIOR TO POURING CONCRETE.
- O. CONDITIONAL ACCEPTANCE: ONCE CONSTRUCTION OF A TRAFFIC SIGNAL HAS BEEN SATISFACTORY COMPLETED; THE SIGNALS ARE "CONDITIONALLY ACCEPTED" BY OWNER. AT THIS TIME THE SIGNAL IS TURNED ON AND THE "BURN-IN" PERIOD BEGINS. THE BURN-IN PERIOD WILL LAST 15 DAYS. DURING THE BURN-IN PERIOD THE SIGNAL SYSTEM IS ALLOWED TO OPERATE UNDER REAL WORLD CONDITIONS. ANY MALFUNCTION ACCRUED DURING THIS PERIOD WILL REQUIRE REPAIR OR REPLACEMENT AND IN THE MALFUNCTION IS SERIOUS ENOUGH, THE BURN-IN PERIOD MUST BE RESTARTED.
- P. FINAL ACCEPTANCE: AFTER THE BURN-IN PERIOD IS COMPLETED, ALL PUNCH LIST ITEMS HAVE BEEN CORRECTED AND THE CONTRACTOR HAS MET ALL CONTRACT REQUIREMENTS (SUCH AS FINAL CLEANUP OF WORK SITE, AS BUILT DRAWINGS AND BORE LOGS), THE SIGNAL WILL BE ACCEPTED. THE CONTRACTOR SHALL PROVIDE A TWO-YEAR GUARANTEE ON ALL WORK PERFORMED UNDER THIS CONTRACT AFTER THE JOB HAS BEEN COMPLETED AND ACCEPTED.
- Q. THE CONTRACTOR SHALL PROVIDE A TWO-YEAR GUARANTEE ON ALL WORK PERFORMED UNDER THIS CONTRACT AFTER THE JOB HAS BEEN COMPLETED AND ACCEPTED.
- R. THE CONTRACTOR SHALL PROVIDE ENGINEER WITH DAILY QUANTITIES AND TRAFFIC CONTROL DIARIES AT THE END OF WORK WEEK OR AS DIRECTED BY THE ENGINEER.
- S. THE CONTRACTOR SHALL SUBMIT "AS-BUILT" OR CORRECTED PLANS SHOWING, IN DETAIL, ALL CONSTRUCTION CHANGES INCLUDING BUT NOT LIMITED TO BORE LOGS, POTHOLE LOGS, WIRING, CABLE, POLES, CONTROLLER CABINET, DETECTION SYSTEM AND LOCATION OF ALL CONDUITS WITHIN 7 DAYS OF INSTALLATION.

- T. ALL TRAFFIC SIGNAL EQUIPMENT THAT IS REMOVED SHALL REMAIN THE PROPERTY OF THE CITY OF COLORADO SPRINGS. SUCH PROPERTY IS TO BE RETURNED BY CONTRACTOR TO 416 FONTANERO ST, CITY TRAFFIC SIGNAL CONSTRUCTION SHOP. CONTRACTOR MUST CONTACT TRAFFIC SIGNALS (719) 385-6747 TO COORDINATE DELIVERY. ALL TRAFFIC SIGNAL EQUIPMENT SHALL BE RETURNED IN THE SAME OPERATING CONDITION WHEN REMOVED. POLES WILL BE STRIPPED CLEAN OF ALL ATTACHED PARTS BEFORE DELIVERY.
- U. CONTRACTOR SHALL REPLACE OR RECONSTRUCT SIDEWALKS, CURBS, GUTTERS, PAVEMENT AND ANY OTHER IMPROVEMENTS REMOVED, BROKEN OR DAMAGED BY CONTRACTOR THAT WERE NOT DESIGNATED FOR REMOVAL IN THE PROJECT. MUST MEET CITY ENGINEERING SPECIFICATIONS AND INSPECTIONS PRACTICES.
- V. SIGNAL HEADS SHALL NOT BE INSTALLED IF LONG DELAY IS EXPECTED FOR TURNING SIGNAL ACTIVE. DURING ANY PERIOD SIGNAL HEAD OR HEADS ARE NOT ACTIVE SHALL BE BAGGED WITH TRAFFIC SIGNAL HEAD COVERS & MARKED WITH LEGIBLE "OUT OF SERVICE" MARKINGS.
- W. ACCEPTABLE TIMES FOR TURNING NEW OR REBUILT INTERSECTION OPERATIONAL IS BETWEEN 9:00AM MONDAY THROUGH 3:00 PM THURSDAY.
- X. CONTRACTOR SHALL PROTECT ALL KNOWN ENVIRONMENTAL RESOURCES IN CITY RIGHT-OF-WAY. EROSION AND SEDIMENT CONTROL SHALL BE IN PLACE WHEN NEED IDENTIFIED ON THE PROJECT.

SIGNING AND STRIPING NOTES:

1. ALL SIGNS AND PAVEMENT MARKINGS SHALL BE IN COMPLIANCE WITH THE CURRENT MANUAL ON UNIFORM TRAFFIC CONTROL DEVICES (MUTCD).
2. REMOVAL OF EXISTING PAVEMENT MARKINGS SHALL BE ACCOMPLISHED BY A METHOD THAT DOES NOT MATERIALLY DAMAGE THE PAVEMENT. THE PAVEMENT MARKINGS SHALL BE REMOVED TO THE EXTENT THAT THEY WILL NOT BE VISIBLE UNDER DAY OR NIGHT CONDITIONS. AT NO TIME WILL IT BE ACCEPTABLE TO PAINT OVER EXISTING PAVEMENT MARKINGS.
3. ANY DEVIATION FROM THE STRIPING AND SIGNING PLAN SHALL BE APPROVED BY EL PASO COUNTY PLANNING AND COMMUNITY DEVELOPMENT.
4. ALL SIGNS SHOWN ON THE SIGNING AND STRIPING PLAN SHALL BE NEW SIGNS. EXISTING SIGNS MAY REMAIN OR BE REUSED IF THEY MEET CURRENT EL PASO COUNTY AND MUTCD STANDARDS.
5. STREET NAME AND REGULATORY STOP SIGNS SHALL BE ON THE SAME POST AT INTERSECTIONS.
6. ALL REMOVED SIGNS SHALL BE DISPOSED OF IN A PROPER MANNER BY THE CONTRACTOR.
7. ALL STREET NAME SIGNS SHALL HAVE "D" SERIES LETTERS, WITH LOCAL ROADWAY SIGNS BEING 4" UPPER-POWER CASE LETTERING ON 8" BLACK AND NON-LOCAL ROADWAY SIGNS BEING 6" LETTERING, UPPER-LOWER CASE ON 12" BLANK, WITH A WHITE BORDER THAT IS NOT RECESSED. MULTI-LANE ROADWAYS WITH SPEED LIMITS OF 40 MPH OR HIGHER SHALL HAVE 8" UPPER-LOWER CASE LETTERING ON 18" BLANK WITH A WHITE BORDER THAT IS NOT RECESSED. THE WIDTH OF THE NON-RECESSED WHITE BORDERS SHALL MATCH PAGE 255 OF THE 2012 MUTCD "STANDARD HIGHWAY SIGNS".
8. ALL TRAFFIC SIGNS SHALL HAVE A MINIMUM HIGH INTENSITY PRISMATIC GRADE SHEETING.
9. ALL LOCAL RESIDENTIAL STREET SIGNS SHALL BE MOUNTED ON A 1.75" X 1.75" SQUARE TUBE SIGN POST AND STUB POST BASE. FOR OTHER APPLICATIONS, REFER TO THE CDOT STANDARDS S-614-8 REGARDING USE OF THE P2 TUBULAR STEEL POST SLIP BASE DESIGN.
10. ALL SIGNS SHALL BE SINGLE SHEET ALUMINUM WITH 0.100" MINIMUM THICKNESS.
11. ALL LIMIT LINES/STOP LINES, CROSSWALK LINES, PAVEMENT LEGENDS, AND ARROWS SHALL BE A MINIMUM 125 MIL THICKNESS PERFORMED THERMOPLASTIC PAVEMENT MARKINGS WITH TAPERED LEADING EDGES PER CDOT STANDARDS S-627-1. WORD AND SYMBOL MARKINGS SHALL BE THE NARROW TYPE. STOP BARS SHALL BE 24" IN WIDTH. CROSSWALKS LINES SHALL BE 12" WIDE AND 8' LONG PER CDOT S-627-1.
12. ALL LONGITUDINAL LINES SHALL BE A MINIMUM 15 MIL THICKNESS EPOXY PAINT. ALL NON-LOCAL RESIDENTIAL ROADWAYS SHALL INCLUDE BOTH RIGHT AND LEFT EDGE LINE STRIPING AND ANY ADDITIONAL STRIPING AS REQUIRED BY CDOT S-627-1.
13. THE CONTRACTOR SHALL NOTIFY EL PASO COUNTY PLANNING AND COMMUNITY DEVELOPMENT (719) 520-6819 PRIOR TO AND UPON COMPLETION OF SIGNING AND STRIPING.
14. THE CONTRACTOR SHALL OBTAIN A WORK IN THE RIGHT OF WAY PERMIT FROM THE EL PASO COUNTY DEPARTMENT OF PUBLIC WORKS (DPW) PRIOR TO ANY SIGNAGE OR STRIPING WORK WITHIN AN EXISTING EL PASO COUNTY ROADWAY.

COLORADO SPRINGS CITY TRAFFIC SIGNAL INSTALLATION & PARTS SPECIFICATIONS:

- SECTION 1 CONTRACTOR PRE-QUALIFICATIONS
- SECTION 2 GENERAL NOTES
- SECTION 3 MATERIALS
- SECTION 4 CABLE SPLICING AND COLOR CODES
- SECTION 5 SPAN WIRE ATTACHMENT
- SECTION 6 CONDUIT, JUNCTION BOXES, AND CONTROLLER BASE
- SECTION 7 ILLUMINATED STREET NAME SIGNS
- SECTION 8 SIGNAL POLE 2015 AASHTO DESIGN
- SECTION 9 SIGNAL POLE FOUNDATION 2015 AASHTO DESIGN
- SECTION 10 SCHOOL FLASHER
- SECTION 11 SIGNAL HEADS AND MOUNTING EQUIPMENT
- SECTION 12 PEDESTAL POLES AND PEDESTRIAN BUTTONS
- SECTION 13 SIGNAL CABINET
- SECTION 14 DETECTION SYSTEMS
- SECTION 15 SERVICE AND WIRE SPECIFICATIONS
- SECTION 16 STEEL CABLE, SIGNAL ACCESSORIES, AND GUY WIRE
- SECTION 17 LED ROADWAY LIGHTING
- SECTION 18 GROUNDING METHODS
- APPENDIX A CONCRETE MIX DESIGNS AND REQUIREMENTS
- APPENDIX B SIGNAL POLE AASHTO 1994 (MAINTENANCE ONLY)
- APPENDIX C SIGNAL FOUNDATION AASHTO 1994 (MAINTENANCE ONLY)

REFERENCE DRAWINGS	No.	DATE	DESCRIPTION REVISIONS	BY
X-MDG22x34 CD's				
COMPUTER FILE MANAGEMENT				
FILE NAME: S:\24.1129.026 Lorson Ranch Commercial North\500 CADD\504 Plan Sets\Construction Plans\Signal\GN01.dwg				
CTB FILE: Matrix(black).ctb				
PLOT DATE: November 4, 2024 1:56:27 PM				
THIS DRAWING IS CURRENT AS OF PLOT DATE AND MAY BE SUBJECT TO CHANGE.				

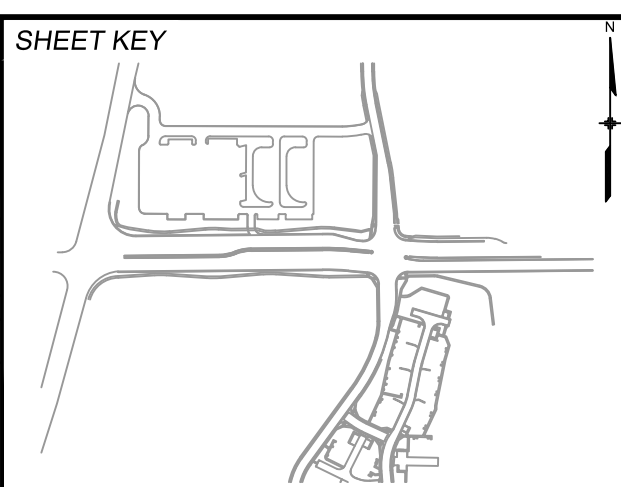

PREPARED FOR:

PREPARED BY:

SEAL

11/04/2024

FOR AND ON BEHALF OF MATRIX DESIGN GROUP, INC. PROJECT No. 24.1129.026

LORSON RANCH COMMERCIAL NORTH

CARRIAGE MEADOWS DRIVE/FONTAINE BOULEVARD TRAFFIC SIGNAL & SIGNING PLAN

GENERAL NOTES

DESIGNED BY:	TJC	SCALE:	DATE ISSUED:	NOVEMBER 2024	DRAWING No.
CHECKED BY:	SDB	HORIZ. N/A	SHEET	2 OF 5	GN01
		VERT. N/A			



Know what's below.
Call before you dig.

TABULATION OF SIGNAL QUANTITIES

ITEM NO.	ITEM DESCRIPTION	UNIT	QUANTITY
814-03036	DRILLED SIGNAL POLE FOUNDATION (36 INCH)	LF	25
814-03042	DRILLED SIGNAL POLE FOUNDATION (42 INCH)	LF	28
813-00201	2 INCH CONDUIT (TRAFFIC)	LF	540
813-00301	3 INCH CONDUIT (TRAFFIC)	LF	1030
813-07012	PULL BOX (30"x17"x18")	EA	6
813-07013	PULL BOX (36"x24"x18")	EA	2
814-80009	TRAFFIC SIGNAL LUMINAIRE	EA	4
813-08001	TRAFFIC SIGNAL METER PEDESTAL	EA	1
814-10130	ILLUMINATED STREET NAME SIGN	EA	4
814-75215	PEDESTRIAN SIGNAL FACE (16) (COUNTDOWN)	EA	8
814-70336	TRAFFIC SIGNAL FACE (12-12-12)	EA	15
814-72860	PEDESTRIAN PUSH BUTTON	EA	8
814-72897	INTERSECTION DETECTION SYSTEM (RADAR)	EA	4
814-84440	TRAFFIC SIGNAL PEDESTAL POLE	EA	4
814-81040	TRAFFIC SIGNAL POLE (1 MAST ARM) (40 FT MAST ARM)	EA	1
814-81045	TRAFFIC SIGNAL POLE (1 MAST ARM) (45 FT MAST ARM)	EA	1
814-81055	TRAFFIC SIGNAL POLE (1 MAST ARM) (55 FT MAST ARM)	EA	1
814-81060	TRAFFIC SIGNAL POLE (1 MAST ARM) (60 FT MAST ARM)	EA	1
814-75847	TRAFFIC SIGNAL CONTROLLER AND CABINET (COMPLETE)	EA	1

NOTE:

TRAFFIC SIGNAL FACE (12-12-12) SHALL INCLUDE VISORS AND ALL MOUNTING HARDWARE REQUIRED TO INSTALL.

SIGNAL POLE SCHEDULE

POLE NUMBER	A	B	C	D
LOCATION	NW CORNER	NE CORNER	SE CORNER	SW CORNER
NORTHING	22705.83	22716.70	22567.24	22548.49
EASTING	21017.00	21115.25	21151.17	21035.59
CAISSON ELEV*	5708.44	5709.32	5710.30	5709.00
MAST ARM LENGTH (FT)	45	55	40	60
BASE DIA. (IN)	36	42	36	42
CAISSON LENGTH (FT)	14	14	11	14

NOTES:

• CONTRACTOR TO VERIFY ALL ELEVATIONS PRIOR TO CONSTRUCTION.

PROPOSED SIGNAL EQUIPMENT LEGEND

PULL BOX	
CONTROLLER CABINET	
PED PUSH BUTTON POLE	
SIGNAL POLE	
POWER METER PEDESTAL	
SIGNAL CONDUIT	

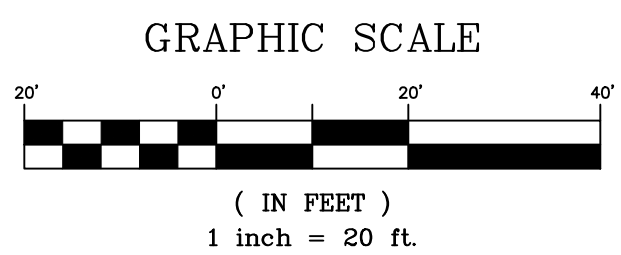
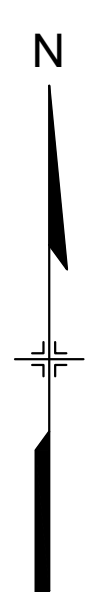
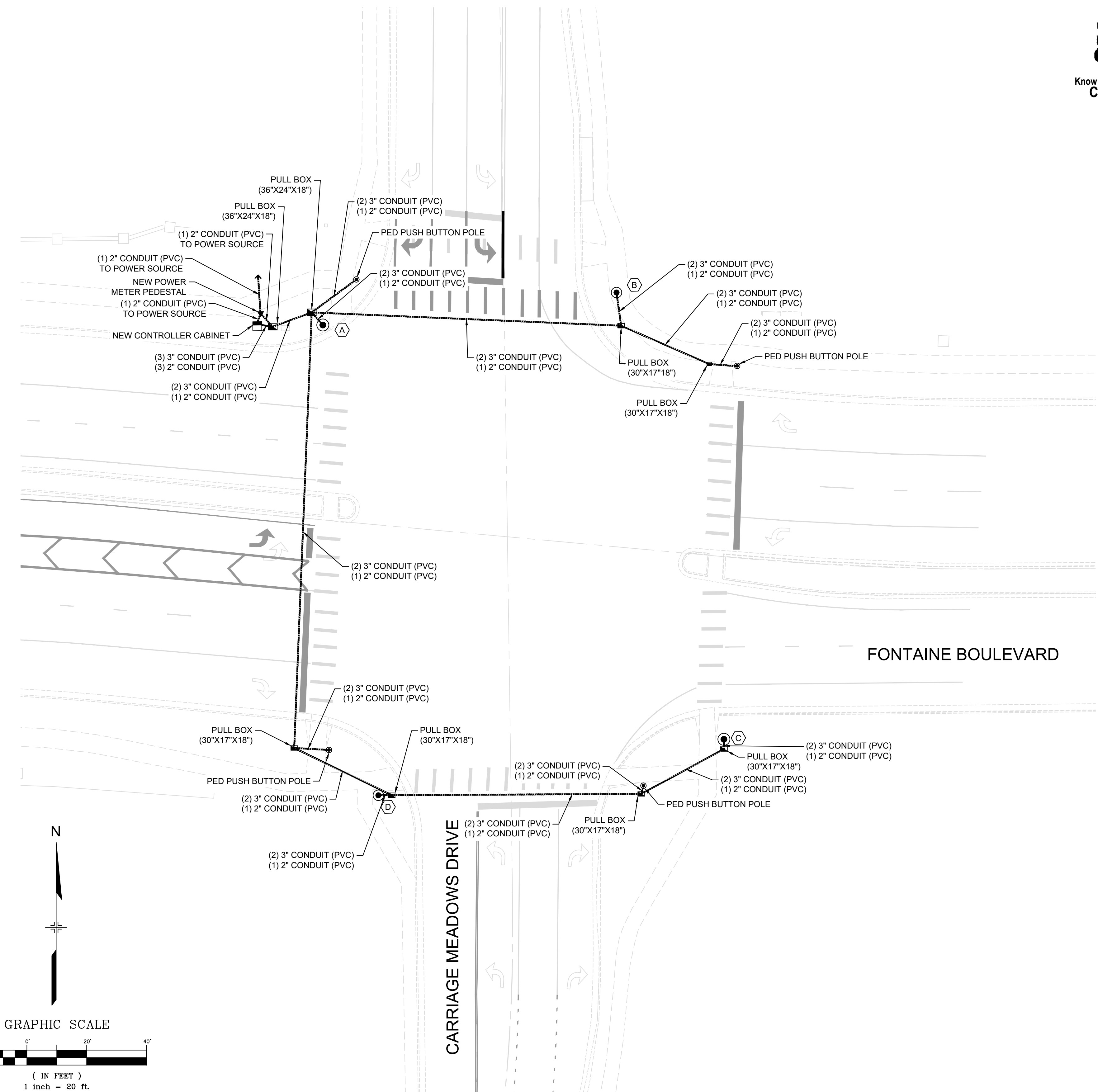

No.	DATE	DESCRIPTION	BY
COMPUTER FILE MANAGEMENT			
FILE NAME: S:\24.1129.026 Lorson Ranch Commercial North\500 CADD\504 Plan Sets\Construction Plans\Signal\SG01.dwg			
CTB FILE: Matrix(black).ctb			
PLOT DATE: November 4, 2024 1:56:28 PM			
THIS DRAWING IS CURRENT AS OF PLOT DATE AND MAY BE SUBJECT TO CHANGE.			

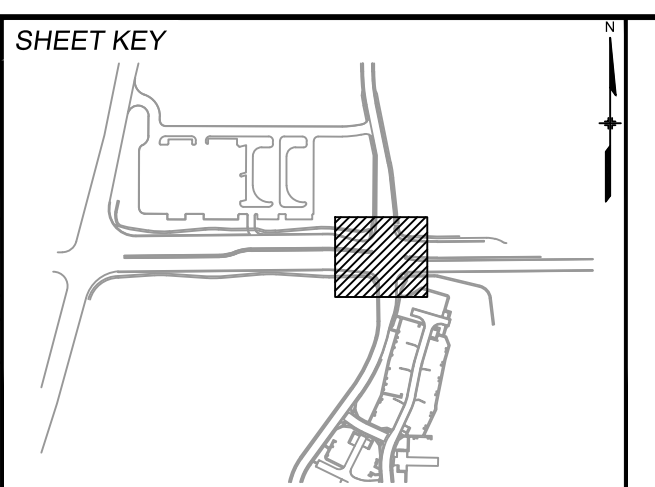

PREPARED FOR:	SEAL
PREPARED BY:	
	11/04/2024
FOR AND ON BEHALF OF MATRIX DESIGN GROUP, INC.	DESIGNED BY: TJC DRAWN BY: AFD CHECKED BY: SDB
EXcellence by Design	SCALE: HORIZ 1"=20' VERT. N/A
	DATE ISSUED: NOVEMBER 2024
	SHEET 3 OF 5
	DRAWING No. SG01

DESIGNED BY: TJC	SCALE: HORIZ 1"=20'	DATE ISSUED: NOVEMBER 2024	DRAWING No. SG01
DRAWN BY: AFD	VERT. N/A	SHEET 3 OF 5	
CHECKED BY: SDB			

LORSON RANCH COMMERCIAL NORTH			
CARRIAGE MEADOWS DRIVE/FONTAINE BOULEVARD TRAFFIC SIGNAL & SIGNING PLAN			
SIGNAL POLE & CONDUIT PLAN			

COUNTDOWN PEDESTRIAN HEAD



17, 18, 19, 20,
21, 22, 23, 24

PROPOSED SIGNAL HEADS

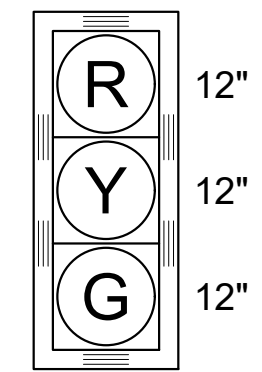

1, 2, 6, 7, 9, 10,
12, 13, 14, 15

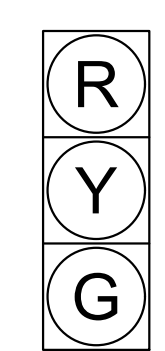

4, 8, 11, 16

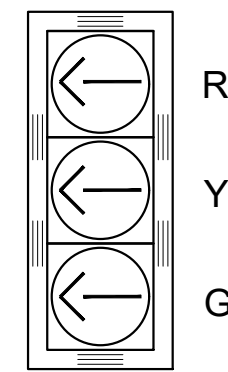

5

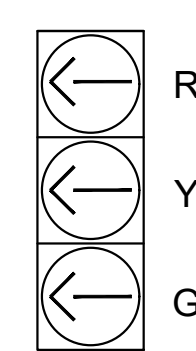

3

STREET NAME SIGNS

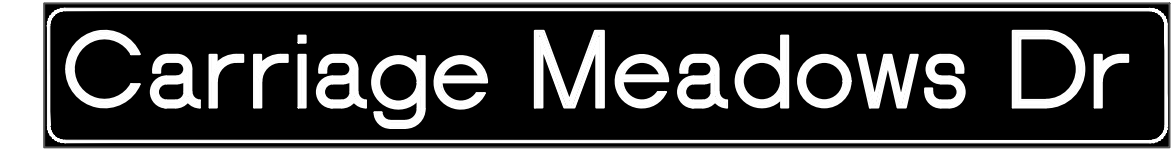

(A)



(B)

NOTES:

- SERIES E(M) ALPHABET SHALL BE USED WITH 12-INCH INITIAL UPPER-CASE LETTERS WITH 9" SUBSEQUENT LOWER-CASE LETTERS.
- WHITE TEXT ON GREEN BACKGROUND SHALL BE USED.
- SHOP DRAWINGS SHALL BE APPROVED BY THE ENGINEER PRIOR TO INSTALLATION.

PROPOSED PEDESTRIAN SIGN

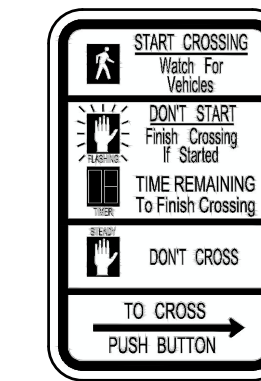

R10-3E
9" x 15"

EACH PEDESTRIAN PUSH BUTTON SHALL BE ACCOMPANIED BY A 9" x 15" R10-3E PEDESTRIAN SIGN. THIS SIGN SHALL BE INCLUDED IN THE PEDESTRIAN PUSH BUTTON PAY ITEM

SIGNAL EQUIPMENT LEGEND

PEDESTRIAN SIGNAL HEAD	
TRAFFIC SIGNAL HEAD W/ BACKPLATE	
TRAFFIC SIGNAL HEAD W/O BACKPLATE	
LUMINAIRE	
PED PUSH BUTTON POLE	
SIGNAL POLE	
PEDESTRIAN PUSH BUTTON AND SIGN	
RADAR DETECTION	
ILLUMINATED STREET NAME SIGN	

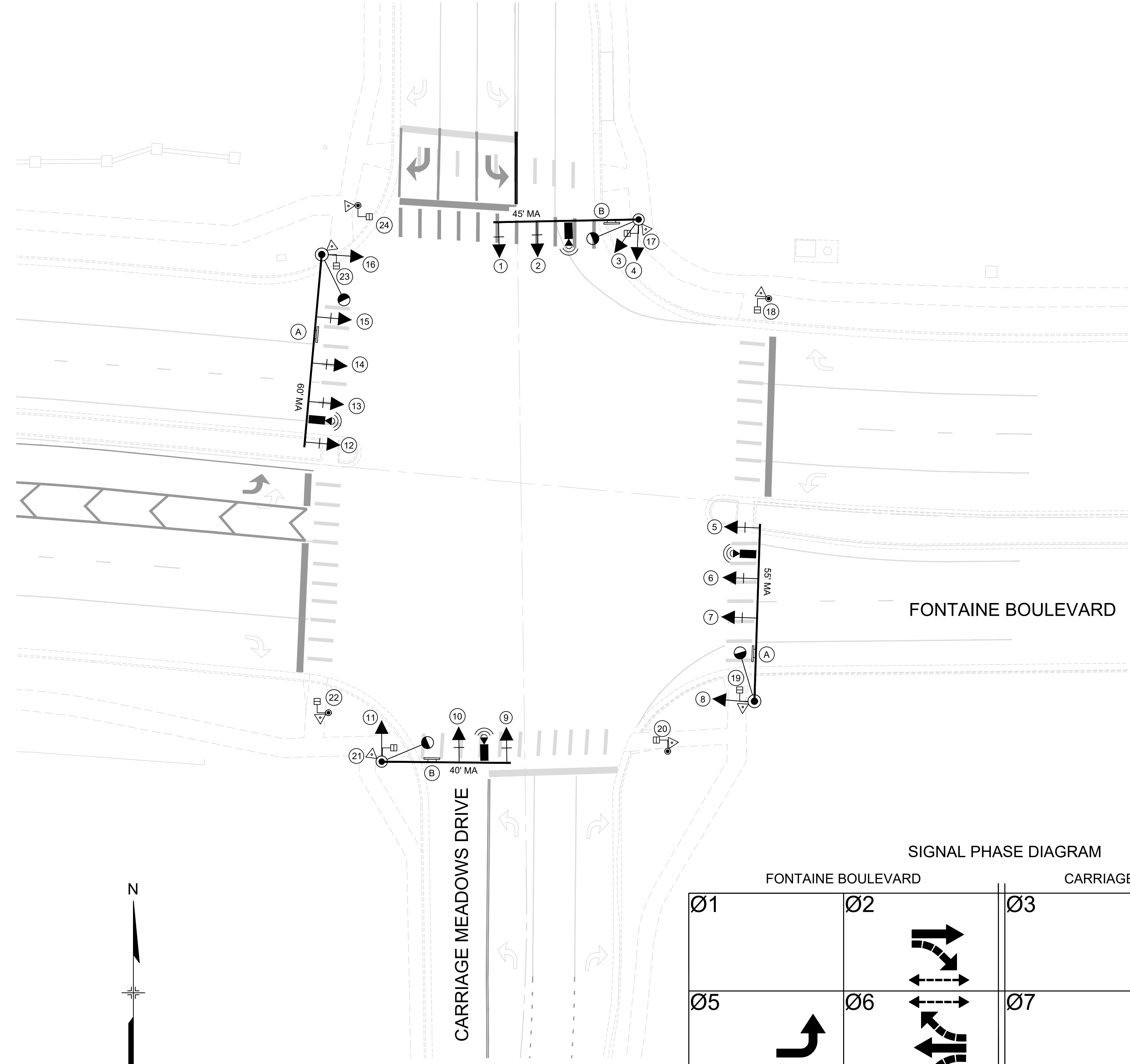
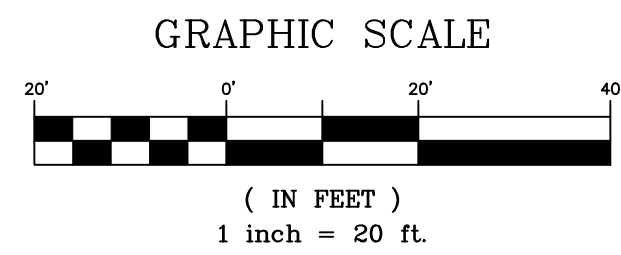
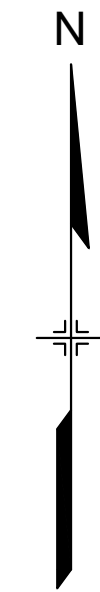

SIGNAL PHASE DIAGRAM

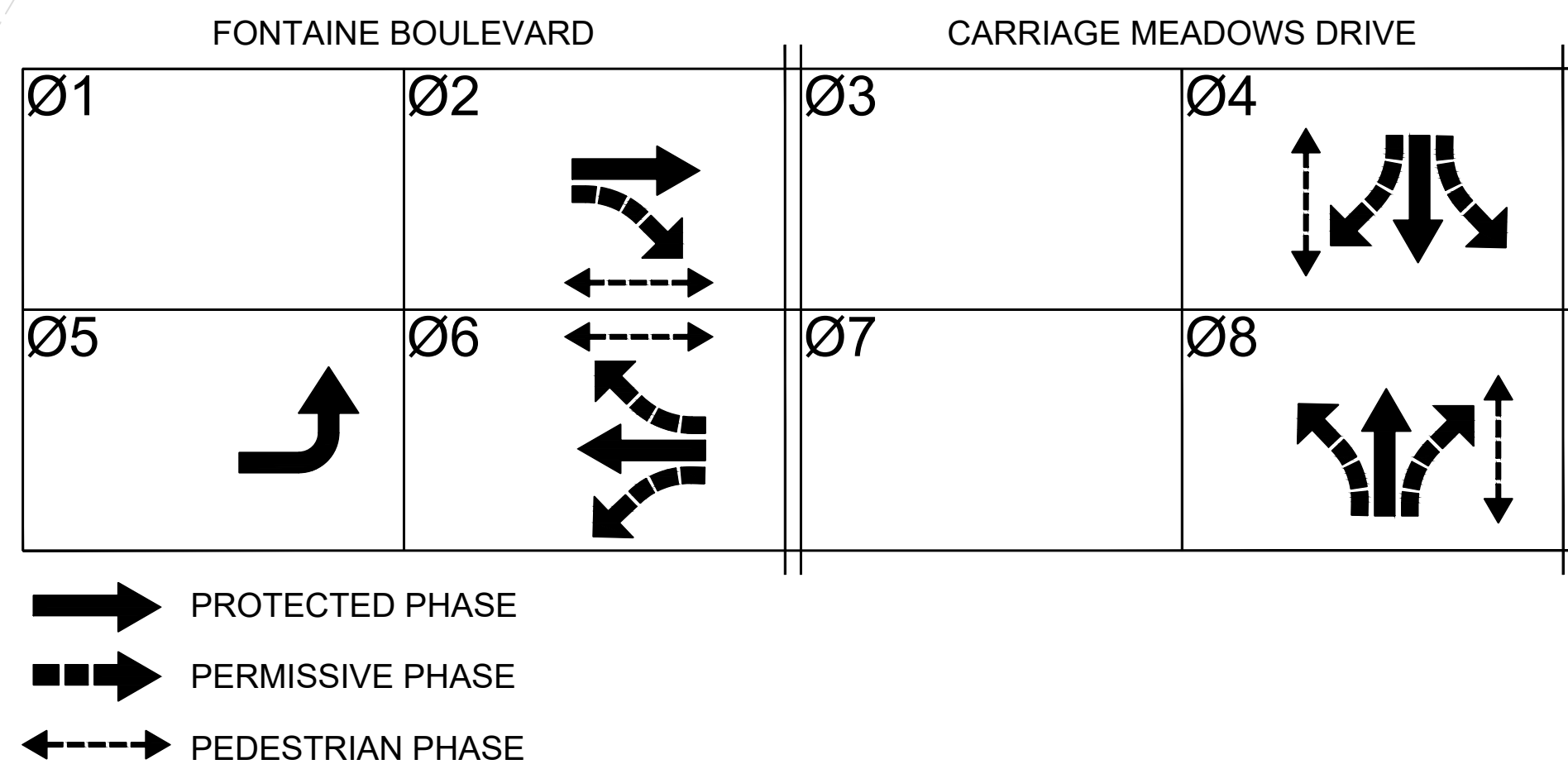

REFERENCE DRAWINGS			
X-MDG22x34 CD's X-1129.026-PR-SIGNAL 100.070bpx 100.070px X-1129.025-EX-BASE			
No.	DATE	DESCRIPTION	BY
COMPUTER FILE MANAGEMENT			
FILE NAME: S:\24.1129.026_Lorson Ranch Commercial North\500 CADD\504 Plan Sets\Construction Plans\Signal\SG01.dwg			
CTB FILE: Matrix(black).ctb			
PLOT DATE: November 4, 2024 1:56:28 PM			
THIS DRAWING IS CURRENT AS OF PLOT DATE AND MAY BE SUBJECT TO CHANGE.			

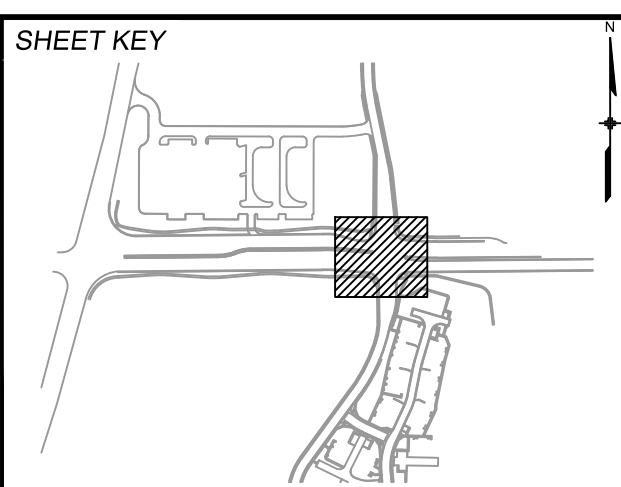

PREPARED FOR:

PREPARED BY:

SEAL

FOR AND ON BEHALF OF
MATRIX DESIGN GROUP, INC.
PROJECT No. 24.1129.026

LORSON RANCH COMMERCIAL NORTH			
CARRIAGE MEADOWS DRIVE/FONTAINE BOULEVARD TRAFFIC SIGNAL & SIGNING PLAN			
TRAFFIC SIGNAL PLAN			
DESIGNED BY: TJC	SCALE: HORIZ 1"=20'	DATE ISSUED: NOVEMBER 2024	DRAWING No. SG02
CHECKED BY: AFD	VERT. N/A	SHEET 4 OF 5	

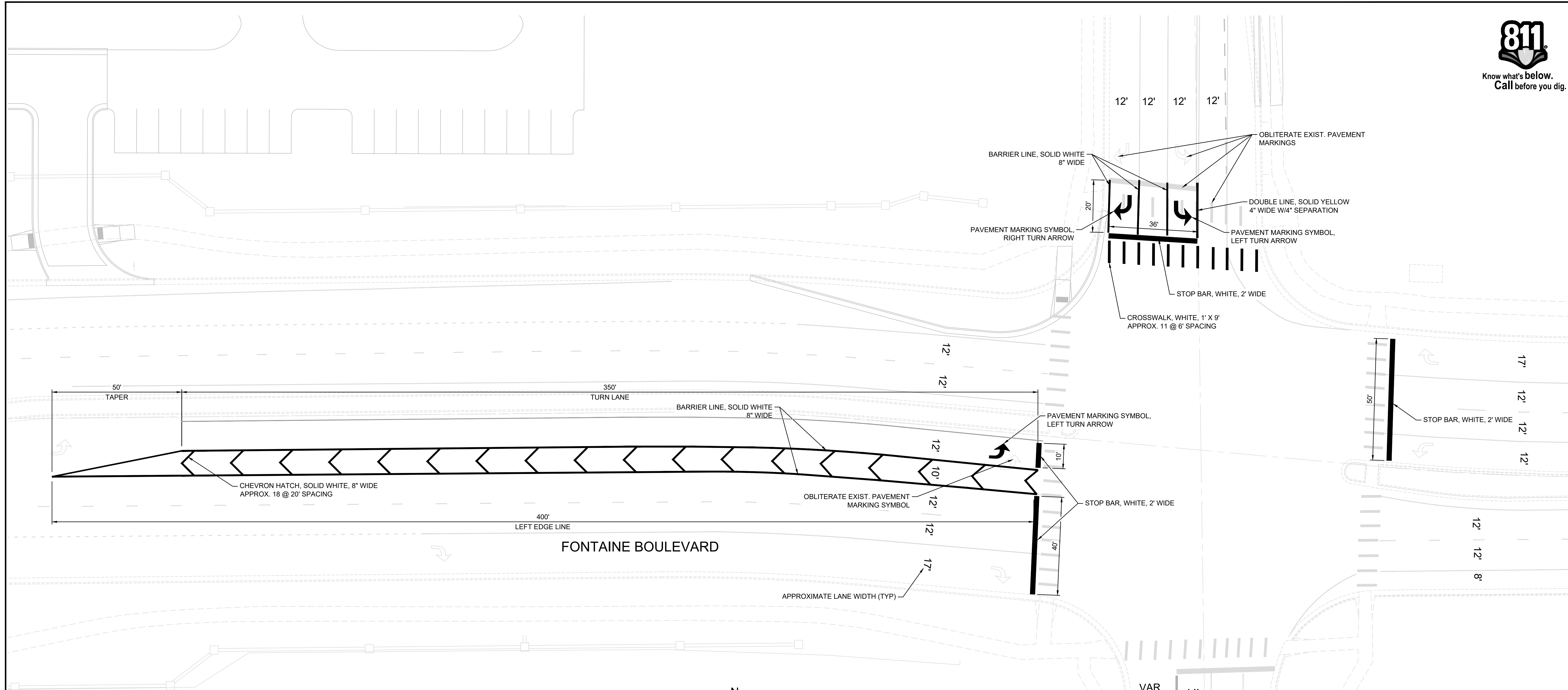

TABULATION OF STRIPING QUANTITIES

ITEM NO.	ITEM DESCRIPTION	UNIT	QUANTITY
627-00002	THERMOPLASTIC PAVEMENT MARKING	SF	595
627-00004	EPOXY PAVEMENT MARKING	SF	590



GRAPHIC SCALE

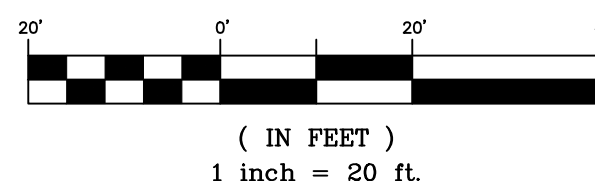

No.	DATE	DESCRIPTION	BY
REVISIONS			

COMPUTER FILE MANAGEMENT	
FILE NAME:	S:\24.1129.026 Lorson Ranch Commercial North\500 CADD\504 Plan Sets\Construction Plans\Signal\SN01.dwg
CTB FILE:	Matrix(black).ctb
PLOT DATE:	November 4, 2024 1:56:29 PM
THIS DRAWING IS CURRENT AS OF PLOT DATE AND MAY BE SUBJECT TO CHANGE.	

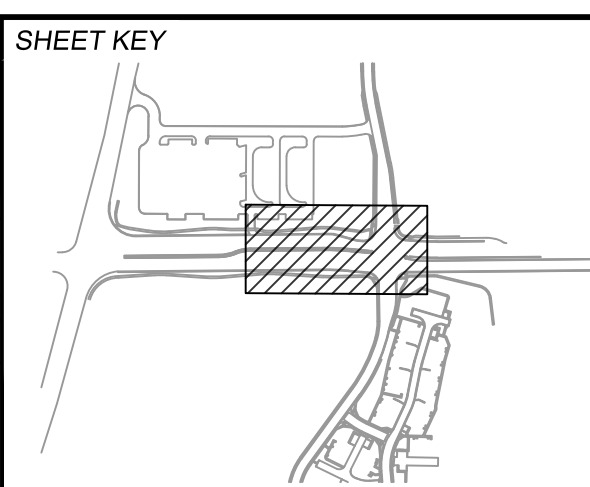

PREPARED BY:

SEAL

FOR AND ON BEHALF OF
 MATRIX DESIGN GROUP, INC.
 PROJECT No. 24.1129.026

LORSON RANCH COMMERCIAL NORTH
 CARRIAGE MEADOWS DRIVE/FONTAINE BOULEVARD
 TRAFFIC SIGNAL & SIGNING PLAN

SIGNING & STRIPING PLAN

DESIGNED BY:	TJC	SCALE:	HORIZ 1" = 20'	DATE ISSUED:	NOVEMBER 2024	DRAWING No.	SN01
CHECKED BY:	SDB	VERT.	N/A	SHEET	5 OF 5		