



Matrix Design Group, Inc.  
2435 Research Parkway, Suite 300  
Colorado Springs, CO 80920  
O 719.575.0100  
F 719.575.0208  
matrixdesigngroup.com

December 11, 2024

Gilbert LaForce  
El Paso County Department of Planning and Community Development  
2880 International Circle  
Colorado Springs, CO 80910

**RE: Fontaine Boulevard at Carriage Meadows Traffic Signal Plan Revisions**

Mr. LaForce:

Attached, please find our revised traffic signal plans to address comments received from the City of Colorado Springs. Signal plan sheets SG01 and SG02 have been superseded by SG01 R1 and SG01 R2. The changes were primarily a change from fully protected left-turn phasing to protected/permmissive left-turn phasing for the eastbound to northbound left-turn and realignment of other vehicle heads. The changes have been highlighted in the R1 plan sheets with red clouds and called out as revision R1.

Please let me know if you have any questions.

Sincerely,

A handwritten signature in blue ink that reads "Scott D. Barnhart".

Scott D. Barnhart, PE, PTOE  
Deputy Director of Transportation Services

Attach: Revised traffic signal plans

# LORSON RANCH COMMERCIAL NORTH



INDEX OF SHEETS		SHEET No.
TS01	TITLE SHEET	1
GN01	GENERAL NOTES	2
SG01	SIGNAL POLE & CONDUIT PLAN	3
SG02	TRAFFIC SIGNAL PLAN	4
SN01	SIGNING & STRIPING PLAN	5

## EL PASO COUNTY TRAFFIC SIGNAL & SIGNING PLAN PCD FILE NUMBER SF248

### CONTACT LIST

**OWNER/DEVELOPER**  
THE LANDHUIS COMPANY  
212 N. WAHSATCH AVENUE, SUITE 301  
COLORADO SPRINGS, CO 80903  
JEFF MARK  
(719) 635-3200

**CIVIL ENGINEER**  
MATRIX DESIGN GROUP  
2435 RESEARCH PARKWAY, SUITE 300  
COLORADO SPRINGS, CO 80920  
SCOTT D. BARNHART, P.E.  
(719) 575-0100

**WATER/SANITARY SERVICES**  
WIDEFILED WATER AND SANITATION DISTRICT  
8495 FONTAINE BOULEVARD  
COLORADO SPRINGS, CO 80925  
ROBERT BANNISTER, (719) 390-7111

**ELECTRIC SERVICES**  
MOUNTAINVIEW ELECTRIC ASSOCIATION  
(719) 495-2283

**GAS SERVICES**  
BLACK HILLS ENERGY  
105 S VICTORIA AVENUE  
PUEBLO, CO 80817  
(800) 303-0752

**ENGINEERING**  
EL PASO COUNTY PUBLIC WORKS DEPARTMENT  
3275 AKERS DRIVE  
COLORADO SPRINGS, CO 80922  
(719) 520-6460

**FIRE DEPARTMENT**  
COLORADO SPRINGS FIRE DEPARTMENT  
375 PRINTERS PARKWAY  
COLORADO SPRINGS, CO 80910  
(719) 444-7000



VICINITY MAP  
N.T.S.



SITE MAP  
N.T.S.

### ENGINEER'S STATEMENT

THESE DETAILED PLANS AND SPECIFICATIONS WERE PREPARED UNDER MY DIRECTION AND SUPERVISION. SAID DETAILED PLANS AND SPECIFICATIONS HAVE BEEN PREPARED ACCORDING TO THE CRITERION ESTABLISHED BY THE COUNTY FOR DETAILED DRAINAGE PLANS AND SPECIFICATIONS, AND SAID DETAILED PLANS AND SPECIFICATIONS ARE IN CONFORMITY WITH THE MASTER PLAN OF THE DRAINAGE BASIN. SAID DETAILED DRAINAGE PLANS AND SPECIFICATIONS MEET THE PURPOSE FOR WHICH THE PARTICULAR DRAINAGE FACILITY(S) IS DESIGNED. I ACCEPT RESPONSIBILITY FOR ANY LIABILITY CAUSED BY ANY NEGLIGENT ACTS, ERRORS OR OMISSIONS ON MY PART IN PREPARATION OF THE DETAILED DRAINAGE PLANS AND SPECIFICATIONS.

BY: *Scott D. Barnhart* DATE: November 4, 2024  
SCOTT BARNHART, P.E. #37447  
FOR AND ON BEHALF OF MATRIX DESIGN GROUP, INC.

### OWNER/DEVELOPER:

I, THE OWNER/DEVELOPER HAVE READ AND WILL COMPLY WITH THE REQUIREMENTS OF THE GRADING AND EROSION CONTROL PLANS AND ALL OF THE REQUIREMENTS SPECIFIED IN THESE DETAILED PLANS AND SPECIFICATIONS

*Jeff Mark*  
JEFF MARK  
PROJECT MANAGER  
THE LANDHUIS COMPANY  
212 N WAHSATCH AVENUE, SUITE 301  
COLORADO SPRINGS, CO 80903

*11/13/24*  
DATE

### EL PASO COUNTY:

COUNTY PLAN REVIEW IS PROVIDED ONLY FOR GENERAL CONFORMANCE WITH COUNTY DESIGN CRITERIA. THE COUNTY IS NOT RESPONSIBLE FOR THE ACCURACY AND ADEQUACY OF THE DESIGN, DIMENSIONS, AND/OR ELEVATIONS WHICH SHALL BE CONFIRMED AT THE JOB SITE. THE COUNTY THROUGH THE APPROVAL OF THIS DOCUMENT ASSUMES NO RESPONSIBILITY FOR COMPLETENESS AND/OR ACCURACY OF THIS DOCUMENT.

FILES IN ACCORDANCE WITH THE REQUIREMENTS OF THE EL PASO COUNTY LAND DEVELOPMENT CODE, DRAINAGE CRITERIA MANUAL, VOLUMES 1 AND 2, AND ENGINEERING CRITERIA MANUAL AMENDED.

IN ACCORDANCE WITH ECM SECTION 1.12, THESE CONSTRUCTION DOCUMENTS WILL BE VALID FOR CONSTRUCTION FOR A PERIOD OF 2 YEARS FROM THE DATE SIGNED BY THE EL PASO COUNTY ENGINEER. IF CONSTRUCTION HAS NOT STARTED WITHIN THOSE 2 YEARS, THE PLANS WILL NEED TO BE RESUBMITTED FOR APPROVAL, INCLUDING PAYMENT OF REVIEW FEES AT THE PLANNING AND COMMUNITY DEVELOPMENT DIRECTORS DISCRETION.

*Joshua Palmer*  
JOSHUA PALMER, P.E.  
COUNTY ENGINEER/ ECM ADMINISTRATOR

11/13/2024  
DATE

THE PARTIES RESPONSIBLE FOR THIS PLAN HAVE FAMILIARIZED THEMSELVES WITH ALL CURRENT ACCESSIBILITY CRITERIA AND SPECIFICATIONS AND THE PROPOSED PLAN REFLECTS ALL SITE ELEMENTS REQUIRED BY THE APPLICABLE ADA DESIGN STANDARDS AND GUIDELINES AS PUBLISHED BY THE UNITED STATES DEPARTMENT OF JUSTICE. APPROVAL OF THIS PLAN BY EL PASO COUNTY DOES NOT ASSURE COMPLIANCE WITH THE ADA OR ANY REGULATIONS OR GUIDELINES ENACTED OR PROMULGATED UNDER OR WITH RESPECT TO SUCH LAWS.

REFERENCE DRAWINGS	SHEET KEY	PREPARED FOR	SEAL	LORSON RANCH COMMERCIAL NORTH	
X:\M022\24 CD's X-1123-EX-IMAGE Site Map_Lorson Ranch Commercial North.dwg				CARRIAGE MEADOWS DRIVE/FONTAINE BOULEVARD TRAFFIC SIGNAL & SIGNING PLAN	
		PREPARED BY:		TITLE SHEET	
				DESIGNED BY: TJC	DRAWING No. TS01
				DRAWN BY: AFD	
				CHECKED BY: SDB	
				SCALE: HORIZ 1/4" = 1'-0"	
				DATE ISSUED: NOVEMBER 2024	
				FOR AND ON BEHALF OF MATRIX DESIGN GROUP, INC. PROJECT No. 24.1129.026	
				1 OF 5 SHEETS	



**STANDARD NOTES FOR CONSTRUCTION:**

- 1. ALL DRAINAGE AND ROADWAY CONSTRUCTION SHALL MEET THE STANDARDS AND SPECIFICATIONS OF THE CITY OF COLORADO SPRINGS/EL PASO COUNTY DRAINAGE CRITERIA MANUAL, VOLUMES 1 AND 2, AND THE EL PASO COUNTY ENGINEERING CRITERIA MANUAL.
2. CONTRACTOR SHALL BE RESPONSIBLE FOR THE NOTIFICATION AND FIELD NOTIFICATION OF ALL EXISTING UTILITIES, WHETHER SHOWN ON THE PLANS OR NOT, BEFORE BEGINNING CONSTRUCTION.
3. CONTRACTOR SHALL KEEP A COPY OF THESE APPROVED PLANS, THE GRADING AND EROSION CONTROL PLAN, THE STORMWATER MANAGEMENT PLAN (SWMP), THE SOILS AND GEOTECHNICAL REPORT, AND THE APPROPRIATE DESIGN AND CONSTRUCTION STANDARDS AND SPECIFICATIONS AT THE JOB SITE AT ALL TIMES, INCLUDING THE FOLLOWING:
3.A. EL PASO COUNTY ENGINEERING CRITERIA MANUAL (ECM)
3.B. CITY OF COLORADO SPRINGS/EL PASO COUNTY DRAINAGE CRITERIA MANUAL, VOLUMES 1 & 2
3.C. COLORADO DEPARTMENT OF TRANSPORTATION (CDOT) STANDARD SPECIFICATIONS FOR ROAD AND BRIDGE CONSTRUCTION
3.D. CDOT M & S STANDARDS
4. NOT WITHSTANDING ANYTHING DEPICTED IN THESE PLANS IN WORDS OR GRAPHIC REPRESENTATION, ALL DESIGN AND CONSTRUCTION RELATED TO ROADS, STORM DRAINAGE AND EROSION CONTROL SHALL CONFORM TO THE STANDARDS AND REQUIREMENTS OF THE MOST RECENT VERSION OF THE RELEVANT ADOPTED EL PASO COUNTY STANDARDS, INCLUDING THE LAND DEVELOPMENT CODE, THE ENGINEERING CRITERIA MANUAL, THE DRAINAGE CRITERIA MANUAL, AND THE DRAINAGE CRITERIA MANUAL VOLUME 2.
5. IT IS THE DESIGN ENGINEER'S RESPONSIBILITY TO ACCURATELY SHOW EXISTING CONDITIONS, BOTH ONSITE AND OFFSITE, ON THE CONSTRUCTION PLANS.
6. CONTRACTOR SHALL SCHEDULE A PRE-CONSTRUCTION MEETING WITH EL PASO COUNTY PLANNING AND COMMUNITY DEVELOPMENT (PCD)- INSPECTIONS, PRIOR TO STARTING CONSTRUCTION.
7. IT IS THE CONTRACTOR'S RESPONSIBILITY TO UNDERSTAND THE REQUIREMENTS OF ALL JURISDICTIONAL AGENCIES AND TO OBTAIN ALL REQUIRED PERMITS, INCLUDING BUT NOT LIMITED TO EL PASO COUNTY EROSION AND STORMWATER QUALITY CONTROL PERMIT (WSQCP), REGIONAL BUILDING FLOODPLAIN DEVELOPMENT PERMIT, U.S. ARMY CORPS OF ENGINEERS-ISSUED 401 AND/OR 404 PERMITS, AND COUNTY AND STATE FUGITIVE DUST PERMITS.
8. CONTRACTOR SHALL NOT DEVIATE FROM THE PLANS WITHOUT FIRST OBTAINING WRITTEN APPROVAL FROM THE DESIGN ENGINEER AND PCD.
9. ALL STORM DRAIN PIPE SHALL BE CLASS III RCP UNLESS OTHERWISE NOTED AND APPROVED BY PCD.
10. CONTRACTOR SHALL COORDINATE GEOTECHNICAL TESTING PER ECM STANDARDS. PAVEMENT DESIGN SHALL BE APPROVED BY EL PASO COUNTY PCD PRIOR TO PLACEMENT OF CURB AND GUTTER AND PAVEMENT.
11. ALL CONSTRUCTION TRAFFIC MUST ENTER/EXIT THE SITE AT APPROVED CONSTRUCTION ACCESS POINTS.
12. SIGHT VISIBILITY TRIANGLES AS IDENTIFIED IN THE PLANS SHALL BE PROVIDED AT ALL INTERSECTIONS.
13. SIGNING AND STRIPING SHALL COMPLY WITH EL PASO COUNTY DOT AND MUTCD CRITERIA.
14. CONTRACTOR SHALL OBTAIN ANY PERMITS REQUIRED BY EL PASO COUNTY DOT, INCLUDING WORK WITHIN THE RIGHT-OF-WAY AND SPECIAL TRANSPORT PERMITS.
15. THE LIMITS OF CONSTRUCTION SHALL REMAIN WITHIN THE PROPERTY LINE UNLESS OTHERWISE NOTED.

**COLORADO SPRINGS TRAFFIC SIGNAL GENERAL NOTES:**

- A. CONTRACTOR SHALL HAVE A COPY OF CURRENT CITY OF COLORADO SPRINGS TRAFFIC SIGNAL INSTALLATION AND PARTS SPECIFICATION ON JOB SITE AT ALL TIMES.
B. ALL WORK SHALL BE DONE IN ACCORDANCE WITH CURRENT CITY OF COLORADO SPRINGS ENGINEERING DIVISION STANDARD SPECIFICATIONS, COLORADO SPRINGS CITY TRAFFIC SIGNAL INSTALLATION AND PARTS SPECIFICATION, CITY OF COLORADO SPRINGS TRAFFIC CONTROLS FOR STREET CONSTRUCTION, UTILITY WORK, AND MAINTENANCE OPERATIONS FOR CONTRACTORS, AND MANUAL ON UNIFORM TRAFFIC CONTROL DEVICES FOR STREETS AND HIGHWAY.
C. ALL MATERIALS AND WORKMANSHIP SHALL BE SUBJECT TO INSPECTION AND APPROVAL BY CITY OF COLORADO SPRINGS ENGINEERING REPRESENTATIVE OR CITY TRAFFIC ENGINEER.
D. REFER TO THE "GROUNDING METHODS" SECTION 18 OF THIS MANUAL FOR INFORMATION ON HOW TO GROUND TRAFFIC SIGNAL SYSTEMS.
E. ALL MATERIALS AND WORKMANSHIP SHALL BE SUBJECT TO INSPECTION AND APPROVAL BY CITY OF COLORADO SPRINGS ENGINEERING REPRESENTATIVE OR CITY TRAFFIC ENGINEER.
F. THE CONTRACTOR SHALL CONTACT THE UTILITY NOTIFICATION CENTER OF COLORADO AT 811 THREE BUSINESS DAYS IN ADVANCE OF ANY EXCAVATING OR GRADING.
G. THE CONTRACTOR SHALL PROTECT AND MAINTAIN UTILITIES AND STRUCTURES AFFECTED BY WORK AND ANY DAMAGE SHALL BE REPAIRED AND RESTORED THE SATISFACTION OF THE CITY OF COLORADO SPRINGS.
H. CONTRACTOR SHALL LIMIT CONSTRUCTION ACTIVITIES TO THOSE AREAS WITHIN THE EXISTING RIGHT-OF-WAY AND TEMPORARY AND PERMANENT EASEMENTS SHOWN ON THE PLANS.
I. THE CONTRACTOR SHALL PRESERVE ALL MONUMENTS, BENCHMARKS, RANGE TIES, AND PROPERTY MARKERS.
J. THE CONTRACTOR SHALL BE RESPONSIBLE FOR MAINTENANCE OF PUBLIC RIGHT-OF-WAY, INCLUDING VEHICLE TRAVELED WAY AND PEDESTRIAN PATHS.
K. INSTALLATION AND MAINTENANCE OF ALL TRAFFIC DEVICES IS THE RESPONSIBILITY OF THE CONTRACTOR.
L. CONSTRUCTION ACTIVITY SHALL BE SCHEDULED WITH THE MINIMUM IMPACT TO PEDESTRIAN AND VEHICLE TRAFFIC.
M. THE CONTRACTOR SHALL BE RESPONSIBLE FOR MAINTENANCE OF TRAFFIC SIGNALIZATION AT EXISTING SIGNALIZED INTERSECTION SHOWN ON THE SIGNAL PLANS AT ALL TIMES FROM BEGINNING OF THE PROJECT TO ACCEPTANCE APPROVED BY THE CITY.
N. CONTRACTOR SHALL CONTACT THE CITY TRAFFIC ENGINEERING REPRESENTATIVE FOR INSPECTION OF POLE CAISSON FROM, ANCHOR BOLTS AND CONDUIT STUB OUT 24 HOURS PRIOR TO INTENT OF POUR, AND (2-HOUR MINIMUM CONFORMATION) PRIOR TO POURING CONCRETE.
O. CONDITIONAL ACCEPTANCE: ONCE CONSTRUCTION OF A TRAFFIC SIGNAL HAS BEEN SATISFACTORY COMPLETED; THE SIGNALS ARE "CONDITIONALLY ACCEPTED" BY OWNER.
P. FINAL ACCEPTANCE: AFTER THE BURN-IN PERIOD IS COMPLETED, ALL PUNCH LIST ITEMS HAVE BEEN CORRECTED AND THE CONTRACTOR HAS MET ALL CONTRACT REQUIREMENTS (SUCH AS FINAL CLEANUP OF WORK SITE, AS BUILT DRAWINGS AND BORE LOGS).
Q. THE CONTRACTOR SHALL PROVIDE A TWO-YEAR GUARANTEE ON ALL WORK PERFORMED UNDER THIS CONTRACT AFTER THE JOB HAS BEEN COMPLETED AND ACCEPTED.
R. THE CONTRACTOR SHALL PROVIDE ENGINEER WITH DAILY QUANTITIES AND TRAFFIC CONTROL DIARIES AT THE END OF WORK WEEK OR AS DIRECTED BY THE ENGINEER.
S. THE CONTRACTOR SHALL SUBMIT "AS-BUILT" OR CORRECTED PLANS SHOWING, IN DETAIL, ALL CONSTRUCTION CHANGES INCLUDING BUT NOT LIMITED TO BORE LOGS, POTHOLE LOGS, WIRING, CABLE, POLES, CONTROLLER CABINET, DETECTION SYSTEM AND LOCATION OF ALL CONDUITS WITHIN 7 DAYS OF INSTALLATION.

- T. ALL TRAFFIC SIGNAL EQUIPMENT THAT IS REMOVED SHALL REMAIN THE PROPERTY OF THE CITY OF COLORADO SPRINGS. SUCH PROPERTY IS TO BE RETURNED BY CONTRACTOR TO 416 FONTANERO ST, CITY TRAFFIC SIGNAL CONSTRUCTION SHOP.
U. CONTRACTOR SHALL REPLACE OR RECONSTRUCT SIDEWALKS, CURBS, GUTTERS, PAVEMENT AND ANY OTHER IMPROVEMENTS REMOVED, BROKEN OR DAMAGED BY CONTRACTOR THAT WERE NOT DESIGNATED FOR REMOVAL IN THE PROJECT.
V. SIGNAL HEADS SHALL NOT BE INSTALLED IF LONG DELAY IS EXPECTED FOR TURNING SIGNAL ACTIVE.
W. ACCEPTABLE TIMES FOR TURNING NEW OR REBUILT INTERSECTION OPERATIONAL IS BETWEEN 9:00AM MONDAY THROUGH 3:00 PM THURSDAY.
X. CONTRACTOR SHALL PROTECT ALL KNOWN ENVIRONMENTAL RESOURCES IN CITY RIGHT-OF-WAY.

**SIGNING AND STRIPING NOTES:**

- 1. ALL SIGNS AND PAVEMENT MARKINGS SHALL BE IN COMPLIANCE WITH THE CURRENT MANUAL ON UNIFORM TRAFFIC CONTROL DEVICES (MUTCD).
2. REMOVAL OF EXISTING PAVEMENT MARKINGS SHALL BE ACCOMPLISHED BY A METHOD THAT DOES NOT MATERIALLY DAMAGE THE PAVEMENT.
3. ANY DEVIATION FROM THE STRIPING AND SIGNING PLAN SHALL BE APPROVED BY EL PASO COUNTY PLANNING AND COMMUNITY DEVELOPMENT.
4. ALL SIGNS SHOWN ON THE SIGNING AND STRIPING PLAN SHALL BE NEW SIGNS.
5. STREET NAME AND REGULATORY STOP SIGNS SHALL BE ON THE SAME POST AT INTERSECTIONS.
6. ALL REMOVED SIGNS SHALL BE DISPOSED OF IN A PROPER MANNER BY THE CONTRACTOR.
7. ALL STREET NAME SIGNS SHALL HAVE "D" SERIES LETTERS, WITH LOCAL ROADWAY SIGNS BEING 4" UPPER-POWER CASE LETTERING ON 8" BLACK AND NON-LOCAL ROADWAY SIGNS BEING 6" LETTERING, UPPER-LOWER CASE ON 12" BLANK.
8. ALL TRAFFIC SIGNS SHALL HAVE A MINIMUM HIGH INTENSITY PRISMATIC GRADE SHEETING.
9. ALL LOCAL RESIDENTIAL STREET SIGNS SHALL BE MOUNTED ON A 1.75" X 1.75" SQUARE TUBE SIGN POST AND STUB POST BASE.
10. ALL SIGNS SHALL BE SINGLE SHEET ALUMINUM WITH 0.100" MINIMUM THICKNESS.
11. ALL LIMIT LINES/STOP LINES, CROSSWALK LINES, PAVEMENT LEGENDS, AND ARROWS SHALL BE A MINIMUM 125 MIL THICKNESS PERFORMED THERMOPLASTIC PAVEMENT MARKINGS WITH TAPERED LEADING EDGES PER CDOT STANDARDS S-627-1.
12. ALL LONGITUDINAL LINES SHALL BE A MINIMUM 15 MIL THICKNESS EPOXY PAINT.
13. THE CONTRACTOR SHALL NOTIFY EL PASO COUNTY PLANNING AND COMMUNITY DEVELOPMENT (719) 520-6819 PRIOR TO AND UPON COMPLETION OF SIGNING AND STRIPING.
14. THE CONTRACTOR SHALL OBTAIN A WORK IN THE RIGHT OF WAY PERMIT FROM THE EL PASO COUNTY DEPARTMENT OF PUBLIC WORKS (DPW) PRIOR TO ANY SIGNAGE OR STRIPING WORK WITHIN AN EXISTING EL PASO COUNTY ROADWAY.

**COLORADO SPRINGS CITY TRAFFIC SIGNAL INSTALLATION & PARTS SPECIFICATIONS:**

- SECTION 1 CONTRACTOR PRE-QUALIFICATIONS
SECTION 2 GENERAL NOTES
SECTION 3 MATERIALS
SECTION 4 CABLE SPLICING AND COLOR CODES
SECTION 5 SPAN WIRE ATTACHMENT
SECTION 6 CONDUIT, JUNCTION BOXES, AND CONTROLLER BASE
SECTION 7 ILLUMINATED STREET NAME SIGNS
SECTION 8 SIGNAL POLE 2015 AASHTO DESIGN
SECTION 9 SIGNAL POLE FOUNDATION 2015 AASHTO DESIGN
SECTION 10 SCHOOL FLASHER
SECTION 11 SIGNAL HEADS AND MOUNTING EQUIPMENT
SECTION 12 PEDESTAL POLES AND PEDESTRIAN BUTTONS
SECTION 13 SIGNAL CABINET
SECTION 14 DETECTION SYSTEMS
SECTION 15 SERVICE AND WIRE SPECIFICATIONS
SECTION 16 STEEL CABLE, SIGNAL ACCESSORIES, AND GUY WIRE
SECTION 17 LED ROADWAY LIGHTING
SECTION 18 GROUNDING METHODS
APPENDIX A CONCRETE MIX DESIGNS AND REQUIREMENTS
APPENDIX B SIGNAL POLE AASHTO 1994 (MAINTENANCE ONLY)
APPENDIX C SIGNAL FOUNDATION AASHTO 1994 (MAINTENANCE ONLY)

Table with columns: REFERENCE DRAWINGS, No., DATE, DESCRIPTION REVISIONS, BY. Includes 'COMPUTER FILE MANAGEMENT' section with file names and dates.

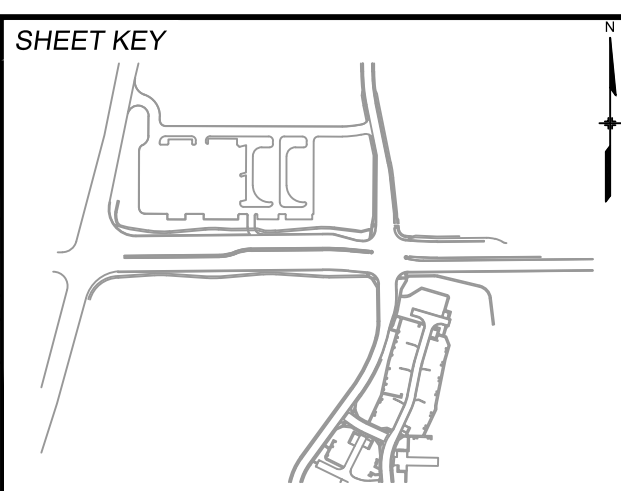

PREPARED FOR: PREPARED BY: Matrix Excellence by Design

SEAL: COLORADO LICENSED PROFESSIONAL ENGINEER, 37447, 11/04/2024

LORSON RANCH COMMERCIAL NORTH CARRIAGE MEADOWS DRIVE/FONTAINE BOULEVARD TRAFFIC SIGNAL & SIGNING PLAN GENERAL NOTES DESIGNED BY: TJC SCALE: HORIZ N/A DATE ISSUED: NOVEMBER 2024 DRAWING No: GN01

TABULATION OF SIGNAL QUANTITIES			
ITEM NO.	ITEM DESCRIPTION	UNIT	QUANTITY
814-03036	DRILLED SIGNAL POLE FOUNDATION (36 INCH)	LF	25
814-03042	DRILLED SIGNAL POLE FOUNDATION (42 INCH)	LF	28
813-00201	2 INCH CONDUIT (TRAFFIC)	LF	540
813-00301	3 INCH CONDUIT (TRAFFIC)	LF	1030
813-07012	PULL BOX (30"x17"x18")	EA	6
813-07013	PULL BOX (36"x24"x18")	EA	2
814-80009	TRAFFIC SIGNAL LUMINAIRE	EA	4
813-08001	TRAFFIC SIGNAL METER PEDESTAL	EA	1
814-10130	ILLUMINATED STREET NAME SIGN	EA	4
814-75215	PEDESTRIAN SIGNAL FACE (16) (COUNTDOWN)	EA	8
814-70336	TRAFFIC SIGNAL FACE (12-12-12)	EA	15
814-72860	PEDESTRIAN PUSH BUTTON	EA	8
814-72897	INTERSECTION DETECTION SYSTEM (RADAR)	EA	4
814-84440	TRAFFIC SIGNAL PEDESTAL POLE	EA	4
814-81040	TRAFFIC SIGNAL POLE (1 MAST ARM) (40 FT MAST ARM)	EA	1
814-81045	TRAFFIC SIGNAL POLE (1 MAST ARM) (45 FT MAST ARM)	EA	1
814-81055	TRAFFIC SIGNAL POLE (1 MAST ARM) (55 FT MAST ARM)	EA	1
814-81060	TRAFFIC SIGNAL POLE (1 MAST ARM) (60 FT MAST ARM)	EA	1
814-75847	TRAFFIC SIGNAL CONTROLLER AND CABINET (COMPLETE)	EA	1

NOTE:  
TRAFFIC SIGNAL FACE (12-12-12) SHALL INCLUDE VISORS AND ALL MOUNTING HARDWARE REQUIRED TO INSTALL.

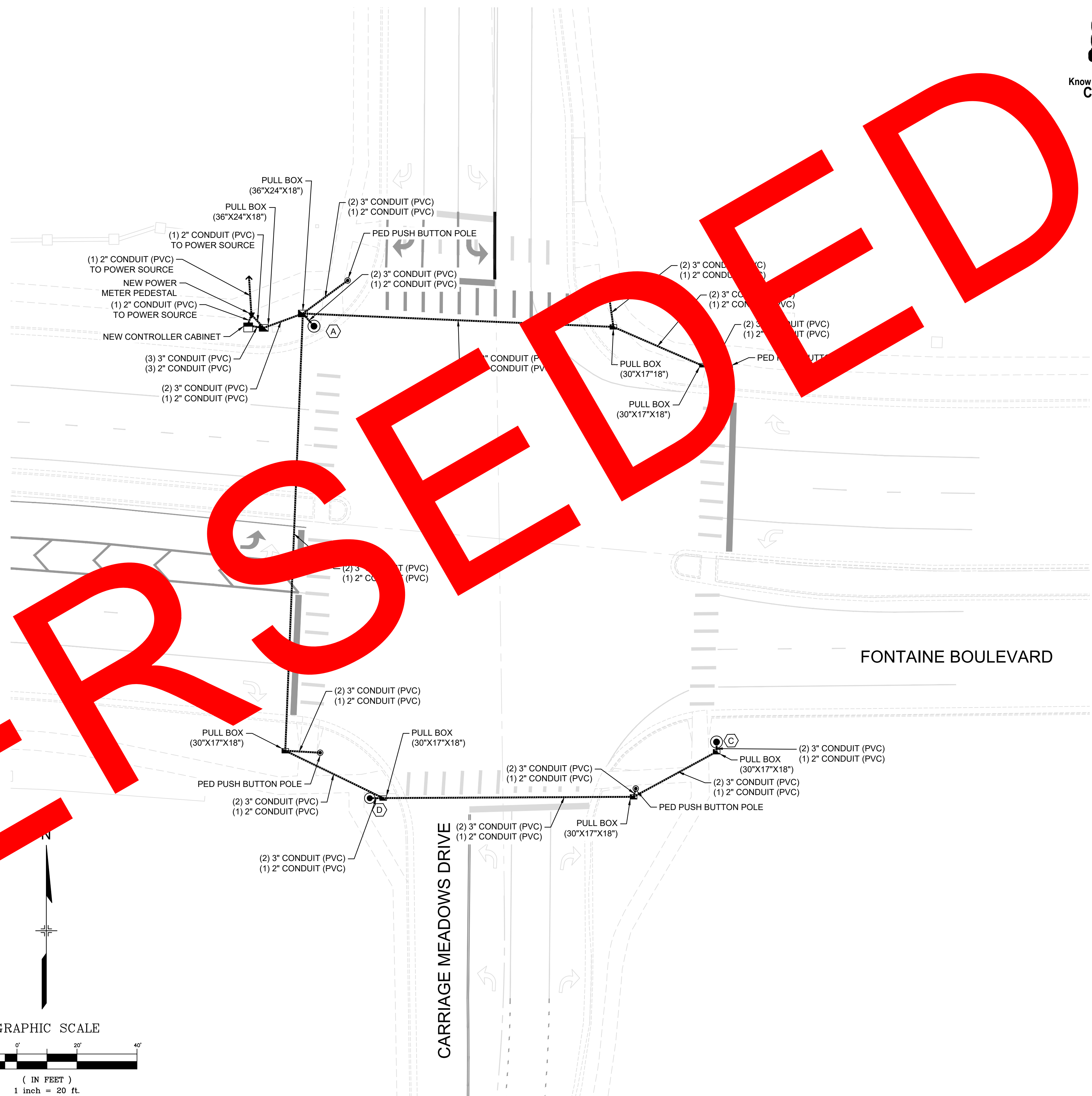

**SIGNAL POLE SCHEDULE**

POLE NUMBER	A	B	C	D
LOCATION	NW CORNER	NE CORNER	SE CORNER	SW CORNER
NORTHING	22705.83	22716.70	22567.24	22548.49
EASTING	21017.00	21115.25	21151.17	21035.59
CAISSON ELEV*	5708.44	5709.32	5710.30	5709.00
MAST ARM LENGTH (FT)	45	55	40	60
BASE DIA. (IN)	36	42	36	42
CAISSON LENGTH (FT)	14	14	11	14

NOTES:  
• CONTRACTOR TO VERIFY ALL ELEVATIONS PRIOR TO CONSTRUCTION.

**PROPOSED SIGNAL EQUIPMENT LEGEND**

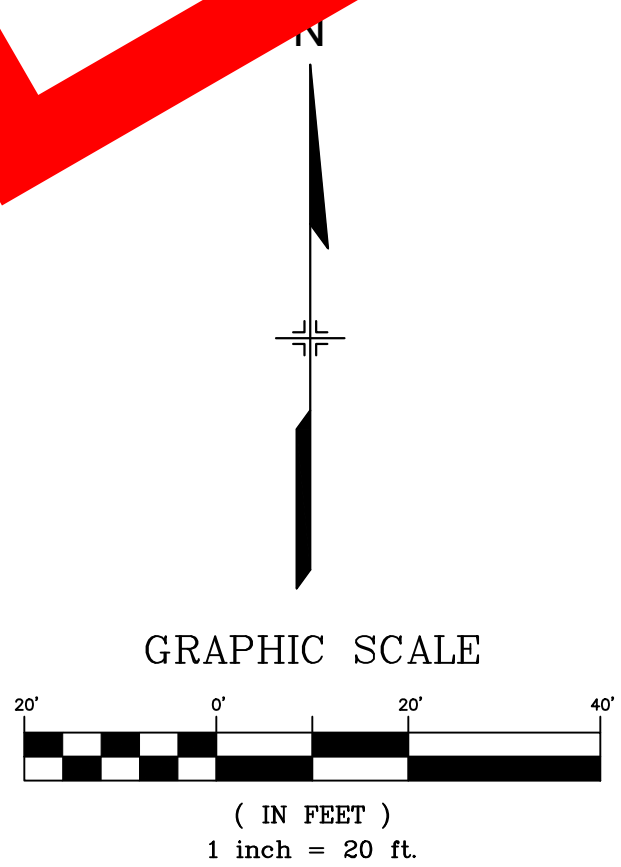
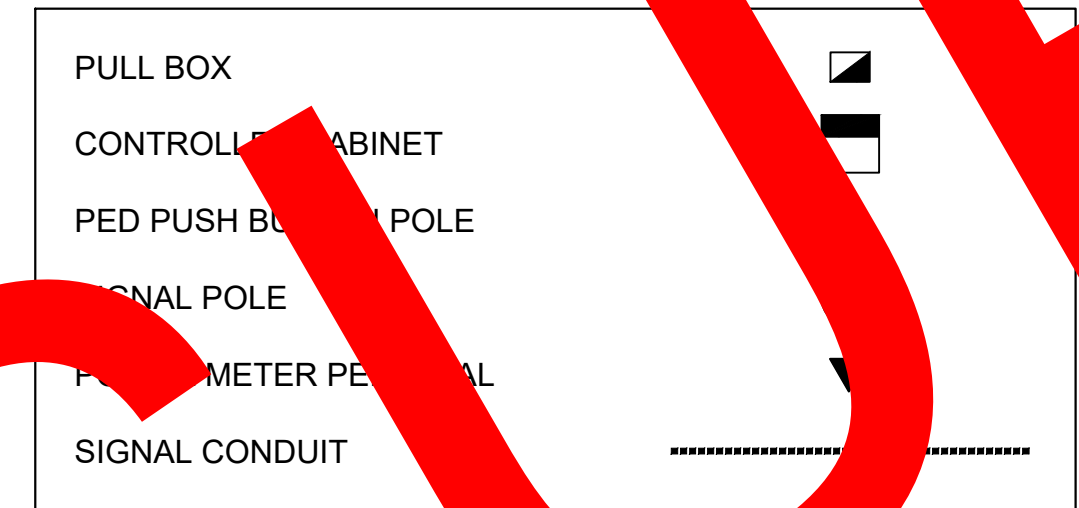

No.	DATE	DESCRIPTION	BY
COMPUTER FILE MANAGEMENT			
FILE NAME: S:\24.1129.026 Lorson Ranch Commercial North\500 CADD\504 Plan Sets\Construction Plans\Signal\SG01.dwg			
CTB FILE: Matrix(black).ctb			
PLOT DATE: November 4, 2024 1:56:28 PM			
THIS DRAWING IS CURRENT AS OF PLOT DATE AND MAY BE SUBJECT TO CHANGE.			

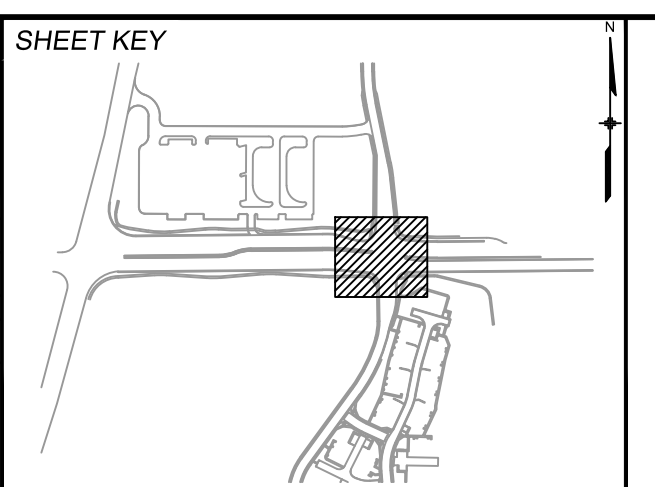

PREPARED FOR:

PREPARED BY:

SEAL

FOR AND ON BEHALF OF  
MATRIX DESIGN GROUP, INC.  
PROJECT No. 24.1129.026

**LORSON RANCH COMMERCIAL NORTH**

CARRIAGE MEADOWS DRIVE/FONTAINE BOULEVARD  
TRAFFIC SIGNAL & SIGNING PLAN

**SIGNAL POLE & CONDUIT PLAN**

DESIGNED BY: TJC	SCALE: HORIZ 1"=20'	DATE ISSUED: NOVEMBER 2024	DRAWING No. SG01
CHECKED BY: SDB	VERT. N/A	SHEET 3 OF 5	

SUPERSEDED



Know what's below.  
Call before you dig.

### TABULATION OF SIGNAL QUANTITIES

ITEM NO.	ITEM DESCRIPTION	UNIT	QUANTITY
814-03036	DRILLED SIGNAL POLE FOUNDATION (36 INCH)	LF	25
814-03042	DRILLED SIGNAL POLE FOUNDATION (42 INCH)	LF	28
813-00201	2 INCH CONDUIT (TRAFFIC)	LF	540
813-00301	3 INCH CONDUIT (TRAFFIC)	LF	1030
813-07012	PULL BOX (30"x17"x18")	EA	6
813-07013	PULL BOX (36"x24"x18")	EA	2
814-80009	TRAFFIC SIGNAL LUMINAIRE	EA	4
813-08001	TRAFFIC SIGNAL METER PEDESTAL	EA	1
814-10130	ILLUMINATED STREET NAME SIGN	EA	4
814-75215	PEDESTRIAN SIGNAL FACE (16) (COUNTDOWN)	EA	8
814-70336	TRAFFIC SIGNAL FACE (12-12-12)	EA	11
814-70460	TRAFFIC SIGNAL FACE (12-12-12-12)	EA	2
814-72860	PEDESTRIAN PUSH BUTTON	EA	8
814-72897	INTERSECTION DETECTION SYSTEM (RADAR)	EA	4
814-84440	TRAFFIC SIGNAL PEDESTAL POLE	EA	4
814-81040	TRAFFIC SIGNAL POLE (1 MAST ARM) (40 FT MAST ARM)	EA	1
814-81045	TRAFFIC SIGNAL POLE (1 MAST ARM) (45 FT MAST ARM)	EA	1
814-81055	TRAFFIC SIGNAL POLE (1 MAST ARM) (55 FT MAST ARM)	EA	1
814-81060	TRAFFIC SIGNAL POLE (1 MAST ARM) (60 FT MAST ARM)	EA	1
814-75847	TRAFFIC SIGNAL CONTROLLER AND CABINET (COMPLETE)	EA	1

**NOTE:**

TRAFFIC SIGNAL FACE (12-12-12) SHALL INCLUDE VISORS AND ALL MOUNTING HARDWARE REQUIRED TO INSTALL.

### SIGNAL POLE SCHEDULE

POLE NUMBER	A	B	C	D
LOCATION	NW CORNER	NE CORNER	SE CORNER	SW CORNER
NORTHING	22705.83	22716.70	22567.24	22548.49
EASTING	21017.00	21115.25	21151.17	21035.59
CAISSON ELEV*	5708.44	5709.32	5710.30	5709.00
MAST ARM LENGTH (FT)	45	55	40	60
BASE DIA. (IN)	36	42	36	42
CAISSON LENGTH (FT)	14	14	11	14

**NOTES:**

• CONTRACTOR TO VERIFY ALL ELEVATIONS PRIOR TO CONSTRUCTION.

### PROPOSED SIGNAL EQUIPMENT LEGEND

PULL BOX	
CONTROLLER CABINET	
PED PUSH BUTTON POLE	
SIGNAL POLE	
POWER METER PEDESTAL	
SIGNAL CONDUIT	

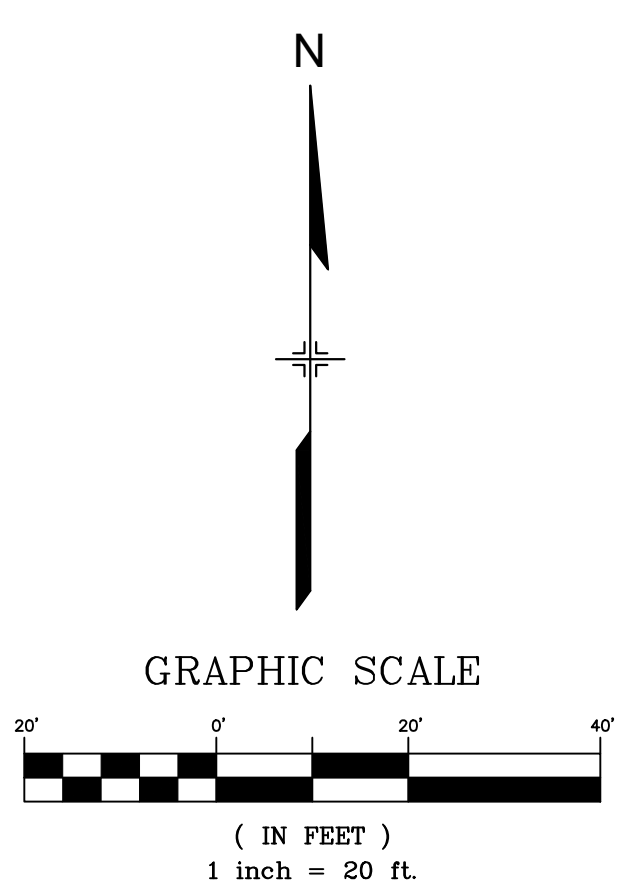
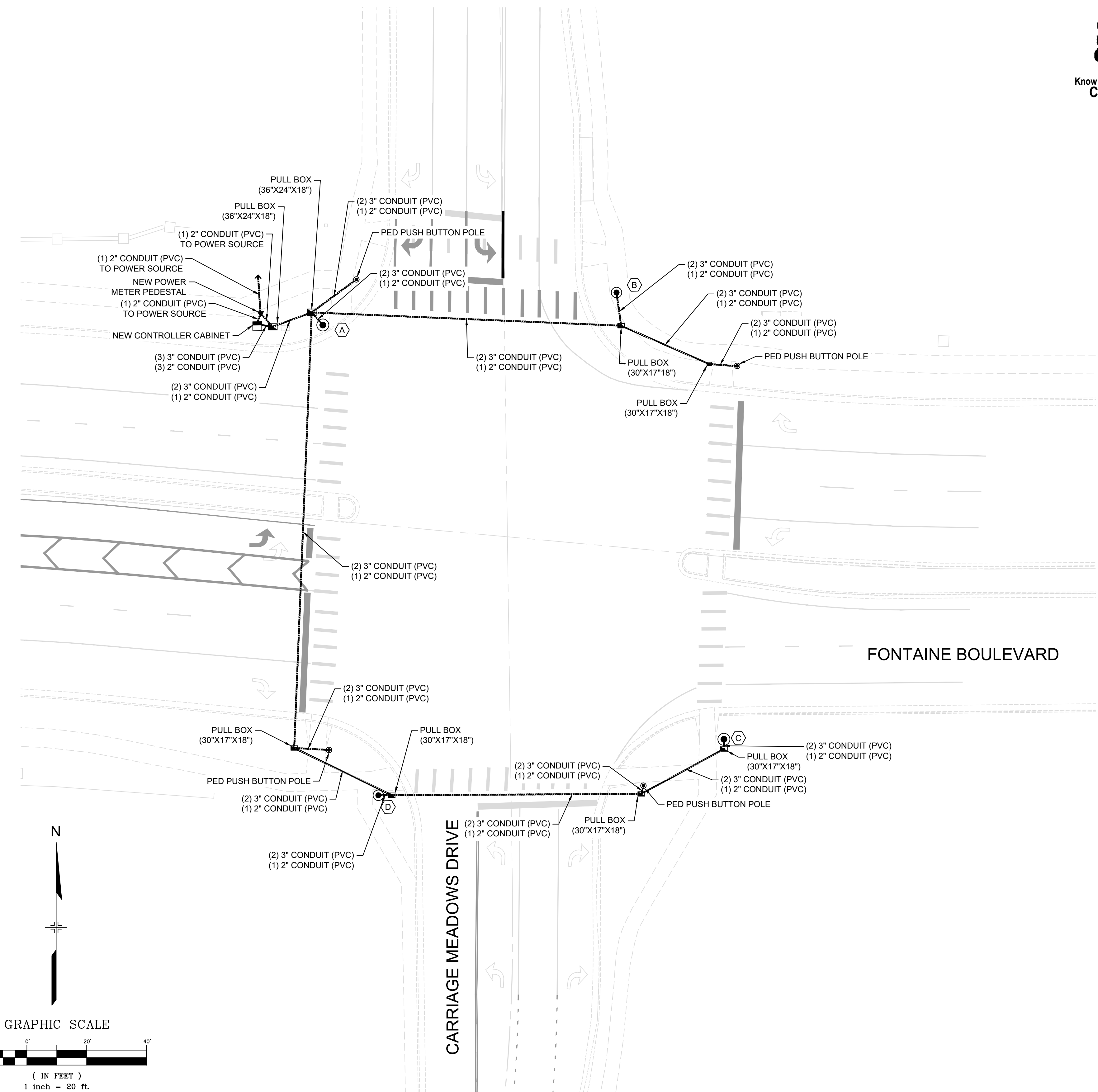

REFERENCE DRAWINGS	NO.	DATE	DESCRIPTION	TJC BY
X-MDG22x34 CD's X-1129-026-PR-SIGNAL 100-0709ps 100-0709px X-1129-025-EX-BASE	1	DEC 2024	REMOVED SIGNAL HEADS, CHANGED LEFT TURN SIGNAL HEAD & PHASING, SHIFTED SIGNAL HEADS TO ALIGN WITH CORRECT LANES	TJC
<b>COMPUTER FILE MANAGEMENT</b>				
FILE NAME: S:\24.1129.026 Lorson Ranch Commercial North\500 CADD\504 Plan Sets\Construction Plans\Signal\SG01_R1.dwg				
CTB FILE: Matrix(black).ctb				
PLOT DATE: December 11, 2024 11:11:04 AM				
THIS DRAWING IS CURRENT AS OF PLOT DATE AND MAY BE SUBJECT TO CHANGE.				

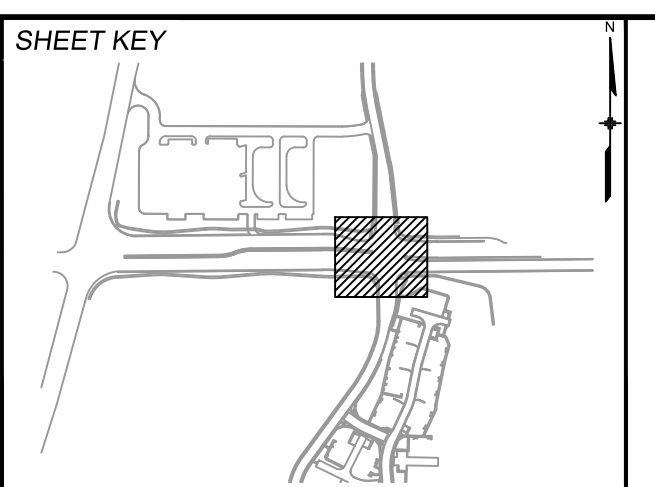

PREPARED FOR:	SCALE:
Matrix Excellence by Design	1" = 20'

FOR AND ON BEHALF OF  
  
 PROJECT No. 24.1129.026

LORSON RANCH COMMERCIAL NORTH			
CARRIAGE MEADOWS DRIVE/FONTAINE BOULEVARD TRAFFIC SIGNAL & SIGNING PLAN			
SIGNAL POLE & CONDUIT PLAN			
DESIGNED BY: TJC	SCALE: 1" = 20'	DATE ISSUED: NOVEMBER 2024	DRAWING No. SG01_R1
CHECKED BY: SDB	VERT. N/A	SHEET 3 OF 5	

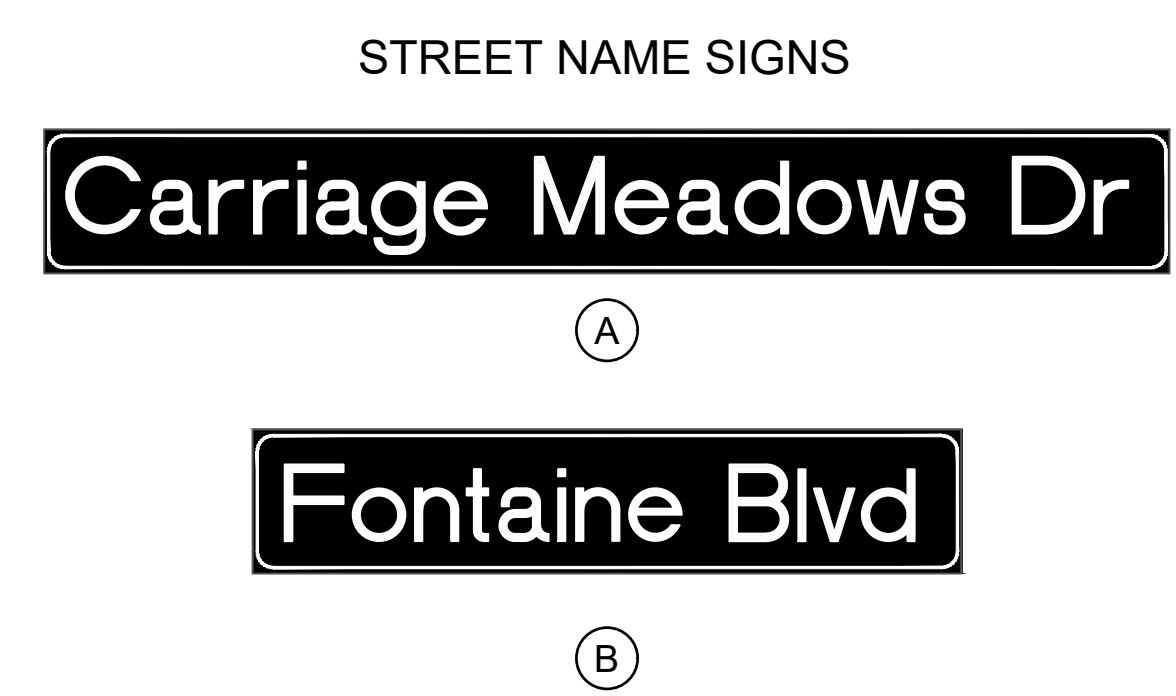
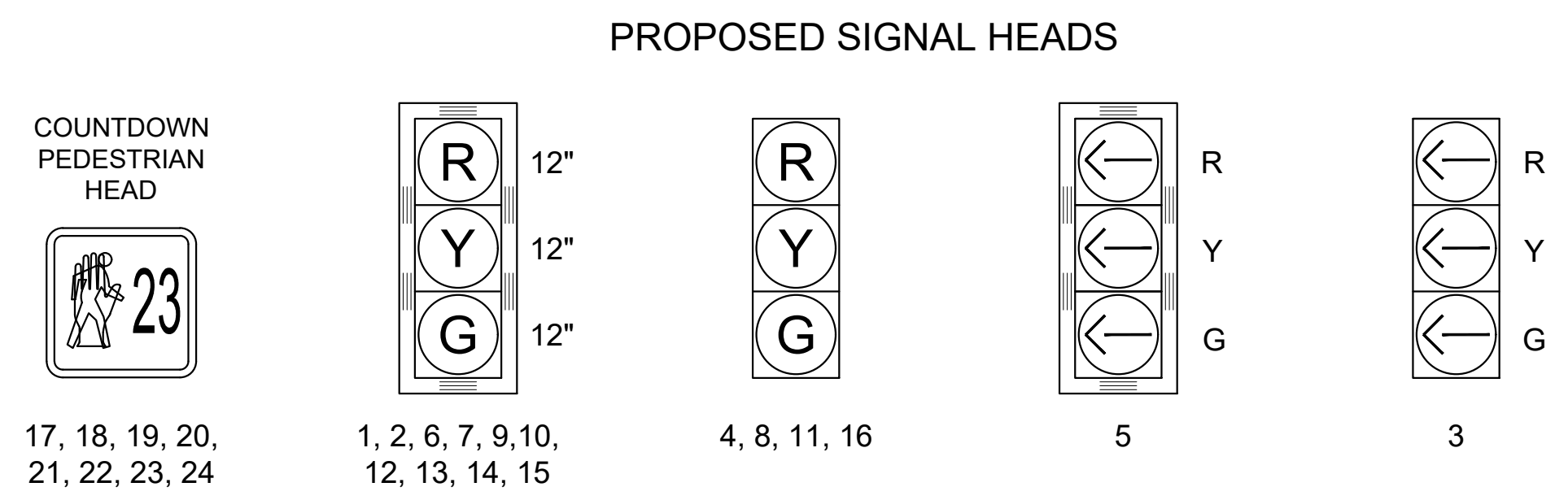

- NOTES:**
- SERIES E(M) ALPHABET SHALL BE USED WITH 12-INCH INITIAL UPPER-CASE LETTERS WITH 9" SUBSEQUENT LOWER-CASE LETTERS.
  - WHITE TEXT ON GREEN BACKGROUND SHALL BE USED.
  - SHOP DRAWINGS SHALL BE APPROVED BY THE ENGINEER PRIOR TO INSTALLATION.

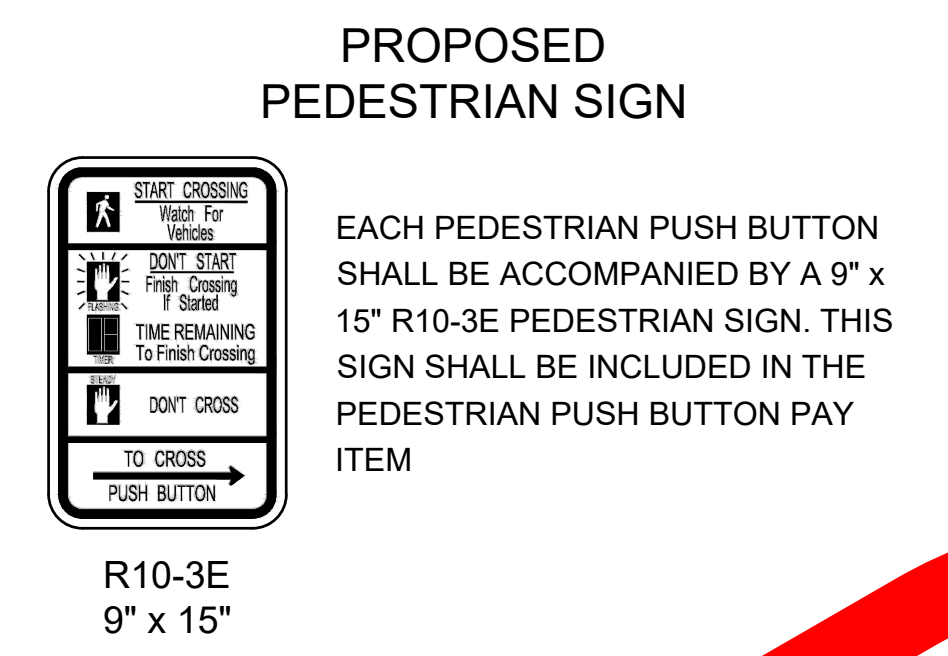

**SIGNAL EQUIPMENT LEGEND**

PEDESTRIAN SIGNAL HEAD	
TRAFFIC SIGNAL HEAD W/ BACKLASH	
TRAFFIC SIGNAL HEAD W/O BACKLASH	
LUMINAIRE	
PED PUSH BUTTON POLE	
SIGNAL POLE	
PEDESTRIAN PUSH BUTTON AND SIGN	
RADAR DETECTOR	
PAVED STREET	

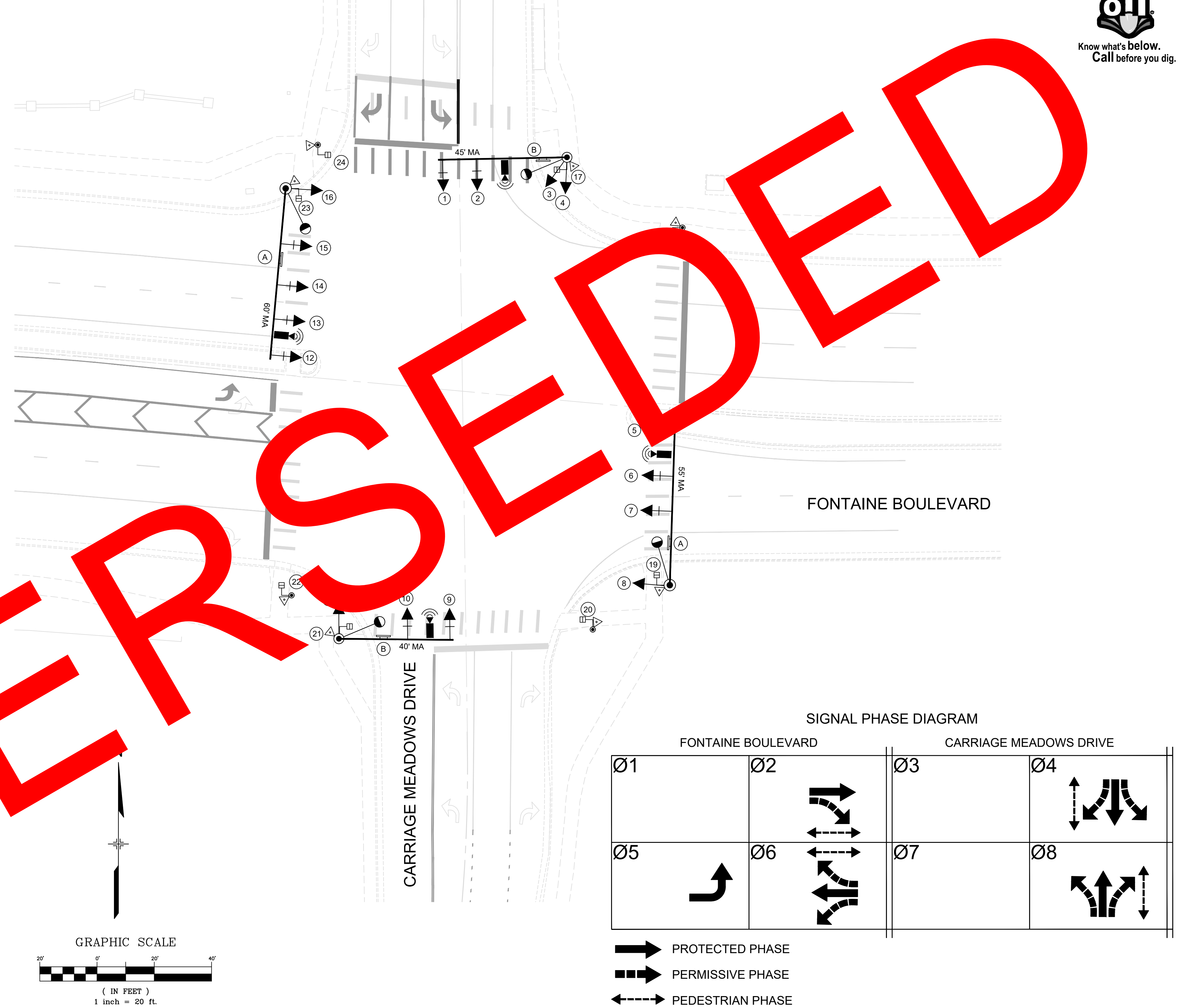

SUPERSEDED

<p><b>REFERENCE DRAWINGS</b></p> <p>X-MDG22x34 CD's X-1129.026-PR-SIGNAL 100.070bpx 100.070cpx X-1129.025-EX-BASE</p>	<table border="1" style="width: 100%; border-collapse: collapse;"> <thead> <tr> <th>No.</th> <th>DATE</th> <th>DESCRIPTION</th> <th>BY</th> </tr> </thead> <tbody> <tr> <td colspan="4" style="text-align: center;"><b>REVISIONS</b></td> </tr> </tbody> </table> <p><b>COMPUTER FILE MANAGEMENT</b></p> <p>FILE NAME: S:\24.1129.026_Lorson Ranch Commercial North\500 CADD\504 Plan Sets\Construction Plans\Signal\SG01.dwg CTB FILE: Matrix(black).ctb PLOT DATE: November 4, 2024 1:56:28 PM THIS DRAWING IS CURRENT AS OF PLOT DATE AND MAY BE SUBJECT TO CHANGE.</p>	No.	DATE	DESCRIPTION	BY	<b>REVISIONS</b>				<p><b>SHEET KEY</b></p>	<p><b>PREPARED FOR:</b></p> <p><b>PREPARED BY:</b></p> <p></p>	<p><b>SEAL</b></p> <p>11/04/2024</p> <p>FOR AND ON BEHALF OF MATRIX DESIGN GROUP, INC. PROJECT No. 24.1129.026</p>	<p style="text-align: center;"><b>LORSON RANCH COMMERCIAL NORTH</b></p> <p style="text-align: center;">CARRIAGE MEADOWS DRIVE/FONTAINE BOULEVARD TRAFFIC SIGNAL &amp; SIGNING PLAN</p> <p style="text-align: center;"><b>TRAFFIC SIGNAL PLAN</b></p> <table border="1" style="width: 100%; border-collapse: collapse;"> <tr> <td>DESIGNED BY: TJC</td> <td>SCALE: HORIZ 1"=20'</td> <td>DATE ISSUED: NOVEMBER 2024</td> <td>DRAWING No. SG02</td> </tr> <tr> <td>CHECKED BY: AFD</td> <td>VERT. N/A</td> <td>SHEET 4 OF 5</td> <td></td> </tr> </table>	DESIGNED BY: TJC	SCALE: HORIZ 1"=20'	DATE ISSUED: NOVEMBER 2024	DRAWING No. SG02	CHECKED BY: AFD	VERT. N/A	SHEET 4 OF 5	
No.	DATE	DESCRIPTION	BY																		
<b>REVISIONS</b>																					
DESIGNED BY: TJC	SCALE: HORIZ 1"=20'	DATE ISSUED: NOVEMBER 2024	DRAWING No. SG02																		
CHECKED BY: AFD	VERT. N/A	SHEET 4 OF 5																			

COUNTDOWN PEDESTRIAN HEAD



17, 18, 19, 20,  
21, 22, 23, 24

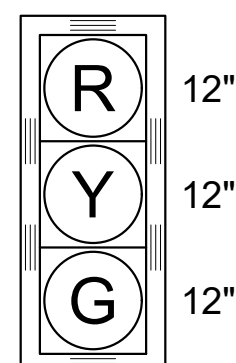

1, 2, 7, 9, 10,  
13, 14, 15

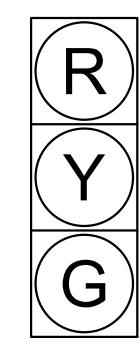

4, 8, 11, 16

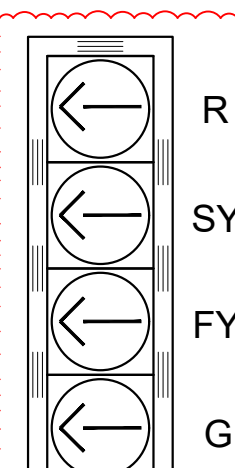

5

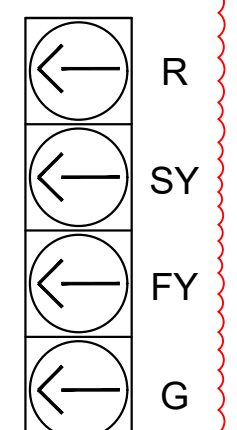

3

STREET NAME SIGNS

**Carriage Meadows Dr**

(A)

**Fontaine Blvd**

(B)

**NOTES:**

- SERIES E(M) ALPHABET SHALL BE USED WITH 12-INCH INITIAL UPPER-CASE LETTERS WITH 9" SUBSEQUENT LOWER-CASE LETTERS.
- WHITE TEXT ON GREEN BACKGROUND SHALL BE USED.
- SHOP DRAWINGS SHALL BE APPROVED BY THE ENGINEER PRIOR TO INSTALLATION.

**PROPOSED PEDESTRIAN SIGN**

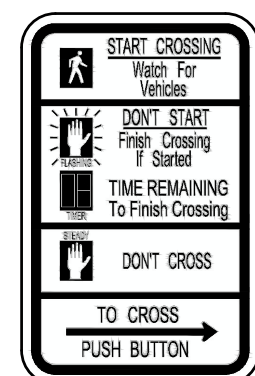

R10-3E  
9" x 15"

EACH PEDESTRIAN PUSH BUTTON SHALL BE ACCOMPANIED BY A 9" x 15" R10-3E PEDESTRIAN SIGN. THIS SIGN SHALL BE INCLUDED IN THE PEDESTRIAN PUSH BUTTON PAY ITEM

**SIGNAL EQUIPMENT LEGEND**

PEDESTRIAN SIGNAL HEAD	
TRAFFIC SIGNAL HEAD W/ BACKPLATE	
TRAFFIC SIGNAL HEAD W/O BACKPLATE	
LUMINAIRE	
PED PUSH BUTTON POLE	
SIGNAL POLE	
PEDESTRIAN PUSH BUTTON AND SIGN	
RADAR DETECTION	
ILLUMINATED STREET NAME SIGN	



GRAPHIC SCALE

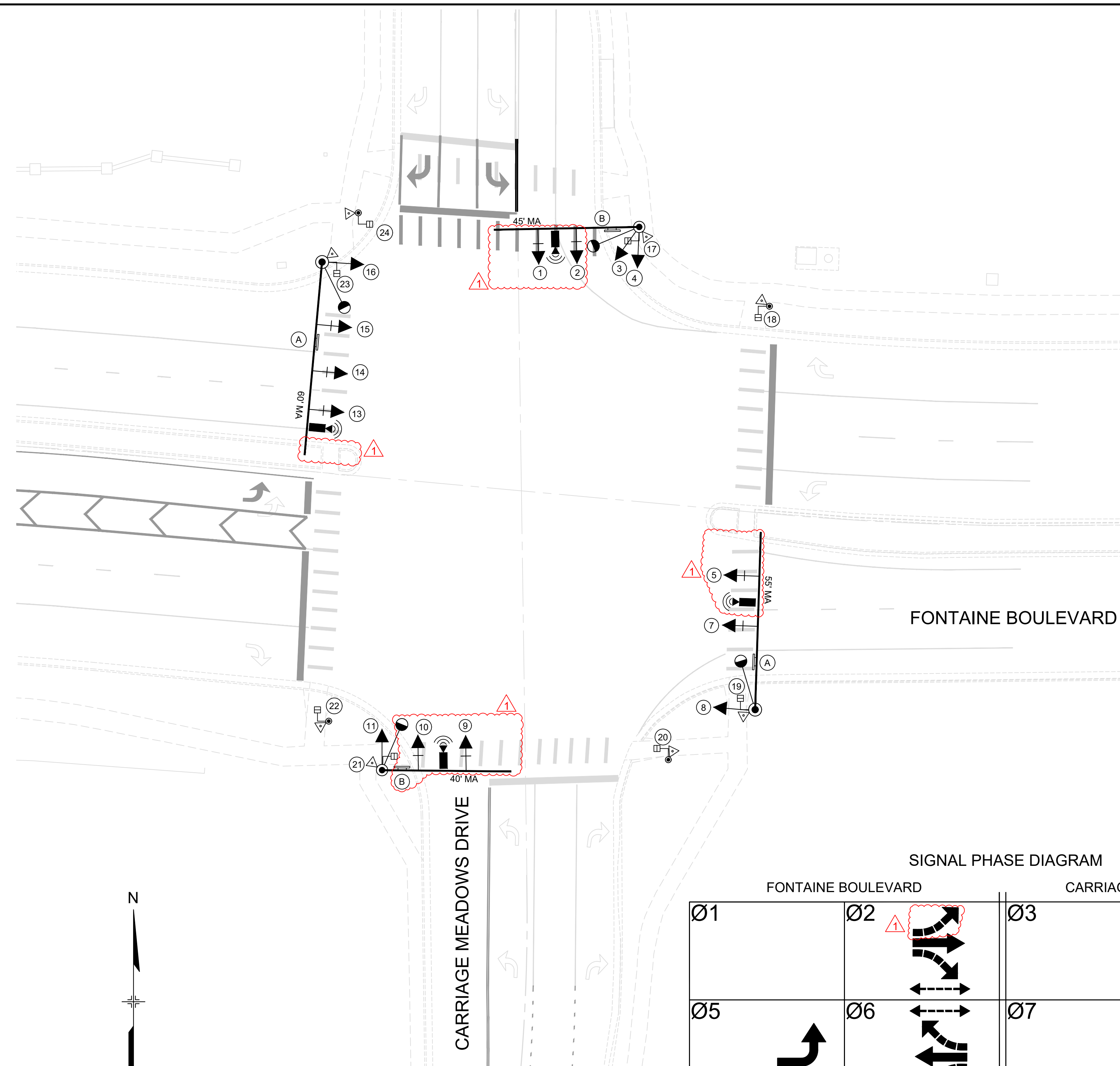
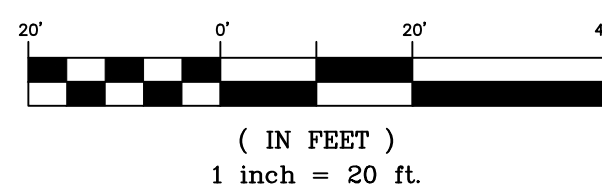

**SIGNAL PHASE DIAGRAM**

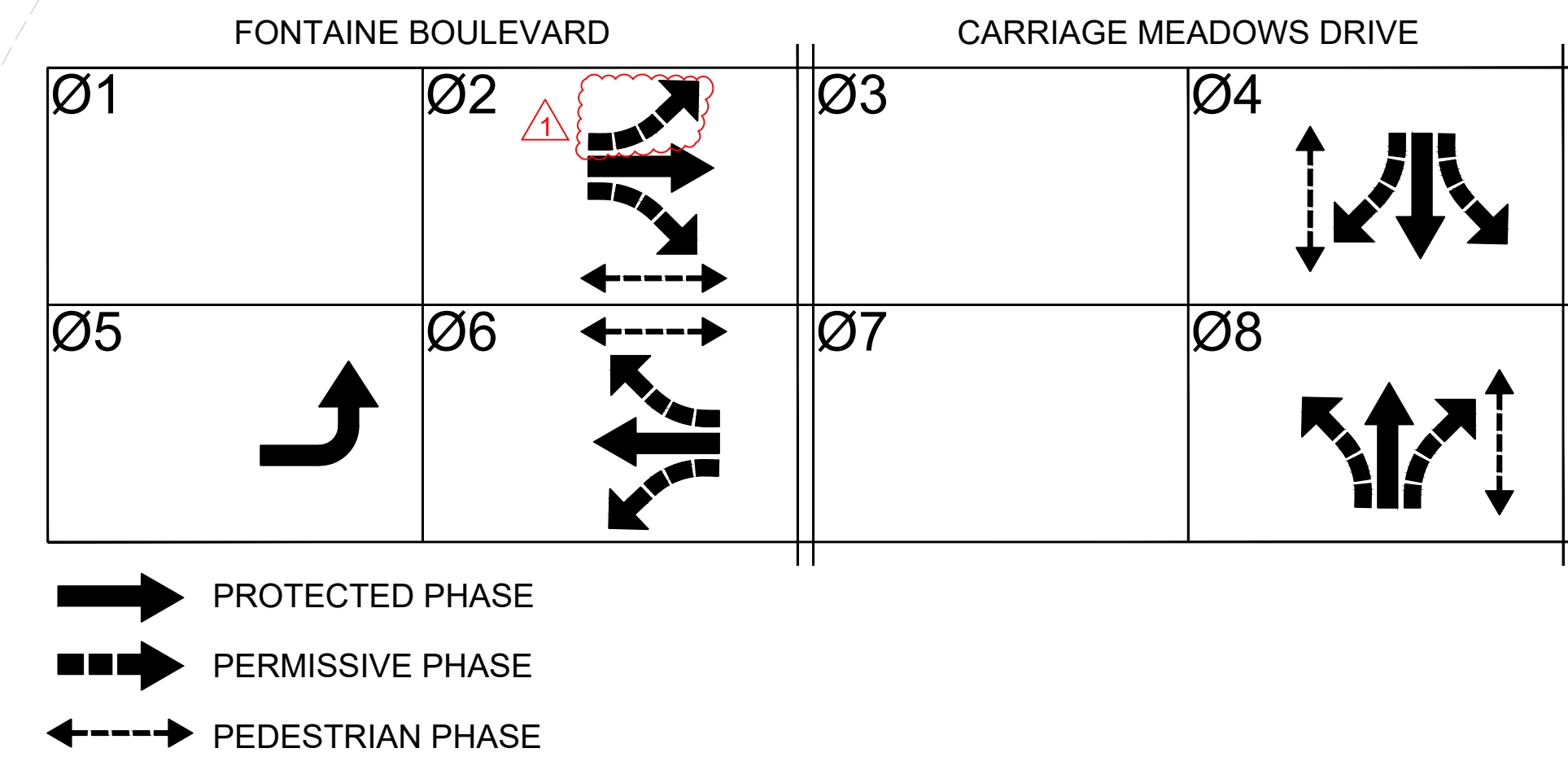

REFERENCE DRAWINGS	NO.	DATE	DESCRIPTION	TJC BY
X-MDG22x34 CD's X-1129.026-PR-SIGNAL 100.0709ps 100.0709ps X-1129.025-EX-BASE	1	DEC 2024	REMOVED SIGNAL HEADS, CHANGED LEFT TURN SIGNAL HEAD & PHASING, SHIFTED SIGNAL HEADS TO ALIGN WITH CORRECT LANES	TJC
<b>COMPUTER FILE MANAGEMENT</b>				
FILE NAME: S:\24.1129.026_Lorson Ranch Commercial North\500 CADD\504 Plan Sets\Construction Plans\Signal\SG01_R1.dwg				
CTB FILE: Matrix(black).ctb				
PLOT DATE: December 11, 2024 11:11:06 AM				
THIS DRAWING IS CURRENT AS OF PLOT DATE AND MAY BE SUBJECT TO CHANGE.				

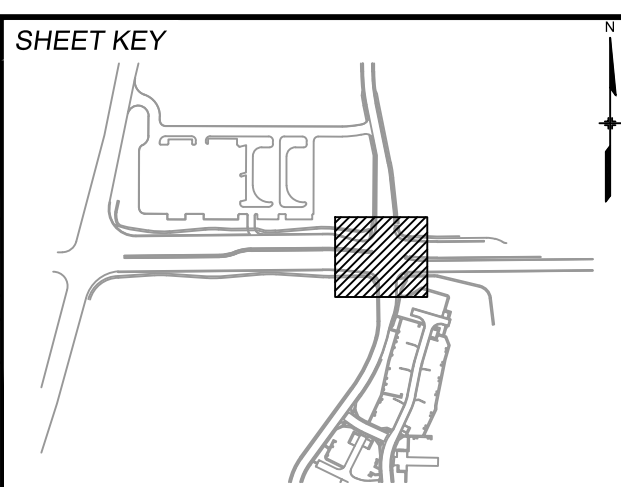

PREPARED FOR:

PREPARED BY:

**Matrix**  
Excellence by Design

SEAL

FOR AND ON BEHALF OF  
MATRIX DESIGN GROUP, INC.  
PROJECT No. 24.1129.026

**LORSON RANCH COMMERCIAL NORTH**

CARRIAGE MEADOWS DRIVE/FONTAINE BOULEVARD  
TRAFFIC SIGNAL & SIGNING PLAN

**TRAFFIC SIGNAL PLAN**

DESIGNED BY: TJC	SCALE: HORIZ 1"=20'	DATE ISSUED: NOVEMBER 2024	DRAWING No. SG02_R1
CHECKED BY: SDB	VERT. N/A	SHEET 4 OF 5	

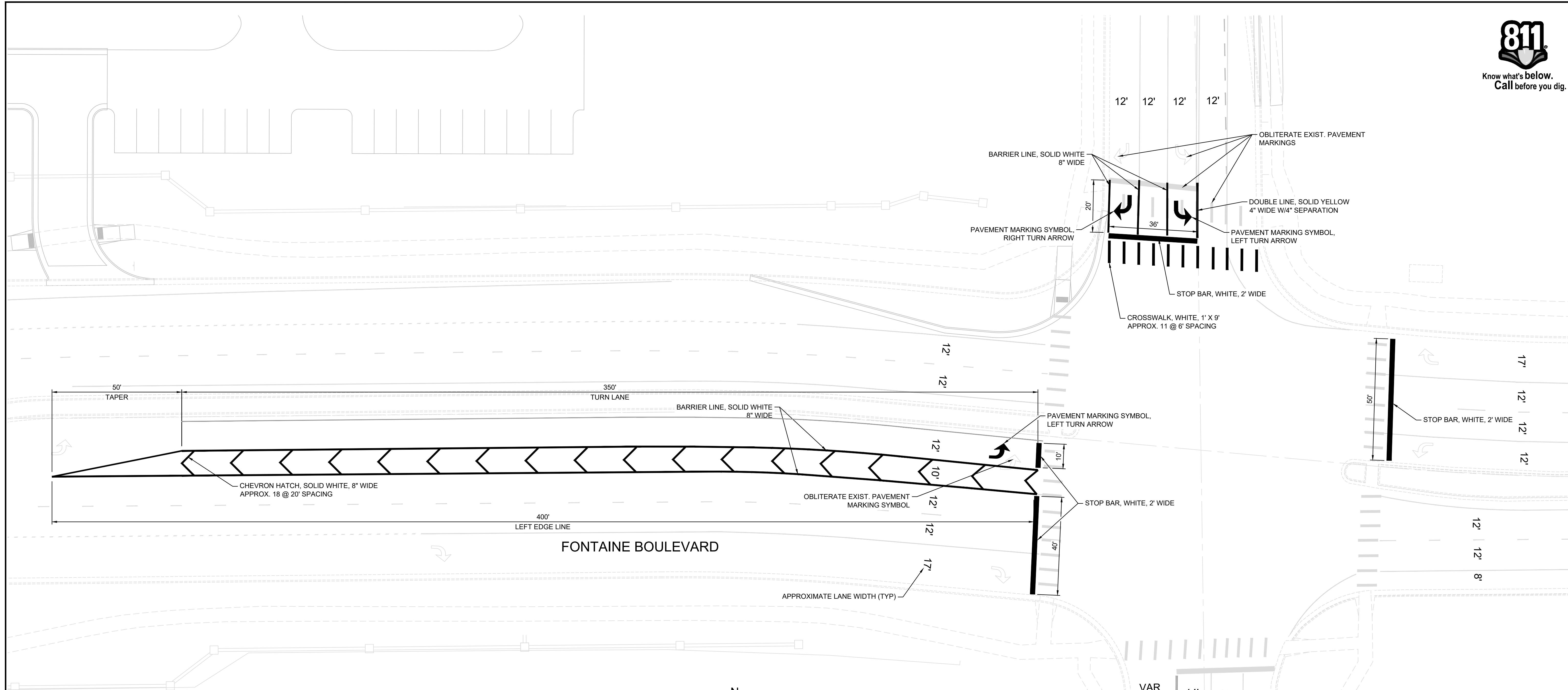

TABULATION OF STRIPING QUANTITIES

ITEM NO.	ITEM DESCRIPTION	UNIT	QUANTITY
627-00002	THERMOPLASTIC PAVEMENT MARKING	SF	595
627-00004	EPOXY PAVEMENT MARKING	SF	590

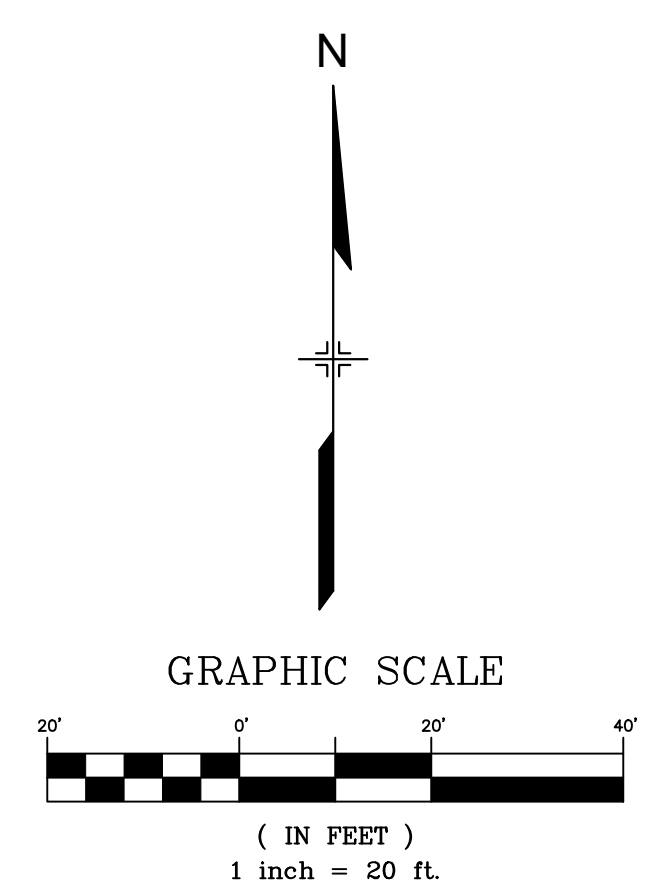

No.	DATE	DESCRIPTION	BY
REVISIONS			

COMPUTER FILE MANAGEMENT

FILE NAME: S:\24.1129.026 Lorson Ranch Commercial North\500 CADD\504 Plan Sets\Construction Plans\Signal\SN01.dwg  
 CTB FILE: Matrix(black).ctb  
 PLOT DATE: November 4, 2024 1:56:29 PM  
 THIS DRAWING IS CURRENT AS OF PLOT DATE AND MAY BE SUBJECT TO CHANGE.

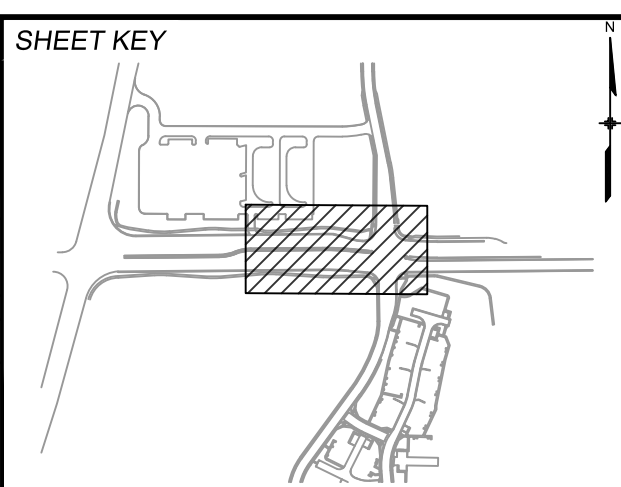

PREPARED BY:

FOR AND ON BEHALF OF  
**Matrix**  
 Excellence by Design

SEAL



11/04/2024

FOR AND ON BEHALF OF  
 MATRIX DESIGN GROUP, INC.  
 PROJECT No. 24.1129.026

**LORSON RANCH COMMERCIAL NORTH**

CARRIAGE MEADOWS DRIVE/FONTAINE BOULEVARD  
 TRAFFIC SIGNAL & SIGNING PLAN

**SIGNING & STRIPING PLAN**

DESIGNED BY: TJC	SCALE: HORIZ 1" = 20'	DATE ISSUED: NOVEMBER 2024	DRAWING No. SN01
CHECKED BY: AFD	VERT. N/A	SHEET 5 OF 5	