

# LORSON RANCH COMMERCIAL NORTH



| INDEX OF SHEETS |                            | SHEET No. |
|-----------------|----------------------------|-----------|
| TS01            | TITLE SHEET                | 1         |
| GN01            | GENERAL NOTES              | 2         |
| SG01            | SIGNAL POLE & CONDUIT PLAN | 3         |
| SG02            | TRAFFIC SIGNAL PLAN        | 4         |
| SN01            | SIGNING & STRIPING PLAN    | 5         |

## EL PASO COUNTY TRAFFIC SIGNAL & SIGNING PLAN PCD FILE NUMBER SF248

### CONTACT LIST

**OWNER/DEVELOPER**  
THE LANDHUIS COMPANY  
212 N. WAHSATCH AVENUE, SUITE 301  
COLORADO SPRINGS, CO 80903  
JEFF MARK  
(719) 635-3200

**CIVIL ENGINEER**  
MATRIX DESIGN GROUP  
2435 RESEARCH PARKWAY, SUITE 300  
COLORADO SPRINGS, CO 80920  
SCOTT D. BARNHART, P.E.  
(719) 575-0100

**WATER/SANITARY SERVICES**  
WIDEFILED WATER AND SANITATION DISTRICT  
8495 FONTAINE BOULEVARD  
COLORADO SPRINGS, CO 80925  
ROBERT BANNISTER, (719) 390-7111

**ELECTRIC SERVICES**  
MOUNTAINVIEW ELECTRIC ASSOCIATION  
(719) 495-2283

**GAS SERVICES**  
BLACK HILLS ENERGY  
105 S VICTORIA AVENUE  
PUEBLO, CO 80817  
(800) 303-0752

**ENGINEERING**  
EL PASO COUNTY PUBLIC WORKS DEPARTMENT  
3275 AKERS DRIVE  
COLORADO SPRINGS, CO 80922  
(719) 520-6460

**FIRE DEPARTMENT**  
COLORADO SPRINGS FIRE DEPARTMENT  
375 PRINTERS PARKWAY  
COLORADO SPRINGS, CO 80910  
(719) 444-7000



VICINITY MAP  
N.T.S.



SITE MAP  
N.T.S.

### ENGINEER'S STATEMENT

THESE DETAILED PLANS AND SPECIFICATIONS WERE PREPARED UNDER MY DIRECTION AND SUPERVISION. SAID DETAILED PLANS AND SPECIFICATIONS HAVE BEEN PREPARED ACCORDING TO THE CRITERION ESTABLISHED BY THE COUNTY FOR DETAILED DRAINAGE PLANS AND SPECIFICATIONS, AND SAID DETAILED PLANS AND SPECIFICATIONS ARE IN CONFORMITY WITH THE MASTER PLAN OF THE DRAINAGE BASIN. SAID DETAILED DRAINAGE PLANS AND SPECIFICATIONS MEET THE PURPOSE FOR WHICH THE PARTICULAR DRAINAGE FACILITY(S) IS DESIGNED. I ACCEPT RESPONSIBILITY FOR ANY LIABILITY CAUSED BY ANY NEGLIGENT ACTS, ERRORS OR OMISSIONS ON MY PART IN PREPARATION OF THE DETAILED DRAINAGE PLANS AND SPECIFICATIONS.

BY: *Scott D. Barnhart* DATE: November 4, 2024  
SCOTT BARNHART, P.E. #37447  
FOR AND ON BEHALF OF MATRIX DESIGN GROUP, INC.

### OWNER/DEVELOPER:

I, THE OWNER/DEVELOPER HAVE READ AND WILL COMPLY WITH THE REQUIREMENTS OF THE GRADING AND EROSION CONTROL PLANS AND ALL OF THE REQUIREMENTS SPECIFIED IN THESE DETAILED PLANS AND SPECIFICATIONS

*Jeff Mark* 11/13/24  
DATE  
JEFF MARK  
PROJECT MANAGER  
THE LANDHUIS COMPANY  
212 N WAHSATCH AVENUE, SUITE 301  
COLORADO SPRINGS, CO 80903

### EL PASO COUNTY:

COUNTY PLAN REVIEW IS PROVIDED ONLY FOR GENERAL CONFORMANCE WITH COUNTY DESIGN CRITERIA. THE COUNTY IS NOT RESPONSIBLE FOR THE ACCURACY AND ADEQUACY OF THE DESIGN, DIMENSIONS, AND/OR ELEVATIONS WHICH SHALL BE CONFIRMED AT THE JOB SITE. THE COUNTY THROUGH THE APPROVAL OF THIS DOCUMENT ASSUMES NO RESPONSIBILITY FOR COMPLETENESS AND/OR ACCURACY OF THIS DOCUMENT.

FILES IN ACCORDANCE WITH THE REQUIREMENTS OF THE EL PASO COUNTY LAND DEVELOPMENT CODE, DRAINAGE CRITERIA MANUAL, VOLUMES 1 AND 2, AND ENGINEERING CRITERIA MANUAL AMENDED.

IN ACCORDANCE WITH ECM SECTION 1.12, THESE CONSTRUCTION DOCUMENTS WILL BE VALID FOR CONSTRUCTION FOR A PERIOD OF 2 YEARS FROM THE DATE SIGNED BY THE EL PASO COUNTY ENGINEER. IF CONSTRUCTION HAS NOT STARTED WITHIN THOSE 2 YEARS, THE PLANS WILL NEED TO BE RESUBMITTED FOR APPROVAL, INCLUDING PAYMENT OF REVIEW FEES AT THE PLANNING AND COMMUNITY DEVELOPMENT DIRECTORS DISCRETION.

JOSHUA PALMER, P.E. 11/13/2024  
COUNTY ENGINEER/ ECM ADMINISTRATOR DATE

THE PARTIES RESPONSIBLE FOR THIS PLAN HAVE FAMILIARIZED THEMSELVES WITH ALL CURRENT ACCESSIBILITY CRITERIA AND SPECIFICATIONS AND THE PROPOSED PLAN REFLECTS ALL SITE ELEMENTS REQUIRED BY THE APPLICABLE ADA DESIGN STANDARDS AND GUIDELINES AS PUBLISHED BY THE UNITED STATES DEPARTMENT OF JUSTICE. APPROVAL OF THIS PLAN BY EL PASO COUNTY DOES NOT ASSURE COMPLIANCE WITH THE ADA OR ANY REGULATIONS OR GUIDELINES ENACTED OR PROMULGATED UNDER OR WITH RESPECT TO SUCH LAWS.

| REFERENCE DRAWINGS  | SHEET KEY | PREPARED FOR | SEAL | LORSON RANCH COMMERCIAL NORTH  |                     |                            |                  |
|---|-----------|--------------|------|--|---------------------|----------------------------|------------------|
| X:\M022\24 CD's<br>X-1123-EX-IMAGE<br>Site Map_Lorson Ranch Commercial North.dwg  |           |              |      | CARRIAGE MEADOWS DRIVE/FONTAINE BOULEVARD<br>TRAFFIC SIGNAL & SIGNING PLAN |                     |                            |                  |
|   |           | PREPARED BY: |      | TITLE SHEET  |                     |                            |                  |
|   |           |              |      | DESIGNED BY: TJC   | SCALE: 1/4" = 1'-0" | DATE ISSUED: NOVEMBER 2024 | DRAWING No. TS01 |
|   |           |              |      | CHECKED BY: SDB  | VERT. 1/4"          | SHEET 1 OF 5               |                  |
| <b>COMPUTER FILE MANAGEMENT</b><br>FILE NAME: S:\24 1129 026 Lorson Ranch Commercial North\500 CADD\504 Plan Sets\Construction Plans\Signal\TS01.dwg<br>CTB FILE: Matrix(black).ctb<br>PLOT DATE: November 4, 2024 1:56:26 PM<br>THIS DRAWING IS CURRENT AS OF PLOT DATE AND MAY BE SUBJECT TO CHANGE |           |              |      |  |                     |                            |                  |



Know what's below.  
Call before you dig.

**STANDARD NOTES FOR CONSTRUCTION:**

- ALL DRAINAGE AND ROADWAY CONSTRUCTION SHALL MEET THE STANDARDS AND SPECIFICATIONS OF THE CITY OF COLORADO SPRINGS/EL PASO COUNTY DRAINAGE CRITERIA MANUAL, VOLUMES 1 AND 2, AND THE EL PASO COUNTY ENGINEERING CRITERIA MANUAL.
- CONTRACTOR SHALL BE RESPONSIBLE FOR THE NOTIFICATION AND FIELD NOTIFICATION OF ALL EXISTING UTILITIES, WHETHER SHOWN ON THE PLANS OR NOT, BEFORE BEGINNING CONSTRUCTION. LOCATION OF EXISTING UTILITIES SHALL BE VERIFIED BY THE CONTRACTOR PRIOR TO CONSTRUCTION. CALL 811 TO CONTACT THE UTILITY NOTIFICATION CENTER OF COLORADO (UNCC).
- CONTRACTOR SHALL KEEP A COPY OF THESE APPROVED PLANS, THE GRADING AND EROSION CONTROL PLAN, THE STORMWATER MANAGEMENT PLAN (SWMP), THE SOILS AND GEOTECHNICAL REPORT, AND THE APPROPRIATE DESIGN AND CONSTRUCTION STANDARDS AND SPECIFICATIONS AT THE JOB SITE AT ALL TIMES, INCLUDING THE FOLLOWING:
  - EL PASO COUNTY ENGINEERING CRITERIA MANUAL (ECM)
  - CITY OF COLORADO SPRINGS/EL PASO COUNTY DRAINAGE CRITERIA MANUAL, VOLUMES 1 & 2
  - COLORADO DEPARTMENT OF TRANSPORTATION (CDOT) STANDARD SPECIFICATIONS FOR ROAD AND BRIDGE CONSTRUCTION
  - CDOT M & S STANDARDS
- NOT WITHSTANDING ANYTHING DEPICTED IN THESE PLANS IN WORDS OR GRAPHIC REPRESENTATION, ALL DESIGN AND CONSTRUCTION RELATED TO ROADS, STORM DRAINAGE AND EROSION CONTROL SHALL CONFORM TO THE STANDARDS AND REQUIREMENTS OF THE MOST RECENT VERSION OF THE RELEVANT ADOPTED EL PASO COUNTY STANDARDS, INCLUDING THE LAND DEVELOPMENT CODE, THE ENGINEERING CRITERIA MANUAL, THE DRAINAGE CRITERIA MANUAL, AND THE DRAINAGE CRITERIA MANUAL VOLUME 2. ANY DEVIATIONS FROM REGULATIONS AND STANDARDS MUST BE REQUESTED, AND APPROVED, IN WRITING. ANY MODIFICATIONS NECESSARY TO MEET CRITERIA AFTER-THE-FACT WILL BE ENTIRELY THE DEVELOPER'S RESPONSIBILITY TO RECTIFY.
- IT IS THE DESIGN ENGINEER'S RESPONSIBILITY TO ACCURATELY SHOW EXISTING CONDITIONS, BOTH ONSITE AND OFFSITE, ON THE CONSTRUCTION PLANS. ANY MODIFICATIONS NECESSARY DUE TO CONFLICTS, OMISSIONS, OR CHANGED CONDITIONS WILL BE ENTIRELY THE DEVELOPER'S RESPONSIBILITY TO RECTIFY.
- CONTRACTOR SHALL SCHEDULE A PRE-CONSTRUCTION MEETING WITH EL PASO COUNTY PLANNING AND COMMUNITY DEVELOPMENT (PCD)- INSPECTIONS, PRIOR TO STARTING CONSTRUCTION.
- IT IS THE CONTRACTOR'S RESPONSIBILITY TO UNDERSTAND THE REQUIREMENTS OF ALL JURISDICTIONAL AGENCIES AND TO OBTAIN ALL REQUIRED PERMITS, INCLUDING BUT NOT LIMITED TO EL PASO COUNTY EROSION AND STORMWATER QUALITY CONTROL PERMIT (WSQCP), REGIONAL BUILDING FLOODPLAIN DEVELOPMENT PERMIT, U.S. ARMY CORPS OF ENGINEERS-ISSUED 401 AND/OR 404 PERMITS, AND COUNTY AND STATE FUGITIVE DUST PERMITS.
- CONTRACTOR SHALL NOT DEVIATE FROM THE PLANS WITHOUT FIRST OBTAINING WRITTEN APPROVAL FROM THE DESIGN ENGINEER AND PCD. CONTRACTOR SHALL NOTIFY THE DESIGN ENGINEER IMMEDIATELY UPON DISCOVERY OF ANY ERRORS OR INCONSISTENCIES.
- ALL STORM DRAIN PIPE SHALL BE CLASS III RCP UNLESS OTHERWISE NOTED AND APPROVED BY PCD.
- CONTRACTOR SHALL COORDINATE GEOTECHNICAL TESTING PER ECM STANDARDS. PAVEMENT DESIGN SHALL BE APPROVED BY EL PASO COUNTY PCD PRIOR TO PLACEMENT OF CURB AND GUTTER AND PAVEMENT.
- ALL CONSTRUCTION TRAFFIC MUST ENTER/EXIT THE SITE AT APPROVED CONSTRUCTION ACCESS POINTS.
- SIGHT VISIBILITY TRIANGLES AS IDENTIFIED IN THE PLANS SHALL BE PROVIDED AT ALL INTERSECTIONS. OBSTRUCTIONS GREATER THAN 18 INCHES ABOVE FLOWLINE ARE NOT ALLOWED WITHIN SIGHT TRIANGLES.
- SIGNING AND STRIPING SHALL COMPLY WITH EL PASO COUNTY DOT AND MUTCD CRITERIA. [IF APPLICABLE, ADDITIONAL SIGNING AND STRIPING NOTES WILL BE PROVIDED.]
- CONTRACTOR SHALL OBTAIN ANY PERMITS REQUIRED BY EL PASO COUNTY DOT, INCLUDING WORK WITHIN THE RIGHT-OF-WAY AND SPECIAL TRANSPORT PERMITS.
- THE LIMITS OF CONSTRUCTION SHALL REMAIN WITHIN THE PROPERTY LINE UNLESS OTHERWISE NOTED. THE OWNER/DEVELOPER SHALL OBTAIN WRITTEN PERMISSION AND EASEMENTS, WHERE REQUIRED, FROM ADJOINING PROPERTY OWNER(S) PRIOR TO ANY OFF-SITE DISTURBANCE, GRADING, OR CONSTRUCTION.

**COLORADO SPRINGS TRAFFIC SIGNAL GENERAL NOTES:**

- CONTRACTOR SHALL HAVE A COPY OF CURRENT CITY OF COLORADO SPRINGS TRAFFIC SIGNAL INSTALLATION AND PARTS SPECIFICATION ON JOB SITE AT ALL TIMES.
- ALL WORK SHALL BE DONE IN ACCORDANCE WITH CURRENT CITY OF COLORADO SPRINGS ENGINEERING DIVISION STANDARD SPECIFICATIONS, COLORADO SPRINGS CITY TRAFFIC SIGNAL INSTALLATION AND PARTS SPECIFICATION, CITY OF COLORADO SPRINGS TRAFFIC CONTROLS FOR STREET CONSTRUCTION, UTILITY WORK, AND MAINTENANCE OPERATIONS FOR CONTRACTORS, AND MANUAL ON UNIFORM TRAFFIC CONTROL DEVICES FOR STREETS AND HIGHWAY.
- ALL MATERIALS AND WORKMANSHIP SHALL BE SUBJECT TO INSPECTION AND APPROVAL BY CITY OF COLORADO SPRINGS ENGINEERING REPRESENTATIVE OR CITY TRAFFIC ENGINEER.
- REFER TO THE "GROUNDING METHODS" SECTION 18 OF THIS MANUAL FOR INFORMATION ON HOW TO GROUND TRAFFIC SIGNAL SYSTEMS.
- ALL MATERIALS AND WORKMANSHIP SHALL BE SUBJECT TO INSPECTION AND APPROVAL BY CITY OF COLORADO SPRINGS ENGINEERING REPRESENTATIVE OR CITY TRAFFIC ENGINEER.
- THE CONTRACTOR SHALL CONTACT THE UTILITY NOTIFICATION CENTER OF COLORADO AT 811 THREE BUSINESS DAYS IN ADVANCE OF ANY EXCAVATING OR GRADING.
- THE CONTRACTOR SHALL PROTECT AND MAINTAIN UTILITIES AND STRUCTURES AFFECTED BY WORK AND ANY DAMAGE SHALL BE REPAIRED AND RESTORED THE SATISFACTION OF THE CITY OF COLORADO SPRINGS. CONTRACTOR SHALL COORDINATE WITH PROJECT MANAGER OR DESIGNEE TO RESOLVE CONFLICTS.
- CONTRACTOR SHALL LIMIT CONSTRUCTION ACTIVITIES TO THOSE AREAS WITHIN THE EXISTING RIGHT-OF-WAY AND TEMPORARY AND PERMANENT EASEMENTS SHOWN ON THE PLANS.
- THE CONTRACTOR SHALL PRESERVE ALL MONUMENTS, BENCHMARKS, RANGE TIES, AND PROPERTY MARKERS. THE CONTRACTOR SHALL BE RESPONSIBLE FOR RESETTling ALL DISTURBED SURVEY MARKERS, INCLUDING MONUMENTS, SECTION CORNERS, ALIQUOT CORNERS MARKERS, ETC.
- THE CONTRACTOR SHALL BE RESPONSIBLE FOR MAINTENANCE OF PUBLIC RIGHT-OF-WAY, INCLUDING VEHICLE TRAVELED WAY AND PEDESTRIAN PATHS, WITHIN THE PROJECT LIMITS AT ALL TIMES UNTIL ACCEPTANCE BY THE CITY.
- INSTALLATION AND MAINTENANCE OF ALL TRAFFIC DEVICES IS THE RESPONSIBILITY OF THE CONTRACTOR.
- CONSTRUCTION ACTIVITY SHALL BE SCHEDULED WITH THE MINIMUM IMPACT TO PEDESTRIAN AND VEHICLE TRAFFIC.
- THE CONTRACTOR SHALL BE RESPONSIBLE FOR MAINTENANCE OF TRAFFIC SIGNALIZATION AT EXISTING SIGNALIZED INTERSECTION SHOWN ON THE SIGNAL PLANS AT ALL TIMES FROM BEGINNING OF THE PROJECT TO ACCEPTANCE APPROVED BY THE CITY. ALL CHANGES TO THE PHYSICAL LAYOUT OF TRAFFIC SIGNAL OR SIGNAL TIMING SHALL BE APPROVED BY THE CITY BEFORE IMPLEMENTATION.
- CONTRACTOR SHALL CONTACT THE CITY TRAFFIC ENGINEERING REPRESENTATIVE FOR INSPECTION OF POLE CAISSON FROM, ANCHOR BOLTS AND CONDUIT STUB OUT 24 HOURS PRIOR TO INTENT OF POUR, AND (2-HOUR MINIMUM CONFORMATION) PRIOR TO POURING CONCRETE.
- CONDITIONAL ACCEPTANCE: ONCE CONSTRUCTION OF A TRAFFIC SIGNAL HAS BEEN SATISFACTORY COMPLETED; THE SIGNALS ARE "CONDITIONALLY ACCEPTED" BY OWNER. AT THIS TIME THE SIGNAL IS TURNED ON AND THE "BURN-IN" PERIOD BEGINS. THE BURN-IN PERIOD WILL LAST 15 DAYS. DURING THE BURN-IN PERIOD THE SIGNAL SYSTEM IS ALLOWED TO OPERATE UNDER REAL WORLD CONDITIONS. ANY MALFUNCTION ACCRUED DURING THIS PERIOD WILL REQUIRE REPAIR OR REPLACEMENT AND IN THE MALFUNCTION IS SERIOUS ENOUGH, THE BURN-IN PERIOD MUST BE RESTARTED.
- FINAL ACCEPTANCE: AFTER THE BURN-IN PERIOD IS COMPLETED, ALL PUNCH LIST ITEMS HAVE BEEN CORRECTED AND THE CONTRACTOR HAS MET ALL CONTRACT REQUIREMENTS (SUCH AS FINAL CLEANUP OF WORK SITE, AS BUILT DRAWINGS AND BORE LOGS), THE SIGNAL WILL BE ACCEPTED. THE CONTRACTOR SHALL PROVIDE A TWO-YEAR GUARANTEE ON ALL WORK PERFORMED UNDER THIS CONTRACT AFTER THE JOB HAS BEEN COMPLETED AND ACCEPTED.
- THE CONTRACTOR SHALL PROVIDE A TWO-YEAR GUARANTEE ON ALL WORK PERFORMED UNDER THIS CONTRACT AFTER THE JOB HAS BEEN COMPLETED AND ACCEPTED.
- THE CONTRACTOR SHALL PROVIDE ENGINEER WITH DAILY QUANTITIES AND TRAFFIC CONTROL DIARIES AT THE END OF WORK WEEK OR AS DIRECTED BY THE ENGINEER.
- THE CONTRACTOR SHALL SUBMIT "AS-BUILT" OR CORRECTED PLANS SHOWING, IN DETAIL, ALL CONSTRUCTION CHANGES INCLUDING BUT NOT LIMITED TO BORE LOGS, POTHOLE LOGS, WIRING, CABLE, POLES, CONTROLLER CABINET, DETECTION SYSTEM AND LOCATION OF ALL CONDUITS WITHIN 7 DAYS OF INSTALLATION.

- ALL TRAFFIC SIGNAL EQUIPMENT THAT IS REMOVED SHALL REMAIN THE PROPERTY OF THE CITY OF COLORADO SPRINGS. SUCH PROPERTY IS TO BE RETURNED BY CONTRACTOR TO 416 FONTANERO ST, CITY TRAFFIC SIGNAL CONSTRUCTION SHOP. CONTRACTOR MUST CONTACT TRAFFIC SIGNALS (719) 385-6747 TO COORDINATE DELIVERY. ALL TRAFFIC SIGNAL EQUIPMENT SHALL BE RETURNED IN THE SAME OPERATING CONDITION WHEN REMOVED. POLES WILL BE STRIPPED CLEAN OF ALL ATTACHED PARTS BEFORE DELIVERY.
- CONTRACTOR SHALL REPLACE OR RECONSTRUCT SIDEWALKS, CURBS, GUTTERS, PAVEMENT AND ANY OTHER IMPROVEMENTS REMOVED, BROKEN OR DAMAGED BY CONTRACTOR THAT WERE NOT DESIGNATED FOR REMOVAL IN THE PROJECT. MUST MEET CITY ENGINEERING SPECIFICATIONS AND INSPECTIONS PRACTICES.
- SIGNAL HEADS SHALL NOT BE INSTALLED IF LONG DELAY IS EXPECTED FOR TURNING SIGNAL ACTIVE. DURING ANY PERIOD SIGNAL HEAD OR HEADS ARE NOT ACTIVE SHALL BE BAGGED WITH TRAFFIC SIGNAL HEAD COVERS & MARKED WITH LEGIBLE "OUT OF SERVICE" MARKINGS.
- ACCEPTABLE TIMES FOR TURNING NEW OR REBUILT INTERSECTION OPERATIONAL IS BETWEEN 9:00AM MONDAY THROUGH 3:00 PM THURSDAY.
- CONTRACTOR SHALL PROTECT ALL KNOWN ENVIRONMENTAL RESOURCES IN CITY RIGHT-OF-WAY. EROSION AND SEDIMENT CONTROL SHALL BE IN PLACE WHEN NEED IDENTIFIED ON THE PROJECT.

**SIGNING AND STRIPING NOTES:**

- ALL SIGNS AND PAVEMENT MARKINGS SHALL BE IN COMPLIANCE WITH THE CURRENT MANUAL ON UNIFORM TRAFFIC CONTROL DEVICES (MUTCD).
- REMOVAL OF EXISTING PAVEMENT MARKINGS SHALL BE ACCOMPLISHED BY A METHOD THAT DOES NOT MATERIALLY DAMAGE THE PAVEMENT. THE PAVEMENT MARKINGS SHALL BE REMOVED TO THE EXTENT THAT THEY WILL NOT BE VISIBLE UNDER DAY OR NIGHT CONDITIONS. AT NO TIME WILL IT BE ACCEPTABLE TO PAINT OVER EXISTING PAVEMENT MARKINGS.
- ANY DEVIATION FROM THE STRIPING AND SIGNING PLAN SHALL BE APPROVED BY EL PASO COUNTY PLANNING AND COMMUNITY DEVELOPMENT.
- ALL SIGNS SHOWN ON THE SIGNING AND STRIPING PLAN SHALL BE NEW SIGNS. EXISTING SIGNS MAY REMAIN OR BE REUSED IF THEY MEET CURRENT EL PASO COUNTY AND MUTCD STANDARDS.
- STREET NAME AND REGULATORY STOP SIGNS SHALL BE ON THE SAME POST AT INTERSECTIONS.
- ALL REMOVED SIGNS SHALL BE DISPOSED OF IN A PROPER MANNER BY THE CONTRACTOR.
- ALL STREET NAME SIGNS SHALL HAVE "D" SERIES LETTERS, WITH LOCAL ROADWAY SIGNS BEING 4" UPPER-POWER CASE LETTERING ON 8" BLACK AND NON-LOCAL ROADWAY SIGNS BEING 6" LETTERING, UPPER-LOWER CASE ON 12" BLANK, WITH A WHITE BORDER THAT IS NOT RECESSED. MULTI-LANE ROADWAYS WITH SPEED LIMITS OF 40 MPH OR HIGHER SHALL HAVE 8" UPPER-LOWER CASE LETTERING ON 18" BLANK WITH A WHITE BORDER THAT IS NOT RECESSED. THE WIDTH OF THE NON-RECESSED WHITE BORDERS SHALL MATCH PAGE 255 OF THE 2012 MUTCD "STANDARD HIGHWAY SIGNS".
- ALL TRAFFIC SIGNS SHALL HAVE A MINIMUM HIGH INTENSITY PRISMATIC GRADE SHEETING.
- ALL LOCAL RESIDENTIAL STREET SIGNS SHALL BE MOUNTED ON A 1.75" X 1.75" SQUARE TUBE SIGN POST AND STUB POST BASE. FOR OTHER APPLICATIONS, REFER TO THE CDOT STANDARDS S-614-8 REGARDING USE OF THE P2 TUBULAR STEEL POST SLIP BASE DESIGN.
- ALL SIGNS SHALL BE SINGLE SHEET ALUMINUM WITH 0.100" MINIMUM THICKNESS.
- ALL LIMIT LINES/STOP LINES, CROSSWALK LINES, PAVEMENT LEGENDS, AND ARROWS SHALL BE A MINIMUM 125 MIL THICKNESS PERFORMED THERMOPLASTIC PAVEMENT MARKINGS WITH TAPERED LEADING EDGES PER CDOT STANDARDS S-627-1. WORD AND SYMBOL MARKINGS SHALL BE THE NARROW TYPE. STOP BARS SHALL BE 24" IN WIDTH. CROSSWALKS LINES SHALL BE 12" WIDE AND 8' LONG PER CDOT S-627-1.
- ALL LONGITUDINAL LINES SHALL BE A MINIMUM 15 MIL THICKNESS EPOXY PAINT. ALL NON-LOCAL RESIDENTIAL ROADWAYS SHALL INCLUDE BOTH RIGHT AND LEFT EDGE LINE STRIPING AND ANY ADDITIONAL STRIPING AS REQUIRED BY CDOT S-627-1.
- THE CONTRACTOR SHALL NOTIFY EL PASO COUNTY PLANNING AND COMMUNITY DEVELOPMENT (719) 520-6819 PRIOR TO AND UPON COMPLETION OF SIGNING AND STRIPING.
- THE CONTRACTOR SHALL OBTAIN A WORK IN THE RIGHT OF WAY PERMIT FROM THE EL PASO COUNTY DEPARTMENT OF PUBLIC WORKS (DPW) PRIOR TO ANY SIGNAGE OR STRIPING WORK WITHIN AN EXISTING EL PASO COUNTY ROADWAY.

**COLORADO SPRINGS CITY TRAFFIC SIGNAL INSTALLATION & PARTS SPECIFICATIONS:**

- SECTION 1 CONTRACTOR PRE-QUALIFICATIONS
- SECTION 2 GENERAL NOTES
- SECTION 3 MATERIALS
- SECTION 4 CABLE SPLICING AND COLOR CODES
- SECTION 5 SPAN WIRE ATTACHMENT
- SECTION 6 CONDUIT, JUNCTION BOXES, AND CONTROLLER BASE
- SECTION 7 ILLUMINATED STREET NAME SIGNS
- SECTION 8 SIGNAL POLE 2015 AASHTO DESIGN
- SECTION 9 SIGNAL POLE FOUNDATION 2015 AASHTO DESIGN
- SECTION 10 SCHOOL FLASHER
- SECTION 11 SIGNAL HEADS AND MOUNTING EQUIPMENT
- SECTION 12 PEDESTAL POLES AND PEDESTRIAN BUTTONS
- SECTION 13 SIGNAL CABINET
- SECTION 14 DETECTION SYSTEMS
- SECTION 15 SERVICE AND WIRE SPECIFICATIONS
- SECTION 16 STEEL CABLE, SIGNAL ACCESSORIES, AND GUY WIRE
- SECTION 17 LED ROADWAY LIGHTING
- SECTION 18 GROUNDING METHODS
- APPENDIX A CONCRETE MIX DESIGNS AND REQUIREMENTS
- APPENDIX B SIGNAL POLE AASHTO 1994 (MAINTENANCE ONLY)
- APPENDIX C SIGNAL FOUNDATION AASHTO 1994 (MAINTENANCE ONLY)

|   |      |             |    |
|---|------|-------------|----|
| REFERENCE DRAWINGS  |      |             |    |
| X-MDG22x34 CD's   |      |             |    |
| No.   | DATE | DESCRIPTION | BY |
| REVISIONS   |      |             |    |
| <b>COMPUTER FILE MANAGEMENT</b>   |      |             |    |
| FILE NAME: S:\24.1129.026 Lorson Ranch Commercial North\500 CADD\504 Plan Sets\Construction Plans\Signal\GN01.dwg |      |             |    |
| CTB FILE: Matrix(black).ctb   |      |             |    |
| PLOT DATE: November 4, 2024 1:56:27 PM  |      |             |    |
| THIS DRAWING IS CURRENT AS OF PLOT DATE AND MAY BE SUBJECT TO CHANGE.   |      |             |    |

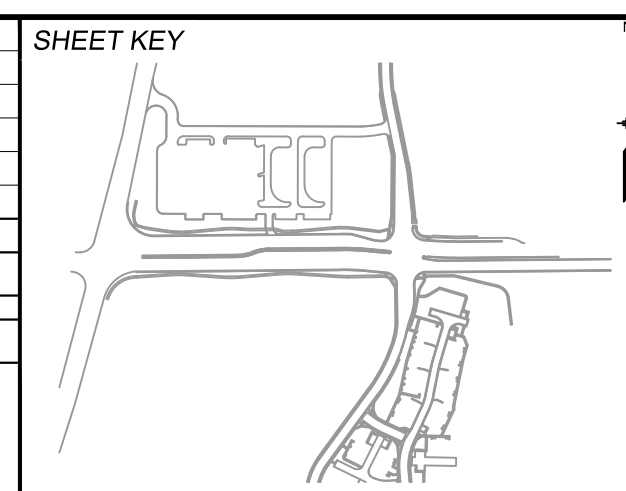

PREPARED FOR:

PREPARED BY:

SEAL

11/04/2024

FOR AND ON BEHALF OF MATRIX DESIGN GROUP, INC. PROJECT No. 24.1129.026

**LORSON RANCH COMMERCIAL NORTH**

CARRIAGE MEADOWS DRIVE/FONTAINE BOULEVARD TRAFFIC SIGNAL & SIGNING PLAN

**GENERAL NOTES**

|              |     |                        |              |               |             |
|--------------|-----|------------------------|--------------|---------------|-------------|
| DESIGNED BY: | TJC | SCALE                  | DATE ISSUED: | NOVEMBER 2024 | DRAWING No. |
| CHECKED BY:  | SDB | HORIZ N/A<br>VERT. N/A | SHEET        | 2 OF 5        | GN01        |



Know what's below.  
Call before you dig.

| TABULATION OF SIGNAL QUANTITIES |   |      |          |
|---------------------------------|---|------|----------|
| ITEM NO.                        | ITEM DESCRIPTION                                  | UNIT | QUANTITY |
| 814-03036                       | DRILLED SIGNAL POLE FOUNDATION (36 INCH)          | LF   | 25       |
| 814-03042                       | DRILLED SIGNAL POLE FOUNDATION (42 INCH)          | LF   | 28       |
| 813-00201                       | 2 INCH CONDUIT (TRAFFIC)                          | LF   | 540      |
| 813-00301                       | 3 INCH CONDUIT (TRAFFIC)                          | LF   | 1030     |
| 813-07012                       | PULL BOX (30"x17"x18")                            | EA   | 6        |
| 813-07013                       | PULL BOX (36"x24"x18")                            | EA   | 2        |
| 814-80009                       | TRAFFIC SIGNAL LUMINAIRE                          | EA   | 4        |
| 813-08001                       | TRAFFIC SIGNAL METER PEDESTAL                     | EA   | 1        |
| 814-10130                       | ILLUMINATED STREET NAME SIGN                      | EA   | 4        |
| 814-75215                       | PEDESTRIAN SIGNAL FACE (16) (COUNTDOWN)           | EA   | 8        |
| 814-70336                       | TRAFFIC SIGNAL FACE (12-12-12)                    | EA   | 15       |
| 814-72860                       | PEDESTRIAN PUSH BUTTON                            | EA   | 8        |
| 814-72897                       | INTERSECTION DETECTION SYSTEM (RADAR)             | EA   | 4        |
| 814-84440                       | TRAFFIC SIGNAL PEDESTAL POLE                      | EA   | 4        |
| 814-81040                       | TRAFFIC SIGNAL POLE (1 MAST ARM) (40 FT MAST ARM) | EA   | 1        |
| 814-81045                       | TRAFFIC SIGNAL POLE (1 MAST ARM) (45 FT MAST ARM) | EA   | 1        |
| 814-81055                       | TRAFFIC SIGNAL POLE (1 MAST ARM) (55 FT MAST ARM) | EA   | 1        |
| 814-81060                       | TRAFFIC SIGNAL POLE (1 MAST ARM) (60 FT MAST ARM) | EA   | 1        |
| 814-75847                       | TRAFFIC SIGNAL CONTROLLER AND CABINET (COMPLETE)  | EA   | 1        |

NOTE:  
TRAFFIC SIGNAL FACE (12-12-12) SHALL INCLUDE VISORS AND ALL MOUNTING HARDWARE REQUIRED TO INSTALL.

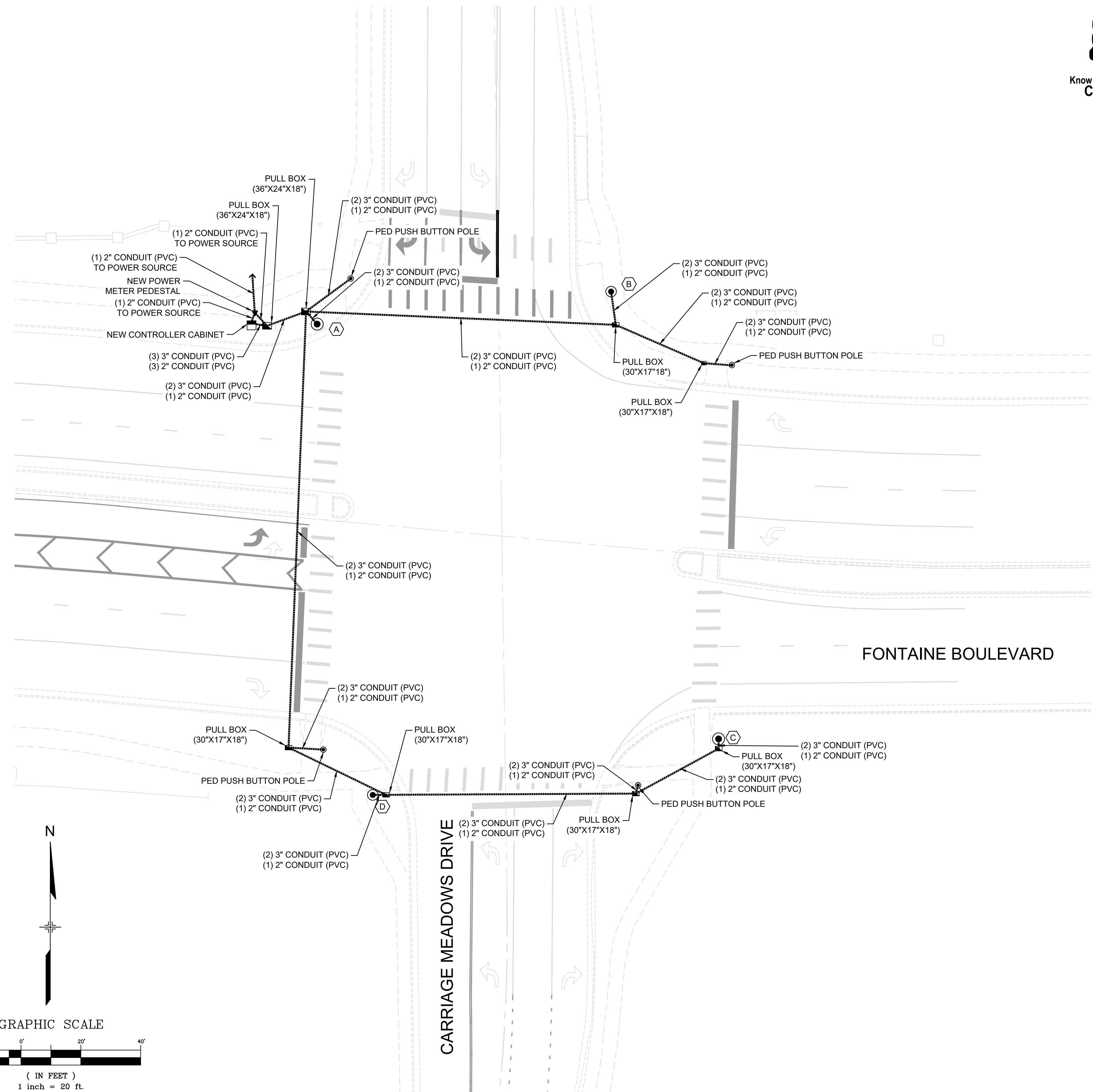

### SIGNAL POLE SCHEDULE

| POLE NUMBER          | A         | B         | C         | D         |
|----------------------|-----------|-----------|-----------|-----------|
| LOCATION             | NW CORNER | NE CORNER | SE CORNER | SW CORNER |
| NORTHING             | 22705.83  | 22716.70  | 22567.24  | 22548.49  |
| EASTING              | 21017.00  | 21115.25  | 21151.17  | 21035.59  |
| CAISSON ELEV*        | 5708.44   | 5709.32   | 5710.30   | 5709.00   |
| MAST ARM LENGTH (FT) | 45        | 55        | 40        | 60        |
| BASE DIA. (IN)       | 36        | 42        | 36        | 42        |
| CAISSON LENGTH (FT)  | 14        | 14        | 11        | 14        |

NOTES:  
• CONTRACTOR TO VERIFY ALL ELEVATIONS PRIOR TO CONSTRUCTION.

### PROPOSED SIGNAL EQUIPMENT LEGEND

|                      |  |
|----------------------|--|
| PULL BOX             |  |
| CONTROLLER CABINET   |  |
| PED PUSH BUTTON POLE |  |
| SIGNAL POLE          |  |
| POWER METER PEDESTAL |  |
| SIGNAL CONDUIT       |  |

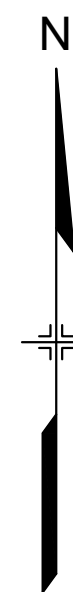

GRAPHIC SCALE



( IN FEET )  
1 inch = 20 ft.

| No.   | DATE | DESCRIPTION | BY |
|---|------|-------------|----|
| COMPUTER FILE MANAGEMENT  |      |             |    |
| FILE NAME: S:\24.1129.026 Lorson Ranch Commercial North\500 CADD\504 Plan Sets\Construction Plans\Signal\SG01.dwg |      |             |    |
| CTB FILE: Matrix(black).ctb   |      |             |    |
| PLOT DATE: November 4, 2024 1:56:28 PM  |      |             |    |
| THIS DRAWING IS CURRENT AS OF PLOT DATE AND MAY BE SUBJECT TO CHANGE.   |      |             |    |

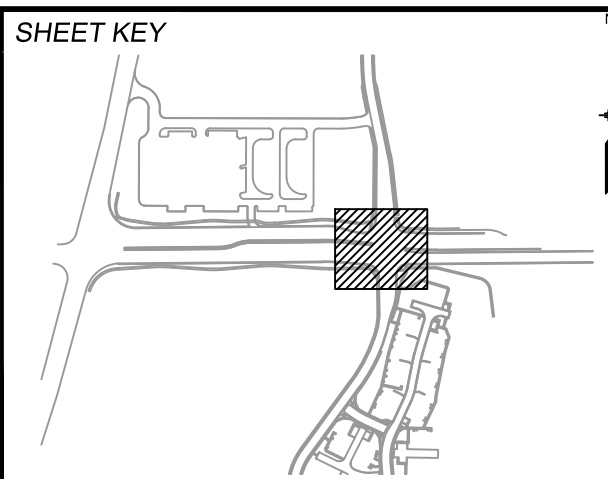

| PREPARED FOR:                  | SCALE:   |
|--------------------------------|----------|
| Matrix<br>Excellence by Design | 1" = 20' |

DESIGNED BY: TJC  
DRAWN BY: AFD  
CHECKED BY: SDB

DATE ISSUED: NOVEMBER 2024

DRAWING No. SG01

FOR AND ON BEHALF OF  
MATRIX DESIGN GROUP, INC.  
PROJECT No. 24.1129.026

LORSON RANCH COMMERCIAL NORTH  
CARRIAGE MEADOWS DRIVE/FONTAINE BOULEVARD  
TRAFFIC SIGNAL & SIGNING PLAN

SIGNAL POLE & CONDUIT PLAN



Know what's below.  
Call before you dig.

COUNTDOWN  
PEDESTRIAN  
HEAD



17, 18, 19, 20,  
21, 22, 23, 24

PROPOSED SIGNAL HEADS

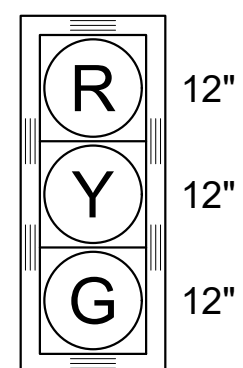

1, 2, 6, 7, 9, 10,  
12, 13, 14, 15

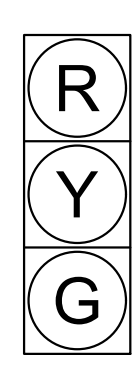

4, 8, 11, 16

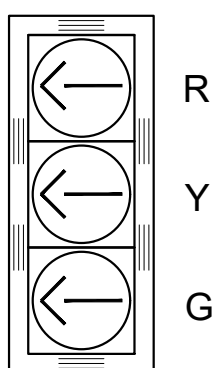

5

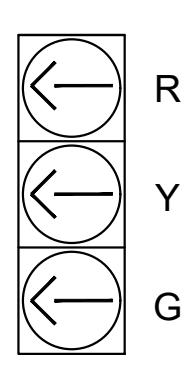

3

STREET NAME SIGNS



(A)



(B)

NOTES:

- SERIES E(M) ALPHABET SHALL BE USED WITH 12-INCH INITIAL UPPER-CASE LETTERS WITH 9" SUBSEQUENT LOWER-CASE LETTERS.
- WHITE TEXT ON GREEN BACKGROUND SHALL BE USED.
- SHOP DRAWINGS SHALL BE APPROVED BY THE ENGINEER PRIOR TO INSTALLATION.

PROPOSED  
PEDESTRIAN SIGN

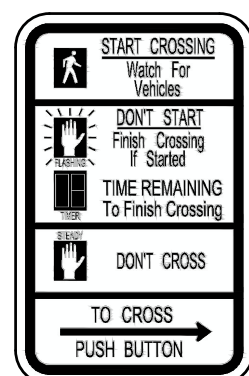

R10-3E  
9" x 15"

EACH PEDESTRIAN PUSH BUTTON SHALL BE ACCOMPANIED BY A 9" x 15" R10-3E PEDESTRIAN SIGN. THIS SIGN SHALL BE INCLUDED IN THE PEDESTRIAN PUSH BUTTON PAY ITEM

SIGNAL EQUIPMENT LEGEND

|                                   |  |
|-----------------------------------|--|
| PEDESTRIAN SIGNAL HEAD            |  |
| TRAFFIC SIGNAL HEAD W/ BACKPLATE  |  |
| TRAFFIC SIGNAL HEAD W/O BACKPLATE |  |
| LUMINAIRE                         |  |
| PED PUSH BUTTON POLE              |  |
| SIGNAL POLE                       |  |
| PEDESTRIAN PUSH BUTTON AND SIGN   |  |
| RADAR DETECTION                   |  |
| ILLUMINATED STREET NAME SIGN      |  |

N

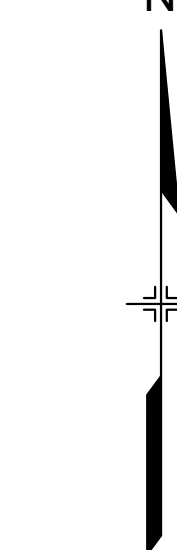

GRAPHIC SCALE



( IN FEET )  
1 inch = 20 ft.

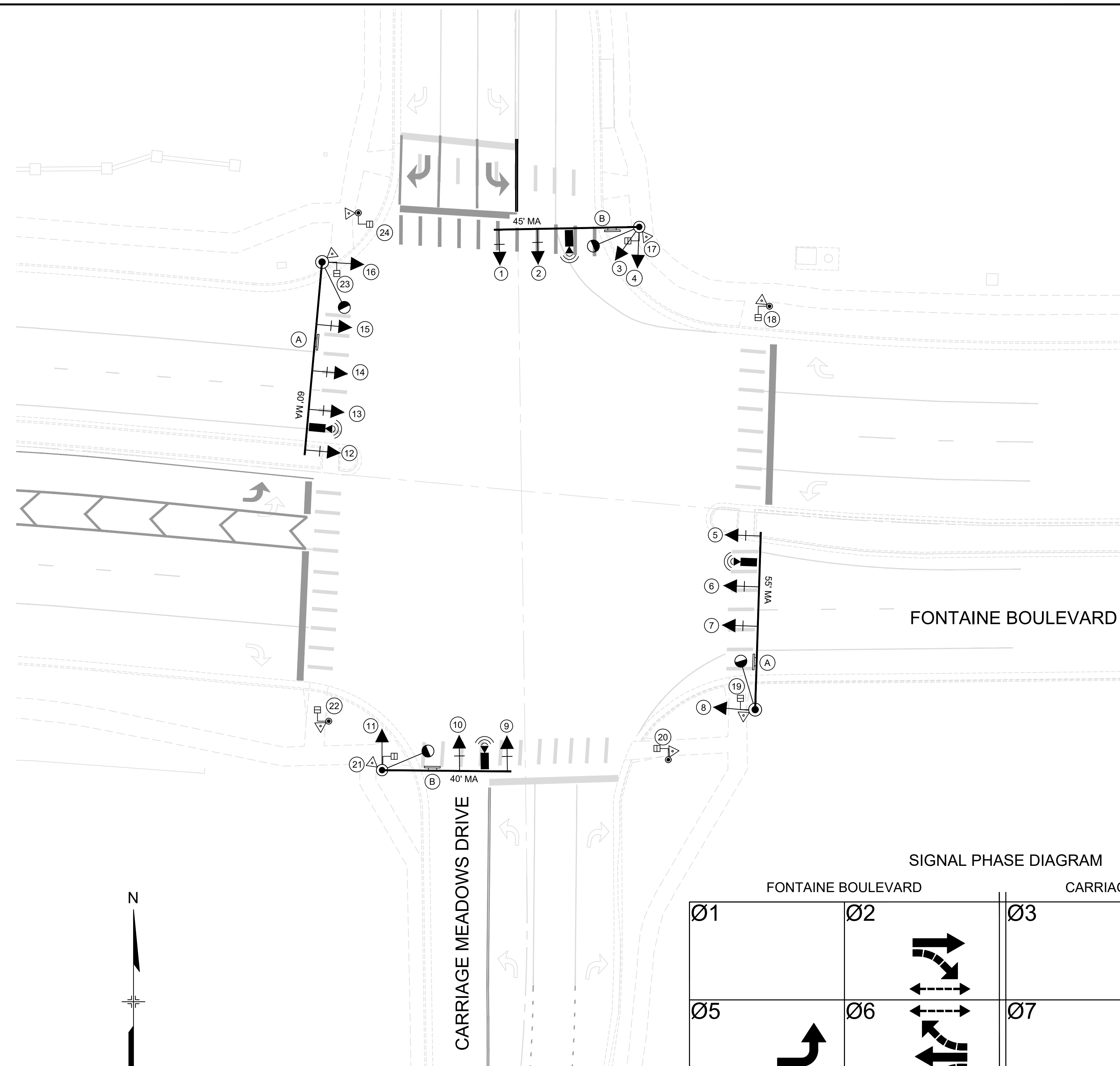

SIGNAL PHASE DIAGRAM

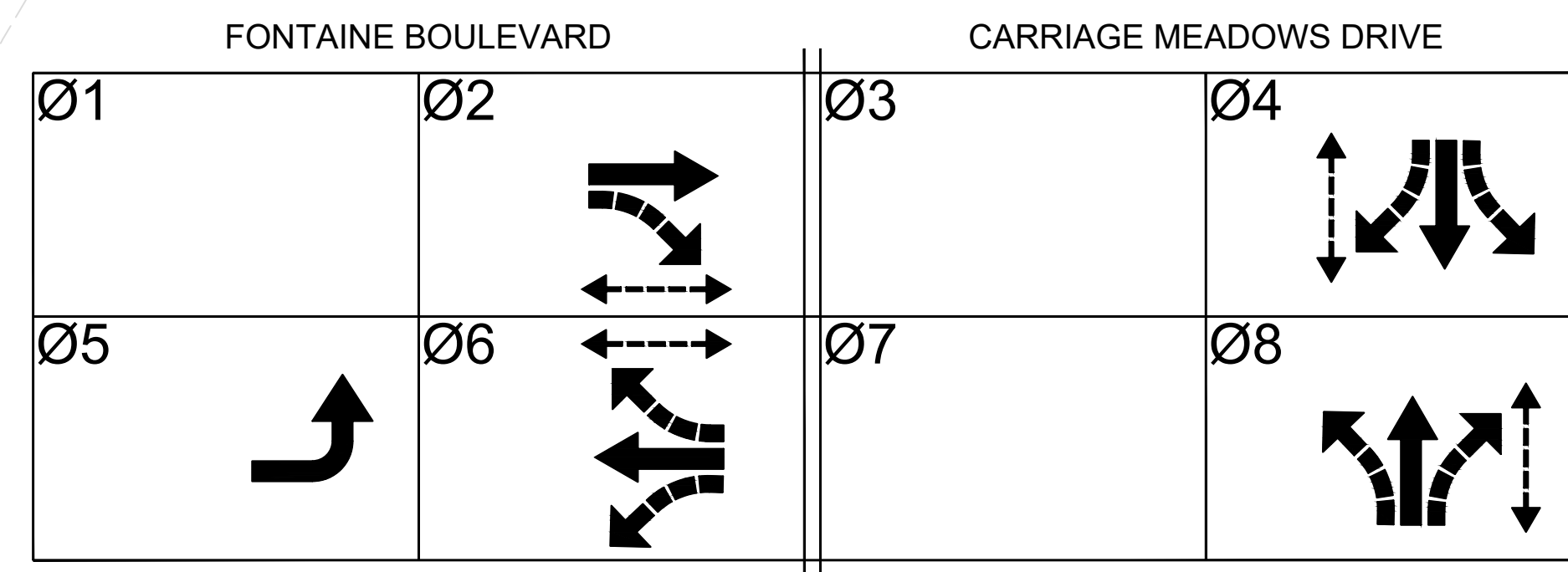

- PROTECTED PHASE
- PERMISSIVE PHASE
- PEDESTRIAN PHASE

|   |      |             |    |
|---|------|-------------|----|
| REFERENCE DRAWINGS  |      |             |    |
| X-MDG22x34 CD's   |      |             |    |
| X-1129.026-PR-SIGNAL  |      |             |    |
| 100.070bpx  |      |             |    |
| 100.070bpx  |      |             |    |
| X-1129.025-EX-BASE  |      |             |    |
| No.   | DATE | DESCRIPTION | BY |
| COMPUTER FILE MANAGEMENT  |      |             |    |
| FILE NAME: S:\24.1129.026_Lorson Ranch Commercial North\500 CADD\504 Plan Sets\Construction Plans\Signal\SG01.dwg |      |             |    |
| CTB FILE: Matrix(black).ctb   |      |             |    |
| PLOT DATE: November 4, 2024 1:56:28 PM  |      |             |    |
| THIS DRAWING IS CURRENT AS OF PLOT DATE AND MAY BE SUBJECT TO CHANGE.   |      |             |    |

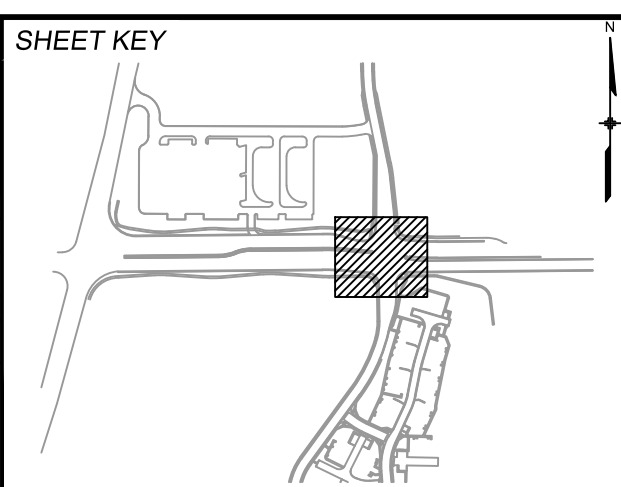

PREPARED FOR:

PREPARED BY:

**Matrix**  
Excellence by Design

SEAL

11/04/2024

FOR AND ON BEHALF OF  
MATRIX DESIGN GROUP, INC.  
PROJECT No. 24.1129.026

DESIGNED BY: TJC

DRAWN BY: AFD

CHECKED BY: SDB

SCALE: HORIZ 1"=20'

DATE ISSUED: NOVEMBER 2024

SHEET: 4 OF 5

DRAWING No. SG02

LORSON RANCH COMMERCIAL NORTH

CARRIAGE MEADOWS DRIVE/FONTAINE BOULEVARD  
TRAFFIC SIGNAL & SIGNING PLAN

TRAFFIC SIGNAL PLAN



Know what's below.  
Call before you dig.

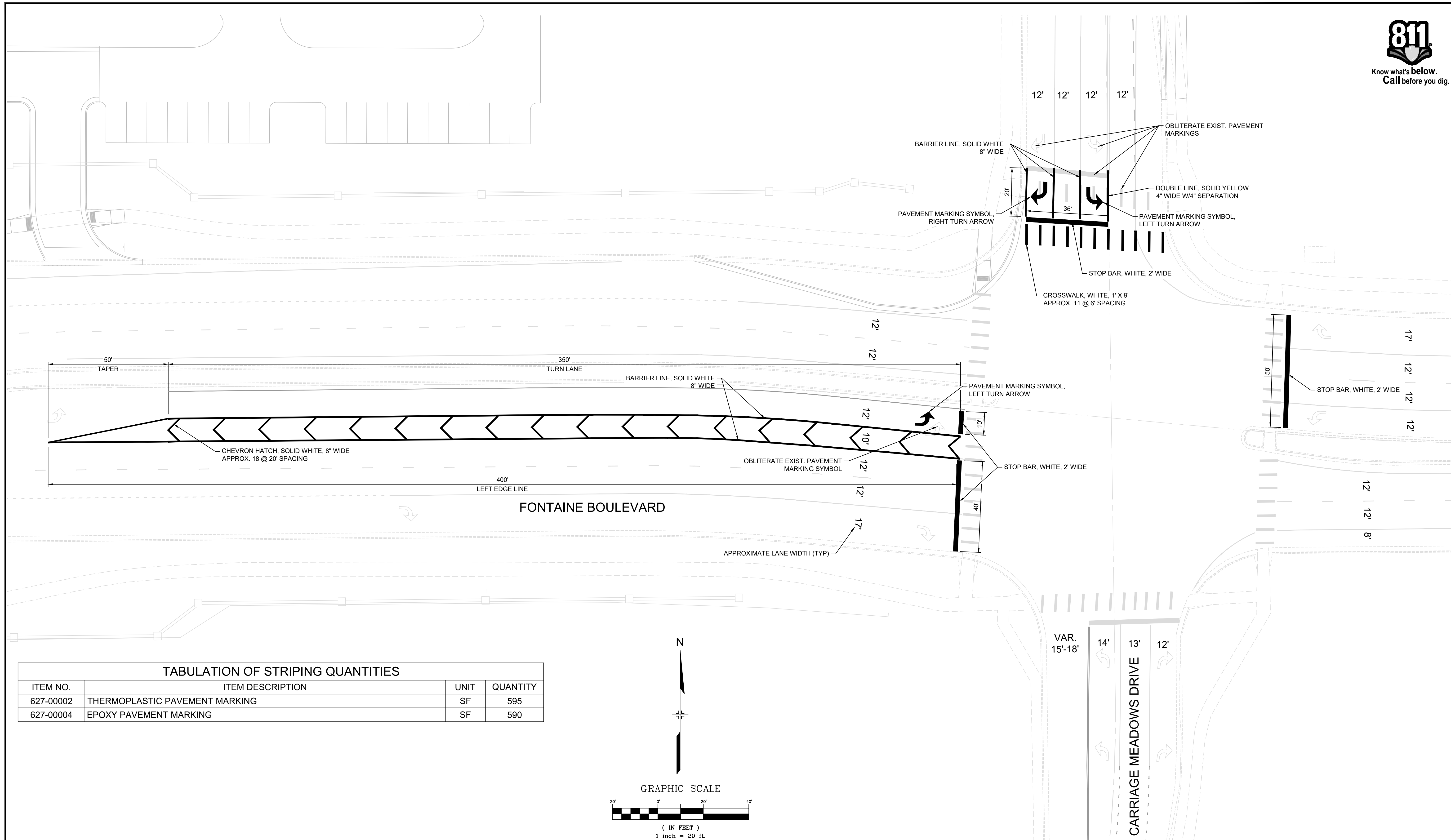

TABULATION OF STRIPING QUANTITIES

| ITEM NO.  | ITEM DESCRIPTION               | UNIT | QUANTITY |
|-----------|--------------------------------|------|----------|
| 627-00002 | THERMOPLASTIC PAVEMENT MARKING | SF   | 595      |
| 627-00004 | EPOXY PAVEMENT MARKING         | SF   | 590      |



GRAPHIC SCALE



| No.   | DATE | DESCRIPTION | BY |
|---|------|-------------|----|
| COMPUTER FILE MANAGEMENT  |      |             |    |
| FILE NAME: S:\24.1129.026_Lorson Ranch Commercial North\500 CADD\504 Plan Sets\Construction Plans\Signal\SN01.dwg |      |             |    |
| CTB FILE: Matrix(black).ctb   |      |             |    |
| PLOT DATE: November 4, 2024 1:56:29 PM  |      |             |    |
| THIS DRAWING IS CURRENT AS OF PLOT DATE AND MAY BE SUBJECT TO CHANGE.   |      |             |    |

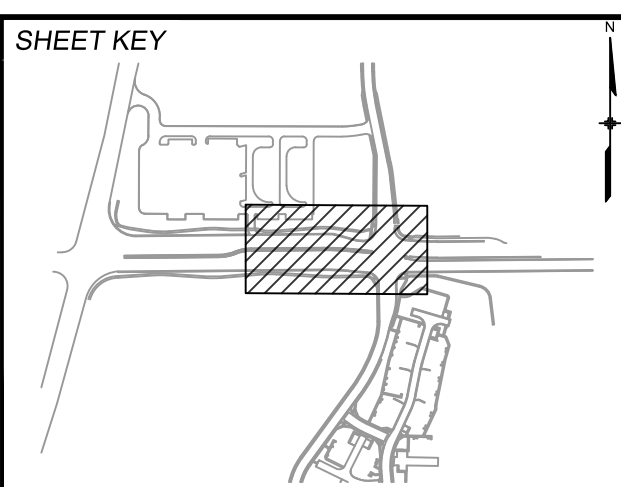

PREPARED BY:  
**Matrix**  
Excellence by Design

SEAL  
FOR AND ON BEHALF OF  
MATRIX DESIGN GROUP, INC.  
PROJECT No. 24.1129.026

DESIGNED BY: TJC  
DRAWN BY: AFD  
CHECKED BY: SDB

SCALE  
HORIZ 1" = 20'  
VERT. N/A

DATE ISSUED: NOVEMBER 2024

DRAWING No. SN01

LORSON RANCH COMMERCIAL NORTH  
CARRIAGE MEADOWS DRIVE/FONTAINE BOULEVARD  
TRAFFIC SIGNAL & SIGNING PLAN

SIGNING & STRIPING PLAN

DESIGNED BY: TJC  
DRAWN BY: AFD  
CHECKED BY: SDB

SCALE  
HORIZ 1" = 20'  
VERT. N/A

DATE ISSUED: NOVEMBER 2024

DRAWING No. SN01