



# EL PASO COUNTY PLANNING & COMMUNITY DEVELOPMENT SIGN APPLICATION

DATE: \_\_\_\_\_

**Project Name** 11694 BENT GRASS MARKET VW (Fox's Pizza)  
**File Number** SC2542  
**Template** [Sign Application](#) | [Compare to Template](#)  
**File Prefix** SC - Sign Application  
**Year** 2025  
**Project Address** 11694 BENT GRASS MARKET VW (Fox's Pizza)  
 #150 5801101070 Total Market Value \$589,443  
 11694 BENT GRASS MARKET VW  
 Falcon, Co 80831  
**Legal Desc.** LOT 2A BENT GRASS PLAZA No Photo Available  
**Review Days** 2  
**Project Area** 1.21 acres  
**Zone** CS

### Vicinity Map

Tax Schedule # \_\_\_\_\_  
 Please show major intersections.

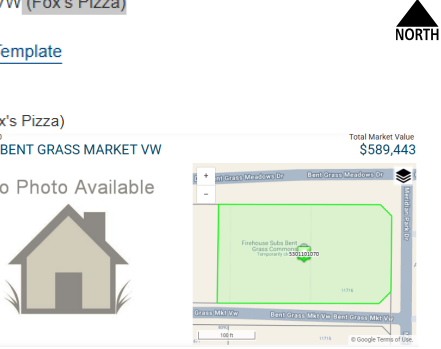

### Type of Sign

Attached Signs - Direction: N

**Storefront** 25.11 feet  
**Multiplier** 1.50  
**Has Illuminated** Yes

	# Signs	Square Feet
Existing	0	0.00
Proposed	1	27.75
<b>TOTAL</b>	<b>1</b>	<b>27.75</b>
<b>Max Allowed</b>	<b>37.67</b>	

**Comment** 14' elevation attached on bldg rear

Attached Signs - Direction: S

**Storefront** 25.11 feet  
**Multiplier** 1.50  
**Has Illuminated** Yes

	# Signs	Square Feet
Existing	0	0.00
Proposed	1	34.92
<b>TOTAL</b>	<b>1</b>	<b>34.92</b>
<b>Max Allowed</b>	<b>37.67</b>	

**Comment** will be mounted 12.67' above sidewalk

### Elevation Drawing

orefront length & placement of sign.

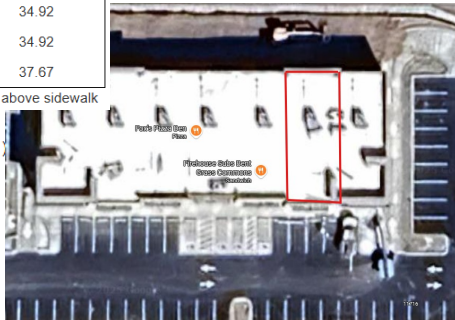

**Applicant** Colorado Quality Sign and Design  
 JASON Cooley ( [cqsdnow@gmail.com](mailto:cqsdnow@gmail.com) )  
 (309) 657-5804

**Owner** Nate Derwick  
 Copestone General Contractors  
 555 Amelia Street  
 ste 100  
 Colorado Springs, CO 80905  
[nathan@copestone-cm.com](mailto:nathan@copestone-cm.com)  
 (719) 578-8833

### Sign Plan

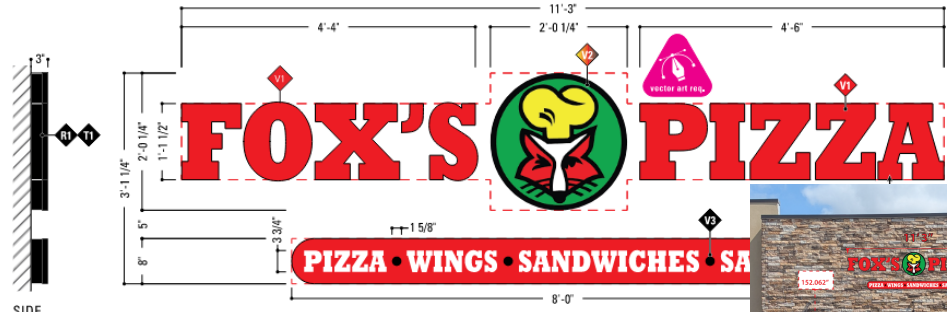

**1 SIGN 01 - BUILDING SIGN ELEVATION**  
 SCALE: 3/4" = 1'-0" (1:16)

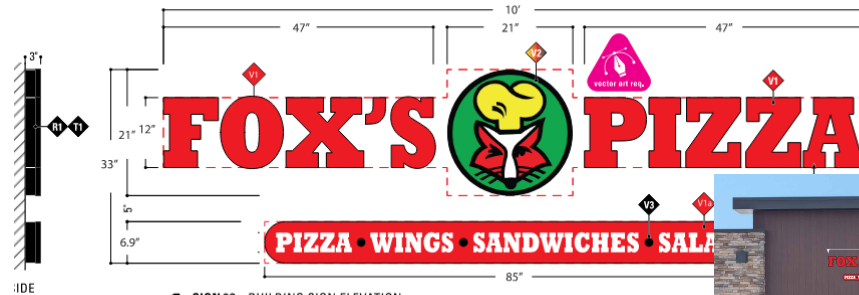

**1 SIGN 02 - BUILDING SIGN ELEVATION**  
 SCALE: 3/4" = 1'-0" (1:16)



### For Planning & Community Development Use Only

Approved Date: **APPROVED** \_\_\_\_\_ Resubmittal? Yes \_\_\_\_\_ No \_\_\_\_\_

Denied Date: **Plan Review** \_\_\_\_\_

Comments: *10/21/2025 11:57:06 AM dsdbenson2*

**EPC Planning & Community  
 Development Department**

**Fee of \$352.00 must accompany this Application. Additional signs at time of first Application are \$125.00. Make checks payable to El Paso County.**



1/20th scale

Day/Night vinyl. Day time Red, Night time White **V1**

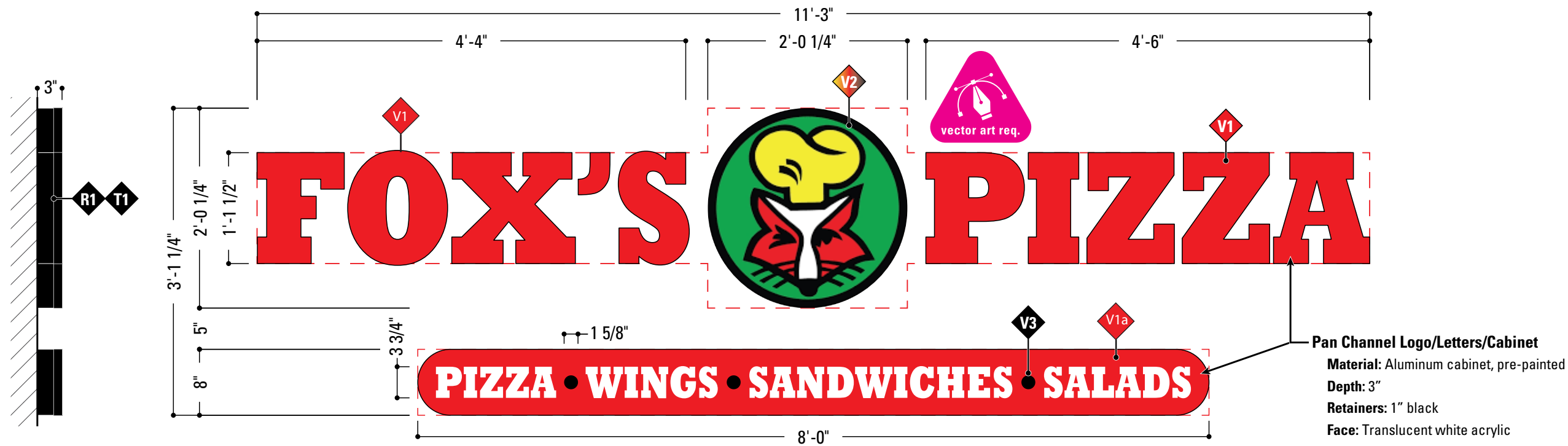

SIDE

**1 SIGN 01 - BUILDING SIGN ELEVATION**  
SCALE: 3/4" = 1'-0" [1:16]

**19.76 SQ FT**

**Pan Channel Logo/Letters/Cabinet**

- Material:** Aluminum cabinet, pre-painted
- Depth:** 3"
- Retainers:** 1" black
- Face:** Translucent white acrylic
- Lighting:** Internal white LED
- Graphics:** 1st surface applied vinyl
- Mount:** Flush to face of wall

**SCOPE OF WORK**

WEATHER-SEAL HOLES IN EXISTING SOFFIT.  
MANUFACTURE & INSTALL **ONE [1]** NEW  
ILLUMINATED PCPF LOGO SIGN.

**ELECTRICAL**

POWER AT SIGN TO BE PROVIDED BY OTHERS.

**COLOR & MATERIAL KEY**

<b>V1</b>	VINYL	3M 3630-33 RED DAY/NIGHT
<b>V1a</b>	VINYL	3M 3630-33RED
<b>V2</b>	VINYL	DIGITAL PRINT
<b>V3</b>	VINYL	3M 3630-22 BALCK
<b>R1</b>	RETURN	BLACK
<b>T1</b>	TRIM	BLACK

NOTE: UNLESS OTHERWISE NOTED, THE COLORS DEPICTED ON THIS RENDERING MAY NOT MATCH ACTUAL COLORS ON FINISHED DISPLAY. PLEASE REFER TO COLOR-CALLOUTS & THEIR APPROPRIATE VENDOR SPECIFIED SAMPLES FOR APPROVED COLOR SPECIFICATIONS.



10'

**FOX'S PIZZA**

PIZZA • WINGS • SANDWICHES • SALADS

33.306"

23' 3"

3' 4"

21' 2"

7' 2"

Day/Night vinyl. Day time Red, Night time White **V1**

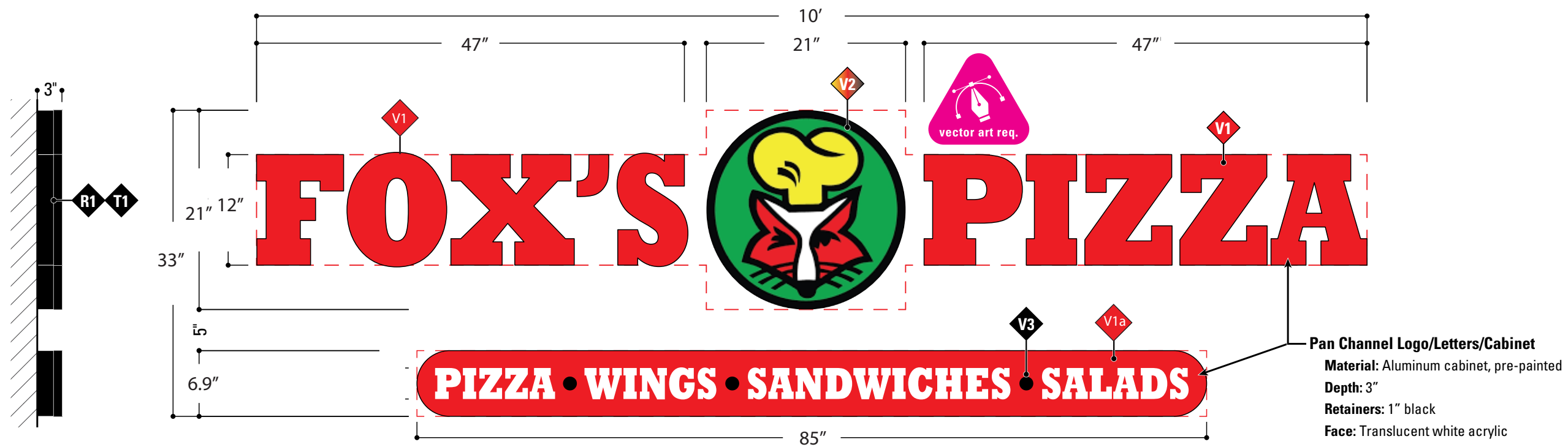

SIDE

**1** SIGN 02 - BUILDING SIGN ELEVATION  
SCALE: 3/4" = 1'-0" [1:16]

**SCOPE OF WORK**

WEATHER-SEAL HOLES IN EXISTING SOFFIT.  
MANUFACTURE & INSTALL **ONE [1]** NEW  
ILLUMINATED PCPF LOGO SIGN.

**ELECTRICAL**

POWER AT SIGN TO BE PROVIDED BY OTHERS.

**COLOR & MATERIAL KEY**

<b>V1</b>	VINYL	3M 3630-33 RED DAY/NIGHT
	<b>V1a</b>	3M 3630-33RED
<b>V2</b>	VINYL	DIGITAL PRINT
<b>V3</b>	VINYL	3M 3630-22 BALCK
<b>R1</b>	RETURN	BLACK
<b>T1</b>	TRIM	BLACK

NOTE: UNLESS OTHERWISE NOTED, THE COLORS DEPICTED ON THIS RENDERING MAY NOT MATCH ACTUAL COLORS ON FINISHED DISPLAY. PLEASE REFER TO COLOR-CALLOUTS & THEIR APPROPRIATE VENDOR SPECIFIED SAMPLES FOR APPROVED COLOR SPECIFICATIONS.