

ENG-PUDSP21001-R1-GEC-Redlines.pdf Markup Summary

1 (5)

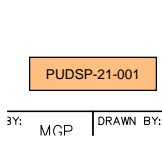

Subject: SW - Text Box
Page Index: 1
Date: 2/1/2021 2:00:58 PM
Author: GReese
Color: ■
Layer:
Space:
Page Label: 1

PUDSP-21-001



Subject: Stormwater Comment Legend
Page Index: 1
Date: 2/1/2021 2:00:58 PM
Author: GReese
Color: ■
Layer:
Space:
Page Label: 1

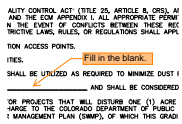

Subject: SW - Comment
Page Index: 1
Date: 2/1/2021 3:01:27 PM
Author: GReese
Color: ■
Layer:
Space:
Page Label: 1

Fill in the blank.



Subject: PCD Comment Legend
Page Index: 1
Date: 2/18/2021 5:01:27 PM
Author: dsdrice
Color: ■
Layer:
Space:
Page Label: 1



Subject: EPC ENG Review
Page Index: 1
Date: 2/18/2021 5:01:37 PM
Author: dsdrice
Color: ■
Layer:
Space:
Page Label: 1

2 (21)



Subject: SW - Comment
Page Index: 2
Date: 2/1/2021 2:01:09 PM
Author: GReese
Color: ■
Layer:
Space:
Page Label: 2

Clarify significance of "Boundary"
Per the GEC Checklist, we'd like to see the Limits
of Disturbance and Construction Boundary. If they
are the same, change label to "construction
boundary/limits of disturbance" or if not the same,
add "limits of disturbance" to the legend and figure

move label to a location within the viewport or freeze

(C) STORM
(TOP)

Subject: SW - Comment
Page Index: 2
Date: 2/1/2021 2:01:09 PM
Author: GReese
Color: ■
Layer:
Space:
Page Label: 2

move label to a location within the viewport or freeze

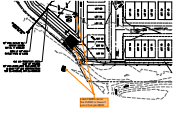

Subject: SW - Comment
Page Index: 2
Date: 2/1/2021 2:01:09 PM
Author: GReese
Color: ■
Layer:
Space:
Page Label: 2

Label if BMPs are for this PUDSP or freeze if part of final plat BMPs

1/2" BY VOLUME
18" PVC RISER PIPE W/5 ROWS OF
2 EACH 1.0" DIA PERFORATIONS
TOP EL.=+3388.00, INV EL.=+3388.50
Specify "Depth at Outlet"
and/or circle row on detail
SB-2 on next sheet that
applies to this site.

Subject: SW - Text Box
Page Index: 2
Date: 2/1/2021 2:06:11 PM
Author: GReese
Color: ■
Layer:
Space:
Page Label: 2

Specify "Depth at Outlet" and/or circle row on detail SB-2 on next sheet that applies to this site.

specify 18" as length or diameter of pipe.

12" PVC
INV. EL.
OUTLET
18" PVC
2 EA
TOP EL.

Subject: SW - Comment
Page Index: 2
Date: 2/1/2021 2:16:08 PM
Author: GReese
Color: ■
Layer:
Space:
Page Label: 2

specify 18" as length or diameter of pipe.

WATER DISPOSAL

Show and label limits of East Fork Sand Creek in this area.

Subject: SW - Comment
Page Index: 2
Date: 2/1/2021 2:16:38 PM
Author: GReese
Color: ■
Layer:
Space:
Page Label: 2

Show and label limits of East Fork Sand Creek in this area

Show limits of road and ditch adjacent to site.

ROAD

Subject: SW - Comment
Page Index: 2
Date: 2/1/2021 2:18:36 PM
Author: GReese
Color: ■
Layer:
Space:
Page Label: 2

Show limits of road and ditch adjacent to site.



Subject: SW - Text Box
Page Index: 2
Date: 2/1/2021 2:20:46 PM
Author: GReese
Color: ■
Layer:
Space:
Page Label: 2

Checklist Item "j" - show or make a note of the existing vegetation.

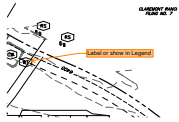

Subject: SW - Comment
Page Index: 2
Date: 2/1/2021 2:35:19 PM
Author: GReese
Color: ■
Layer:
Space:
Page Label: 2

Label or show in Legend

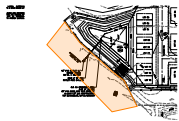

Subject: Polygon
Page Index: 2
Date: 2/1/2021 2:35:34 PM
Author: GReese
Color: ■
Layer:
Space:
Page Label: 2

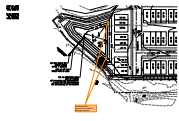

Subject: SW - Comment
Page Index: 2
Date: 2/1/2021 2:37:18 PM
Author: GReese
Color: ■
Layer:
Space:
Page Label: 2

provide erosion protection at outfall of drainage swales.



Subject: SW - Dimension
Page Index: 2
Date: 2/1/2021 2:38:06 PM
Author: GReese
Color: ■
Layer:
Space:
Page Label: 2

50'-0"

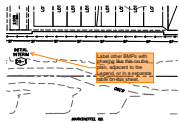

Subject: SW - Comment
Page Index: 2
Date: 2/1/2021 2:39:02 PM
Author: GReese
Color: ■
Layer:
Space:
Page Label: 2

Label other BMPs with phasing like this on the plan, adjacent to the Legend, or in a separate table on this sheet.

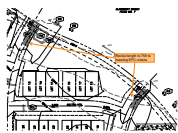

Subject: SW - Comment
Page Index: 2
Date: 2/1/2021 2:48:05 PM
Author: GReese
Color: ■
Layer:
Space:
Page Label: 2

Revise length to 75ft to meeting EPC criteria

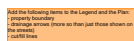

Subject: SW - Comment
Page Index: 2
Date: 2/1/2021 3:01:42 PM
Author: GReese
Color: ■
Layer:
Space:
Page Label: 2

Add the following items to the Legend and the Plan:
 - property boundary
 - drainage arrows (more so than just those shown on the streets)
 - cut/fill lines

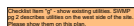

Subject: SW - Text Box
Page Index: 2
Date: 2/1/2021 3:22:26 PM
Author: GReese
Color: ■
Layer:
Space:
Page Label: 2

Checklist Item "g" - show existing utilities. SWMP pg 2 describes utilities on the west side of the site. Please show them on this plan.



Subject: Callout
Page Index: 2
Date: 2/18/2021 12:37:23 PM
Author: dsdrice
Color: ■
Layer:
Space:
Page Label: 2

Label offsite grading. Show all property lines and improvements.



Subject:
Page Index: 2
Date: 2/18/2021 3:42:58 PM
Author: dsdrice
Color: ■
Layer:
Space:
Page Label: 2

Label County parcel (Tract E)

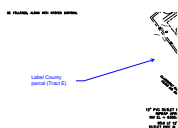

Subject: Callout
Page Index: 2
Date: 2/18/2021 3:45:13 PM
Author: dsdrice
Color: ■
Layer:
Space:
Page Label: 2

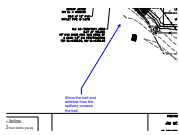

Subject: Callout
Page Index: 2
Date: 2/18/2021 4:59:08 PM
Author: dsdrice
Color: ■
Layer:
Space:
Page Label: 2

Show the trail and address how the spillway crosses the trail.

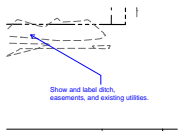

Subject: Callout
Page Index: 2
Date: 2/18/2021 5:00:11 PM
Author: dsdrice
Color: ■
Layer:
Space:
Page Label: 2

Show and label ditch, easements, and existing utilities.

3 (2)

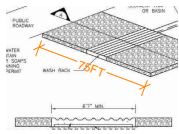

Subject: SW - Dimension w/ User Input
Page Index: 3
Date: 2/1/2021 2:10:37 PM
Author: GReese
Color: ■
Layer:
Space:
Page Label: 3

75FT

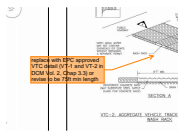

Subject: SW - Comment
Page Index: 3
Date: 2/1/2021 2:11:12 PM
Author: GReese
Color: ■
Layer:
Space:
Page Label: 3

replace with EPC approved VTC detail (VT-1 and VT-2 in DCM Vol. 2, Chap 3.3) or revise to be 75ft min length