

LAND USE LEGEND:

44 AC. RESIDENTIAL: 0.2 DU/AC,	9 D.U.
33 AC. RESIDENTIAL: 0.4 DU/AC,	13 D.U.
35 AC. RESIDENTIAL: 1 DU/AC,	35 D.U.
163 AC. RESIDENTIAL: 2 DU/AC,	272 D.U.
657 AC. RESIDENTIAL: 3-5 DU/AC,	2,366 D.U.
19 AC. RESIDENTIAL: 5-8 DU/AC,	140 D.U.
257 AC. RESIDENTIAL: 5-8 DU/AC ACTIVE ADULT,	1,325 D.U.
32 AC. RESIDENTIAL: 8-12 DU/AC,	320 D.U.
40 AC. RESIDENTIAL: 12-20 DU/AC,	691 D.U.
50 AC. COMMERCIAL	
57 AC. ELEMENTARY / K-8 SCHOOL	
18 AC. NEIGHBORHOOD PARK	
30 AC. COMMUNITY PARK	
57 AC. OPEN SPACE / PARK / GREENWAY	
43 AC. OPEN SPACE / BUFFER	
8 AC. UTILITY PARCEL	

TOTAL: 1,444 AC. TOTAL: 5,225 D.U. Max

SYMBOL LEGEND:

ROAD
FULL MOVEMENT ACCESS POINT
100-YEAR FLOODPLAIN
TRAIL
BUFFER / OS TRAIL CORRIDOR / EASEMENT
NEIGHBORHOOD PARK
ACCESS SPACING (FEET)

VICINITY MAP:

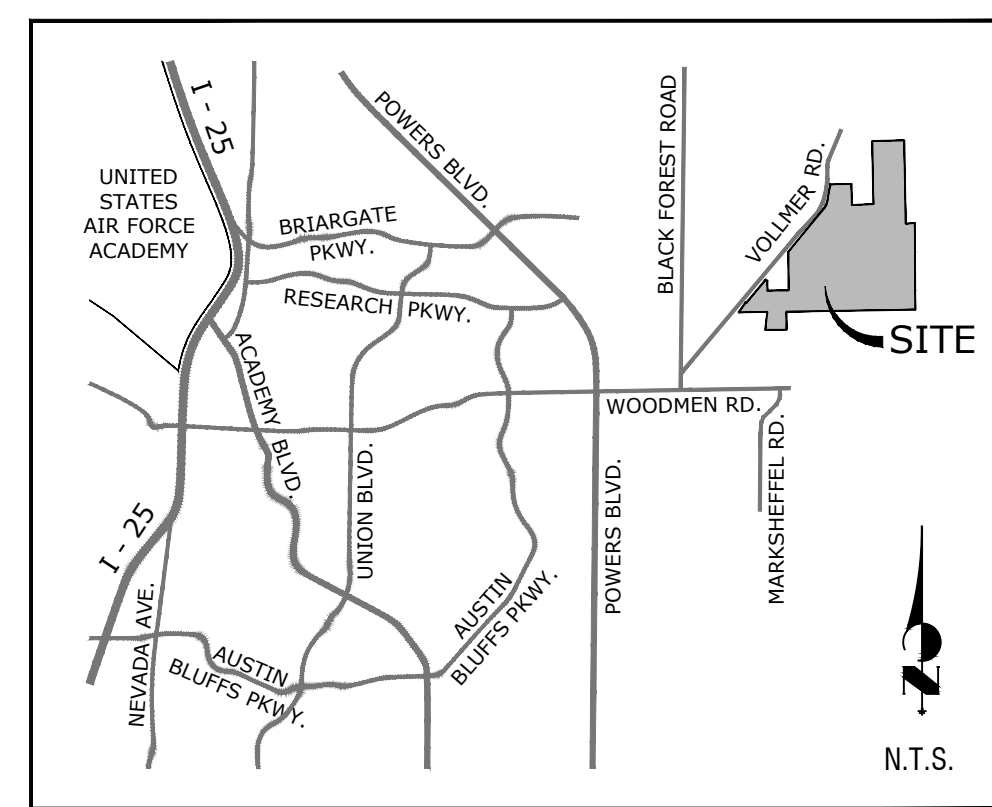

LEGAL DESCRIPTION:

THE WEST HALF OF THE WEST HALF OF THE EAST HALF AND EAST HALF OF THE WEST HALF AND THE SOUTHWEST QUARTER OF THE SOUTHWEST QUARTER OF SECTION 27; THE EAST HALF OF THE SOUTHEAST QUARTER AND THAT PORTION OF THE SOUTHWEST QUARTER OF THE SOUTHEAST QUARTER LYING SOUTH AND EAST OF THE COUNTY ROAD KNOWN AS VOLLMER ROAD, OF SECTION 28; THE WEST HALF OF THE EAST HALF AND THE WEST HALF OF SECTION 34; THE EAST HALF AND THE EAST HALF OF THE SOUTHWEST QUARTER AND THE SOUTHWEST QUARTER OF THE SOUTHWEST QUARTER OF SECTION 33, AND ALL THAT PART OF THE NORTHWEST QUARTER OF SECTION 33 LYING SOUTH AND EAST OF THE COUNTY ROAD KNOWN AS VOLLMER ROAD, EXCEPT THAT PORTION OF THE SOUTHWEST QUARTER OF THE NORTHWEST QUARTER OF SAID SECTION 33 LYING SOUTH AND EAST OF SAID COUNTY ROAD AS DEEDED TO COLORADO INTERSTATE GAS COMPANY BY WARRANTY DEED RECORDED IN BOOK 1173 AT PAGE 359; AND THAT PORTION OF THE NORTHEAST QUARTER OF THE SOUTHEAST QUARTER AND THE SOUTHEAST QUARTER OF THE SOUTHEAST QUARTER LYING SOUTHWEST OF THE COUNTY ROAD KNOWN AS VOLLMER ROAD, OF SECTION 32, EXCEPT THAT PORTION OF THE NORTHEAST QUARTER OF THE SOUTHEAST QUARTER OF SAID SECTION 32 DEEDED TO J. MARCUS BROWN BY TRUSTEES' DEED RECORDED IN BOOK 3292 AT PAGE 168; ALL IN TOWNSHIP 12 SOUTH, RANGE 65 WEST OF THE 6TH P.M., EL PASO COUNTY, COLORADO. ALL THAT PORTION OF THE NORTHWEST QUARTER OF THE SOUTHEAST QUARTER OF SECTION 28, TOWNSHIP 12 SOUTH, RANGE 65 WEST OF THE 6TH P.M., EL PASO COUNTY, COLORADO LYING SOUTH AND EAST OF THE COUNTY ROAD (VOLLMER ROAD), ALSO: THE NORTHWEST QUARTER OF THE NORTHWEST QUARTER OF SECTION 4, TOWNSHIP 13 SOUTH, RANGE 65 WEST OF THE SIXTH PRINCIPAL MERIDIAN, LYING SOUTHERLY OF AN EXISTING EAST - WEST FENCE AS DESCRIBED IN SPECIAL WARRANTY DEED RECORDED DECEMBER 23, 2004 AT RECEPTION NO. 204209417, COUNTY OF EL PASO, STATE OF COLORADO, ALSO: THE SOUTHEAST QUARTER OF THE SOUTHWEST QUARTER OF THE SOUTHEAST QUARTER OF SECTION 32, TOWNSHIP 12 SOUTH, RANGE 65 WEST OF THE 6TH P.M., LYING SOUTHEASTERLY OF THE PUBLIC ROAD KNOWN AS VOLLMER ROAD, EL PASO COUNTY, COLORADO, AND CONTAINING 1443.695 ACRES MORE OR LESS.

NOTES:

1. MTCR, GCR, & PROPOSED CLASSIFICATION AND ROW DATA IS FOUND ON PAGE 16 OF THE 2008 SKETCH PLAN DOCUMENT.

1. NO SCHOOL SITES ARE SHOWN IN THE ACTIVE ADULT COMMUNITY DUE TO THE NATURE OF THE USE. IF THIS USE CHANGES, OR SCHOOL-AGE CHILDREN OCCUPY THESE UNITS, SCHOOL DEDICATION WILL BE MADE.

OWNER & DEVELOPER INFO:

SR LAND, LLC.
20 BOULDER CRESCENT STREET, SUITE 102
COLORADO SPRINGS, CO 80903-3300

CHALLENGER COMMUNITIES, LLC.
8605 EXPLORER DRIVE, SUITE 250
COLORADO SPRINGS, CO 80920-1013

MORLEY BENTLEY/TRADER VICS INVESTMENTS LLC.
P.O. BOX 217
GALENA, KS 66739-0217

Overall Development Dwelling Unit Table

	HOMESTEAD FILING 1 SF-04-029	BRANDING FROM FILING 1 SF-06-017	TOTAL ENTITLED UNITS	REMAINING DEVELOPABLE UNITS	MAXIMUM DWELLING UNITS
DWELLING UNITS	72	51	123	5,102	5,225

ROAD CLASSIFICATION TABLE

Roadway	Existing	2040 MTCR	2050 MTCR/CPP	Sterling Ranch Proposed
Vollmer Road	2 lane Collector - 60'	4 lane Minor - 100'	4 lane Minor - 100'	4 lane Minor - 100'
Briargate Parkway	4 lane Principal - 160'	4 lane Principal - 130'	4 lane Principal - 130'	4 lane Principal - 130'
Banning Lewis Ranch Parkway	4 lane Principal - 130'	4 lane Principal - 130'	4 lane Principal - 130'	4 lane Principal - 130'
Marksheffel Road	2 lane Principal - 130'	4 lane Principal - 130'	4 lane Principal - 130'	4 lane Principal - 130'

*A deviation is requested for Marksheffel Road to be built to the City of Colorado Springs standards.

STERLING RANCH SKETCH PLAN AMENDMENT

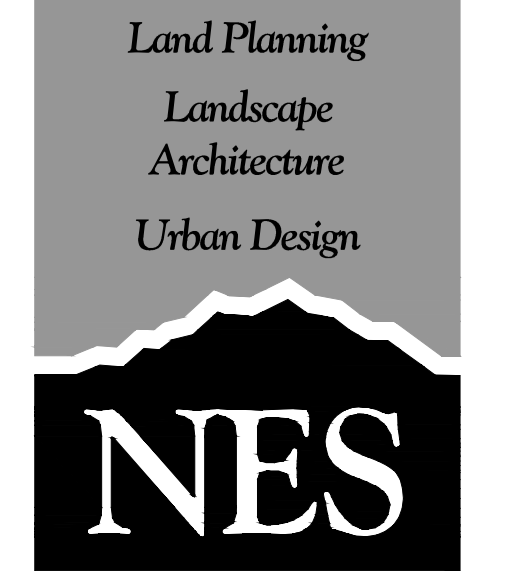
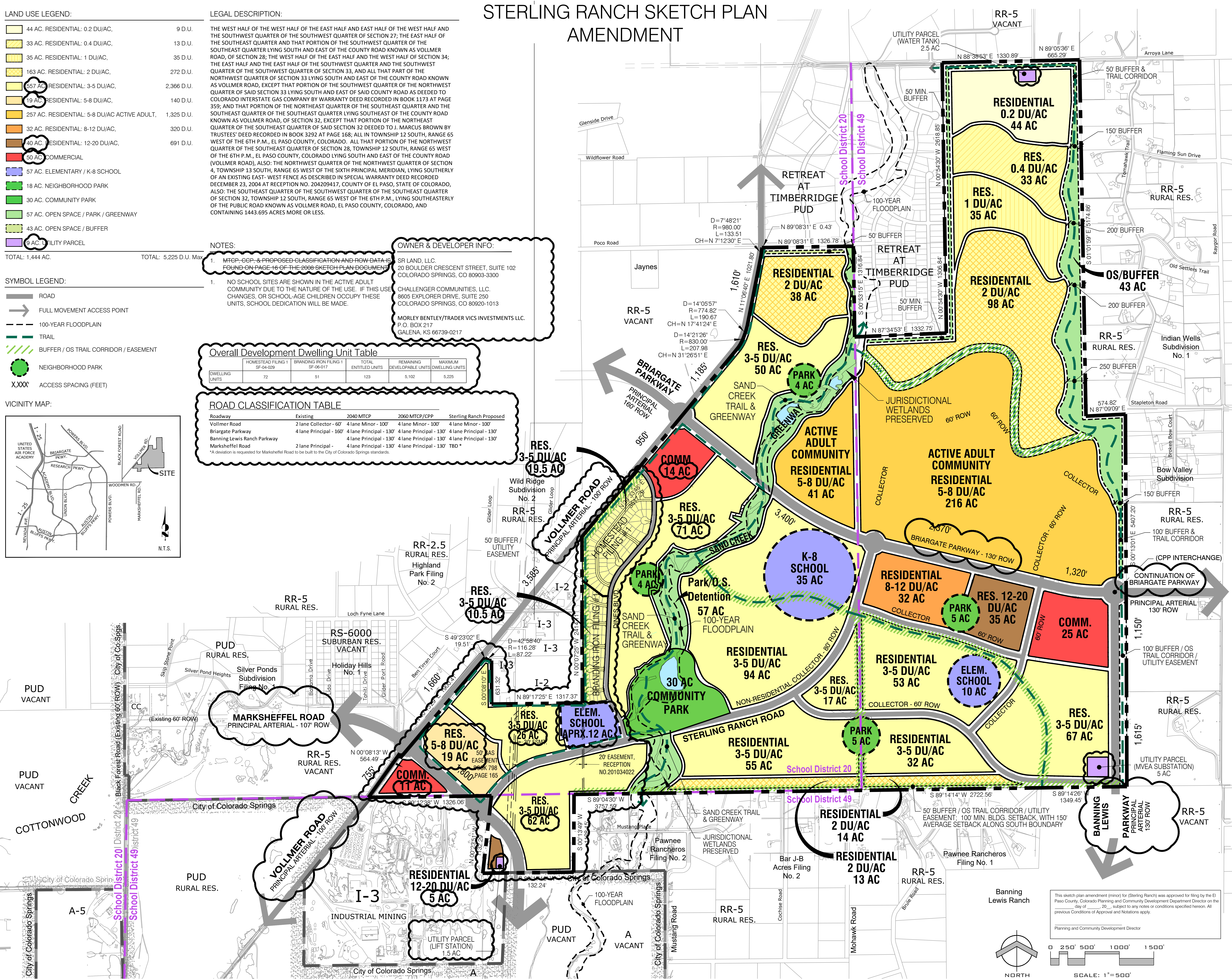

N.E.S. Inc.
619 N. Cascade Avenue, Suite 200
Colorado Springs, CO 80903
Tel. 719.471.0073
Fax 719.471.0267
www.nescolorado.com

© 2012. All Rights Reserved.

STERLING RANCH

SKETCH PLAN AMENDMENT

MORLEY-BENTLEY INVESTMENTS, LLC.

DATE: OCTOBER 29, 2007
PROJECT NO.: J.MAYNARD/J.ROMERO
PREPARED BY: J.KUNNEL/JN-SWIFT

AMENDMENT

DATE	BY	DESCRIPTION
04-10-2008	JLK	COUNTY COMMENTS
04-30-2008	JLK	COUNTY COMMENTS
05-22-2008	JLK	COUNTY COMMENTS
10-13-2008	JLK	AMENDED SKETCH PLAN PER COUNTY COMMENTS
10-29-2008	JLK	AMENDED SKETCH PLAN PER COUNTY COMMENTS
05-22-2009	JLK	AMENDED SKETCH PLAN PER COUNTY COMMENTS
07-12-2018	MS	AMENDMENT
10-25-2018	BI	COUNTY COMMENTS
11-26-2018	BI	COUNTY COMMENTS
11-28-2018	BI	COUNTY COMMENTS

1 OF 1

SKP 07-007